

Versluce M. \$1 = 722.

105-B-3

013386

"H." Claims
Hidden Lake Area

Pete Versluce

- 1 - an area of float bearing disseminated sulphides (Sphalerite)
- 2 - an area of massive sulphide float

DATE Aug. 11-70

ASSAY CERTIFICATE

FILE NO. 6252-5

WHITEHORSE ASSAY OFFICE
P.O. BOX 346. WHITEHORSE. YUKON

RECEIVED FROM H. Versluce

SAMPLE NO.	GOLD OZ. PER TON	SILVER OZ PER TON	Lead	Zinc	Copper	Nickel		
1			.70	10.23				
2				.16				
3					.08	TR		
4		1.42	4.38	5.82				
5		1.94	1.59	5.52				

ASSAYER [Signature]

P. Versluis

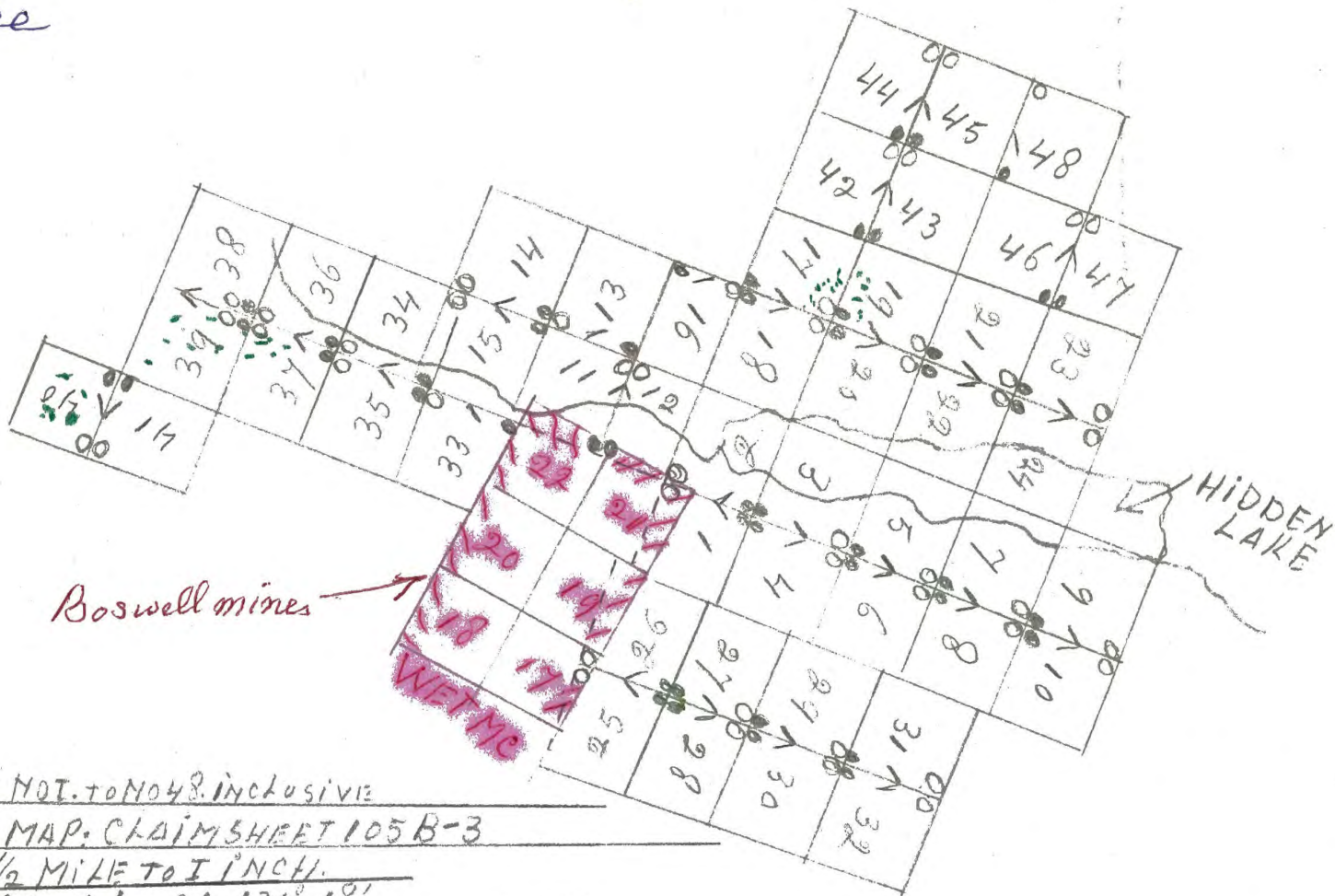

"H" GROUP: MC: NOT TO NO 48 INCLUSIVE

WOLF LAKE MAP: CLAIM SHEET 105 B-3

SCALE: 1/2 MILE TO 1 INCH.

LAT: 60° 13' LONG: 131° 18'

WATSON LAKE MINING DISTRICT.

o POST NO 1

o POST NO 2

- Mineralization local. Sample # 5
- " " In place? " # 4

POST NO 2: WET MC 22 + 21: 1500' SOUTH OF HEAD OF LAKE. AS THIS SKETCH SHOWS

H 37 + 39 new No 1 Post local Sample # 3

H 37 + 39 local in large slide area Sample # 1