

013565

REPORT ON TOTE-TRAIL CONSTRUCTION

CUB PROJECT

CUB, BUC & ROG MINERAL CLAIM GROUPS

Whitehorse Mining District

Yukon Territory

Latitude : 60°54'N

Longitude: 138°13'W

N.T.S. 115-B-16

Work done in the period
June 1st to July 15, 1970

By:

M. E. (TIM) COATES, P. ENG.

ATLAS EXPLORATIONS LIMITED

September 29, 1970

LIST OF CLAIMS

<u>Claim No.</u>	<u>Grand No.</u>	<u>Recording Date</u>
BUC 1-6	Y38257-Y38262	Sept. 26, 1969
ROG 1-40	Y53030-Y53069	June 29, 1970
42-62	Y53545-Y53565	July 15, 1970
CUB 18	Y92280	July 23, 1965
20	Y92282	July 23, 1965
22	Y92284	July 23, 1965

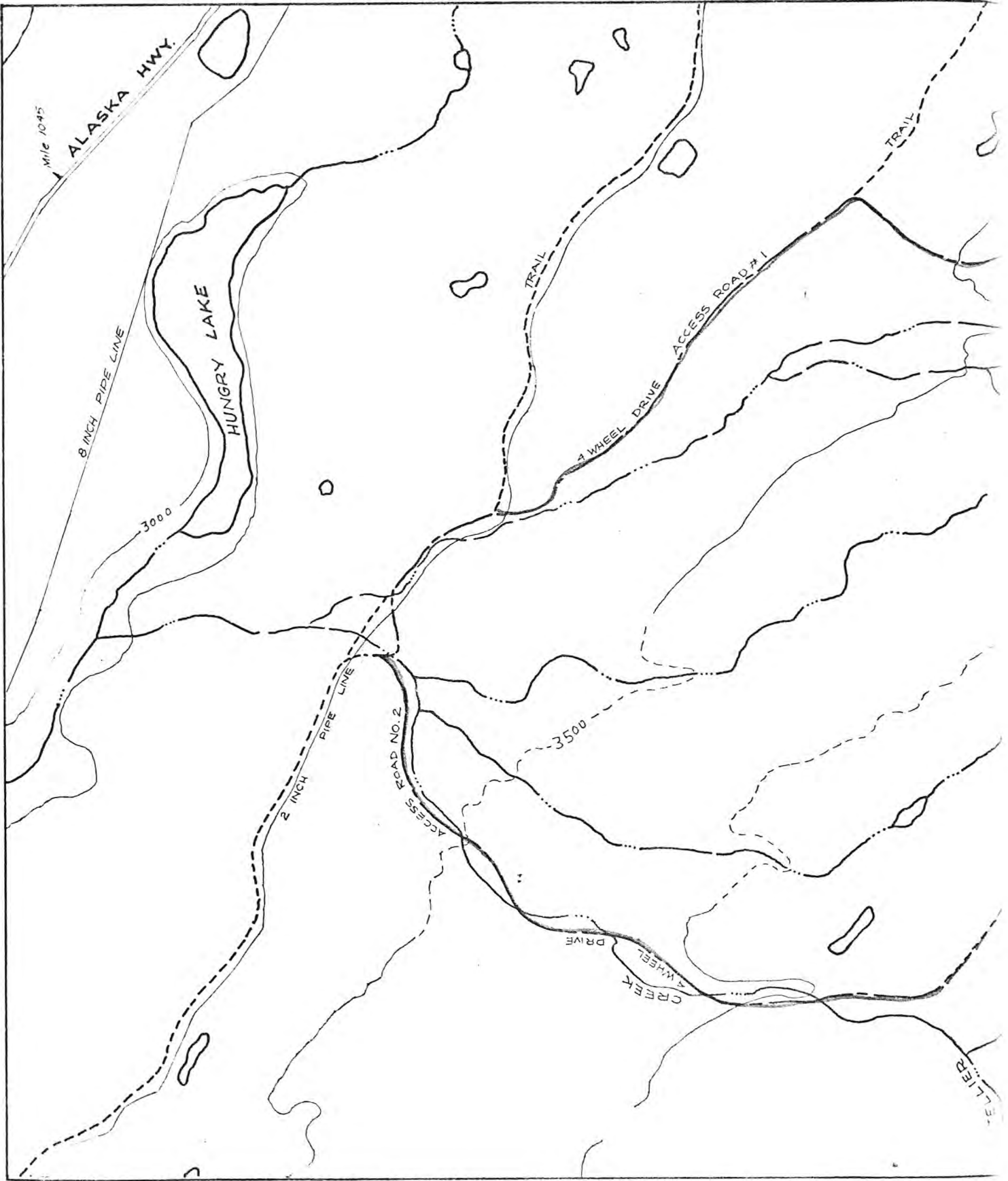

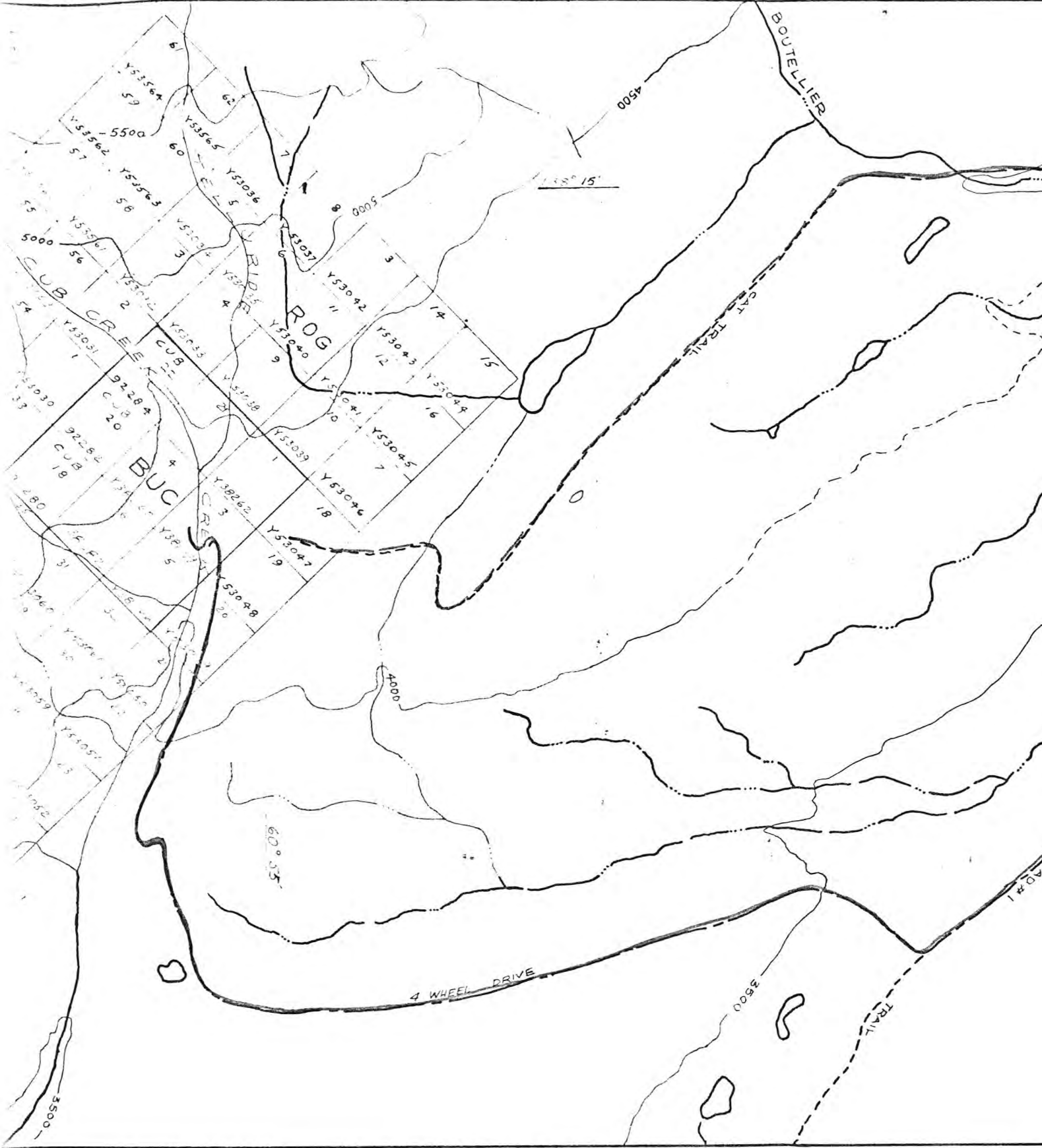

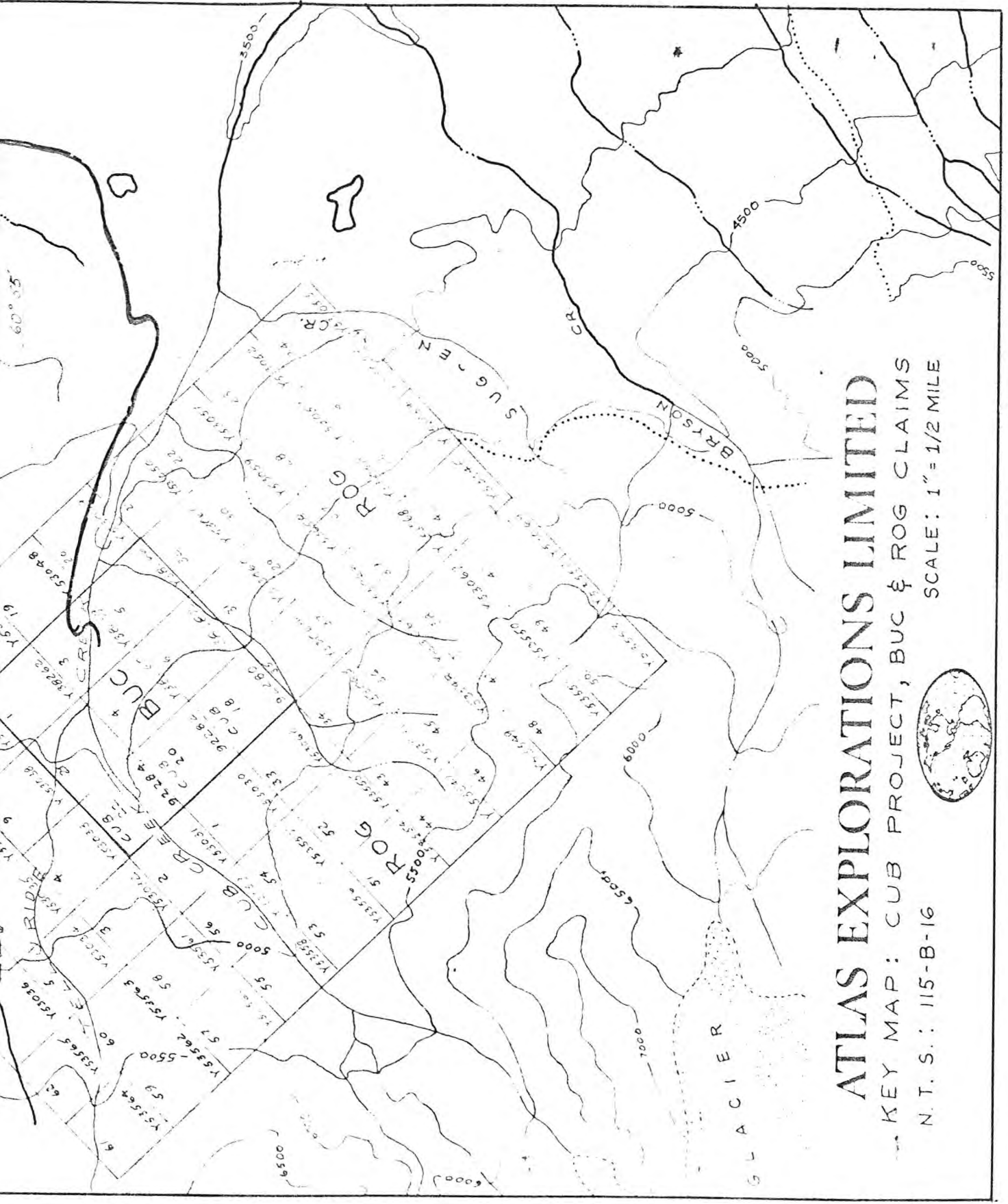

ATLAS EXPLORATIONS LIMITED

KEY MAP: CUB PROJECT, BUC & ROG CLAIMS

N.T.S.: 115-B-16



SCALE: 1" = 1/2 MILE

Figure 1

TABLE OF CONTENTS

	<u>Page</u>
LIST OF CLAIMS	
KEY MAP	
INTRODUCTION	1
LOCATION	1
SCOPE OF WORK	2
Appendix I - Vouchers Supporting Costs	
Appendix II - Summary of Costs	
Appendix III- Affidavit Supporting Summary of Costs	
Appendix IV - List of Personnel	

ATLAS EXPLORATIONS LIMITED

330 MARINE BUILDING
355 BURRARD STREET
VANCOUVER 1, B.C.

REPORT ON TOTE-TRAIL CONSTRUCTION
CUB PROJECT
CUB, BUC & ROG MINERAL CLAIM GROUPS

INTRODUCTION

The CUB Project involved check geological mapping, geo-chemical and geophysical surveys and included 709 ft. of diamond drilling. The tote-trail was used to provide access to the work area by 4-wheel drive vehicles. This mode of transportation was used to move men, supplies and fuel to and from the property.

The D-7E Caterpillar used to construct the tote-road was also used to clear drill sites and move the drill from site to site. The road work was supervised by Gordon Richards, geologist.

LOCATION

The CUB Project area is situated in N.T.S. area 115-B-16 at approximately $60^{\circ}54'N$ latitude and $138^{\circ}13'W$ longitude. The tote-trail can be reached from Mile 1050 on the

Alaska Highway via a C.N. telecommunications road which services a microwave station (See Figure 1).

SCOPE OF WORK

Approximately 12 miles of tote-road were built to provide access to the CUB claims. Two routes were cleared; both originated at an old pipeline which runs parallel to the Alaska Highway.

The first trail follows high ground for a distance of approximately 8 miles from the pipeline to the Elaine Group. Some fill work and a culvert were required in marshy sections near Telluride Creek. The second road along Boutellier Creek, which would have been a more direct route, is impassable near the work area (See Figure 1).

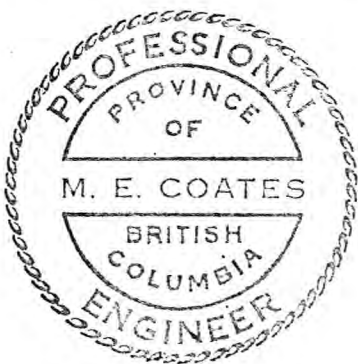

: Respectfully submitted,

A handwritten signature in black ink, appearing to read "M. E. Coates".

M. E. (Tim) Coates
Geologist

Sept. 1970

SUMMARY OF COSTS - CUB CLAIMS
ACCESS ROAD CONSTRUCTION

Wages	Schedule "E"	\$ 424.61
Report Writing	Schedule "G"	102.66
Supplies and Contracts	Schedule "H"	675.00
	Schedule "F"	8,837.14
Camp Support	Schedule "B"	921.26
Expediting	Schedule "A"	<u>84.92</u>
		\$ 11,045.59
Head Office Administration 10%		<u>1,104.56</u>
	TOTAL	\$ <u><u>12,150.15</u></u>

NOTE: Vouchers to support indicated are given in detail in "Report on Diamond Drilling - Cub Project" by M. E. (Tim) Coates, P. Eng. September, 1970.

ATLAS EXPLORATIONS LIMITED

330 MARINE BUILDING
355 BURRARD STREET
VANCOUVER 1, B.C.

AFFIDAVIT SUPPORTING SUMMARY OF COSTS

I, M. E. (TIM) COATES, Geologist, Atlas Explorations Limited, of Vancouver, British Columbia, do hereby state that, to the best of my knowledge and belief, the statement of cost presented in this report (Report on Tote-Trail Construction - Cub Project - Cub, Buc & Rog Mineral Claim Groups) is both correct and true.

M. E. (Tim) Coates

Oct 1 / 1970
Date

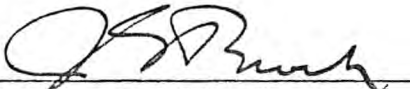
Notary Public in and
for Yukon Territory

LIST OF PERSONNEL

M. E. Coates	Project Manager	Vancouver, B.C.
Gordon Richards	Geologist	Vancouver, B.C.
Jack Acheson	Cat Skinner	Whitehorse, Y.T.
Roman Dust	Helper	Whitehorse, Y.T.
Douglas Jones	Helper	Vancouver, B.C.
Lowen Panzer	Cat Skinner	Whitehorse, Y.T.