

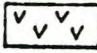

013734
105 H-6

MATT BERRY MINES L^{TD}
WATSON LAKE MINING DIVISION
FRANCES LAKE AREA
YUKON TERRITORY

LEGEND

-  - ACIDIC INTRUSIONS
(Granodiorite, Quartzdiorite & Granite)
-  - BEDIMENTARY ROCKS
(MONTAGUE GROUP)
-  - SURFACE MINERALIZATION

Geology from G.S.C. Map 1048A

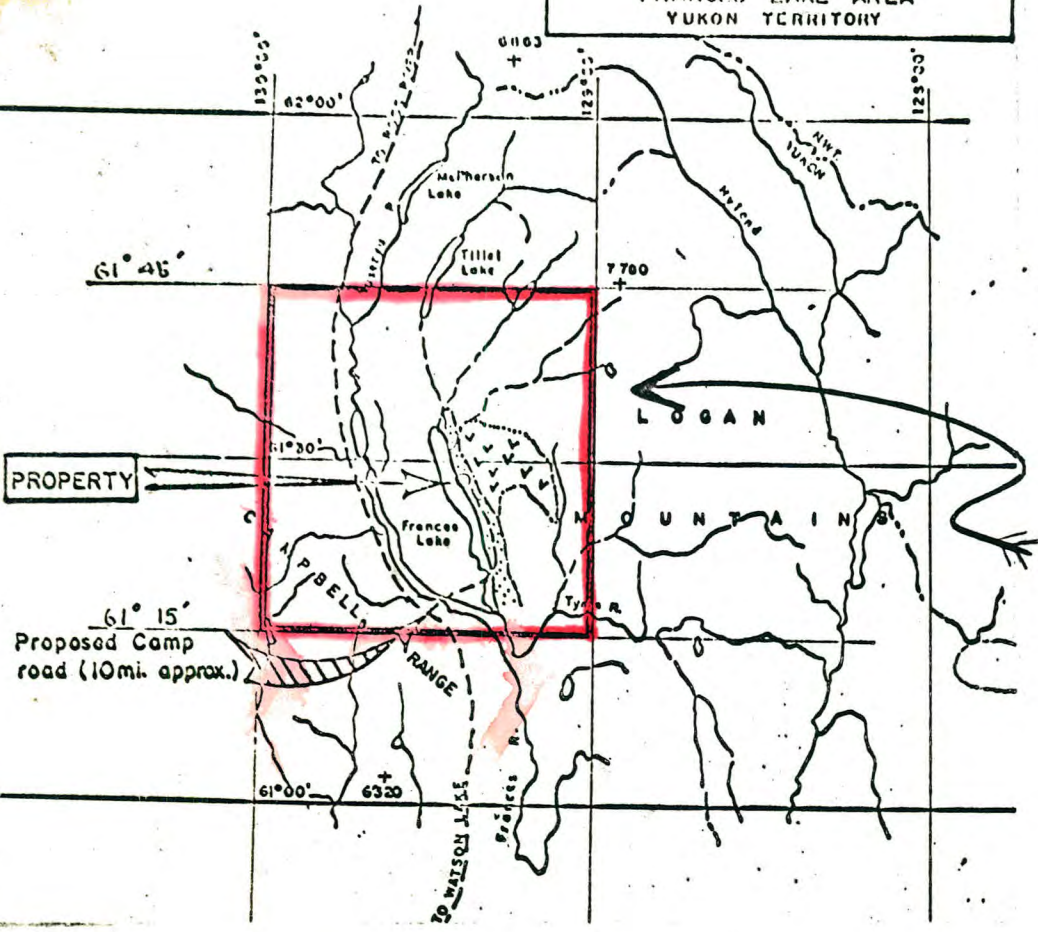

" FRANCES LAKE AREA "

SCHEDULE B

The boundries of the Frances Lake Area is within the Frances Lake Sheet No. 105H, Yukon Territy, N.W.T are as follows:

Latitude 61 degrees 15 minutes to 61 degrees 45 minutes.
Longitude 129 degrees 0 minutes to 130 degrees 0 minutes.

PROPERTY MAP
MATT BERRY MINES LTD.
FRANCES LAKE AREA-YUKON
June 15, 1970

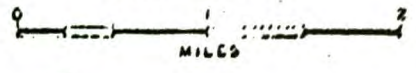

MATT BERRY CLAIMS: Total holdings in Frances Lake project 264 Unpatented Claims.

DON 1-52

AREAS OF MINERALIZATION:

Schedule "A"

Trace of Synclinal Axis Matt Zone ??

61°30'

LAZ 1-91

Matt Zone Drilling in Matt 4 & 6

Approximate Location of Granite

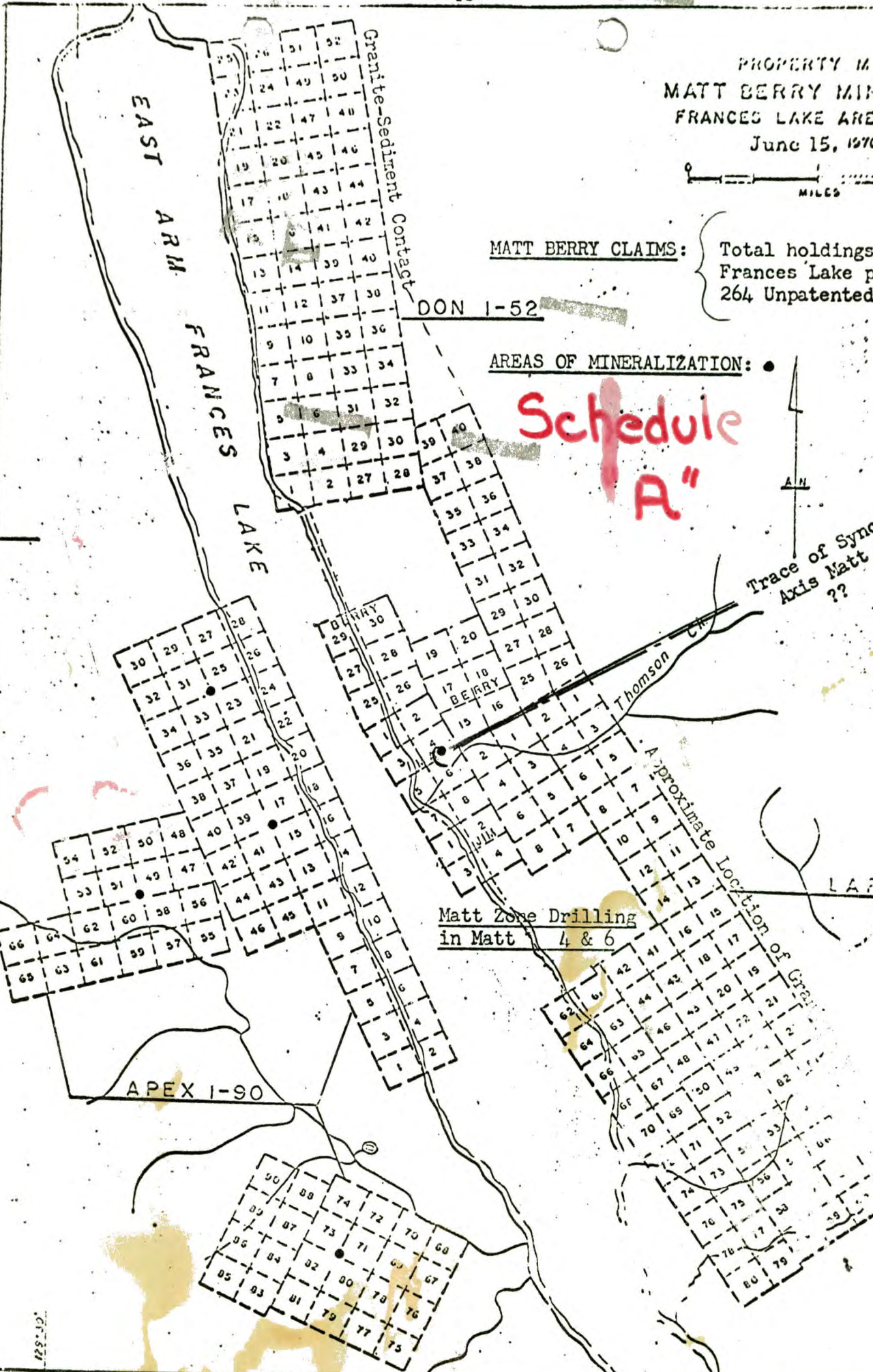

APEX 1-90

CF-521