

105 4 6

ATLAS TESTING LABORATORIES LTD.  
7911 Argyll Road • EDMONTON, ALBERTA • Phone 469-2391

013744

CERTIFICATE OF ASSAY

TO Matt Barry Mines Ltd.,  
Suite 801 - 347 Bay Street,  
Toronto 1, Ontario.

Lab. No. 346  
September 19, 1966

cc: Matt Barry Mines Ltd.,  
Burnaby 2, B.C.

I hereby certify that the following are the results of assays made by me upon the herein described samples.

MARKED	GOLD		SILVER		LEAD	ZINC	Sb	TOTAL VALUE PER TON (2000 LBS.)
	Ounces per Ton	Value per Ton	Ounces per Ton	Value per Ton	Percent	Percent	Percent	
#1254	trace	---	2.3		6.25	11.69	To	
#1255	trace	---	21.4		45.84	14.54	Follow	

Hole N° 1 From 400 ft to 435 ft  
Hole N° 1 From 660 ft to 680 ft

Sept 22/66

These are the first assay results received from core samples from Matt Barry drill log on Frances hole

h.h.

Gold calculated at \$..... per ounce

Silver calculated at \$..... per ounce

Calculated at ..... per lb.

Calculated ..... per lb.

NOTE:

Rejects retained one month.  
Pulps retained three months  
unless otherwise arranged.

*[Signature]*  
Registered Assayer, Province of British Columbia

# DIAMOND DRILL RECORD

PROPERTY MATT BERRY MINES LIMITED HOLE No. 1  
 SHEET NUMBER 1 SECTION FROM Collar TO 68.0 STARTED AUGUST 31, 1966.  
 LATTITUDE \_\_\_\_\_ DATUM \_\_\_\_\_ COMPLETED SEPTEMBER 4, 1966  
 DEPARTURE \_\_\_\_\_ BEARING \_\_\_\_\_ ULTIMATE DEPTH 166'  
 ELEVATION \_\_\_\_\_ DIP \_\_\_\_\_ PROPOSED DEPTH 120'

LOCATION:

SECTION 10 + 50  
 95 FEET COST OF BASE FINE  
 4 FEET SOUTH OF 10 + 50

DIRECTION S 72° W.

DEPTH FEET	FORMATION	SAMPLE NO.	FROM	TO	WIDTH	ASSAY VALUES		
0-14	Casing							
14-205	Slatey Schist							
205 - 25	Quartz with occ. flecks of biotite schist bands at 37.5							
25-39.8	Slatey Schist(1" Minor Pyrite)							
39.8-43.8	Quartz with occ. schist bands	1254	40.0	43.5	3.5'			
	39.8 - 43.5 Sphalerite & oxidized sphalerite with minor F.G. Galena							
	43.5 - 43.8 (30% galena min.)							
43.8-62.5	slatey schist with occ. qtz. less than 1" wide Stringers & oxidized shalerite & pyrite							
62.5-63.5	Quartz & Schist with minor sphalerite							
635-65	Schist with quartz veinlets containing fine gr. galena.							

*bulky gray fine grained, sandy*

*struc. of phyllite, with a lot of large dark, # 10, # 15, # 20, # 25, # 30, # 35, # 40, # 45, # 50, # 55, # 60, # 65, # 70, # 75, # 80, # 85, # 90, # 95, # 100, # 105, # 110, # 115, # 120, # 125, # 130, # 135, # 140, # 145, # 150, # 155, # 160, # 165, # 170, # 175, # 180, # 185, # 190, # 195, # 200, # 205, # 210, # 215, # 220, # 225, # 230, # 235, # 240, # 245, # 250, # 255, # 260, # 265, # 270, # 275, # 280, # 285, # 290, # 295, # 300, # 305, # 310, # 315, # 320, # 325, # 330, # 335, # 340, # 345, # 350, # 355, # 360, # 365, # 370, # 375, # 380, # 385, # 390, # 395, # 400, # 405, # 410, # 415, # 420, # 425, # 430, # 435, # 440, # 445, # 450, # 455, # 460, # 465, # 470, # 475, # 480, # 485, # 490, # 495, # 500, # 505, # 510, # 515, # 520, # 525, # 530, # 535, # 540, # 545, # 550, # 555, # 560, # 565, # 570, # 575, # 580, # 585, # 590, # 595, # 600, # 605, # 610, # 615, # 620, # 625, # 630, # 635, # 640, # 645, # 650, # 655, # 660, # 665, # 670, # 675, # 680, # 685, # 690, # 695, # 700, # 705, # 710, # 715, # 720, # 725, # 730, # 735, # 740, # 745, # 750, # 755, # 760, # 765, # 770, # 775, # 780, # 785, # 790, # 795, # 800, # 805, # 810, # 815, # 820, # 825, # 830, # 835, # 840, # 845, # 850, # 855, # 860, # 865, # 870, # 875, # 880, # 885, # 890, # 895, # 900, # 905, # 910, # 915, # 920, # 925, # 930, # 935, # 940, # 945, # 950, # 955, # 960, # 965, # 970, # 975, # 980, # 985, # 990, # 995, # 1000*

66.0 - 680 vein massive fine to med 1255 66.0 68.0 2.0  
 DRILLED BY grained galena & shalerite SIGNED \_\_\_\_\_

# DIAMOND DRILL RECORD

PROPERTY Francis Lane HOLE No. 1  
 SHEET NUMBER 1 SECTION FROM \_\_\_\_\_ TO \_\_\_\_\_ STARTED \_\_\_\_\_  
 LATITUDE \_\_\_\_\_ DATUM \_\_\_\_\_ COMPLETED \_\_\_\_\_  
 DEPARTURE \_\_\_\_\_ BEARING \_\_\_\_\_ ULTIMATE DEPTH \_\_\_\_\_  
 ELEVATION \_\_\_\_\_ DIP \_\_\_\_\_ PROPOSED DEPTH \_\_\_\_\_

- 1 - 166
- 2 - 122
- 3 - 71
- 4 - 141
- 5 - 93
- 6 - 148
- 7 - 141
- 8 - 181
- 9 - 129

DEPTH FEET	FORMATION	SAMPLE NO.	FROM	TO	WIDTH	ASSAY VALUES			
0-15	Overburden								
15-20.5	Phylitic Slate (P.S.) Dk. gray, <sup>soft</sup> strongly siliceous, SL. contorted ? Fine crevulations, set @ 0-90° to coal, in SW								
20.5-24.5	Qtz zone - Milky wh, massive, minor carb. patches, SW at top of S, & fossils Scatt. throughout of med. gen. calcite & blk. shale - possible fault zone No sulfides								
24.5-40	P.S. - 5-45° to coal - strongly crevul. - becoming shaly in places								

1192

10 - 248      1440

# DIAMOND DRILL RECORD

PROPERTY \_\_\_\_\_ HOLE No. 1

SHEET NUMBER 2 SECTION FROM \_\_\_\_\_ TO \_\_\_\_\_ STARTED \_\_\_\_\_

LATITUDE \_\_\_\_\_ DATUM \_\_\_\_\_ COMPLETED \_\_\_\_\_

DEPARTURE \_\_\_\_\_ BEARING \_\_\_\_\_ ULTIMATE DEPTH \_\_\_\_\_

ELEVATION \_\_\_\_\_ DIP \_\_\_\_\_ PROPOSED DEPTH \_\_\_\_\_

DEPTH FEET	FORMATION	SAMPLE NO.	FROM	TO	WIDTH	ASSAY VALUES			
40-44	SULFIDE VEIN - @ 45° to rock								
(2.5A)	40-40.8 - 25% SULF. mainly ZnS + PbS.								
	40.8-43.5 - CHARITIC QTZ. < 5% SULF.								
	43.5-44.0 - PbS + ZnS in qtz. - 50% SULF.								
44-66	P.S. - OCCASIONAL CLOSE-CUTTING VEINLETZ OF CHALCITE & WR. QTZ. (ZnS) up to 1/4" width Some calcite								
66-68.5	Sulfide Vein -								
(2.5A)	66-67 - 100% SULF. - 75% PbS, 25% ZnS.								
	67-68 - " - 70% ZnS, 25% PbS								
	68-68.5 - WR. QTZ - < 5% SULF.								
68.5-77	P.S. AS (44-66)								

NORTHERN MINER FORM 505 REV. 1/54

DRILLED BY \_\_\_\_\_ SIGNED \_\_\_\_\_



# DIAMOND DRILL RECORD

PROPERTY MATT BERRY MINES LTD HOLE No. 1  
 SHEET NUMBER 2 SECTION FROM 68.0 TO 166 STARTED AUG 31/66  
 LATITUDE \_\_\_\_\_ DATUM \_\_\_\_\_ COMPLETED \_\_\_\_\_  
 DEPARTURE \_\_\_\_\_ BEARING \_\_\_\_\_ ULTIMATE DEPTH 166  
 ELEVATION \_\_\_\_\_ DIP -30° PROPOSED DEPTH 1201

FEET	FORMATION	SAMPLE NO.	FROM	TO	WIDTH	ASSAY VALUES			
58.0-68.5	QTZ: WITH MINOR GARNET								
68.5-77.0	SLATEY SCHIST WITH QTZ Veinlets Containing Minor Sphalerite & Garnet								
77.0-166	SLATEY SCHIST very little qtz.								



DDH - 2

SEE DDH 1

# DIAMOND DRILL RECORD

PROPERTY MATT BERRY MINES LIMITED HOLE No. 2  
 SHEET NUMBER 1 SECTION FROM COLLAR TO \_\_\_\_\_ STARTED SEPTEMBER 4, 1966  
 LATITUDE \_\_\_\_\_ DATUM \_\_\_\_\_ COMPLETED SEPTEMBER 5, 1966  
 DEPARTURE \_\_\_\_\_ BEARING \_\_\_\_\_ ULTIMATE DEPTH 122'  
 ELEVATION \_\_\_\_\_ DIP 60° PROPOSED DEPTH 120'

LOCATION: SECTION 10+ 50  
 4 FEET SOUTH OF SECTION  
 95 FEET EAST OF BASELINE  
 DIRECTION S 72° W

DEPTH FEET	FORMATION	SAMPLE NO.	FROM	TO	WIDTH	ASSAY VALUES		
0-13'	Casing							
13-18'	Qtz. with slatey schist							
18-38	Slatey Schist (6" Qtz. @ 21.5-22) with many small qtz. veinlets							
38.-39.5	Qtz. with considerable sphalerite and galena	7796	38	40	2			
5-43.5	Slatey Schist							
435-455	Quartz with minor slatey schist							
455-580	slatey schist with occ. veinlets of quartz. & sphalerite							
58.0-615	Quartz. & slatey schist with heavy sphalerite & galena mineralization	7797	57	60	3			
61.5 -	slatey schist - banding	7798	60	62	2			
k22	45°							

*-13 sanding, fine grained*  
*13-61 Schist w/ Qtz. - not too much*  
*with little Ubbig - sandy*  
*61-122 Sand - by thick*  
*not dinner in S.S.*  
*Lagen for Mob.*

# DIAMOND DRILL RECORD

PROPERTY ..... HOLE No. 2  
 SHEET NUMBER 1 SECTION FROM ..... TO ..... STARTED .....  
 LATITUDE ..... DATUM ..... COMPLETED .....  
 DEPARTURE ..... BEARING ..... ULTIMATE DEPTH .....  
 ELEVATION ..... DIP ..... PROPOSED DEPTH .....

*R = 95%*

DEPTH FEET	FORMATION	SAMPLE NO.	FROM	TO	WIDTH	ASSAY VALUES			
0-13	O.R.								
13-18	Qty A zone - as in hole # 1								
18-38	P.S. - sil. crystallized								
(152) → 38-39.5	Qty vein - banded - 50% sulf - 25% Pb, 25% Zn								
39.5-58	P.S. - strongly cemented as in hole # 1								
58-62	Vein								
(400)	58-58.5 - 50% sulfides to - 165 to - 205								
	58.5-59.5 chert - 50% sulf								
	59.5-62 - 30% sulf - 25% Pb, 25% Zn								
62-122	P.S. - for same as in hole # 1								
	uncerted - sect @ 60° to core								
	(92) - 1/2" ind - gty strings								

NORTHERN MINER FORM 505 REV./54

DRILLED BY \_\_\_\_\_ SIGNED \_\_\_\_\_

DDH 3

SEE DDH 1

# DIAMOND DRILL RECORD

PROPERTY ..... HOLE No. 3  
 SHEET NUMBER ..... SECTION FROM ..... TO ..... STARTED .....  
 LATITUDE ..... DATUM ..... COMPLETED .....  
 DEPARTURE ..... BEARING ..... ULTIMATE DEPTH .....  
 ELEVATION ..... DIP ..... PROPOSED DEPTH .....

*R = 95%*

DEPTH FEET	FORMATION	SAMPLE NO.	FROM	TO	WIDTH	ASSAY VALUES			
0-12	O.B.								
12-17.5	Qtz - S zone as in hole #1								
17.5-41.5	P.S. - strongly contact								
41.5-47.5	Ken - 75% surface in calcite gts. 20% ZnS, 5% PbS								
47.5-48.5	Pt. - cont as before								
48.5-48.25	Ken zone - 10% surface - mostly ZnS. in chlorite gts.								
48.25-71.0	P.S. - sl. contact. thin cont. mainly calcite, 2" strips 1" wide @ 52.5, 53.0, 57.0-58.0, 63.0 3" stamps - 40% ZnS, 5% PbS @ 64.0 sch @ 75'								

NORTHERN MINER FORM 505 REV./54

DRILLED BY \_\_\_\_\_ SIGNED \_\_\_\_\_

# DIAMOND DRILL RECORD

PROPERTY MATT BERRY MINES LIMITED HOLE No. 3  
 SHEET NUMBER \_\_\_\_\_ SECTION FROM \_\_\_\_\_ TO \_\_\_\_\_ STARTED \_\_\_\_\_  
 LATITUDE \_\_\_\_\_ DATUM \_\_\_\_\_ COMPLETED \_\_\_\_\_  
 DEPARTURE \_\_\_\_\_ BEARING \_\_\_\_\_ ULTIMATE DEPTH \_\_\_\_\_  
 ELEVATION \_\_\_\_\_ DIP 90° PROPOSED DEPTH 71'

LOCATION: SAME AS HOLE NO. 1 & 2

DIRECTION S 72 W

*- 71 Silver -*

DEPTH FEET	FORMATION	SAMPLE NO.	FROM	TO	WIDTH	ASSAY VALUES		
0-13	Casing							
13-18	Black slates & quartz brecciated and recemented foliated 60°							
18-41	Black slates-contorted and foliated							
41-43	Mineralized quartz and slates - galena & sphalerite -- 40% mineralized	7792	41	43	2			
43-45½	Black slates with quartz.							

# DIAMOND DRILL RECORD

PROPERTY MATT BERRY MINES LIMITED HOLE No. 3  
 SHEET NUMBER 2 SECTION FROM \_\_\_\_\_ TO \_\_\_\_\_ STARTED \_\_\_\_\_  
 LATITUDE \_\_\_\_\_ DATUM \_\_\_\_\_ COMPLETED \_\_\_\_\_  
 DEPARTURE \_\_\_\_\_ BEARING \_\_\_\_\_ ULTIMATE DEPTH \_\_\_\_\_  
 ELEVATION \_\_\_\_\_ DIP \_\_\_\_\_ PROPOSED DEPTH 71'

DEPTH FEET	FORMATION	SAMPLE NO.	FROM	TO	WIDTH	ASSAY VALUES			
45½-48½	Mineralized slates & quartzite	7793	45½	46½	1				
	20% combined sphalerite & galena	7794	46½	48½	2				
48½-64½	Black slates foliation at about 60°-numerous mineralized sections								
64½-65½	Mineralized slates & quartz.- quartz.-galena & sphalerite	7795	64½	65½	1				
65½-71	Black Slates								
	About 80% recovery - most loss core in mineralized sections.								





# DIAMOND DRILL RECORD

PROPERTY..... HOLE No. 4

SHEET NUMBER..... SECTION FROM..... TO..... STARTED.....

LATITUDE..... DATUM..... COMPLETED.....

DEPARTURE..... BEARING..... ULTIMATE DEPTH.....

ELEVATION..... DIP..... PROPOSED DEPTH.....

DEPTH FEET	FORMATION	SAMPLE NO.	FROM	TO	WIDTH	ASSAY VALUES			
0-13	O.S.								
13-19	Oty S. Zone - 21 before								
19-36.5	P.S.								
36.5-37.25	Vein zone - 20% sulph <sup>15% Zn</sup> <sub>5% PbS</sub>								
37.25-44.5	P.S. - strongly contacted								
	Start Zn-qtz stringer. Thinned - only								
	Significant zone at 52.5' - 3" <sup>25% PbS</sup> <sub>10% Zn</sub>								
56.5-80	Vein zone								
	54.5-55.5 - 10% PbS minor Zn								
	55.5-56.0 - 10% Zn, " PbS.								
86.0-141	P.S. - 6" chloritic gk <sup>133.0</sup>								
	sch @ 95'								



# DIAMOND DRILL RECORD

PROPERTY MATT BERRY MINES LIMITED HOLE No. 4  
 SHEET NUMBER \_\_\_\_\_ SECTION FROM \_\_\_\_\_ TO \_\_\_\_\_ STARTED \_\_\_\_\_  
 LATITUDE \_\_\_\_\_ DATUM \_\_\_\_\_ COMPLETED \_\_\_\_\_  
 DEPARTURE \_\_\_\_\_ BEARING \_\_\_\_\_ ULTIMATE DEPTH \_\_\_\_\_  
 ELEVATION \_\_\_\_\_ DIP 60° PROPOSED DEPTH 141

LOCATION SAME AS NO. 1, 2 & 3.

DIRECTION S 47° W

- 26 flasing Sandstone  
 26 - ~ 70' Schistose  
 ~ 70 - 141' gebänderte Sandsteine

DEPTH FEET	FORMATION	SAMPLE NO.	FROM	TO	WIDTH	ASSAY VALUES			
0-13	Casing								
13-19½	Quartz vein - brecciated sections of shale material								
19½-36	Black slate with sections of quartz. stringer foliation 70%								
37	Mineralized quartz vein sphalerite & galena-	7787	36	37	1				
37-47½	Black slates with numerous stringer of mineralized quartz with sphalerite	7790	44½	45½	1				
		7791	42½	43½	1				

# DIAMOND DRILL RECORD

PAGE 2

PROPERTY MATT BERRY MINES LIMITED HOLE No. 4  
 SHEET NUMBER 2 SECTION FROM \_\_\_\_\_ TO \_\_\_\_\_ STARTED \_\_\_\_\_  
 LATITUDE \_\_\_\_\_ DATUM \_\_\_\_\_ COMPLETED \_\_\_\_\_  
 DEPARTURE \_\_\_\_\_ BEARING \_\_\_\_\_ ULTIMATE DEPTH \_\_\_\_\_  
 ELEVATION \_\_\_\_\_ DIP \_\_\_\_\_ PROPOSED DEPTH 141

DEPTH FEET	FORMATION	SAMPLE NO.	FROM	TO	WIDTH	ASSAY VALUES			
47½-55	Black slates - bedding at 70% - a number of mineralized quartz veins.	7788	47½	49½	2				
55-57	Quartz vein - fractured and well mineralized galena, spaherite & pyrite	7789	55	57	2				
57-41	Black slates bedding 60° to 75°  RECOVERY IN MINERALIZED ZONES ESTIMATED TO BE 60%.								

DDH 5

SEE DDH 4



# DIAMOND DRILL RECORD

PROPERTY MATT BERRY MINES LIMITED HOLE No. 5  
 SHEET NUMBER \_\_\_\_\_ SECTION FROM \_\_\_\_\_ TO \_\_\_\_\_ STARTED \_\_\_\_\_  
 LATITUDE \_\_\_\_\_ DATUM \_\_\_\_\_ COMPLETED \_\_\_\_\_  
 DEPARTURE \_\_\_\_\_ BEARING \_\_\_\_\_ ULTIMATE DEPTH \_\_\_\_\_  
 ELEVATION \_\_\_\_\_ DIP - 30° PROPOSED DEPTH 93

SAME LOCATION AS NO. 1, 2, 3 & 4.  
 DIRECTION S 47° W

DEPTH FEET	FORMATION	SAMPLE NO.	FROM	TO	WIDTH	ASSAY VALUES			
0 - 9	Casing								
0 - 13½	Black Slates - high contorted								
13½-22	Quartz lenses and slates irregular bedding								
22-39	Black Slates								
39-47	Mineralized zone	7783	39	41	2				
	irregular lenses of sulphides	7784	41	47	6				
	20% mineralized - galena, spaherite & pyrite, patches of black slates.								

*61 - 30' Sand beds fr.*  
*~35' - 69' Schistose fr.*  
*69 - 93 Sand beds fr.*

# DIAMOND DRILL RECORD

PROPERTY MATT BERRY MINES LIMITED HOLE No. 5  
 SHEET NUMBER 2 SECTION FROM \_\_\_\_\_ TO \_\_\_\_\_ STARTED \_\_\_\_\_  
 LATITUDE \_\_\_\_\_ DATUM \_\_\_\_\_ COMPLETED \_\_\_\_\_  
 DEPARTURE \_\_\_\_\_ BEARING \_\_\_\_\_ ULTIMATE DEPTH \_\_\_\_\_  
 ELEVATION \_\_\_\_\_ DIP \_\_\_\_\_ PROPOSED DEPTH 93'

DEPTH FEET	FORMATION	SAMPLE NO.	FROM	TO	WIDTH	ASSAY VALUES			
47-58	Black slates with irregular veinlets of quartz - bedding at 70°								
58-60	Black slates - 15% mineralized sphalerite galena & pyrite - bedding from 45 to 70°	7785	58	60	2				
63	Black slates with irregular mineralized sections - galena sphalerite & pyrite	7786	60	63	3				
63-93	Black slates - shaly bedding at 45°								

# DIAMOND DRILL RECORD

PROPERTY MATT BERRY MINES LIMITED HOLE No. 6  
 SHEET NUMBER \_\_\_\_\_ SECTION FROM \_\_\_\_\_ TO \_\_\_\_\_ STARTED \_\_\_\_\_  
 LATITUDE \_\_\_\_\_ DATUM \_\_\_\_\_ COMPLETED \_\_\_\_\_  
 DEPARTURE \_\_\_\_\_ BEARING \_\_\_\_\_ ULTIMATE DEPTH 148'  
 ELEVATION \_\_\_\_\_ DIP -60° PROPOSED DEPTH \_\_\_\_\_

LOCATION: STATION 71

DEPTH FEET	FORMATION	SAMPLE NO.	FROM	TO	WIDTH	ASSAY VALUES		
0-34	Casing overburden							
34-37	Mineralized - sulphides 40% - sphalerite & galena brecciated & fractured - 60% recovery.	7782	34	37	3			
37-41	Slate - mineralized in sections foliation 30%							
41-148	Slate, black, foliated at 30 to 40% - minor stringers of quartz and carbonates							
14 feet of core loss throughout hole								

NO. 7 - 108 feet east of  
 NO. 6 - at 50° on sections  
 - 12 + 00

# DIAMOND DRILL RECORD

PROPERTY..... HOLE No. 6

SHEET NUMBER..... SECTION FROM..... TO..... STARTED.....

LATITUDE..... DATUM..... COMPLETED.....

DEPARTURE..... BEARING..... ULTIMATE DEPTH.....

ELEVATION..... DIP..... PROPOSED DEPTH.....

PTH FEET	FORMATION	SAMPLE NO.	FROM	TO	WIDTH	ASSAY VALUES			
0-33.5	0.5								
33.5-39	Venite Zone (2.0 R.) 10% sulphur - submic. Pb, Zn								
39-148	Ps. - sch @ 70°								
	39-90 (40' R) sch @ 60°								
	90-148 (95' R) sch @ 75°								

DDH 7

SE E DDH 1

DIAMOND DRILL RECORD

MATE BERRY MINES LTD.

Thompson Creek Property HOLE 7A Logged by R.J. Cathro

Dip- 60° Footage- 141' Date- Sept. 20, 1966

<u>Depth</u>	<u>Recovery(%)</u>	<u>Formation</u>	<u>Sample#</u>	<u>Footage</u>			<u>Rec.</u>
				<u>From</u>	<u>To</u>	<u>Width</u>	
0-54.0		-overburden					
54.0-86.0	95	- <u>Phyllitic Shale</u> - dark grey, soft, strongly schistose @ 85° to core axis, increasing number of narrow quartz stringers and fine crenulations towards 86.0; - (70.0)- 6 inches white chloritic quartz.					
86.0-88.0	50	<u>Vein Zone</u> - vaguely banded, crushed sulfides well cemented in chloritic milky quartz, some carbonate, 25%PbS, minor ZnS.	6901	86.0	88.0	2.0	1.0
88.0-95.0	95	<u>Phyllitic Shale</u> - as 54.0-86.0 but more strongly contorted. (92.0)- 2 inches disseminated PbS in chloritic quartz stringer.					
95.0-97.5	80	<u>Vein Zone</u> - slightly banded, strongly crushed sulfides in quartz matrix. (95.0-96.0)- 45% PbS, 5% ZnS (96.0-97.5)- 10% PbS, 5% ZnS.	6902 6903	95.0 96.0	96.0 97.5	1.0 1.5	1.0 1.25
97.5-141	95	<u>Phyllitic Shale</u> - strongly schistose at 75° to core, very little contortion.					

DIAMOND DRILL RECORD

MATE BERRY MINES LTD.

Thompson Creek Property HOLE 7A Logged by R.J. Cathro

Dip- 60° Footage- 141' Date- Sept. 20, 1966

<u>Depth</u>	<u>Recovery(%)</u>	<u>Formation</u>	<u>Sample#</u>	<u>Footage</u>			<u>Rec.</u>
				<u>From</u>	<u>To</u>	<u>Width</u>	
0-54.0		-overburden					
54.0-86.0	95	- <u>Phyllitic Shale</u> - dark grey, soft, strongly schistose @ 85° to core axis, increasing number of narrow quartz stringers and fine crenulations towards 86.0; - (70.0)- 6 inches white chloritic quartz.					
86.0-88.0	50	<u>Vein Zone</u> - vauelly banded, crushed sulfides well cemented in chloritic milky quartz, some carbonate, 25%PbS, minor ZnS.	6901	86.0	88.0	2.0	1.0
88.0-95.0	95	<u>Phyllitic Shale</u> - as 54.0-86.0 but more strongly contorted. (92.0)- 2 inches disseminated PbS in chloritic quartz stringer.					
95.0-97.5	80	<u>Vein Zone</u> - slightly banded, strongly crushed sulfides in quartz matrix. (95.0-96.0)- 45% PbS, 5% ZnS (96.0-97.5)- 10% PbS, 5% ZnS.	6902 6903	95.0 96.0	96.0 97.5	1.0 1.5	1.0 1.25
97.5-141	95	<u>Phyllitic Shale</u> - strongly schistose at 75° to core, very little contortion.					

DIAMOND DRILL RECORD

HOLE 8

Dip- 60°

Footage- 181

<u>Depth</u>	<u>Recovery</u>	<u>Formation</u>
0-25.0		-overburden
25.0-32.0	95	<u>Phyllitic Shale</u> - dark gray, soft, strongly crushed and contorted schistosity at 45° to core axis.
32.0-39.0	10	<u>Possible Fault Zone</u> - only 6 inches core; gougy chloritic schist, one small piece of disseminated pyrite.
39.0-181.0	95	<u>Phyllitic Shale</u> - schistosity at 80° to core axis. - (48.0-49.5)- white quartz, minor breccian frags. - (51.0-53.0)- white quartz, minor breccia frags. - (53.0-63.0)- 50% patchy white quartz. - (90.0-181.0)- less schistose. - (140.0-146.0)- 50% patchy white quartz. - (150.0-181.0)- scattered patchy white quartz.

DIAMOND DRILL RECORD

HOLE 8

Dip- 60°

Footage- 181

<u>Depth</u>	<u>Recovery</u>	<u>Formation</u>
0-25.0		-overburden
25.0-32.0	95	<u>Phyllitic Shale</u> - dark gray, soft, strongly crushed and contorted schistosity at 45° to core axis.
32.0-39.0	10	<u>Possible Fault Zone</u> - only 6 inches core; gougy chloritic schist, one small piece of disseminated pyrite.
39.0-181.0	95	<u>Phyllitic Shale</u> - schistosity at 80° to core axis. - (48.0-49.5)- white quartz, minor breccian frags. - (51.0-53.0)- white quartz, minor breccia frags. - (53.0-63.0)- 50% patchy white quartz. - (90.0-181.0)- less schistose. - (140.0-146.0)- 50% patchy white quartz. - (150.0-181.0)- scattered patchy white quartz.

DDH 9

SEE DDH 1

DDH 8

DIAMOND DRILL RECORD

HOLE 9A

Dip- 70°

Footage- 129

<u>Depth</u>	<u>Recovery (%)</u>	<u>Formation</u>	<u>Sample#</u>	<u>From</u>	<u>To</u>	<u>Footage Width</u>	<u>Rec.</u>
0-25.0		-overburden-					
25.0-61.0	95	<u>Phyllitic Shale</u> -dark grey, soft, strongly schistose at 55° to core axis (52.0-61.0)- strongly contorted.					
61.0-62.5	85	<u>Vein Zone</u> -(61.0-61.5)- white chloritic quartz -(61.5-62.5) 20%PbS, 5%ZnS, strongly crushed.	6904	61.5	62.5	1.0	0.75
62.5-77.0	65	<u>Phyllite shale</u> -as (52.0-61.0)					
77.0-79.0	75	<u>Vein Zone</u> -25% ZnS, minor PbS, Pyrite in chloritic quartz.	6905	77.0	79.0	2.0	1.5
79.0-90.5	95	<u>Phyllitic Shale</u> -as (52.0-61.0)					
90.5-96.0	95	<u>Vein Zone</u> -(90.5-92.5)- strongly crushed massive sulfide zone- 70%PbS, 20%ZnS. -(92.5-95.0)- banded patchy sulfides- 25%PbS, 5% ZnS. -(95.0-96.0)- chloritic quartz.	6906 6907	90.5 92.5	92.5 95.0	2.0 2.5	2.0 2.5
96.0-129.0	95	<u>Phyllitic Shale</u> -Schistosity at 70° to core axis, some contortion and brecciation close to vein zone.					

DIAMOND DRILL RECORD

HOLE 9A

Dip- 70°

Footage- 129

<u>Depth</u>	<u>Recovery (%)</u>	<u>Formation</u>	<u>Sample#</u>	<u>From</u>	<u>To</u>	<u>Footage Width</u>	<u>Rec.</u>
0-25.0		-overburden					
25.0-61.0	95	<u>Phyllitic Shale</u> -dark grey, soft, strongly schistose at 55° to core axis (52.0-61.0)- strongly contorted.					
61.0-62.5	85	<u>Vein Zone</u> -(61.0-61.5)- white chloritic quartz -(61.5-62.5) 20%PbS, 5%ZnS, strongly crushed.	6904	61.5	62.5	1.0	0.75
62.5-77.0	65	<u>Phyllite shale</u> -as (52.0-61.0)					
77.0-79.0	75	<u>Vein Zone</u> -25% ZnS, minor PbS, Pyrite in chloritic quartz.	6905	77.0	79.0	2.0	1.5
79.0-90.5	95	<u>Phyllitic Shale</u> -as (52.0-61.0)					
90.5-96.0	95	<u>Vein Zone</u> -(90.5-92.5)- strongly crushed massive sulfide zone- 70%PbS, 20%ZnS. -(92.5-95.0)- banded patchy sulfides- 25%PbS, 5% ZnS. -(95.0-96.0)- chloritic quartz.	6906 6907	90.5 92.5	92.5 95.0	2.0 2.5	2.0 2.5
96.0-129.0	95	<u>Phyllitic Shale</u> -Schistosity at 70° to core axis, some contortion and brecciation close to vein zone.					

Diamond Drill Record

Matt Berry Mines Ltd.

Thompson Creek Property

Hole #10

Logged by R.J. Cathro

Dip- 60°

Footage- 248

Date- Sept. 28, 1966

<u>Depth</u>	<u>Recovery</u> (%)	<u>Formation</u>	<u>Sample</u>	<u>From</u>	<u>To</u>	<u>Width</u>	<u>Rec.</u>
0-37.0	-	over burden					
37.0-171.0	95	Phyllitic Shale- as before sch. @ 60° bedding @ 90° (6.5-62.0) patchy, chloritic quartz. (62.0-67.0) strongly contort. c fine gtz.-carb. stringers. (133.0)(143.0)- 6" wh. gtz.- carb. (142.0 on)- occasional narrow gtz veinlets c small pyritic patches. (161.0)- 6" white gtz. and buff carb. (162.0)- minor ZnS in narrow veinlets.					
171.0-171.5	95	Vein Zone- medium-grained PbS, minor pyrite in chloritic gtz.-carb.- 10% sulfides.	6908	171.0	171.5	0.5	95
171.5-173.25	95	Phyllitic Shale- as before.					
173.25-177.5		Vein Zone- strongly chloritic wh. gtz. & buff carb.- patchy & vaguely banded. (173.25-174.25) 15% ZnS, 15% PbS. (174.25-176.5) minor patchy stringers- PbS, ZnS- 2% sulfides. (176.5-177.5) 5% PbS, 5% ZnS.	6909 6910 6911	173.25 174.25 174.25 176.5 176.5 177.5	174.25 174.25 176.5 176.5 177.5	1.0 2.25 1.0	95 95 95
177.5-179.5	95	Phyllitic Shale- as before.					

<u>Depth</u>	<u>Recovery</u> (%)	<u>Formation</u>	<u>Sample</u>	<u>From</u>	<u>To</u>	<u>Footage</u> <u>Unit</u> <u>Width</u>	<u>Rec.</u>
179.5-182.5		Vein Zone- (179.5-181.0)- selective replacement along sch. planes- PbS in some, ZnS in others, mainly gtz. gangue & some chloritic carbonate.	6912	179.5	181.0	1.5	90
		(181.0-182.5)- gtz. carb. gangue- no mineralization.					
182.5-202.5		<u>Phyllitic Shale</u> - as before, sch. @ 50°.					
202.5-204.0		Vein Zone- 50% sulfides, 35% PbS, 15% ZnS, strongly crushed; wh. chloritic gtz. & buff carb. gangue.	6913	202.5	204.0	1.5	90
204.0-240.0		<u>Phyllitic Shale</u> - as before- sch. @ 50°-70°.					

Diamond Drill Record

Matt Berry Mines Ltd.

Thompson Creek Property

Hole #10

Logged by R.J. Cathro

Dip- 60°

Footage- 248

Date- Sept. 28, 1966

<u>Depth</u>	<u>Recovery</u> (%)	<u>Formation</u>	<u>Sample</u>	<u>From</u>	<u>Footage</u> <u>to</u>	<u>Width</u>	<u>Rec.</u>
<del>0-37.0</del>	-	over burden					
37.0-171.0	95	<u>Phyllitic Shale</u> - as before sch. @ 60°, bedding @ 90° (6.5-62.0) patchy, chloritic quartz. (62.0-67.0) strongly contort. ē fine gtz.-carb. stringers. (133.0)(143.0)- 6" wh. gtz.- carb. (142.0 on)- occasional narrow gtz veinlets ē small pyritic patches. (161.0)- 6" white gtz. and buff carb. (162.0)- minor ZnS in narrow veinlets.					
171.0-171.5	95	<u>Vein Zone</u> - medium-grained PbS, minor pyrite in chloritic gtz.-carb.- 10% sulfides.	6908	171.0	171.5	0.5	95
171.5-173.25	95	<u>Phyllitic Shale</u> - as before.					
173.25-177.5		<u>Vein Zone</u> - strongly chloritic wh. gtz. & buff carb.- patchy & vaguely banded. (173.25-174.25) 15% ZnS, 15% PbS. (174.25-176.5) minor patchy stringers- PbS, ZnS- 2% sulfides. (176.5-177.5) 5% PbS, 5% ZnS.	6909 6910 6911	173.25	174.25	1.0	95 95 95
177.5-179.5	95	<u>Phyllitic Shale</u> - as before.					

<u>Depth</u>	<u>Recovery</u> (%)	<u>Formation</u>	<u>Sample</u>	<u>From</u>	<u>To</u>	<u>Footage</u> <u>Width</u>	<u>Rec.</u>
179.5-182.5		<u>Vein Zone-</u> (179.5-181.0)- selective replacement along sch. planes- PbS in some, ZnS in others, mainly gtz. gangue & some chloritic carbonate.	6912	179.5	181.0	1.5	90
		(181.0-182.5)- gtz. carb. gangue- no mineralization.					
182.5-202.5		<u>Phyllitic Shale-</u> as before, sch. @ 50°.					
202.5-204.0		<u>Vein Zone-</u> 50% sulfides, 35% PbS, 15% ZnS, strongly crushed; wh. chloritic gtz. & buff carb. gangue.	6913	202.5	204.0	1.5	90
204.0-240.0		<u>Phyllitic Shale-</u> as before- sch. @ 50°-70°.					

Hole #11

Dip- 60°

Footage about 200

Date- October 1, 1966

<u>Depth</u>	<u>Recovery</u>	<u>Formation</u>
0-12	85	<p><u>Phyllitic Shale-</u>                      (12-30)- numerous chloritic qtz. patches narrow veinlets schistosity very contorted.                      (26.5-29.5)- 1.0' core- gougy shale.                      (30-69)- minor short contort sections and chloritic qtz. patches; sch. @ various angles to core axis.                      (67.0-69.0)- 0.75' core.</p>
69.0-69.5	95	<p><u>Vein Zone-</u> unmineralized, dk. gry vein qtz.- brecciated.</p>
69.5-71.0	35	<p><u>Phyllitic Shale-</u> 0.5' core.</p>
71.0-79.0	5	<p><u>Ground Core-</u> only 0.5' recovered- all phyllitic shale.</p>
79.0		<p><u>Vein Zone-</u> only 2" core recovered, 50% ZnS, minor PbS, closely resembles sulfide zones in previous drilling.</p>
79.0-194.0	75	<p><u>Phyllitic Shale-</u> dissem. pyrite in some places, sch. @ 20°, banding @ 80° to core axis; several gouge sections may indicate small faults.                      (79.0-83.0)- 0.5' core.                      (83.0)- 2" muddy gouge.                      (83.0-86.0)- 1.5' core.                      (90.0)- 2" muddy gouge.                      (115.0)- " " "                      (123.5) " " "                      (138.0-142.0)- no core.                      (142.0-146.0)- 1.0' core.                      (147.5)- 0.5' zone of banded, pyritic, chloritic qtz.                      (160.0-165.0)- 0.25' core.                      (174.0-179.0)- 0.25' core- all gouge.                      (179.0-179.5)- soft, muddy shale.</p>
194.0 on		<p>? - core not seen.</p>

Hole #11

Dip- 60°

Footage about 200

Date- October 1, 1966

<u>Depth</u>	<u>Recovery</u> %	<u>Formation</u>
0-12	85	<u>Phyllitic Shale-</u> (12-30)- numerous chloritic <u>qtz.</u> patches narrow veinlets schistosity very contorted. (26.5-29.5)- 1.0' core- gougy shale. (30-69)- minor short contort sections and chloritic <u>qtz.</u> patches; sch. @ various angles to core axis. (67.0-69.0)- 0.75' core.
69.0-69.5	95	<u>Vein Zone-</u> unmineralized, dk. gry vein <u>qtz.</u> - brecciated.
69.5-71.0	35	<u>Phyllitic Shale-</u> 0.5' core.
71.0-79.0	5	<u>Ground Core-</u> only 0.5' recovered- all phyllitic shale.
79.0		<u>Vein Zone-</u> only 2" core recovered, 50% ZnS, minor PbS, closely resembles sulfide zones in previous drilling.
79.0-194.0	75	<u>Phyllitic Shale-</u> dissem. pyrite in some places, sch. @ 20°, banding @ 80° to core axis; several gouge sections may indicate small faults. (79.0-83.0)- 0.5' core. (83.0)- 2" muddy gouge. (83.0-86.0)- 1.5' core. (90.0)- 2" muddy gouge. (115.0)- " " " (123.5) " " " (138.0-142.0)- no core. (142.0-146.0)- 1.0' core. (147.5)- 0.5' zone of banded, pyritic, chloritic <u>qtz.</u> (160.0-165.0)- 0.25' core. (174.0-179.0)- 0.25' core- all gouge. (179.0-179.5)- soft, muddy shale.
194.0 on		? - core not seen.

DDH 12

SEE DDH 11

DIAMOND DRILL RECORD

MATT BERRY MINES LTD.

Thompson Creek property HOLE 12

Logged by A.R. Archer

Dip→ Footage- 100'

Date- Oct. 22, 1966

<u>Depth</u>	<u>Recovery</u>	<u>Formation</u>	<u>Sample#</u>	<u>Footage</u>		<u>Rec.</u>	
				<u>From</u>	<u>To</u>		<u>Width</u>
0-10.0		-overburden					
10-78.5	60	- <u>Phyllitic Shale</u> -dark grey, soft, strongly schistose @ 60° to core axis, core broken, num- erous mud seams and quartz stringers.  (54.0-78.5)- becom- ing increasingly chloritic.  (70.0-73.0) no core.					
78.5-81.0	75	- <u>Vein Zone</u> -(78.5-79.5)- broken core, several frag- ments with PbS, ZnS, minor chalcopyrite.	7248	78.5	79.5	1.0	0.5
		-(79.5-81.0)- 20% sulfides, strongly chloritic.	7249	79.5	81.0	1.5	1.5
81.0-100.0	100	- <u>Phyllitic Shale</u> -as before; trace pyrrhotite @ 84.0					

DIAMOND DRILL RECORD

MATT BERRY MINES LTD.

Thompson Creek property HOLE 12

Logged by A.R. Archer

Dip→

Footage- 100'

Date- Oct. 22, 1966

<u>Depth</u>	<u>Recovery</u>	<u>Formation</u>	<u>Sample#</u>	<u>Footage</u>			<u>Rec.</u>
				<u>From</u>	<u>To</u>	<u>Width</u>	
0-10.0		-overburdan					
10-78.5	60	- <u>Phyllitic Shale</u> -dark grey, soft, strongly schistose @ 60° to core axis, core broken, num- erous mud seams and quartz stringers.  (54.0-78.5)- becom- ing increasingly chloritic.  (70.0-73.0) no core.					
78.5-81.0	75	- <u>Vein Zone</u> -(78.5-79.5)- broken core, several frag- ments with PbS, ZnS, minor chalcopyrite.	7248	78.5	79.5	1.0	0.5
		-(79.5-81.0)- 20% sulfides, strongly chloritic.	7249	79.5	81.0	1.5	1.5
81.0-100.0	100	- <u>Phyllitic Shale</u> -as before; trace pyrrhotie @ 84.0					

DIAMOND DRILL RECORD

MATT BERRY MINES LTD.

Thompson Creek Property

Hole 13

Logged by A.R. Archer

Dip-

Footage- 279.0

Date- Oct. 22, 1966

Depth

Recovery (%)

Formation

0-32.0

-overburden

32.0-279.0

95

-Phyllitic Shale

-dark grey, soft, strongly  
schistose from 70°-80° to  
core axis.

-(50.0-60.0) broken chloritic.

-(90.0) schistosity flattens  
to 30°.

-(107.0-115.0)- 60% recovery,  
core broken, 20% gtz.

DIAMOND DRILL RECORD

MATT BERRY MINES LTD.

Thompson Creek Property

Hole 13

Logged by A.R. Archer

Dip-

Footage- 279.0

Date- Oct. 22, 1966

Depth

Recovery (%)

Formation

0-32.0

-overburden

32.0-279.0

95

-Phyllitic Shale

-dark grey, soft, strongly  
schistose from 70°-80° to  
core axis.

-(50.0-60.0) broken chloritic.

-(90.0) schistosity flattens  
to 30°.

-(107.0-115.0)- 60% recovery,  
core broken, 20% gtz.

DDH 14

SEE DDH 10

MATT BERRY MINES LIMITED

DRILL HOLE RECORD

Hole No. 14 at -90 degrees

Depth: 343.0 Casing 42 feet

Proposed 300 feet End of month 274 feet

Started Nov. 9, 1968 Completed Nov. 14, 1968  
(started at 69.0 feet)

Location: 15+20 on B.L. (S 66° E)  
0+50 (N 24° E)  
Elevation 2743.5

Objective:  
To intersect MATT BERRY ZONE  
extending strike length of zone.

Results:

Intersected MATT BERRY ZONE  
from 250.5 to 258.0, inclusive,  
7.5 feet averaging 7.21 ounces Silver,  
15.10 % Lead and 11.60 % Zinc;  
with minor amounts of metallization  
in both the hanging wall (244.0-  
250.5) and footwall (258.0-259.0)  
sections.

H.S.G.

DAIMOND DRILL RECORD

MATT BERRY MINES LTD.

Thompson Creek Property

Hole 14

Logged by A.R. Archer

Dip-

Footage 69.0

Date- Oct. 22, 1966

Depth

Recovery (%)

Formation

0-42.0

-overburden

42.0-69.0

-Phyllitic Shale  
-dark grey, soft,  
strongly schistose @  
80° to core axis.

HOLE FROZEN IN.

DAIMOND DRILL RECORD

MATT BERRY MINES LTD.

Thompson Creek Property

Hole 14

Logged by A.R. Archer

Dip-

Footage 69.0

Date- Oct. 22, 1966

Depth

Recovery (%)

Formation

0-42.0

-overburden

42.0-69.0

-Phyllitic Shale  
-dark grey, soft,  
strongly schistose @  
80° to core axis.

HOLE FROZEN IN.

DDH 15

SEE DDH 4

MATT BERRY MINES LIMITED

DRILL HOLE RECORD

Hole No. 15 at -90 degrees

Depth: 421 feet Casing 62 feet

Proposed \_\_\_\_\_ feet End of month \_\_\_\_\_ feet

Started November 16, 1968 Completed November 29, 1968

Location: 1606.5 on B.L. (S66°E)  
10.5 (N24°E) Elevation 2761.5

Objective:  
To intersect MATT BERRY ZONE  
extending Strike length of zone  
87 feet.

Results:  
Intersected MATT BERRY Zone  
from 191.5 to 196.3 (inclusive)  
4.8 feet ~~assaying~~ 2.90 ounces Ag  
5.87 % Pb and 5.35 % Zn with  
very minor metallization in the  
footwall section

Copy

DDH 16

SEE DDH 4

MATT BERRY MINES LIMITED

DRILL HOLE RECORD

Hole No. 16 at -90° degrees

Depth: ~~148.0~~ 149.0 feet Casing 31.5 feet

Proposed \_\_\_\_\_ feet End of month \_\_\_\_\_ feet

Started December 1/68 Completed December 7/68

Location: 17+34 on B.L. (566° E)  
(Elevation 2711.5)

Objective:  
To intersect MATT BERRY ZONE  
~~and~~ extending strike length of zone  
127.5 feet.

Results:

Intersected MATT BERRY ZONE  
from 89.0 to 98.0 feet inclusive  
9 feet averaging 2.19 ounces Ag  
4.24% Pb and 6.24% Zn  
with minor metallurgy in the  
footwall section

Copy

1734  
1009.5  
127.5

DDH 17

SEE DDH 1

DDH 16

MAT. BERRY MINES LIMITED

DRILL HOLE RECORD

Hole No. 17 at -60 degrees

Depth: 115.0' Casing 37 feet

Proposed \_\_\_\_\_ feet End of month \_\_\_\_\_ feet

Started December 7/68 Completed January 31, 1969

Location: 17 + 34 on B.L.  
Drilling S 24° W  
Elevation 2711.5

Objective:  
To intersect Matt Berry Zone  
cut in Hole No. 16 and obtain definite  
information as to the dip of this  
Results: zone.

Intersected Matt Berry Zone from  
63.0 - 79.0 feet; sampled ~~zone~~ zone  
as follows

<u>Sample No. 11642</u>	<u>63.0 - 69.5</u>
<u>11643</u>	<u>69.5 - 72.5</u>
<u>11644</u>	<u>73.5 - 79.0</u>

and shipped samples to Crest  
Laboratories, Edmonton, for  
analyses.

This drilling indicated that the  
Matt Berry Zone <sup>here</sup> is dipping 47°  
~~47~~ degrees to the northeast

MATT BERRY MINES LIMITED

DRILL HOLE RECORD

Hole No. 17 at -60 degrees (drilling S 24°W)

Depth: Casing ~~340~~ feet  
37.0

Proposed 100.0 feet End of month 38.0 feet

Started December 7/68 Completed \_\_\_\_\_

Work halted temporarily Dec. 10/68)

Location:  
17+34 on B.L.  
Drilling to southward

Objective:  
To intersect Matt Berry Zone  
cut in Hole No. 16 and ~~get~~ obtain  
definite information as to dip of this  
zone

Results:  
Work shut down temporarily for  
holiday season.

115'  
38  
77

COPY

DDH 18

SEE DDH 10

N 24° E  
ELEVATION  
2790 ↗

BASE LINE S 66° E

OVERBURDEN

184 ← MATT BERRY ZONE

184 -  
185 - 188  
188 - 189  
189 - 190  
190 - 191  
191 - 192  
192 - 193  
193 - 194  
194 - 195  
195 - 196  
196 - 197  
197 - 198  
198 - 199  
199 - 200  
200 - 201  
201 - 202  
202 - 203  
203 - 204  
204 - 205  
205 - 206  
206 - 207  
207 - 208  
208 - 209  
209 - 210  
210 - 211  
211 - 212  
212 - 213  
213 - 214  
214 - 215  
215 - 216  
216 - 217  
217 - 218  
218 - 219  
219 - 220  
220 - 221  
221 - 222  
222 - 223  
223 - 224  
224 - 225  
225 - 226  
226 - 227  
227 - 228  
228 - 229  
229 - 230  
230 - 231  
231 - 232  
232 - 233  
233 - 234  
234 - 235  
235 - 236  
236 - 237  
237 - 238  
238 - 239  
239 - 240  
240 - 241  
241 - 242  
242 - 243  
243 - 244  
244 - 245  
245 - 246  
246 - 247  
247 - 248  
248 - 249  
249 - 250  
250 - 251  
251 - 252  
252 - 253  
253 - 254  
254 - 255  
255 - 256  
256 - 257  
257 - 258  
258 - 259  
259 - 260  
260 - 261  
261 - 262  
262 - 263  
263 - 264  
264 - 265  
265 - 266  
266 - 267  
267 - 268  
268 - 269  
269 - 270  
270 - 271  
271 - 272  
272 - 273  
273 - 274  
274 - 275  
275 - 276  
276 - 277  
277 - 278  
278 - 279  
279 - 280  
280 - 281  
281 - 282  
282 - 283  
283 - 284  
284 - 285  
285 - 286  
286 - 287  
287 - 288  
288 - 289  
289 - 290  
290 - 291  
291 - 292  
292 - 293  
293 - 294  
294 - 295  
295 - 296  
296 - 297  
297 - 298  
298 - 299  
299 - 300  
300 - 301  
301 - 302  
302 - 303  
303 - 304  
304 - 305  
305 - 306  
306 - 307  
307 - 308  
308 - 309  
309 - 310  
310 - 311  
311 - 312  
312 - 313  
313 - 314  
314 - 315  
315 - 316  
316 - 317  
317 - 318  
318 - 319  
319 - 320  
320 - 321  
321 - 322  
322 - 323  
323 - 324  
324 - 325  
325 - 326  
326 - 327  
327 - 328  
328 - 329  
329 - 330  
330 - 331

331'

MATT BERRY MINES LTD
SECTION D-D
HOLE NO. 18
Scale 1" = 30' Feb 14/69

MATT BERRY MINES LIMITED

DRILL HOLE RECORD

Hole No. 18 at -90 degrees  
Depth: 331 feet Casing 93 feet (Bedrock 92.0)  
Proposed 400 feet End of month 331 feet  
Started February 5/1969 Completed February 12, 1969

Location: 19+00 on the B.L. (S 66° E)  
0+75 N 24° E Elevation 2790

Objective: To intersect the MATT BERRY ZONE  
and extend the length of the zone  
Results: 166 feet (to the South 66° E)

Intersected MATT BERRY ZONE  
from 184 to ~~189.5~~ <sup>190.0</sup> with fair to  
massive sulphide replacement from  
185 to 188 consisting mainly of ~~zinc~~ <sup>ZnS</sup> (10%)  
galena (5%) and minor amounts of chalcopyrite  
in a quartz carbonate gangue.

Just as soon as Mike Phillips  
ships in proper core splitter to handle  
"B" size core, will sample & ship  
samples to Crest Laboratories for analysis.

MAT BERRY MINES LIMITED

DRILL HOLE RECORD

Hole No. 19 at -90 degrees

Depth: 407 feet Casing 82 feet

Proposed 400 feet End of month 738 feet

Started February 14, 1969 Completed February 19, 1969

Location: 21+50 on the Baseline  
0+75 N 24° E

Objective: To extend the Matt Berry Zone  
250 feet to the Southeast

Results:

The hole intersected the Matt Berry Zone from 108.5 to 152.1 with mineralizations occurring in at least four sections: from 109-111; 117.3-119.9; 146.1-149.5; 150.0 to 152.1 with barren material between (siliceous argillite). In those four sections chalcopyrite predominates; sphalerite comes next in amount with galena in lesser amount. There is more sphalerite in the last two sections than in the first two.

The core will be sampled and sent out to Crest Laboratories for assay.

D.D. Hole No. 19

N 24° E →

OVERBURDEN

BASIS LINE

109 - 111'  
117.3 - 119.9

Barren Phyll

Barren

146.1 - 149.5  
150.0 - 152.1

Barren

MATT BERRY ZONE

230'

Contact between Siliceous Argillite and impure siliceous Limestone

467'

MATT BERRY MINES LTD

SECTION

D.D. HOLE No 19

Scale 30' = 1 inch FEB. 19/69

# DIAMOND DRILL RECORD

PROPERTY Matt Berry Mines Ltd  
 LOCATION: LAT. 19° 00' on the BL  
 DEP. 0+75 N24°E  
 ELEVATION OF COLLAR 2792'  
 DATUM Trancis Lake (2540)  
 BEARING \_\_\_\_\_  
 DIRECTION AT START: DIP ± 90°  
 LOGGED BY Adel Cammann HOR. COMP. \_\_\_\_\_  
 PURPOSE OF HOLE Extension skatke VER. COMP. \_\_\_\_\_  
M.B.Z.

TESTS			TESTS			Core	
Ft.	Dip.	Ast. Bearing	Ft.	Dip.	Ast. Bearing	Ft. Received	p.c. Recovery
						243.5	75%

HOLE NUMBER 19  
 SHEET NUMBER 1  
 SECTION FROM 0 TO \_\_\_\_\_  
 STARTED Feb. 14, 1969  
 COMPLETED Feb 19, 1969  
 ULTIMATE DEPTH 407'  
 PROPOSED DEPTH 400'

DRILLED BY Arctic Diamond Drilling

Distance		ROCK	DESCRIPTION	Sample No.	Length Ft.	ANALYSIS						
from	to					Au.	Ag.	Pb.	Zn.	Cu.	Ave.	
0	82	<u>Overburden</u>										
82.0	108.5	<u>Phyllitic shale</u>	Thin bedded with 90° to core axis (95.6-96.8) - Brecc. gtz and carb. with veinlets of mineralization: FeS <sub>2</sub> , magnetite - CuFeS <sub>2</sub> ? (101.2-101.8) - brecc. gtz. carb. with stringers of FeS <sub>2</sub> minus CuFeS <sub>2</sub> .									
108.5	152.1	<u>Matt Berry Zone</u>	Mineralization occurs in the following sections: a) (109.0-111.0), b- (117.3-119.9), c- (146.1-149.5), d- (150.0-152.1) - CuFeS <sub>2</sub> predominates in all sections, there are more ZnS and PbS in the last two sections than in the first two. Barren phyllitic shale between the sections with sch. 60°.	11652	1.0							108.0-109.0
152.1	230.0	<u>Phyllitic shale</u>	(152.1-179.0) highly sheared with gtz. stringers with traces of FeS, CuFeS <sub>2</sub> . (179.0-230.0) - twisted schistosity. (179.0-230.0) flat sch. gtz. stringers with traces of CuFeS <sub>2</sub> & ZnS	11653	1.0							109-110
230.0	407.0	<u>Clastic quartz schist</u>	Greyish with talc and muscovite, sch. from flat to contorted (338.0-336.0), (398.0-400.0) with FeS <sub>2</sub> speckles of CuFeS <sub>2</sub>	11654	1.0							110-111
				11655	1.0							111-112
				11656	1.0							112-113
				11657	1.0							113-114
				11658	1.0							114-115
				11659	0.7							115-116
				11660	1.0							116-117
				11661	1.1							117-118
												118-119
												119-120
												146.1-146.7
												146.7-147.7
												147.7-149.3
												149.3-150.0
												150.0-151
												151-152.1
												319.0-320.0

*Adel Cammann*

# DIAMOND DRILL RECORD

PROPERTY Mat Berry Mines Ltd  
 LOCATION: LAT. 19° 00' on the B.L.  
 DEP. 0+75 N24°E  
 ELEVATION OF COLLAR 2793'  
 DATUM Francis Lake (2540)  
 DIRECTION AT START: BEARING \_\_\_\_\_  
 DIP ± 90°  
 LOGGED BY Adel Camman HOR. COMP. \_\_\_\_\_  
 PURPOSE OF HOLE Extension strike VER. COMP. \_\_\_\_\_  
M.B.Z.

TESTS							
Ft.	Dip.	Ast. Bearing	Ft.	Dip.	Ast. Bearing	Core	
						Ft. Received	p.c. Recovery
						243.5	75%

HOLE NUMBER 19  
 SHEET NUMBER 1  
 SECTION FROM 0 TO \_\_\_\_\_  
 STARTED Feb. 14, 1969  
 COMPLETED Feb 19, 1969  
 ULTIMATE DEPTH 407'  
 PROPOSED DEPTH 400

DRILLED BY Arctic Diamond Drilling

Distance		ROCK	DESCRIPTION	Sample No.	Length Ft.	ANALYSIS						
from	to					Au.	Ag.	Pb.	Zn.	Cu.	Ave.	
0	82	<u>Overburden</u>										
82.0	108.5	<u>Phyllitic shale</u>	Thin bedded with 90° to core axis (95.6-96.8) - Brecc. gtz and carb. with veinlets of mineralization: FeS <sub>2</sub> , magnetite - CuFeS <sub>2</sub> ? (101.2-101.8) - brecc. gtz. carb. with stringers of FeS <sub>2</sub> minor CuFeS <sub>2</sub> .									
108.5	152.1	<u>Mat Berry Zone</u>	Mineralization occurs in the following sections: a) (109.0-111.0), b) (117.3-119.9), c) (146.1-149.5), d) (150.0-152.1) - CuFeS <sub>2</sub> predominates in all sections, there are more ZnS and PbS in the last two sections than in the first two. Barren phyllitic shale between the sections with sch. 60°.	11652	1.0							1080-1090
				11653	1.0							109-110
				11654	1.0							110-111
				11655	1.0							117-118
				11656	1.0							118-119
				11657	1.0							119-120
				11658	0.6							146.1-146.7
				11659	1.0							146.7-147.7
				11660	1.6							147.7-149.3
				11661	0.7							149.3-150.0
2.1	230.0	<u>Phyllitic shale</u>	(152.1-179.0) highly sheared with gtz. stringers with traces of FeS <sub>2</sub> , CuFeS <sub>2</sub> . (179.0-230.0) - twisted schistosity. (199.0-230.0) flat sch., gtz. stringers with traces of CuFeS <sub>2</sub> & ZnS	11662	1.0							150.0-151
				11663	1.1							151-152.1
230.0	407.0	<u>Clastic quartz schist</u>	Greyish with talc and muscovite, sch. from flat to contorted (332.0-336.0), (398.0-400.0) with FeS <sub>2</sub> speckles of late S <sub>2</sub>	11664	1.0							319.0-320.0

Adel Camman

DDH No 20

Elevation 2785'

Overburden  
117 feet

239 feet

Matt Betty Zone  
Highly sheared and ganggy  
argillite and phyllitic  
shale with numerous  
mud seams and disseminated  
pyrite and minor chalcophite.  
Quartzite stringers and veinlets  
with pyrite.

350 feet

433 feet

MATT BERRY MINES LTD.

SECTION

DDH No. 20

Scale 30' = 1"

MARCH 5 / 69

A. Tammam

MA. BERRY MINES LIMITED

DRILL HOLE RECORD

Hole No. 20 at -90 degrees

Depth: 433 feet

Casing 133 feet

Proposed 400 feet

End of month 11711 feet

Started February 21, 1969

Completed March 5, 1969

Location: 20+00 on the Base Line

2+00 N 24° E - Elevation 2785 feet

Objective: To intersect Matt Betty Zone  
and obtain informations as to the dip.

Results:

Intersected Matt Betty Zone from 239' to 350'.  
In this interval the M.B.Z. consists in highly shear and gassy  
argillite and phyllitic shale with numerous minor seams and  
disseminated pyrite, minor chalcopyrite. Quartzite stringers  
and veinlets with pyrite and chalcopyrite are present along  
all the section. The zone is sampled as follows:

Sample No. 11669 (248.2 - 251.4)

" " 11670 (349' - 350')

and shipped samples to Crest Laboratories, Edmonton.



PROPERTY Matt Benny Mines Ltd.  
 LOCATION: LAT. 20 1 00 BL  
 DEP. 2 1 00 N 24° E  
 ELEVATION OF COLLAR 2 7 85'  
 DATUM Francis Lake (2540')  
 DIRECTION AT START: BEARING \_\_\_\_\_  
 DIP -90°  
 LOGGED BY Adel Tammar HOR. COMP. \_\_\_\_\_  
 PURPOSE OF HOLE Extension dip VER. COMP. \_\_\_\_\_  
M. D. 2

# DIAMOND DRILL RECORD

## TESTS

Ft.	Dip.	Ast. Bearing	Ft.	Dip.	Ast. Bearing	Core	
						Ft. Received	p.c. Recovery
						244	77%

HOLE NUMBER 20  
 SHEET NUMBER 1  
 SECTION FROM \_\_\_\_\_ TO \_\_\_\_\_  
 STARTED Feb. 21-1969  
 COMPLETED March 5-1969  
 ULTIMATE DEPTH 433  
 PROPOSED DEPTH 400

DRILLED BY Arctic Diamond Drilling

Distance		ROCK	DESCRIPTION	Sample No.	Length Ft.	ANALYSIS						
from	to					Au.	Ag.	Pb.	Zn.	Cu.	Ave.	
0	117	<u>Overburden</u>										
117	122	<u>Quartz</u>	with veinlets of FeS <sub>2</sub> - CuFeS <sub>2</sub>	11665	2.4							
122	239	<u>phyllitic shale</u>	Dark grey, strongly sch., 50° to core axis. mud seams in part and qtz. stringers with FeS <sub>2</sub> , CuFeS <sub>2</sub> . (147-153) - caving (152-153) - one foot of qtz vein with FeS <sub>2</sub> , CuFeS <sub>2</sub> (184.9-187.0) - diss. FeS <sub>2</sub> - qtz stringers with CuFeS <sub>2</sub> (187.0-190.9) - as above with increasing number of qtz. stringers and fine crenulation	11666	1.0							
239.0	350.5	<u>Matt Benny Zone</u>	Highly sheared and ganggy argillite and phyllitic shale with numerous mud seams and disseminated FeS <sub>2</sub> , minor CuFeS <sub>2</sub> . qtz. stringers and veinlets with FeS <sub>2</sub> CuFeS <sub>2</sub> (248.2-251.4) - diss. FeS <sub>2</sub> with qtz veinlets in phyll. shab (315.4-318.4) - only 5" core - speckles of CuFeS <sub>2</sub> (318.4-320.6) - only 6" core - qtz. with CuFeS <sub>2</sub> (348.0-350.3) - phyll. shale with 3" of qtz with CuFeS <sub>2</sub>	11667	2.1							
				11668	3.9							
350.5	432.0	<u>Phyllitic shale</u>	As above, sch. 70° (398.4-400.5) - white quartz; from 400 to 400.5 clonitic qtz with CuFeS <sub>2</sub> (401.7-402.6) - clonitic qtz	11669	3.2							
				11670	1.3							
				11671	2.1							
				11672	0.9							

MAT. BERRY MINES LIMITED

DRILL HOLE RECORD

Hole No. 21

at 75 degrees

Depth: 340 feet

Casing 110 feet Bedrock 106 feet

Proposed 400 feet

End of month 340 feet

Started March 7, 1969

Completed March 15, 1969

Location: 18+00 on the Baseline  
2+50 N24°E

Objective: Intersect Mat Betty Zone and obtain information as to the dip.

Results:

The suspected zone was intersected from 224 feet to 268 feet, in which the both HW and FW are dark grey phyllitic shale with contorted schistosity and numerous mud seams. The inferred vein (2.2 foot core from 226.8-229) is a dark grey, brecciated quartz with no visible mineralization. Nevertheless, we find mineralizations in the following sections:

- (228.1 - 229.0) - 9 inches of brecciated quartz; traces of chalcopyrite
- (229.0 - 233.3) - Phyllitic shale: numerous quartzitic stringers with pyrite - minor chalcopyrite - sphalerite?
- (235.7 - 236.0) - 3 inches of white quartz with visible chalcopyrite and pyrite.
- (345.0 - 346.3) - numerous veinlets and stringers of quartz with chalcopyrite, pyrite, sphalerite as traces?
- (347.2 - 348.5) - Phyllitic shale with veinlets of quartz as above.

There is another suspected zone from 322 feet to 336 feet which consists in the both HW and FW of dark grey phyllitic shale with contorted schistosity and mud seams; mineralizations is to be found in the following sections:

- (324.8 - 325.3) - 5 inches of brecciated carbonate with quartz, chalcopyrite, pyrite, minor sphalerite.
- (328.0 - 329.0) - one foot of brecciated carbonate with quartz, chalcopyrite, pyrite and more visible sphalerite.

Apart from the Matt Betty Zone we find mineralizations in the following sections:

- (142.8 - 150.2) - only 4 feet core of brecciated quartz with pyrite, minor chalcopryite.
- (168.4 - 171.0) - quartzitic vein with chalcopryite, minor pyrite. - only 10 inches core.
- (207.0 - 207.9) - 9 inches of quartz and carbonate with 4% chalcopryite, 2% pyrite.

The core is sampled as follows:

Sample No.	11673	(142.8' - 144.6')
"	"	11674 (144.6' - 146.0')
"	"	11675 (226.8' - 229.0')
"	"	11676 (247.2 - 248.5)
"	"	11677 (324.8 - 325.3)
"	"	11678 (328.0 - 329.0)

and shipped to Crest Laboratories, Edmonton.

Ed Samson

Don't agree with the log

should be correct

Ed Samson

N24°E

Elevation 2795

-75° toward the BL ←

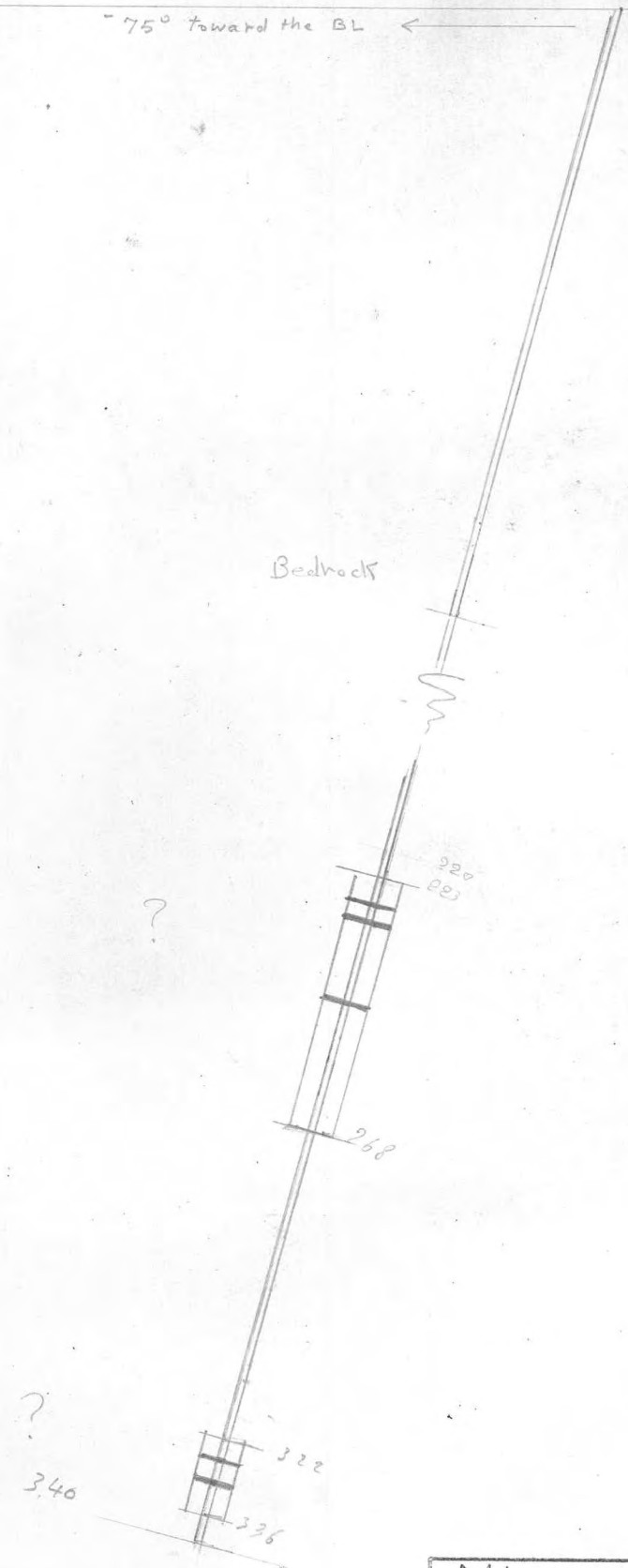

MATT BERRY MINES LTD.	
Section	
DDH No. 21	
Scale 1 INCH = 30 FEET	Match 16 / 69
A. Tammam	



# DIAMOND DRILL RECORD

PROPERTY Matt Betty Mines Ltd  
 LOCATION: LAT. \_\_\_\_\_  
 DEP. \_\_\_\_\_  
 ELEVATION OF COLLAR \_\_\_\_\_  
 DATUM \_\_\_\_\_  
 DIRECTION AT START: BEARING \_\_\_\_\_  
 DIP \_\_\_\_\_  
 LOGGED BY \_\_\_\_\_ HOR. COMP. \_\_\_\_\_  
 PURPOSE OF HOLE \_\_\_\_\_ VER. COMP. \_\_\_\_\_

TESTS

Ft.	Dip.	Ast. Bearing	Ft.	Dip.	Ast. Bearing	Core	
						Ft. Received	p.c. Recovery

HOLE NUMBER 21  
 SHEET NUMBER 2  
 SECTION FROM 268 TO 340  
 STARTED \_\_\_\_\_  
 COMPLETED \_\_\_\_\_  
 ULTIMATE DEPTH \_\_\_\_\_  
 PROPOSED DEPTH \_\_\_\_\_

DRILLED BY \_\_\_\_\_

Distance		ROCK	DESCRIPTION	Sample No.	Length Ft.	ANALYSIS						
from	to					Au.	Ag.	Pb.	Zn.	Cu.		Ave.
268	322	<u>Phyllitic Shale</u>	dark grey, strongly schistose, parallel to core axis, some contortion (268-305) - some mud seams (305-306) - disseminated cubic crystals of pyrite, speckles of chalcopyrite (306-322) - schistosity from very contorted to parallel to core axis -	11680	1.0							
322	340	<u>Matt Betty Zone?</u>	(324.7-325.0) - brecciated, white qtz. with speckles of chalcopyrite - pyrite - chlorite - (sphalerite?) - 5" core (325.0-328.0) - shear and gangy phyllitic shale. (328.0-329.0) - brecciated carbonate with; qtz, speckles of chalcopyrite - minor sphalerite? - pyrite. (329.0-333.7) - <del>strongly</del> phyllitic shale strongly schistose with mud seams. sch. 30° to core axis (333.7-336.0) - Phyllitic shale with schistosity <sup>perpendicular</sup> <del>parallel</del> to core axis (336.0-340) - Less schistosity, contorted bands.	11681 11682	0.5 1.0							

# DIAMOND DRILL RECORD

PROPERTY Math Betty Mines Ltd  
 LOCATION: LAT. 1800' - BL  
 DEP. 250' - N 24° E  
 ELEVATION OF COLLAR 2795'  
 DATUM Francis Lake (2540')  
 DIRECTION AT START: BEARING \_\_\_\_\_  
 DIP 75°  
 LOGGED BY A. Tamm HOR. COMP. \_\_\_\_\_  
 PURPOSE OF HOLE Extension dip VER. COMP. \_\_\_\_\_  
Math Betty Zone

HOLE NUMBER 21  
 SHEET NUMBER 1  
 SECTION FROM \_\_\_\_\_ TO \_\_\_\_\_  
 STARTED March 7, 1969  
 COMPLETED March 15, 1969  
 ULTIMATE DEPTH 340'  
 PROPOSED DEPTH 400'

### TESTS

Ft.	Dip.	Ast. Bearing	Ft.	Dip.	Ast. Bearing	Core	
						Ft. Received	p.c. Recovery

DRILLED BY \_\_\_\_\_

Distance		ROCK	DESCRIPTION	Sample No.	Length Ft.	ANALYSIS						
from	to					Au.	Ag.	Pb.	Zn.	Cu.	Ave.	
0	107	<u>Bedrock</u>										
107	224	<u>Phyllitic Shale</u>	Dark grey, schistosity from <sup>perpend.</sup> parallel to 30° to core axis wavy surface with dull micaceous luster (115 - 136) - schistosity <sup>perp.</sup> parallel to core axis (136 - 141) - " 20° to core axis (142.7 - 144.1) - qtz. vein with some schistos bands - chalcopyrite, pyrite; one speckle of galena - sphalerite? (144.6 - 150.0) - milky qtz as above. (168.4 - 171.0) - only 8" core of white qtz with veinlets of chalcopy. (183.0 - 190.0) - strongly foliated and fractured phyllitic shale. (190.0 - 190.8) - brecc. white qtz. with phyllite digestion - veinlets of chalcopyrite and pyrite. (198.0 - 207.2) - Phyllitic shale - schistosity 30° - less schistose. (207.2 - 207.8) - white qtz and buff carbonate with speckles of chalcopyrite - granular pyrite; traces of sphalerite? (215 - 224) - Phyllitic shale with mud seams close to the zone (216.9 - 217.9) greyish qtz. - no visible mineral.	11673	1.6							
					11674	2.6						
					11675	0.8						
					11676	0.6						
224	268	<u>Math Betty Zone?</u>	(224.5 - 225.4) - brecciated qtz - no visible mineralization (226.9 - 228.1) - brecc. qtz as above with numerous phyll. digestion (228.1 - 268) - Phyllitic shale, schistosity from 60° to flat numerous stringers of qtz with cubic crystals of pyrite. (235.7 - 236.0) - 3 inches of highly chalcopyritic qtz. (247.3 - 248.5) - numerous qtz. stringers - no visible mineralization (252 - 252.8) - Phyll. shale - qtz. stringers with chalcopyrite. (252 - 268) - Phyll. shale sch 60° str. and schistose and some mud seams close to the F.W.	11677	1.1							
					11678	1.2						
					11679	0.8						



DDH 22

SEE DDH 15

DDH 19

N24°E

Elevation 2766'

Overburden

77'

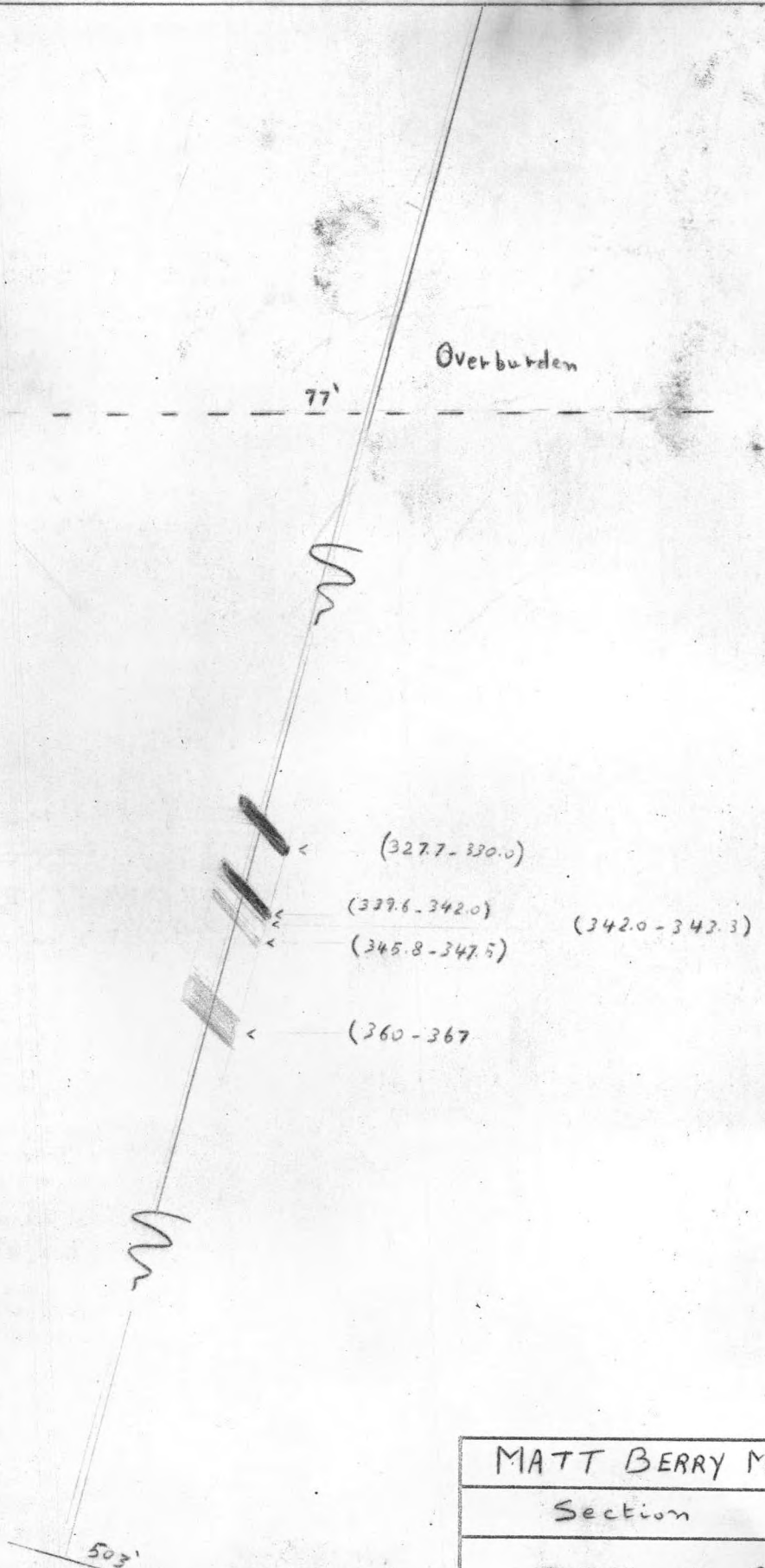

↑  
MATT  
BERRY  
ZONE  
↓

MATT BERRY MINES LTD.	
Section	
DDH No. 22	
Scale 1" = 30'	April 2, 1961
Adel Tanwan	

MATT BERRY MINES LIMITED

DRILL HOLE RECORD

Hole No. 22 at -75 degrees

Depth: 503 Feet Casing 77 feet

Proposed 500 feet End of month 843 feet

Started March 17, 1969 Completed March 31, 1969

Location: 16+00 on the Baseline  
2+00 N24°E

Objective: Intersect Matt Berry Zone and obtain information as to the dip.

Results: The Zone dip is 47° to NE and consists in sections as follow:

- 1) From 327.7 to 330.0 - In the H.W. about one foot of white qtz. with scattered mineralization. In the F.W. about one foot of brecciated carbonate abundantly sulphidic: PbS 20% - ZnS 20% - CuFeS<sub>2</sub> 10% - FeS<sub>2</sub> 5%
- 2) From 339.6 to 342.0 - Core loss 6 inches - Carbonat with quartz as gangue mineral - about 1.4' massive sulphide: 20% pyrite - 10% chalcopyrite - 5% galena - 5% sphalerite.
- 3) From 342.0 to 343.3 - Core loss 6 inches - phyllitic shale with numerous selective replacement along the schistosity - mineralization mainly pyrite and chalcopyrite - minor sphalerite - quartz and minor carbonate as gangue minerals.
- 4) From 345.8 to 347.5 - only 6 inches core - numerous fragments of massive sulphide: mainly galena, minor ZnS and CuFeS<sub>2</sub>.
- 5) From 360 to 367 - phyllitic shale with numerous selective sulphide replacement in bands from 1 inches to 3 inches.

The Zone is sampled as follow: Sample no. 11683 (327.7-330.0), Sample no. 11684 (339.6-342.0), Sample no. 11685 (342.0-343.3), Sample no. 11686 (360.0-362.8), Sample no. 11687 (362.8-364.5), Sample no. 11688 (364.5-367.0). All the samples shipped to Crest laboratories for analyses.

Ade Cannon  
April 2, 1969



# DIAMOND DRILL RECORD

PROPERTY \_\_\_\_\_  
 LOCATION: LAT. \_\_\_\_\_  
 DEP. \_\_\_\_\_  
 ELEVATION OF COLLAR \_\_\_\_\_  
 DATUM \_\_\_\_\_  
 DIRECTION AT START: BEARING \_\_\_\_\_  
 DIP \_\_\_\_\_  
 LOGGED BY \_\_\_\_\_ HOR. COMP. \_\_\_\_\_  
 PURPOSE OF HOLE \_\_\_\_\_ VER. COMP. \_\_\_\_\_

## TESTS

Ft.	Dip.	Ast. Bearing	Ft.	Dip.	Ast. Bearing	Core	
						Ft. Received	p.c. Recovery

HOLE NUMBER \_\_\_\_\_  
 SHEET NUMBER \_\_\_\_\_  
 SECTION FROM \_\_\_\_\_ TO \_\_\_\_\_  
 STARTED \_\_\_\_\_  
 COMPLETED \_\_\_\_\_  
 ULTIMATE DEPTH \_\_\_\_\_  
 PROPOSED DEPTH \_\_\_\_\_

DRILLED BY \_\_\_\_\_

Distance		ROCK	DESCRIPTION	Sample No.	Length Ft.	ANALYSIS													
from	to					Au.	Ag.	Pb.	Zn.	Cu.		Ave.							

22  
 1  
 March 17, 1969  
 March 31, 1969  
 503  
 500

Arctic Diamond Drilling

Matt Betty Mines Ltd  
 16+00 on the Base Line  
 / 2+00 N240E  
 2766  
 Francis Lake (8540')  
 2750  
 A. Tammann  
 Extension dip  
 MAH Betty Zone

# DIAMOND DRILL RECORD



PROPERTY Matl Betty Mines Ltd  
 LOCATION: 16+00 BL  
 DEP. 2+00 N24°E  
 ELEVATION OF COLLAR 27.66  
 DATUM Francis Lake (2540')  
 BEARING  
 DIRECTION AT START: DIP - 75°  
 LOGGED BY A. Tammam HOR. COMP. \_\_\_\_\_  
 PURPOSE OF HOLE Extension dip VER. COMP. \_\_\_\_\_  
Matl Betty Zone

### TESTS

Ft.	Dip.	Ast. Bearing	Ft.	Dip.	Ast. Bearing	Core	
						Ft. Received	p.c. Recovery

HOLE NUMBER 22  
 SHEET NUMBER 1  
 SECTION FROM 0 TO 347.5  
 STARTED March 17, 1969  
 COMPLETED March 31, 1969  
 ULTIMATE DEPTH 503'  
 PROPOSED DEPTH 500'

DRILLED BY Arctic Diamond Drilling

Distance		ROCK	DESCRIPTION	Sample No.	Length Ft.	ANALYSIS							
from	to					Au.	Ag.	Pb.	Zn.	Cu.		Ave.	
0	77	Overburden											
77	327.7	Phyllitic shale	Dark grey, sch. 90°-50° to core axis, more sheat and gangy closer to the zone, mud seams (91.5-92.7) - mud seams (112.7-122.0) - numerous contorted bands and strings of qtz. - sch. 90° to core axis. (125.5-126.5) - on foot of white qtz. with brecciated carbonate - traces of pyrite. (162.0-168.8) - Milky qtz. with carbonate - chloritic in parts. (170.0-174.3) - 3 feet of white brecc. qtz. with carbonate - chloritic in part - traces of pyrite. (182.0-208.0) - schistosity from 50° to contorted. (208.0-298.0) - Less sch. - from 80° to 90°. (298.0-327.7) - strongly foliated - chlorite along the schistosity - sheat and gangy closer to the zone.										
327.7	367.0	Matl Betty Zone	(327.7-330.0) - Core loss 4 inches - in the H.W. about, one foot of white qtz. with scattered mineralization, in the F.W. about, one foot of brecciated carbonate with massive sulphides: 20% PbS, 20% ZnS, 10% CuFeS <sub>2</sub> , 5% FeS <sub>2</sub> (330.0-339.6) - strongly foliated phyll. shale with mud seams (337.6-342.0) - Core loss 6 inches - about 1/4' massive sulphides - carbonate and qtz. as gangue minerals 20% FeS <sub>2</sub> - 10% CuFeS <sub>2</sub> - 5% PbS - 5% ZnS (342.0-343.8) - Core loss 6 inches - phyll. shale with numerous selective replacements along the schistosity mineralization mainly FeS <sub>2</sub> and CuFeS <sub>2</sub> - minor sphalerite, (343.3-345.8) - as above - minor mineralization (345.8-347.6) - only 6 inches core - numerous fragments of massive sulphides - mainly PbS, minor ZnS and CuFeS <sub>2</sub>	11683	1.9								
				11684	1.8								
				11685	1.2								
				11690	1.4								
				11691	only 4" core								

11694 (330-332)  
 11695 (332-334)  
 11696 (334-336)  
 11697 (336-339.6)

# DIAMOND DRILL RECORD

PROPERTY Mad Betty Mines Ltd.  
 LOCATION: LAT. \_\_\_\_\_  
 DEP. \_\_\_\_\_  
 ELEVATION OF COLLAR \_\_\_\_\_  
 DATUM \_\_\_\_\_  
 DIRECTION AT START: BEARING \_\_\_\_\_  
 DIP \_\_\_\_\_  
 LOGGED BY \_\_\_\_\_ HOR. COMP. \_\_\_\_\_  
 PURPOSE OF HOLE \_\_\_\_\_ VER. COMP. \_\_\_\_\_

TESTS

Ft.	Dip.	Ast. Bearing	Ft.	Dip.	Ast. Bearing	Core	
						Ft. Received	p.c. Recovery

HOLE NUMBER 22  
 SHEET NUMBER 2  
 SECTION FROM 347.5 TO 503  
 STARTED \_\_\_\_\_  
 COMPLETED \_\_\_\_\_  
 ULTIMATE DEPTH \_\_\_\_\_  
 PROPOSED DEPTH \_\_\_\_\_

DRILLED BY \_\_\_\_\_

Distance		ROCK	DESCRIPTION	Sample No.	Length Ft.	ANALYSIS								
from	to					Au.	Ag.	Pb.	Zn.	Cu.		Ave.		
367.0	503.2	phyllitic shale	(347.5 - 361.0) - Core lcs 8 feet - sheared phyll. shale (361.0 - 367.0) - Phyll. shale with numerous selective replacement in bands from 1 inch to 2 inches micaceous, limonite, calc. ls, some ZnS and PbS Samples: (364 - 362.8) - (362.8 - 364.5) - (364.5 - 367.0) (367.0 - 376.4) - strongly schistose with plz. stringers with FeS <sub>2</sub> (376.4 - 377.8) white quartzite veins with patches of calc. ls, FeS <sub>2</sub> (377.8 - 405.0) - phyllitic shale as above (405.0 - 405.6) - 8" quartzite vein as above (405.6 - 503.2) - phyllitic shale a.a. with plz. bands from 1" to 5" with pyrite, calc. ls, much ZnS, some mal seams (472.0 - 477.0) - white plz vein in part phyllitic (475.5 - 476.7) - 7" of white plz with numerous inclusions of chalcopyrite, pyrite  <i>Adel Tammas</i> April 2, 1969	11686	1.8							11692	(347.5 - 350.0)	
				11687	1.8								11693	(350.0 - 354.0)
				11688	2.0								11698	(354.0 - 359.0)
													11699	(359.0 - 361.0)



# DIAMOND DRILL RECORD

PROPERTY Math Betty Mines Ltd.  
 LOCATION: LAT. \_\_\_\_\_ DEP. \_\_\_\_\_  
 ELEVATION OF COLLAR \_\_\_\_\_  
 DATUM \_\_\_\_\_  
 DIRECTION AT START: BEARING \_\_\_\_\_ DIP \_\_\_\_\_  
 LOGGED BY \_\_\_\_\_ HOR. COMP. \_\_\_\_\_  
 PURPOSE OF HOLE \_\_\_\_\_ VER. COMP. \_\_\_\_\_

## TESTS

Ft.	Dip.	Ast. Bearing	Ft.	Dip.	Ast. Bearing	Core	
						Ft. Received	p.c. Recovery

HOLE NUMBER 22  
 SHEET NUMBER 2  
 SECTION FROM 347.5 TO 503  
 STARTED \_\_\_\_\_  
 COMPLETED \_\_\_\_\_  
 ULTIMATE DEPTH \_\_\_\_\_  
 PROPOSED DEPTH \_\_\_\_\_

DRILLED BY \_\_\_\_\_

Distance		ROCK	DESCRIPTION	Sample No.	Length Ft.	ANALYSIS								
from	to					Au.	Ag.	Pb.	Zn.	Cu.		Ave.		
367.0	503.2	Phyllitic shale	(347.5 - 361.0) - Core has 8 feet - sheared phyll. shale (361.0 - 367.0) - Phyll. shale with numerous selective replacement in bands from 1 inch to 3 inches mineralization: FeS <sub>2</sub> - CuFeS <sub>2</sub> - minor ZnS and PbS Samples: (361 - 362.8) - (362.8 - 364.5) - (364.5 - 367.0) (367.0 - 376.4) - strongly schistose with glz. stringers with FeS <sub>2</sub> (376.4 - 377.8) white quartzite vein with patches of CuFeS <sub>2</sub> - FeS <sub>2</sub> (377.8 - 405.0) - Phyllitic shale as above (405.0 - 405.6) - 6" quartzite vein as above (405.6 - 503.2) - Phyllitic shale a.s. with glz. bands from 1" to 5" with pyrite, CuFeS <sub>2</sub> , minor ZnS, some mud seams (492.0 - 493.0) - white glz vein in part chertite (475.5 - 476.2) - 7" of white glz with numerous veinlets of chalcopyrite, pyrite  <i>Adel Tanouss</i> April 2, 1969	11686	1.8							11692	(347.5 - 350.0)	
				11687	1.8								11693	(350.0 - 354.0)
				11688	2.0								11698	(354.0 - 359.0)
				11689	1.2								11699	(359.0 - 361.0)

core lost 4.3' ←

DDH 23

SEE DDH 8

MA. BERRY MINES LIMITED

DRILL HOLE RECORD

Hole No. 23 at 75 degrees

Depth: 425 feet

Casing 47 feet

Proposed 450 feet

End of month 425 feet

Started April 3

Completed April 7

Location:

14+00 BL, 2+00 N24°E, (Bearing S39°W)  
Elevation 2745'

Objective:

Extention dip of Matt Berry Zone

Results:

The hole intersected Matt Berry Zone from 272' to 289.8' with mineralization occurring in two sections: from 274' to 275' and from 285' to 289.8'; in between phyllitic shale with selective replacement along the schistosity

The two sections consist of quartz and carbonate with predominant massive galena and minor sphalerite in the F.W, in the H.W predominates pyrite, chalcopyrite occurs in lesser amount.

The core will be sampled and sent the samples to Crest Laboratories for assay.

W. L. Lamm  
April 8, 1969

Elevation 2718'

N39°E →

Bedrock 47'

Bedrock 32'

Elevation 2505'

(272'-273')

(285'-289.8')

(286'-289')

(303'-308')

April 7, 1969

425'

April 11, 1969

409'

MATT BERRY MINES LTD.	
Section N39°E	
DDHs No. 23, 24	
Scale 1"=30'	April 11, 1969
Adel Tamman	





# DIAMOND DRILL RECORD

PROPERTY \_\_\_\_\_  
 LOCATION: LAT. \_\_\_\_\_  
 DEP. \_\_\_\_\_  
 ELEVATION OF COLLAR \_\_\_\_\_  
 DATUM \_\_\_\_\_  
 DIRECTION AT START: BEARING \_\_\_\_\_  
 DIP \_\_\_\_\_  
 LOGGED BY \_\_\_\_\_ HOR. COMP. \_\_\_\_\_  
 PURPOSE OF HOLE \_\_\_\_\_ VER. COMP. \_\_\_\_\_

## TESTS

Ft.	Dip.	Ast. Bearing	Ft.	Dip.	Ast. Bearing	Core	
						Ft. Received	p.c. Recovery

HOLE NUMBER 23  
 SHEET NUMBER 2  
 SECTION FROM 285.0 TO 289.8  
 STARTED \_\_\_\_\_  
 COMPLETED \_\_\_\_\_  
 ULTIMATE DEPTH \_\_\_\_\_  
 PROPOSED DEPTH \_\_\_\_\_

DRILLED BY \_\_\_\_\_

Distance		ROCK	DESCRIPTION	Sample No.	Length Ft.	ANALYSIS								
from	to					Au.	Ag.	Pb.	Zn.	Cu.		Ave.		
285.0	289.8	<u>Vein Zone</u>	Core recovered: 4.3' - gtz. with buff carbonate - veinlets and patches of fine grained pyrite, chalc. pyrite - in the FW massive galena and phalente.	11703	1.0	(285-286)								
			phyllitic shale strongly schistose - only one foot core.	11704	2.0	(286-288)								
287.8	293.0		Strongly schistose phyllitic shale, in parts with mud seams:	11705	1.8	(288-289.8)								
293.0	412.5		(338.7 - 348.0) 4" of mud seams (348.0 - 351.0) 1.9 foot / mud seams (378.3 - 380.0) 1.8 foot " " (386.5 - 387.0) about 1/2 foot of gtz. and carbonate with pyrite and speckles of chalc. pyrite.	11706	1.6	(289.8-293)								
412.5	419.5		Clastic quartz schist, grayish with talc and muscovite.											
419.5	475.0		Phyllitic shale as above.											

*Adelmann*  
April 9, 1969

DDH 24

SEE DDH 8

DDH 21

DDH 23

MATT BERRY MINES LIMITED

DRILL HOLE RECORD

Hole No. 24 at -90 degrees

Depth: 409 feet

Casing 32 feet

Proposed 450 feet

End of month 834 feet

Started April 8, 1969

Completed April 11, 1969

Location:

14+00 BL, 2+00 N24°E  
Elevation 2718'

Objective:

Extention dip of Matt Berry Zone.

Results:

The hole intersected two mineralized sections:  
from 286' to 289' and from 303' to 308'.

Those two sections consist of quartz and carbonate  
with predominant massive galena and minor sphalerite  
in the F.W.; in the HW predominates pyrite; chalcopyrite  
occures in lesser amount.

The core will be sampled and sent samples  
to Crest Laboratories for assay.

Adel Cannon  
April 11, 1969









DDH 25

SEE DDH 15

DDH 20

N 24° E →  
Elevation 2743'

Collar DDH No. 25

Overburden 60'

Elevation 2403'

(398.0 - 404.0)

(458.0 - 474.5)

April 23, 1969

500'

Matt Berry Mines
Watson Lake Area Y.T.
Section Diamond Drill Hole No. 25
Scale 1" = 40' <i>Adelcamman</i>

MATT BERRY MINES LIMITED

DRILL HOLD RECORD

Hole No. 25

at -70 degrees

Casing 56 feet Bedrock 60 ft

Depth: 500 feet

Proposed 600 feet

End of Month 1334 feet

Started April 17, 1969

Completed April 23, 1969

Location:

15+60 on the BL  
3+50 N24°E, Elevation 2743'

Objective:

Extention dip Matt Berry Zone

Results:

Intersected two mineralized veins.

- 1) From 398.0 to 404.0' in which the mineralizations occur as follow:
  - a - (398.8 - 399.8') - mainly  $CuFeS_2$  - minor  $PbS$  &  $ZnS$ .
  - b - (399.8 - 401.0) - predominant massive  $PbS$ ,  $ZnS$ .
  - c - (401.0 - 402.5) - stringers of  $CuFeS_2$  in quartz gangue.
  - d - (402.5 - 404.0) - predominant  $PbS$  &  $ZnS$ , minor  $CuFeS_2$ .
- 2) From 458.0 to 474.5'
  - a - (458.0 - 464.5) - predominant massive  $ZnS$  &  $PbS$ , minor  $CuFeS_2$  in quartz-carbonate gangue
  - c - (464.5 - 472.0) - selective replacement along schistosity, mineral. as above.
  - d - (472.0 - 474.5) - predominant  $CuFeS_2$ , minor  $PbS$ ,  $ZnS$  in rusty quartz gangue.

The core is sampled and logged. Sampled has been sent to Crest Laboratories, Edmonton



# DIAMOND DRILL RECORD

PROPERTY Math Berry Mines

LOCATION: LAT. \_\_\_\_\_  
DEP. \_\_\_\_\_

ELEVATION OF COLLAR \_\_\_\_\_

DATUM \_\_\_\_\_

DIRECTION AT START: BEARING \_\_\_\_\_  
DIP \_\_\_\_\_

LOGGED BY \_\_\_\_\_ HOR. COMP. \_\_\_\_\_

PURPOSE OF HOLE \_\_\_\_\_ VER. COMP. \_\_\_\_\_

TESTS						Core	
Ft.	Dip.	Ast. Bearing	Ft.	Dip.	Ast. Bearing	Ft. Received	p.c. Recovery

HOLE NUMBER 25

SHEET NUMBER 2

SECTION FROM 399.8 TO 472.0

STARTED \_\_\_\_\_

COMPLETED \_\_\_\_\_

ULTIMATE DEPTH \_\_\_\_\_

PROPOSED DEPTH \_\_\_\_\_

DRILLED BY \_\_\_\_\_

Distance		ROCK	DESCRIPTION	Sample No.	Length Ft.	ANALYSIS					
from	to					Au.	Ag.	Pb.	Zn.	Cu.	Ave.
			(399.8 - 401.0) - predominant massive PbS and ZnS.	11718	1.0						(399.8 - 401.0)
			(401.0 - 402.5) - 1.5 core - mainly gtz. gangue - patches and stringers of CuFeS <sub>2</sub> & FeS <sub>2</sub> pyrrhotite	11719	1.5						(401.0 - 402.5)
			(402.5 - 404.0) - 1.5 core - predominant PbS & ZnS, minor FeS <sub>2</sub> & CuFeS <sub>2</sub> .	11720	1.5						(402.5 - 404.0)
			(404.0 - 407.5) - 1.5 core - predominant PbS & ZnS, minor FeS <sub>2</sub> & CuFeS <sub>2</sub> . Strongly foliated to very contorted - gtz. bands from 1" to 6".	11721	1.0						(404.0 - 407.5)
404.0	450.8	Phyllitic shale	(407.5 - 410.0) - only 4" core - phyll. shale with gtz. fragments with traces of CuFeS <sub>2</sub> .	11722							(407.5 - 410.0)
			(410.0 - 413.0) - core lost one foot - 5" of massive PbS, minor ZnS, CuFeS <sub>2</sub> , FeS <sub>2</sub> .	11723	0.5 sample 1						(410.0 - 413.0)
			(413.0 - 431.5) - core lost one foot - one foot of white gtz. with patches of CuFeS <sub>2</sub> .								
			(431.5 - 435.0) - core lost one foot - one foot of white gtz. with patches of CuFeS <sub>2</sub> .								
			(435.0 - 447.5) - core lost 2.5" white gtz. with nodules of CuFeS <sub>2</sub> .								
			(447.5 - 452.0) - strongly contorted with gtz. outcarb. crenulation - 5" of gtz. outcarb. with predominant ZnS.	11724	1.2						(450.8 - 452.0)
			(452.0 - 453.0) - one foot of streaked gtz. with speckles of PbS-ZnS, CuFeS <sub>2</sub> .	11725	1.0						(452.0 - 453.0)
			(453.0 - 455.0) - strongly contorted with gtz. crenulation								
			(455.0 - 458.0) caving								
458.0	474.5	Vein Zone	(458.0 - 464.5) - gtz. and carbonated with PbS <sub>2</sub> predominant massive ZnS & PbS - minor CuFeS <sub>2</sub>	11726	2.0						(458.0 - 464.5)
			(464.5 - 472.0) - selective replacement with bands to 7" - mainly gtz. outcarb. gangue - mineralization as above.	11727	1.8						(464.5 - 472.0)
			(472.0 - 474.5) - selective replacement with bands to 7" - mainly gtz. outcarb. gangue - mineralization as above.	11728	only 8" sample - represent one foot						(472.0 - 474.5)
			(474.5 - 477.0) - selective replacement with bands to 7" - mainly gtz. outcarb. gangue - mineralization as above.	11729	1.5						(474.5 - 477.0)
			(477.0 - 479.5) - selective replacement with bands to 7" - mainly gtz. outcarb. gangue - mineralization as above.	11730	2.5						(477.0 - 479.5)
			(479.5 - 482.0) - selective replacement with bands to 7" - mainly gtz. outcarb. gangue - mineralization as above.	11731	2.0 sample - represent 1.5'						(479.5 - 482.0)

# DIAMOND DRILL RECORD

PROPERTY Matt Berry Mines

LOCATION: LAT. \_\_\_\_\_  
 DEP. \_\_\_\_\_

ELEVATION OF COLLAR \_\_\_\_\_

DATUM \_\_\_\_\_

DIRECTION AT START: BEARING \_\_\_\_\_  
 DIP \_\_\_\_\_

LOGGED BY \_\_\_\_\_ HOR. COMP. \_\_\_\_\_

PURPOSE OF HOLE \_\_\_\_\_ VER. COMP. \_\_\_\_\_

TESTS

Ft.	Dip.	Ast. Bearing	Ft.	Dip.	Ast. Bearing	Core	
						Ft. Received	p.c. Recovery

HOLE NUMBER 25

SHEET NUMBER 3

SECTION FROM 472.0 TO 500.0

STARTED \_\_\_\_\_

COMPLETED \_\_\_\_\_

ULTIMATE DEPTH \_\_\_\_\_

PROPOSED DEPTH \_\_\_\_\_

DRILLED BY \_\_\_\_\_

Distance		ROCK	DESCRIPTION	Sample No.	Length Ft.	ANALYSIS					
from	to					Au.	Ag.	Pb.	Zn.	Cu.	Ave.
474.5	500.0	<u>phyllite slate</u>	(472.0 - 474.5) only 2 core - mostly g.l.c. with predominant FeS <sub>2</sub> , <del>minerals</del> - minor PbS & ZnS (474.5 - 477.0) - shaly and gangue (477.0 - 484.5) - core lost 6 feet - no above with in parts, mud casing. (484.5 - 500.0) - sch. 10° to core axis.  <div style="text-align: center; margin-top: 20px;"> <i>M. J. Lammiman</i>                          April 24, 1969                     </div>	11732	only 1.5' sampled, represents 3.5'						(488.5 - 472.0)
				11733	only 2.0' sampled, represents 4.0'						(479.0 - 474.5)



# DIAMOND DRILL RECORD

PROPERTY Matt Berry Mines

LOCATION: LAT. \_\_\_\_\_  
 DEP. \_\_\_\_\_

ELEVATION OF COLLAR \_\_\_\_\_

DATUM \_\_\_\_\_

DIRECTION AT START: BEARING \_\_\_\_\_  
 DIP \_\_\_\_\_

LOGGED BY \_\_\_\_\_ HOR. COMP. \_\_\_\_\_

PURPOSE OF HOLE \_\_\_\_\_ VER. COMP. \_\_\_\_\_

TESTS			TESTS			Core	
Ft.	Dip.	Ast. Bearing	Ft.	Dip.	Ast. Bearing	Ft. Received	p.c. Recovery

HOLE NUMBER 25

SHEET NUMBER 2

SECTION FROM 399.8 TO 472.0

STARTED \_\_\_\_\_

COMPLETED \_\_\_\_\_

ULTIMATE DEPTH \_\_\_\_\_

PROPOSED DEPTH \_\_\_\_\_

DRILLED BY \_\_\_\_\_

Distance		ROCK	DESCRIPTION	Sample No.	Length Ft.	ANALYSIS					
from	to					Au.	Ag.	Pb.	Zn.	Cu.	Ave.
404.0	450.8	Phyllitic shale	(399.8-401.0) - predominant massive PbS and ZnS.	11718	1.0						(399.8-401.0)
			(401.0-402.5) - 1.5 core - mainly gtz. gangue - patches and stringers of CuFeS <sub>2</sub> and FeS <sub>2</sub> - pyrrhotite	11719	1.5						(401.0-402.5)
			(402.5-404.0) - 1.5 core - predominant PbS & ZnS, minor FeS <sub>2</sub> & CuFeS <sub>2</sub> .	11720	1.5						(402.5-404.0)
			Strongly foliated to very contorted - gtz. bands from 1" to 8".	11721	1.0						(404.0-405.0)
			(407.5-410.0) - only 4" core - phyllitic shale with gtz. fragments with masses of CuFeS <sub>2</sub> .	11722							(407.5-410.0)
			(410.0-413.0) - core lost one foot - 5" of massive PbS, minor ZnS, CuFeS <sub>2</sub> , FeS <sub>2</sub> .	11723	0.5 sample						(410.0-)
			(431.5-435.0) - core lost one foot - one foot of white gtz. with patches of CuFeS <sub>2</sub> .								
			(438.0-439.5) - core lost 3.5" - white gtz. with veins of CuFeS <sub>2</sub> .								
			(449.5-452.0) - strongly contorted with gtz. and carb. crementation - 5" of gtz. and carb. with predominant ZnS.	11724	1.2						(450.8-452.0)
			(452.0-453.0) - one foot of streaked gtz. with speckles of PbS - ZnS - CuFeS <sub>2</sub> .	11725	1.0						(452.0-453.0)
458.0	474.5	Vein Zone	(453-458) - strongly contorted with gtz. crementation (455.0-458.0) caving.								
			(458.0-464.5) - gtz. and carbonated with pyrite predominant massive ZnS & PbS - minor CuFeS <sub>2</sub>	11726	2.0						(458.0-460.0)
			(464.5-472.0) - selective displacement with bands to 7" - mainly gtz. and carb. gangue - no mineralization as above.	11727	1.8						(460.0-462.0)
				11728	only 8" sample - represent one foot						(462.0-463.0)
				11729	1.5						(463.0-464.5)
			11730	2.5						(464.5-467.0)	
			11731	1.0 sample - represent 1.5'						(467.0-468.0)	

PROPERTY Matt Berry Mines

LOCATION: LAT. \_\_\_\_\_  
 DEP. \_\_\_\_\_

ELEVATION OF COLLAR \_\_\_\_\_

DATUM \_\_\_\_\_

DIRECTION AT START: BEARING \_\_\_\_\_  
 DIP \_\_\_\_\_

LOGGED BY \_\_\_\_\_ HOR. COMP. \_\_\_\_\_

PURPOSE OF HOLE \_\_\_\_\_ VER. COMP. \_\_\_\_\_

# DIAMOND DRILL RECORD

## TESTS

Ft.	Dip.	Ast. Bearing	Ft.	Dip.	Ast. Bearing	Core	
						Ft. Received	p.c. Recovery

HOLE NUMBER 25

SHEET NUMBER 3

SECTION FROM 472.0 TO 500.0

STARTED \_\_\_\_\_

COMPLETED \_\_\_\_\_

ULTIMATE DEPTH \_\_\_\_\_

PROPOSED DEPTH \_\_\_\_\_

DRILLED BY \_\_\_\_\_

Distance		ROCK	DESCRIPTION	Sample No.	Length Ft.	ANALYSIS					
from	to					Au.	Ag.	Pb.	Zn.	Cu.	Ave.
474.5	500.0	phyllitic shale	(472.0 - 474.5) only 2' core - rusty gtz. with predominant FeS <sub>2</sub> , <del>FeS</del> - minor PbS & ZnS. (474.5 - 477.0) - sheared and ganggy. (477.0 - 484.5) - core lost 6 feet - as above with, in parts, mud seams. (484.5 - 500.0) - sch. 10° to core axis.  <i>Adel Lammiman</i> <i>April 24, 1969</i>	11732	only 1.5' sampled, appears to be 3.5'						(468.5 - 472.0)
				11733	only 2' sampled, appears to be 4.0'						(477.0 - 479.5)