

NOTICE

THIS MAP IS ISSUED AS A PRELIMINARY GUIDE FOR WHICH THE DEPARTMENT OF NORTHERN AFFAIRS AND NATIONAL RESOURCES WILL ACCEPT NO RESPONSIBILITY FOR ANY ERRORS, INACCURACIES OR OMISSIONS WHATSOEVER ON THE SHEET BEFORE ADEQUATE SURVEYS HAVE BEEN MADE.

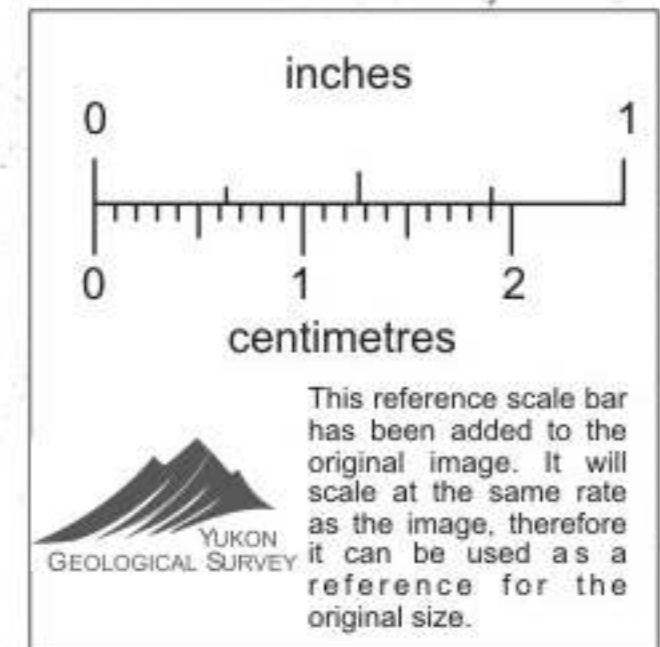

DEPART

FT. 1500

- 6 June 61
- 21 Apr. 61
- 22 Mar. 61
- 25 Jan. 61
- 5 Dec. 60
- 7 Apr. 59
- 17 Oct 65
- 7 Mar 66
- 27 OCT. 65.
- 17 Dec 62
- 18 June 62
- 13 Mar. 62

N 20° W

N 70° W

WHITEHORSE

TIM GROUP

SCALE: 1" = 1/2 MI.

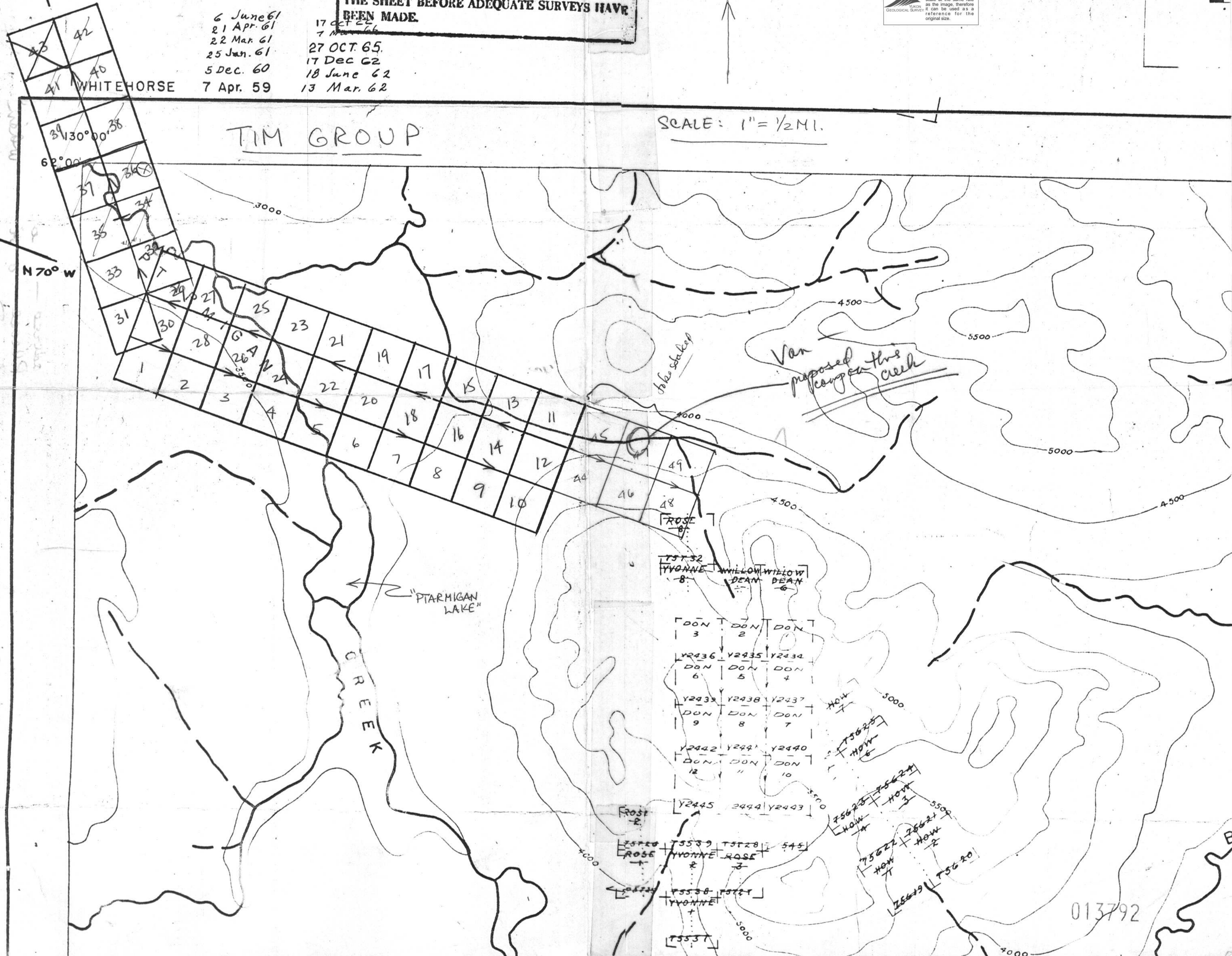

013792