

105 G 2



P. DEAN  
1 August 1969

All talus along slope  
is fine-grained unmineralized  
granite. occasional qtz veins,  
& occasional rusty zones  
produced by decomposition  
of mafic minerals in  
granite.

A12850-185

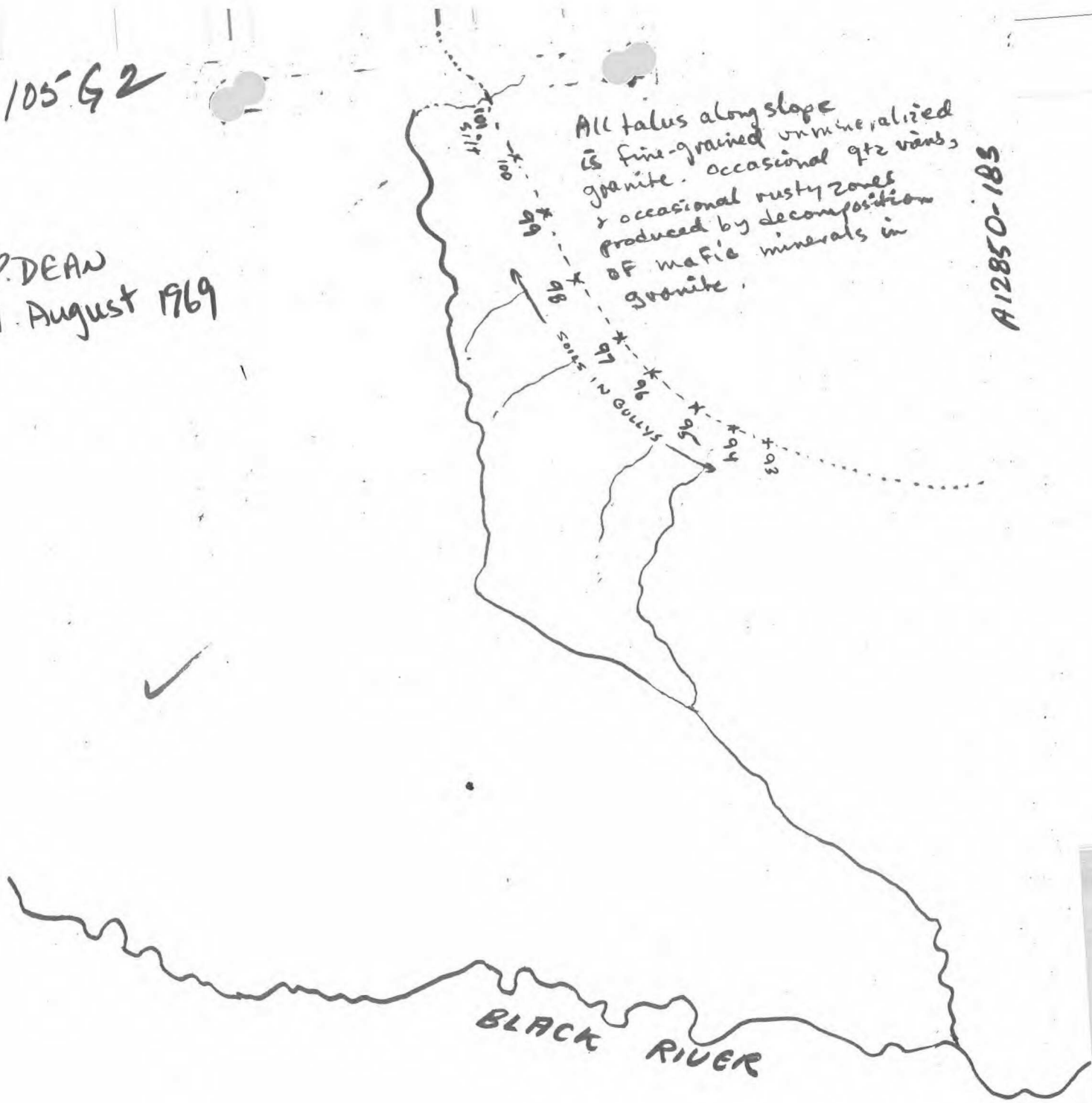

BLACK RIVER

013942

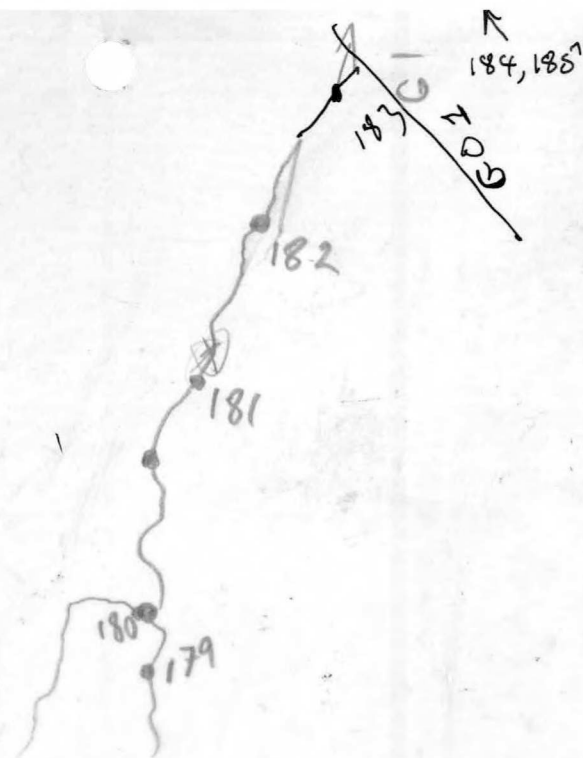

~~180~~  
~~179~~

Nils S. Claus

Aug 1

10S G/2

A12189-253

↑ Take Ave.

105Goz & 01

No 6.

Nail S. Glass

Diorite. Basic Dyke cutting  
Granite.

Granite

186

187

188

681

A12255-265

↑  
N  
Transect

105G02

No 4

FYRE LAKE REGION ✓

MAP 105G/2  
R. WELLS  
AUG 3, 1969  
SCALE: 1" = 1/2 MI

MINER. - CONFINED TO THE  
LMSN, SHELLE FORMATIONS  
WITH MINOR RUST (PYRR.)  
IN THE GNTE.

BIO. QTZ GNTE  
WITH ORTH. (PMUK)  
FELD.  
RK. SAMPLES TAKEN

Planted  
Chestnut

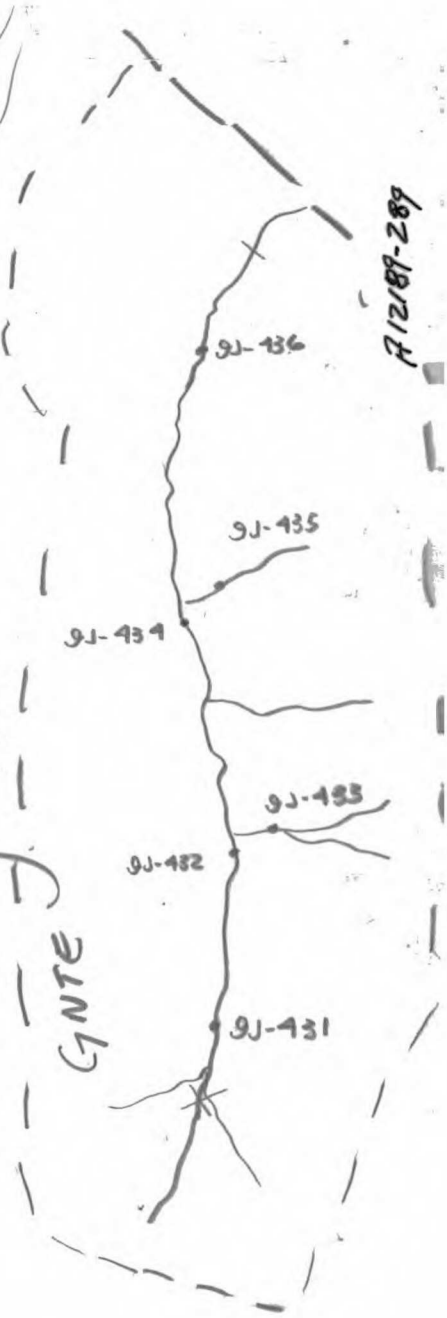

F12189-289



FYRE LAKE REGION ✓

cards ✓  
pi ✓

B

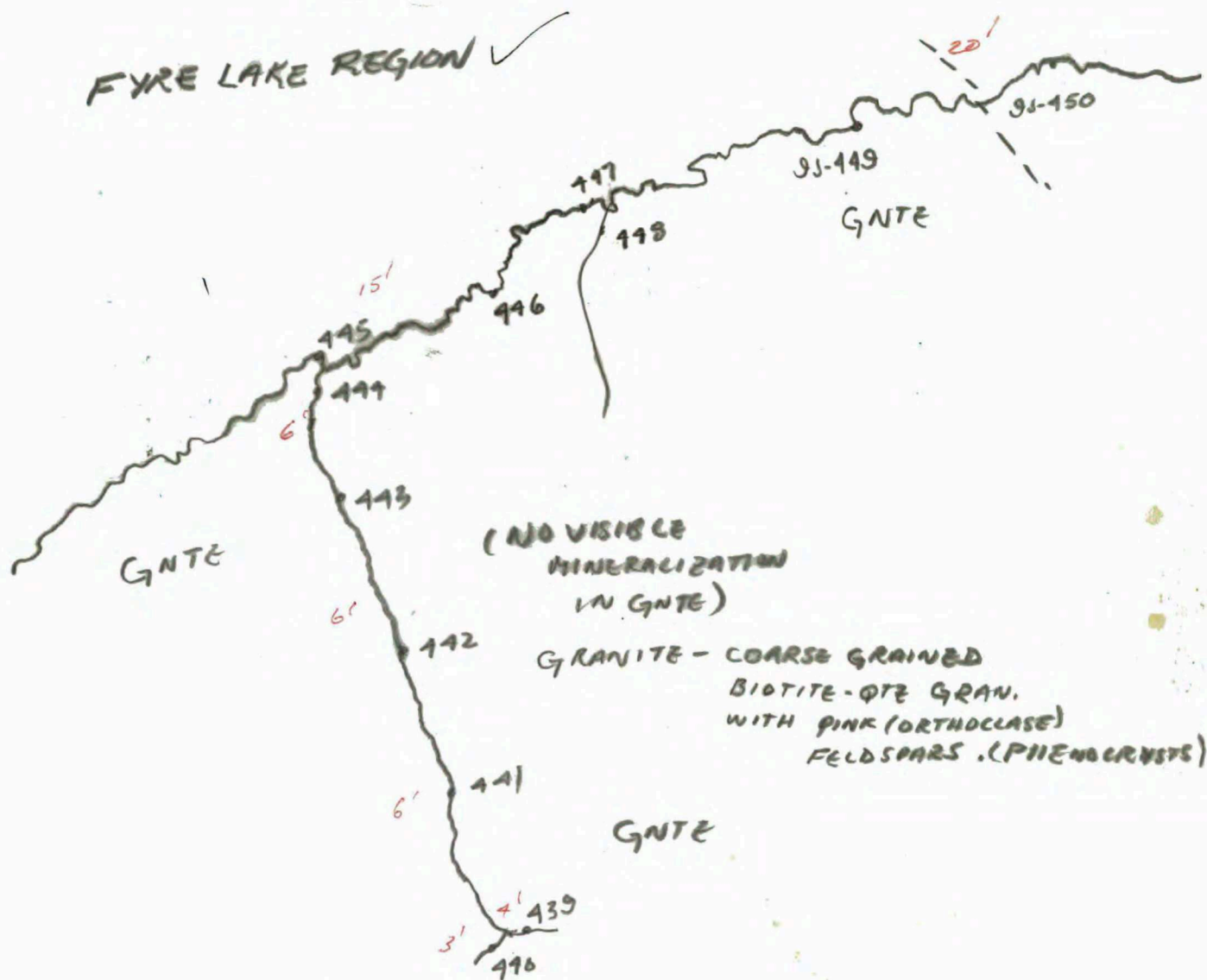

105 G/2

AUG 4, 1969

R. WELLS

1" = 1/2 MI

PAGE 1

A12228-239



Trawl 33  
105202

No 1

W  
W  
W  
A 12189-291

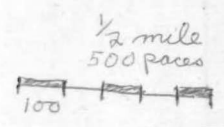
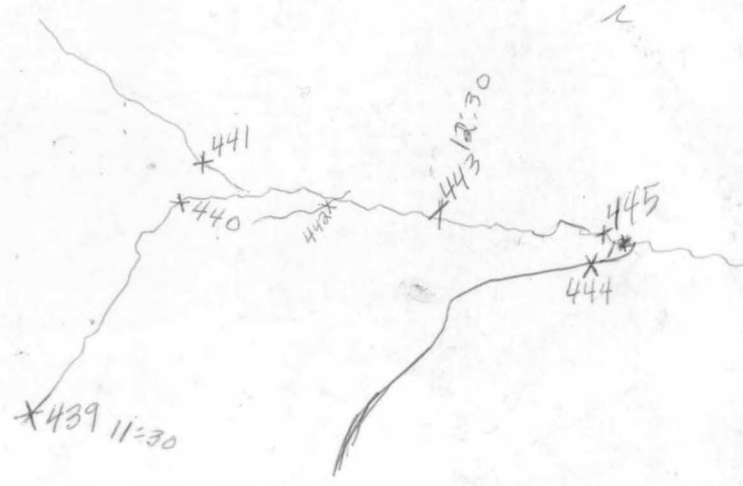

21A

# FYRE LAKE REGION

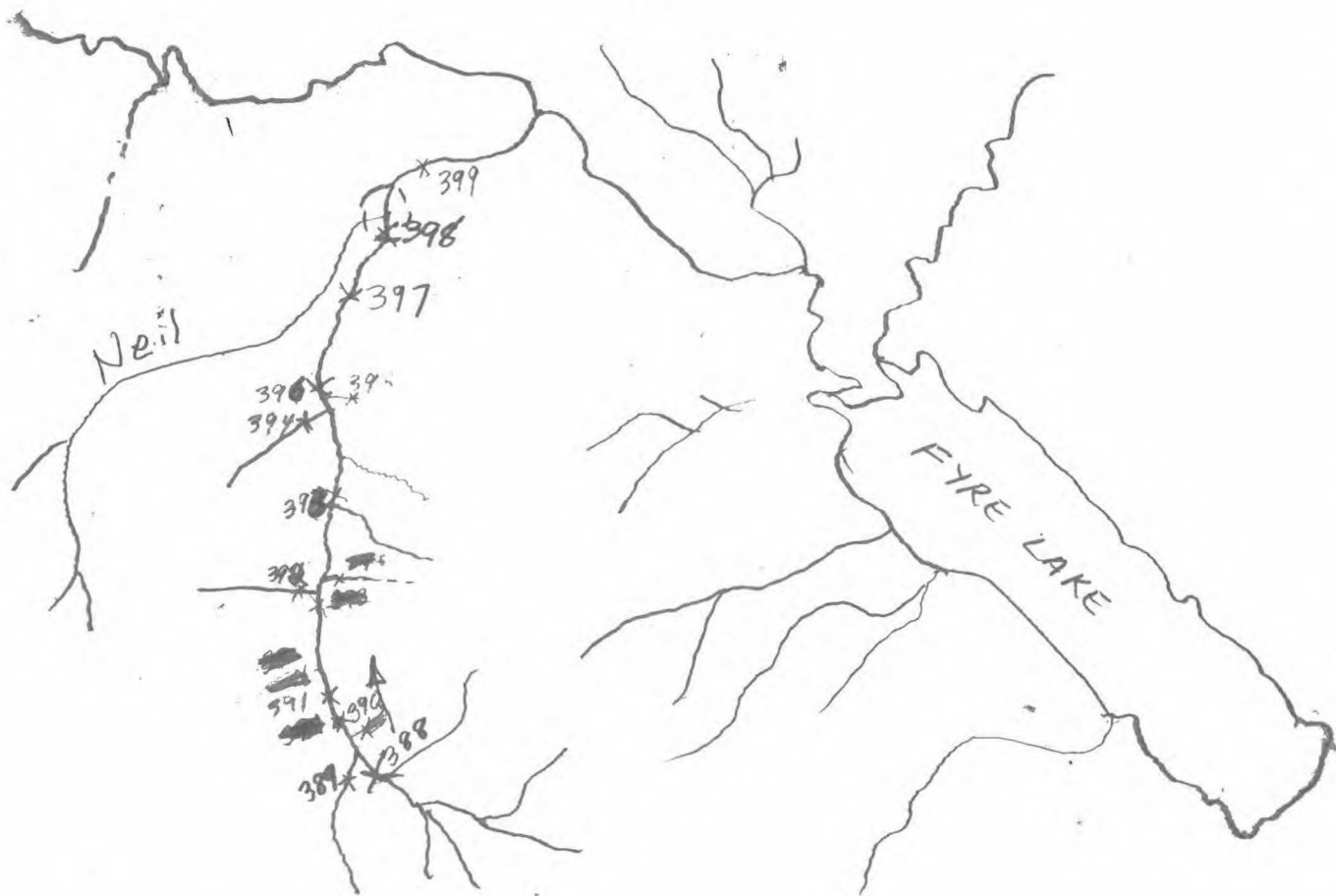

W. HAMILTON

1" = 1 MI  
30/7/69

MAP-105 G/2 (UPPER  
BLANK RIVER)

18

N  
Tran 33  
105G02

A 12850-186

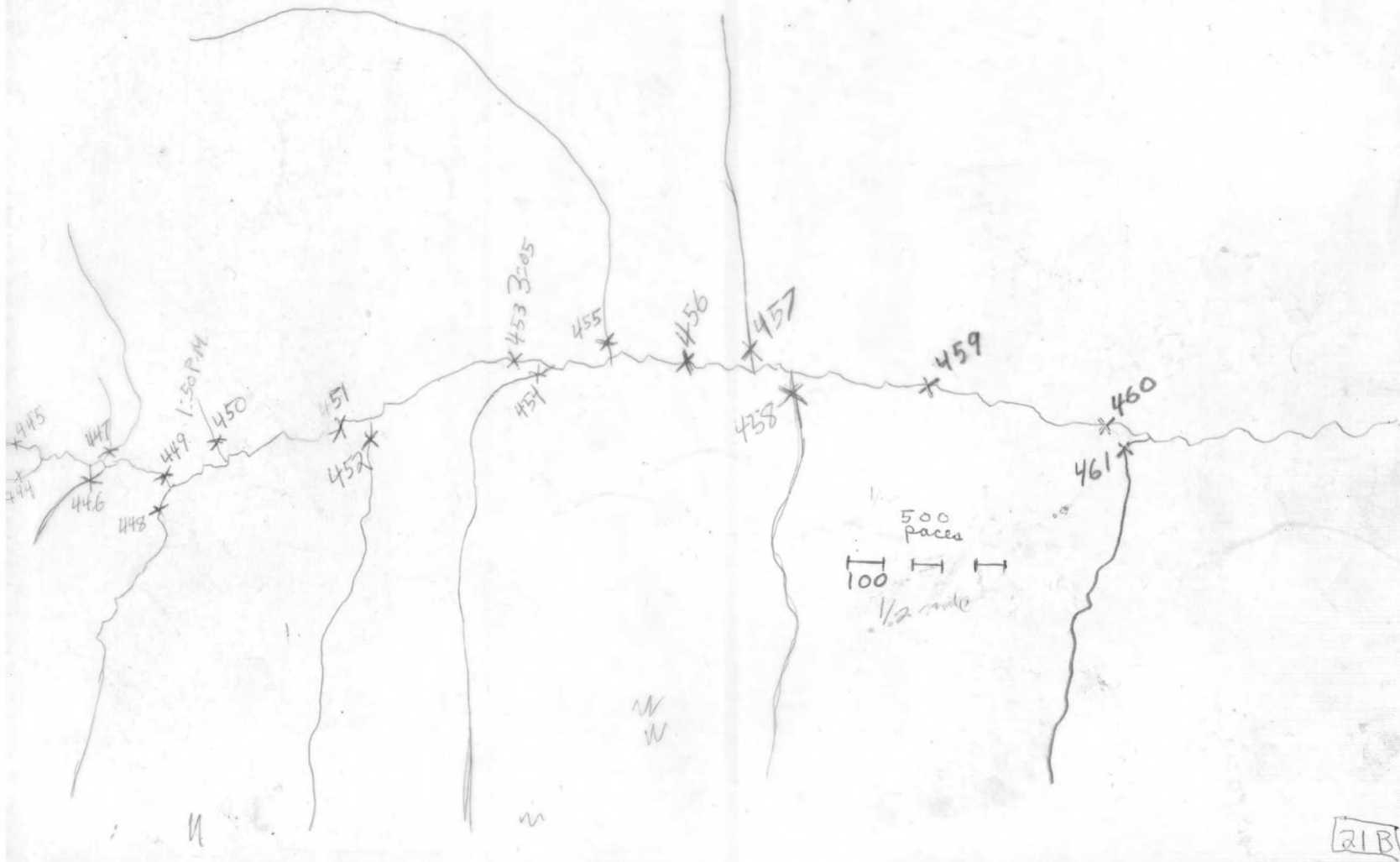

2

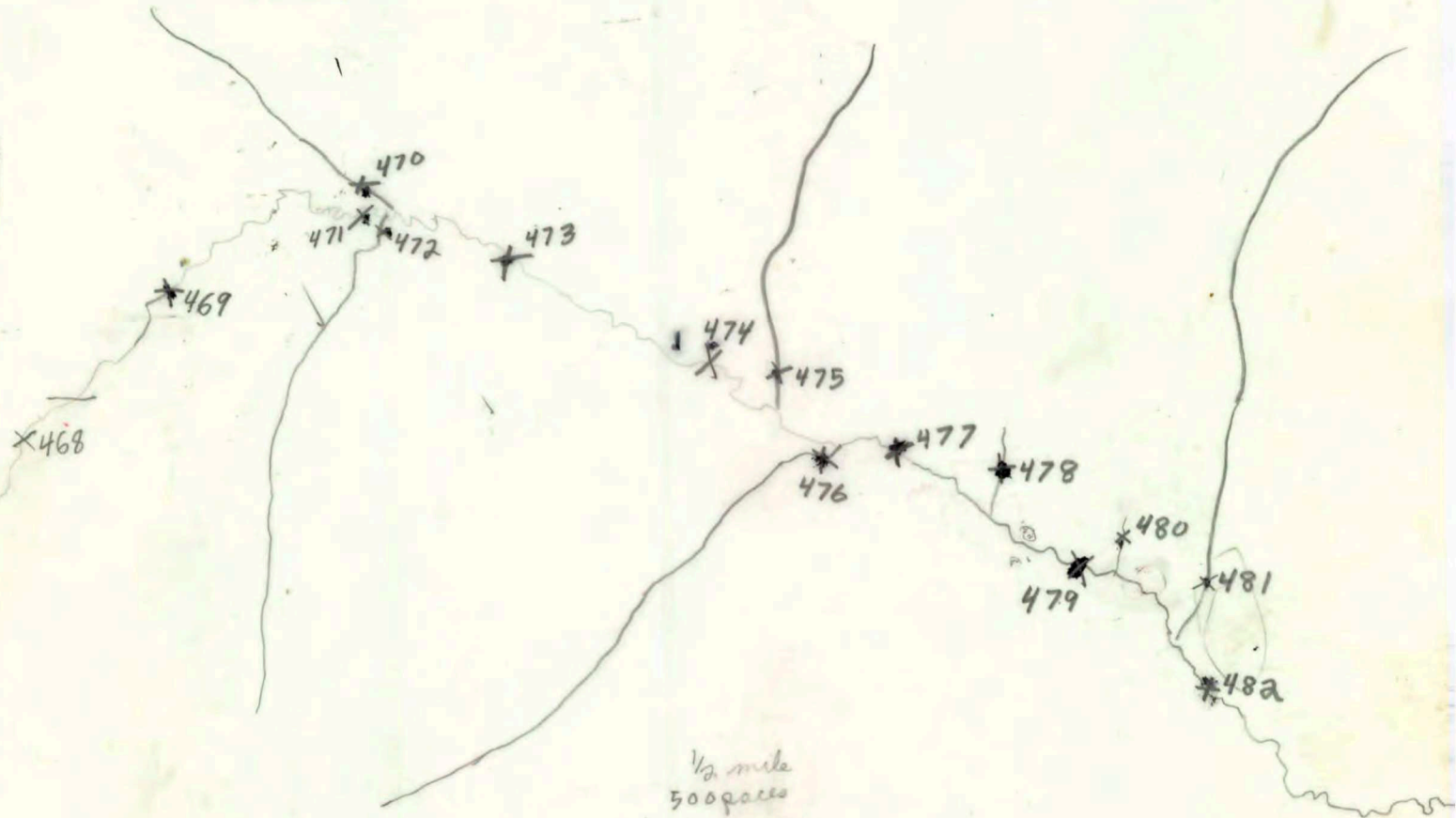

~~✗~~

↑  
distorted part of  
photo :: use  
other one

105G02

W.H.  
4/8/69  
A12228-237  
22B

FIRE LAKE - REGION



DONE  
30/7/69

DENTON

see rock sample for:  
# 9V454, 455, 456  
460, 461 (2)

G. DENTON  
JULY 30, 69

FYRE LAKE AREA

MAP 105 G/2  
SCALE 1" = 1 mile

G. DENTON  
SCALE 1" = 1 mi  
JULY 30, 1969

MAP 105 G/2 (UPPER BLACK RIVER)

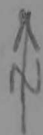
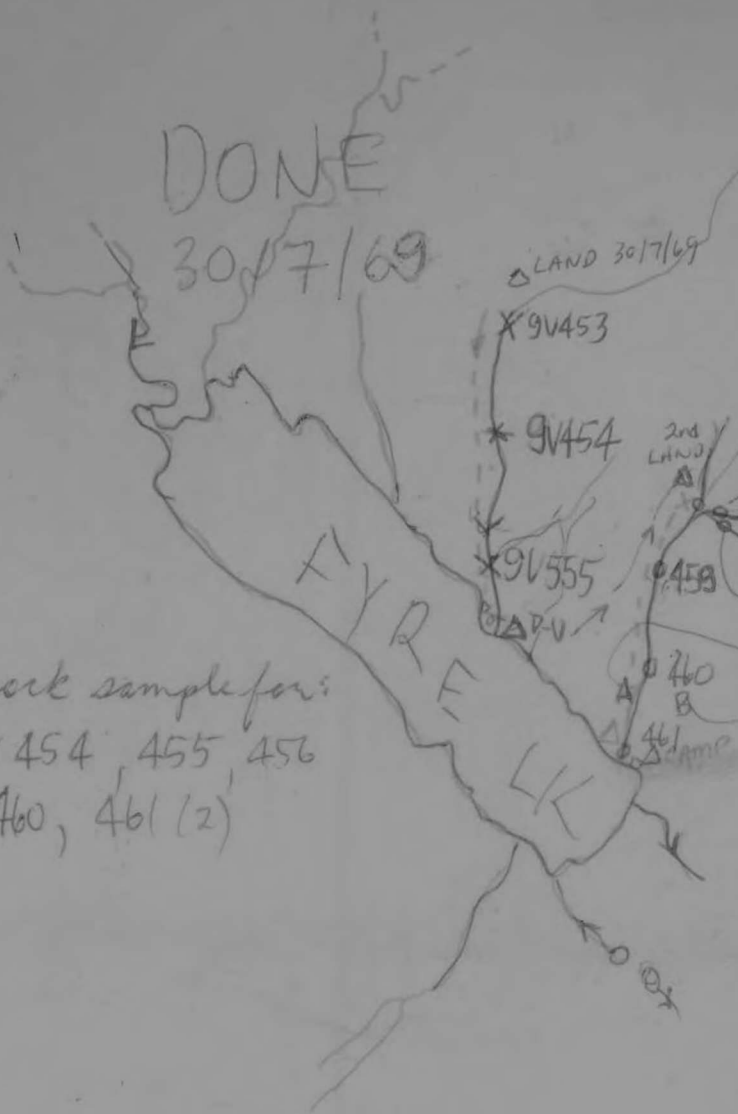

15  
A | 19

20  
B | 10

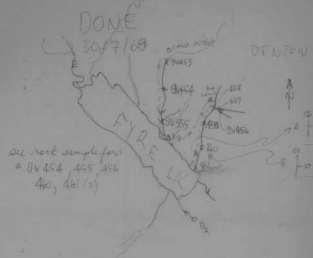

G. DENTON  
JULY 30, 69  
FYRE LAKE AREA

MAP 105 G/2

SCALE 1" = 1 mile

MAP 105 G/2 (UPPER BLACK RIVER)

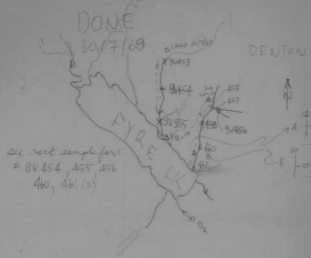

G. DENTON  
JULY 30, 69  
FYRE LAKE AREA

MAP 105 G/2

SCALE 1" = 1 mile

MAP 105 G/2 (UPPER BLACK RIVER)



G. DENTON  
JULY 30, 69  
FYRE LAKE AREA

MAP 105 G/2

SCALE 1" = 1 mile

MAP 105 G/2 (UPPER BLACK RIVER)



G. DENTON  
JULY 30, 69  
FYRE LAKE AREA

MAP 105 G/2

SCALE 1" = 1 mile

MAP 105 G/2 (UPPER BLACK RIVER)

see rock sample for:  
# 9V 454, 455, 456  
460, 461 (2)

G. DENTON  
JULY 30, 69

FYRE LAKE AREA

MAP 105 G/2  
SCALE 1" = 1 mile

G. DENTON  
SCALE 1" = 1 mi  
JULY 30, 1969

MAP 105 G/2 (UPPER BLACK RIVER)

AUGUST 1, 1969

G. DENTON

MAPS 10562-67

(FYRE LAKE  
CAMP)

SCALE: 1" = .55 miles

A.P.# 12228-256

-234

gv493 and 209

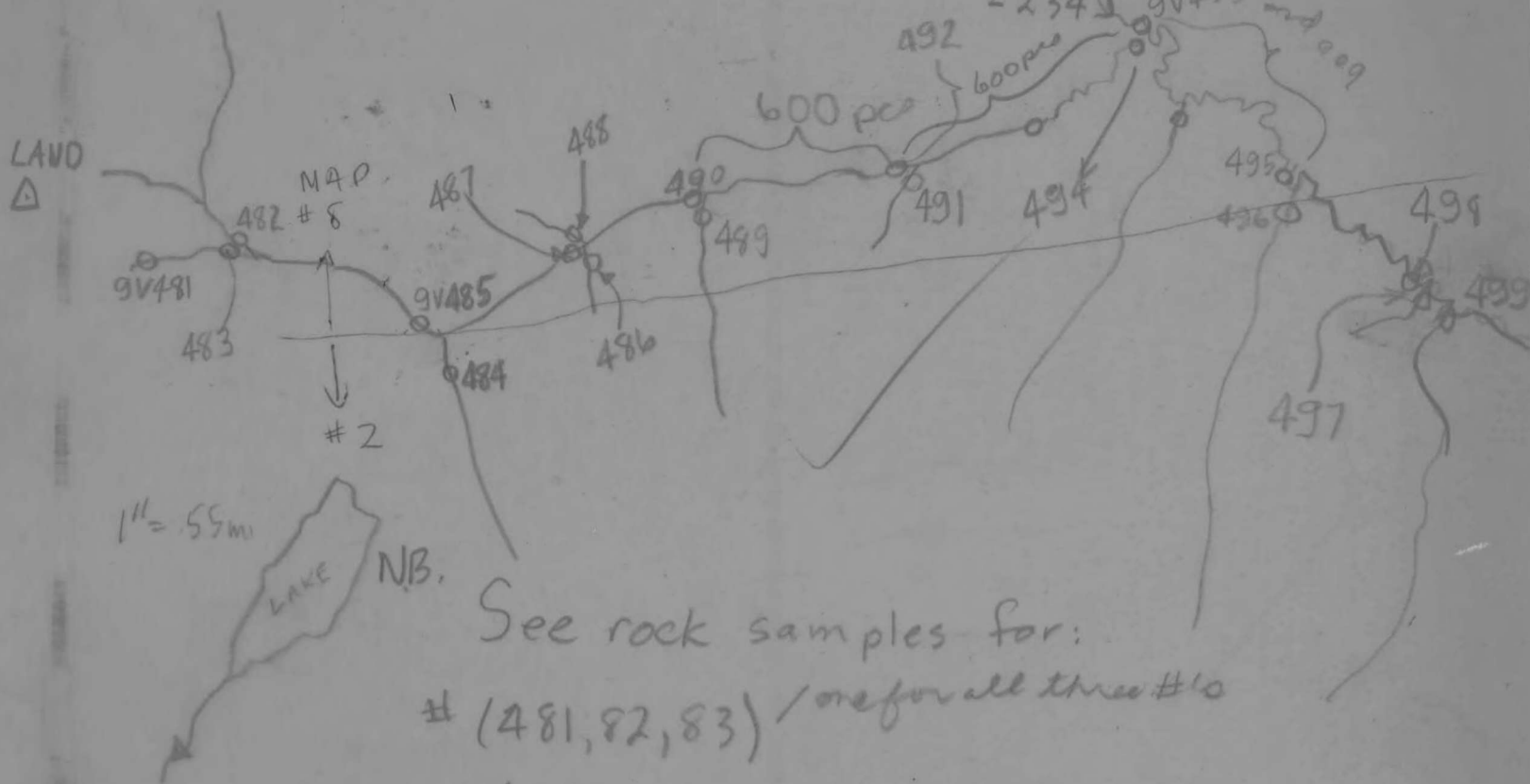

See rock samples for:  
# (481, 82, 83) / one for all three #'s  
and 499

1 of 2 overlays

452-8714

PICK-UP  
1/8/69

9V500

501

~~PICK-UP~~

N  
↑

1" = 4 miles

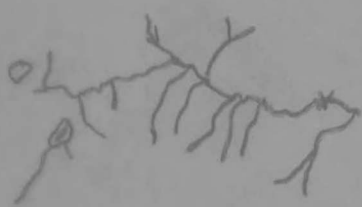

↑  
N

2 of 2 overlays

AUGUST 1, 1963

G. DENTON

MAPS 10562-67

(FIRE LAKE  
CAMP)

SCALE 1 1/2 / 55 miles  
9V504 9V505 12228-256  
501

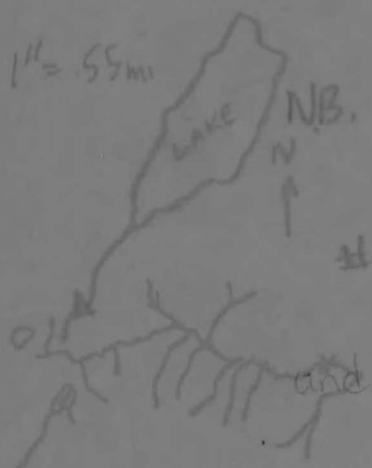
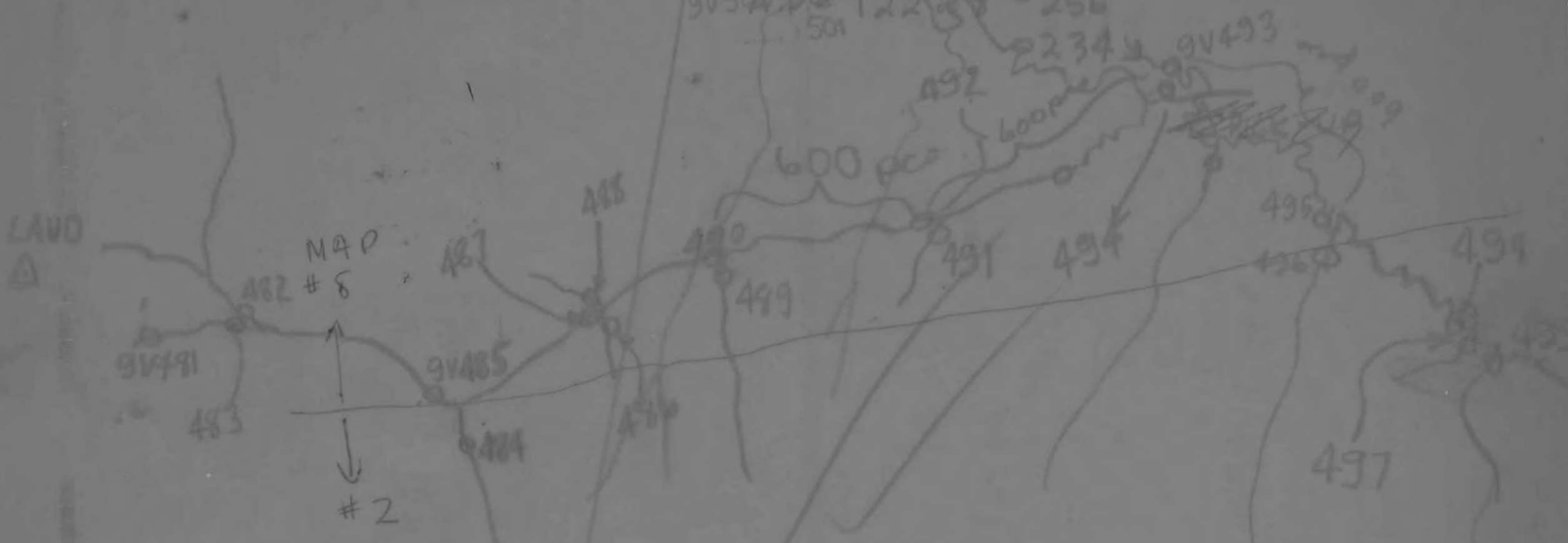

See rock samples for:  
# (481, 82, 83) / one for all three #'s



1 of 2 overlays  
2 of 2 overlays

105 6217

Pickup 5:60

Traverse 3

Aug 1/69

W. Greenwald

