

014876

NORDE. EXPLORATION LTD.

August 4th, 1966

HOMESTAKE SHOWING-SAMPLES

AUG 17 1966

<u>Number:</u>	<u>Width:</u>	<u>Oz. Ag./T</u>	<u>% Lead</u>	<u>Description:</u>
Van. 1	10.0'	23.6	1.7	From greenstone sericite schist hanging-wall 0 to 10' N. Location 160' N 70E of shaft. Few visible sulphides, some carbonates, siderite and oxidized gangue.
Van. 2	10.0'	6.72	Tr.	150' N 70E of shaft. From 10' to 24' N of hanging wall to quartzite foot-wall. True width 10.0'. No visible sulphides, some limonite and crushed greenstone & quartzite with clay gouge.
Van. 3	1.5'	419.1	19.4	162' N 70E of shaft. 8' north of hanging wall. Massive galena with some jamesonite.
Van 4	2.0'	103.7	12.6	166' N 70E of shaft. 5' south of foot wall. Galena and arsenopyrite in vein quartz.
Van 5	0.5'	1435.0	Tr.	190' N 70E of shaft. 9' North of hanging wall. Character of high grade ore in place. Galena, some tetrahedrite and cerussite visible.
Van 6	0.5'	811.1	43.0	169' N. 70E of shaft. 7' North of hanging-wall. Character of stringer of ore in place. Fine-grained laminated galena with some freibergite visible.

The above Shaft Vein was exposed by ripping and dozing over the strike of the vein with a Caterpillar D-8 Tractor. The frozen overburden was removed for a strike distance of 170 feet of which a 40 foot strike length was completely cleared of debris in a side hill cut about 25' deep.

The vein, over this 40' of strike length consists of a 20 foot width of sheared greenstone, quartzite, siderite, limonite and vein gouge. Within this matrix are short, apparently discontinuous lenses of massive galena ore with some secondary enrichment with associated silver minerals. It is thought that this showing may have good economic potential at depth and on strike possibly for several hundred feet east of the old shaft. Further cross trenching with a Ripper and a heavy front-end bucket loader for overburden removal is recommended.

HOMESTAKE No. 2
 OLD SHAFT HOMESTAKE No. 8

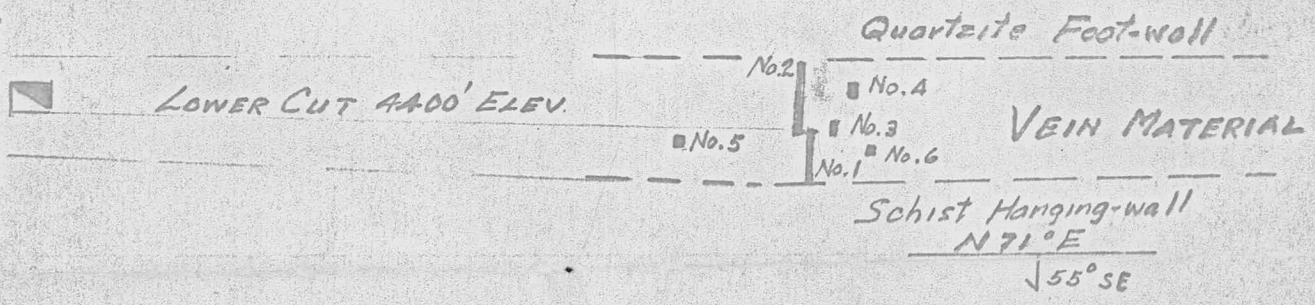

#1	5'	47.2	5.4	6'	13.8
#5	5'	143.5	4r	6'	120.0
#6	5'	81.1	21.5	6'	67.6
		271.8	26.9		201.4
<u>60'L</u>	<u>5'W</u>	<u>90.649</u>	<u>9.0P6</u>	6'	67.1 6.7

HOMESTAKE SHOWING
LOCATIONAL PLAN OF NEW TRENCH
SHOWING VAN SAMPLES 1 TO 6

SCALE: 40 FT TO 1 INCH Approximate Only

AUGUST 4th., 1966

ROBERT

HOMESTAKE No. 8 B.M.C.
 LEE FRACTION No. 1

CUT ON UPPER VEIN APPROX. 4485' ELEV.

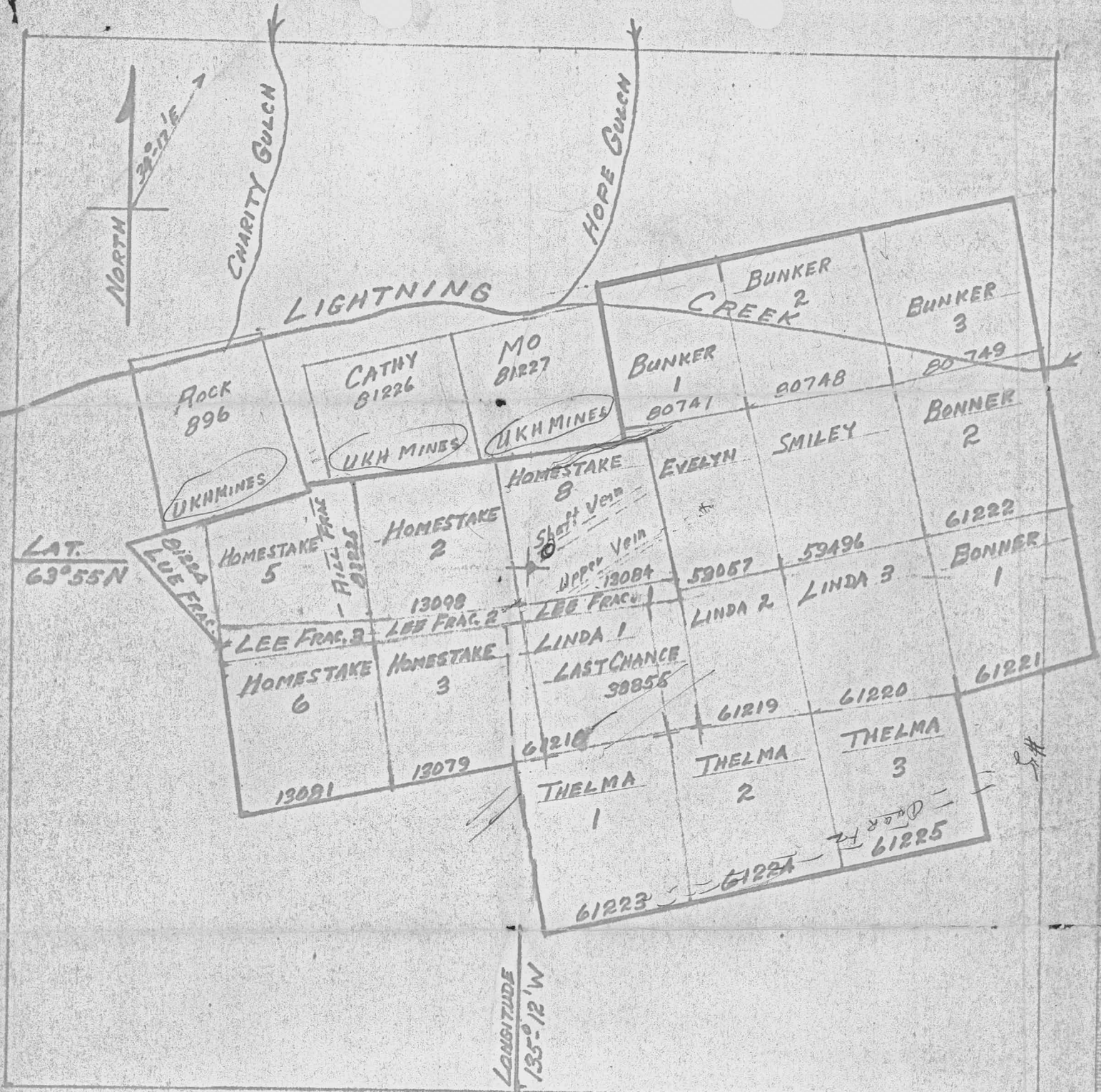

SHAFT LOCATION:
 4.4 Miles From Keno City, Y.T.
 ELEV. APPROX. 4400 FEET.
 Access 1.6 Miles steep tractor road
 1.5 Miles wagon road
 1.3 Miles good truck road
 4.4 Total Mileage shaft to Keno.

HOMESTAKE SHOWING
PROPERTY PLAN
 FROM CLAIM SHEET 105M-1A
 SCALE: 1320 FT. TO 1 INCH.

AUGUST, 1966

19 full
 5 fractions

CDMT.
 E.D.N. Taylor
 Casino Silver