

105K4

LIL Claims



MAP 105K4
PHOTO AIZ176-92

Claims plotted
Land 16/10/69

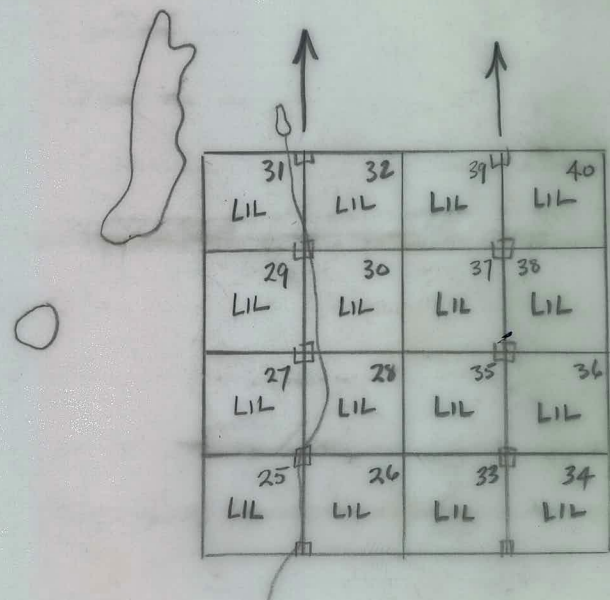

015111
Lishy claims

105K4

Sample ~~9X41~~ to ~~9X47~~

Traverse #53

Peter Fox

Sheet 1

A12182-121

Sept 3/69

105L4 sheet
105K8

105K4
105L8

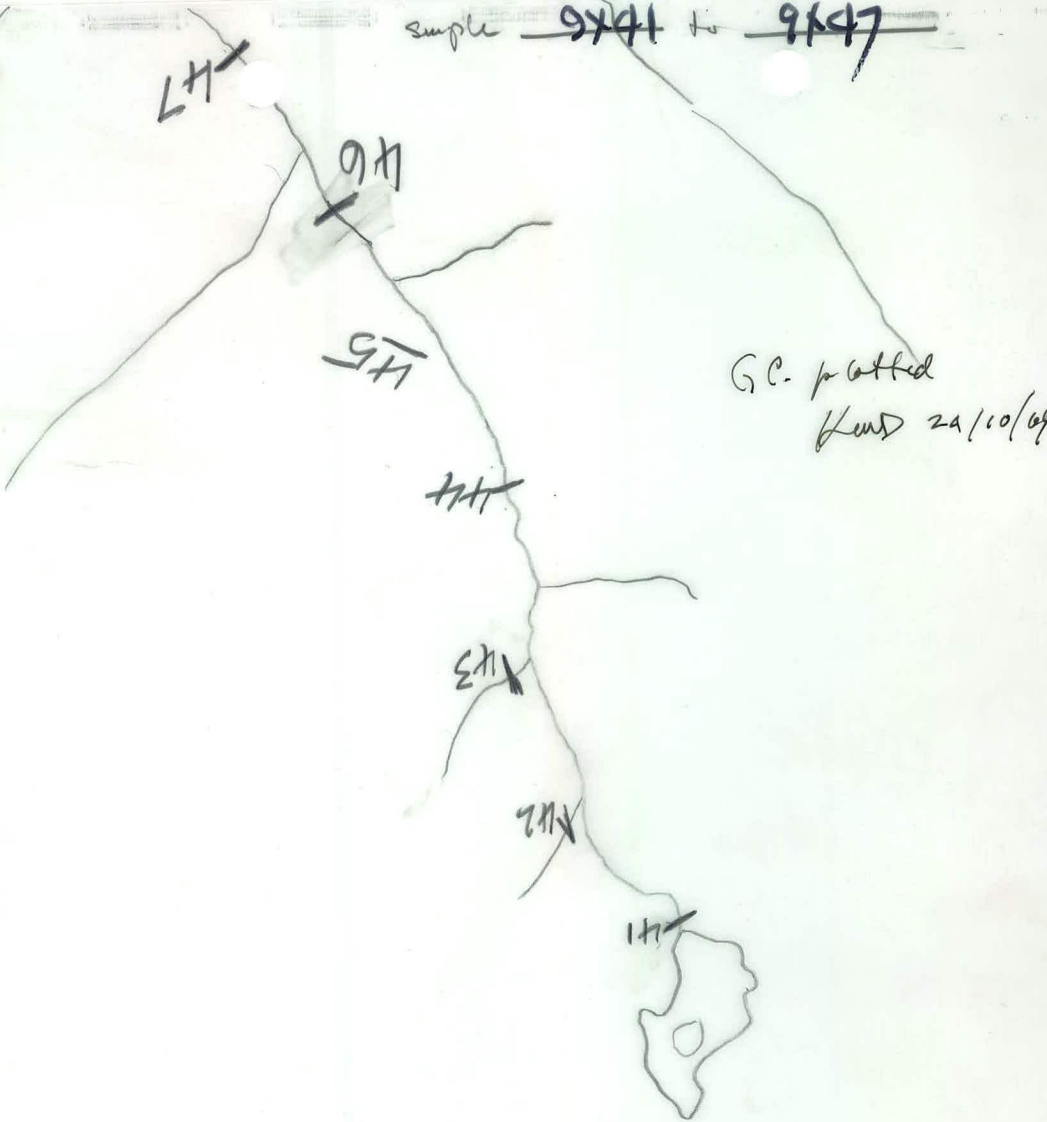

G.C. plotted

Hand 2A/10/69

105K/4

A
Aug 28th/69
G. Pearce
A12182-204

Geochron
Plotted.

Geol plotted
HMS. 29/10/69.

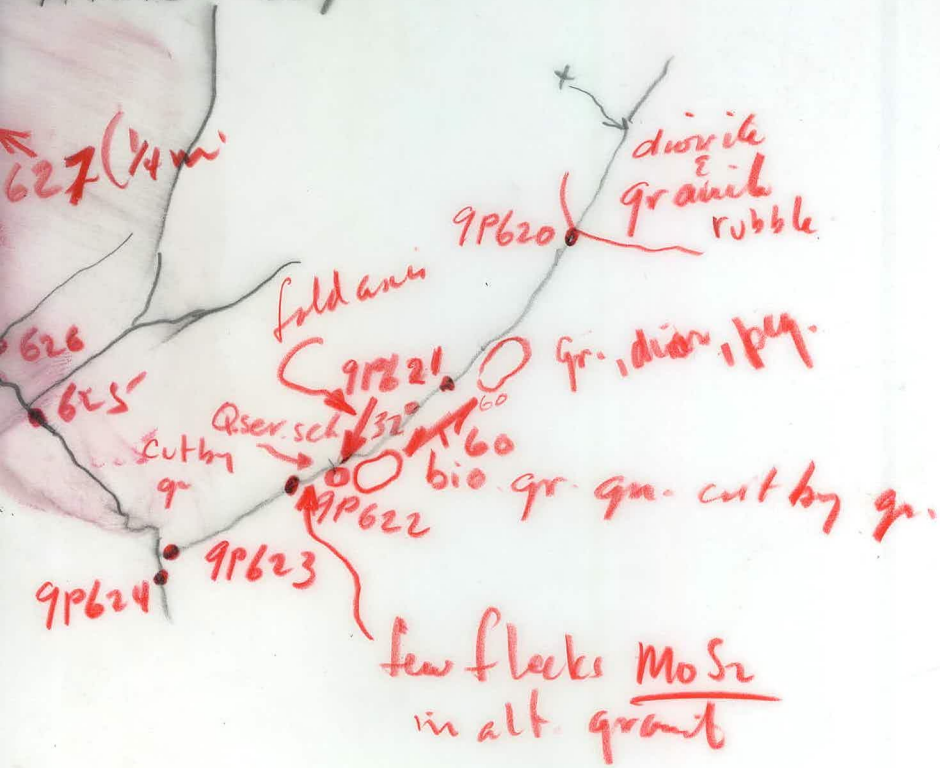

#23

C. Denton



Aug 24/69

105 K 04 ~~406~~

Photo 1

A-12176-64

2ND OUT

Pick-up @ 4:30

SOIL LINE

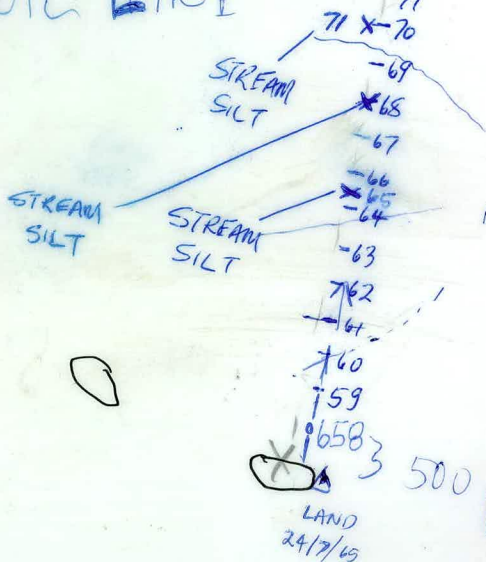

677 at landing site atop of ridge

671 is stream silt and is at same Δ as 670

668 is silt samples

N.B 665 is silt sample midway between 664 & 666

500 fts between lake and 1st sample

#'s 658 - 677 inclusive

Samples 658 to 677

↑ 008°

plotted

P.P. Sept. 1/69

Sample No 9218 to 9230

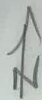

traverse # 46

Aug 31 / 69

A12232-232

105K4

Livingston Johnson

Grasshopper platted
Land
10/10/69

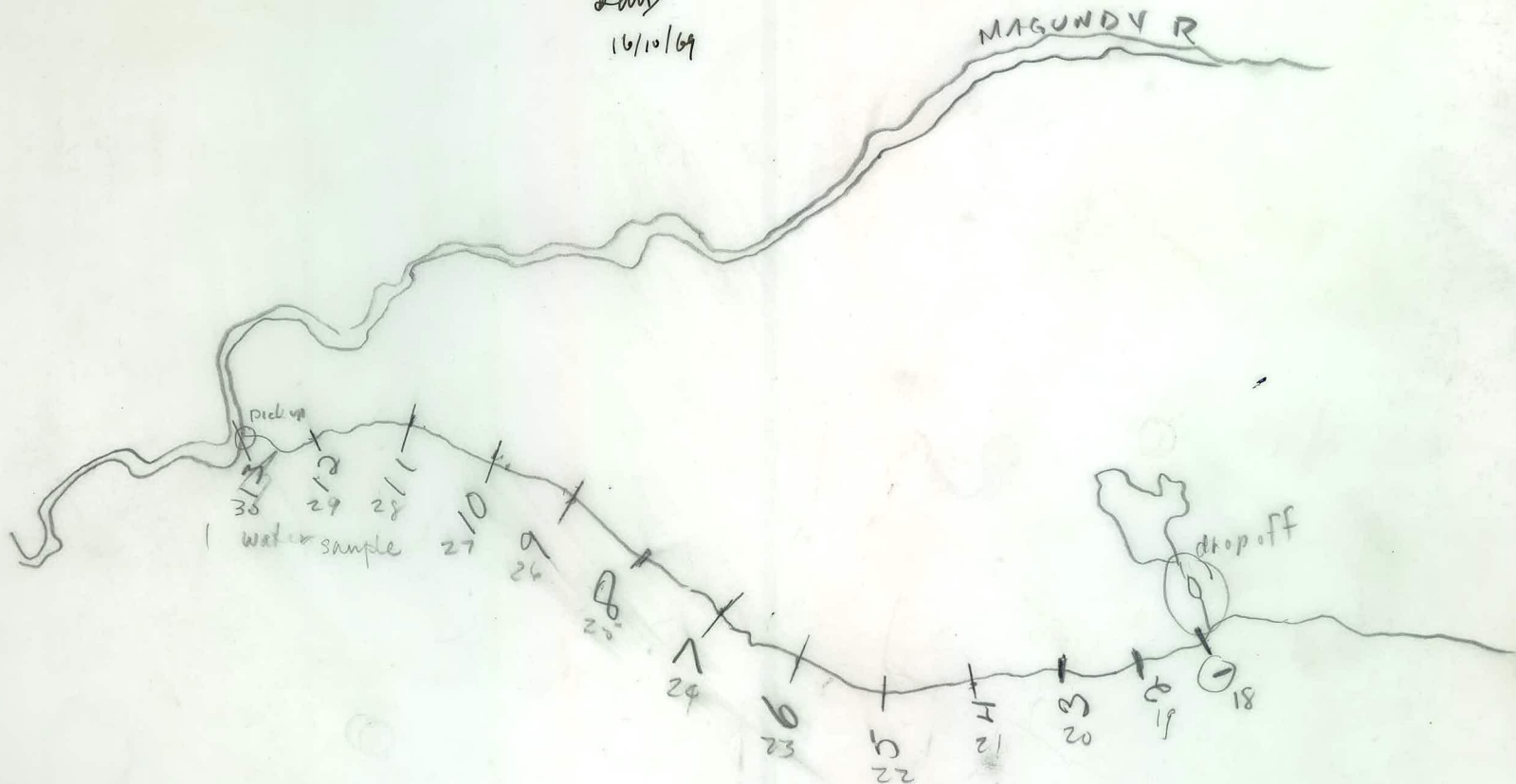

MoS₂ Showing

105K4



A12176-58

Aug 29/69.

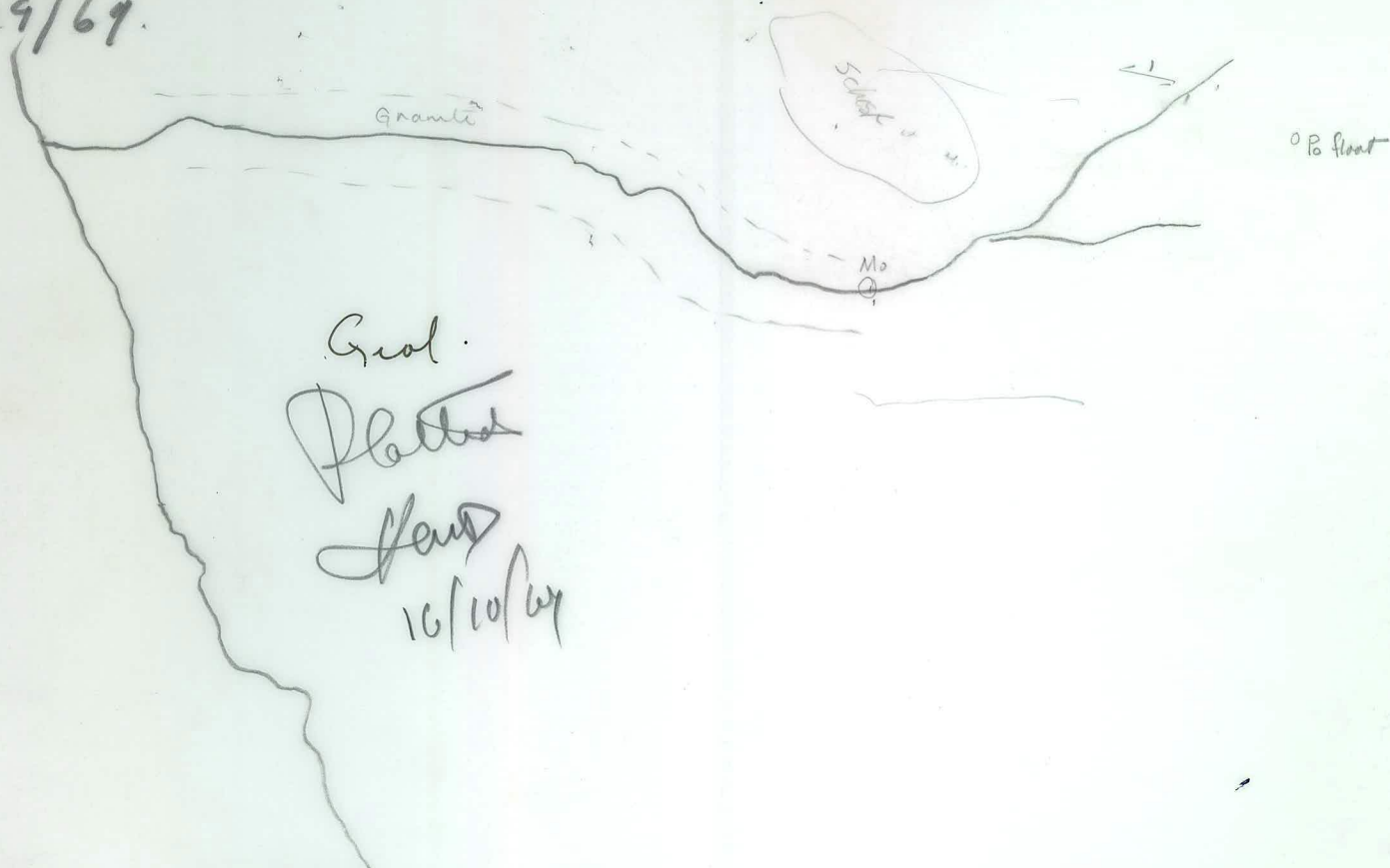

Sample No _____ to _____



Aug 31/69

A12232-348

105K4

Peter Fox

Traverse # 48

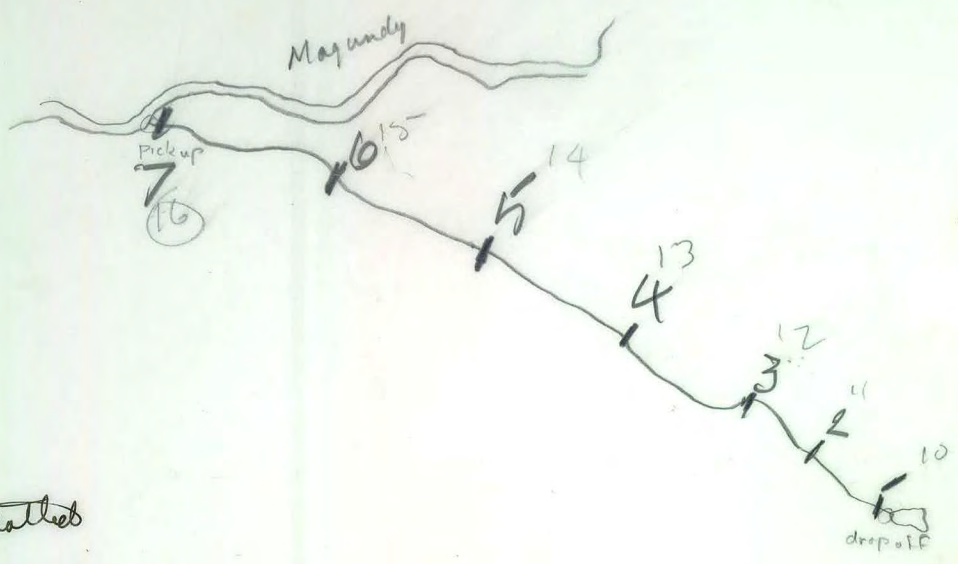

Gravel pit
 16/10/69

SAMPLE NOS. ^{C.O.} 130 to 171 G. Lishy 94-98

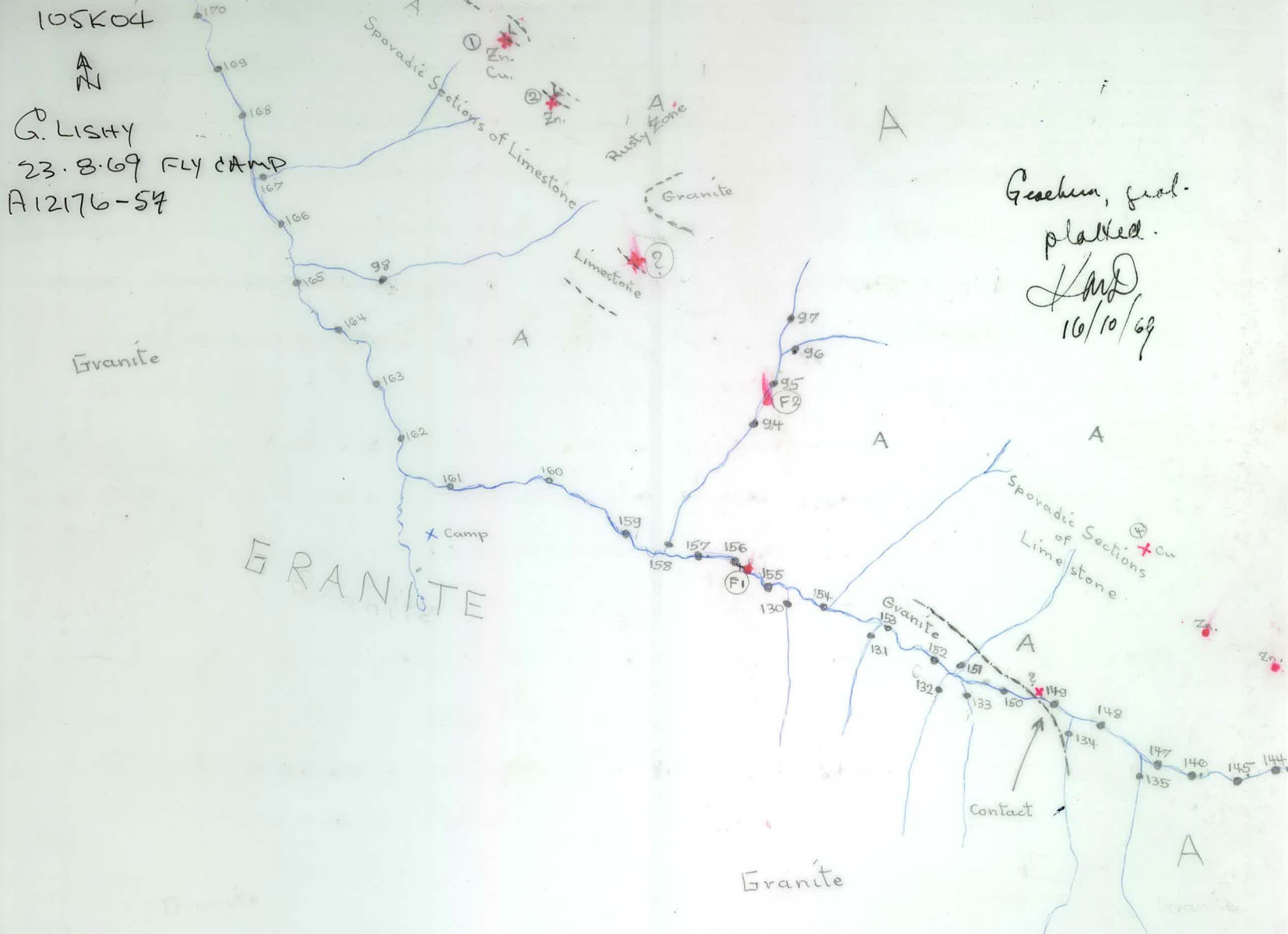

A - Mica Schists, Banded Altered Sediments, Crystalline Limestone
Granite - Fine to Medium Grained, Monzonite, Gneiss,

X Mineralized Outcrop

• " " " Float

All Mineralization found in Epidote-Farnet Scarn



Plotted

Sampler 9M1 to 9M12

105K4

Aug 23, 1969

Traverse #15

~~Take care~~ for pickup?

One of 2 photos.

Geo. Geochem.

Yield number 9M1 → 9M2 etc.

9M1 - 9M12

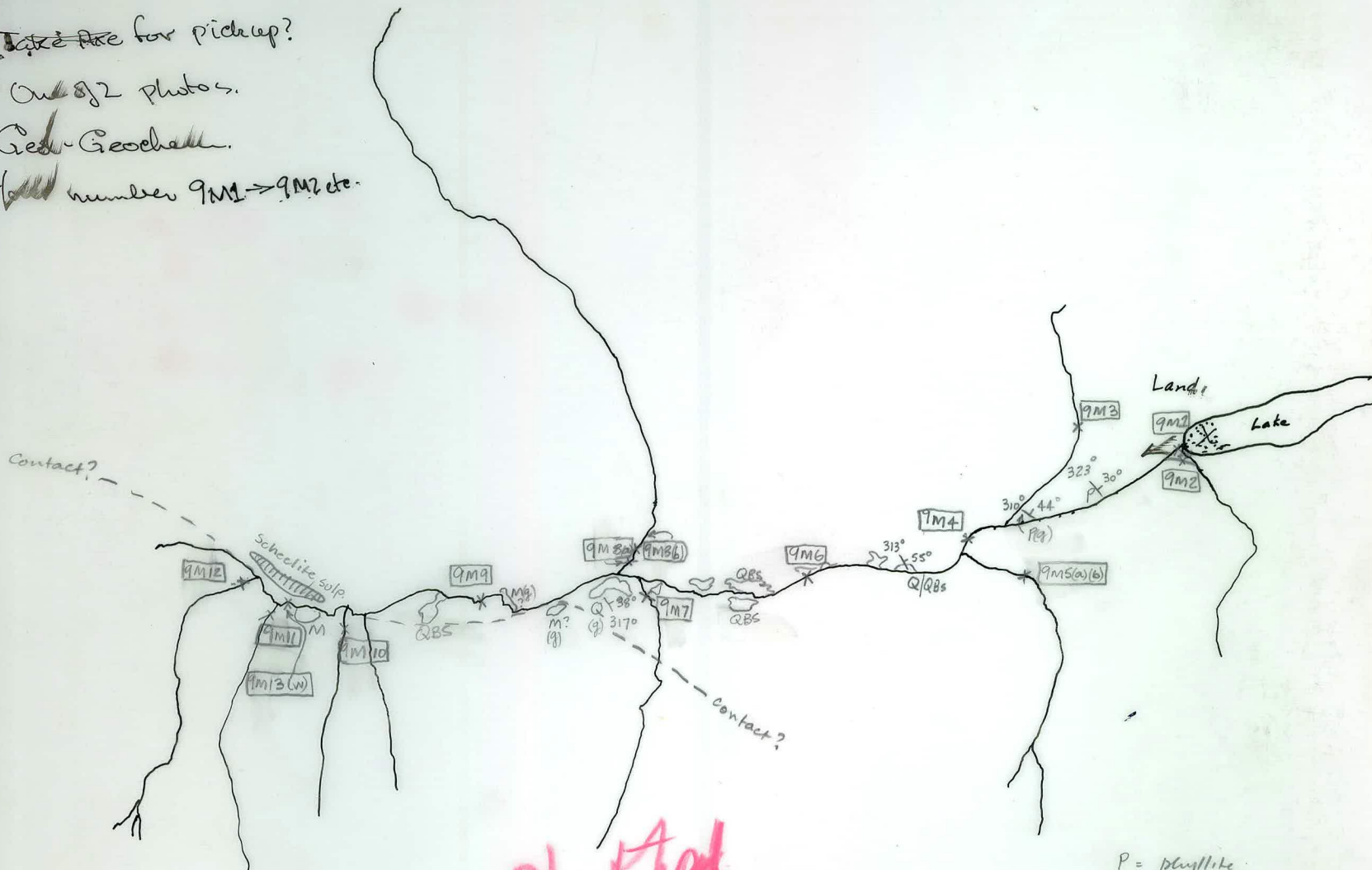

plotted

P = phyllite
 Q = quartzite
 QBS = quartz-biotite schist
 M = monzonite
 (g) = gossaned



105K/4

Samples 31 to 51

Sept 1/69



Livingstone J.

A13518-294

~~photo #2 of 2~~

Traverse 29.



Geoschem plotted

KMD

10/10/69

Samples 9N315-40 9N320

Tray #33
105 K04 & K03
A12178-128
Photo 182

Δ water sites
Neil Glass

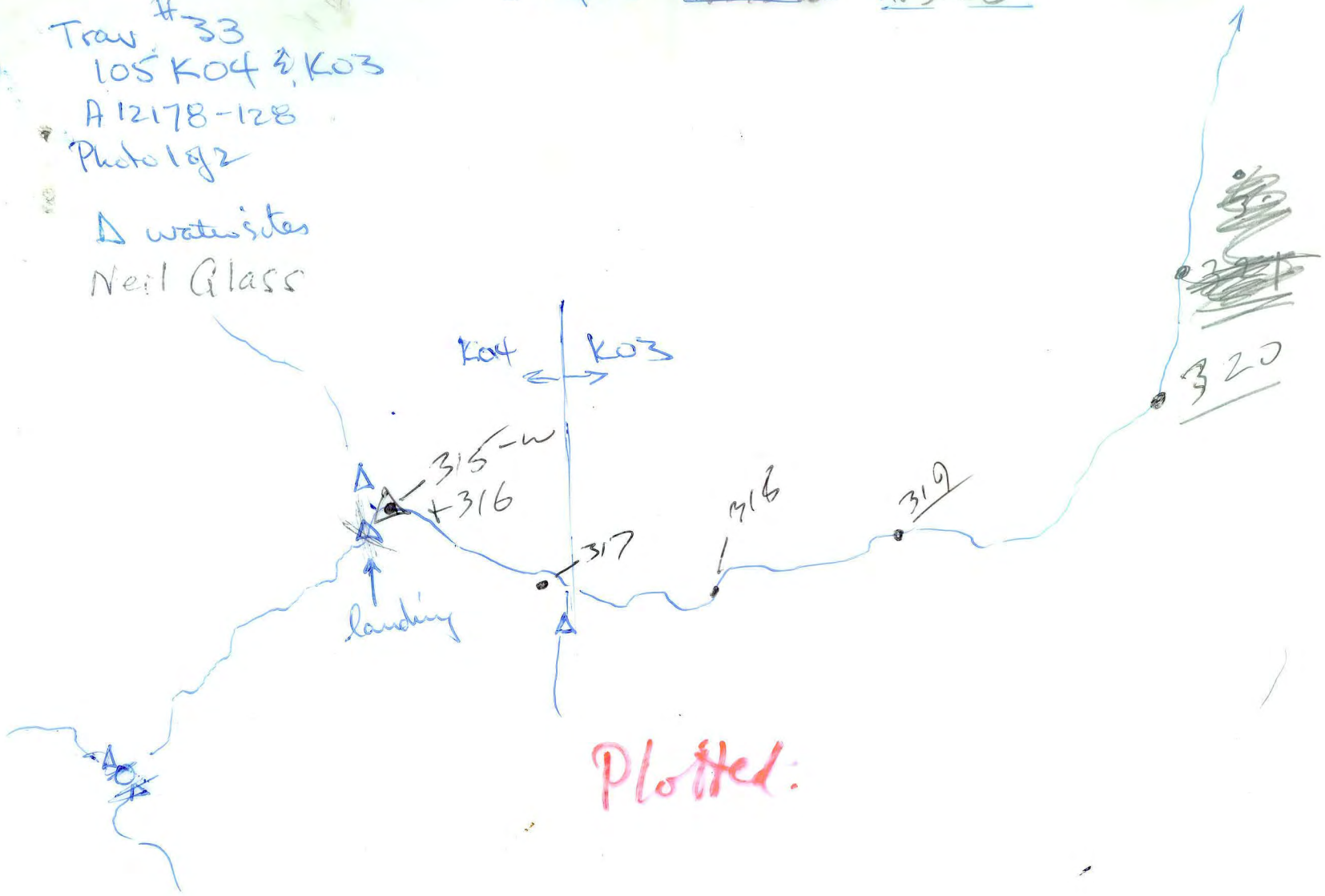

Plotted:

Sample No GV694 to GV967

Plotted

↑
traverse # 47

Aug 31/69

A13518-298

105 K4

Gary Deaton



1 of 2 overlays

Sample No 698 to 703



Aug 31/69

A12232-347

A 105 K4

Gary Denton

Plotted.

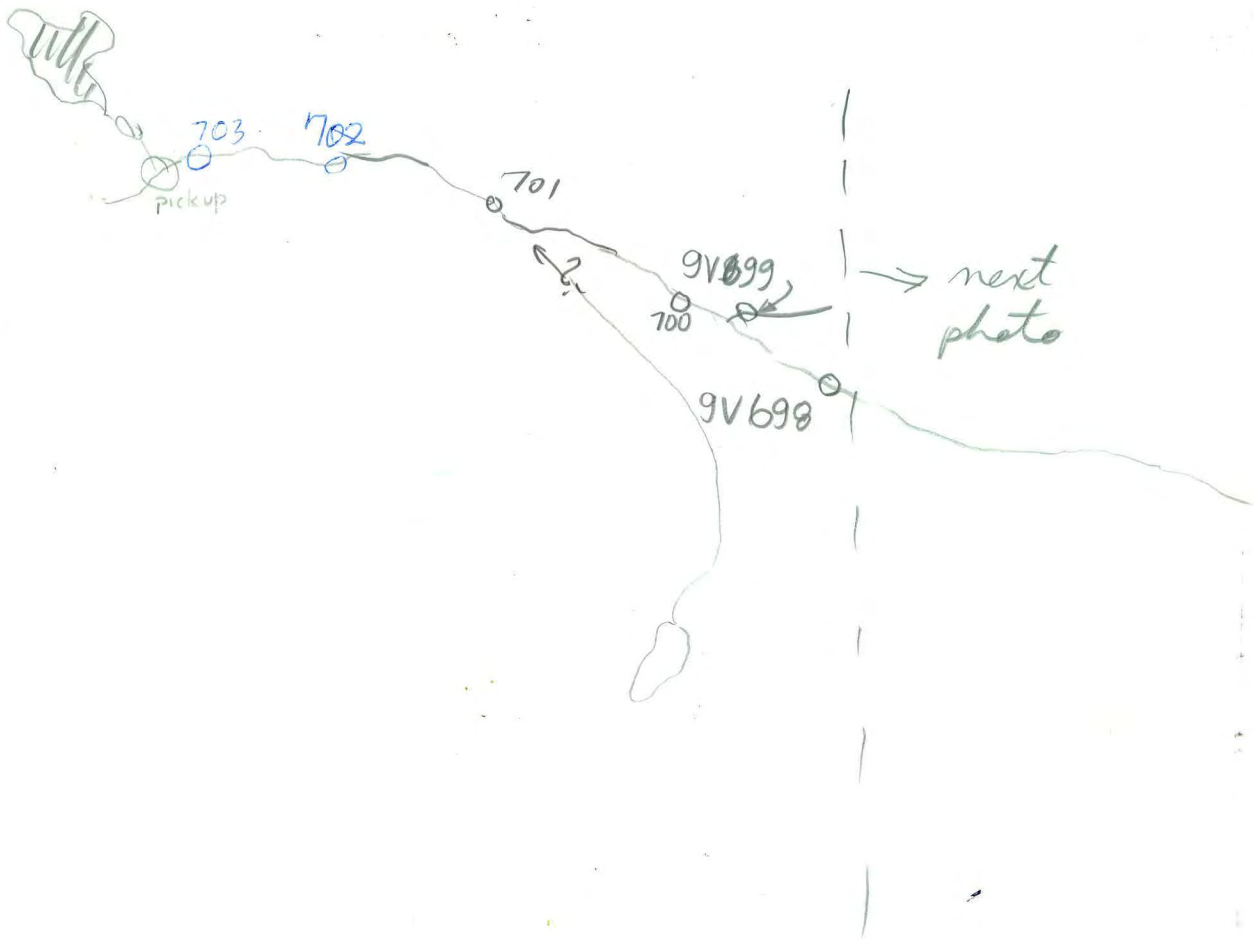

2 of 2 overlays

105 K / 4
Aug 23/69

Plotted

Samples 9P564 to 582

⌈
Reol-geodes
Traverse #14
Q. Pearce

geol sketch

A. 2176-59
2 of 2 photos.

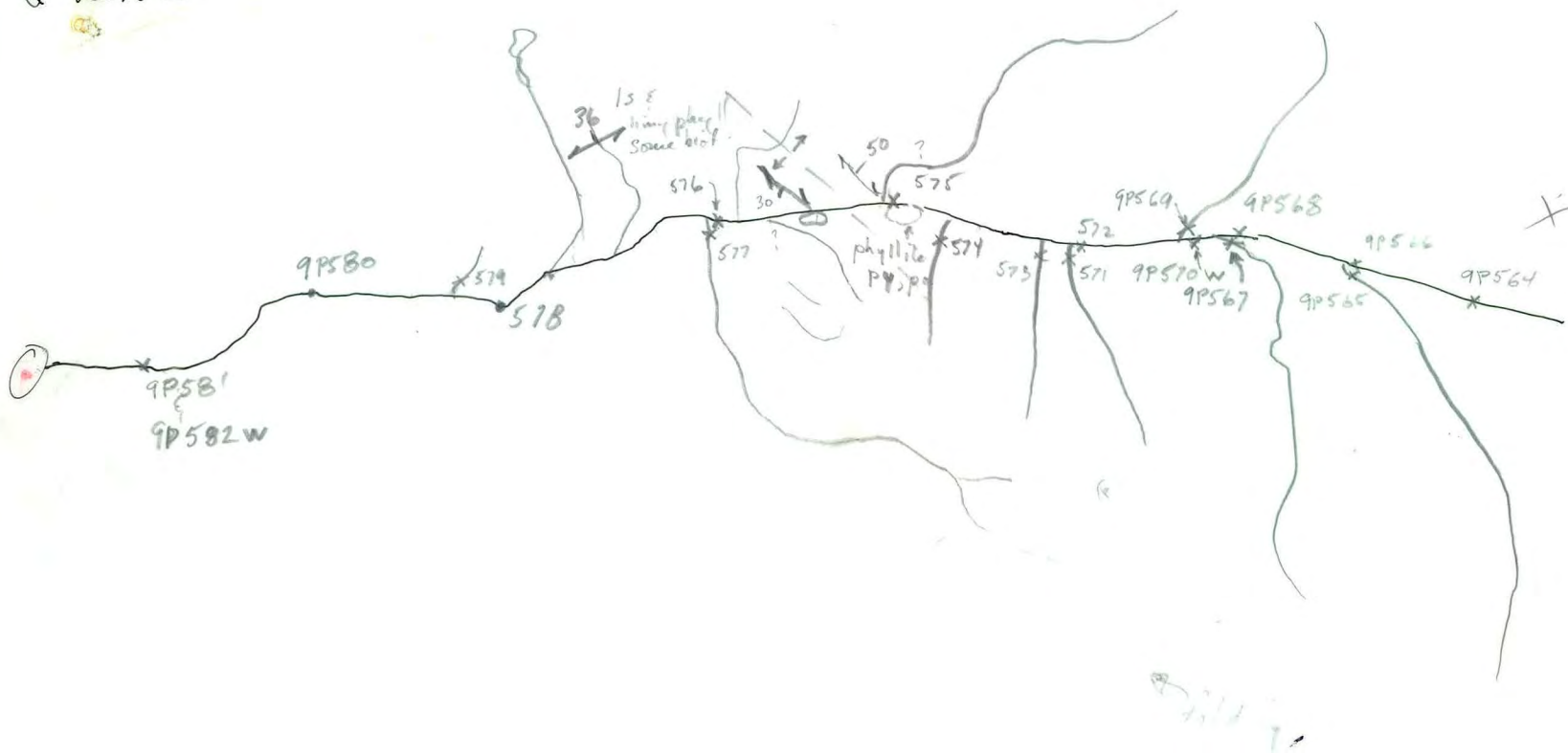

Plotted

N ↑

23 Aug/1969

W. Hamilton

Map 105K4

Traverse

Samples 571 to 589

RIVER

MAGUNDY

Geol Plotted

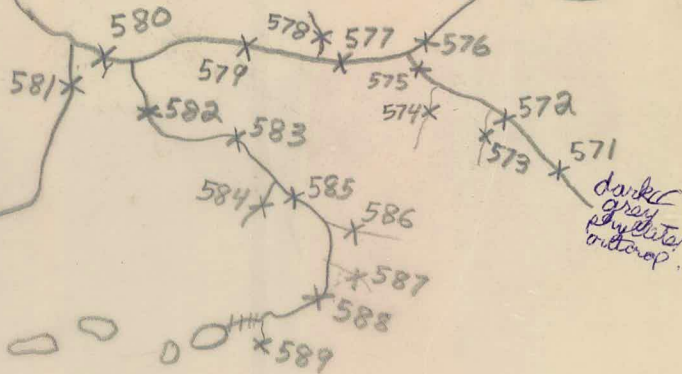

INSET FOR 9H570 S:IT
REK CLAIM GROUP 105K04 E ↑

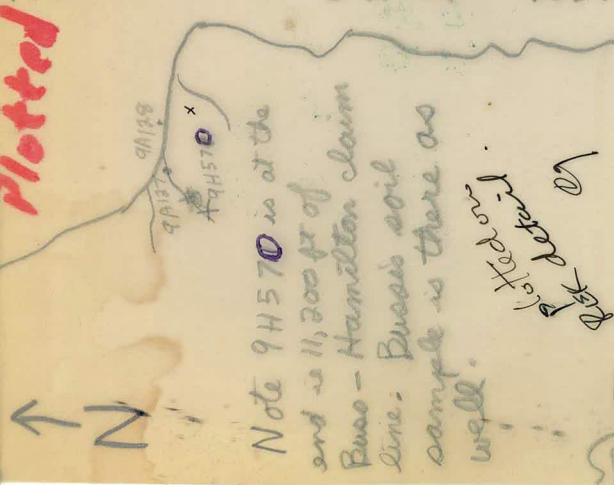

Note 9H570 is at the
end of 11,300 ft of
Busco - Hamilton claim
line. Busco's soil
sample is there as
well.
Plotted on
Rek detail

Note re. Geology: The entire area
from 571 to 585 was characterized by
dark grey phyllite outcrops. Almost no
rusty rocks (float) in streams. Two such
quartz - pyrite containing rocks found at
576 and 585, respectively.

W. Hamilton
23/8/69

105 K A

↑
N

Aug. 17/69

Trav #4

W. Gruenwald

Sample 933 to 938

Photo A-12176-83

Plotted

Geol plotted

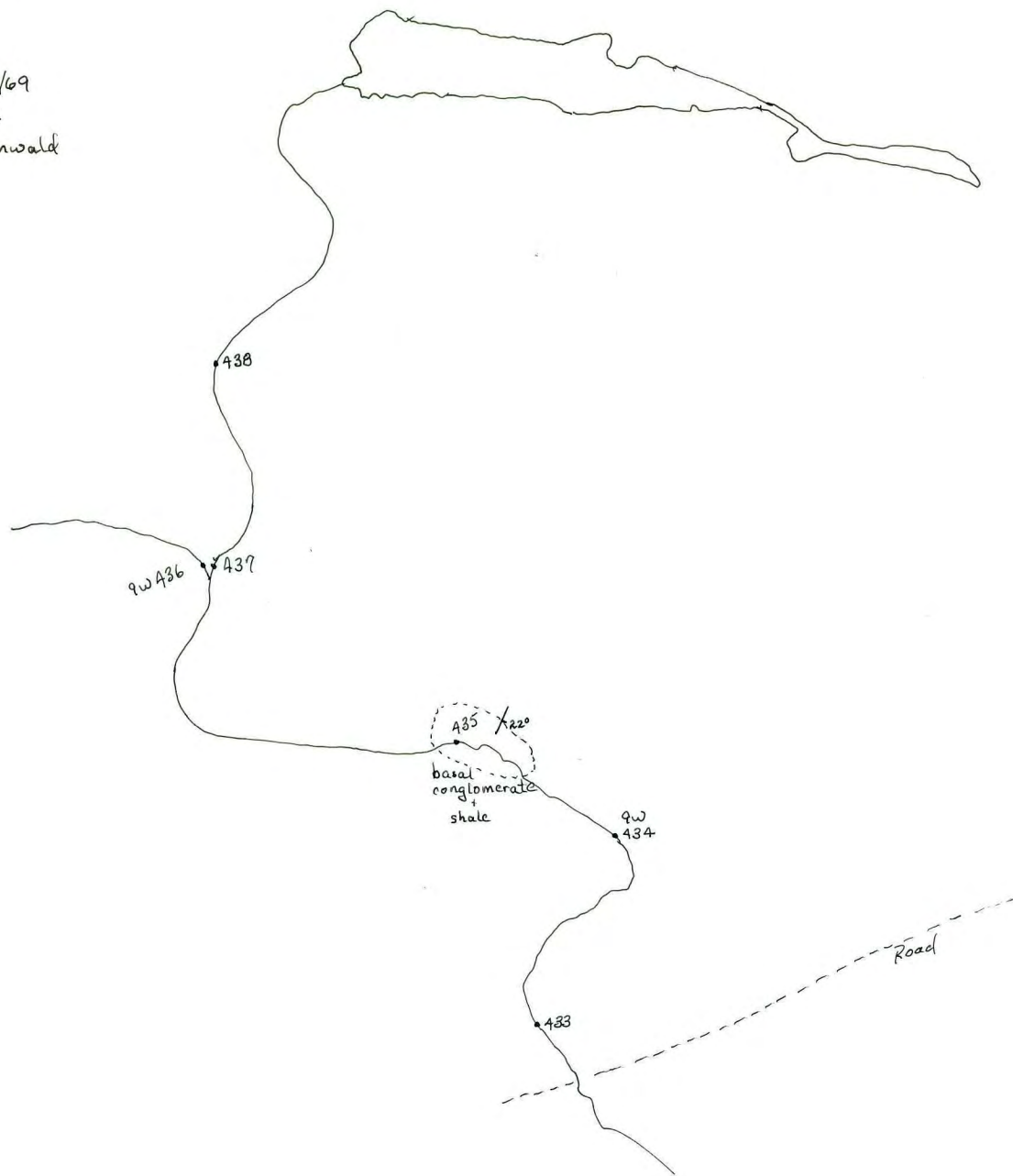

105K04

Aug 22, 1969



Silts

Traw. No 3

Neil Glass

Samples 9N~~242~~ to 9N~~247~~

A12176-65

~~Plot~~
Sam. o

9N241 to 9N247

Plotted

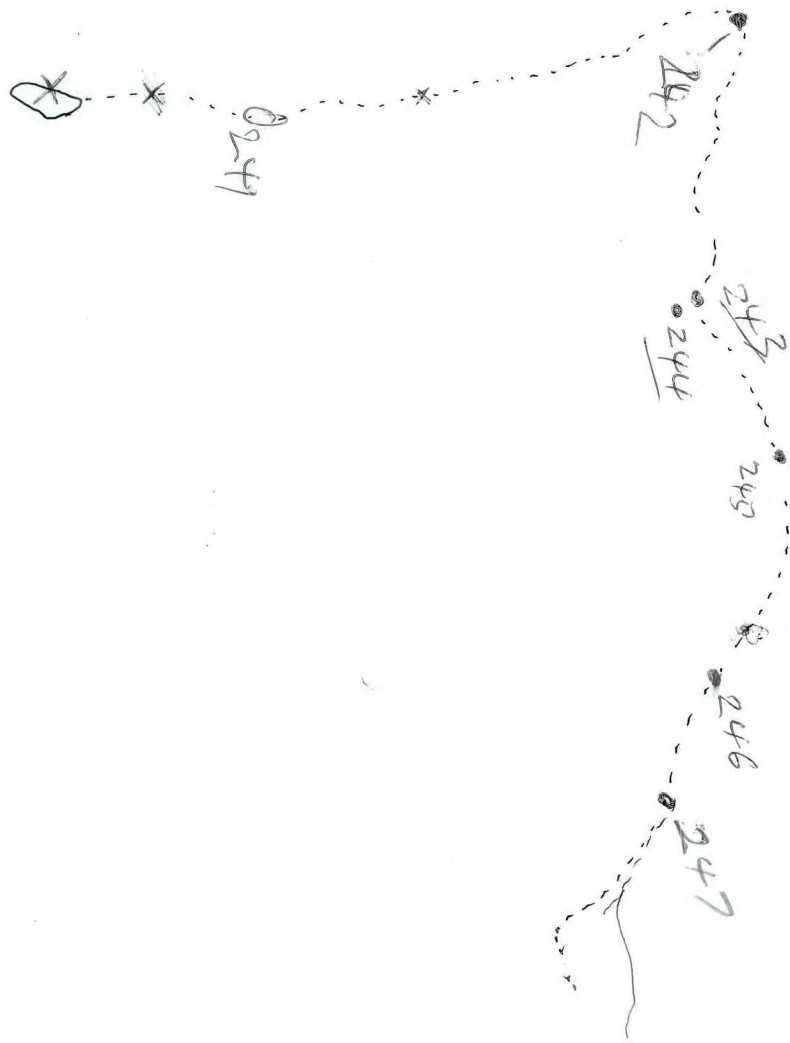

TAY R. VER

A12182-.99

Plotted

MAGUNDY RIVER AREA
MAP-105K04

Ray Wells

Great. plotted.

South Half
Aug 17/69
traverse #1
Wells
Photo #1 of 2
NOTE: ONLY 1 PHOTO
REQUIRED.

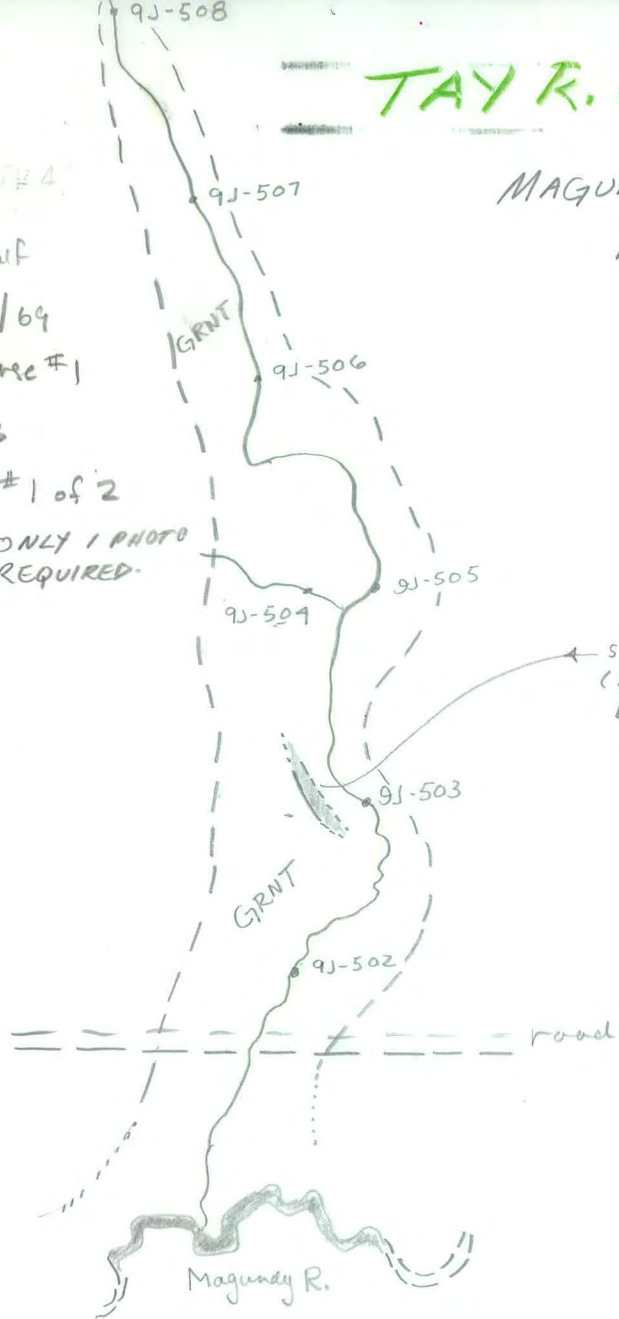

MINERALIZATION

- RUST IN GRNT (MEDIUM-FINE)
- BUT NO VISUAL EVIDENCE OF MINER.

R. WELLS

Probably next
good creek to West
(i.e. in 105L01)

W

#20

E. Buss

Photo 282

Aug 29/69

105K04

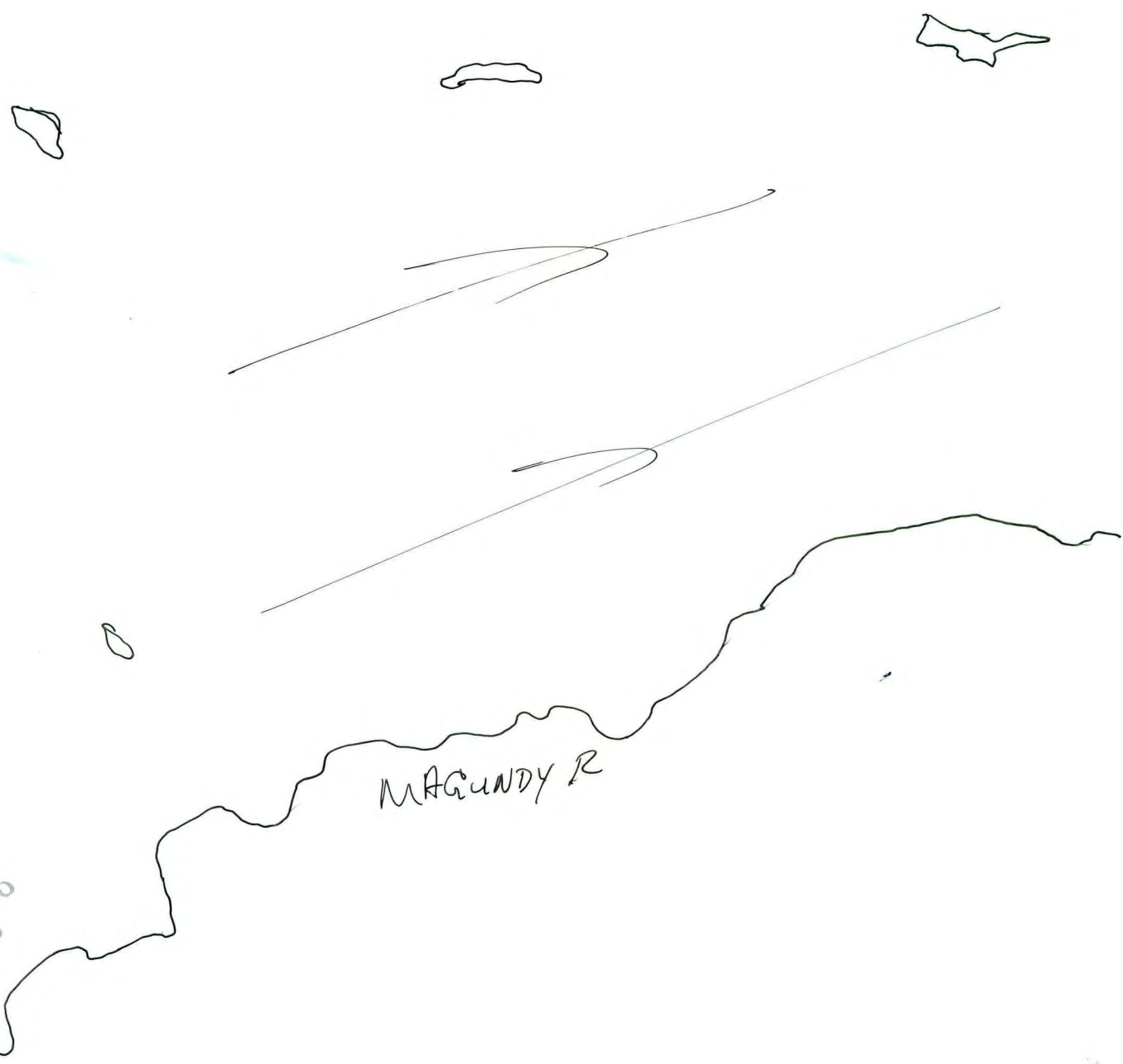

105-K4

Samples 9N 266 to 9N 265

↑ Photo # 12182-200

△ proposed 1420 sample site

Photo 2 of 2.

Tray # 24

Neil Glass

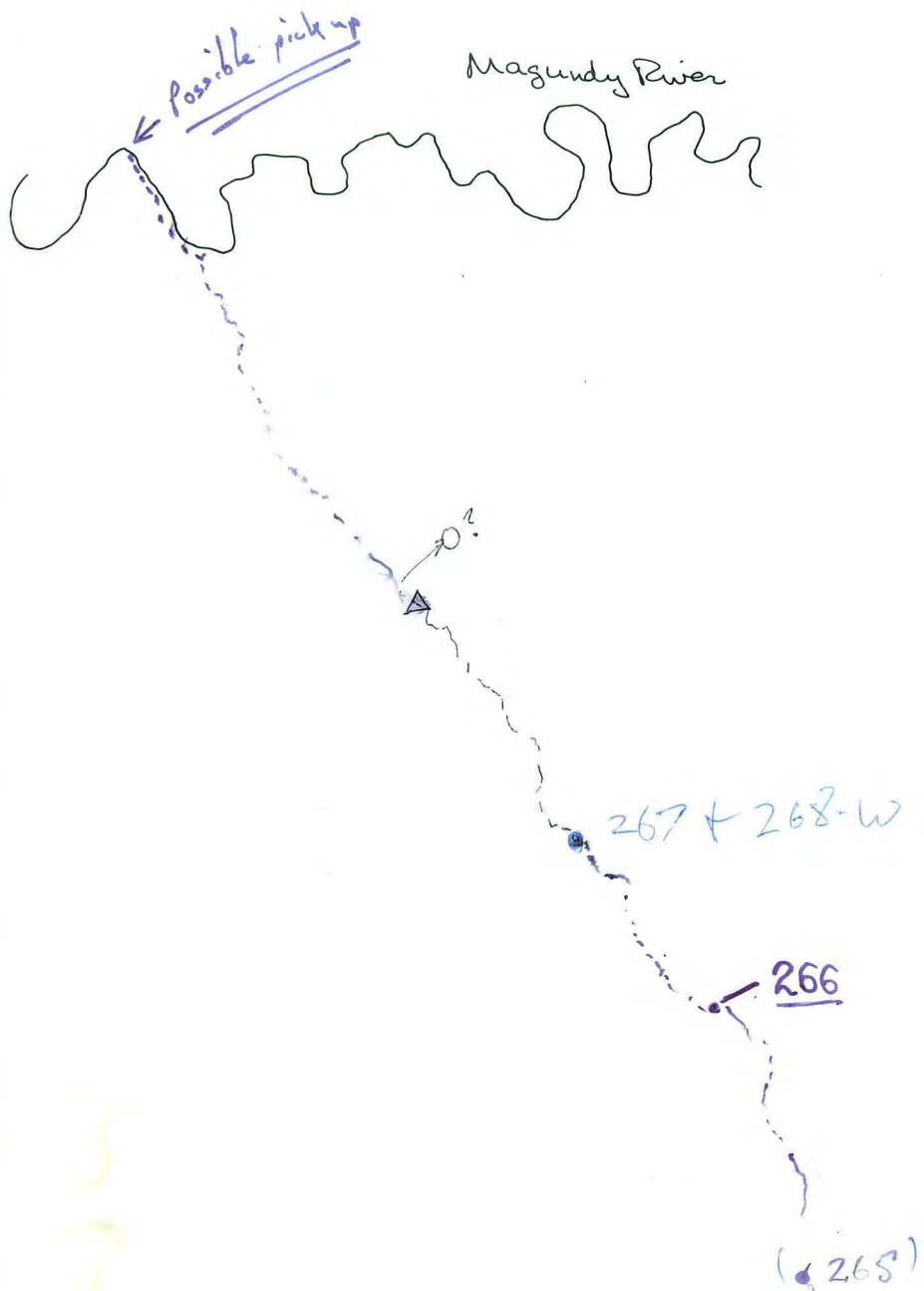

Plotted
Aug 31

105127

SAMPLES 9N 256 to
9N 5



TAKE AXE.

NEIL GLASS

TRAV #24

PHOTO 192

▲ Proposed H₂O sample site.

Photo #12182-202

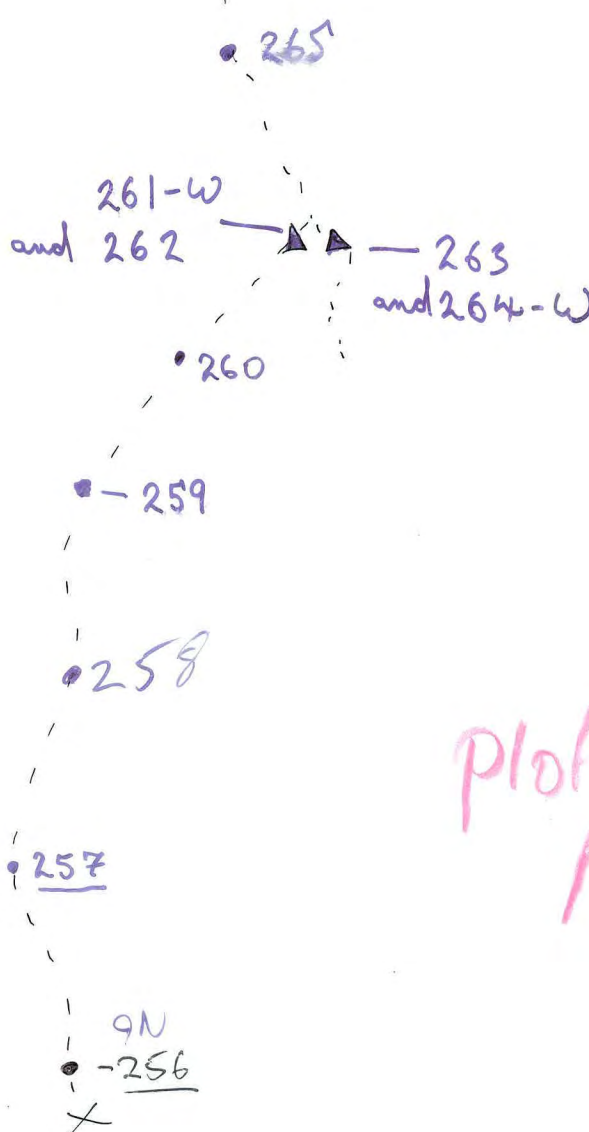

Plotted
Aug 31.

105 K 4

A
N

Aug 19th
Traverse #2
(2 of 2)

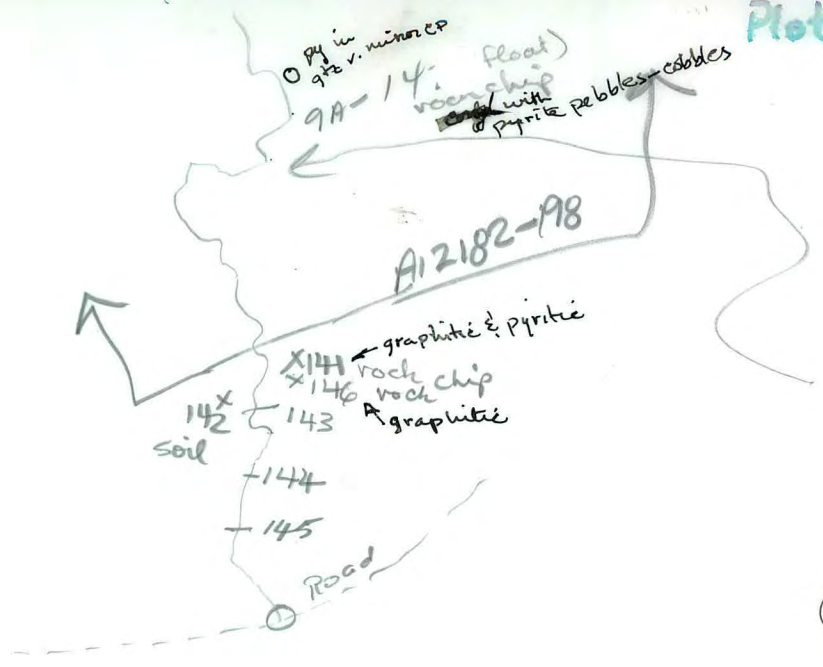

Plotted Samples - to -

A -176-62
2 of 2 photos.
P. DEAN
9A-141 → 147

Sample 9A-147
float in
creek

Geol plotted KMD 23/10/09

105 K 4

20
Aug 1, 69
Traverse # 2
(1 of 2)

Plotted

samples - to -
A121. 2-198
1 of 2 photos
K-A camp established 20.9.69
moved

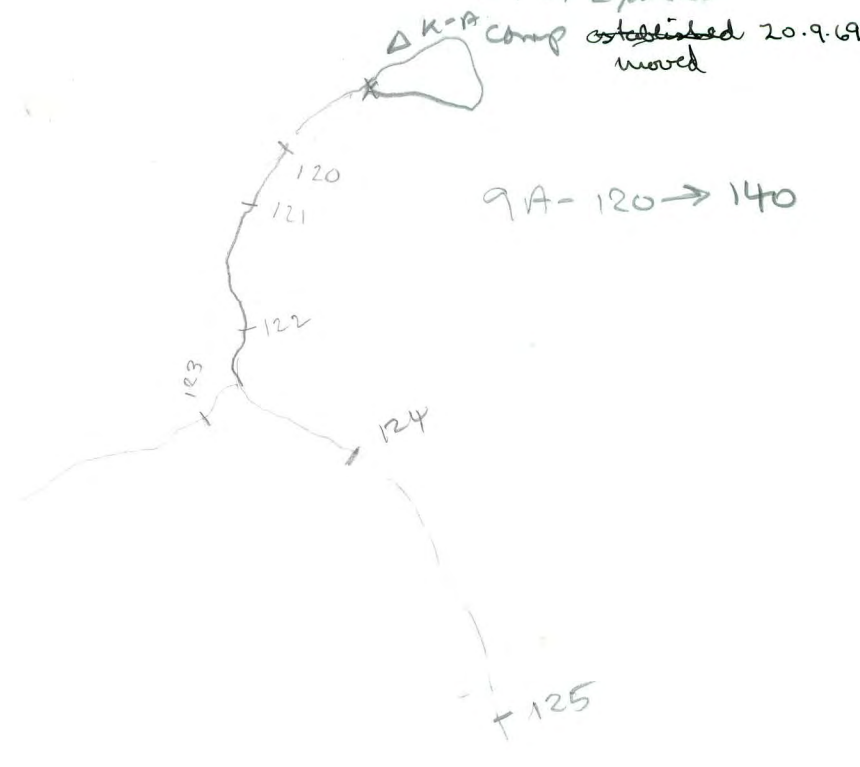

Great plateau
fwd 23/10/69

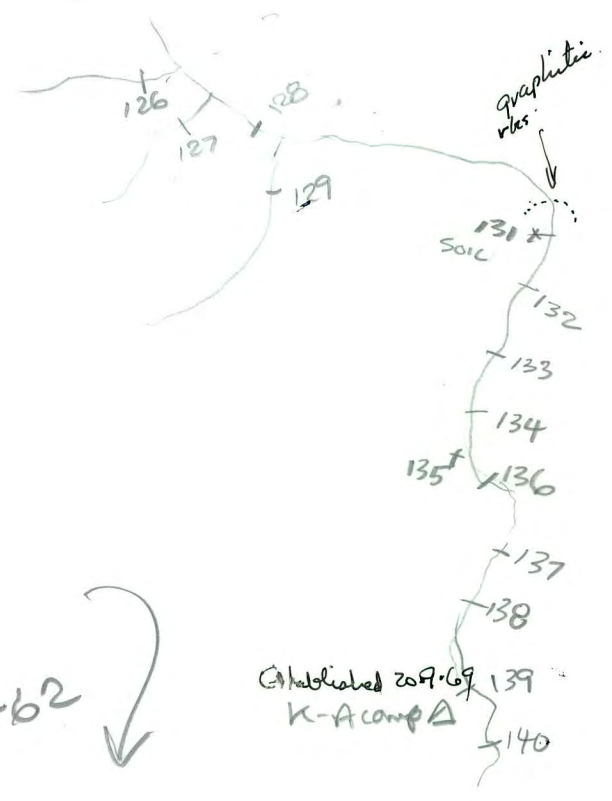

next photo
A12176-62

Established 20.9.69
K-A camp

A12176-64
Plotted

105K4
↑
Aug 17/69
traverse #3
Dean BOSS
4 PM ±

see Glass
WRONG TRAV - NO2
vs (next creek to W)
(i.e. same as Dean Trav. of 20.8.69)
creek non-existent

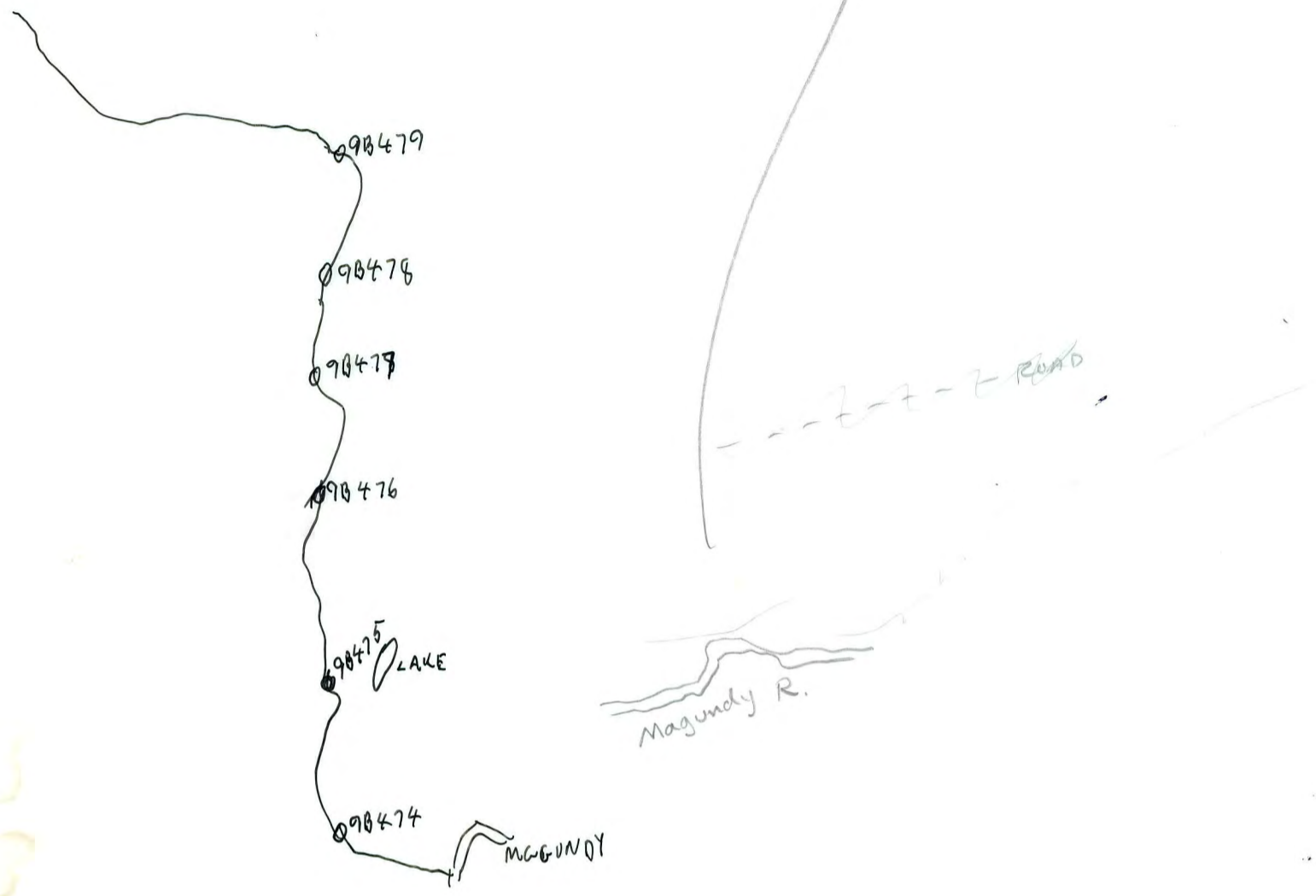

Plotted

SAMPLES 9V 586 to 9V 617

105K04
AUG 22, 69

Start



NB SAMPLES ARE APPROX 500' APART

SOIL LINE
TRAV #12
GARY DENTON
A12176-64

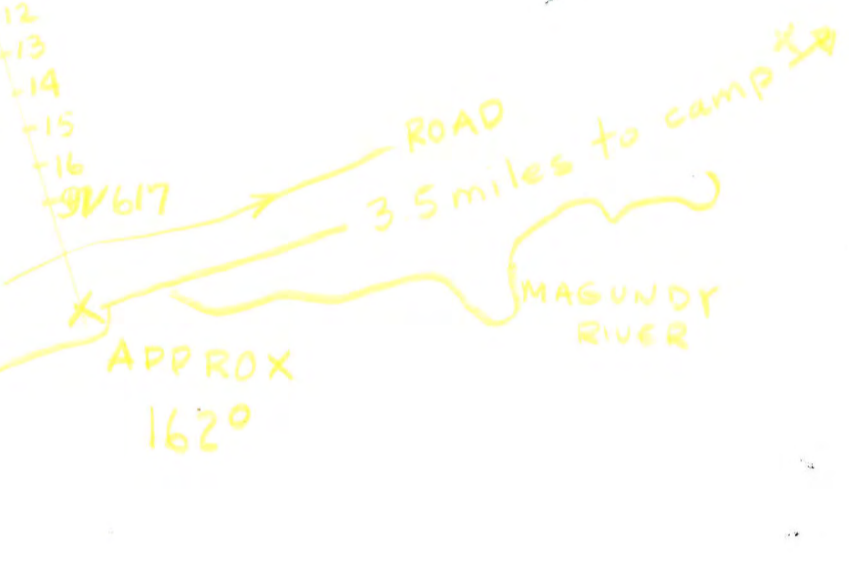

105K4

TAY RIVER

Samples 509 to 532

1. 2176-83

TRAVERSE #10

R. WELLS

Plotted

Aug 19th/69
Traverse #10

SOIL SAMPLE TRAVERSE

- NOTE:
- 9J-513 + 522 = SILTS
 - 9J-510 = GREY SOIL
 - 9J-516 = BLACK SOIL
 - ALL OTHERS ARE RED SOIL

* NO VISIBLE ^{OUTCROP} THROUGH OUT TRAVERSE

MAP: 105K04
PHOTO: A12176-83

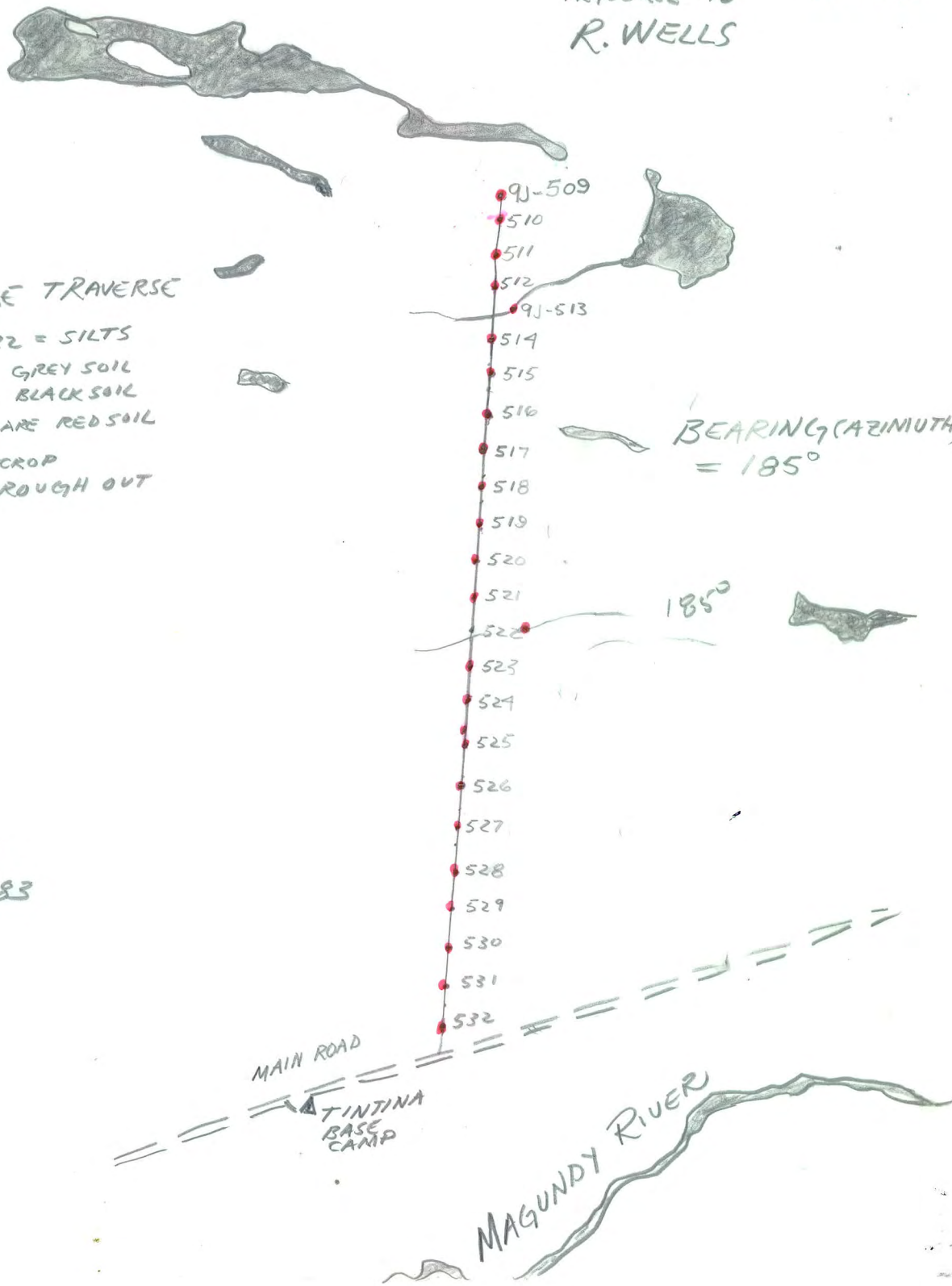

Plotted

Samples 98492 to 98517

AUG 76-62

105 K4
soil line & silt intertidial

Aug 23, 1969

Traverse #16

Buss - Take axefox pick-up
mattock for soils

Sample every 500 feet approx

68°

camp 3 1/2 mi

MAGUNDY RIVER

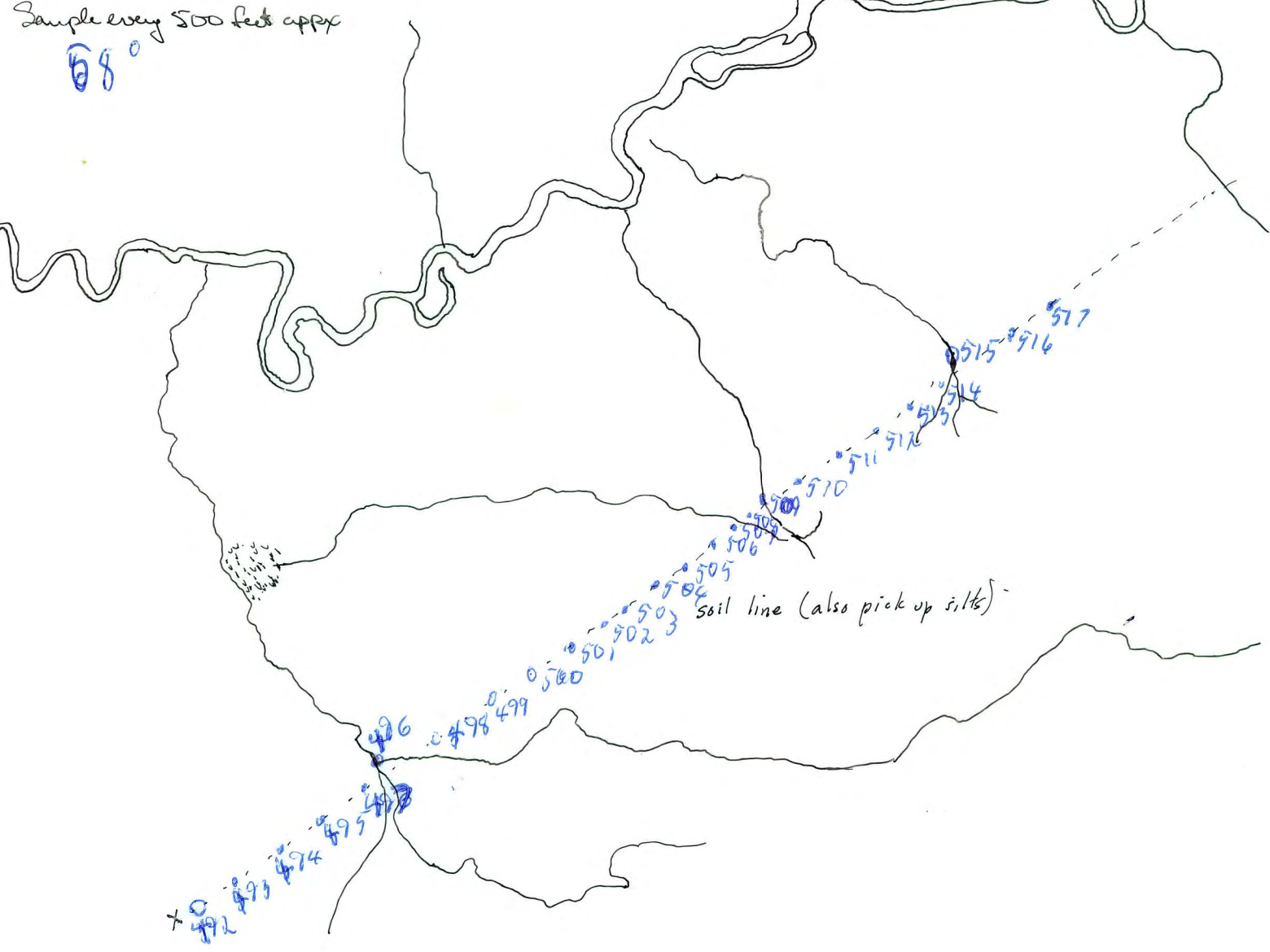

Sample# — to —

583 to 595

#21
TRAN. No. 21

Take AXE!

G. Pearce
105KA
Aug 24/69
A-12176-87

SA

△ Proposed H₂O site.
PICK-UP 5:30

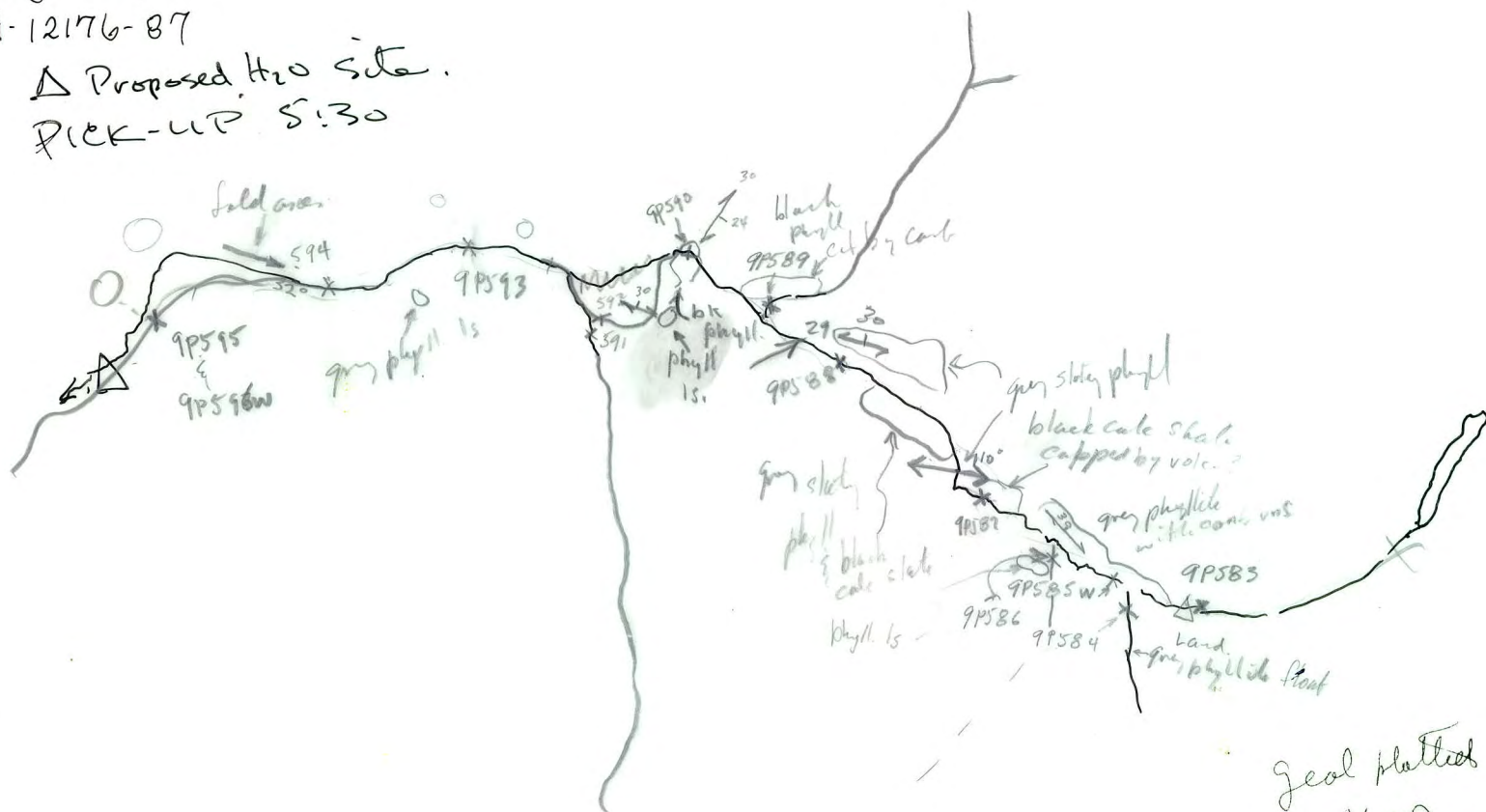

Geol plotted

Hand

25/10/69

Geochem plotted

Aug 31

1" = 1 mile 105K-4 top sheet overlay (N W corner)

P. DEAN 26 August 1969

Samples 9A-237 → 9A-242

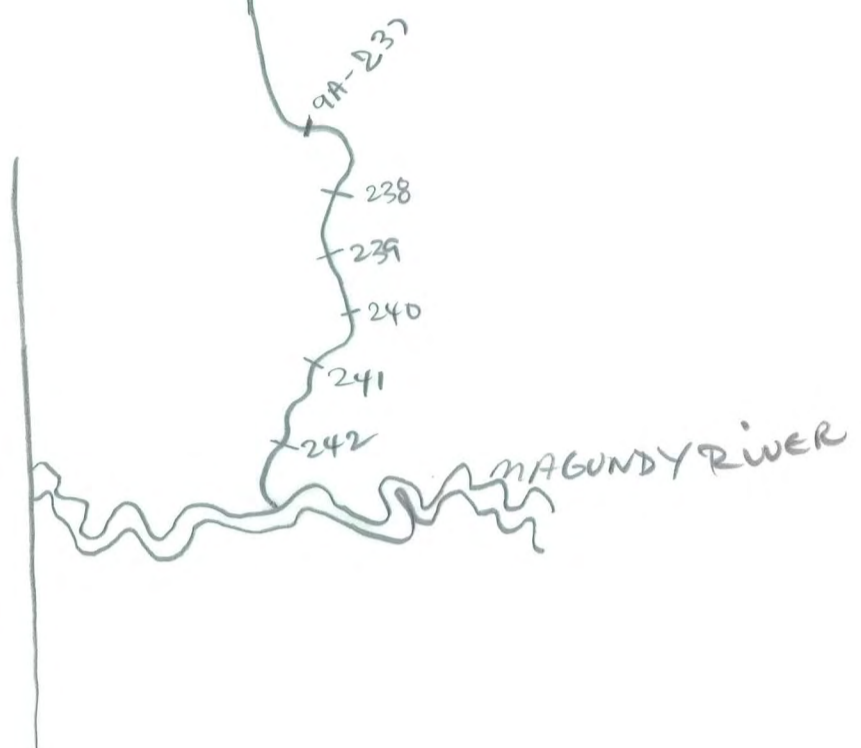

Plotted
Aug 31

TRAV 22

Samples 9M 14 to 9M 24.

BREMNER (M)

24.8.68

A12232-341

Photo 192

105 K04

△ possible H₂O sample sites?

3RD OUT

PICK-UP 5:30



Gridlines plotted.
Aug 31.

A 12176-90 E 59

Aug. 23/69.

A. Pearce.

Traverse #14.

105K 4.

0700 rounded hill South of
cirque

grey phyllite cut by
bull gtz E 90/55N.

Walked down (S) to Valley

9P564 - R 4x1

Grey Phyllite

1500 Jct. with cirque creek
from S.

Cirque creek - 9P565

main - 9P566

"knotted" grey phyllite
blast from cirque creeks

3700 - Creek from S.

9P567 A 5 B L R.

'5 x 5'

knotted phyllite (stained)
- blast

9P568 - main creek

Bx. 5 P.C.

4000 - Inlet from N -

9P569 - 1' x 0.1
gray.

(water) → 9P570W - main creek

5800 - small trickle
from N 4 creek - B

9P571 A 9P572

main 9P572 knotted
phyllite - dark leaf
like a 9919 - decussate
pattern in fol. plane
identical to that
seen at Orvil pit

6300 - small - creek 2
from N 9P573

7400 - 9P574 dry
center of channel.
Some py, po, ? in
sub. float.

7650 - silty, phyllite
with minor py & po.
Σ 132/50N

8500 - 575 main Cr.

9100 - ls & limy phyllite
under calc. bed - fine
dissen - py & spg
than limestone.
Σ 134/30W

10,500 - trail from N
4x 03 P&h
granite & phyll. local.
90577
main 576

13000 - walked up ravine 1200'
to high site:
resill. ls, limy phyllite
phyllite & bit gr. sch.
Σ 75/36N

... back to mouth of
ravine (no creek in ravine)

14500 - Silt main
9P578
R-12x0.5
grey.

14750 - trib from N - small
9P579

14700 - 9P580

17400 - 9P581 E 582