

015495

MAY 4 1966

KERR-ADDISON GOLD MINES LIMITED

(FOR INTER-OFFICE USE ONLY)

To..... Mr. P. M. Kavanagh..... From..... W. M. Sirola..... ✓

Subject..... Swim Lakes "A" Group - Diamond Drilling..... Date..... May 3, 1966.....

Enclosed are four letter sized plans of the various zones we will be drilling on the "A" Group.

In the case of zones 1 and 2, I have coloured in red pencil the first two holes of each zone. The disposition of these drill holes is such as to quickly give us dip information on each zone.

For zones 3, 4 and 5, I have shown in red pencil one vertical drill hole in the eye of the gravity anomaly. Barring unforeseen problems, these will be drilled through to the graphitic footwall in each case.

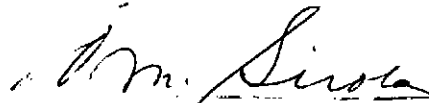

W. M. Sirola.

WMS/lk

MAY 2 1966

KERR-ADDISON GOLD MINES LIMITED

(FOR INTER-OFFICE USE ONLY)

y/5-14

To..... Mr. P. M. Kavanagh..... From..... W. Sirola..... ✓

Subject..... Swim Lakes "A" Group - Diamond Drilling..... Date..... April 29, 1966.....

The instructions I have given Fred Chow regarding the disposition of the four drills are as follows:

<u>Zone Number</u>	<u>Location</u>	<u>Bearing</u>	<u>Dip</u>	<u>Direction of Next Move</u>
1	A-6-A	S 30° W.	60°	Westward on same tier.
1	A-4 + 200' N	S 30° W.	60°	Westward on same tier.
2	150 ft. N. of center of Bouger anomaly.	S 30° W.	60°	Northward to second tier in line with upper hole. The same bearing and dip.
5	Line 13 E. B.L. 2 + 700 S.		90°	If economic mineralization encountered, move 200 feet N. Otherwise, move to zone four and drill vertical hole on line 10 - 600 N.

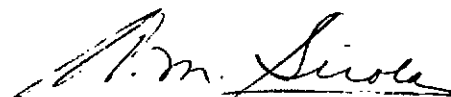

W. M. Sirola.

WMS/lk

From A-19

File Swim Lakes

J H Stovel

13 1/5/14

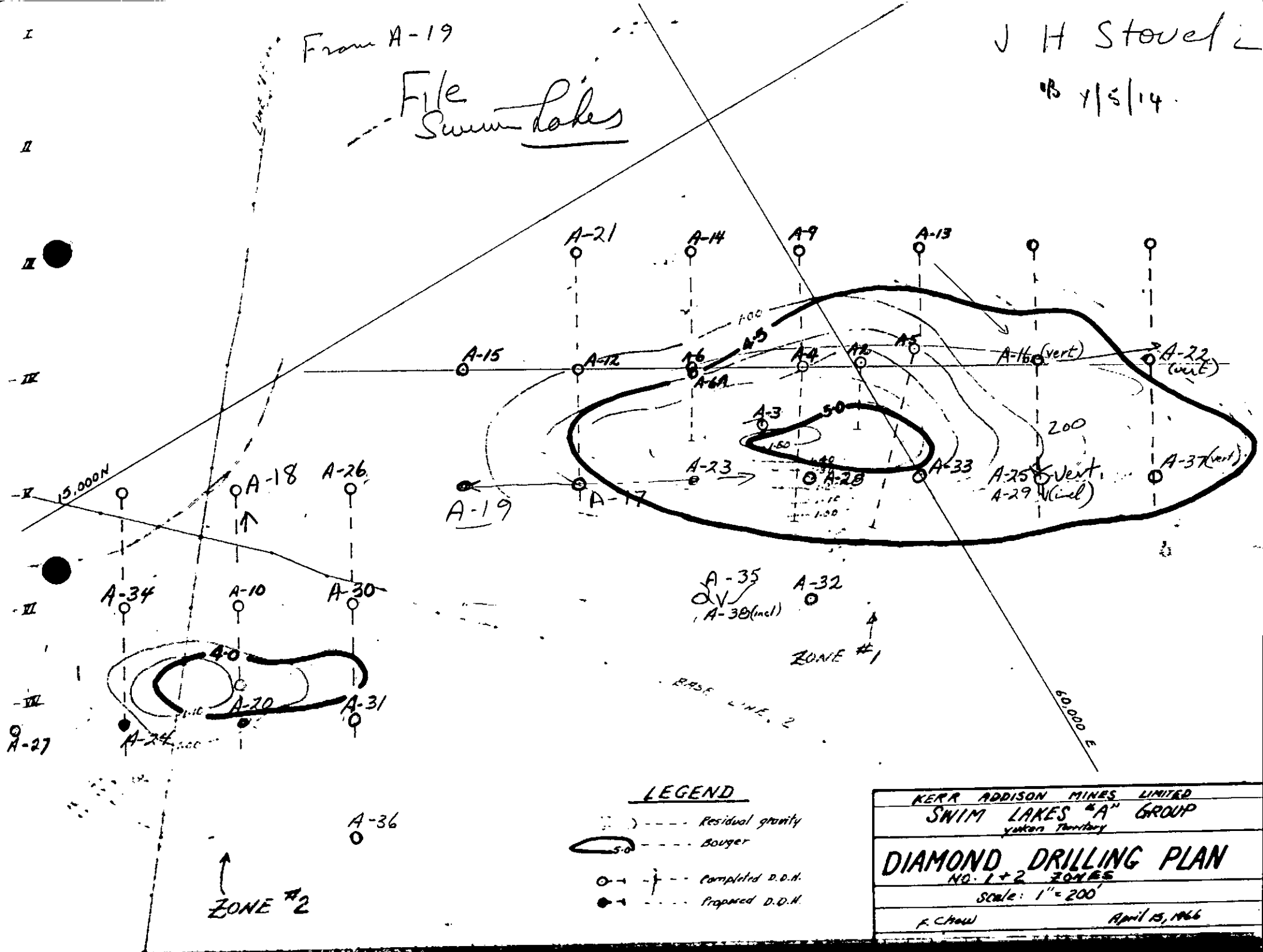

LEGEND

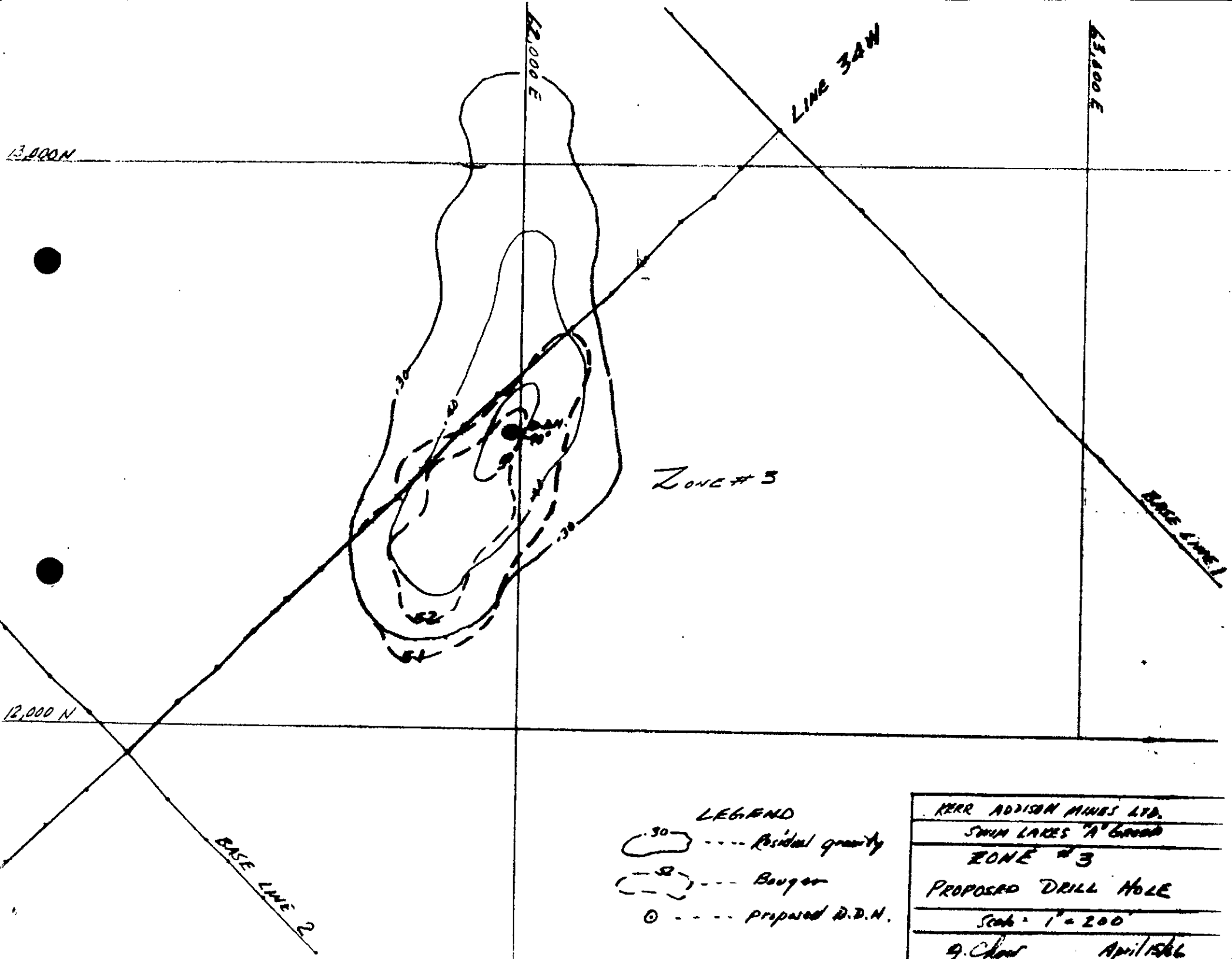

- Residual gravity
- Bouguer
- Completed D.D.H.
- Proposed D.D.H.

KERR ADDISON MINES LIMITED	
SWIM LAKES "A" GROUP	
Yukon Territory	
DIAMOND DRILLING PLAN	
NO. 1+2 ZONES	
Scale: 1" = 200'	
F. Chow	April 15, 1966



ZONE # 3

LEGEND

-  --- Residual gravity
-  --- Bouguer
-  --- Proposed D.D.N.

MERR ADDISON MINES LTD.
SWIM LAKES "A" GROUP
ZONE # 3
PROPOSED DRILL HOLE
Scale = 1" = 200'
G. Chas April 1966

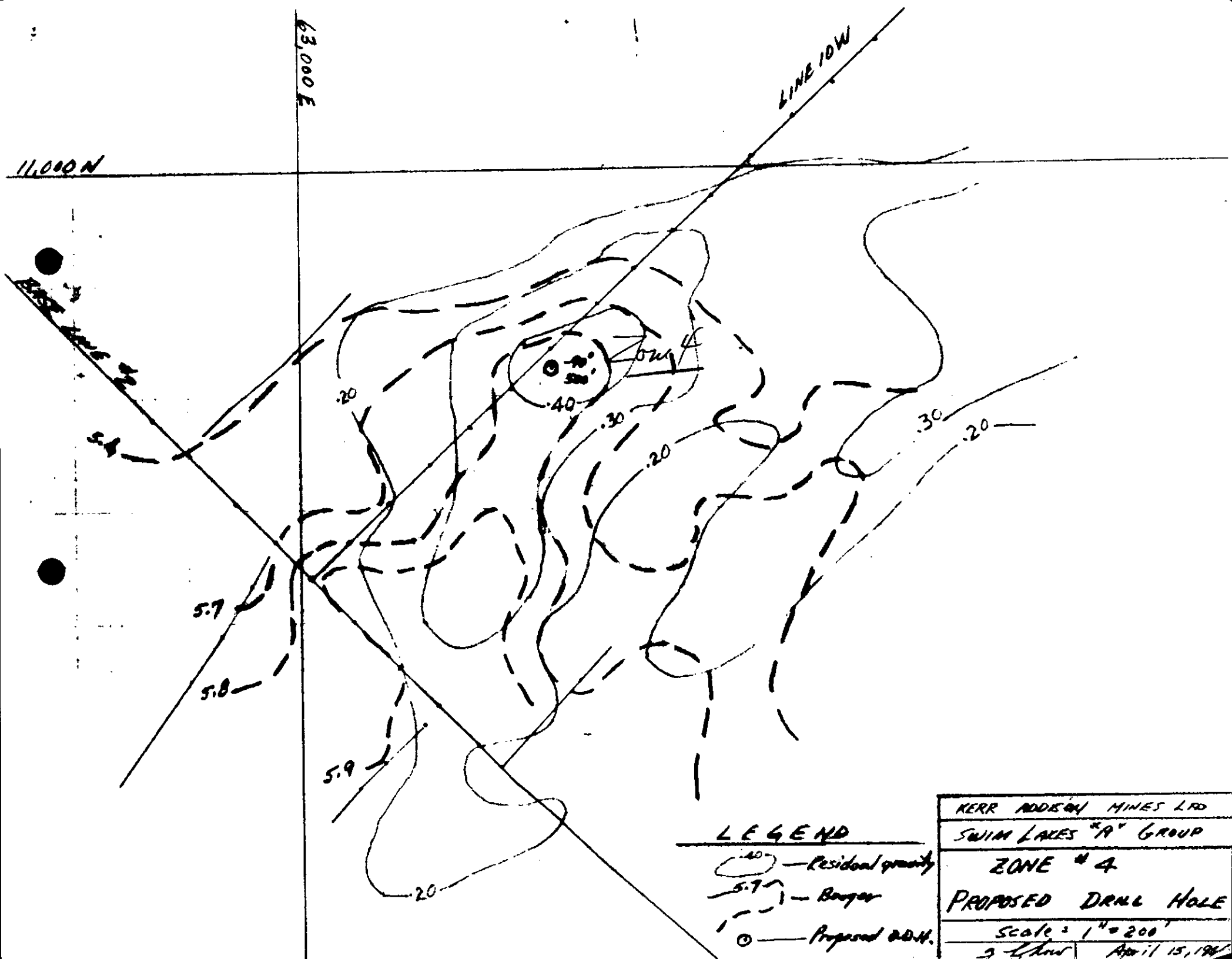

11,000 N

63,000 E

LINE 10W

40
Proposed D.H.

20

40

30

20

30

20



5.7

5.8

5.9

20

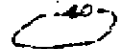
LEGEND

-  - Residual gravity
-  - Boundary
-  - Proposed D.H.

KERR ADDISON MINES LTD	
SWIM LAKES "A" GROUP	
ZONE # 4	
PROPOSED DRILL HOLE	
Scale = 1" = 200'	
3 - L.H.W.	April 15, 1941

