

015935

JEAN MINERAL  
CLAIMS

1970

105 K 5

*1 Grav. Thewence*



GRAZ

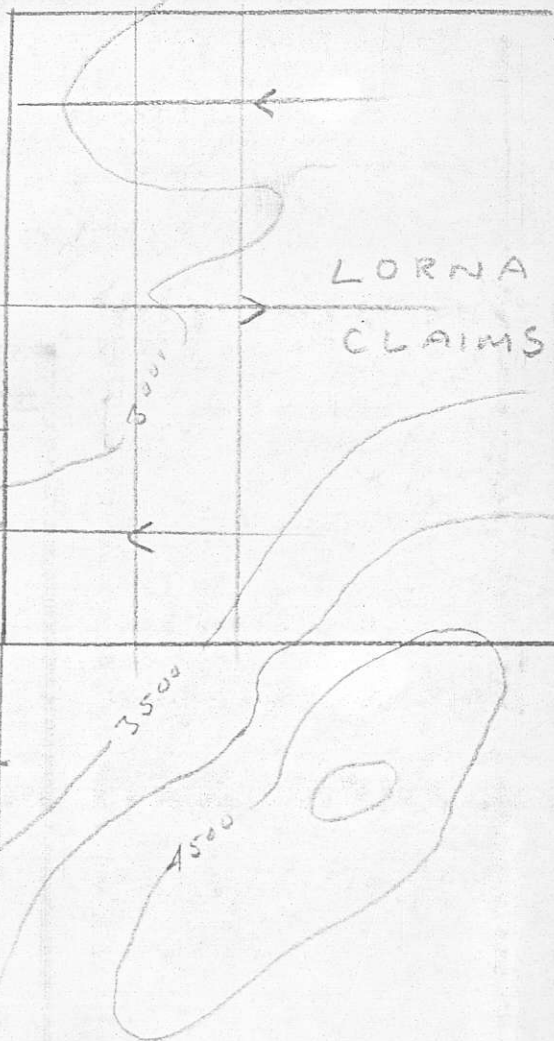
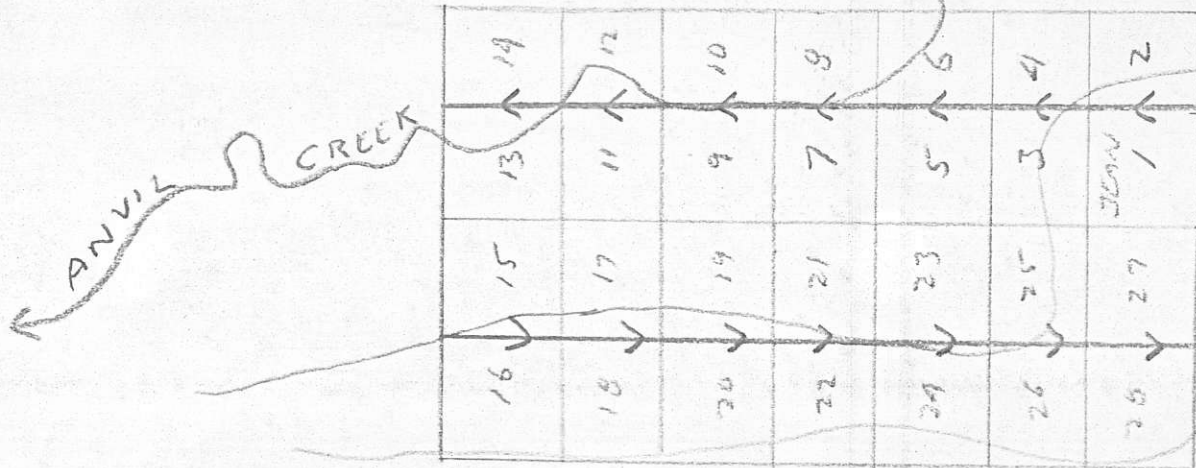

JEAN CLAIMS  
105 K 5

1/2 MILE - 1 INCH

JSB 9/12/70

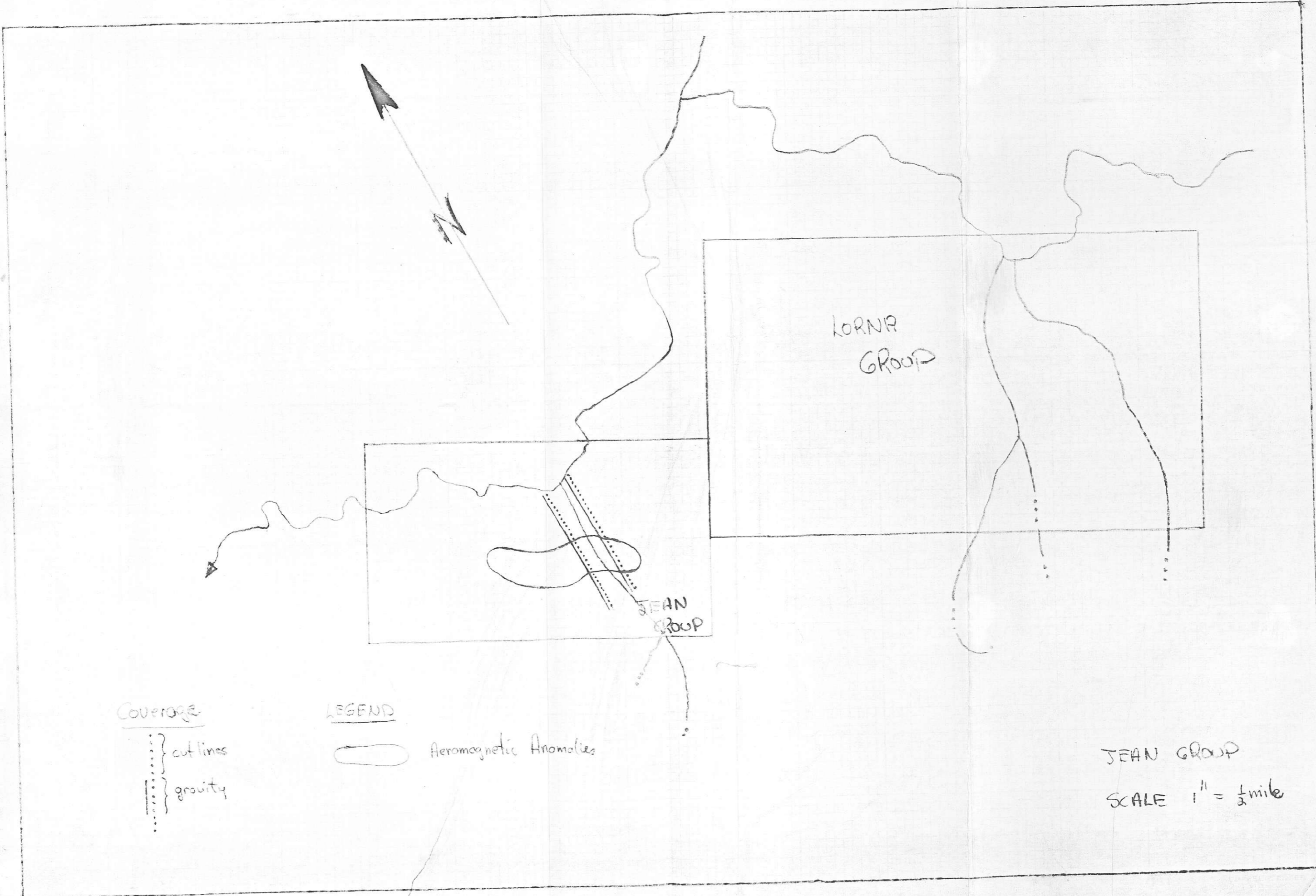

LORNA  
GROUP

JEAN  
GROUP

Coverage  
} cut lines  
} gravity

LEGEND  
○ Aeromagnetic Anomalies

JEAN GROUP  
SCALE 1" = 1/2 mile

BASE LINE

30° 25 20 15 10 5 0

665.00

664.00

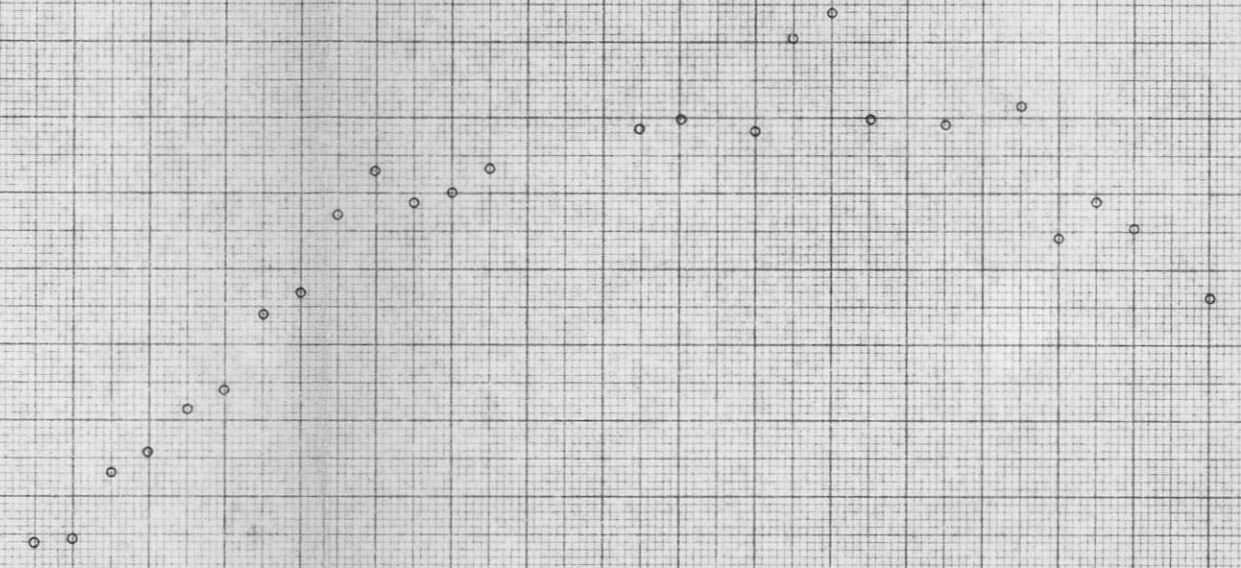

K&E 10 X 10 TO THE CENTIMETER 47 1512  
MADE IN U.S.A.  
RUFFEL & ESSER CO.

ATLAS - JEAN

JEAN CLAIMS

The total expenditures on the Jean Claims was \$260.00. This includes one day of work for the Overland Gravity Crew plus the prorated portion of the total expenses that are applicable to the Jean work.

BOUGUER MAP

The Jean work is represented by a single line and the Bouguer Map has very little meaning except to express the intensity of that line. We can see no evidence of any residual anomalies which could be equated to a sulphide bearing body. All that we present on this project is a Bouguer Map and Elevation Map.

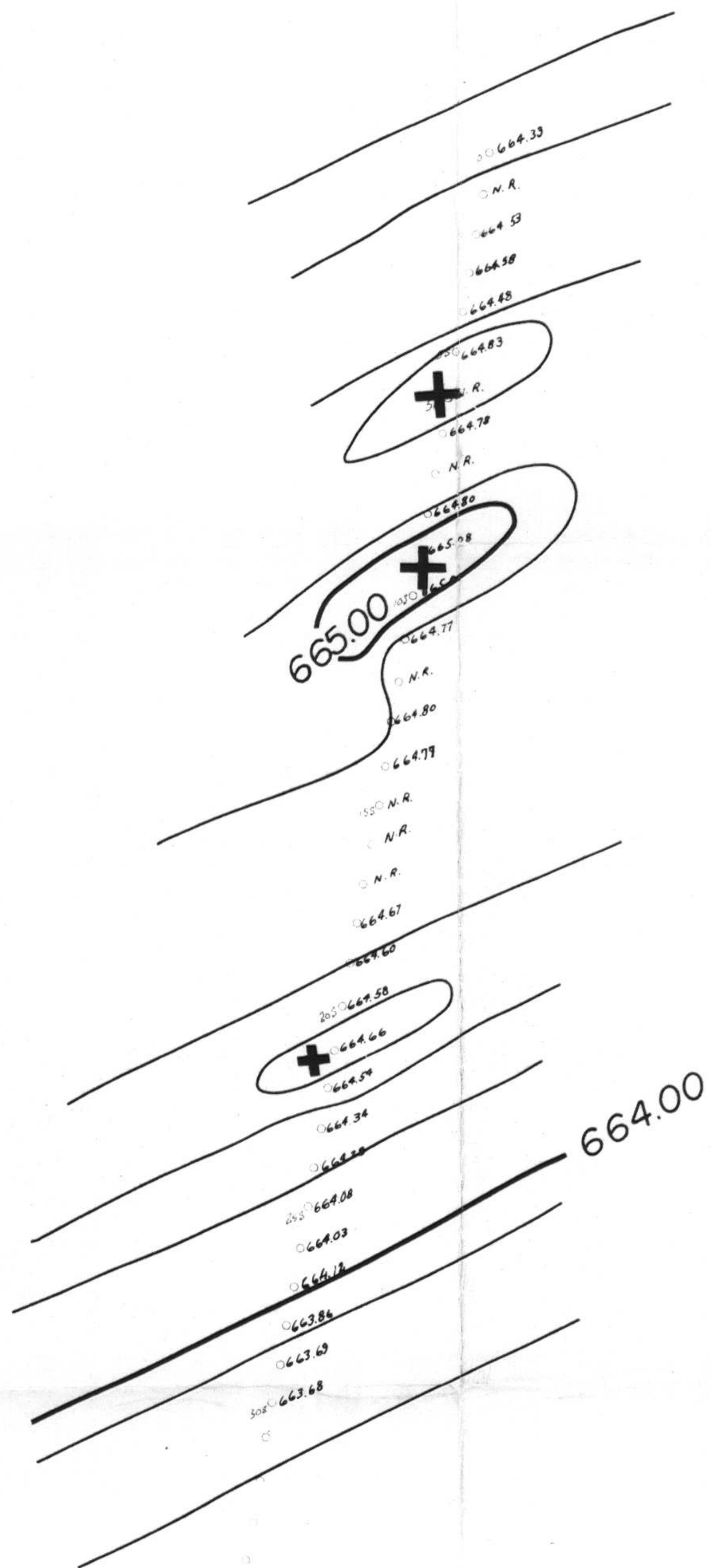

OVERLAND  
EXPLORATION SERVICES (1969) LTD.

FOR  
ATLAS EXPLORATIONS LIMITED

JEAN CLAIM BLOCK

BOUGUER GRAVITY MAP

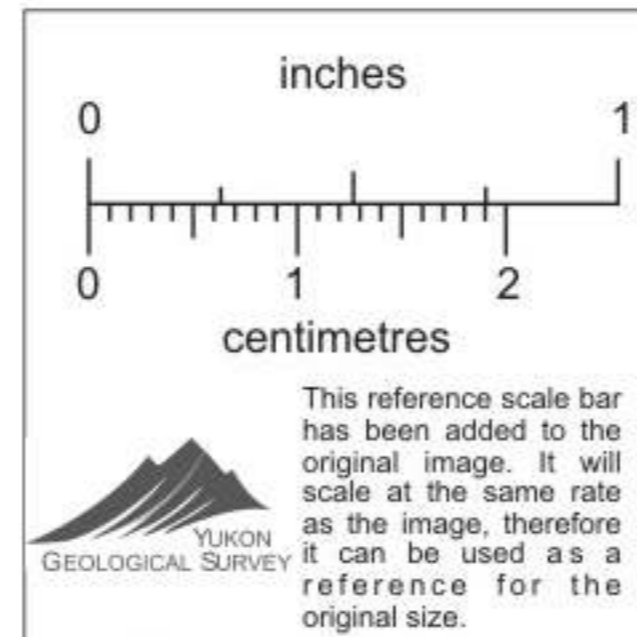

Scale 1" = 400'

C1 020 mgl.

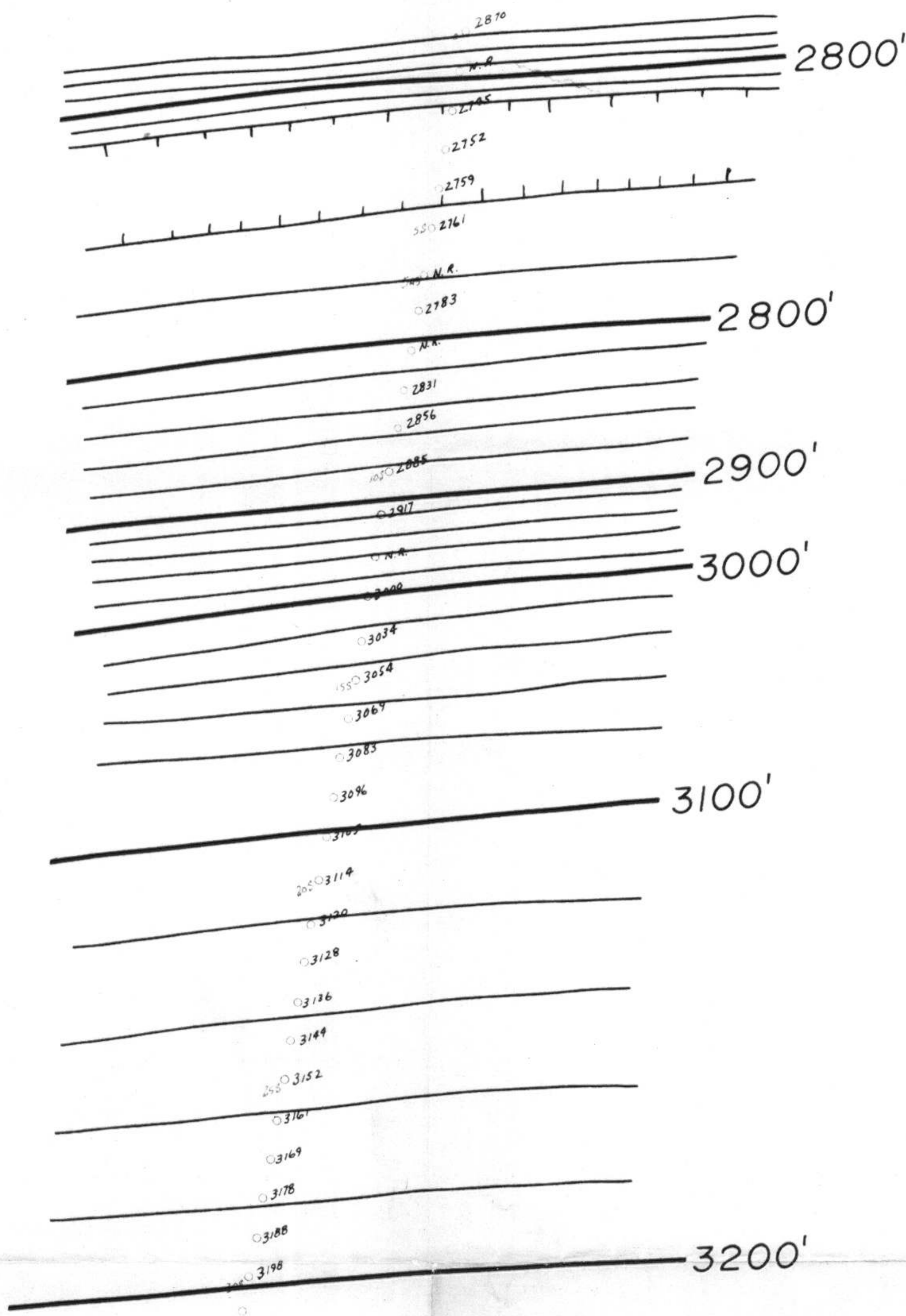

OVERLAND  
EXPLORATION SERVICES (1969) LTD.

FOR  
ATLAS EXPLORATIONS LIMITED  
JEAN CLAIM BLOCK  
**SURFACE ELEVATION MAP**  
Scale 1" = 400' C 20'

