

016090

NOV 9 1966

KERR ADDISON MINES LIMITED

(FOR INTER-OFFICE USE ONLY)

of 4/5-7

To Mr. P. M. Kavanagh From W. M. Sirola

Subject Swim Lakes "A" Group - Soil Sampling Date November 7, 1966

W.S.R.
K.C.G.
J.H.S.
E.F.
R.D.S.
B.C.B.
P.M.K. ✓
G.W.M.
R.O.M.
C.K.W.
J.B.S.
G.P.R.
K.F.L.
I.B.
E.C.J.

The enclosed map shows all of the soil sampling done on the "A" Group by our own people and by J. A. C. Fortesque of the G.S.C. All of the samples have been treated with hot acids so that analysis techniques are basically the same.

The most persistent high zinc values were obtained at the north end of line 65W where that line extends beyond BL-1. For the moment, my interpretation of this anomalous situation is that there is a hydromorphic fan resulting from transportation of zinc from the mineralized zone downhill. Quite possibly, there was some seepage at that point on the hillside, but I do not know this for certain. Fortesque's notations would suggest that all of the ground in that area is frozen. Be that as it may, I think that were we to run lines, say, 400 feet on either side of line 65W, we would probably again obtain anomalous values. Obviously there is no mineralization underlying the anomaly since it is shown as a gravity low on the Bouger map. The gravity low I interpret as deeper overburden. Probably the bedrock depression at that point provided a catch-basin for the zinc being carried downward by ground waters.

There are other scattered anomalous values on the map, the most pertinent of these (apart from the float area on claim number 18) are on line 1E between BL-1 and BL-2. Again, these could not be very meaningful in the absence of gravity anomalies.

I think that we should do sufficient additional geochemistry to indicate that the anomalies at the north end of line 65W are what I think they are. This would mean that some lead-zinc deposits in the Yukon do have distinct geochemical anomalies of one form or another. Once this has been demonstrated it would then suggest to me that we should do a systematic geochemical survey of the remainder of the claim group. This could be followed by gravity surveys of any persistently anomalous areas thus located.

*Discussed this with Sirola
in Vancouver on Dec 8/66.
Mak
Dec 13/66*

W. M. Sirola
W. M. Sirola.

WMS/lk

Encl. - Soil Sampling Plan,
Scale - 1" = 400 feet.

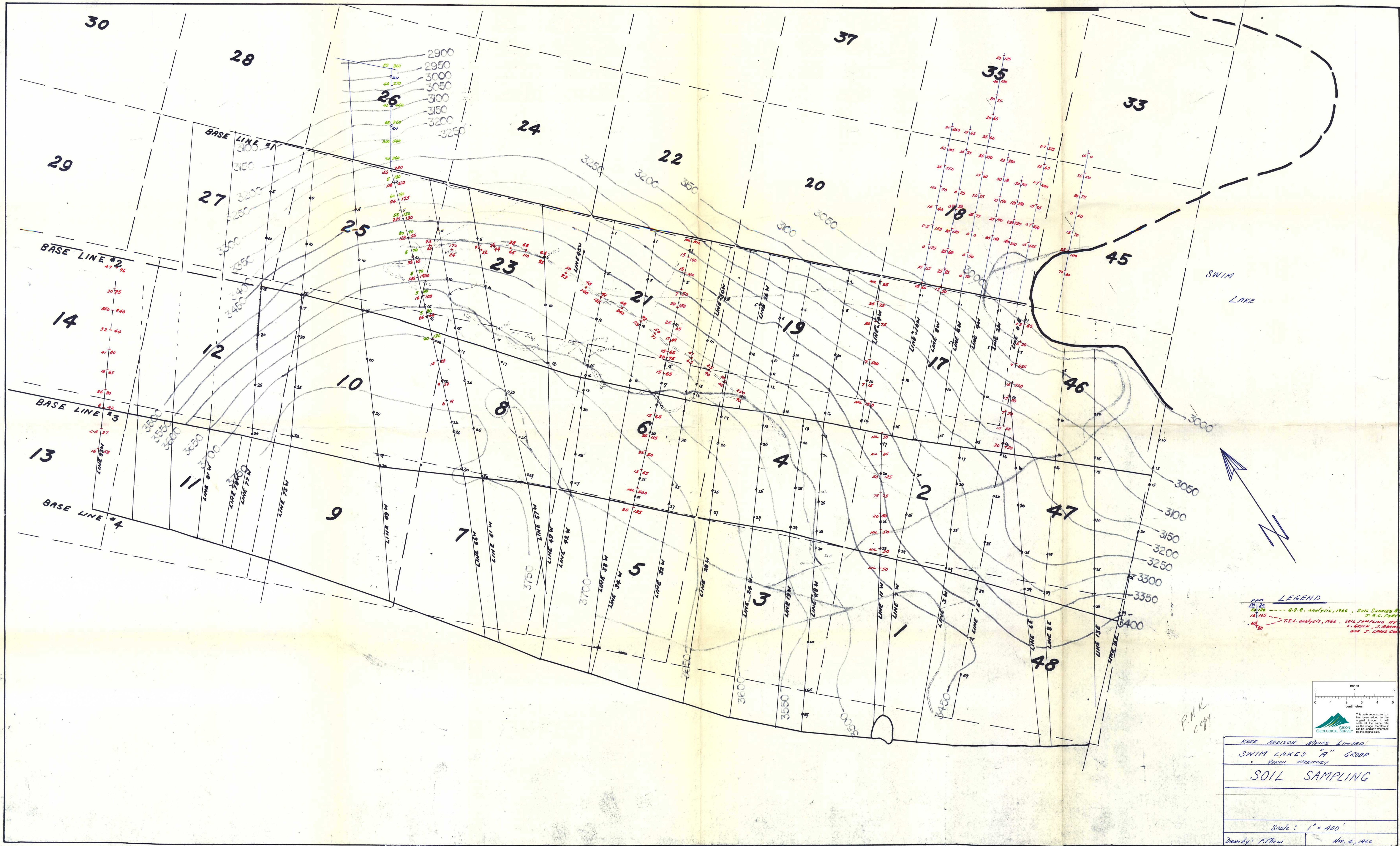

LEGEND

20 25 30 35 40 45 50 55 60 65 70 75 80 85 90 95 100
 --- G.C. analysis, 1966. SOIL SAMPLING BY J.A.C. FORTIN
 --- T.S.L. analysis, 1966. SOIL SAMPLING BY C. BROWN, J. ROBINSON, and J. LEWIS CORRY

P.M.K.
1971

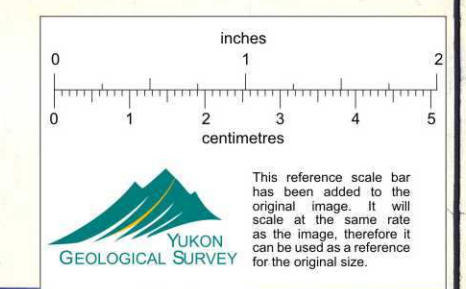

KEBE ADDISON MINES LIMITED	
SWIM LAKES "A" GROUP	
YUKON TERRITORY	
SOIL SAMPLING	
Scale: 1" = 400'	
Drawn by: F. Chou	Nov. 4, 1966