

**LOCKWOOD SURVEY CORPORATION LIMITED**

CONTRACT # G 3174  
FLIGHT # 19  
DATE FLOWN Sept 25/65  
AIRCRAFT MLL  
FLYING HEIGHT 200

PROFILES  
GULF MAGNETOMETER Mk III 4 /MINUTE  
SENSITIVITY 1200  
APN-1 RADIO ALTIMETER \_\_\_\_\_ /MINUTE  
SENSITIVITY \_\_\_\_\_

LINE No. 376-N

017212

**LOCKWOOD SURVEY CORP., LTD.**  
**ELECTROMAGNETOMETER PROFILES.**

Job No..... Flight No.....  
Date Flown..... Aircraft..... Line No.....  
Sensitivity, In Phase..... Out of Phase.....  
Flying Height..... Bird Height.....  
Tape Speed.....

2250  
**LOCKWOOD SURVEY CORP., LTD.**  
2250

**ELECTROMAGNETOMETER PROFILES.**  
2000

Job No. *J-3174* Flight No. *19*

Date *Sept 25/55* Aircraft *MIL* Line No. *50-376-N*

Sensitivity In Phase *100% P.F.S.* Out of Phase *0.4% P.F.S.*

Flying Height *200'* Bird Height *150'*

Tape Speed *3" PM*

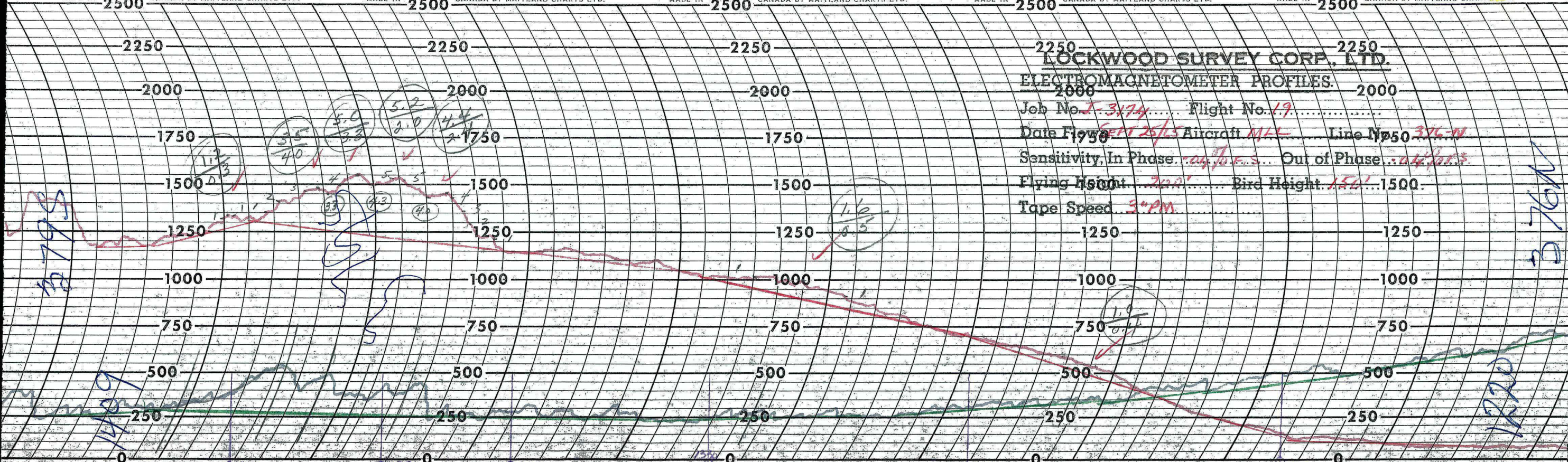

*379*

*6041*

*376-N*

*6041*

No. 43232

No. 43232

No. 43232

No. 43232

No. 43232

*1347*

*1358*

*1294*

*1150*

G 3174 - FLT #19

Sept 25/65

MLL

376-N

JE

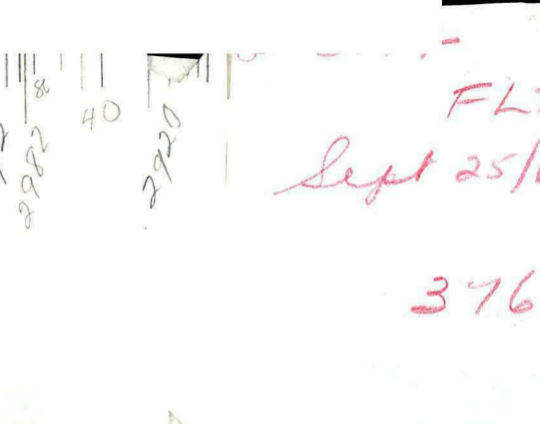
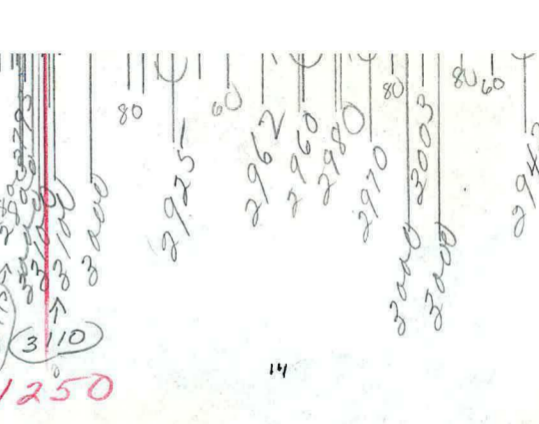
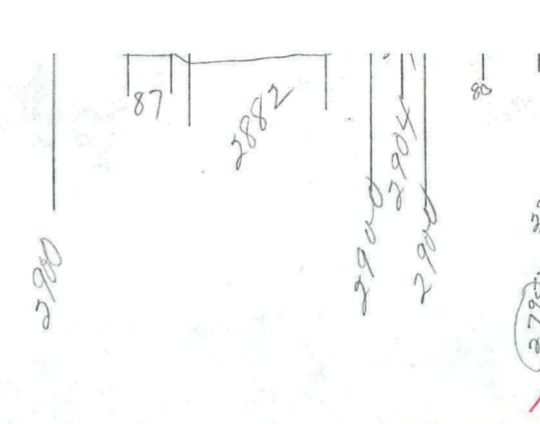
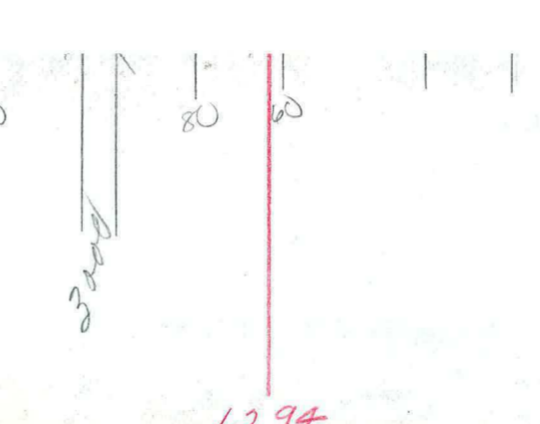
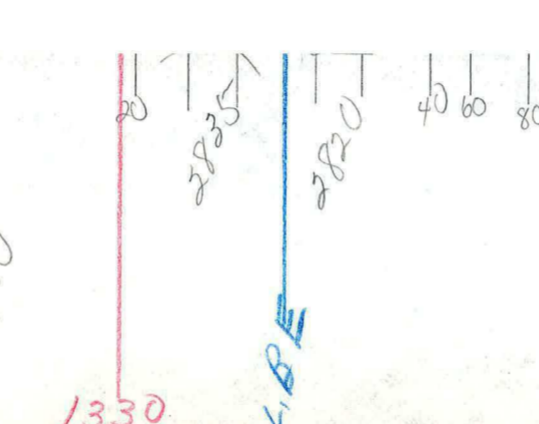
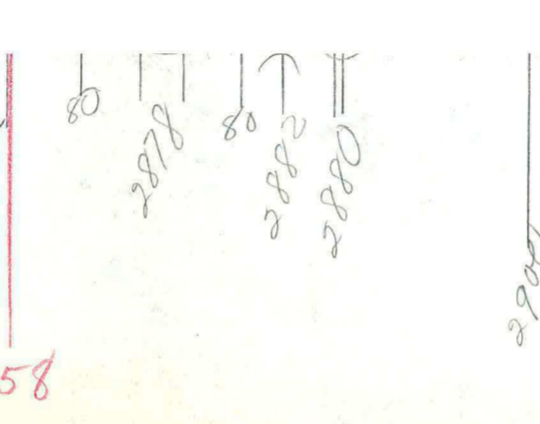
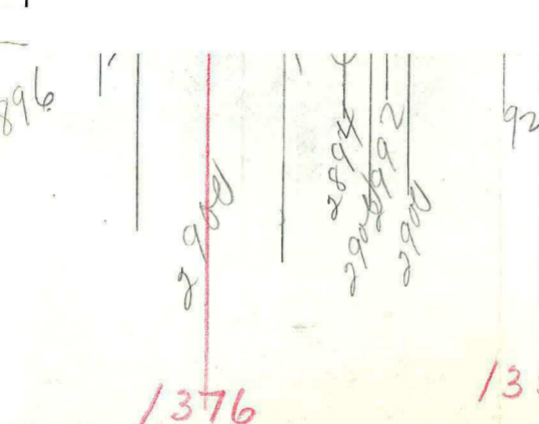
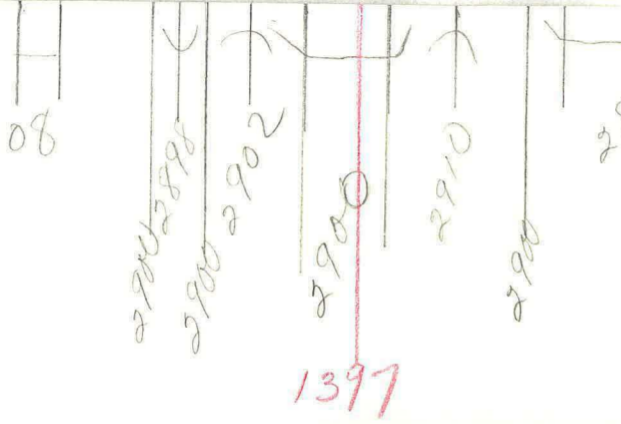

MLL

FLT #19

Sept 25/65

376-N

JE

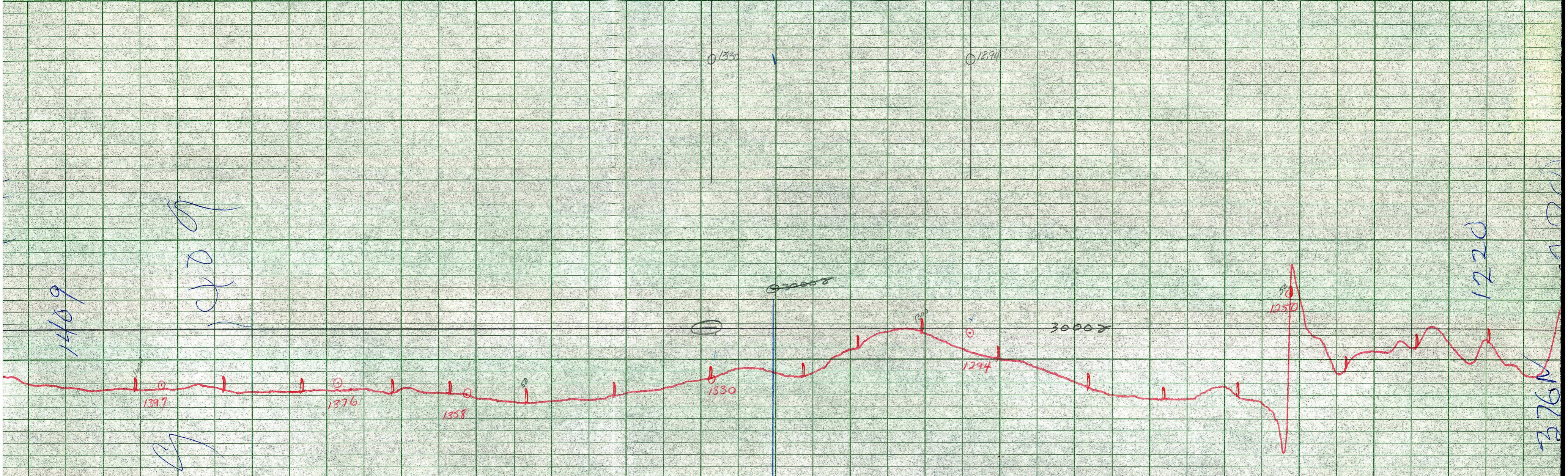

LOCKWOOD SURVEY CORP., LTD.  
 GULF MK 111 AIRBORNE MAGNETOMETER PROFILE  
 Job No. 6-3174 Flight No. 17  
 Date Flown SEPT. 25/66 Aircraft M11 Line No. 376-N  
 Sensitivity Full Scale 1200γ Steps 100γ  
 Height Flown 400' Tape Speed 6" PM