

KERR ADDISON MINES LIMITED

(FOR INTER-OFFICE USE ONLY)

018013

48 y/7

W.S.R.
K.C.G.
J.H.S.
E.F.
R.D.S.
P.C.P.
P.M.K. ✓
S.W.M.
R.G.M.
C.K.W.
J.B.S.
G.P.R.
K.F.L.
J.I.B.
E.C.J.

To: W. M. Sirola From: Paul M. Kavanagh

Subject: Swim Lakes BC Group, Yukon Date: January 4th, 1966

This is prompted by your December 30th memorandum referring to your proposed additional gravity coverage on this group this year. By the way, please try to remember to call this group our BC Group (after the original B and C aeromagnetic anomalies it contains) rather than the BS Group (the name given to the claims). Similarly, we want to refer to our small group as the D Group rather than the JB Group.

Attached are copies of United Geophysical's final Bouguer and Surface Elevation maps just in case you don't have them. The Bouguer map is a little more finished than the preliminary one they gave us, a copy of which you sent with your memorandum.

Also attached is an extra copy of a soil sampling map we have. It shows that lines 28W and 32W are probably already cut, whereas there is probably no line 29W presently cut; you have shown a line 29W on your attached copy of the preliminary Bouguer map.

Until I have prepared my overall budget in the next week or so and have had it approved or modified I am not able to advise you whether or not your budget in its entirety is approved or not. The following remarks on your proposed gravity survey are therefore by way of commentary. Although I suppose that \$2,000 worth of extra gravity work on this property is a safe extra check to make - considering the developing state of the area - I must say that I think our past work makes it unlikely that we have missed anything in the part of the property you want to gravity survey. In addition to the negative E-M response to which you refer, we also obtained a negative ground magnetic response, and only a few weak local positive results from our S.P. survey, and our rubenium-method soil survey. In addition, it would appear that the C aeromagnetic anomaly which prompted us to stake the southeast part of this claim group in the first place is located in the south part of the group where we obtained positive responses from ground magnetic, E-M and S.P. surveys, which as you suggest may simply be representing a belt of magnetic graphitic schist. I would suggest that in this area, perhaps what associated mineralization there is lies along the south of the belt in the locale where Dynasty found low grade mineralization in their Sea Group drilling a year or so ago.

Now that we have a good debate going - like the geologists that we are - I will give you a chance at rebuttal by asking you to let me have your reasons for the proposed gravity work on the D Group. Being first speaker on the affirmative you are entitled to a four-minute rebuttal.

*Paul M. Kavanagh*  
Paul M. Kavanagh  
Chief Geologist - Exploration

# KERR-ADDISON GOLD MINES LIMITED

(FOR INTER-OFFICE USE ONLY)

To..... P.M. KAVANAGH. .... From..... W.M. SIROLA. ....  
Subject..... "BS" CLAIM GROUP, SWIM LAKES, Y.T. .... Date..... December 30th, 1965. ....

The accompanying map indicates the proposed additional gravity coverage on the "BS" group.

From the self-potential and E.M. work already completed, it is obvious that a broad graphitic schist belt occurs on the BS 20, 22 and 24 M.C.'s, and it may also overlap to BS 23.

From our experience on the "A" group, the area immediately bordering this graphitic belt on the north is prime exploration country. I say this despite the fact that the E.M. readings to the north of the graphitic belt do not suggest any mineralization. As you know, it would be very difficult to determine the location of the "A" group sulphide masses from the E.M. results.

Prior gravity work extended only to Base Line 15 N., but we have no coverage between that base line and Finger Lake.

I am aware that the fractions staked by Dynasty are still in good standing, but most of our work would be done to the north of these fractions, on our own ground.

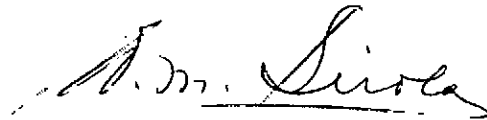

William M. Sirola.

WMS:iw  
Encls:

FINGER LAKE

B.S. GROUP . Y.T.

GRAVITY SURVEY.  
BOUGUER ANOMALY SKETCH MAP.

FOR  
KERR ADDISON MINES  
BY  
UNITED GEOPHYSICAL CO. OF AMERICA.  
PARTY 588  
T. RICH.  
SEPT. 1964.

4W — PROPOSED  
1966 GRAVITY SURVEY  
8 LINES (4W - 29W)  
TOTAL 11,440 FT.

SCALE 1 INCH = 400 FEET.  
CONTOUR INTERVAL 0.1 MILLIGALS. ALL VALUES RELATIVE  
GRAVITY SURVEY — B.S. GROUP  
LINE ENDS BY CLAIM BOUNDARY  
GRAVITY SURVEY — SEA GROUP

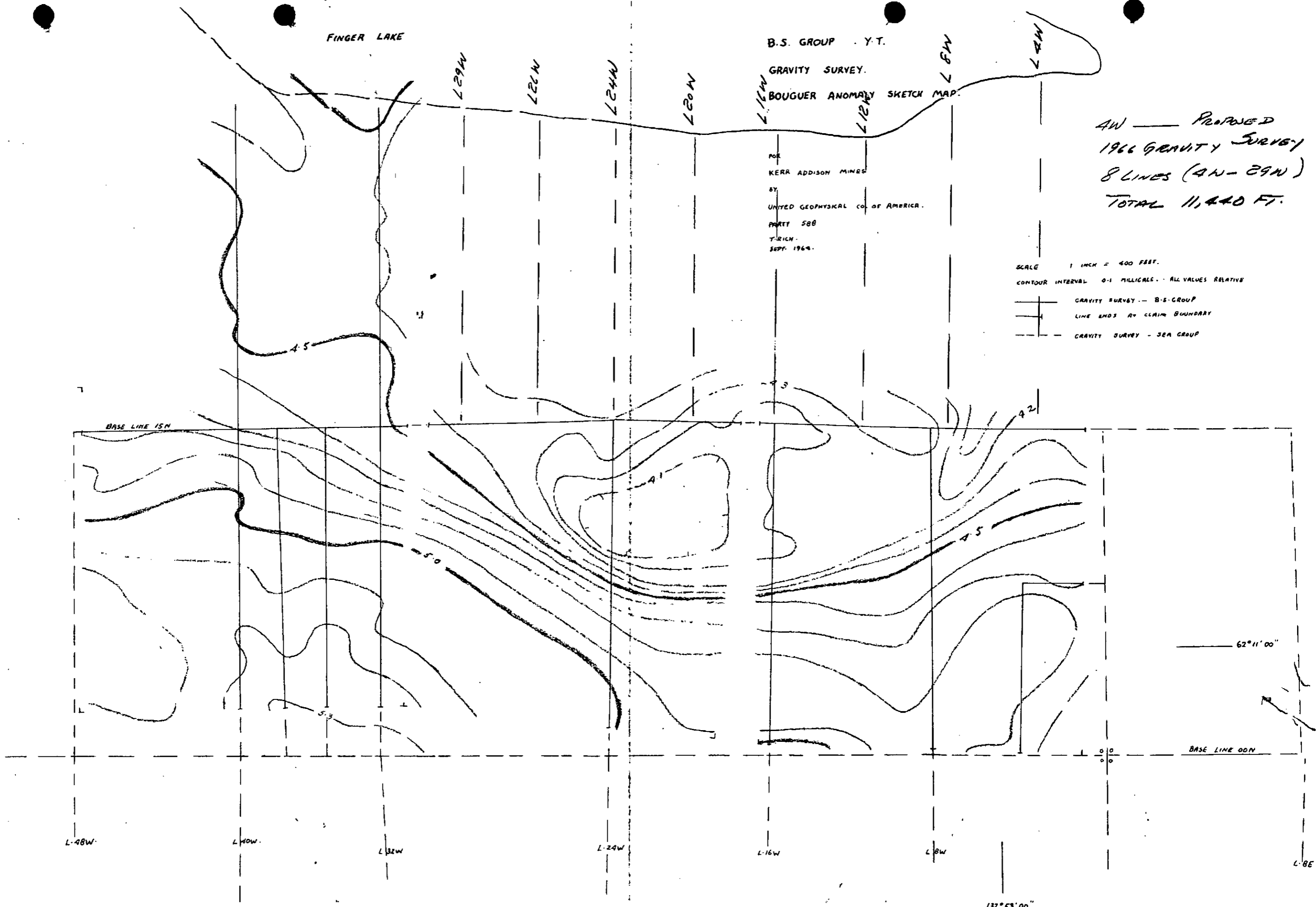

L-28W

L-27W

L-26W

L-24W

L-16W

L-8W

132° 53' 00"

L-8E

# KERR-ADDISON GOLD MINES LIMITED

(FOR INTER-OFFICE USE ONLY)

To P.M. KAVANAGH.

From W.M. SIROLA.

Subject SWIM LAKES "BC" GROUP, Y.T.

Date January 6th, 1966.

W.S.R.  
K.C.G.  
J.H.S.  
E.F.  
R.D.S.  
B.C.B.  
P.M.K. ✓  
G.W.M.  
R.O.M.  
C.K.W.  
J.B.S.  
G.P.R.  
K.F.L.  
J.L.B.  
E.C.J.

*This small 1966 gravity survey is budgeted for  
& will be carried out. M.K. Jan. 17/66*

I am always glad to debate any of the programmes which I advocate on any of our properties, and I will answer the points you raised in the sequence in which you raised them:

## E.M. Response:

I cannot find the E.M. response over the main ore zone at Swim Lakes. The ore zone appears to be in the hanging wall of the E.M. anomalies and appears to be caused by the graphitic schist. This situation could be equally true on the "BC" Group.

## Ground Magnetic Response:

This appears to be lacking, but I do not consider it safe to assume that every mineralized zone must have magnetite or pyrrhotite.

## S.P. Survey:

There is at least one definite S.P. anomaly occurring on lines 12 W. and 16 W., north of Base Line 15 N. A similar S.P. anomaly occurs over the main ore zone at Swim Lakes. It should be borne in mind that S.P. response is negligible if the thickness of overburden is 100 feet, or more.

## Soil Surveys:

According to McRae, the north slope of the hill is permafrost. In addition, the overburden is probably too deep for the method to work.

I am simply trying to utilize on the "BC" Group what we have learned on the "A" Group. Duncan Crone has suggested that satellite mineralized zones occur to the north of the main magnetic and electrical anomalies. Surely this possibility also exists on the "BC" Group.

# KERR-ADDISON GOLD MINES LIMITED

(FOR INTER-OFFICE USE ONLY)

To.....From.....

Subject.....Date.....

contd..

- 2 -

I feel that the high geochem results obtained on our south boundary simply indicate that a mineralized zone came close to surface at that point. However, this zone was in the footwall of a broad graphitic schist band which occurs on our claims, and I feel that we should be seeking ore in the hanging wall. Apart from all this, I want to be very sure that nothing is being overlooked on our established claim groups.



William M. Sirola.

WMS:iw.

KERR ADDISON MINES LIMITED

(FOR INTER-OFFICE USE ONLY)

ops  
Y/EF  
7  
New file ✓  
✓

To.....W. M. Sirola.....From.....P. M. Kavanagh.....

Subject.....Proposed Gravity Survey, Swim Lakes BC Group, Date February 3rd, 1966.  
Yukon.

With reference to your memorandum on this subject dated January 27th, this is just to confirm my telephone conversation with you this morning in which I advised that because Duncan Crone, after reviewing your memorandum and the attached letter of Dr. Brant's, still very definitely considers that a gravity survey on the lake would have little chance of being executed successfully, I have decided not to approve such a survey.

This decision is based on the best judgement I could muster and I appreciate your acceptance of it in our conversation this morning.

Paul M. Kavanagh  
Chief Geologist - Exploration.

PMK:sw



NEWMONT EXPLORATION LIMITED  
44 BRIAR RIDGE ROAD  
DANBURY, CONNECTICUT 06811

GEOPHYSICAL DEPARTMENT

January 24, 1966

RECEIVED  
JAN 26 1966

KERR ADDISON GOLD MINES LTD.

Mr. William M. Sirola  
Kerr Addison Mines Limited  
Suite 405, 1112 West Pender Street  
Vancouver 1, B. C., Canada

Dear Mr. Sirola:

I have your letter of January 18, 1966.

This is so long ago that my memory is hazy. It seems to me we tried torsion balance work at Steep Rock Lake, for gravity meters were not then available. Torsion balances are just too susceptible to the wave action under the ice, but there should be no trouble with a modern gravity meter.

I only suggest that you make some computations as to the size of the anomaly you might expect. You may find it very difficult to detect a 10 foot vein under 40 or 50 feet of cover. Also it is good practice to extend your line considerably in either direction to determine your background effects.

Just casually I wonder if you are the Sirola I knew at Little Long Lac many years ago?

Sincerely yours,

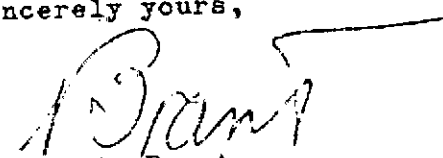
  
Arthur A. Brant

AAB/lu