

62° 11' 30"

FINGER LAKE

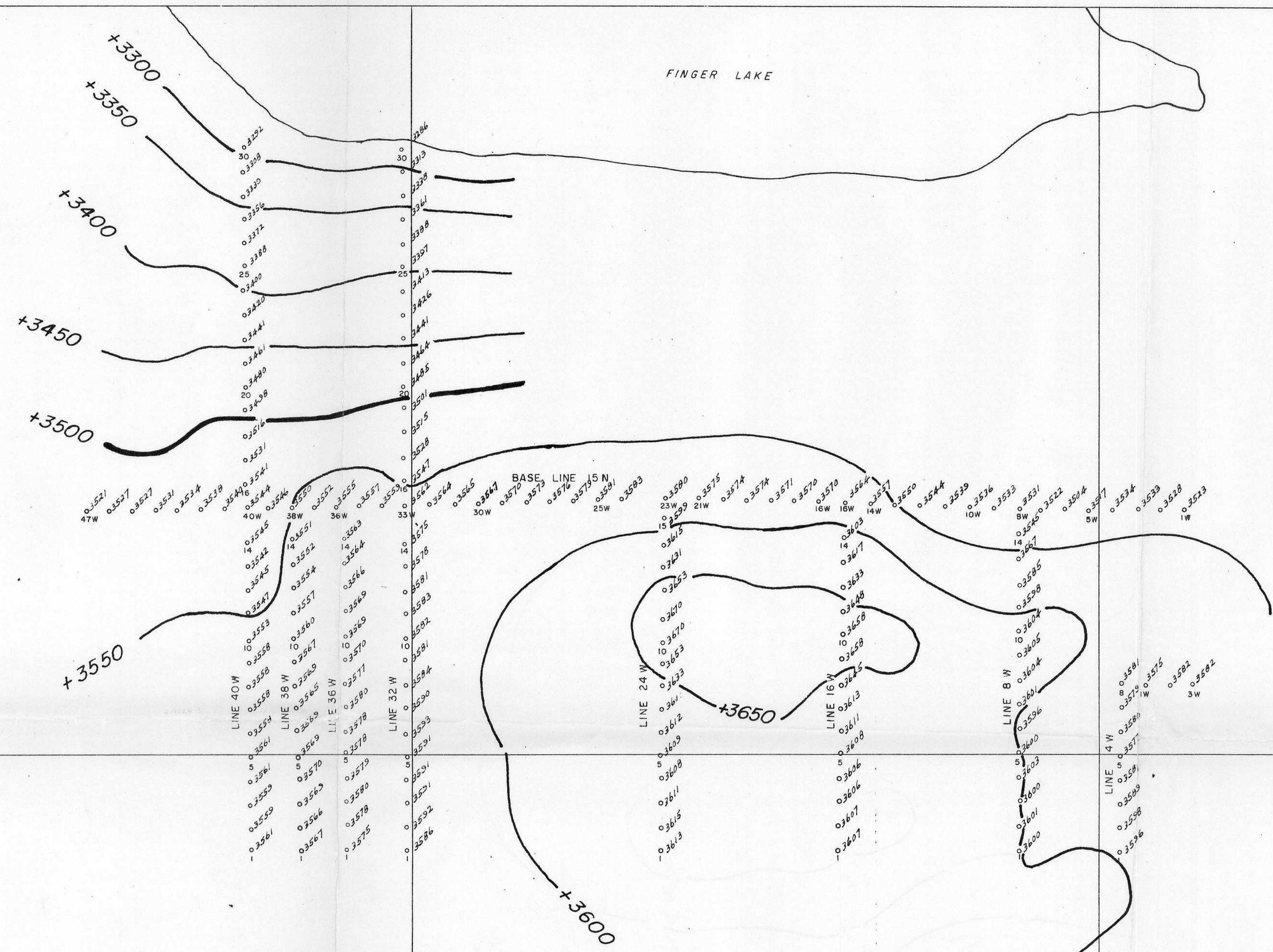

62° 11'

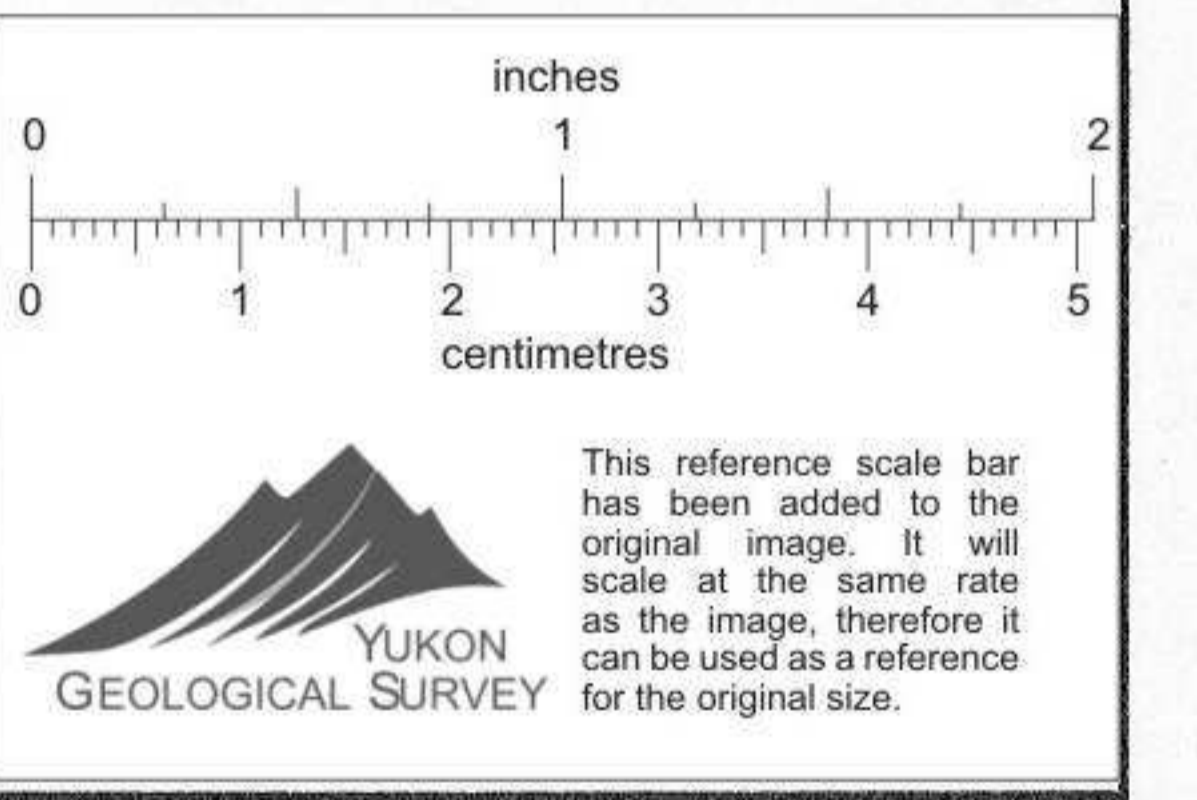

KERR ADDISON MINES LIMITED

B. S. GROUP PROJECT
 YUKON TERRITORY
(C Anomaly, (BC Group))
SURFACE ELEVATION

UNITED GEOPHYSICAL CO. OF AMERICA
PARTY 588

Contour Interval 50 FT. Interpretation by A. RICH
 Scale 1 Inch = 400 ft. Approved by R.B. GALESKI

Date SEPT. 1964

018228