

13	14	29	30	45	46	57	58
11	12	27	28	43	44	55	56
9	10	25	26	41	42	53	54
7	8	23	24	39	40	51	52
5	6	21	22	37	38	47	50
3	4	19	20	35	36		
1	2	17	18	33	34		

not staked

staking due North.

Claim group name: KNEIL

Claims	1 → 8	Jim Mackensen
	9 → 16	Gregg Jilson
	17 → 24	Cathy Sulley
	25 → 32	Linda Johnson
	33 → 40	Hogie
	41 → 48	Nigel
	49 → 56	Deck
	57 → 60	Mike

A24796-67

018652

13	14	29	30	45	46	57	58
11	12	27	28	43	44	55	56
9	10	25	26	41	42	53	54
7	8	23	24	39	40	51	52
5	6	21	22	37	38	49	50
3	4	19	20	35	36		
1	2	17	18	33	34		

not staked

staking due North.

Claim group name: KNEIL

Claims	1 → 8	Jim Markesan
	9 → 16	Gregg Jilson
	17 → 24	Estoy Sullky
	25 → 32	Linda Johnson
	33 → 40	Hogie
	41 → 48	Nigel
	49 → 56	Dick
	57 → 60	Mike

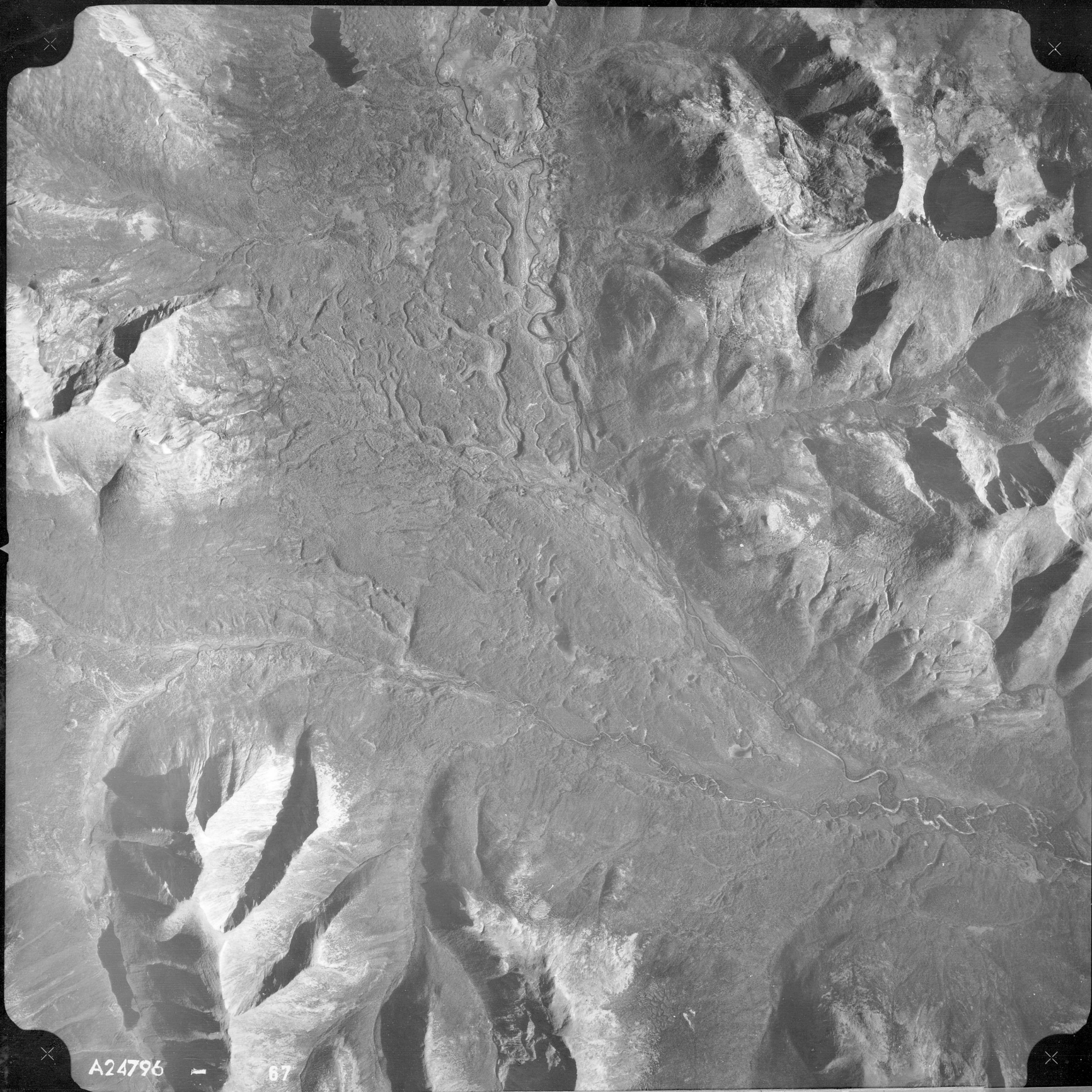

A24796

67

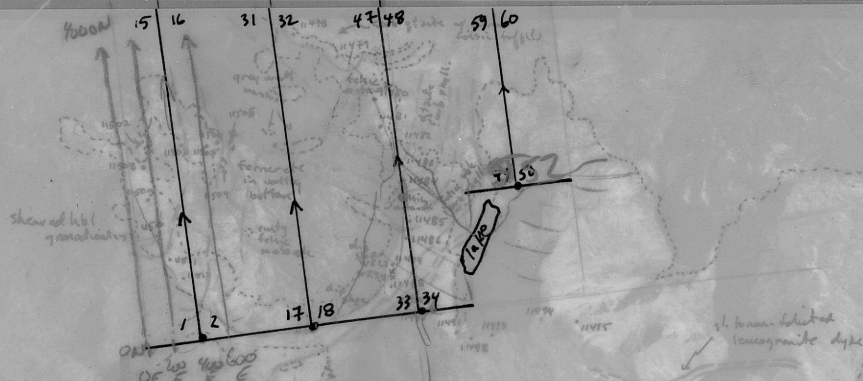

staking due North
 Claims group name: KNEIL

Claims	1-8	Jim Markensan
	9-16	Gregg Jilson
	17-24	Cathy Suley
	25-32	Linda Johnson
	33-40	Hogie
	41-48	Nigal
	49-56	Dick
	57-60	Mike

Post 1
 Post 2
 K. 1

K4 -
 2
 K2

Post 1
 KNEIL
 staking N
 1500' N
 1500' W

450 m.

claim length

JKM - forward
 June 21/81 also June 23, 24, 27
 A 2474796-68 1:50,000



JRM traverse
 June 21/81 also June 23, 24, 27
 A 24796-68 ~1:50,000

A24796 - 68

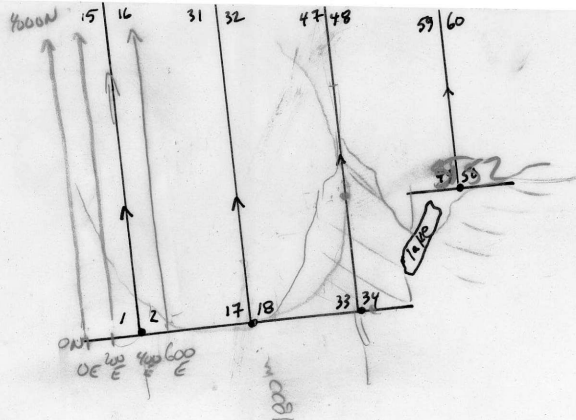

staking due North
 Claims group name: KNEIL

Claims	1-8	Jim Mortensen
	9-16	Gregg Wilson
	17-24	Cathy Suley Suley
	25-32	Linda Johnson
	33-40	Hogie
	41-48	Nigel
	49-56	Derek
	57-60	Mike

Post 1
 Post 2
 K. 1

K4 -
 2
 L2

Post 1
 KNEIL
 staking N
 1500' N
 1500' W

450 m.

claim length

A24796-68

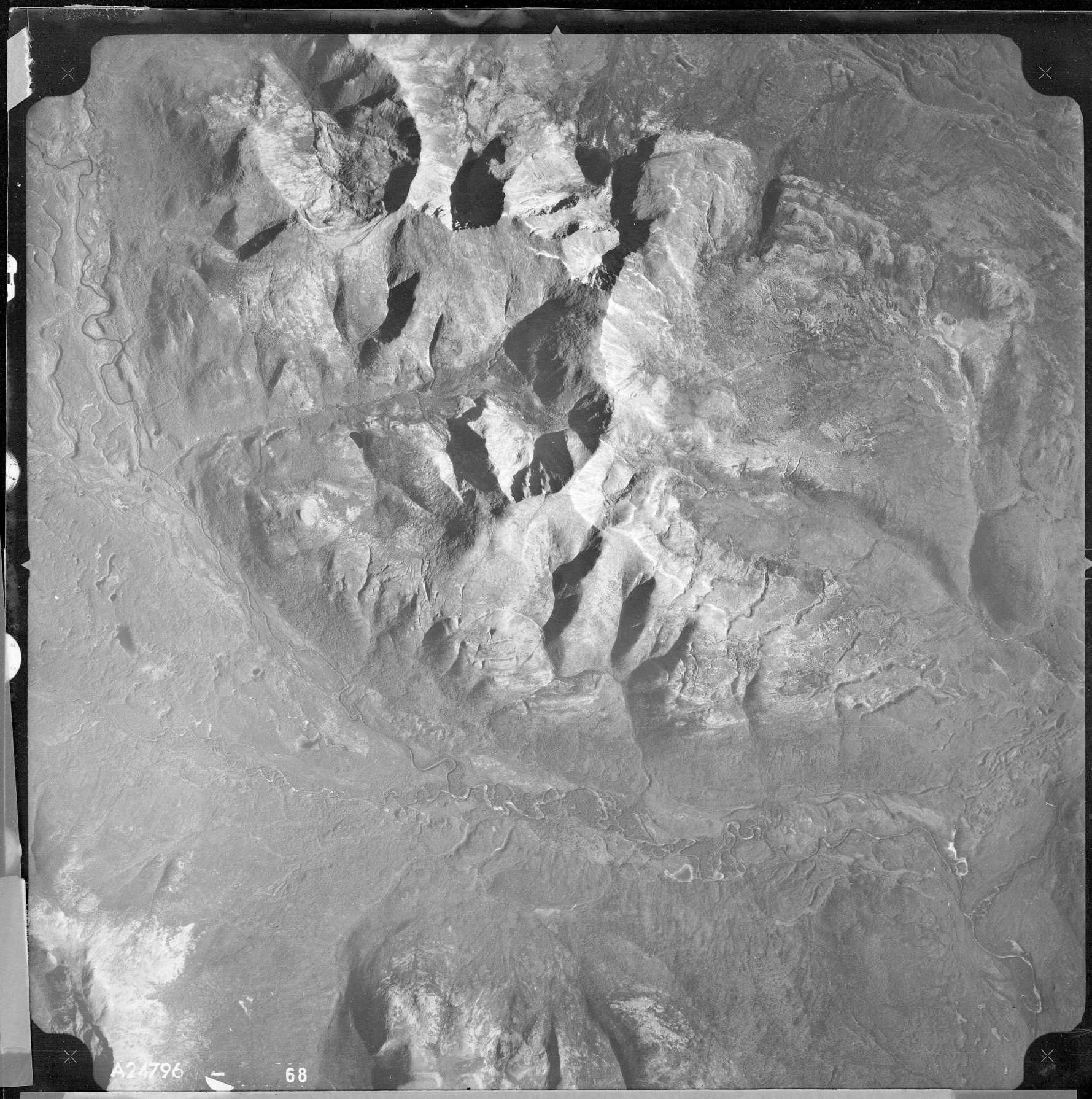

A24796

68