

GRUM JOINT VENTURE

019107

SAMPLE NO. A

Date Oct / 75

LOCATION

SKETCH

Dist. from Sta.

Length of Sample

Type

Description Chip

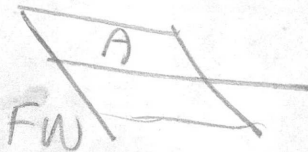

ASSAYED FOR

Pb Zn Ag

Taken by: [Signature]

GRUM JOINT VENTURE

SAMPLE NO. _____

ASSAY FOR

Pb Zn Ag

<input type="checkbox"/>	<input type="checkbox"/>	<input type="checkbox"/>	<input type="checkbox"/>	<input type="checkbox"/>
--------------------------	--------------------------	--------------------------	--------------------------	--------------------------

GRUM JOINT VENTURE

SAMPLE NO. B

Date Oct 10/75

LOCATION

SKETCH

Dist. from Sta.
Length of Sample
Type
Description <u>Chip</u>

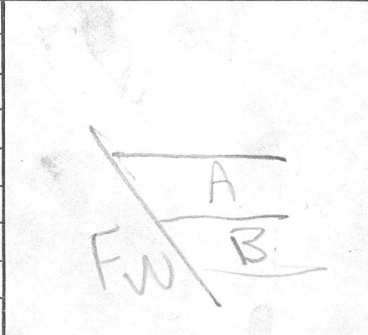

ASSAYED FOR	Pb	Zn	Ag				
Taken by: <u>[Signature]</u>							

GRUM JOINT VENTURE

SAMPLE NO. _____

ASSAY FOR	Pb	Zn	Ag				

GRUM JOINT VENTURE

SAMPLE NO. ^D.....

Date Oct 10/75.....

LOCATION

SKETCH

Dist. from Sta.

Length of Sample

Type Chip

Description

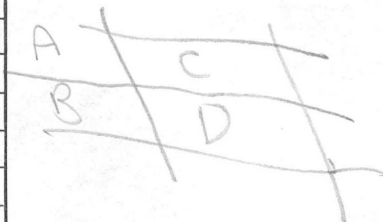

ASSAYED FOR

Pb Zn Ag

--	--	--	--

Taken by: [Signature]

GRUM JOINT VENTURE

SAMPLE NO.

ASSAY FOR

Pb Zn Ag

--	--	--	--

GRUM JOINT VENTURE

SAMPLE NO. _____

Date Oct 10/75

E

LOCATION

SKETCH

Dist. from Sta.

Length of Sample

Type

Description

Chip

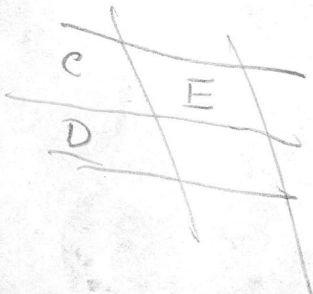

ASSAYED FOR

Pb Zn Ag

--	--	--	--

Taken by: 

GRUM JOINT VENTURE

SAMPLE NO. _____

ASSAY FOR

Pb Zn Ag

--	--	--	--

GRUM JOINT VENTURE

SAMPLE NO. F

Date Oct 10/75

LOCATION

SKETCH

Dist. from Sta.

Length of Sample

Type

Description Chip

F

ASSAYED FOR

Pb Zn Ag

<u>1</u>	<u>1</u>	<u>1</u>		
----------	----------	----------	--	--

Taken by: [Signature]

GRUM JOINT VENTURE

SAMPLE NO. _____

ASSAY FOR

Pb Zn Ag

--	--	--	--	--

GRUM JOINT VENTURE

G

SAMPLE NO.

Date Oct 10/75

LOCATION

SKETCH

Dist. from Sta.

Length of Sample

Type

Description Chip

.....

.....

.....

.....

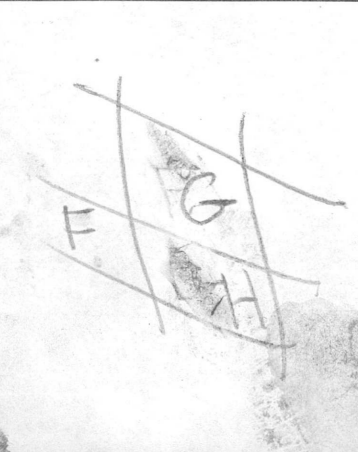

ASSAYED FOR

Pb Zn Ag

--	--	--	--	--

Taken by: [Signature]

GRUM JOINT VENTURE

SAMPLE NO.

ASSAY FOR

Pb Zn Ag

--	--	--	--	--

GRUM JOINT VENTURE

SAMPLE NO. H

Date Oct 10/75

LOCATION

SKETCH

Dist. from Sta.

Length of Sample

Type

Description

Chip

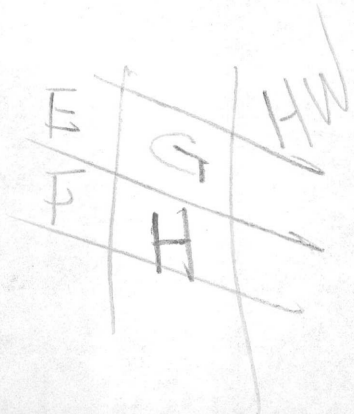

ASSAYED FOR

~~Pb~~ ~~Zn~~ ~~Ag~~

--	--	--	--	--

Taken by: *[Signature]*

GRUM JOINT VENTURE

SAMPLE NO. _____

ASSAY FOR

Pb Zn Ag

--	--	--	--	--

PANEL	ESTIMATED Pb+Zn	ASSAYED			MEAN		
		Pb	Zn	Ag	Pb	Zn	Ag
A	10						
B	10						
C	10						
D	10						
E	15						
F	15						
G	6						
H	6						

NOTE:

Duplicate samples of approx. 5lbs. of chips each, taken from each panel by means of chipping into a hand-held bag with a geologist's pick.

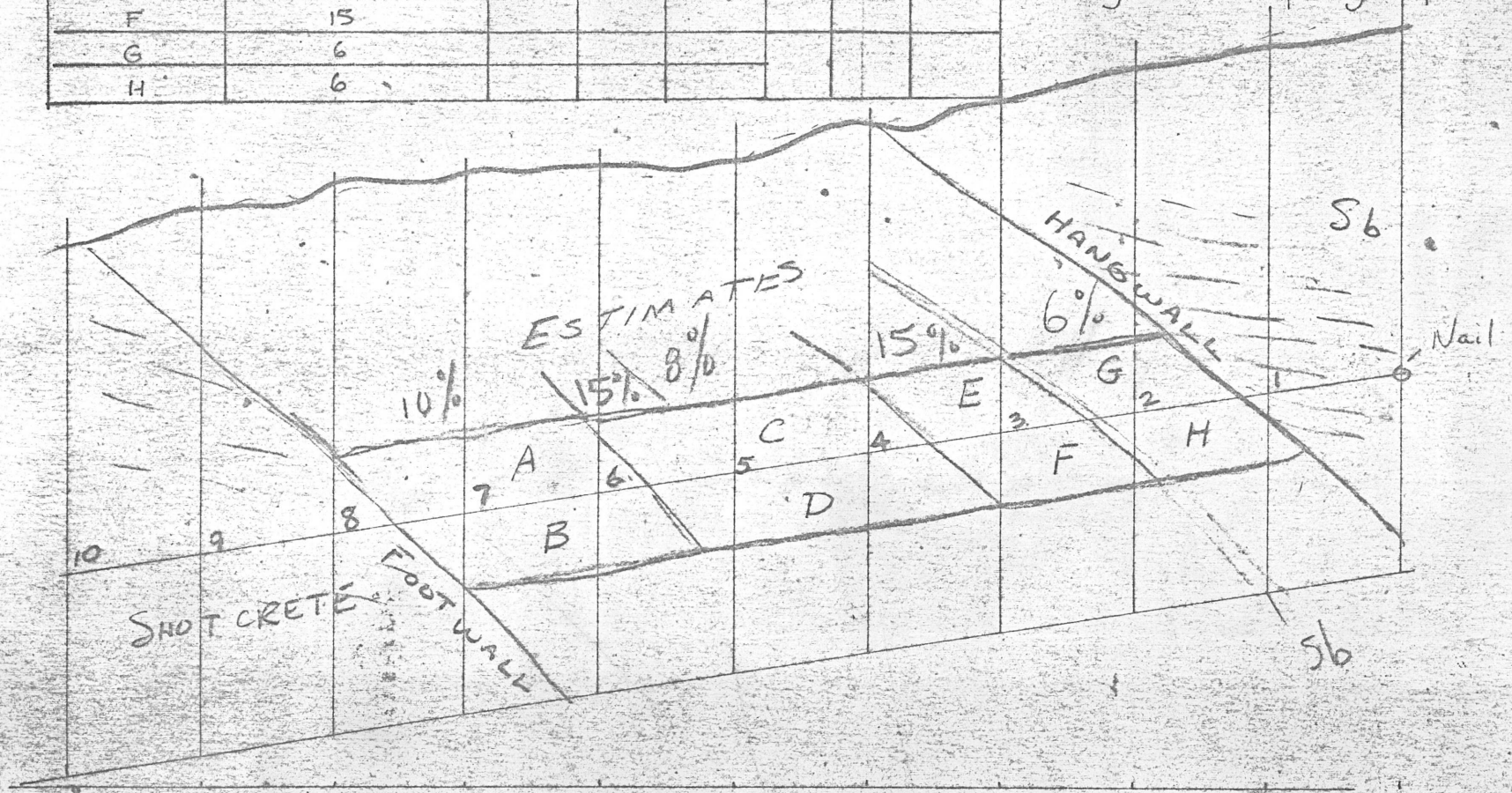

SCALE-1:50

ORE INTERSECTION
RIGHT WALL

SCALE
DAY NO. YR.

KERR ADDISON MINES Ltd.
GRUM JOINT VENTURE
RECORD OF CHIP SAMPLES

HEADING 76-WEST X-CUT

DATE	SAMPLE NO	SURVEY STA. & DIRECTION	DISTANCE FROM SURVEY STA.	ASSAY RESULTS		
				Pb(%)	Zn(%)	Ag gms/t
July 31, 1976	R-83	76-018 (SEE LAYOUT)	5m (Bot)	2.38	6.35	43.20
"	R-84	"	5m (Top)	1.55	3.98	30.17
"	R-85	NO SAMPLE SHOT CRETE	—			
"	R-86	"	—			
"	R-87	"	—			
"	R-88	"	—			
"	R-89	76-018 (SEE LAYOUT)	5m (Bot)	2.63	5.59	50.40
"	R-90	"	5m (Top)	2.40	3.80	41.49
"	R-91	"	5m (Bot)	2.08	3.70	30.17
"	R-92	"	5m (Top)	1.35	1.80	21.26
"	R-93	"	5m (Bot)	1.68	1.75	20.23
"	R-94	"	5m (Top)	.80	3.18	29.14
"	R-95	NO SAMPLE SHOT CRETE	—			
"	R-96	"	—			
"	R-97	"	—			
"	R-98	"	—			
"	R-99	76-018 (SEE LAYOUT)	5m (Bot)	.85	1.90	15.09
"	R-100	"	5m (Top)	2.18	1.83	17.14
"	R-101	NO SAMPLE SHOT CRETE	—	2.58	1.90	28.11
"	R-102	"	—	2.58	1.90	32.21
"	R-103	"	—	2.15	3.25	30.17
"	R-104	"	—	1.55	3.98	30.17

KERR ADDISON MINES Ltd.
GRUM JOINT VENTURE
RECORD OF CHIP SAMPLES

HEADING 80-West - X-Cut

DATE	SAMPLE NO	SURVEY STA. & DIRECTION	DISTANCE FROM SURVEY STA.	ASSAY RESULTS		
				Pb(%)	Zn(%)	Ag gms/t
July 30, 1976	R-15	76-026 (North)	15.8 → 20.8 (Bot)	.83	.85	12.00
	R-16	"	15.8 → 20.8 (Top)	0.55	0.58	9.94
	R-17	No SAMPLE SCREEN		-	-	-
	R-18	No SAMPLE SCREEN		-	-	-
	R-19	No SAMPLE SCREEN		-	-	-
	R-50	No SAMPLE SCREEN		-	-	-
July 30, 1976	R-51	76-026 (North)	30.8 → 35.8 (Bot)	1.55	2.23	19.20
	R-52	"	30.8 → 35.8 (Top)	1.69	1.73	21.94
July 30, 1976	R-53	"	35.8 → 40.8 (Bot)	1.65	2.55	27.43
	R-54	"	35.8 → 40.8 (Top)	1.43	3.40	22.97
July 30, 1976	R-55	"	40.8 → 45.8 (Bot)	1.50	3.15	25.37
	R-56	"	45.8 → 50.8 (Top)	1.43	2.85	18.17
July 30, 1976	R-57	"	50.8 → 55.8 (Bot)	1.20	2.80	26.40
	R-58	"	50.8 → 55.8 (Top)	1.28	2.85	20.23
July 30, 1976	R-59	"	5m (Bot)	1.48	2.53	26.40
	R-60	"	5m (Top)	1.34	2.58	21.34
July 30, 1976	R-61	"	5m (Bot)	5.88	10.42	118.97
	R-62	"	5m (Top)	1.25	2.48	21.26
July 30, 1976	R-63	"	5m (Bot)	7.56	11.87	128.23
	R-64	"	5m (Top)	2.03	3.10	38.10

**KERR ADDISON MINES Ltd.
GRUM JOINT VENTURE
RECORD OF CHIP SAMPLES**

HEADING 80-West - X-Cut

DATE	SAMPLE NO	SURVEY STA. & DIRECTION	DISTANCE FROM SURVEY STA.	* ASSAY RESULTS		
				Pb(%)	Zn(%)	Ag gms/t
July 30, 1976	R-65	76-026 (South)	10 → 15 (Bot)	3.58	8.85	53.49
	R-66	"	10 → 15 (Top)	2.75	5.80	45.26
July 30, 1976	R-67	"	15 → 20 (Bot)	.48	.73	7.20
	R-68	"	15 → 20 (Top)	0.38	0.80	7.20
July 30, 1976	R-69	"	20 → 25 (Bot)	.48	.90	18.17
	R-70	"	20 → 25 (Top)	0.13	0.93	9.94
July 30, 1976	R-71	"	25 → 30 (Bot)	.68	1.15	9.94
	R-72	"	25 → 30 (Top)	1.80	2.35	27.13
July 30, 1976	R-73	"	30 → 35 (Bot)	1.63	3.05	76.40
	R-74	"	30 → 35 (Top)	2.18	1.80	37.37
July 30, 1976	R-75	"	35 → 40 (Bot)	.48	.60	7.20
	R-76	"	35 → 40 (Top)	2.13	3.30	27.13
July 30, 1976	R-77	"	40 → 45 (Bot)	1.38	1.35	21.26
	R-78	"	40 → 45 (Top)	2.75	3.60	31.20
July 30, 1976	R-79	"	45 → 50 (Bot)	.28	.48	8.91
	R-80	"	45 → 50 (Top)	1.78	1.80	28.16
July 30, 1976	R-81	"	50 → 55 (Bot)	.58	.10	7.89
	R-82	"	50 → 55 (Top)	0.75	0.98	17.14

**KERR ADDISON MINES Ltd.
GRUM JOINT VENTURE
RECORD OF CHIP SAMPLES**

HEADING 8A- West X-Cut

DATE	SAMPLE NO	SURVEY STA. & DIRECTION	DISTANCE FROM SURVEY STA.	ASSAY RESULTS		
				Pb(%)	Zn(%)	Ag gms/t
July 26, 1976	R-1	076-045 (North)	11.6 → 16.6 BOTTOM PANEL	4.18	8.93	74.74
"	R-2	076-045 (North)	11.6 → 16.6 TOP PANEL	5.98	11.29	83.66
"	R-3	076-045 (North)	6.6 → 11.6 BOTTOM PANEL	4.80	8.55	72.62
"	R-4	076-045 (North)	6.6 → 11.6 TOP PANEL	6.17	9.66	78.51
"	R-5	076-045 (North)	16 → 6.6 BOTTOM PANEL	3.13	6.22	53.49
"	R-6	076-045 (North)	16 → 6.6 TOP PANEL	7.20	12.29	103.89
"	R-7	076-045 (South)	16(N) → 3.2(S) Bot	3.40	7.26	52.46
"	R-8	"	16(N) → 3.2(S) Top	5.90	11.13	87.77
"	R-9	"	3.2 → 8.2 (Bot.)	3.38	7.62	57.60
"	R-10	"	3.2 → 8.2 (Top)	4.18	8.90	71.66
"	R-11	"	8.2 → 13.2 (Bot)	3.90	7.93	67.20
"	R-12	"	8.2 → 13.2 (Top)	5.68	11.88	90.86
"	R-13	"	13.2 → 18.2 (Bot)	3.85	7.67	58.29
"	R-14	"	13.2 → 18.2 (Top)	4.60	11.24	79.54
"	R-15	"	18.2 → 23.2 (Bot)	3.50	7.88	58.29
"	R-16	"	18.2 → 23.2 (Top)	3.93	9.10	76.69
"	R-17	"	23.2 → 28.2 (Bot)	3.00	6.17	49.03
"	R-18	"	23.2 → 28.2 (Top)	4.80	10.23	80.57
"	R-19	"	28.2 → 33.2 (Bot)	4.40	9.21	70.63
"	R-20	"	28.2 → 33.2 (Top)	4.18	6.83	69.60
"	R-21	"	33.2 → 38.2 (Bot)	2.55	3.96	42.51
"	R-22	"	33.2 → 38.2 (Top)	2.23	3.30	37.37

KERR ADDISON MINES Ltd.
GRUM JOINT VENTURE
RECORD OF CHIP SAMPLES

HEADING

81-W-X-Cut

DATE	SAMPLE NO	SURVEY STA. & DIRECTION	DISTANCE FROM SURVEY STA.	ASSAY RESULTS		
				Pb(%)	Zn(%)	Ag gms/t
July 26, 1976	R-23	076-045 (South)	38.2 → 43.2 (Bot)	2.75	1.16	19.31
"	R-24	"	38.2 → 43.2 (Mid)	3.10	1.30	50.40
"	R-25	"	38.2 → 43.2 (Top)	0.13	0.10	2.06
"	R-26	"	43.2 → 48.2 (Bot)	1.18	1.95	29.14
"	R-27	"	43.2 → 48.2 (Top)	0.68	1.10	14.06
July 27, 1976	R-28	076-042 (South)	38.2 → 5m (Top)	0.63	0.98	10.97
"	R-29	"	5m (from previous) Bot.	0.58	1.90	12.00
"	R-30	"	" (Top)	5.77	8.45	89.83
"	R-31	"	" (Bot)	2.98	5.95	50.40
"	R-32	"	" (Top)	1.58	1.40	23.31
"	R-33	"	" (Bot)	0.90	1.25	14.06
"	R-34	"	" (Top)	1.78	3.08	30.17
"	R-35	"	" (Bot)	1.20	1.30	20.23
"	R-36	"	" (Top)	0.73	1.98	16.11
"	R-37	"	" (Bot)	0.05	0.13	2.06
"	R-38	"	" (Mid)	0.10	0.45	2.06
"	R-39	"	" (Bot)	2.03	4.60	32.23
"	R-40	"	" (Top)	1.95	1.35	30.17
"	R-41	"	" (Bot)	3.28	4.80	51.51
"	R-42	"	" (Top)	3.65	6.15	56.57
"	R-43	"	" (Bot)	2.00	3.85	35.31
"	R-44	"	" (Top)	1.55	3.18	27.13

BY BJ DATE Jan 22/76 SUBJECT Sulphide chip samples SHEET NO. _____ OF _____
 CHKD. BY _____ DATE _____ Test for possible Bulk Sample D JOB NO. _____
 Location Co NW

NOT TO SCALE

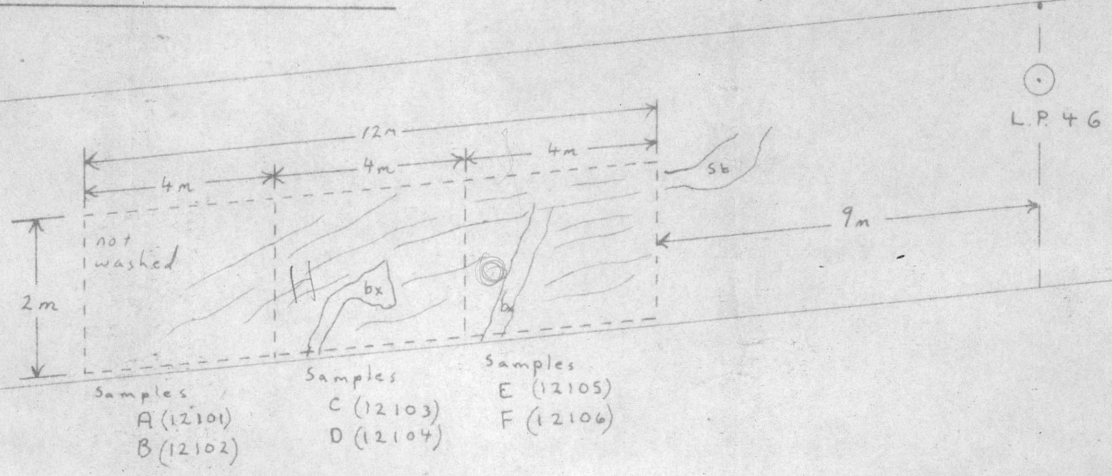

PANEL	SAMPLE NUMBER	ASSAYED			MEAN			Width
		Pb	Zn	Ag	Pb	Zn	Ag	
A	12101	8.04	9.93	3.27	7.64	10.37	3.17	4 metre
B	12102	7.24	10.80	3.06				
C	12103	5.38	9.05	2.18	5.08	9.42	2.11	4 metre
D	12104	4.78	9.78	2.03				
E	12105	5.03	9.01	2.15	4.94	8.79	2.12	4 metre
F	12106	4.85	8.56	2.09				

SAMPLE H-1

EAST WALL 84 XC

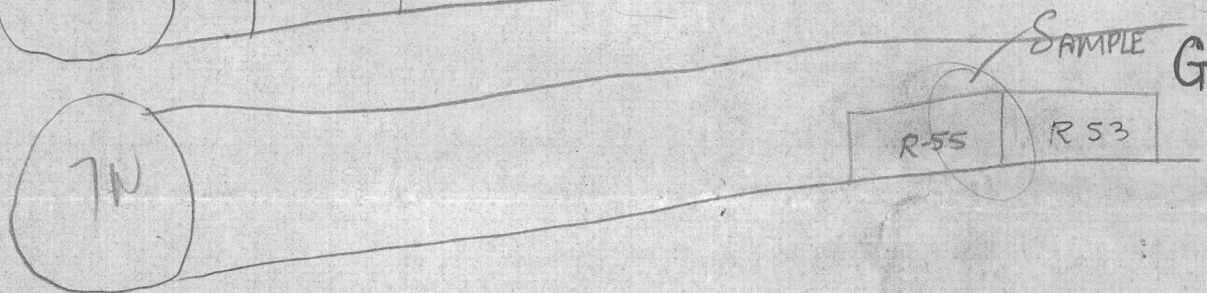
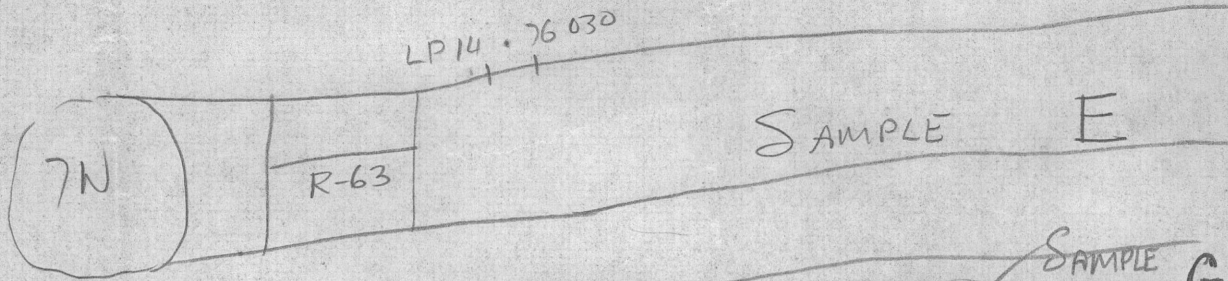
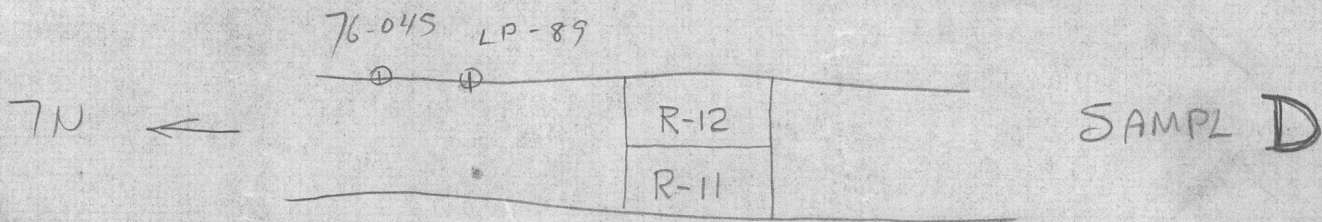

RIGHT WALL 6NE

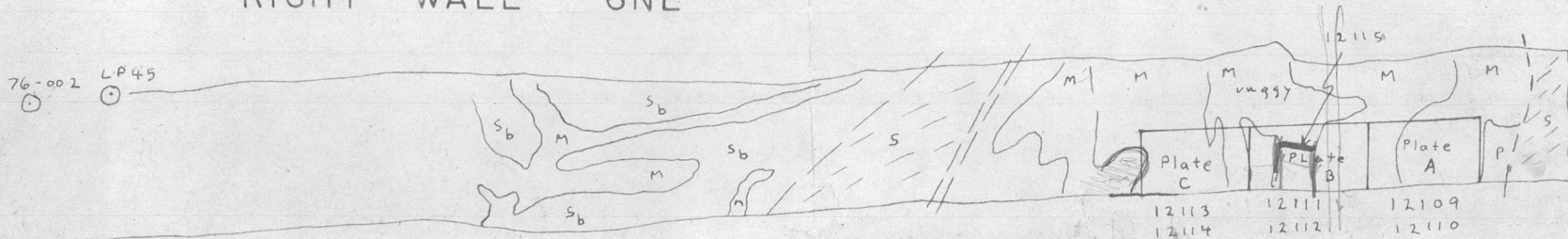

Location of Chip Samples

Sampled Jan 27 / 76

Sample Number	Plate	Assay			Mean		
		Pb	Zn	Ag	Pb	Zn	Ag
12109	A	7.89	19.81	3.79	7.89	19.21	3.81
12110	A	7.89	18.60	3.82			
12111	B	9.95	20.93	1.21	10.56	21.25	1.39
12112	B	11.17	21.56	1.56			
12113	C	10.11	18.60	1.50	10.17	18.90	1.50
12114	C	10.23	19.20	1.50			
12115 *	B	6.71	13.61	2.79	6.71	13.61	2.79

* 12115 - sample of vuggy granular sulphide

SAMPLE F

Scale 1:250

Glen Tetu

Feb. 1976

RIGHT WALL 6NE

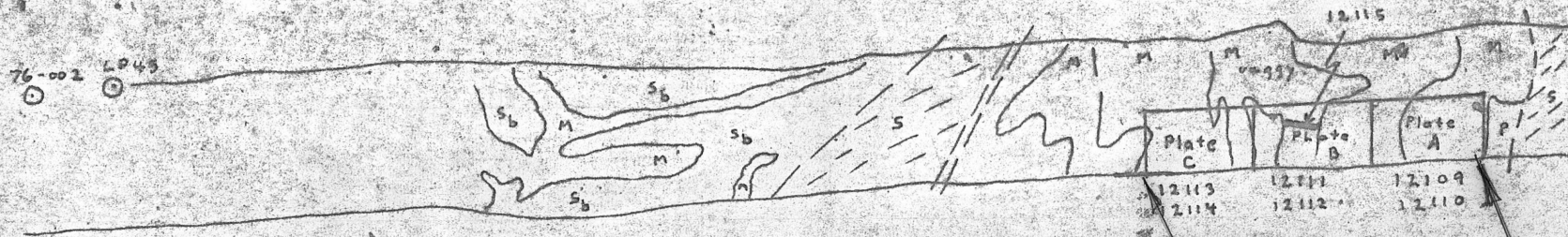

Location of Chip Samples

Sampled Jan 27/76

Sample Number	Plate	Assay			Mean		
		Pb	Zn	Ag	Pb	Zn	Ag
12109	A	7.89	19.81	3.79	7.89	19.21	3.81
12110	A	7.89	18.40	3.92			
12111	B	9.95	20.23	4.21	10.54	21.25	4.39
12112	B	11.17	21.56	4.56			
12113	C	10.11	18.40	4.50	10.17	18.90	4.50
12114	C	10.23	19.20	4.50			
12115*	B	6.78	13.66	3.79	6.78	13.66	3.79

10743.8 N
7737.6 E

10751.5 N
10728.3 E

* 12115 - sample of luggy granular sulphide

Scale 1:280

Glen Tetu

Feb. 1976

DATE. FEBRUARY 16, 1976

FILE NO. 9425-13
CHIP SAMPLES



ASSAY CERTIFICATE

WHITEHORSE ASSAY OFFICE LTD.
BOX 4518 WHITEHORSE Y. T.
PHONE 667 2694 Y1A 2R8

SAMPLE RECEIVED FROM

KERR ADDISON MINES

SAMPLE NO.	GOLD Oz. Per Ton	SILVER Oz Per Ton	LEAD	ZINC				
12101		3.27	8.04	9.93				
12102		3.06	7.24	10.80				
12103		2.18	5.38	9.05				
12104		2.03	4.78	9.78				
12105		2.15	5.03	9.01				
12106		2.09	4.85	8.56				
12109		3.79	7.89	19.81				
12110		3.82	7.89	18.60				
12111		4.21	9.95	20.93				
12112		4.56	11.17	21.56				
12113		4.50	10.11	18.60				
12114		4.50	10.23	19.20				
12115		2.79	6.74	13.64				

*Entered by
Laurie Butcher*

ASSAYER. K Hayward jr GEO. SPALDING

DATE August 6, 1976

FILE NO. 9644-44

App for pay on Aug 13/76

ASSAY CERTIFICATE

WHITEHORSE ASSAY OFFICE LTD.
 BOX 4518 WHITEHORSE Y. T.
 PHONE 667 2694 Y1A 2R8

SAMPLE RECEIVED FROM Kerr Addison

SAMPLE NO.	GOLD Oz. Per Ton	SILVER Oz. Per Ton	LEAD	ZINC	SILVER gms/tonne
UNDERGROUND CHIP SAMPLES					
R1			4.48	8.93	74.74
R2			5.98	11.29	83.66
R3			4.80	8.55	72.69
R4			6.17	9.66	78.51
R5			3.13	6.22	53.49
R6			7.20	12.29	103.89
R7			3.40	7.26	52.46
R8			5.90	11.13	87.77
R9			3.38	7.62	57.60
R10			4.18	8.90	71.66
R11			3.90	7.93	67.20
R12			5.68	11.88	90.86
R13			3.85	7.67	58.29
R14			4.60	11.24	79.54
R15			3.50	7.88	58.29
R16			3.93	9.10	72.69
R17			3.00	6.17	49.03
R18			4.80	10.23	80.57
R19			4.40	9.21	70.63
R20			4.48	6.83	69.60
R21			2.55	3.96	42.51
R22			2.23	3.30	37.37
R23			2.75	4.46	49.37
R24			3.40	4.30	50.40
R25			.13	.10	2.06
R26			1.48	1.95	29.14
R27			.68	1.10	14.06
R28			.63	.98	10.97
R29			.58	1.90	12.00
R30			5.77	8.45	89.83
R31			2.98	5.95	50.40
R32			1.58	1.40	23.31
R33			.90	1.25	14.06
R34			1.78	3.08	30.17
R35			1.20	1.30	20.23
R36			.73	1.98	16.11
R37			.05	.13	2.06
R38			.10	.45	2.06
R39			2.03	4.60	32.23
R40			1.95	4.35	30.17
R41			3.28	4.80	54.51
R42			3.65	6.15	56.57
R43			2.00	3.85	35.31
R44			1.55	3.18	27.43

*Entered by RB
 Aug 10, 1976*

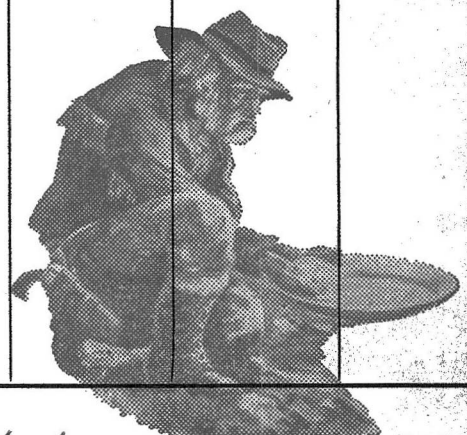

ASSAYER K. Howland M GEO. SPALDING

DATE. AUGUST 20, 1976

FILE NO. 9680 - 31

ASSAY CERTIFICATE

Ass. for pay on Sep. 13/76 Inv

*Underground
Rock chips*

WHITEHORSE ASSAY OFFICE LTD.
BOX 4518 WHITEHORSE Y. T.
PHONE 667 2694 Y1A 2R8

SAMPLE RECEIVED FROM

KERR - ADDISON MINES

SAMPLE NO.	GOLD Oz. Per Ton	SILVER Oz. Per Ton	LEAD	ZINC	SILVER gms/tonne			
R - 45			.83	.85	12.00			
51			1.55	2.23	19.20			
53			1.65	2.55	27.43			
55			1.50	3.15	25.37			
57			1.20	2.80	26.40			
59			1.48	2.53	26.40			
61			5.88	10.42	118.97			
63			7.56	11.87	128.23			
65			3.58	8.85	53.49			
67			.48	.73	7.20			
69			.48	.90	18.17			
71			.68	1.15	9.94			
73			1.63	3.05	26.40			
75			.48	.60	7.20			
77			1.38	1.35	21.26			
79			.28	.48	8.91			
81			.58	.10	7.89			
83			2.38	6.35	43.20			
84			1.55	3.98	30.17			
89			2.63	5.59	50.40			
90			2.40	3.80	41.49			
91			2.08	3.70	30.17			
92			1.35	1.80	21.26			
93			1.68	1.75	20.23			
94			.80	3.18	29.14			
99			.85	1.90	15.09			
100			2.18	1.83	17.14			
105			2.18	.90	28.11			
106			2.58	1.90	33.26			
107			2.15	2.20	30.17			
108			1.43	1.85	22.29			

31

*Entered by RG
Aug 28/76.*

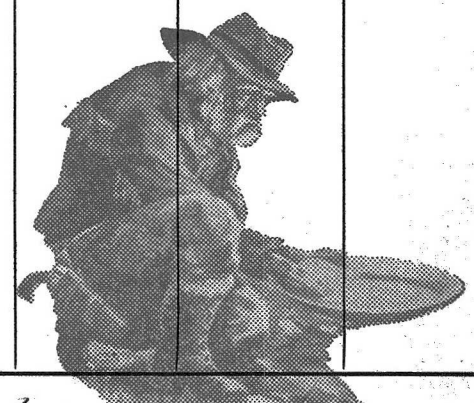

ASSAYER. *L. Hoyland* GEO. SPALDING

DATE. AUGUST 30, 1976

ASSAY CERTIFICATE

FILE NO. 9707 - 37

App. for pay. on Sept 3/76 Ind J

Underground chip samples

WHITEHORSE ASSAY OFFICE LTD.
 BOX 4518 WHITEHORSE Y. T.
 PHONE 667 2694 Y1A 2R8

SAMPLE RECEIVED FROM

KERR - ADDISON MINES

SAMPLE NO.	GOLD Oz. Per Ton	SILVER Oz. Per Ton	LEAD	ZINC	SILVER gms/tonne			
R - 46			.55	.58	9.94			
52			1.69	1.73	21.94			
54			1.43	3.40	22.97			
56			1.43	2.85	18.17			
58			1.28	2.85	20.23			
60			1.34	2.58	24.34			
62			1.25	2.48	21.26			
64			2.03	3.10	38.40			
66			2.75	5.80	45.26			
68			.38	.80	7.20			
70			.43	.93	9.94			
72			1.80	2.35	27.43			
74			2.48	4.80	37.37			
76			2.13	3.30	27.43			
78			2.75	3.60	31.20			
80			1.78	1.80	28.46			
82			.75	.98	17.14			

17

*Entered by B
 Sept 6 1976.*



ASSAYER. *K. Hayland* GEO. SPALDING

DATE. OCTOBER 20, 1975

FILE NO. 9379-8

ASSAY CERTIFICATE

WHITEHORSE ASSAY OFFICE LTD.
BOX 4518 WHITEHORSE Y. T.
PHONE 667 2694 Y1A 2R8

SAMPLE RECEIVED FROM

KERR- ADDISON MINES

SAMPLE NO.	GOLD Oz. Per Ton	SILVER Oz. Per Ton	LEAD	ZINC				
A		3.27	9.83	10.65				
B		4.06	10.58	10.83				
C		2.88	6.95	6.97				
D		3.33	7.68	8.57				
F		2.35	6.43	4.02				
G		1.03	2.57	2.70				
H		1.56	3.30	2.64				
I		1.68 *	5.11	2.94				

* Checked Twice

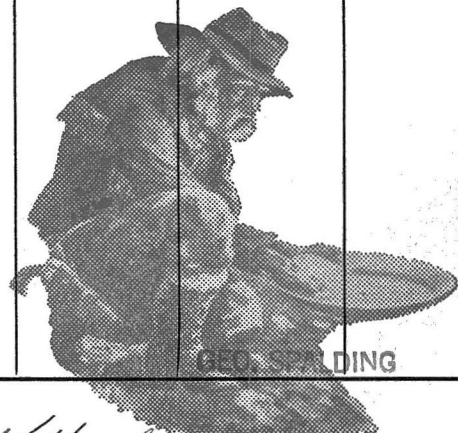

GEO. SPINDING

ASSAYER. *K. Howland*



GENERAL TESTING LABORATORIES

DIVISION SUPERINTENDENCE COMPANY (CANADA) LTD.

1001 EAST PENDER ST., VANCOUVER, B.C., CANADA, V6A 1W2
 PHONE (604) 254-1647 TELEX 04-507514 CABLE SUPERVISE

TO: **KERR ADDISON MINES**
Ste. 703 - 1112 West Pender Street
Vancouver, B.C.
V6E 2S1

(Continued) ... page 2 ...

CERTIFICATE OF ASSAY

No.: 7611-1751 DATE: Nov. 20/76

We hereby certify that the following are the results of assays on: **DDG**

MARKED	NGOLD	NSILVER	Specific Gravity S.G.	XXX	XXX	XXX	XXX	XXX
	OZ/ST GR/MT	OZ/ST GR/MT						
182 - G			3.442					
197			2.872					
200			2.649					
382			2.858					
387			3.589					
388			3.313					
391			3.006					
392			2.927					
394			3.870					
196			3.499					
199			2.756					
385			3.002					
381			3.008					
384			3.221					
386			3.366					
389			3.216					
390			3.016					
393			3.594					
400			3.224					
195			3.169					
198			3.061					
380			2.928					
383			3.174					
396			4.387					
397			3.106					
398			3.902					
399 - G			3.193					

NOTE: REJECTS RETAINED ONE MONTH. PULPS RETAINED THREE MONTHS. ON REQUEST PULPS AND REJECTS WILL BE STORED FOR A MAXIMUM OF ONE YEAR.

ALL REPORTS ARE THE CONFIDENTIAL PROPERTY OF CLIENTS. PUBLICATION OF STATEMENTS, CONCLUSION OR EXTRACTS FROM OR REGARDING OUR REPORTS IS NOT PERMITTED WITHOUT OUR WRITTEN APPROVAL. ANY LIABILITY ATTACHED THERETO IS LIMITED TO THE FEE CHARGED.

[Signature]
L. WONG

PROVINCIAL ASSAYER

COPY

Analytical and Consulting Chemists, Bulk Cargo Specialists, Surveyors, Inspectors, Samplers, Weighers

MEMBER: American Society For Testing Materials • The American Oil Chemists' Society • Canadian Testing Association
 REFEREE AND OR OFFICIAL CHEMISTS FOR: Vancouver Merchants Exchange • National Institute Of Oilseed Products • The American Oil Chemists' Society
 OFFICIAL WEIGHMASTERS FOR: Vancouver Board Of Trade • Vancouver Merchants Exchange

J. Paxton

GENERAL TESTING LABORATORIES

DIVISION SUPERINTENDENCE COMPANY (CANADA) LTD.

1001 EAST PENDER ST., VANCOUVER, B.C., CANADA, V6A 1W2
PHONE (604) 254-1647 TELEX 04-507514 CABLE SUPERVISE



TO:
KERR ADDISON MINES
 Ste. 703 - 1112 West Pender St.,
 Vancouver, B.C.
 V6E 2S1

CERTIFICATE OF ASSAY

No.: **7611-1751** DATE: **Nov. 30/76**

We hereby certify that the following are the results of assays on: DDC

MARKED	GOLD	SILVER	Specific Gravity S.G.	XXX	XXX	XXX	XXX	XXX
	OZ/ST GR/MT	OZ/ST GR/MT						
162 - C			4.398					
167			4.405					
170			4.443					
175			4.201					
176			4.318					
179			4.033					
180			3.831					
181			4.410					
184			4.300					
185			4.350					
186			4.360					
164			4.185					
166			4.504					
168			3.827					
173			3.924					
177			4.245					
183			3.915					
187			4.008					
190			4.227					
191			4.377					
192			4.447					
193			4.245					
161			3.256					
163			4.407					
165			4.337					
169			3.498					
171			3.675					
172			4.411					
174			3.661					
178			4.389					
188			4.413					
189			3.671					
194 - C			4.583					

/ Continued on next page

NOTE: REJECTS RETAINED ONE MONTH. PULPS RETAINED THREE MONTHS. ON REQUEST PULPS AND REJECTS WILL BE STORED FOR A MAXIMUM OF ONE YEAR.

ALL REPORTS ARE THE CONFIDENTIAL PROPERTY OF CLIENTS. PUBLICATION OF STATEMENTS, CONCLUSION OR EXTRACTS FROM OR REGARDING OUR REPORTS IS NOT PERMITTED WITHOUT OUR WRITTEN APPROVAL. ANY LIABILITY ATTACHED THERETO IS LIMITED TO THE FEE CHARGED.

 L. WONG PROVINCIAL ASSAYER

COPY

Analytical and Consulting Chemists, Bulk Cargo Specialists, Surveyors, Inspectors, Samplers, Weighers

MEMBER: American Society For Testing Materials • The American Oil Chemists' Society • Canadian Testing Association
 REFEREE AND OR OFFICIAL CHEMISTS FOR: Vancouver Merchants Exchange • National Institute Of Oilseed Products • The American Oil Chemists' Society
 OFFICIAL WEIGHMASTERS FOR: Vancouver Board Of Trade • Vancouver Merchants Exchange

KERR ADDISON MINES LIMITED

(FOR INTER-OFFICE USE ONLY)

To..... J. Paxton From..... J. K. Carrington

Subject..... GRUM METALLURGICAL SAMPLING Date..... February 1, 1977

As a result of recent metallurgical testing we require some additional samples from the Grum. This sampling has two parts as follows:

(1) Core Samples for Polished Examination

Dave's initial work appears to have gone a long way towards explaining some of our metallurgical problems. To complete his survey and to provide a better picture of the distribution of metallurgical types of ore he requires quite a few more core samples. The details are with the attached memo.

(2) Bench Test Samples

From each of the following sites we require two 500 pounds each samples of +8" material. 500 pounds amounts to $\frac{1}{2}$ drum. Do not add water to the drum but place a plastic seal under the lid before securing it.

Site: C	Sampling Designation: C3
D	D3
F	F3 Massive, Hard
	F3 Massive, Vuggy
G	G3
H	H3

1 25lb sample to Mr. R. Cross.

One set of drums is to go to Mattagami Lake Mines Limited, Matagami, Quebec, Attention: K. Konigsmann. The duplicate set is to go to Lakefield Research Laboratories, Lakefield, Ontario. This work should be done before the core sampling and every effort made to get the samples out as quickly as possible.

The F site may be a bit tricky. From photos Dave took there appears to be a well defined fault running across the site with massive, hard sulphides on the upper side and oxidized, vuggy sulphides on the lower. We require separate samples of each even if you have to move away a little distance from the original site.

*P. Cross
→
Box 91
Commerce Court
Toronto
MSL 1C7*

KERR ADDISON MINES LIMITED

(FOR INTER-OFFICE USE ONLY)

To.....From.....

Subject.....Page Two.....Date.....

For each site, please make a detailed sketch of the geology and send this to Dave and a copy to me. We wish to duplicate the sampling you and he did last November as closely as possible.

If you have any questions you can reach me at Brenda Mines, Peachland, British Columbia, (604) 493-0220.



J. K. Carrington.

:ced

B-ORFS

SAMPLES

RECEIVED

NOV. 24, 1976

	1. Fe	2. Fe-M	3. Br-MV	4. Br-MB	5. Br-MVg	6. Br-MBc	7. Br-MVc	8. Br-MBc	9. Ec	10. Gc	11. Dc	12. Ic	13. Cc	14. A
% OF COMPOSITE	3	11	2	0	1	1	1	1	5	20	20	20	15	0
SPECIFIC GRAVITY	4.48	3.55	4.38	4.30	4.31	4.24	4.28	4.01	3.92	2.78	3.04	3.35	3.55	4.39
NATURAL pH	6.5	6.7	6.5	6.8	6.7	7.0	6.4	6.8	8.7	7.9	7.8	7.5	7.3	11.2
FORM. SiO_2	158	41	599	68	650	230	550	150	96	6	46	84	74	246
Au oz/t	.036	.032	.045	.040	.047	.041	.048	.049	.055	.012	.020	.027	.036	.049
Ag oz/t	3.0	3.5	5.1	4.0	3.9	3.7	4.1	3.8	5.9	.6	1.7	2.3	1.2	3.0
% Cu	.10	.02	.24	.05	.33	.11	.28	.09	.09	.03	.08	.06	.04	.18
% Zn	14.4	18.9	16.0	15.7	12.0	15.3	12.0	14.6	16.3	3.2	6.6	9.0	4.5	7.8
% Pb	6.9	6.5	9.9	9.0	8.0	9.0	8.1	8.5	9.1	1.5	3.3	4.8	2.8	8.6
PPM Hg	183	192	183	146	132	149	146	144	267	33	91	114	49	17
% ZnO	.3	36.5	5.7	10.1	7.3	11.7	12.0	17.4	13.6	81.7	63.6	48.2	42.6	4.9
% SiO_2	.7	34.6	5.2	9.4	6.0	10.1	10.5	15.4	12.7	72.7	58.2	44.6	39.2	3.5
% Fe	29.4	10.4	25.9	23.6	27.8	22.8	26.7	20.8	16.0	3.8	8.2	11.1	20.3	30.9
% Co	.005	.003	.005	.010	.011	.011	.007	.009	.003	.002	.002	.004	.005	.012
% Cd	.02	.02	.02	.02	.02	.02	.02	.02	.03	.004	.009	.012	.006	.011
% S	40.0	21.2	38.3	35.6	36.4	33.3	36.4	31.4	27.0	5.2	12.2	19.5	24.7	35.2
% Ni	.09	.09	.09	.09	.11	.11	.09	.09	.08	.07	.08	.09	.09	.09
% AS	.33	1.36	.08	.46	.48	.40	.09	.37	.10	.02	.23	.21	.42	.04
% CaO	.97	.18	.07	.28	1.1	1.1	.17	.36	4.8	.55	.90	.53	.07	5
% MgO	.51	.12	.02	.13	.56	.59	.10	.19	2.3	.37	.53	.30	.08	1.1
% PYRITE	54	16	50	45	51	11	50	38	28	7	15	24	40	53
DESCRIPTION	MASSIVE V. G. CR OXIDIZED	MASSIVE, HARD OXIDIZED	MASSIVE, V. G. G OXIDIZED	MASSIVE HARD OXIDIZED	AS (3) PLUS 1kg FAULT GORGE	AS (4) PLUS 1kg FAULT GORGE	AS (3) PLUS 1kg graphitic phyllite	AS (4) plus 1kg graphitic phyllite	MASSIVE RECRYSTALLIZED HIGH Zn Pb	LOW GRADE SILICEOUS BANDS	MASSIVE BANDS BANDS BANDS	MASSIVE BANDS BANDS BANDS	SILICEOUS OR PLUS MASSIVE BANDS BANDS	MASSIVE PLUS MASSIVE PLUS SHEET (PLUS SHEET PIECES)

BY J.P. DATE JAN/77

SUBJECT GRUM JOINT VENTURE

SHEET NO. _____ OF _____

CHKD. BY _____ DATE _____

BUCK SAMPLE LOCATIONS FOR

JOB NO. NOTE MEMO

METALLURGICAL TESTS

JAN 20/77 J.K. CARRINGTON

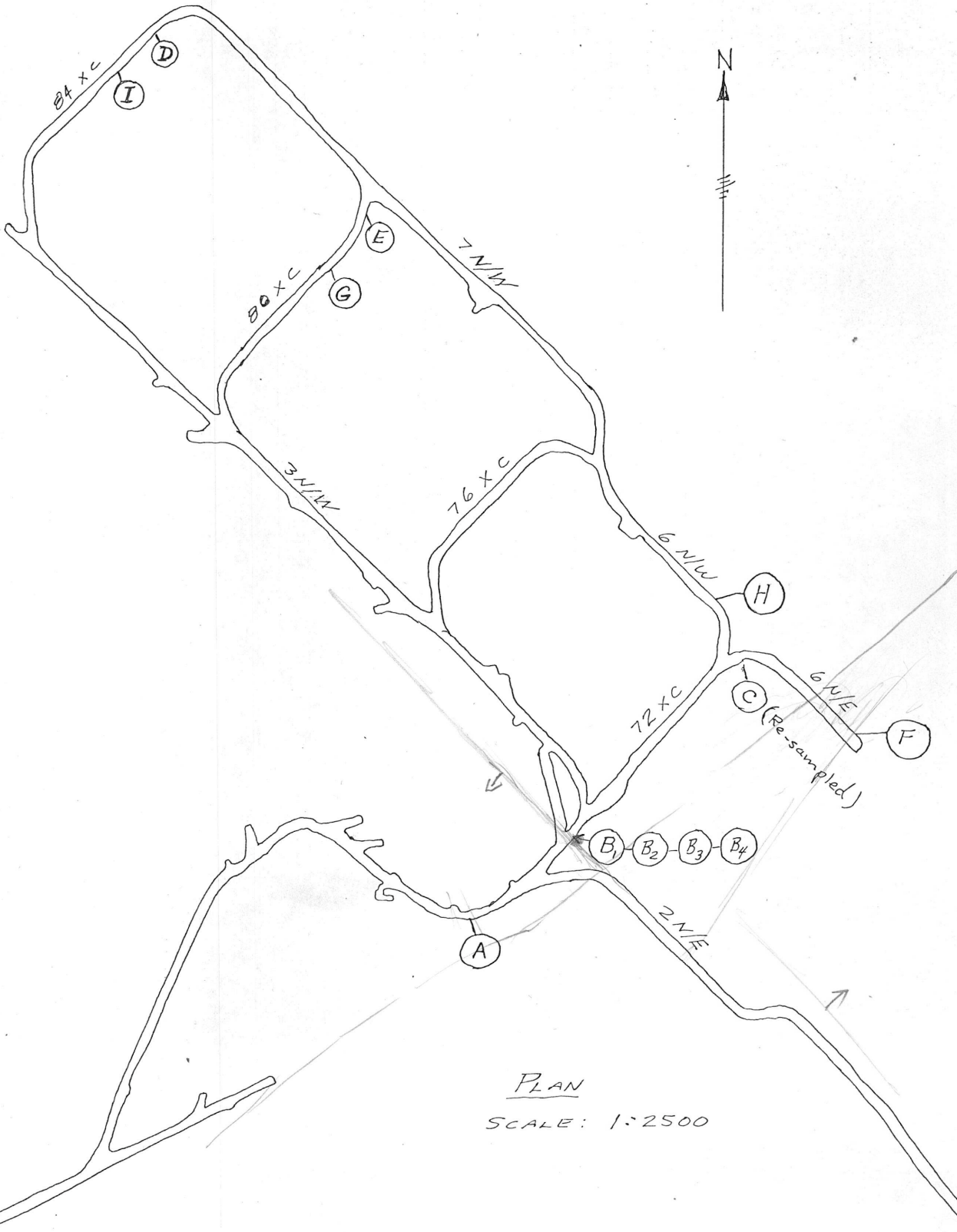

PLAN
SCALE: 1:2500

Small sample
taken by
J.P. & D.C.
Nov 1976

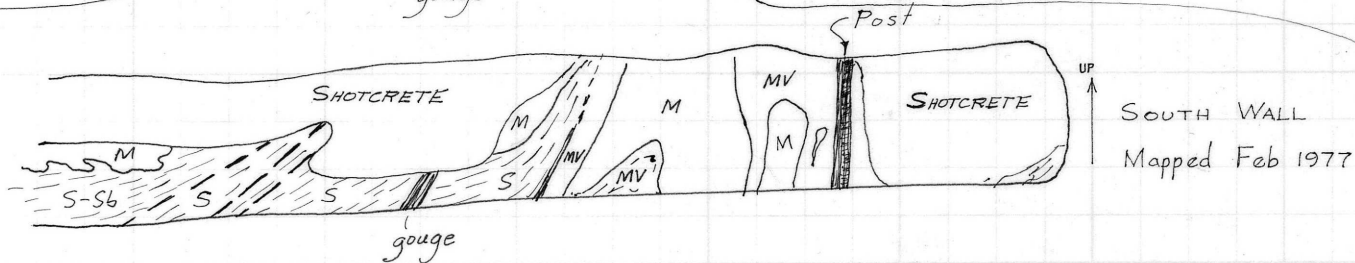
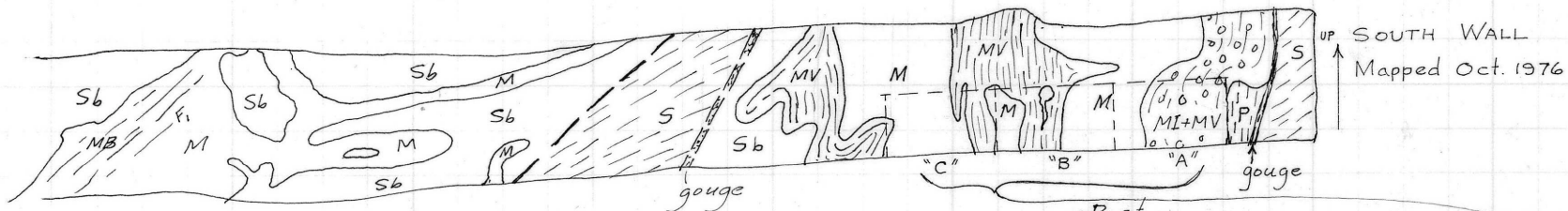
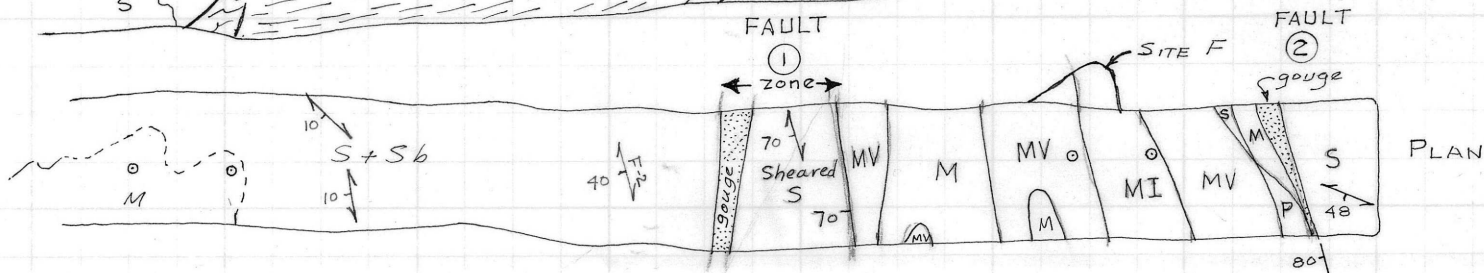
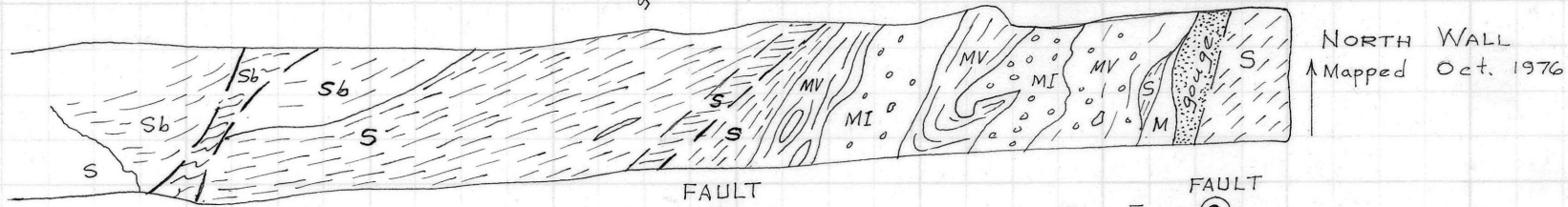
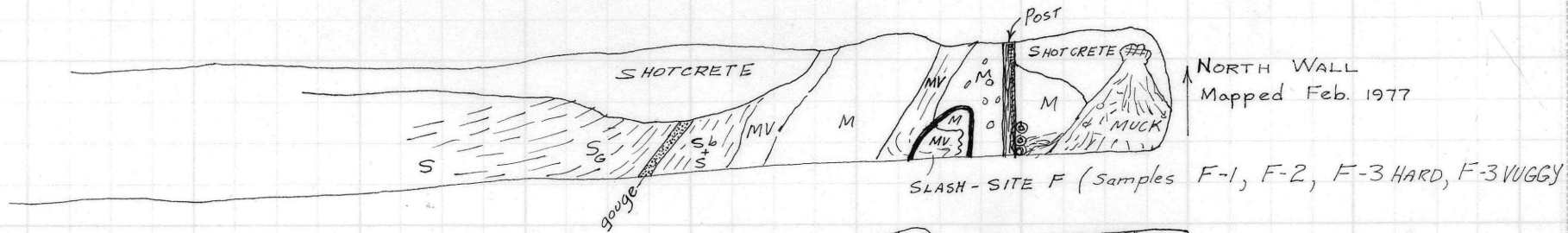

CHIP SAMPLE RESULTS (Feb. 1976)

PANEL "A"	7.89 % Pb	19.21 % Zn	122 gm/t Ag
PANEL "B"	10.56 % Pb	21.25 % Zn	140 gm/t Ag
PANEL "C"	10.17 % Pb	18.90 % Zn	144 gm/t Ag

SKETCH OF SITE
F

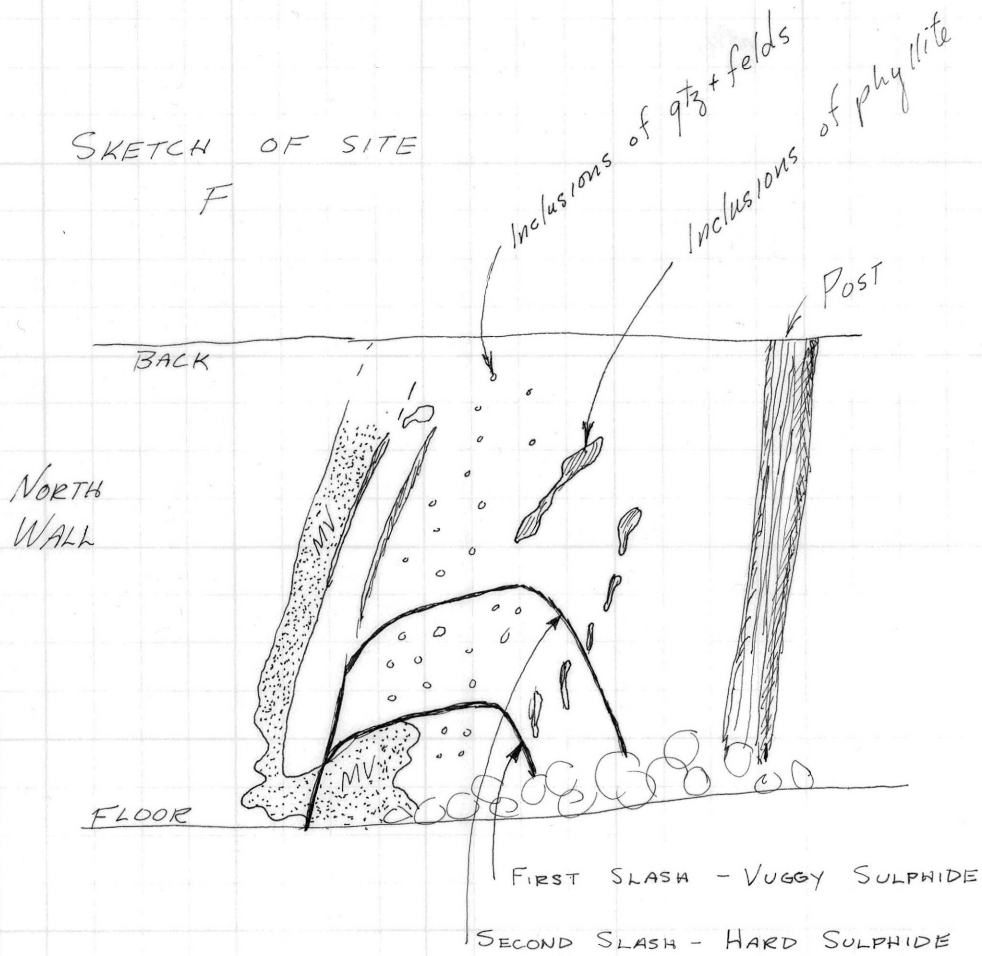

SECTION

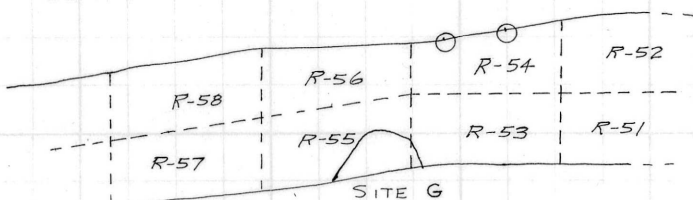

East Wall
 Chip Sample Assay
 Panel R-55
 Pb = 1.50 %
 Zn = 3.50 %
 Ag = 25 gm/t

PLAN

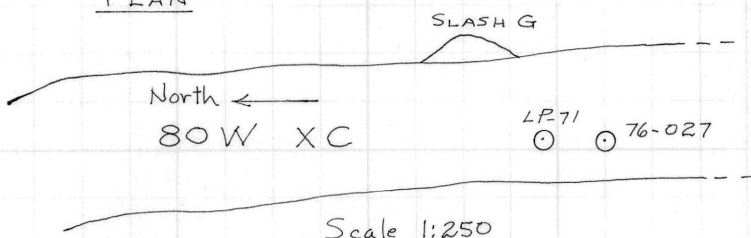

SKETCH OF G SLASH

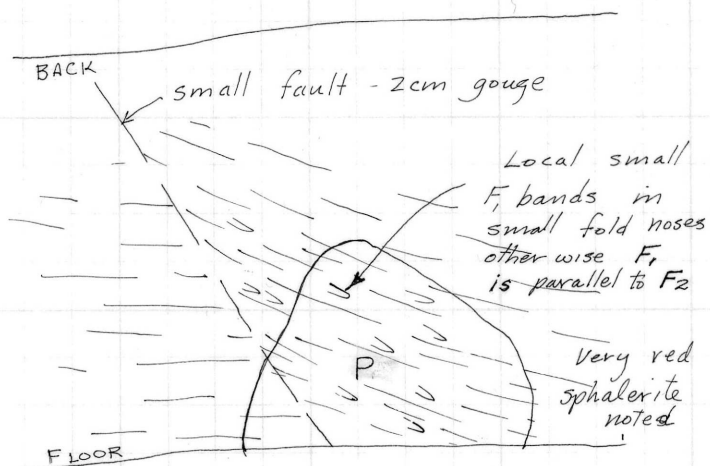

sulphide bands in quartz-sericite phyllite.
 Sulphides comprise 25%
 15% Py 10% Pb-Zn

SECTION

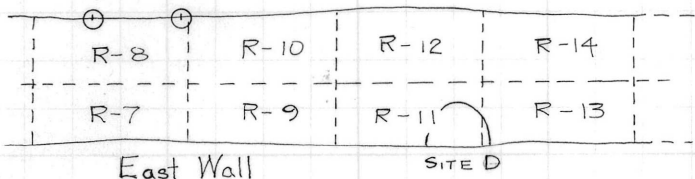

Chip Sample Assay
 Panel R-11
 Pb = 3.90 %
 Zn = 7.93 %
 Ag = 67 gm/t

PLAN

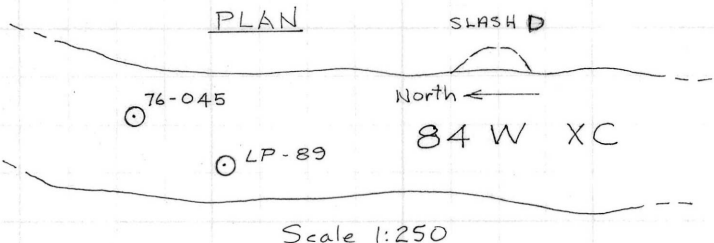

SKETCH OF D SLASH

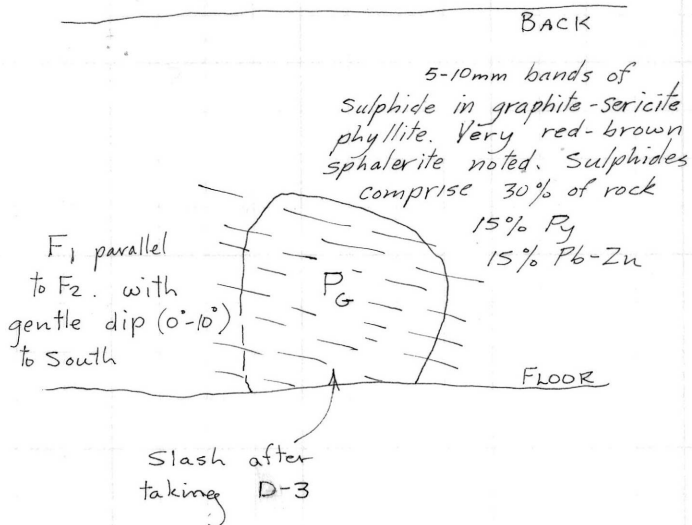

Slash after taking D-3

