

KERR ADDISON MINES LIMITED
P.O. BOX 91
COMMERCE COURT WEST
TORONTO, ONTARIO
M5L 1C7

019299

Grum 6A

COPY

July 5, 1977

Mr. J. Oik
Vice-President & General Manager
Cyprus Anvil Mining Corporation
330 - 355 Burrard Street
VANCOUVER, B.C.
V6C 2G8

Dear Jim:

As per our conversation this morning, I am enclosing a copy of a claim map which shows the approximate areas on your ground which we plan to do some soils drilling this month. This involves three sites, each end of Shrimp Lake and in upper Vangorda Creek, and about six holes per site. These holes are designed to go to bedrock or sufficiently deep to establish a good dam design. Access is readily available to the Shrimp Lake sites with only about 1,500 feet of road required at the Blind Creek end, but we have to put in a cat track to the upper Vangorda Creek site. This would take off from near Doal Lake by our present camp and follow the contours around to Vangorda Creek.

I believe there are two drill holes, presumably Cyprus Anvil's, near the Vangorda Creek end of Shrimp Lake which are on or near a proposed dam site. We would appreciate it greatly if we could study the logs from these holes. As you indicated, once we have the correct designation of these holes, either Bill Sirola or myself will contact Glenn for a copy of the logs.

Based on our discussion, I plan to proceed with this work. Thank you for your co-operation.

Best regards.

Yours very truly,

KERR ADDISON MINES LIMITED



John K. Carrington
Project Manager
Grum Joint Venture

JKC:js
Enclosure

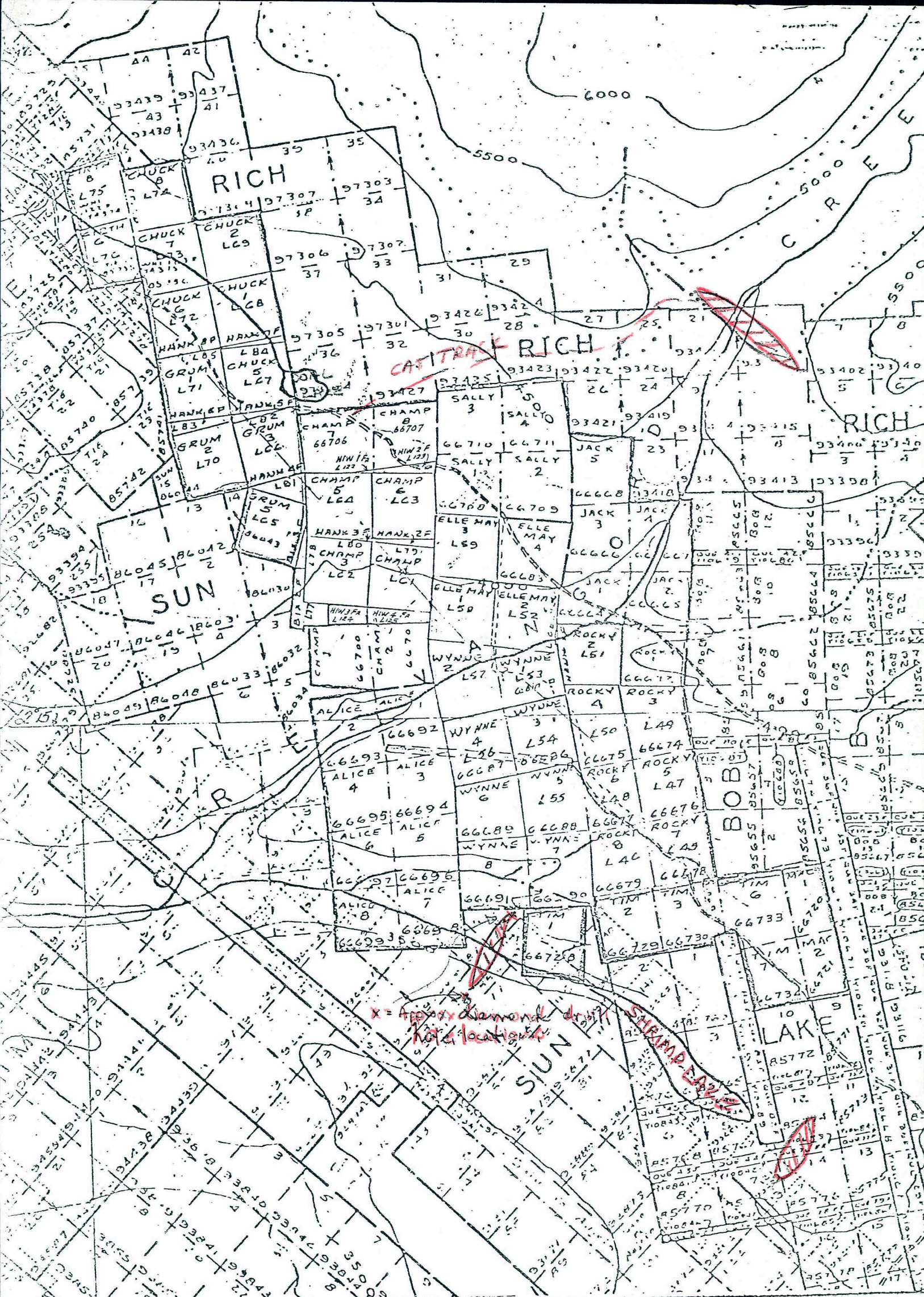

- Approx Soils Drilling Location Sites
- Kerr Addison Mines Min Claims, Ken-Alex J.U.
 - Vangorda Mines Min Claims, Ken-Alex J.U.
 - Vangorda Mines, Min. Claims, 100% Kerr

KERR ADDISON MINES LIMITED	
VANGORDA MINES LTD.	
CLAIM MAP	
SCALE: 1" = 1/2 MI.	
NTS 105 K3, 6	KERR 11 1969 CLAIM
2-2-69 2-2-69	

HW Fr. Sta. incl. staked in April 65 by surveyor.
 should be done before mining should be