

019311

A.E.X. HOLES

June 20, 1974

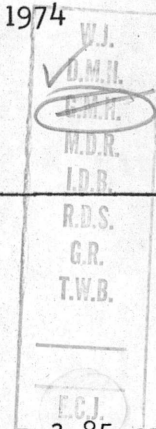

Hole No.	Location	Depth	Mineralized Zone					
A-1	76 + 00W 7 + 40S	1026'	853.0 - 863.7	10.7	Low Values			
A-2	NA							
A-3	NA							
A-4	75 + 60W 0 + 60S	700'	656.0 - 675.5	19.5'	6.7 % Pb	10.8 % Zn	3.85 oz. Ag	
A-5	76 + 00W 2 + 00N	592'	420.0 - 426.0	6.0'	10.6 % Pb	9.62% Zn	3.84 oz. Ag	
			526.5 - 586.5	60.0'	5.29% Pb	11.42% Zn	2.70 oz. Ag	
A-6	NA							
A-7	76 + 50W 14 + 00N	477'	No significant mineralization					
A-8	84 + 00W 11 + 00N	763'	306.8 - 322.0	15.2'	2.41% Pb	4.89% Zn	1.05 oz. Ag	
			583.5 - 592.5	9.0'	3.23% Pb	6.11% Zn	1.40 oz. Ag	
A-9	76 + 00W 7 + 00N	761'	375.7 - 408.7	33.0'	1.48% Pb	3.71% Zn	0.99 oz. Ag	
			410.0 - 416.0	6.0'	5.55% Pb	7.92% Zn	0.80 oz. Ag	
			434.0 - 479.0	45.0'	4.32% Pb	7.15% Zn	2.25 oz. Ag	
A-10	78 + 00W 2 + 00N	820'	518.0 - 623.0	105.0'	4.39% Pb	6.75% Zn	1.95 oz. Ag	
			623.0 - 730.0	Weak Mineralization				
			730.0 - 756.0	26.0'	5.14% Pb	8.03% Zn	2.63 oz. Ag	
			767.0 - 775.4	8.4'	3.00% Pb	6.72% Zn	1.82 oz. Ag	
			779.0 - 783.0	4.0'	1.73% Pb	3.12% Zn	1.02 oz. Ag	
			785.0 - 787.6	2.6'	5.25% Pb	13.80% Zn	2.80 oz. Ag	
			802.0 - 815.0	13.0'	4.50% Pb	6.27% Zn	2.24 oz. Ag	
A-11	74W on Base Line	unknown	379.0 - 387.0	8.0'	6.00% Pb	6.84% Zn	2.10 oz. Ag	
			493.5 - 506.5	13.0'	4.50% Pb	3.87% Zn	0.87 oz. Ag	
			584.0 - 599.0	15.0'	7.37% Pb	11.45% Zn	3.92 oz. Ag	
			693.0 - 700.0	7.0'	2.40% Pb	2.70% Zn	1.38 oz. Ag	
			736.0 - 745.0	9.0'	3.38% Pb	5.28% Zn	1.92 oz. Ag	
A-12	84W 4 + 00N	unknown	674.0 - 1045.0	371.0'	Sulphides, banded			
			1045.0 - 1055.0	10.0'	Massive Sulphides			
A-13	68W on Base Line		133.0 - 219.0	86.0'	Rich Sulphide Ore except for barren section (171.0 - 178.0)			
			388.0 - 404.0	16.0'	Weak Sulphides			
			404.0 - 410.0	6.0'	High Grade Ore			
			428.0 - 509.0	81.0'	Weak Sulphides			

KERR ADDISON MINES LIMITED

(FOR INTER-OFFICE USE ONLY)

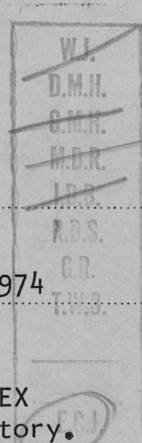

To..... File From..... G. M. Hogg

Subject..... Re: AEX - Vangorda Area Drilling Date..... June 18, 1974

W. Sirola reported today on recently received assay results from the AEX drilling on the Kerr Addison claims in the Vangorda area of the Yukon Territory.

		<u>%Pb</u>	<u>%Zn</u>	<u>%Cu</u>	<u>oz. Au</u>	<u>oz. Ag</u>
Hole A- 8	306.8 - 322.0 (15.2')		7%			1.0
Hole A- 9	434.0 - 479.0 (45.0')	4.32	7.15	0.08	0.02	2.25
Hole A-10	518.5 - 583.0 (64.5')	4.60	9.65	0.17	0.03	2.52
	or					
	518.5 - 623.0 (104.5')	4.39	6.75	0.13	0.03	1.95
Hole A-11	379.0 - 402.0 (23.0')					Massive Sulphides
	494.0 - 505.0 (11.0')					" "
	584.0 - 599.0 (15.0')					" "
	693.0 - 704.0 (11.0')					" "
	727.5 - 746.0 (18.5')					" " & Min. Phyllite

Assuming a width of mineralization of 800' and a possible strike length of 6000 ft., an estimated programme of 20 holes for 15000 ft. (est. \$300,000) will be required.

GMH:rg

G. M. Hogg

June 18/74

Also advised w. Siola hole A-13
at 68 W on Base line shows
good ore from 150 - 213' (63'). Dillyj...

GM

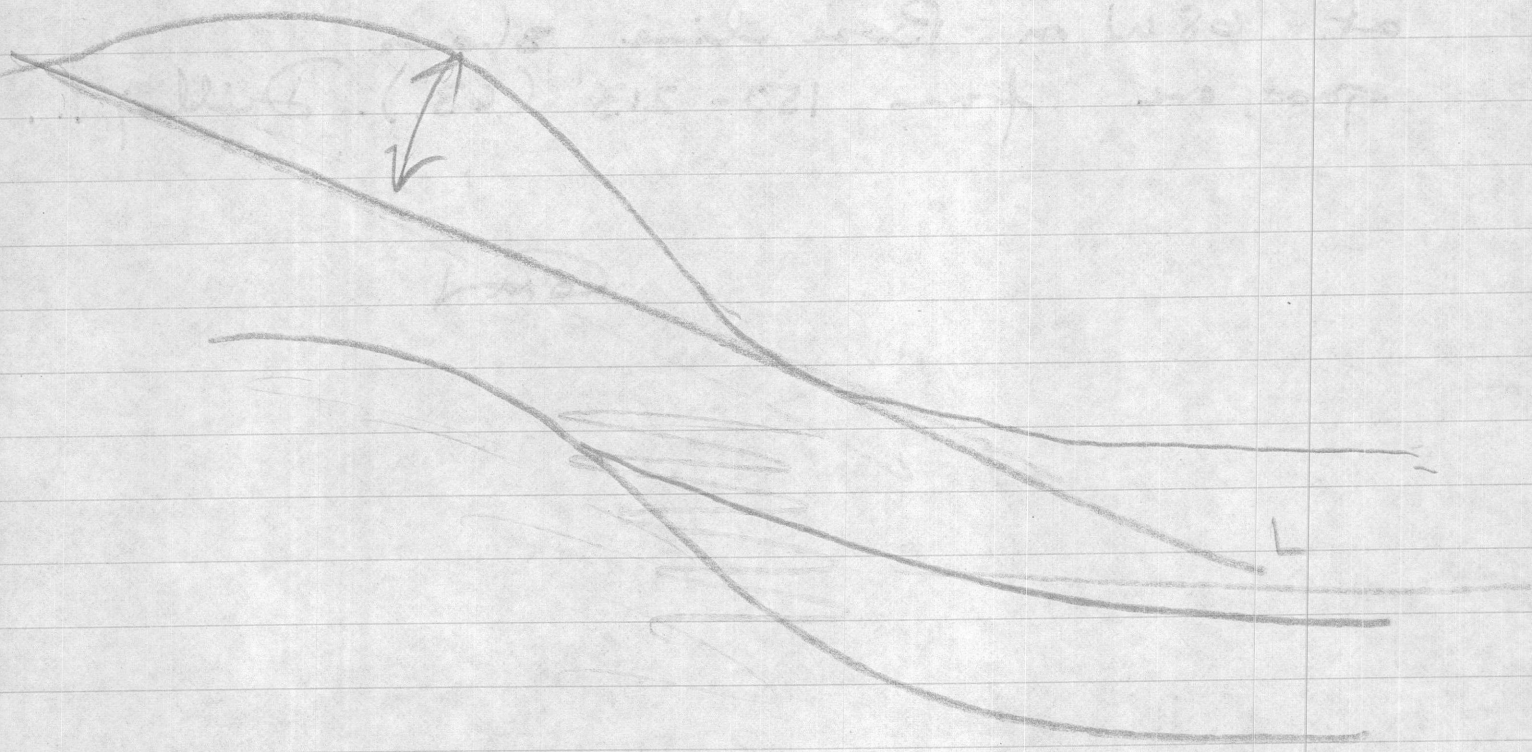

KERR ADDISON MINES LIMITED

(FOR INTER-OFFICE USE ONLY)

of
7.9
7

To..... W. James From..... G. M. Hogg

Subject..... AEX Drill Results -- Vangorda Area Date..... June 27, 1974

We have been advised by AEX Minerals that Holes A-14 and A-15 have been completed. No assays are available, but excellent mineralization is reported as follows:

A-14	76W 3S	895 - 942 (47')	Good Ore Grade
A-15	92W 10N	425 - 434 (9')	Good Ore Grade
		453 - 481 (28')	High Grade
		483 - 496 (13')	Good Ore Grade
		623 - 631 (9')	Mineralized

This is being put on sections which will be up-to-date by tomorrow.

The A-15 intersection is highly significant regarding northwesterly extension (zone is 3,000' long minimum). The A-14 intersection is probably related to the deep mineralization in A-10. This second deep zone has good potential.

G. M. Hogg

GMH:js

KERR ADDISON MINES LIMITED

(FOR INTER-OFFICE USE ONLY)

To..... FILE From..... G. M. Hogg
Subject..... A.E.X. Drilling Results -- Date..... June 6, 1974
 Vangorda Area, Y.T.

of
Y. 9
7

W.J.
D.M.H.
G.M.H.
M.D.R.
I.D.B.
R.D.S.
G.R.
T.W.B.
E.C.J.

A. Aho reported to W. Sirola today that the following results had been received on Hole A-10 (200' N of A-5):

518.5 - 581.0 (62.5')	} EST. 10% Zn, 5% Pb 14.72% Pb, Zn combined, 2.80 oz. Ag.
726.0 - 756.0 (30.0')	
801.5 - 815.0 (13.5')	Estimated as good ore.

Hole A-11 is in progress at a point 200' east of A-4, and is at a depth of 675'. Three intercepts are reported as follows:

379.0 - 402.0 (23.0')	Mineralized.
494.0 - 505.0 (11.0')	Mineralized.
584.0 - 599.0 (15.0')	Mineralized, noted as good ore.

G. M. Hogg

GMH:js

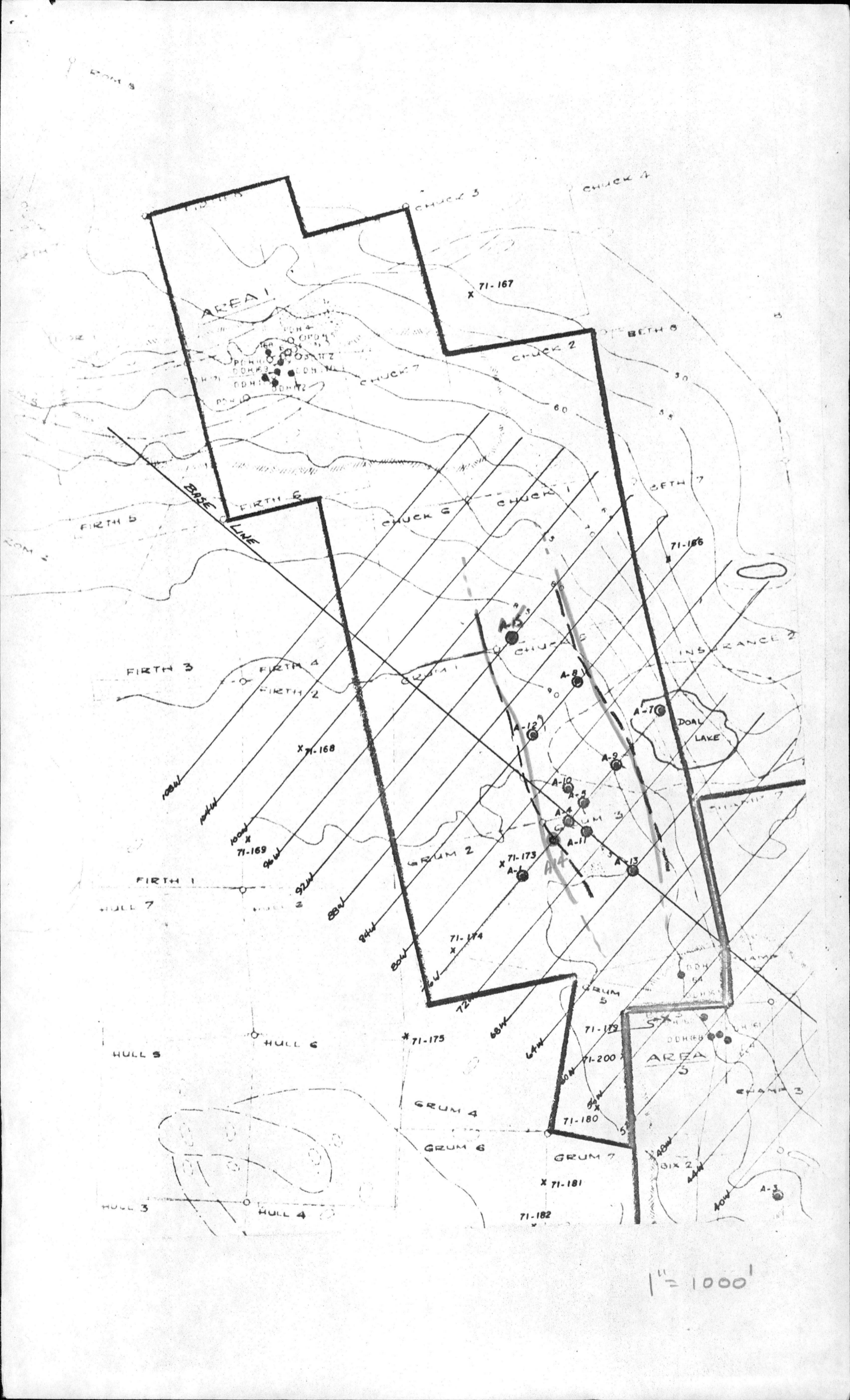

A13

	Depth	Thickness	Pb	Zn	Cu	Au	Ag
A-13	133.5 - 145.5	12	1.25	0.62	0.21	0.01	0.76
	145.5 - 158.5	13	8.10	8.40	0.16	0.04	3.12
	158.5 - 171.5	13	7.65	5.52	0.19	0.05	2.70
	180.0 - 193.5	12.5	5.03	4.20	0.21	0.02	2.68
	- 197.	3.5	1.50	1.90	0.15	0.005	0.86
	- 202	5.0	5.25	5.40	0.20	0.04	2.08
	- 210.5	8.5	1.25	0.16	0.08	0.03	0.99
	- 219.0	8.5	1.63	0.90	0.20	0.02	1.56
	398 - 404	6.0	0.90	2.00	0.03	0.01	0.72
	- 410.5	6.5	3.23	4.74	0.15	0.02	1.98
	428 - 448	20.0	0.80	1.50	0.09	0.01	0.56

Jack