

GEOLOGIC MAP OF THE LAYSIER GROUP

- Altered biotite porphyry
- Greenstone
- Schist, greenish to greyish
- Quartzite, medium gray to dark grey
- Red, brown, yellow ochres staining fractures
- Outcrop area
- | | | |
|--|---|-------------------|
| | } | Geologic contacts |
| | | |
| | | |
- Strike and dip of bedding foliation.
- | | | |
|--|---|-----------------------------|
| | } | Faults, movement indicated. |
| | | |
- Location posts on chained picket line.

Map by pace and compass

Geology and map by D. Tempelman-Kluit.

June 1 & 2, 1963

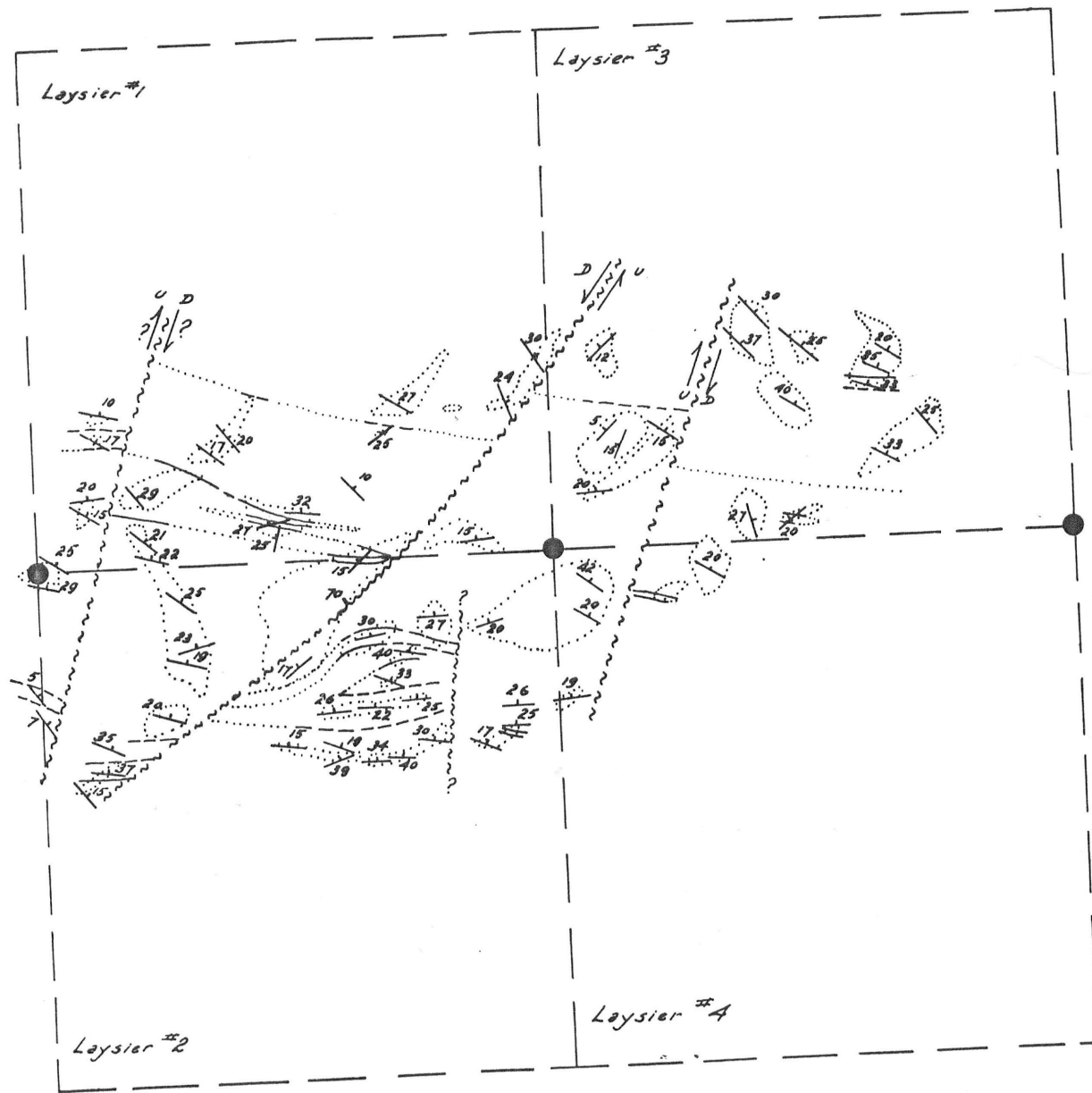

Scale 1" = 500'

019474