

019500

EARN
PROJECT
-1974-
AREA A

Geochemical
Geological
Prospectors
notes

EARN PROJ 74 AREA A

7 June 74

ptly cloudy - otherwise
warm - mod wind
very windy at high elev.

A-1

grey chert w
minimal vt glass py
& some py flakes
in gte veinlets

joints

022

B 83

A-2

rusty, off white

to grey weathering
chert. mostly grey when
fresh - contains up to few
% pyrite as very fine dissem.
or as flakes along fracture planes
or gte veinlets - locally
irregularly banded (see sample A-2).
locally looks as though white
weathering material could be
structurally controlled alteration
of grey - can't get good
measurement of banding looks
to dip gently into hill.

026

joints

B 72

A-3 rusty white to light
 grey weath chert with
 disseminated pyrite - weathering
 diff seems to be a bedding
 controlled feature but also controlled
 by fractures

36
 090
 good

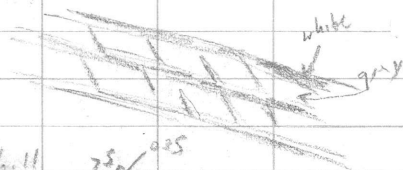

~ 100' up hill 750/035
 massive greenish grey chert
 weathers white to buff

A-4 weakly rusty grey 352
 white weath chert - ⁱⁿ partings
 seems weakly argill here
 some white material is
 coarser grained with hematite
 vugs. (see A-4 sample)

A-5

slightly rusty - grey & lesser
white ~~weather~~ grey chert. 196
thickly bedded with good parting
along bedding(?) and vague lamination

few 100' south
along gut. 305 parting

A-6 Trapped down to see questionable
mass - turned out to be red
mass - grey arg chert rubble
in vicinity

A-7 argillaceous chert - slightly
rusty - weathers light grey to
rusty buff - med grey - has
pronounced fissility but not
a particularly good planar
structure - just go hill grades
into sil shale - grey good planar
fissility - more honey - no fossils noted
Sub no diligent search

A-8

slightly arg grey chert -
thick bedded with bedding
displayed as a parting - sim to
A-5

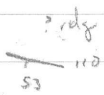

Thick bedded ^{grey} chert and
arg chert - includes 1"
thick band of ^{grey} arg chert

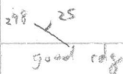

with small white "punk" masses
see sample A-8 - some white weath
arg material has same masses -
more arg rich material here
has sub-vertical fabric which
confuses bedding picture - a
foot film?



A-9 slightly rusty mostly light

gray weath chert and
arg chert - bedding

joints 038

picture is very confused here
could dip down hill! ~ 20-30°
steeper than hillside but very poor
evidence - bright orange-rusty
spot near here - sample A-9 -

no visible mineral - a few vuggy & +3
veinlets - rock is grey slightly arg chert

A-10 yellow brown weath weakly arg
 chert - bedding unclear - strong
 planar weakness not quite
 C parting or on the other
 hand a fissility has
 been measured - numerous gtr
 wrinkles traverse rock as
 is common in these cherts.

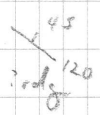

A-11
 Recumbent tight F, fold
 in chert arg chert

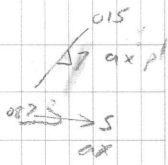

see photo - fold seems
 to be thrust overlain by
 a thrust thus can't give symmetry

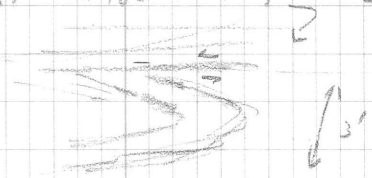

just up with a regularly bedded
 cc



considering predom of shallow dips and
 probable trace of beds folds are
 S folds. 320 F Pacific Rainproof looking E → S extension

9 June 74

A-12 banded v. Eg purplish grey
to light grey banded rhyolite.
could conceivably be altered chert
but strongly suspect this is
a rhyolite - very uncertain
reading on banding

270 \pm 20
+ 20

don't know how representative
this is or even if its from
an o/c -

Rhyolite is impregnated
with fine sulphides probably
mostly py but seems to
be some po - minor
ginkner mineralization but
form is unknown seems to be
veinlets with no strict restriction

A-12-1 sulphide impreg rhy

A-12-2 Pb veinlets. check for
Pb Zn Cu Ag Au

some mineralization along bands
in rhyo but only py?

Just a little up stream <100' is
a good outcrop of chrysolite - quite
well jointed and locally banded

nearly orthogonal
at site



banding is variable and from
one piece 2 separate directions
can be obtained - looks as though
this could be a chrysolite breccia
with banded pinkish to purplish
grey chrysolite matrix and grey
to purplish grey to cream cherty
siliceous fringes with no banding.

Fe sulphides finely impregnated
along bands and in x cutting
veinlets - some "Fragsl.?" contain
dissemin py. Some definite po
here - how best way aroundly
across creek ?

(N-12 is just up stream and
across from sample D-0412-1)

N12 is directly down hill
from a point between 3800-

Another Pb bearing veinlet was found in a float boulder a few feet from 3800-36

See sample A-12-3. Here the very thin veinlet lies with in or zone of bleached rhyolite probably only a few inches thick discordant to banding.

A-12 \Rightarrow 8113 took a FF up well worn trail to investigate possibility of previous work here - appears as though trail is a game trail used to pass a big talus pile up ahead - walked over talus pile lots of fairly sulphide (mainly py some go) rich rhyolites both banded or laminated and massive and some interlayered.

A-13 Pb-Zn showing ~500' up from D6410 galena and sphalerite bearing veinlets apparently along joints - no veins are very wide

veins are within a zone where
 host massive chrysolite has been
 replaced by arsenopyrite (?).
 about $\frac{1}{2}$ the chrysolite here has
 disseminated arsenopyrite but only 1-3%
 or 50 - joints involved trend:

~~130°~~ 130±
 strongest and
 possibly most
 heavily mineralized

050
 80±
 some what less
 well developed
 but maybe
 = mineral

sub hor
 to 110°
 SW dip
 weak
 ? mineral

joints are not good planar ones
 but undulate somewhat and
 are discontinuous

Mineralization seems to occur
 in pockets between joints as
 well as veinlets

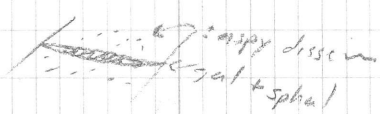

widest pocket seen was $\frac{3}{4}$ inch

10 July 74
cool bit muggy
- slight wind
rain in PM.

A-14. sample of weakly magnetic
pyritiferous and pyroclastic
banded rhyolite - may have
some cpy (200' vs from A13)
another 100' vs. Finley laminat
sulfide bearing finely sverose
lt grey rhyolite (?) (?) -
minor sil arg flt.

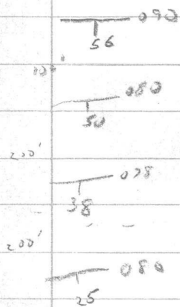

(A-15)

Just across stream from
D6400

Just 2 outcrops are relief
weathering fine gr limy quartz
sandstone interlayered with sil
argillite or very arg chert and
minor impure limestone. At
this pt is a recumbent
fold with axis trending
SE by and ax pl dipping slightly
Nly - could be sharp fold or
could be tectonic

9350c with fold is small thrust
 dipping $\sim 20^\circ$ SW - this
 unit must be ^{variation of} the classic Egan
 gp gneiss - and it seems
 obvious that the lam white
 weathering (rhyolite?) material
 on the talus slope might
 be limy gneiss - perhaps
 A-13 is also at this horizon
 might explain the sudden
 presence of calcite veins.
 limy gneiss weathery & beakled
 as is at side up A-15 is
 sample of limy gneiss

couple 100' or less are
 flat or dip SWly 10° or less -
 seem to be younger and
 contain many coarse calcite
 pockets - and calcite filled
 tension cracks trending 060°
 and vert (\pm) - not as bedding
 is 095 - 255 on lam limy ss

A-16 - silty limestone - lamin ⁰⁰⁵
 sandy sstite siltstn and ^{f-12}
 gray to dark grey siliceous
 argillite with subtle discontinuous
 laminations accentuated by pyrite
 and/or pyrochite - weakly
 magnetic

A-17 siliceous argillite with few
 1/2 fine py in laminations
 and slightly limy sil arg
 also with py possibly some
 pu - samples taken for
 ppm tests

105
 10 ??
 poor rdg.

A-18 ^{to dark grey} grey, silty argillite - weathers
^{and yellowish}
 rusty - minor disseminated py -
 (sample for Zn ppm)

080
 50 good rdg
 100' distance

090
 50 poor rdg

A-19 minor gal occur in banded cherty
role?

A-20 light grey to med grey with
slight purplish tinge - slightly
limy - ^{relief weather} minor dissem po (+py?)
and Fe cpy - see sample
(note: numbered A-19) - ?? rocktype
limy chylite? - maybe an
altered sediment.

A-21 med grey limestone - relief
weather - probably slightly silty.
weather light grey -
a few 100' further on west x bedded
silty limestone - rt side up. ²⁰
large ocs of same - ₁₂₄
weather light grey

A-22 at ss station 4000' #105
have been in ^s arg - thin
bedded - platy - dark grey
to black weather rusty
has same yellow stain
as at A-18 - seems to
be same rock.

have been out of ls unit
 for several 100's of feet
 (I am directly across from
 bulge in opposite ridge
 where shadow begins in
 photo)

Strat sequence in this area is:

thick bedded chert
 and arg chert
 grey silice slates

Pb Zn
 mineral
 occurrences

cherty acid volcanics - ash

fall tubes
 Zn rich black platy
 mud sil arg illite
 (with yellow rusting)

thin silty sandy ls
 interbedded sil arg illite

fine py (postrcp) & limy ss & sst. layers

Kalicas fms
 lower Mississippian
 brachi.

Riddick & Green
 (1961)

Area A rock samples

A-13 display - main showing

✓ W A-12-3 EA-6 Pb Zn Ag - boulder
near geochem flag on
line 3800

✓ A-12-2 EA-7 Pb variable Pb Zn Ag
✓ A-12-1 EA-4 Sph imp rhy ppm Pb Zn Ag
As As

B A R [A-4] EA-3 fault gouge - ppm Cu Pb Zn

A12 → A13 A-5 EA-1 petrographic samples between
stations 12 & 13 on talus slide
+ sample B character sample rusty
pyr tuffaceous chert

B A R [A-9] EA-5 small rusty gossan in
Hump natn cherts. ppm Pb Zn Cu

A-8 petrographic sample
mottled sil arg(?)

A-2 EA-11 petrographic sample tuffaceous
chert.

✓ A13-2 EA-8 main showing Pb Zn Cu Ag Au
(Pb Zn sample)
(isotopes??) Spec

✓ A13-1 EA-9 main showing ~~Pb Zn Cu Ag Au~~
(Aspy sample) Spec
over all ~20% Aspy

EL3-1 EA-10 Cu Pb Zn

✓ EW-1 EA-2 character sample of tuffac.
chfs.
ppms Cu Pb Zn Ag Au As

Area B samples

Hal Dana cliffs west EB 1
" " " east EB 2

100 N 19E ^{EB3} EB4 pet sample vfg banded
rhy

12W trench " EB 5
EB 6 + sulph
bricks

0750W 0760W EB-7

DETWILLER

A
=

7 June 74

Parent. Bed Rock
ALUUVIUM

Texture - sand gravel clay

Horizon develops - good bad

Slope steps red

Line	Station	Horizoy depth	Color	Texture	Slope & direction ↑
4000'	1	8" B	Dark Brown	Sand	South/West
"	2	7" B	"	"	" steep
"	3	9" B	Black	"	"
"	4	6" B	Brown	"	"
"	5	6" C	"	"	"
"	6	10" B	"	"	"
"	7	16" B	Gray	clay	"
"	8	6" B	Light Brown	sand	"
"	9	5" B	Gray Brown	sand	"
"	10	6" B	Light Brown	sand	S/W 260'
"	11	4" B	Gray/ Brown	sand clay	"
"	12	2" B	Black	—	"
"	13	3" B	"	—	"
"	14	4" B	"	Sand.	"
"	15	5" B	Black	Rock chips	"
"	16	2" C	Rock	"	"
"	17	6" C	Black	sand	"
"	18	4" C	Black	gravel	"
"	19	4" C	"	"	north very steep
"	20	5" C	"	"	south
"	21	8" C	Light Brown	gravel clay	"
"	22	10" C	"	gravel	"
"	23	4" C	Brown	rock	north west

We want Horizon
B. below volcanic
sand gravel
direction
of the slope
down

Vegetation	Drainage	Horizon development	Parent material	Other	(D-2)
Small shrubs & Trees	good	poor	B	one layer joins other	NO difference
"	"	"	B		
"	"	fair	B	small pieces of rock (rust)	
"	"	poor	B		
"	"	very poor	B	volcanic ash	
"	"	"	B	NO Horizon B	
"	"	"	B	particles of clay	
"	fair	fair	B	volcanic Ash & clay	NO B
"	"	Good	B		
"	good	fair	B	much rock chips in soil	
"	good	poor	B		
"	poor	very poor	B	clay within 3" of surface	
Small shrubs	"	none	B	NO soil	
"	fair	"	B	"	
very few shrubs	"	"	B		
"	"	poor	B	rock chips	
"	poor	none	B	Traces of rust	beside stream
"	"	poor	B		
"	good	"	B	NO trace of volcanic ash	
"	"	"	B	beside creek	
"	"	"	B	other side creek	
"	"	"	B		
"	"	41	B	gravel 1 in from surface	
"	"	"	B	large NO. of rock (rust on surface)	

Line	Station	Horizon depth	Color	Texture	Slope & N direction ↑
4000!	24	3" C	Brown	rock	North west
"	25	12" C	Brown	gravel	1) med S
"	26	8" C	"	gravel	"
"	27	6" C	Brown	gravel/rock	North
"	28	9" C	Brown	gravel	"
"	29	8" C	Brown	gravel	North east 40°
"	30	14" B	Dark Brown	"	west
"	31	11" B	"	sand	"
"	32	13" B	Light Brown	sand	"
"	33	9" B	med Brown	sand	South west
"	34	12" B	Light Brown	sand	"
"	35	8" B	Dark Brown	gravel	North west 20°

Vegetation	drainage	horizon development	peron material	other
very few shrubs	fair	none	B	rock (rust) on surface
"	"	poor	B	gravel from 2" surface
"	"	"	B	
"	good	"	B	" beside creek
"	"	"	B	rust in soil
"	"	"	B	" above creek
Shrubs & Trees	"	good	B	west side creek
"	"	fair	B	
"	"	poor	B	very sandy soil
"	fair	good	B	"
"	"	fair	B	"
"	good	"	B	rock (rust) on surface

(D4)

8 / June / 74

Line	Station	Horizon -depth	color	Texture	slope & direction
4000	36	6" B	M. Brown	gravel	North steep / west
"	37	10" B	L. Brown	gravel	"
"	38	5" B	M. Br.	sand	"
"	39	12" B	m. Br	sand	North west
"	40	5" B	Gray Br.	sand clay	North / west
"	41	10" C	Light Br.	gravel	"
"	42	13" B	Light Br.	sand	North steep
"	43	8" B	Dark Br.	sand	"
"	44	4" B	"	"	"
"	45	10" B	"	"	"
"	46	3" B	Black	"	"
"	47	4" A	"	veg	"
"	48	7" B	Brown	"	"
"	49	8" A	L. Br.	veg	"
"	50	7" A	Med Br.	"	"
"	51	6" A	"	"	"
"	52	8" A	"	" sand	"
"	53	10" B	Light Br.	sand	"
"	54	12" B	Gray Black	"	East
"	55	8" A	Med Br.	veg.	East
"	56	14" B	Dark Br.	clay sand	"
4600					
"	57	8" C	RUST	gravel	North east
"	58	5" B	light Br.	gravel	"
		below B		sand gravel	

vegetation	drainage	horizon development	parent material	other	(D.S)
Moss & shrubs	good	poor	B	large quantity of rocks (rust)	
"	fair	"	A	"	
"	"	very poor	B	very little soil	
"	good	fair	B		
more trees	fair	poor	A	Beside small stream	
Moss & shrubs	poor	poor	B	fine chips rock very little dirt	
"	poor	none	B	"	
"	fair	poor	B	face of cliff rock (rust)	
MOSS	"	none	B	on rock side crust everywhere	
MOSS & shrubs	poor	poor	B	west side of small stream	
"	very poor	none	A	permafrost 2 inch from surface	
many small shrubs	"	poor	A	west side " East side stream	
"	fair	"	A	permafrost	
"	"	none	A	East side small stream	
"	"	"	A	East another stream	
"	"	"	A		
few shrubs	"	"	A	permafrost 2" below surface	
"	"	fair	A		
Trees	"	"	A		
"	"	"	A		
"	poor	poor	A	North west of creek	
MOSS	good	none	B	South west creek	
MOSS	fair	poor	B	"	

Line	Station	Horizon depth	Color	Texture	slope & direction
4600	59	8" B	med Brown	sand gravel	NORTH/east steep
"	60	10" B	"	"	"
"	61	11" B	light Br.	sand rock	"
"	62	10" B	"	"	"
"	63	12" B	"	"	"
"	64	9" B	med Br.	"	"
"	65	8" B	"	"	"
"	66	4" A	Light Brown	Sand	"
"	67	" B	Black	"	"
"	68	3" B	"	"clay	NORTH
"	69	4" A	"	"	"
"	70	4" B	"	Sand & clay	"
"	71		Rock	slide	steep
"	72	8" B	med Br.	rock	"
"	73	5" B	"	rock	north/ west
"	74	8" B	Light Br.	gravel sand	"
"	75	4" B	"	"	west
"	76	6" B	"	"	"
"	77	4" B	"	rock	"
"	78	6" B	Light Brown	Gravel	"
"	79	8" B	"	"	"
"	80	6" B	"	"	"
"	81	5" B	"	"	"
"	82	4" B	med Br.	"	"
"	83	"	"	"	"

Vegetation	drainage	development	materials	Other	(D6)
Moss	fair	good	B	SOUTH	West
"	"	Fair	B		crack
Moss & shrubs	"	"	B		"
"	poor	"	B	Beside	rock shelf
"	"	poor	B	Below	rock shelf
"	"	"	B		
Moss	"	none	B		
" "	fair	none	B	organic	
shrubs	poor	poor	B		
Moss	very poor	none	B	Flat part	ridge
"	"	"	B	above	rock (rust)
"	"	"	B	organic	
NO	Sample				
Moss	good	poor	B	surrounded	by rock
"	"	"	B	"	
" & shrubs	Fair	Fair	B		
rock	good	none	B	Flat part	of ridge
"	"	"	"	"	
"	"	"	B	surrounded	rock (rust)
rock moss	"	poor	B	"	
" & shrubs	"	"	B	"	
"	"	"	B	"	
Moss	good	"	B		
moss rock	"	"	B		
"	"	"	"		

4600 83

9 June 74

Line	Station	Horizon Depth	color	Texture	slope & direction
4000	84	8" B	Med Br.	sand clay	south west slight slope
"	85	10" B	Black	sand	SOUTH
"	86	6" A	"	"	"
"	87	12" A	"	"	" med. slope
"	88	10" B	Black Gray	"	"
"	89	8" B	Light Br.	sand clay	"
"	90	6" B	Dark Br	"	south east med.
"	91	9" B	"	"	SOUTH
"	92	13" A	Black	clay	"
"	93	6" B	Dark Br.	sand	south west med
"	94	10" B	Gray Light Br	"	SOUTH
"	95	12" B	Black	sand	"
"	96	6" B	Gray Black	gravel	"
"	97	5" B	"	sand	"
"	98	8" B	"	clay	"
"	99	7" B	Black	sand clay	"
"	100	10" B	light Br.	sand	SOUTH
"	101	12" B	Dark Br.	sand	"
"	102	8" B	"	"	"
"	103	10" B	Med Br.	"	"
"	104	11" B	Light Br.	"	"
"	105	8" B	"	gravel	"
"	106	10" B	Black	clay	"
"	107	11" B	light Br.	sand	"
		B		gravel sand	

Vegetation	drainage	horizon development	material	other
moss trees shrubs	fair	very good	A	
"	good	poor	A	
"	poor	NONE	A	perma frost 6" from surface
"	very poor	"	A	organic
"	poor	poor	A	
"	fair	Fair	A	
"	"	"	B	perma frost 6" down
"	poor	poor	B	
"	"	"	B	
"	"	"	B	perma frost 6" down
good sized trees	good	fair	B	
"	poor	very poor	B	
moss grass trees	"	poor	B	
"	"	NONE	B	
"	"	poor	B	
"	"	"	B	
"	good	fair	A	
"	good	poor	A	
" + grass	fair	"	A	
moss trees	good	fair	B	
"	"	poor	B	
shrubs + trees	very good	fair	B	surrounded by rocks (rust)
"	poor	poor	B	
"	good	fair	B	

Line	Station	Horizon Depth	Color	Texture	Slope & direction
4000	108	7" B	Black	sand	South
"	109	10" B	Black	clay	"
"	110	6" B	Brown	sand	"
"	111	7" B	"	"	"
"	112	7" B	Black	sand clay	"
"	113	8" B	"	"	"
"	114	10" B	"	"	"
"	115	13" B	Dark Brown	sand	"
"	116	8" B	light Br.	"	"
"	117	9" B	med Br.	"	"
"	118	11" B	Dark med Br.	"	"
"	119	6" B	med Br.	"	"
"	120	12" B	Dark Br.	"	"
"	121	8" B	Gray L. Br.	sand clay	"
"	122	12" B	Med Br.	sand	"
"	123	8" A	Black	clay	"
"	124	12" B	Br.	sand	"
"	125	6" B	Dark Br.	"	"

Vegetation	drainage	horizon	parent material	Other
Moss Trees	Fair	Poor	B	
"	Poor	"	B	
"	Good	"	A	
"	Fair	Poor	A	Beside Very Small stream
"	Poor	"	1A	permafrost 7" on surface
"	very poor	Fair	B	
"	Poor	none	B	
"	Poor	Fair	A	
" + shrubs	Poor	Poor	A	Beside small stream
"	good	"	B	
"	Fair	Fair	B	
"	good	Poor	B	
"	Fair	"	A	
"	Fair	Fair	A	
"	good	Poor	A	
"	Poor	"	B	
"	Fair	Fair	B	
more trees	Poor	Fair	A	north of stream

10 June 74

Line	Station	Horizontal Depth	Color	Texture	slope direction
4210	126	8" B	med Br.	Gravel	North/steep
"	127	12" B	light Br.	"	"
"	128	3" A	Black	sand	North west
"	129	7" B	Light Br.	sand clay	"
"	130	5" B	med Br.	"	"
4610	131	6" B	"	Gravel Clay	" steep
"	132	8" B	"	"	"
"	133	5" B	Light Br.	Gravel	"
"	134	7" B	Light Br.	Gravel	"
"	135	8" B	med Br.	Gravel	"
"	136	11" B	"	Gravel	"
"	137	7" B	Light Br.	"	NORTH
"	138	14" B	med Brown	sand gravel	NORTH

gravel
sand

Vegetation	drainage	horizon development	perenn material	other
Moss shrubs	good	poor	B	surrounded by rock (rust)
"	"	fair	B	below rock shell.
small trees	poor	None	A	organic permafrost 3" down
Moss	poor	poor	B	
Moss Trees	very poor	poor	B	Beside main stream flowing N/E
Moss	fair	fair	B	surrounded by rock (rust)
"	fair	poor	B	"
"	good	poor	B	"
"	good	fair	B	In moss clearings between rock slides
"	"	"	B	"
Moss	good	None	B	very little dirt, mostly rock
"	"	poor	B	above the join of two streams
"	fair	Good	B	surrounded by rock (rust)

11 June 74

X
camp

E

N

S

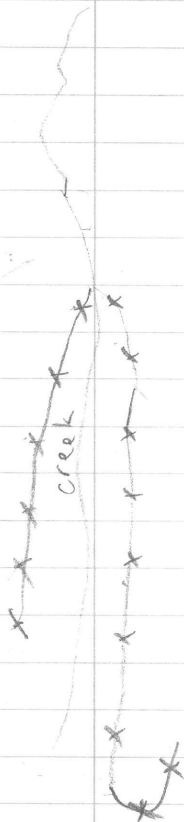

W

Line	Station	Horizon Depth	Color	Texture	slope & direction
3650	139	13" B	med Br	sand	south east gentle
"	140	12" A	Black	"	"
"	141	9" B	Dark Br.	"	"
"	142	6" A	Black	"	"
"	143	8" B	Grey Brown	sand clay	"
"	144	12" B	Grey Brown	sand	"
"	145	6" B	Light Br.	sand clay	North west gentle
"	146	14" B	Grey	sand gravel	North west med. steep
"	147	12" A	Black	clay	North west steep
"	148	10" A	"	"	"
"	149	12" B	Gray Br.	sand gravel	" med steep
"	150	14" B	Gray	"	"
"	151	14" B	Gray Brown	sand gravel	"
"	152	7" B	Light Br.	sand	south west
"	153	9" B	med Brown	sand clay	south

Vegetation	Drainage	Horizontal development	Percent material	Other
moss-shrubs	good	good	A	
Trees	fair	poor	A	permafrost 12" down
"	poor	poor	A	permafrost 8" down
"	"	none	A	organic
"	poor	poor	A	
"	good	none	A	Beside stream
"	fair	fair	A	No layers crossed over stream
fern trees	fair	poor	A	Base of hill
"	poor	poor	A	organic
"	poor	poor	A	organic
Moss Trees	fair	poor	B	
"	good	fair	B	rock slowing Through moss
"	fair	good	B	starting to round corner of ridge.
Moss Trees	good	good	B	Top of ridge.
"	fair	good	B	"

Line	Station	Horizon Depth	Color	Texture	Slope + direction
4350 28 W	00 N	8" B	Dark Brown	sand	North West gentle slope
4330 28 W	02 N	6" A	Black Ash	sand ash	"
4280 28 W	04 N	12" B	Med Br.	sand	"
4250 28 W	06 N	4" A	Dark Br.	sand	"
4240 28 W	08 N	3" A	"	sand	"
4220 28 W	10 N	6" A	Med Br.	sand	flat marsh
4260 24 W	10 N	4" A	Dark Brown	sand	North
4285 24 W	8 N	7" A	"	"	West
4340 24 W	6 N	5" A	"	"	Gentle Slope
"	4 N	10" A	"	sand clay	"
4350 24 W	2 N	9" B	Med Brown	"	"
4378 24 W	2 N	6" A	"	"	"
4380 34 W	00 N	10" A	Med Br.	sand	"
→ was 20 ft below 20 W, 00 N →					
4460 12 W	00 N	8" A	Dr. Br. Ash	sand	North West
4470 12 W	2 N	7" A	"	"	"
4490 12 W	4 N	6" A	Black	sand clay	Gentle
4480 12 W	6 N	12" B	Grey Brown	sand	slope
4460 12 W	8 N	4" A	Dr Brown	sand	"
4450 12 W	10 N	7" B	Med Br.	sand	"

Vegetation	drainage	Horizon Development	Percent Material	Other
MOSS shrubs few trees	Fair	fair	B ?	
"	poor	good	B ?	ash + org.
"	very poor	good	B ?	Beside surface rock
"	fair	NONE	B ?	permafrost 3" surface
"	fair	poor	A	Beside small stream
"	very poor	poor	A	Beside larger stream, marsh
"	fair	poor	A	Beside stream & pools of water
"	fair	fair	B ?	side of small hill
"	Good	fair	B	
"	very poor	NONE	A	pools of water around
"	Fair	fair	A	Beside small stream
"	fair	poor	B ?	
"	poor	fair	B ?	

and 30 ft N. of BL.

"	Fair	good	B ?	
"	fair	fair	B ?	
"	very poor	NONE	B	side of small hill
MOSS shrubs	good	poor	B	" " "
Fewer Trees	fair	NONE	B ?	" "
"	good	fair	B ?	" "

LINE	STATION	HORIZON DEPTH	Color	Texture	slope + Direction
4580 4W	10NB	14" B	gray	sand clay	Top of ridge
4590 4W	8NB	10" B	"	Gravel	"
4580 4W	6NB	9" A	Light br.	Sand	south gentle
4575 4W	4NA	6" A	Black	sand	"
4515 4W	2NA	7" A	"	"	"
4480 4W	00NA	9" A	Black	"	"

Came within 15 feet of

vegetation	drainage	Horizon	Percent	Material	Other
moss few shrubs	fair	poor	B.		surrounded by rock chips
"	poor	poor	B.		
"	good	poor	B		starting to descend from ridge
more moss	fair	none	B.		
"	poor	poor	B?		
"	poor	fair	B?		some ash in sample
mark on Baseline					

Line	Station	Harrow Depth	Color	Texture	Slope & Direction
4490 16W	02 S	6" A	med Br.	sand	South slight
4480 16W	04 S	14" B	Grey Br.	Clay gravel	"
4470 16W	06 S	8" A	Black	sand	"
4460 16W	08 S	9" A	"	"	"
4450 28W	08 S	10" A	Black	sand	"
4460 28W	06 S	8" B	Grey	sand Gravel	"
4480 28W	04 S	6" A	Grey Asl	sand	"
4470 28W	02 S	6" A	Black	sand	"

came out half-way between

Line	Station	Horiz Depth	Color	Texture	Slope & Direction
4580 08 E	00N	8" A	Dark Br.	sand	south very gentle
4587 08 E	02N	7" A	Dark Br.	"	"
4610 08 E	04N	8" A	Black	clay	"
4615 08 E	06N	10" B	Grey	clay gravel	"
4630 08 E	08N	14" B	"	"	"
4620 08 E	10N	12" B	"	"	"
4625 04 E	10N	10" A	Dark Br.	sand	"
4620 04 E	8N	8" A	ash	"	"
4605 04 E	6N	6" A	"	"	"
4590 04 E	4N	6" A	"	"	"
4585 04 E	2N	8" A	Black	sand clay	"
4580 04 E	00N	7" A	Dark Br.	sand	"

Lines from Base Line

4530 00 W	02S	8" A	Dark Brown	sand	Break of slope
4470 12 W	08S	10" A	Dark Br.	sand	south
4490 12 W	06S	9" A	Dark Br.	sand	south slight
4510 12 W	04S	12" A	Light Br.	sand	"
4530 12 W	02S	6" A	Med Br. black	"	"

Came out about half way between

vegetation	drainage	Horizontal development	Vertical material	Other
moss shrubs few trees	fair	fair	B?	some ash in sample
"	poor	good	B?	"
"	"	fair	B?	"
"	fair	poor	B?	depression between hills
"	good	poor	B?	side of small hill (west)
"	poor	NONE	B?	"
"	fair	poor	B?	"
"	fair	fair	B?	some ash
"	fair	good	B?	in sample
"	poor very	fair	B?	"
more trees	poor	NONE	B?	"
"	fair	fair	B	Break of slope
T6 Trees shrubs moss	Break of slope			
"	fair	poor	B	Break of slope
"	fair	poor	B"	Break of slope
"	poor	poor	B	Break of slope
"	fair	poor	B"	organic
"	poor	poor	B	"

0.8 W + 0.12 W about 15 south
of B.L

vegetation	drainage	Horizo develop.	Parent Material!	Other
moss shrubs Trees	poor	poor	B?	
"	fair	NONE	B.	near rocks on surface
"	very poor	NONE	B	
"	poor	poor	B	Break of slope
"	poor	poor	B.	Break of slope
"	fair	NONE	B	
"	poor	good	A.	ASK
"	fair	good	A.	

L 28w 9 L 24w

ECCLES

A
=

PARENT MATERIAL ; BED ROCK

ALUVIUM

TEXTURE - SAND, GRAVEL, CLAY

COARSENESS, SORTING

- REMAINS OF VEG

HORIZON DEVELOP - GOOD BAD

SLOPE ↑ 60 STEPS, 100'

PACE 65 STEPS = 200'



LINE	Station	Depth	col/or	texture	SLOPE & DIRECTION
3800'	1	B / 8"	DARK GREY / BROWN	FINE GRAINED WITH SOME RX.	SW / 239° STEEP
	2	B / 9"	DARK GREY BROWN	SANDY FINE	221° STEEP
	3	B / 11"	GREY	FINE SANDY	229° STEEP
	4	A VOL ASH / 12"	BROWN	VEG VOL ASH	STEEP 255°
	5	B / 6"	GREY	SANDY + ROCK FRAG.	230°
	6	B / 8"	GREY	SANDY	221° V. STEEP
	7	B / 4"	GREY	SANDY WITH RX	266° V. STEEP
	8	B / 6"	GREY	SANDY + RX	247° V. STEEP
	9	B / 8"	GREY	SANDY + RX	241° STEEP
	10	A / 12"	LIGHT GREY + BROWN	VOL. ASH VEG	251° STEEP
	11	B / 8"	GREY	SANDY + RX	241° STEEP

plotted

VEGETATION	DRAINAGE	HORIZON DEVELOPEMENT	PARENT MATERIAL A OR B	OTHER OUTCROPS, CLAIM POST	PIES (E-2)
TREES & LOW SHRUBS	GOOD FAIR	POOR	B		
TREES & SHRUBS	FAIR	POOR	ABS	SUGHT DEP	
TREES & SHRUBS	GOOD	POOR	A	SLIGHT DEP.	
//	FAIR	FAIR (PERMA)	A		
✓/	FAIR	FAIR	B		
SHRUBS	FAIR	FAIR	B		
TREES + SHRUBS	FAIR	FAIR	B		
TREES + SHRUBS	FAIR	FAIR	B		
TREES	FAIR	FAIR	B		
TREES	FAIR PERMA.	GOOD	A		
TREES	FAIR	GOOD	B		

LINE	STATION	HORIZ. DEPTH	COLOR	TEXTURE	SLOPE & DIRECTION
3800	12	B / 8"	GREY	SANDY - RY	↙ 244
	13	B / 6"	GREY	SANDY SOME VOL. ASH (PERMA)	↖ 300 STEEP
	14	B / 3"	GREY	SANDY	↖ 296 STEEP
	15	B / 8"	'BLACK'	GRAVEL	↖ 332 V. STEEP
	16	B / 10"	GREY	GRAVEL	↖ 332 V. STEEP
	17	B / 7"	GREY	GRAVEL	↖ 318 V. STEEP
	18	B / 11"	BROWN	GRAVEL	↖ GENTLE
	19	A / 7"	BROWN	ORGANIC FINE GRAINED (PERMA)	↖ 320° GENTLE
	20	B / 10"	BROWN	GRAVEL (PERMA)	↖ GENTLE
	21	B / 6"	BROWN	GRAVEL	↖ 340° GENTLE

Plotted

VEG	DRAINAGE	HORIZON DEVELOPMENT	PARENT MAT A OR B	OTHER (E3)
TREE & SHRUBS	FAIR	GOOD	B	ROUND FACE OF HILL
DECIDUOUS TREES	POOR	GOOD	A/B?	
TREES & SHRUBS	POOR	POOR	B	DRAW BETWEEN 2 HILLS
TUNDRA SOME SHRUBS	FAIR	POOR	B	HILL FACE
"	FAIR	POOR	B	
"	FAIR	POOR	B	
TREES & SHRUBS	POOR	POOR	B	LAND LEVELLING OUT (NEARING 'AMP' VALLY)
MOSS & TREES	POOR	POOR	A	STREAM VALLEY (NE SIDE OF STREAM)
SHRUBS & MOSS	FAIR	POOR	B	ALUVIAL FAN 
SHRUBS & MOSS	FAIR	FAIR	B	

LINE	STATION	HORIZON DEPTH	COLOR	TEXTURE	SLOPE & DIRECTION
3800	22	B / 3"	BROWN	COURSE GRAVEL	N 332° MED.
	23	A / 6"	BROWN	FINE GRAINED VEG. (PERMA)	↖ 328 MED
	24	A / 8"	BROWN	VEG. (PERMA)	↖ 340 MED
	25	B / 6"	BROWN	GRAVEL	↖ 340 GENTLE
	26	B / 7"	BROWN	FINE GRAINED	↖ 244 GENTLE
	27	A / 6"	BROWN	ORGANIC	↖ 295 STEEP
	28	A B / 8"	BLACK	ORGANIC FINE GRAINED	↖ 318 STEEP
	29	A / 6" PERMA	BLACK	FINE VEG.	↖ 318 STEEP

P6 Hcd

VEG	DRAINAGE	HORIZONTAL DEVEL	PERCENT MAY A STOPS	OTHER	(E-4)
TREES & SHRUBS	FAIR	FAIR	B	JUST SW OF CAMP.	
TREES + SHRUBS	FAIR	POOR	A	ABOVE CAMP. BASE OF SLOPE	
TREES & SHRUBS	FAIR	POOR	A	BASE OF SLOPE	
TREES + TUNDRA	FAIR	POOR	B	50' SW OF RIVER BY / x CAMP.	
TREES + SHRUBS	FAIR	GOOD	A	x / OTHER SIDE OF CREEK	
//	//	POOR	A	STREAM VALLEY	
//	//	//	A	ENTERING OTHER STREAM	
//	//	//	A	VERGING UP STREAM	
			:		

8 June 74

(E-5)

~~XXXX~~

LINE	STATION	HORIZONS	COLOR	TEXTURE	SLOPE & DIRECTION
		DEPTH			
3800	30	B / 8"	GREY	SANDY R VEG	↗ 308° V. STEEP
	31	B / 4"	GREY	SANDY + RX	↗ 308 V. STEEP
	32	B / 3"	GREY		↗ 311 W. STEEP
	33	A / 8" PERMA	BROWN	VEG FINE SAND	↗ 10° V. STEEP
	34	A / 6" PERMA	BROWN	VEG	↗ V. STEEP
	35	A / 7" PERMA	BROWN	VEG	↖ 320 ↗ 340 V. STEEP
	36	A / 9" PERMA	BROWN		↗ 340 V. STEEP
	37	B / 4"	DARK GREY	GRAVEL DIRT	↖ 322 GENTLE
	38	B / 3"	BROWN (DARK)	VEG SAND	↗ 16° MED
	39	A / 2" PERMA	BROWN	VEG	↗ 338 V. STEEP
	40	NO	SAMPLE		TAKEN ↗ 16°
	41	A / 6"	BLACK DIRT plotted	DIRT	↖ STEEP RIVER 15 AGS

VEG.	DRAINAGE	HORIZON DEV	PARENT MATERIAL A OR B	OTHER CUTCROPS	(E-6)
TREES + SHRUBS	FAIR	POOR	B	RIDGE BETWEEN 2 RIVERS	X/S
"	"	FAIR	B	MOVING UP STREAM VALLEY	
DECID TREES	"	"	B	EDGE OF 'ZUFIC' BLUFF	
SHRUBS	"	POOR	A		
"	"	"	A		
"	"	"	A	VERGING DOWN TOWARDS RIVER	
"	"	"	A	20' NE. SMALL STREAM	
DEC TREES	"	FAIR	B		
TREES + SHRUBS	"	POOR	A	MIDDLE OF ANIMAL PATH	
SHRUBS	"	"	A	STREAM VALLEY NARROWING	
TREES + SHRUBS	"	"	A	TALUS BLOCKS BESIDE RIVER	

LINE	STATION	HORIZON Depth	COLOR	TEXTURE	SLOPE & DIRECTION
4400'	1	A / 6"	BROWN	VEG SOIL	→ STEEP
	2	A / 8"	BROWN	VEG SOIL	→ STEEP
	3	A / 6"	BROWN	VOL ASH VEG	↗ 66° STEEP
	4	B / 4"	GREY	CLAYISH	↗ 66° STEEP
	5	A / 6"	DARK GREY	VEG CLAYISH	→ STEEP
	6	A / 10"	GREY.	VOL. ASH VEG	↗ 80° STEEP
	7	B / 16"	LIGHT BROWN	GRAVEL	↗ 60°
	8	A / 12"	GREY	VEG VOL. ASH	↗ 68° STEEP
	9	B / 8"	LIGHT BROWN	SANDY	→ STEEP
	10	B / 4"	LIGHT BROWN	SANDY + RX	→ STEEP
	11	B / 6"	"	SANDY	↗ V. STEEP
	12	B / 4"	"	"	↗ "
	13	A / 8"	GREY	VOL ASH SANDY	"
	14	A / 8" PERMA	BROWN	VEG	"
	15	A / 9"	BROWN	VEG	↗ 37° STEEP
	16	NO.	SAMPLE		
	17	A / 10"	BROWN	SANDY	↗ 326° STEEP
	18	A / 6"	BROWN	VEG	↗ 310° STEEP
	19	B / 8"	BROWN	SANDY + RX + VEG	↗ 348° STEEP

PHED

VEG	DRAINAGE	HORIZONTAL DIVERS	PARENT MATERIAL	OTHER (E-7)
TUNDRA	GOOD	POOR	A	ADJACENT TO FOLDED BED OUTCROP 
DECID TREES	FAIR	POOR	A	//
TUNDRA	GOOD	POOR	A	TALUS SLOPE ON 2 ND ARY RIV.
LOW SHRUBS	FAIR	FAIR	B	.
DECID TREES	POOR	POOR	A	DEPRESSION IN SLOPE
TUNDRA	GOOD	FAIR	A	FLAT FACE OF SLOPE, DEP. TO THE SOUTH.
TUNDRA	FAIR	FAIR	B	EDGE OF SLOPE BEFORE A DEP.
TUNDRA	GOOD	POOR	A	BESIDE A VERY STEEP GULLY RUNNING NE. (N. SIDE)
LOW SHRUBS	GOOD	POOR	B	MOVING UP SLOPE OF PREVIOUS DEP
TUNDRA	GOOD	FAIR	B	ON CREST OF HIL CURVING DIRN. OF MAIN RIV
TREES & SHRUBS	POOR	POOR	B	LOOK DIRECTLY ON MAIN RIV.
//	FAIR	POOR	B	//
TUNDRA	//	//	A	JUST ON EDGE OF DEP
//	//	//	A	ABOVE STEEP CLIFF
//	//	//	A	BELOW LARGE OUTCROP (CHERT
//	//	//	A	TALUS SLOPE N. STEEP BLUFF
//	//	//	A	DEP TO WEST
//	//	FAIR	B	CENTER OF DEP

LINE	STATION	HORIZONTAL DEPTH	COLOR	TEXTURE	SLOPE DIRECTION
4400	20	B 1/4"	BROWN	GRAVEL	↙ 239 GET 1 LB
	21	A 1/6"	BROWN	GRAVEL VEG	↙ 234 STEEP
	22	A 1/2"	BROWN	VEG GRAVEL	
	23	B 1/1"	BROWN	DIRT R ₃	↙ 240° STEEP
	24	A 1/6"	"	"	"
	25	A 1/6"	"	"	"
	26	A 1/4"	"	DIRT	↙ 226 STEEP
	27	A 1/8" PERMA	"	VEG	↙ 253° STEEP
	28	B 1/4"	"	ROCK CHIPS	↗ 260

P/A-1

VEG	DRAINAGE	HORIZONS DEV	PARENT MATERIAL	OTHER (E8)
TUNDRA	GOOD	FAIR	B	ON TOP EDGE OF ROCK BLUFF LOOKING DOWN TO CAMP
SCRUB	GOOD	POOR	B	HEADING UP RIVER TALUS SLOPE
"	"	"	B	TALUS
SHRUB	GOOD	FAIR	B	TALUS
"	FAIR	POOR	B	"
SCRUB TREES	GOOD	POOR	B	"
S SHRUB	GOOD	POOR	B	"
"	POOR	"	A	NEARING HEAD OF CAMP RIV
—	GOOD	"	B	IN RIV VALLEY

E9

9 July 74

LINE	STATION	HORIZON	COLOR	TEXTURE	SLOPE
		DEPTH			DIRN.
3800'	42	B 1/2"	BROWN	SANDY	↓ GENTLE
	43	B 1/8"	"	"	↓ 140 STEEP
	44	A 1/2"	"	VEG	↓ 116° STEEP
	45	A 1/16"	BROWN + GREY	VEG & SANDY	↓ 136°
	46	A 1/6"	BROWN	VEG	↓ 153 MED
	47	A 1/8"	DARK BROWN	"	↓ 200° MED
	48	B 1/7"	BROWN	SANDY	↓ MED
	49	B 1/6"	"	SANDY + RICKS	↓ 158° MED
	50	A 1/12"	PERMA GREY	VOL ASH	↓ 150° STEEP
	51	B 1/18"	GREY	SAND + RX	↓ 220° STP
	52	B 1/10"	BROWN	SANDY	↓ 202° STP
	53	B 1/8"	"	SANDY + RX	" ↓ STP
	54	B 1/2"	"	"	↓ 120 V. STEEP
	55	B 1/8"	"	"	↓ 136 V. STP
	56	A 1/8"	" PERMA	VEG SAND	↓ 124 STP
	57	B 1/6"	GREY	SANDY	↓ 164 STP
	58	A 1/12"	BROWN	DIRT	↓ 140 STP
	59	A 1/12"	"	"	↓ 145 V. STP
	60	B 1/2"	"	SAND & RX	↓ STEEP
	61	B 1/9"	"	"	"
	62	B 1/10"	"	"	"
	63	B 1/10"	DARK GREY	SANDY	↓ 180 STP
	64	A 1/16"	BROWN	VEG	↓ 168°
	65	A 1/10"	GREY BROWN	VOL ASH	↓ 168°
		PERMA	BROWN	VEG	↓ MED

Plotted

VEG	DRAINAGE	DEV.	PARENT MAT A OR B	OTHER	(E10)
TREES & SHRUBS	GOOD	GOOD	A	LOOKING DOWN ON R. RIV.	
TREES	"	"	"		
"	POOR	POOR	A	LOOKING DOWN TO CAMP	
"	FAIR	FAIR	A	INA DEP	
"	"	POOR	A	"	
"	"	"	A	CROSSED OVER WASHOUT	
"	GOOD	FAIR	A		
"	"	GOOD	B		
"	FAIR	"	A		
"	"	FAIR	B	CROSSED OVER SPOKE WHICH IS R. E.	
"	GOOD	GOOD	B	STILL LOOKING DOWN AT CAMP	
"	"	"	B	"	
"	"	"	B	HILL STARTING TO CURVE UP RIV	
"	"	"	B	A CROSS FROM RIDGE SEPARATING CAMP & MAIN STRAAN	
"	FAIR	POOR	A		
"	POOR	FAIR	B		
"	"	POOR	A	MOVING UP RW	
"	"	"	A		
"	GOOD	"	B	PASSED OVER A DEPRESSION	
"	"	FAIR	B		
"	"	GOOD	B		
"	POOR	POOR	A	N.E. OF SMALL STREAM	
"	FAIR	FAIR	A		
"	POOR	POOR	A	ACROSS FROM LARGE TALUS SLOPES (CROSS)	

LINE	STATION	HORIZON DEPTH	COLOR	TEXTURE	SLOPE / DIRN
3808	66	A/12"	BROWN	VEG	↓ V. STP
	67	A/10"	"	"	"
	68	A/12"	" PERMA	"	↓ 196 V. STP
	69	A/18"	"	"	↓ V. STP
	70	A/20"	"	SANDY VEG	↓ 220 STD
	71	A/8"	" PERMA	"	↓ 218 MED
	72	A/8"	" PERMA	VEG	"
	73	A/6"	" PERMA	"	↓ 220 SPD
	74	A/8"	" PERMA	"	"
	75	A/12"	" PERMA	"	"
	76	A/12"	" PERMA	"	"
	77	A/10"	" PERMA	SANDY VEG	↓ 200 STP
	78	A/10"	" PERMA	"	↓ 210 GENTLE
	79	A/14"	" PERMA	VEG	↓ 198 GENTLE
	80	A/14"	" PERMA	"	↓ 228 "

Plotted

VEG	DRAINAGE	HORIZON DEV	PARENT MAT A OR B	OTHER
TREES	POOR	POOR	A	(E 11)
"	"	"	"	
"	"	"	"	CROSSED OVER WIDE DEPRESSION
"	GOOD	"	A	ON RIDGE OF A SLOPE
"	"	"	A	BESIDE CHEST OUTCROP ON
"	POOR	"	A DEP	RISE BETWEEN 2 DEP
"	"	"	A	IN A WASH DIT
"	FAIR	"	A	
"	POOR	"	A	
"	"	"	A	RIVER CURVES S.W. ↙
"	"	"	A	
"	POOR	"	A	CROSSED OVER DEPRESSION
"	"	"	A	
"	"	"	A	NEARING RIV
"	"	"	A	

3800 — 3830'
4000 — 4000'
4200 — 4240'
4400 — 4505'
4600 — 4730'
4800 — 4940'

~~MAR 27~~

LINE	STATION	HORIZONTAL DEPTH	COLOR	TEXTURE	SLOPE DIRN
4400	29	A/2"	BROWN	VEG	↑ V. STP
	30	B/4"	GREY	PERMA SANDY	↖ 740° ↓ STP
	31	B/6"	"	"	↗ 280° V. STP
	32	B/8"	"	"	↗ 280° V. STP
	33	B/10"	"	"	↗ 322° V. STP
	34	B/8"	"	"	↑ V. STP
	35	B/6"	BROWNISH	"	↖ 310° MED
	36	B/6"	"	"	← STP
	37	B/6"	"	SAND GRAVEL	← STP
	38	A/8"	BROWN, GREY	ASH VEG	← STP
	39	B/8"	DARK GREY	SANDY	↑ STP
	40	B/8"	"	"	↖ 290° STP
	41	B/8"	BROWNISH	SANDY + RX	↖ 245° STP
	42	B/6"	BROWN	ASH, GRAVEL SAND	↖ 2290° ↓ STP
	43	B/8"	BROWNISH	SAND + RX	↖ 236° STP
	44	B/10"	"	"	↖ 224° STP
4600	1	B/4"	BROWNISH	SAND GRAVEL	↖ 244° STP
	2	B/6"	"	"	↑
	3	A/6"	"	SAND, ASH VEG	↑ STP
	4	B/8"	"	SANDY	← STP
	5	B/8"	"	SAND + RX	← STP
	6	B/8"	"	GRAVEL	← "
4800	21		Plotted		

VEG	DRAINAGE	HORIZON DEV	PARENT MAT A C E B	OTHER
TUNDRA	GOOD	POOR	A	ON TOP OF A ROCK CLIFF
"	FAIR	"	B	IN A DEP.
"	"	FAIR	B	ON A RIDGE BETWEEN 2 DEP.
" TALL	"	"	B	MOVING OUT OF A DEP.
" TALUS	"	"	B	ON RIDGE BETWEEN 2 DEP.
"	"	"	"	CROSSED OVER DEP.
"	GOOD	"	B	ON RIDGE ABOVE CAMP.
" TALL TREE, MOSS TALL	"	"	B	ENTERING A VERY WIDE DEP.
"	"	"	B	STILL ENTERING DEP.
"	"	POOR	A	NE OF STREAM IN SAME DEP.
TUNDRA	FAIR	FAIR	B	MOVING OUT OF DEP CROSSED STREAM
"	"	GOOD	B	CROSSED SMALL RIDGE ENTERING INTO SHALLOW DEP
"	GOOD	FAIR	B	ABLE TO NOW SEE UP MAIN RIV.
TREES & TUNDRA	"	GOOD	B	ON RIDGE
TREES	"	"	B	
"	"	"	B	
TUNDRA	GOOD	FAIR	B	
"	"	"	B	
"	"	POOR	A	ENTERING WIDE DEPRESSION
LOW BUSH	POOR	POOR	B	NE SIDE OF STREAM
TUNDRA	GOOD	FAIR	B	MOVING DEP OUT OF
TUNDRA TALUS	GOOD	POOR	B	STILL MOVING OUT OF DEP.

4600' = 1

320 L Pacific Rainproof

1400

LINE	STATION	HORIZON	COLOR	TEXTURE	SLOPE	
		DEPTH			DIRN	
4600'	7	B	10"	BROWN	GRAVEL	↗ 30°
	8	B	12"	"	SANDY	↑ GENTLE
	9	B	6"	"	SAND + GRAVEL	↗ 26° STP
	10	A	6"	"	VEG + SAND	↗ 40° STP
	11	B	8"	"	GRAVEL	↗ 26° STP
	12	A	6"	"	VEG SAND	↑
	13	B	6"	"	GRAVEL	↑ STP
4800'	21	A	6"	DARK BROWN	VEG + SOIL	↑ STP
	22	B	6"	BROWN	SANDY	↖ 35° STP
	23	A	12"	GREY BROWN	ASH VEG	↑ STP
	24	A	4"	BROWN	VEG	↑ STP
	25	A	8"	"	"	↑ STP
	26	B	3"	"	SANDY	↖ GENTLE
	27	A	8"	"	VEG	↖ 29° GENTLE
	28	A	6"	BLACK	VEG ASH	"
	29	A	8"	BROWN	VEG	↘ 24°

Plotted

VEG	DRAINAGE	HORIZON DEV	PARENT MAT A OR B	OTHER
TUNDRA	FAIR	POOR	B	PASSED OVER RIDGE LOOKING
"	GOOD	POOR	B	OVER CAMP.
"	POOR	POOR	B	IN TOP OF BLUFF
"	GOOD	"	A	IN MIDDLE OF DEP
"	FAIR	"	B	ON SMALL RIDGE BETWEEN 2 DEP.
"	"	"	A	IN A DEP.
"	"	"	A	ON A HIGH RIDGE
"	"	"	B	ON RIDGE. CROSSED OVER DEEP DEP.
" TALUS	FAIR	POOR	A	NEAR CAMP RIVER HEAD
" "	"	FAIR	B	ON RIDGE SEPARATING CAMP FROM DEP
"	"	POOR	A	IN CENTER OF A DEP.
"	GOOD	"	A	ON RIDGE
"	FAIR	"	A	IN MIDDLE OF DEP.
"	GOOD	"	B	ABOVE RIDGE OVERLOOKING CAMP.
TUNDRA	POOR	"	A	PASSED OVER SLIGHT DEP
"	GOOD	"	A	(LARGE ONE FURTHER DOWN.)
"	"	"	A	ON BLUFF ABOVE A RIDGE

LINE	STATION	HORIZON		COLOR	TEXTURE	SLOPE	
		DEPTH					DIRN.
3800'	81	A	1/10"	GREY	ASH	↓	GENTLE
LOW	82	A	1/12"	BROWN	VEG	↘	128° GENTLE
	83	A	1/12"	GREY	ASH	↘	130° GENTLE
	84	B	1/8"	DARK GREY	SAND VEG	↘	156° GENTLE
	85	B	1/6"	"	SAND		"
	86	A	1/8"	BLACK	VEG	↘	204° GENTLE
	87	A	1/10"	"	"	↘	160° GNTL
	88	A	1/10"	PERMA	"	↘	110
	89	A	1/12"	BLACK + GREY	VEG ASH	↙	194° STP.
	90	A	1/12"	BLACK	VEG	↘	160° STP
	91	A	1/8"	PERMA	VEG	↘	144° STP
	92	B	1/16"	LIGHT BROWN	SANDY SOME ASH		"
	93	B	1/16"	"	SANDY	↘	126° STP
	94	B	1/8"	"	ASH SAND	↘	154° STP
	95	B	1/8"	"	GRAVEL SAND	↘	138° GENTLE
	96	A	1/8"	BROWN PERMA	VEG		"
	97	A	1/8"	BLACK PERMA	VEG	↘	116° GENTLE
	98	A	1/10"	"	VEG SANDY	↘	116° GNTL
	99	A	1/8"	BROWN + GREY	VEG ASH	↘	150° GNTL
	100	A	1/9"	BLACK PERMA	VEG	↘	GNTL
	101	A	1/7"	"	"		"

VEG.	DRAINAGE	HORIZON DEV.	PARENT MAT A OR B	OTHER.
TREE	GOOD	GOOD	A	ON RIDGE
"	"	POOR	A	
"	"	"	A	
"	FAIR	FAIR	A	IN A DEEP
"	POOR	"	B	"
"	"	POOR	A	
"	FAIR	"	A	
"	"	"	A	CROSS OVER DRIES UP STREAM - IN A DEEP.
"	GOOD	FAIR	A	MOVING OUT OF DEEP.
"	"	POOR	A	LOOKING DIRECTLY AT CAMP.
"	FAIR	"	A	LOOKING UP CAMP RIVER.
"	GOOD	GOOD	B	BESIDE A CHERTY OUTCROP ON A RIDGE
"	"	"	B	OPPOSITE RIDGE SEPARATING CAMP MAIN RIVERS.
"	"	"	B	
"	FAIR	POOR	B	
"	GOOD	"	A	MOVING UP RIV. VALLEY
"	FAIR	"	A	"
"	"	FAIR	"	PASSED OVER SMALL STREAM BED
"	"	"	A	
"	"	"	A	
"	POOR	POOR	A	BY STREAM

	# 90	
3800	Low	+ 3800'
3800	# 54	- 4100'
4000	# 94	+ 360'
4200	# 56	- 4525'
4200	# 61	= 4550'

DISTANCE BETWEEN
 L00E, L02E & L04E IS 400'

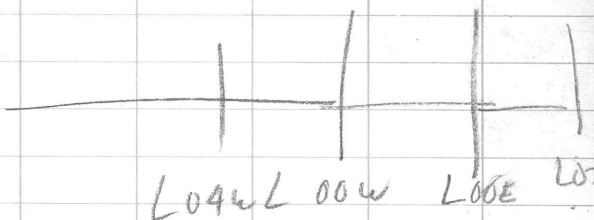

LINE	STATION	HORIZON	COLOR	TEXTURE	SCOPE D/R/W
		DEPTH			
L02E	00N	A / 6"	BROWN GREY	VEG ASH	↓ 160
	02N	A / 8"	BROWN	VEG	
	04N	A / 10"	BROWN GREY	VEG ASH	1
	06N	B / 4"	LIGHT BROWN	SANDY	1
	08N	"	"	"	
	10N	"	DARK GREY	CLAY GRAVEL	

#61 #200' RIBBON ~~50'~~ 50' W OF
 #60 " " 20' SE OF

L04W 02S A / 8" BROWN VEG ↓
 04S A / 10" " " "

L08W 06S A / 10" " " 3
~~04S A / 10" " " "~~
 04S A / 10" " " "
 02S A / 8" BROWN VEG ↓
 CAME OUT 1/2 WAY BETWEEN

L20W 02S A / 10" GREY DSU ↓
 04S A / 8" " W ↓

VEG	DRAINAGE	HORIZON DET.	PARENT MAT	OTHER
TREES	POOR	GOOD	?	AT BREAK IN SLOPE
"	"	"	?	PERMA
"	"	"	"	"
SARVAS	GOOD	POOR	B	NEAR CREST OF HILL
"	"	"	"	CREST OF HILL
"	"	"	"	"
LOAE	BLOON		ON LINE	
LOOW	BLOON			
TREES	POOR	POOR	?	
"	"	"	"	BREAK IN SLOPE
"	FAIR	GOOD	?	BREAK IN SLOPE
"		4200' NE		
"	POOR	POOR	?	
"	POOR	"	?	
LO8 W F LO4 W				
TREES	POOR	GOOD	?	
"	"	FAIR		

L20W	06S	B / 2"	GREYISH	SANDY GRAY	↓
	08S	A / 8"	GREY	ASH	↓
	10S	A / 8"	BROWN	VEG	↓

L24W	10S	A / 10"	GREY	ASA VEG	↓
	08S	A / 8"	BROWN GREY	"	↓
	06S	A / 6"	GREY	ASH	
	04S	A / 6"	"	"	↓
	02S	A / 8"	"	"	↓

CAM 13 OUT 75' ABOVE L24W

L32W	02S	A / 8"	BROWN	VEG	↖ 310
	04S	A / 6"	BROWN GREY	VEG	
	06S	A / 8"	BROWN	VEG	
	08S	A / 6"	BLACK	"	

	DRAIN	HORIZON DEY		
TREES	POOR	POOR	B	PERMA
"	"	GOOD	A?	PERMA
"	"	POOR	?	BREAK IN SLOPE
#48	4200'	NW	OF	L24W; 10S
"	"	FAIR	?	BREAK IN SLOPE
"	"	GOOD	?	
"	"	POOR	?	
"	"	"	R	PERMA
"	"	FAIR	?	
"	FAIR	POOR	?	
"	GOOD	GOOD	?	
"	FAIR	POOR	?	
"	POOR	POOR	?	BREAK IN SLOPE

VEG

DRAINAGE

NO. 120N
DEV.

PAR
MAT
A OR B

OTHER

L 28 W

BL 00N

elev = 4350'

L 32 W

BL 00N

elev. = 4300'

L 20 W

BL 00N

elev = 4420'

L 24 W

BL 00N

elev. = 4380

L 16 W

BLOON

elev 4430

L 12 W

BLOON

elev

L 08

4510

L 04

4480

L 00

4532W

LINE	STATION	HORIZON	COLOR	TEXTURE	SLOPE
		DEPTH			DIRN.
L32W	00N	A / 9"	BLACK GREY	ASH VEG	↖ 316
	02N	A / 6"	"	"	←
	04N	A / 12"	"	"	←
	06N	A / 8"	BLACK	VEG	←
	08N	A / 6"	"	"	↖ 300
	10N	A / 10"	"	"	↑
	12N	A / 6"	"	"	↓
L20W	12N	A / 8"	"	"	←
	10N	A / 8"	"	"	←
	08N	A / 12"	"	"	←
	06N	A / 8"	"	"	↘ 100°
	04N	B / 6"	GREY (DARK)	GRAVEL SAND	↖ 310°
	02N	A / 10"	BLACK	VEG	←
	00N	A / 8"	"	"	↖ 306°
	HIT	LINE	RIGHT	DN.	
L16W	00N	A / 12"	BLACK	VEG	←
	02N	A / 12"	GREY	ASH	↖ 300°
	04N	A / 10"	BLACK	VEG	
	06N	A / 6"	"	"	
	08N	A / 8"	"	"	↖ 310°
	10N	A / 8"	BLACK GREY	VEG ASH	↖ 326
	12N	A / 10"	BLACK	VEG	

VEG	DRAINAGE	HORIZON DEV	PARENT MATERIAL A OR B	OTHER
TREE	POOR	GOOD	A ?	PERMA
"	"	"	A ?	PERMA
"	"	"	A ?	"
"	"	F+	A ?	"
"	"	"	A ?	"
"	"	"	A ?	"
"	"	"	" ?	"
"	"	POOR	A ?	MOVING UP HILL
"	FAIR	"	A ?	"
"	"	"	A ?	ON RIDGE OF HILL
"	POOR	"	A ?	ON HILL
"	FAIR	"	B	
"	POOR	"	A ?	
"	"	"	A ?	
"	"	"	"	
"	"	"	A ?	ON BASE LINE
"	FAIR	GOOD	A ?	4420
"	POOR	POOR	A ?	MOVING UP HILL
"	"	"	A ?	
"	"	"	A ?	
"	FAIR	GOOD	A ?	PASSED OVER SMALL HILL MOVING INTO DEEP
"	"	POOR	A ?	4420

LINE	STATION	HORIZON DEPTH	COLOR	TEXTURE	SLOPE DIP
L08W	12N	B / 8"	BROWN	SANDY	130 ↓
	10N	A / 10"	GREY	ASH	↑ 320°
	08N	A / 6"	BROWN GREY	VEG ASH	←
	06N	A / 8"	"	"	"
	04N	A / 10"	BROWN	VEG	← 220
	02N	A / 10"	"	"	"
	00W	A / 10"	"	"	"
L00W	00N	B / 6"	BROWN	SANDY	← 205°
	02N	A / 10"	BROWN GREY	VEG ASH	"
	04	A / 8"	"	"	"
	06	B / 12"	LIGHT BROWN	ASH + SAND	↓
	08	A / 6"	BROWN	VEG	↑
	10	B / 8"	LIGHT BROWN	SANDY	"

VEG	DRAINAGE	HORIZON DEV	PARENT MAT	OTHER
FEW TREES	FAIR	GOOD	B	NEAR TOP 4540'
"	GOOD	GOOD	A?	
"	"	"	A?	HILL CHANGING DIRN.
"	FAIR	"	A?	MOVING DOWN HILL
"	"	POOR	A?	
"	POOR	"	A?	OFF HILL ONTO FLAT GROUND.
"	FAIR	"	A?	PL
"	FAIR	GOOD	B?	
"	POOR	GOOD	A?	
"	"	"	A?	BETWEEN 2 HUMPS
"	POOR	GOOD	B?	" 4550
"	"	—	A?	HOLLOW 4570
"	GOOD	GOOD	B?	4560

WIEBE

A
=

W-1

7 June 74

Line	Station	Horizon Depth	Color	texture	Slope and direction
4200	1	A-B 1/10"	BL+GR	ALUO	↙ STEEP
	2	B 1/8"	GR	AL+OR	↙ STEEP
	3	B 1/6"	GR	ALL	↙ STEEP
	4	B 1/6"	BR	SANDY	↙ STEEP
	5	B 1/6"	BR	SANDY	↙ STEEP
	6	B 1/8"	BR GR	SANDY	↙ STEEP
	7	B 1/6"	BR	SANDY	↖ STEEP
	8	A+B 1/10"	BR, GR	SAND+OR	↖ STEEP
	9	C 1/8"	GR, BR	Rock chips	↖ STEEP
	10	C 1/10"	GR	AL-CLAY	↖ STEEP
	11	C 1/8"	GR	Rock chips	↖ STEEP
	12	C 1/8"	GR BR	Rock+CLAY	↖ STEEP
	13	C 1/6"	BR	Rock chips	↖ STEEP
	14	C 1/6"	BR	Rock chips	↖ STEEP
	15	C 1/4"	BR	Rock chips	↑ STEEP
	16	C 1/4"	BR	ROTOR	↑ STEEP
	17	C 1/2"	LT BR	SILT	↑ STEEP
	18	C 1/2"	LT BR GR	SILT GR	↑ STEEP
	19	C 1/2"	LT BR	SANDY	↑ STEEP
	20	C 1/2"	LT BR	SANDY	↑ STEEP
	21	C 1/8"	BR	SANDY	↑ STEEP
	22	B 1/6"	BR	SANDY	↙ STEEP
	23	C 1/8"	BR	Rock chips	↙ STEEP
Ph. H. L.	24	A+C 2"	LT BR	SILT+OR	↙ STEEP
	25	C 8"	BR	SILT	↙ STEEP

WLD

Vegetation	drainage	horizon development	percent material	other
TRCES + Bus	FAIR	POOR	VEG ALL	
TR + Bus	FAIR	FAIR	B + VEG ^{ALL}	
TR + Bu	FAIR	FAIR	ALL	
TR + Bu	FAIR	GOOD	BED	
TR + Bu	FAIR	GOOD	BED	
TR + Bu	FAIR	FAIR	BED	
Bush + MOSS + Bush	GOOD	FAIR	GOOD	
Bush + MOSS + Bush	FAIR	POOR	ALL + OR	
MOSS	FAIR	POOR	BED	
MOSS	GOOD	POOR	ALL + BED	
MOSS	GOOD	POOR	BED	
MOSS	GOOD	POOR	BED	
TALUS SLOPE	GOOD	POOR	BED	
MOSS	GOOD	POOR	BED	
MOSS	GOOD	POOR	BED	
MOSS	GOOD	POOR	BED	
MOSS	GOOD	POOR	BED	
MOSS	GOOD	POOR	BED + TAL	
MOS	GOOD	POOR	BED	
MOSS	GOOD	POOR	BED	
TALUS SLOPE	GOOD	FAIR	BED	RIGHT ON CR.
BUSH	GOOD	FAIR	ALL + BED	FAR SIDE OF CR
BUSH	GOOD	FAIR	BED	
TALUS SLOPE	GOOD	POOR	OR + BED	
TALUS SLOPE	GOOD	POOR	BED	

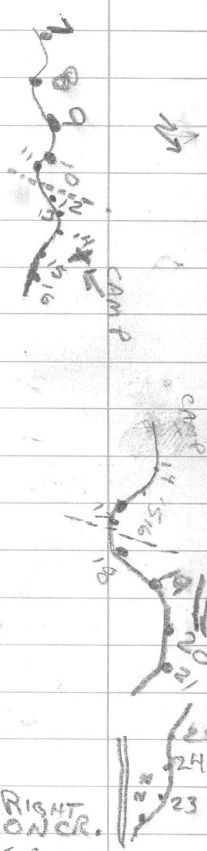

LINE	STATION	HORIZON DEPTH	COLOR	TEXTURE	SLOPE + DIRECTION
4200	29	A+B 1/4"	GRAY	SILTY	↑ STEEP
	30	A+B 1/8"	GRAY	SILTY	↑ STEEP
	31	B 1/4"	LT BR	SANDY	↑ STEEP
	32	C 1/2"	BR	SANDY	↑ STEEP
	33	B 1/10"	LT BR	SILTY	↑ STEEP
	34	B 1/4"	DK BR	SILT OR	↑ STEEP
	35	B 1/6"	LT BR	SANDY	↑ STEEP
	36	B 1/10"	LT BR	SILTY	↑ STEEP
	37	A+B 1/8"	BL+GR	FROZ	↑ ST
	38	B 1/8"	LT BR+GR	SILT	↑ ST
	39	B 1/8"	LT BR+GR	SILT	↑ ST
	40	B 1/4"	LT BR	SANDY	↑ ST
	41	B 1/4"	BR	SILT	↑ ST
	42	B 1/8"	BR	SANDY	ST →
	43	B 1/8"	GR	SILT OR	ST →
	44	B 1/10"	GR	SILT	ST →
	45	C 1/6"	LT BR	SANDY	ST →
	46	B 1/10"	BR	SANDY OR	ST →
	47	B 1/8"	LT BR	SILT OR	ST ↑
	48	B 1/4"	BR+GR	SILT OR	ST ↑

P/A

8 June

74

VEGETATION	DRAINAGE	HORIZON DEVEL.	PERCENT MATERIAL	OTHER
BUSH	FAIR	POOR	AL	FROZEN STIFF
BUSH	FAIR	POOR	AL	
MOSS	FAIR	POOR	BED	FROZEN
TALUS SC	FAIR	POOR	BED	
MOSS	FAIR	POOR	AL+BED	
MOSS	FAIR	POOR	AL+OR	
MOSS	FAIR	POOR	BED+OR	
BUSH	FAIR	POOR	BED+AL	FROZ
MOSS	FAIR	POOR	AL+OR	FROZ
BUSH	FAIR	POOR	AL+BE	FROZ
BUSH	FAIR	POOR	AL+BE	FROZ
MOSS	FAIR	POOR	BED	FROZ
ROCKSLIP	FAIR	POOR	BED	FROZ
MOSS	FAIR	FAIR	BED	
BUSH	FAIR	POOR	AL	ON CREEK BED
MOSS	FAIR	POOR	AL	FROZ
TALUS SC	FAIR	POOR	BED	
BUSH	FAIR	POOR	AL+OR	FROZ
BUSH	FAIR	POOR	AL+OR	FROZ
MOSS*	FAIR	POOR	BED+OR	MAIN CR 100'

LINE	STATION	TOP / BOT DEPTH	COLOR	TEXTURE	SLOPE DIRECTION
4800	1	C/4"	GRAY	SANDY	↑ ST
	2	C/4"	BR	"	↑ ST
	3	C/4"	BR	ROCK CHIPS	↑ ST
	4	C/4"	BR	" "	↑ ST
	5	C/4"	BR	" "	↑ ST
	6	C/4"	BR	" "	↑ ST
	7	C/4"	"	SILTY	ST →
	8	C/4"	BR	SANDY	ST →
	9	C/2"	BR	SANDY	ST →
	10	C/2"	BR	SILT	ST →
	11	C/2"	BR	SILT OR	ST →
	12	C/4"	BR	ROCK CHIPS	ST →
	13	C/4"	BR	ROCK CHIPS	ST →
	14	C/6"	GRAY	SILT	↑ FLAT
	15	C/4"	LTBR	SILT	↑ FLAT
	16	B/6"	LTBR	SILT	↑ FLAT
	17	C/4"	LTBR	ROCK CHIPS	← STEEP
	18	C/6"	LTBR	ROCK CHIPS OR G	← STEEP
	19	C/4"	LTBR	SILT	← STEEP
	20	A+C/4"	BL	ROCK PORTULCAS	↑ STEEP

Plotted

VEGET	DRAIN	HOR DEV	PAREN MAT	OTHER
MOSS	GOOD	POOR	BED	
MOSS	GOOD	POOR	BED+FRONT	
MOSS	"	"	"	" CROSSED CR
"	"	"	"	"
"	"	"	"	" CROSSED CR
"	"	"	"	" ON CR. BED
"	"	"	"	CROSSED CR
MOSS	GOOD	FAIR	BED	
TALUS	GOOD	POOR	TALUSCOPE	
MOSS	GOOD	FAIR	BED+AL	
MOSS	GOOD	FAIR	BED	CROSSED CR
TALUSCOPE	GOOD	POOR	BED	
" "	" "	" "	" "	
BUSH	POOR	POOR	BED	
BUSH	POOR	FAIR	BED	FROZ
MOSS	FAIR	FAIR	AL+BED	
MOSS	GOOD	POOR	BED	
TALUSCOPE	GOOD	POOR	BED+ORG	
TALUS	GOOD	POOR	BED	
TALUS+MOSS	GOOD	POOR	BED	HEAD OF CAMP OF CR PAST COOK TENT

LINE	STATION	HORIZON DEPTH	COLOR	TEXTURE	SLOPE DIRECTION
4200	49	1/10"	GREY	SILT	↓ FLAT
	50	" 1/10"	GR+BL	SILT+OR	↘ FLAT
	51	" 1/8"	GR	SILT	↘ FLAT
	52	" 1/8"	GR	SILT	→ FLAT
	53	" 1/10"	GR	SILT	↓ FLAT
	54	" 1/12"	GR	SILT	↘ FLAT
	55	" 1/10"	LT GR+BL	SILT+OR	↓ FLAT
	56	" 1/10"	LT. GR	SILT+OR	↘ FLAT
	57	" 1/12"	LT. GR	SILT+OR	↓ FLAT
	58	" 1/8"	LT GR	SILT+OR	↓ FLAT
	59	" 1/8"	BL	SILT+OR	↘ FLAT
	60	" 1/10"	LT GR	" "	↘ FLAT
	61	" 1/10"	" "	" "	↓ "
	62	" 1/8"	DK GR	" "	↓ FLAT
	63	" 1/4"	GR	SILT	↓ "
	64	" 1/8"	LT GR	SILT+OR	↓ "
	65	" 1/8"	GR	" "	↓ "
	66	" 1/4"	"	SILT	↓ "
	67	" 1/4"	GR	SILT+O	↘ "
	68	" 1/10"	LT GR+BL	SILT+O	↘ FLAT

VEGET	DRAIN	MOR DEV	PAREN MAT	OTHER	(W7)
BUSH	POOR	FAIR	ALH		
BUSH	POOR	POOR	AL+OR		
BUSH	POOR	POOR	A+OR		
BUSH	POOR	POOR	A+OR	FROZ	
BUSH	POOR	POOR	A+OR		
BUSH	POOR	POOR	A+OR		
BUSH	POOR	POOR	A+OR	FROZ	
BUSH	POOR	POOR	A+OR		
"	"	"	" "	FROZ	
BUSH	POOR	POOR	A+OR	FROZ	
"	"	"	" "		
"	"	"	1 1 1	FROZ	
"	"	"	"	FROZ	
"	"	"	"	FROZ	
"	"	FAIR	AL		
"	"	POOR	AL+OR	FROZ	
"	"	"	" "		
"	POOR	FAIR	AL		
"	"	POOR	AL+OR		
"	"	"	" "	FROZ	

LINE	STAT	HORI DEPTH	COLOR	TEXT	DIRECTION SLOPE
4410	1	C/6"	BR	ROCK + OR	STEEP ↑
	2	C/6"	BR	"	← STE
	3	C/6"	BR	ROCK CAP + OR	← ST
	4	C/4"	BR	ROCK C + OR	← ST
	<u>5</u>	C/6"	BR	SILT	← ST
4810	6	C/6"	BR	ROCK CHIPS	↑ GENTLE SLOPE
	7	C/6"	"	" "	← " "
	8	C/6"	"	" "	← " "
	9	C/6"	BR	OR + ROCK CHIPS	← STEEP
2	10	C/6"	BR	ROCK CHIPS	← "
	11	C/6"	BR	" "	← "
	12	B/6"	LT BR	SILT + RC	↑ ST
	13	B/4"	BR	SILT + OR	↑ ST
	14	B/4"	BR	SILT	↑ ST
	15	B/4"	BR	ROCK CHIPS	↑ ST

VEGET	DRAN	OR DEU	MAT	OTHER
TAKUS 56	GOOD	POOR	BED	(PREVIOUS
" "	"	"	"	
MOSS	"	"	BED+OR	
"	"	"	" "	
"	"	FAIR	" "	
"	FAIR	POOR	BED	
"	GOOD	"	"	
"	"	"	"	
"	"	"	"	
"	"	POOR	BED	
"	GOOD	"	"	4200'
MOSS	GOOD	POOR	A+B	7900
MOSS	GOOD	POOR	A+B	OUT
MOSS	GOOD	POOR	A	150'
"	"	"	BED	110
				ACTUAL
				ACTUAL
				4350'
				4510
				(4600 OUT AT 50')
				(4800 OUT 150' AT 400)

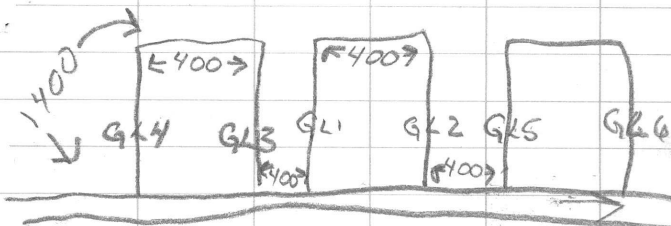
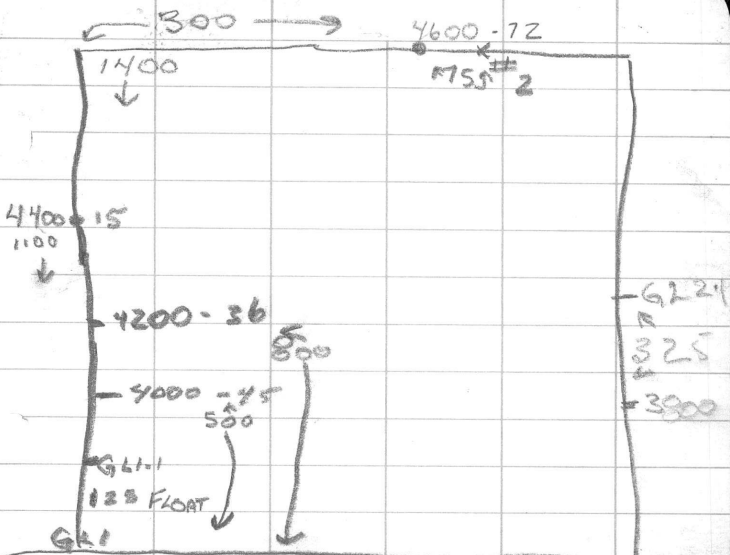

LINE	STAT	HORIZ DEPTH	COLOR	TEXT	DIRECT SLOPE
------	------	----------------	-------	------	-----------------

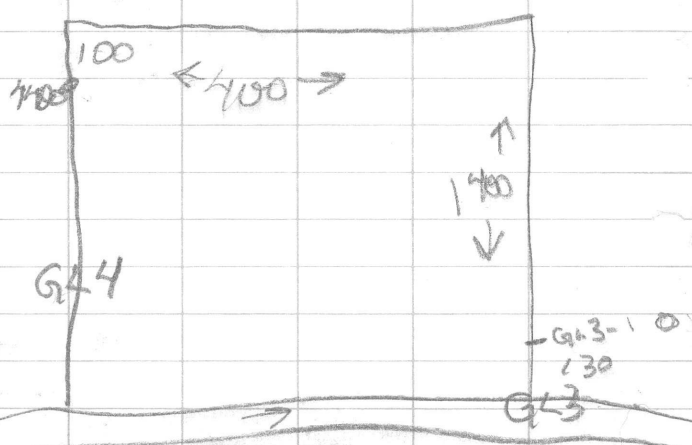

← 350 →

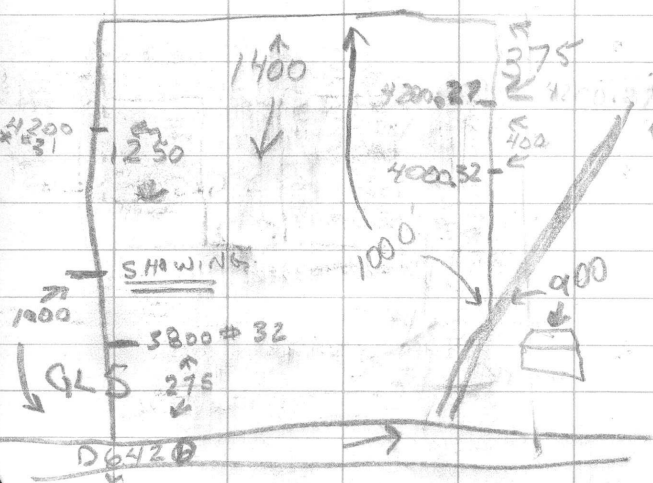

VEGET

DRAW

HOR
DEV

PAN-001
MAT

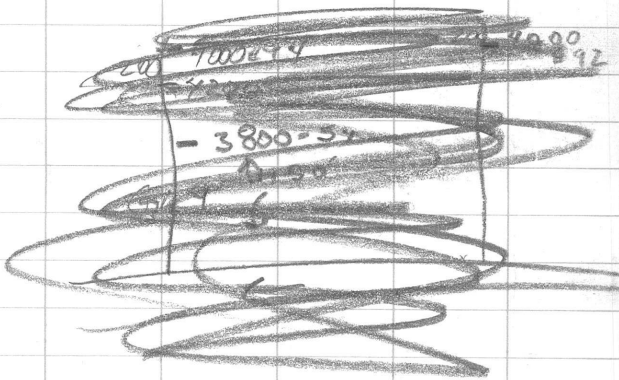
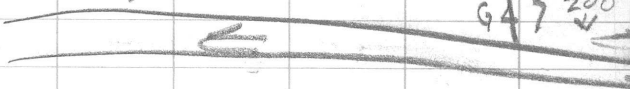
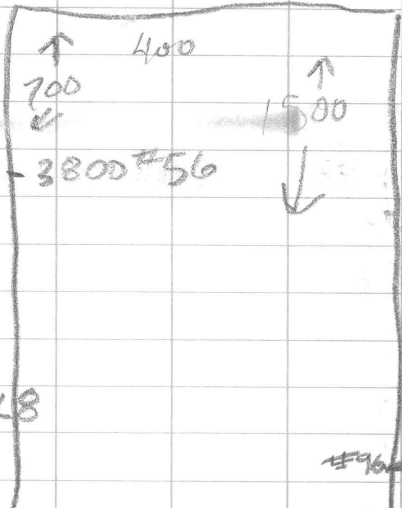

400



300

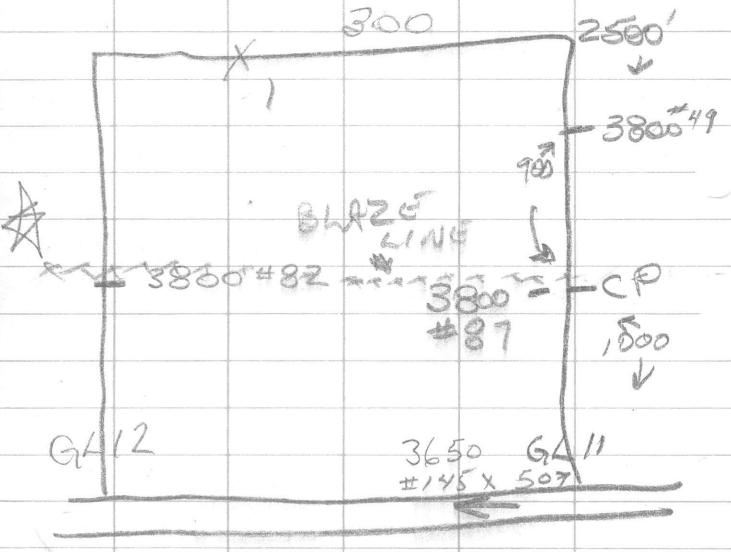

CP # 1

DANE 50

MC

1500R

FEB 22-66

STAN

BARRELL

CLAIM #

Y1151

POST # 1

DANE

MC

1500

FEB 22-66

TAG # Y1152

STAN B.

POST # 2

DANE 49

FEB

TAG # 5 11 50

POST # 2

CLAIM # 5 11 51

DANE

FEB 22

POST # 1

CLAMM # 91153

DANE
2500R

FEB 22