

KAZA COPPER PROJECT

1973 : DEAN, SIHOTA, HOWARD,
MASER.

019506

**PACIFIC
WATERPROOF**

Mining Transit Book

FILLER No. 321

KAZA COPPER
PROJECT

P. M. DEAN

15-30 May 1973

May 17

L0100/220E: otop porphyritic
andesite with blebs &
inlets of bright green epidote. In some
~~some~~ places there is strong flow banding &
alignment of fsp. Plag forms radiating
clusters of phenocrysts. Groundmass is pale
greenish green (weathered) or dark green blk.
(fresh). Whitish felsic & silicic blebs &
inlets, sometimes associated with the
epidote.

600E: andesite porphyry Minor lim-
gossan.

820E - Float boulders (rounded) of bx
or cg. Fragments of chert, qtz, jasper, volc.

- to 1000E - glacial boulders & cobbles of
various rock types, includ. granite, bx, volc,
felsite, etc.

SAMPLES:

3D1: typical andesite porphyry

3D2: Unit 6 felsic dike 100N-100E

3D3: epidote in andesite porphyry
200N-200E

3D4: Unit "4" skarn
near IDH 384

May 18:

Samples:

- 3D 5 - Unit 2b hbl'd porph
- 3D 6 - Unit 1 andes. porph
- 3D 7 - Unit 7 HBLDITE
- 3D 8 - Fepr-epidote-qtz altⁿ
- 3D-9 - monzonite-Sb
- 3D-10 - core from ~150 FT, DDH-11

KSPR-EP-QTZ ALTⁿ IN
ANDESITE PORPH

ROAD L800S - 200E
CROSSES BL 600S

ROAD L800S - 700E

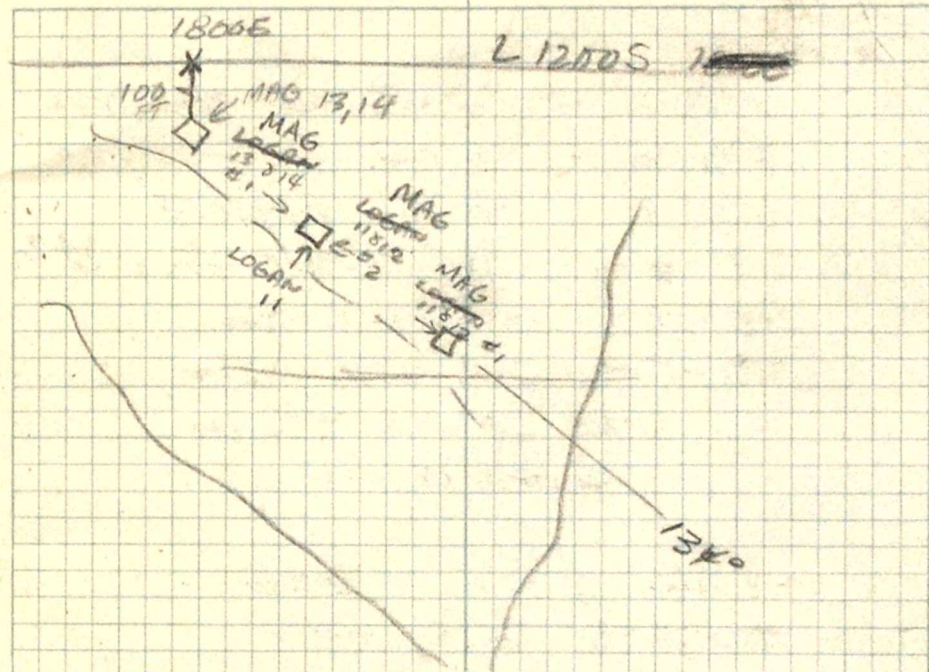
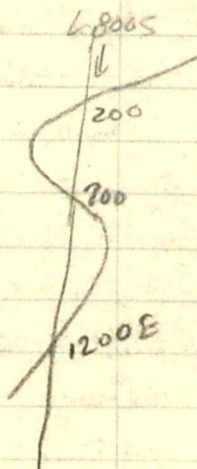

RUSTY CANYON IN CREEK -
about 1 mile above road
crossing of Kara Creek. Reddish
brown, dense, fine grained and
massive rock of uncertain type -
could be volcanic with weathered
& altered mafics, or could be a
massive, Fe-rich mudstone.
Silicification along fractures.
Tiny cavities looking like vesicles
may indicate volcanic origin.

Other, unaltered, fine grained volcanics occur downstream & upstream from the rusty steps, also cg with granite frags. in 90% bx matrix of similar rock type to rusty canyon occurs 500 FT upstream from rd crossing.

Samples 3D-11 are from rusty canyon at ~ L 16 S.

May 19:

L 1600N crosses rd at 300 W. steps of andes porph. extend from B2 on 1600N to 400W & over to L 1200 to South. About 2% green epidote in veinlets and blobs.

LINE 0 - 700W - RD & BASE OF HILL

400W - felsite dike cutting hbl and. large qtz eyes up to $\frac{1}{2}$ " across
sample 3D-12

700E - Small showing py & ep in

sheared zone ~ 5 FT wide and at least 30 FT LONG
TRENDS at ~ 160 & DIPS INTO HILL at ~ 45°
"VEIN" CONSISTS PRIMARILY OF FINE GRAINED FELTED AMPHIBOLE, PYRITE & CP IS INTERSTITIAL TO HBL OR ACT.

L 45 - 800E - ~~showing~~ SHOWING IN AND PORPH :

~ 8 FT x ³⁰⁰ ~~8~~ FT LONG - Long dimension

trends at ~ 160° STRONG JOINTING

at 263° DIPPING at ~ 70° to N.

Same felted act or HBL at 700E on L 0, WITH PY & POSSIBLY CP SALTED

THROUGH IT. 3D-13 is character sample TO BE ASSAYED FOR Cu ~~Fe~~ Au Ag & ?

INTERMITTANT MIN FLOAT TRENDS NEARLY BACK TO L 0 ALONG TRENCH-LIKE FEATURE,

Good steps of Andesite porph along each side of "trench" give max width of mineralization of ~ 40-50 FT; Probably, it is only ~ 10 FT wide or less, localized along sheared & fractured fault zone

L45-600E Volcanic bx with ophanitic green-grey fragments floating in matrix crowded with phenocrysts of plag. Some of clasts also contain plag phenos. Sample 3D-14

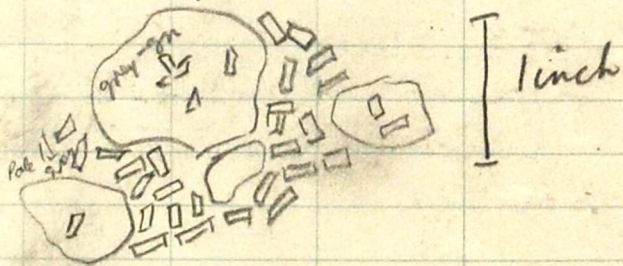

20 May:

L800S-1200E (200N) -

Trench with well-exposed hornblende dike ~ 8 FT wide - suitable for channel sample to assay. Also a large block of massive fossiliferous ^{sandy} CS - fossils include corals, brachiopods & gastropods, as well as other unidentified beasts.

3D-18

L800S-2600E - 200FTN -

angular blocks of andesite on ridge top. Some with plag phenos, other chunks drk green & aphanitic.

L800S-3200E - 100N -

substep of andesite - porphyritic (plag phenos) - resembles AND porph near showings

L800S-5200E to 5400E - broad, straight, trench-like feature - straight, sharply cut-off walls. Trends at ~145°.

Probably a fault. Angular substep? of andesite on east side (chips in soil)

L800S-6000E: drk green, very dense, had a heavy base etc. phenos of pyroxene or amphibole in drk green matrix. broken red in soil. Occasional grains of pyrite

6100E - HBL AND. OTC: rock is porphyritic with green matrix crowded with blk hbl laths and drk ~~grn~~ grn, slightly larger phenos. of ~~same~~ plag? [3D-15] pyroxene partly altered to hbl. Pyroxene phenos weather to pale green, hbl stays black.

↳ 200 FT NE OF STN 5400E

end of L 16S - otop of andesite weakly vined with calcite along jointing planes. Small vein of qtz-cp 4" thick and 3 FT long (Sample 3D-16). Abundant Cu stain in vein but other veins & rock as a whole has no sulphides.

L 1600S 5300 - lump of andesite - continuous otop along karack to north between here & Kara Falls.

4600E - lin in soil & rusty rock chips for 200 FT to East

L 1600S - 3400 E to 3200E:

- dense grey-grn andesite or tuff. w. no phenos. Occasional blobs & veinlets of calcite. O tops & Subotops for 300 FT to W of line & at least 100 FT to south.

L 1600S - 2000E - good porph andesite as at showings - chunks & chips in soil.

L 1600S - 1800E - AND PORPH SUBOTOP ON ROAD.

- no more otop to BL

returned to trench near Line 800S 1200E and took channel chip sample across 6 1/2 FT of dike, ⊥ to strike. Dike is near ~~per~~ vertical ~~is~~ and about 8 FT wide (only 6 1/2 FT is exposed in trench as clean bedrock.) Sample number 3D-17 - for assay for Cu Au Ag. Also sample 3KD-1M for geochemical analysis for a bunch of things.

21 May

L245-2850E - Substep J
AND PORPH.

L245-4200E - 200N - South shore of
small pond is hbl-pyx-and.

Rusty outcrops to the north appear
to be bx, silicified & epidotized
volcanics (Sample 3D-19)

Pyrite and calcite are present
in the more brecciated samples.

(3D-20). Epidote veinlets &
calcite veinlets are present
in the HBL-PYX AND outcrops N & South
of ponds.

L245-4800E - Karak -

brown, finegrained, rusty rock
forming creek canyon could be
altered (deeply weathered?) volcanic,
or possibly tuffaceous shale?

(Sample 3D-21) - 100 FT N of
end of L245. contact between

brown & HBL-PYX AND - is 200
FT N of end of L245, is vertically
& crosses karak in E-W direction.

Heavy & steady snow made
mapping impossible: went
back to camp at noon.

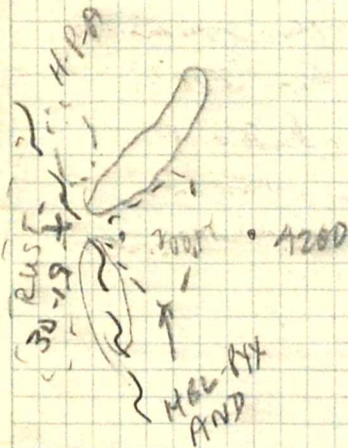

22 May:

Post to Mag 788 FINAL, 19, 110
INITIAL - 300 FT SSE of
road crossing of Kara Ch
Cln line runs 40° E of N.

1 mi SSE of rd crossing on Kara
Ch: low hills $\frac{1}{2}$ to $\frac{3}{4}$ mile
east of Lion Creek are formed
of pyroclastics: breccias &
x1 tuffs. On weathered
surface these look like intrusive
rock, and are probably Bob
Tait's intrusive stocks. 3D-22

BL 2000 E - 34.50S, 200 W -

claim posts Logan 11 #1,
Logan 9x10, #2's

claim line runs $\approx 30^\circ$

DRILL CORE SAMPLES:

DDH #2 - 76 FT - zoned vein with
calcite - sph - py

DDH #2 - 140 FT - silicified andesite
w. KSPAR ALT².

DDH #1 - 280 - volcanic breccia or
cg.

DDH #1 - 468 - lx, sil., epidotized
volc cg. Bottom of Hole at

DDH #5 - 40 - void ss. ? - 169 FT

DDH #5 - 50 - KSPAR ALT² w borite

23 May

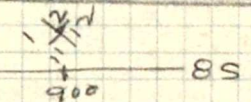
Fire $\begin{matrix} \text{LFT} & & \text{RT} \\ \downarrow & \swarrow & \downarrow \\ 1, 2 & & \#1 \\ 11, 12 & & \#2 \end{matrix}$  - 50 FT N of 900 on
line BS

MAG 11, 12 #1 - 300 FT S of
3000 E on line 36S

claim line crosses BL 30E at 6400S

3KD-2R - rusty shear cutting
caliche sep alt'd and.

crude layering in andesite at
above sample strikes $\sim 20^\circ$, dips
 $68^\circ E$

3KD-3R - bx, lim. stained
sil. andesite sandstone
sample 3D23

3D-24 -

limy fossiliferous sandstone
outcropping along west bank of ch
forms ~~syncline~~ Syncline with axial
Beds from a few inches to ~~2~~ 2 FT
feet thick. Fossils include
carbonized plant remains & shell
material. Appears to overly volcanics
& may be of younger age. Could
be derived in part from the
volcanics.

3D-24

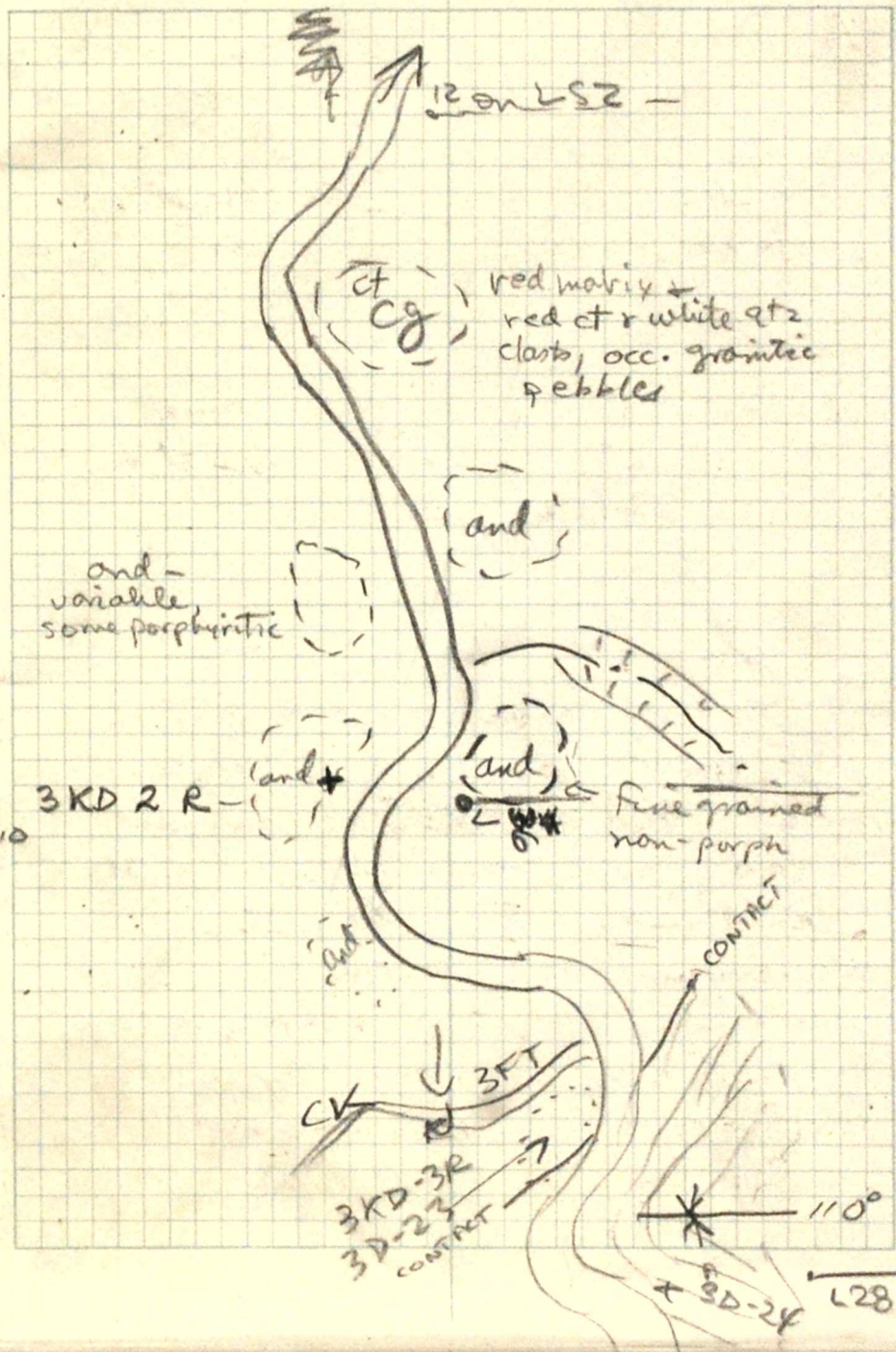

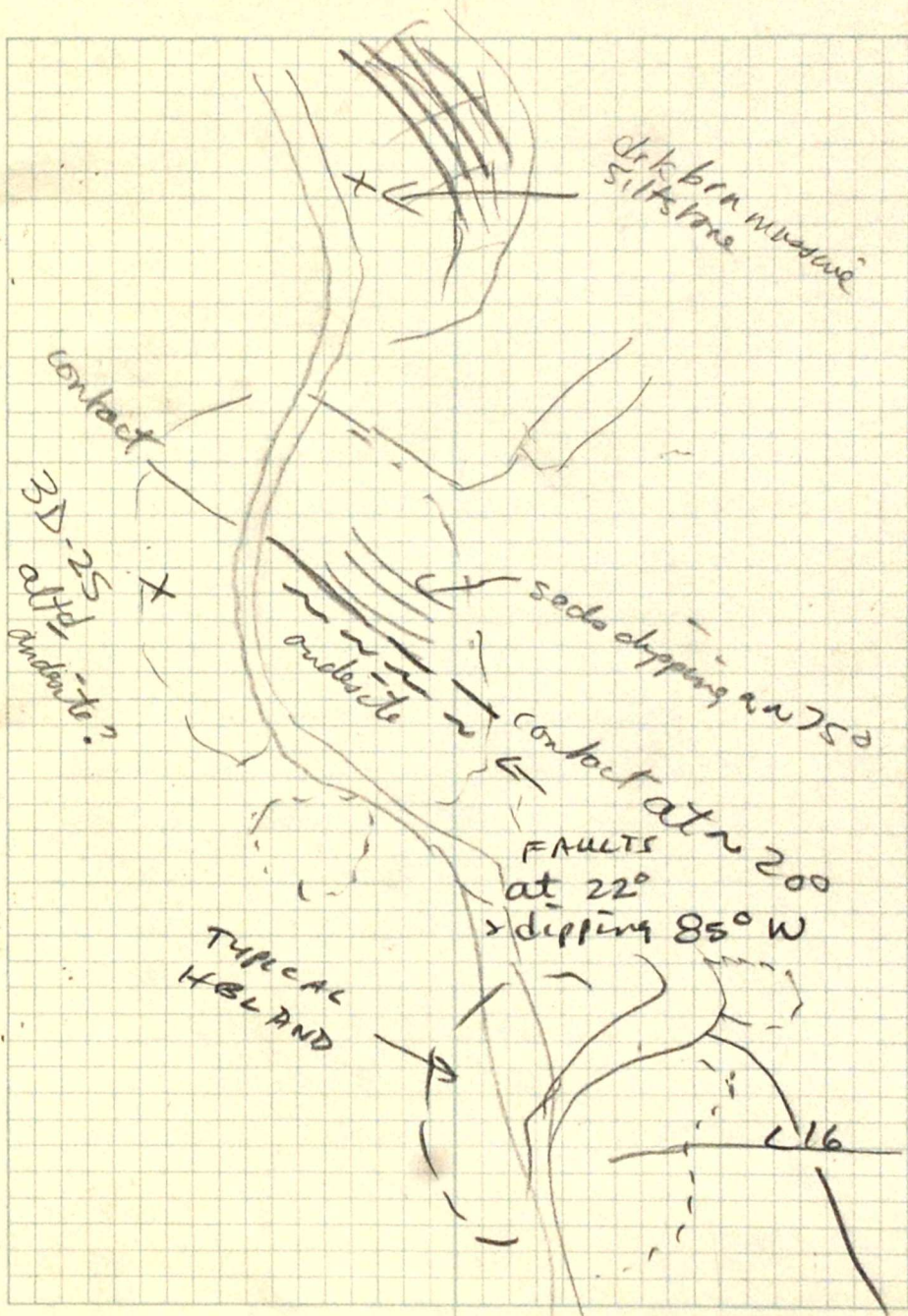

24 May:

Mineral showing at O on BLO

3D-26: chip sample for assay across 13 FT, \perp to strike of showing. Represents horizontal distance, not true width. Impossible to determine ~~true~~ exact attitude of mineralized zone, but seems to be close to vertical. gossanous rubble extends for 50 FT to the SW and 75 FT to the NE but is impossible to dig to bedrock. Only the part sampled has any copper stain or sign of mineralization other than pyrite. Hand specimen # 3D-27 represents the best mineralized material available at the showing. Mineralization is in fractures and disseminations in hornblende.

3D-28 - at N 600 N, 2005

"Metamorphic scoria material" with cp & py. Grab sample of typical mineralization. Maximum width of mineralization is about 5 FT

3D-29

chip sample across 9 FT. Mineralization is along contact of felsite dike with porphyritic andesite. Rocks bearing mineralization are Rensbakkens "metamorphic scoria material"

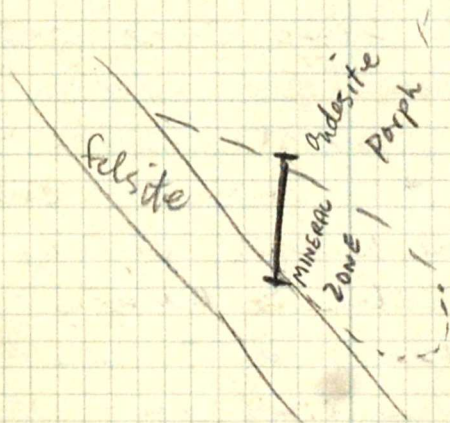

600 N - 20 FT S:

mineralization in main zone here shows definite relation to Fault, and consists of 2 FT of massive pyrite flanked by 3 FT of diss. py & cp. Rx to west of Fault are ~~sparsely~~ mineralized. Fault dips to east at 60°, strikes 155°. Sample: 3D-30 is a chip sample across 6 FT (horizontal) ⊥ to strike of Fault.

3D-31 - hand specimen of scum with grey mineral (mag?) from mineralized zone. IT IS MAGNETITE

3D-32 - chip sample across SFT in showing not marked on Rierskakkens map. Massive to diss. py & cp occur in hornblendite dike cutting andesite porph. Could be a continuation of the dike crossing L45 at ~600 or 800 E. Occurs in a topographic linear trench.

25 May:

⁵⁰⁰ - START OF STEP
L 800 N - 450 W - rd loops around to camp -
Crossed same line at ~1400 FT W.
- 400 W - CAT TRENCHES FOR 100 FT
- 125 W - MAIN HIGHWAY TO KRZAK
L 400 N - 100 W - MAIN HIGHWAY 11' }
10 W - TRENCH }
BLO-600 N - above trench CONTACTS
perpendicular trench to
HIGHWAY

CLAIMS - INITIAL FIRE # 4 & 3
SOFT W of SON on BLO -
west side of highway.

L 400 N - 200 E - andesite porph
300 E - 100 S - showing a
trench with yesterday's 3D-32
chip sample.

- nearly continuous step along
ridge of hill.

throughout
- weak to moderate eps KSP are all
- continuous step ends at L450 N
850 E

200S of 1200E on 1400N subtop of hblite dike material

L0-21E to 24.50 - fg, nonporph and. at 24.50 changes to porph and as per showings area. Occ. sil & ep altⁿ. Otc ends at 26E

L0 30.50 to 3300E - weakly porph andesite intermediate to HBL or to oph andesite. Class with and porph.

L0 36-38E - subtop of oph & hbl and

BL 40E-0N - subtop of oph and.

SN - CK ~~at~~ crosses BL to join Pond CK from west 2-3FT

8N - 50E - HBL AND SUBOTCP - 300E - (across on east side of Pond CK) - same rock type, some sections up to 25 FT across of oph andesite

These andesites are cut by a Qtz-fspr porph dike ~10 FT thick - trending at 20°, 50 FT E of ck.

~~Sample~~
Ridge top is lenticular in shape, is ~500 FT wide N of BL STN 10N & contains sparse ep-sil altⁿ. Some parts of step are finely porph & resemble And porph, but are closer to HBL AND in relation.

QTZ-FSPR porph dike crosses ck & otcps at 200 FT E of 1700 on 1400E BL (cutting hbl and)

1900 N - 400 E - HBL AND OTC

1600 N - 150 E - HBL AND OTC NEAR CK

2000 N - finely porph HBL AND OTC W & S of small ck which crosses BL here

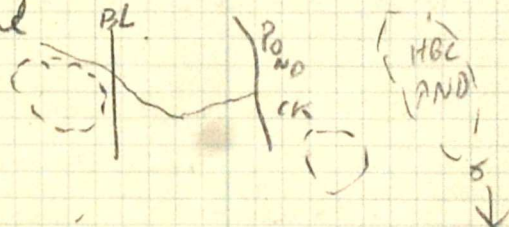

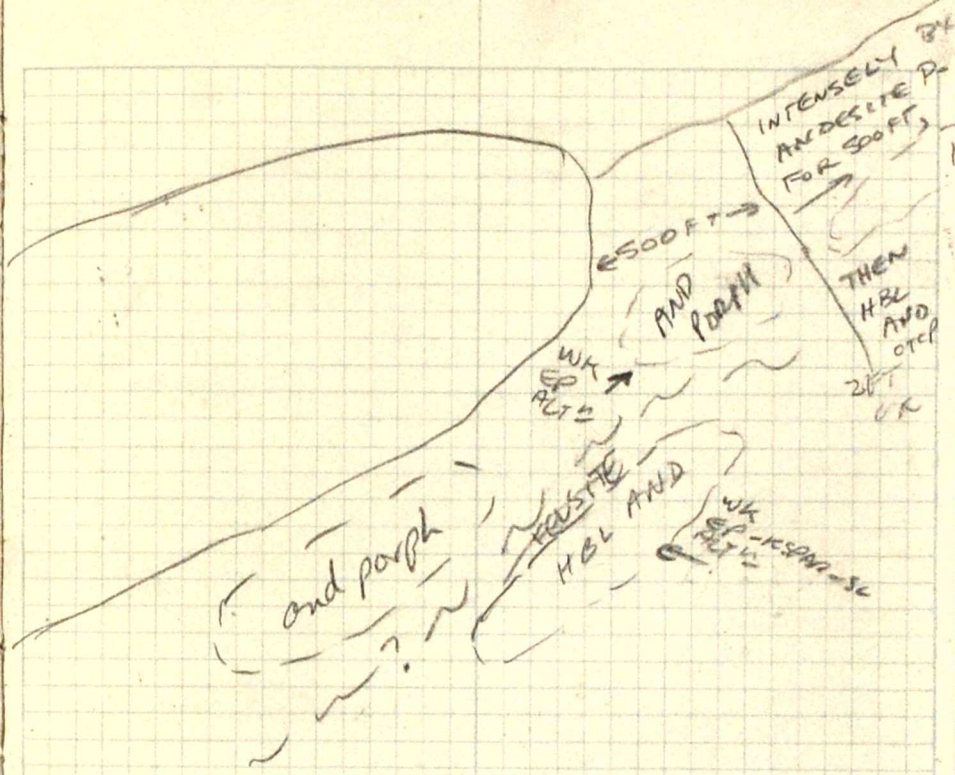
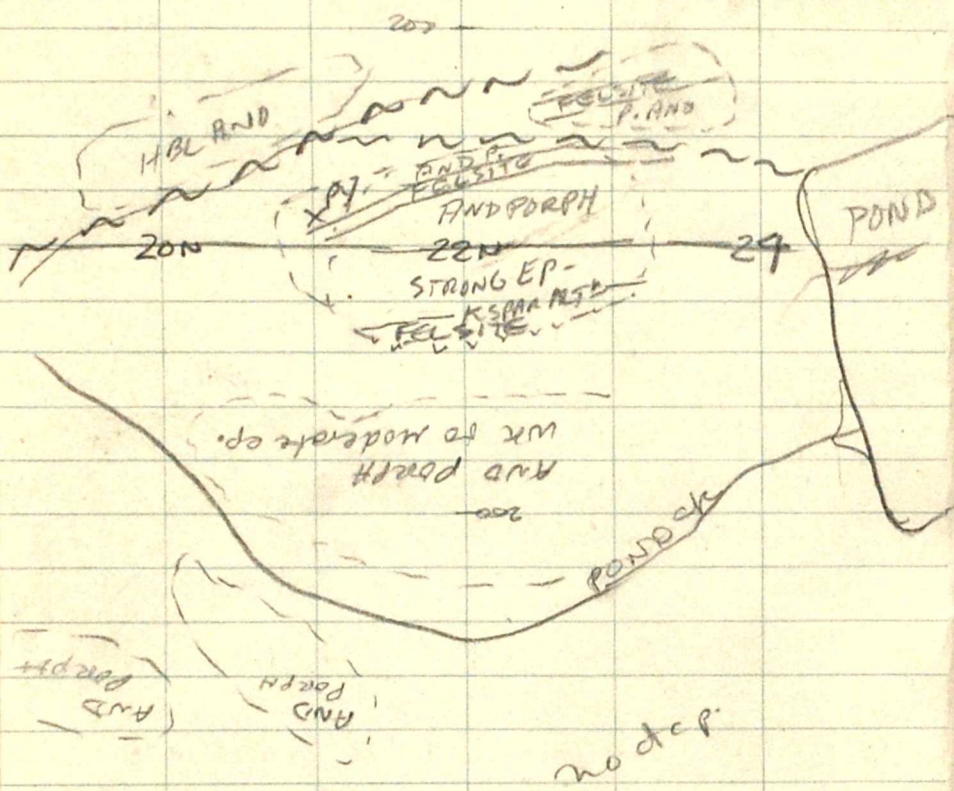

- zigzagged 3000ft to the north through 2-3ft deep snow to reach road. Where rock was exposed it was mainly andesite porph, usually with epidote up to ~ 25%.

- well mineralized float in ploughed up dirt beside road - mag-py & maybe cp.

26 May

L12N-1100W - step of hbl and.

27 May

BL crosses rd at 2750
KT BRUNCO POSTS are 200 FT E of
28 on BL

West side of Lion Creek

200 FT upslope from Roberta 1-2-3-4 post -
subtop of sugary white rock with
microlytic cavities & rusted out mafics.
Some rounded, clastic looking, fg grey
inclusions look like clasts in a cg,
but rock looks like felsite, not ss.

3D-35 - 1000 FT upslope from
last - volcanic breccia with
abundant limestone - some looks 10,
+ some 2° virelets, very porous,
uggy rock which looks like it would
be an ideal lost rock.

next step (beyond meadow) - small
step of ologomitic cg with
mainly granitic clasts up to 6".
General color white or buff.

next ridge is rhyolite or
trachyte flows with poorly
developed columnar jointing.
(3D-36)

"3D-37" - FROM nr. DDH 100 FT N
of L BS, 7000

3D-38 - ct ss from Karack (float)

3D-39 - massive sulph from ABLDITE
DKE 50 J L 8N, 4E

28 May

Photo 3 - hand trench at our BL-0-LINEO

Photo 4 - copper stain in microhedral
hblite dike in hand trench

Photo 5 - sulphides in vein on
Fault. Hammer lies on
massive sulphides.

Photo 6 - DDH # _____
mineralization on contact
of fg grey felsite dike with
andesite porphyry.

Photo 7 - epidote seam - close up

Rock Samples

3D-5 } Typical 1a
3S-40 }

3S-7 Typical 1b

3D-6 - Typical 1c

3D-38 - 1c with largest phenos
found

3D-22 - pyroclastic xl tuff - 1d

3D-35 - Flow top - Unit 1c and
1° marble (Unit 2)

3D-23 - either Unit 1 ^{volc} ss or
Unit 3 derived from 1
- rusty, conygon, pyritized

3D-33 - Unit 2 Marble lens
From showing w. Cu
(see also 3D-35 For U. 2)

3D-11 - brn siltstone - Unit 3a

3D-38 - chert ss (Kazack float).

3D-18 - Foss. SS 3b (From float)

3D-24 - Foss. SS (in place in Kazalonya)

- Unit 3c - ct cg - no sample

Unit 4 - no samples ^{Sustut cg}
^{Sustut ss}

3D-2 }
3D-12 } Unit 5a: various acid
3D-9 } dikes
3D-37 }
3S-26 }

3D-36 - rhyolite volc from w. of
Lion ck.

MINERALIZATION & ALTⁿ SAMPLES

" HBLENDITE " { 3D-27 - wkly mineral (3% py)
3D-13 - strongly min. (20% sulph)
3D-39 - 70% sulphides

" SCARN " { 3D4
3D28

EP-KSPAR-SIL ALTⁿ - 3D 33 (2 pieces)

^{SIL}
WK EP altⁿ - 3D-3
3D-14

BX calcified, pyritized,
& Sil andesite from } 3D-20
Fault zones } 3S-9
3S-14
3D-19

qtz-cp vein 3D-16

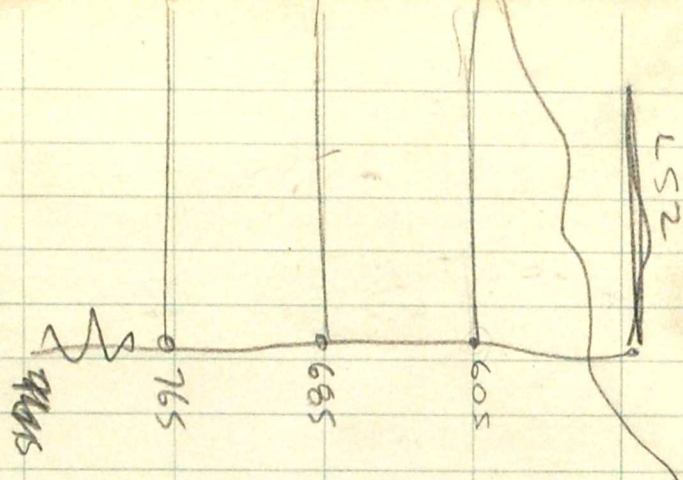

TUES: FLEW TO SMITHERS

WED: MOB TO PROPERTY

THURS: LINECUTTING

17: (S) (M) (H) (D) GEOL
SOILS & MAG

FRI: MAG SOILS LINECUTTING

18: MAG GEOL SOILS LINECUTTING GEOL

SAT: GEOL SOILS LINECUTTING GEOL

SUN: GEOL SOILS LINECUTTING GEOL

MON { SHORT DAY BECAUSE OF WEATHER }
21 { MAG SOILS LINECUTTING GEOL }

TUES 22 GEOL SOILS LINECUTTING GEOL

WED 23 GEOL SOILS LINECUTTING LINES & GEOL

THURS 24 MAG SOILS LINES GEOL (SAMPLING SHOWINGS)

FRI 25 MAG SOILS LINES GEOL
mag committed suicide

SAT 26 GEOL RECCY SOILS LINES GEOL
(ROAD)

SUN 27 GEOL RECCY SOILS RECCY SOIL LINE (KAZACH)

MON 28 GEOL RECCY SOILS LINECUT

TUES 29 GEOL GRID SOILS RECCY SOILS (UPPER KAZACH)

WED 30 } DEMOB TO SMITHERS

STN: TIME: RDG: CORR. FINAL VALUE

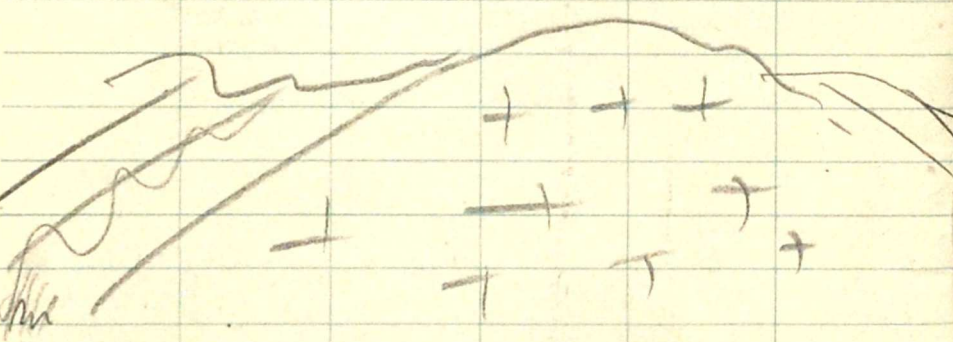

16 N -10

CHECK IN STN 0: (640) (-20) 620

640
680

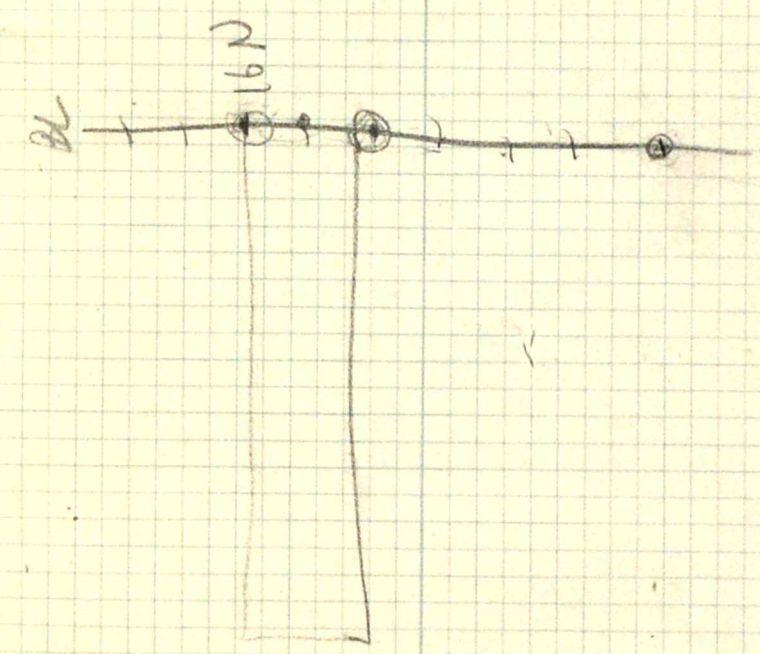

line flagger - roads
creeks
claim posts
ridge tops
line tie-ins to baseline

soil sampler - creeks & swamps.
- location relative to station
if more than 50 FT away
- sample: organic?
rust-stained?
- claim posts.
- sample creeks with
well developed silt
- note any occurrence of
rust staining or copper staining
or qtz veins in rock outcrops
along lines

mag - time

PACIFIC
WATERPROOF

Mining Transit Book

FILLER No. 321

KAZA COPPER PROJECT
PAUL SIHOTA
MAY 1973

GEOLOGY AND
MAGNETOMETER NOTES

↑
N

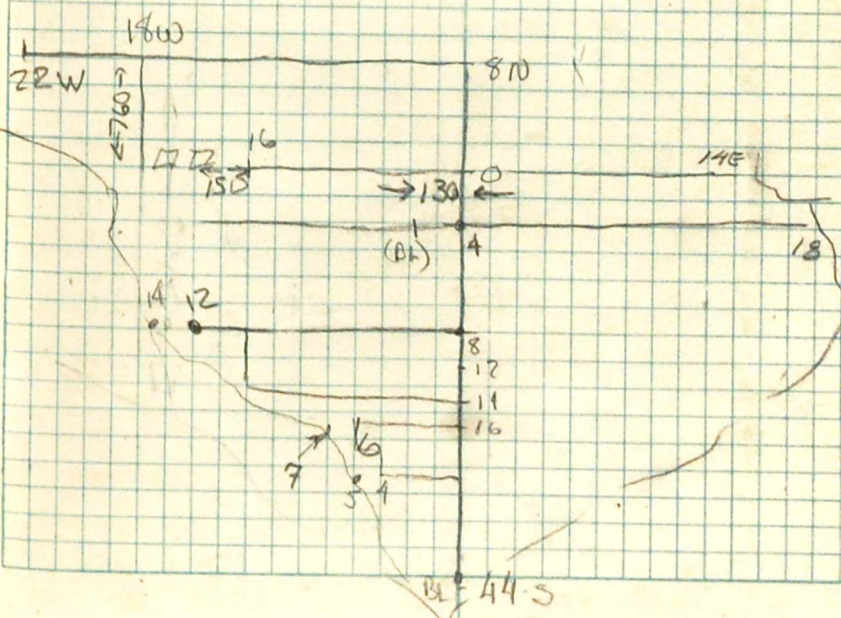

May 18/73

7/98 x 900

Stn.	Time	Rdg.	Corr.		
B.S	9:54	1100			
BL 00	10:22	550			
BL 2N	10:25	1100			
4N	10:27	1220			
6N	10:30	1860			
8N	10:33	2000			
10N	10:36	3200			
12N	10:38	3000	0	0	
14N	10:40	2400		16.	2420
16N	10:42	3700	4	33.	3730
16N-1W	10:44	3800	6	49	3850
16N-2W	10:46	2500	8	65.	2570
16N-3W	10:48	2600	10	82	2680
16N-4W	10:50	2450	12	98	2550
16N-5W	10:51	2400	13	106	2510
16N-6W	10:52	2400	14	114	2510
16N-7W	10:55	2650	16	131	2780
16N-8W	10:56	3200	18	147	3350
16N-9W	10:58	3100	20	163	3260
16N-10W	11:00	3400	22	180	3580
12N-10W	11:08	2600	30	245	2850
12N-11W	11:10	1700	32	261	1960
12N-12W	11:12	1430	34	277	1710
-13W	11:13	1490	35	286	1780
14W	11:15	1600	37	302	1900

12N-15W	11:17	1760	39	318	2020
12N-16W	11:18	1830	40	326	2160
-17W	11:19	1760	41	335	2000
-18W	11:20	1750	42	343	2090
-19W	11:22	2140	44	359	2500
20W	11:23	1870	45	367	2240
21W	11:24	1760	46	375	2140
22W	11:25	1850	47	384	2230
23W	11:27	1930	49	400	2330
12N-2380W	11:28	1740	50	408	2150
16N-28W	11:35	1530	57	465	2000
27W	11:37	1560	59	481	2040
26W	11:38	1750	60	490	2240
25W	11:40	1770	62	506	2280
24W	11:41	1750	63	514	2260
23W	11:43	1800	65	530	2330
22W	11:44	1880	66	539	2420
21W	11:45	1800	67	547	2350
20W	11:47	2060	69	563	2620
19W	11:48	1730	70	571	2300
18W	11:49	1500	71	579	2080
17W	11:50	1680	72	588	2270
16W	11:52	1650	74	604	2250
15W	11:53	1500	75	612	2110
14W	11:54	1400	76	620	2020

16N-13W	11:56	1200	78	636	1840
16N-12W	11:59	900	-80	653	1550
OP' W of 10W	12:00	2200	81	661	2860
BL 16N	12:13	2580	3700	+1200	94 3270
14N	12:15	1600	2400	+800	2380
12N	12:17	2350	3000	+650	98 3150
10N	12:19	2580	3200	+620	
8N	12:22	1460	2000	+540	
6N	12:24	1500	1860	+360	
4N	12:26	1250	1220	-60	
2N	12:28	1000	1100	+100	
BL 00	12:30	460	550	+90	

16	3500	3100			
14	2400	2000			
12	3080	2680			
10	3290	2890			
8	2130	1730	1390	740	150
6	2080	1680	1660	480	-100
4	1650	1250	1110	540	50
	↑ corrected vals				
					590

May 19/73

Sta	time	reading				
BL-00	10:23	-2740				
BL-2N	10:26	-2230				
BL-4N	10:28	-2060				
6N	10:30	-1500				
8N	10:32	-1800				
10N	10:35	-1280				
12N	10:38	-1040				
14N	10:40	-1750				
16N	10:42	-730	730	-		
14N	10:44	-1780	1750	-30	0	
12N	10:46	-1020	1040	-20	0	
10N	10:48	-715	1280	-565	0	
8N	10:51	-1750	1800	-50	0	
6N	10:53	-1580	1500	-80	-10	
4N	10:55	-2090	2060	-30	-10	
2N	10:57	-2200	2230	-30	-10	
BL-00	10:59	-2750	2740	-10	-10	
BL-00	11:11	-2760				
25	11:13	-2040				
45	11:15	-1940				
65	11:17	-1920				
85	11:19	-1900				
105	11:21	-1900				
125	11:23	-1820				
145	11:25	-1800				

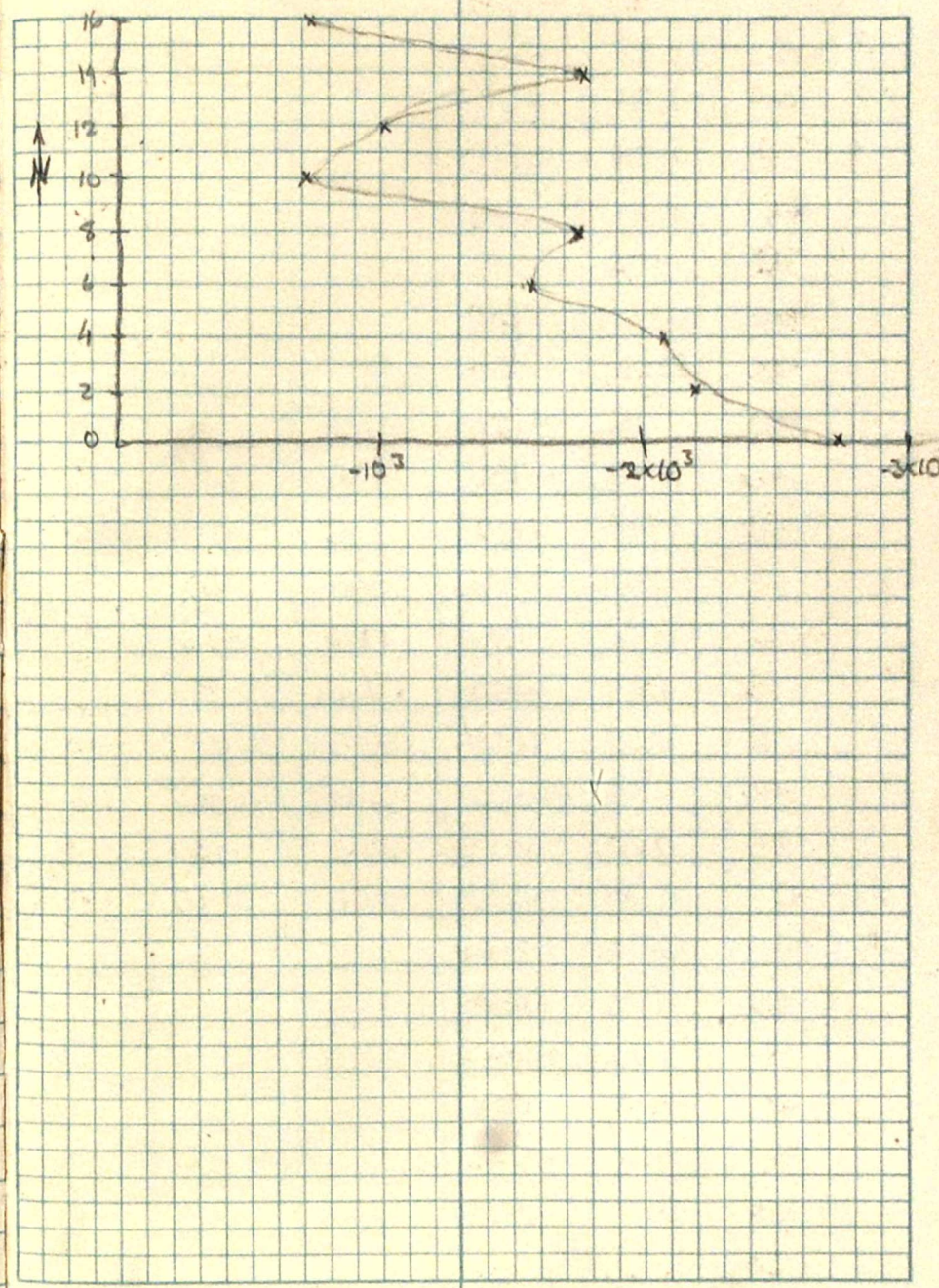

165	11:28	-980			
185	11:32	-1900			
205	11:34	-1490			
225	11:35	-1400			
245	11:37	-790			
265	11:39	-655			
285	11:42	-585			~ CORR.
305	11:44	-1140	1140	-	+30
285	11:46	-595	585	515 +20	
265	11:48	-630	655	685 +55	
245	11:50	-790	790	820 +30	
225	11:53	-1350	1400	1430 +80	
205	11:55	-1500	1490	1520 +20	
185	11:57	-1820	1800	1830 +10	+30
165	11:59	-1010	980	1020 +10	+40
145	12:02	-1870	1800	1840 +30	
125	12:04	-1850	1820	1860 +10	
105	12:06	-2060	1900	1940 +120	
85	12:08	-2000	1900	1940 +60	
65	12:10	-1940	1920	1960 +20	
45	12:12	-1990	1940	1980 -10	
25	12:14	-2100	2040	2080 -20	
BL-00	12:15	-2800	2760	2800 40	+40

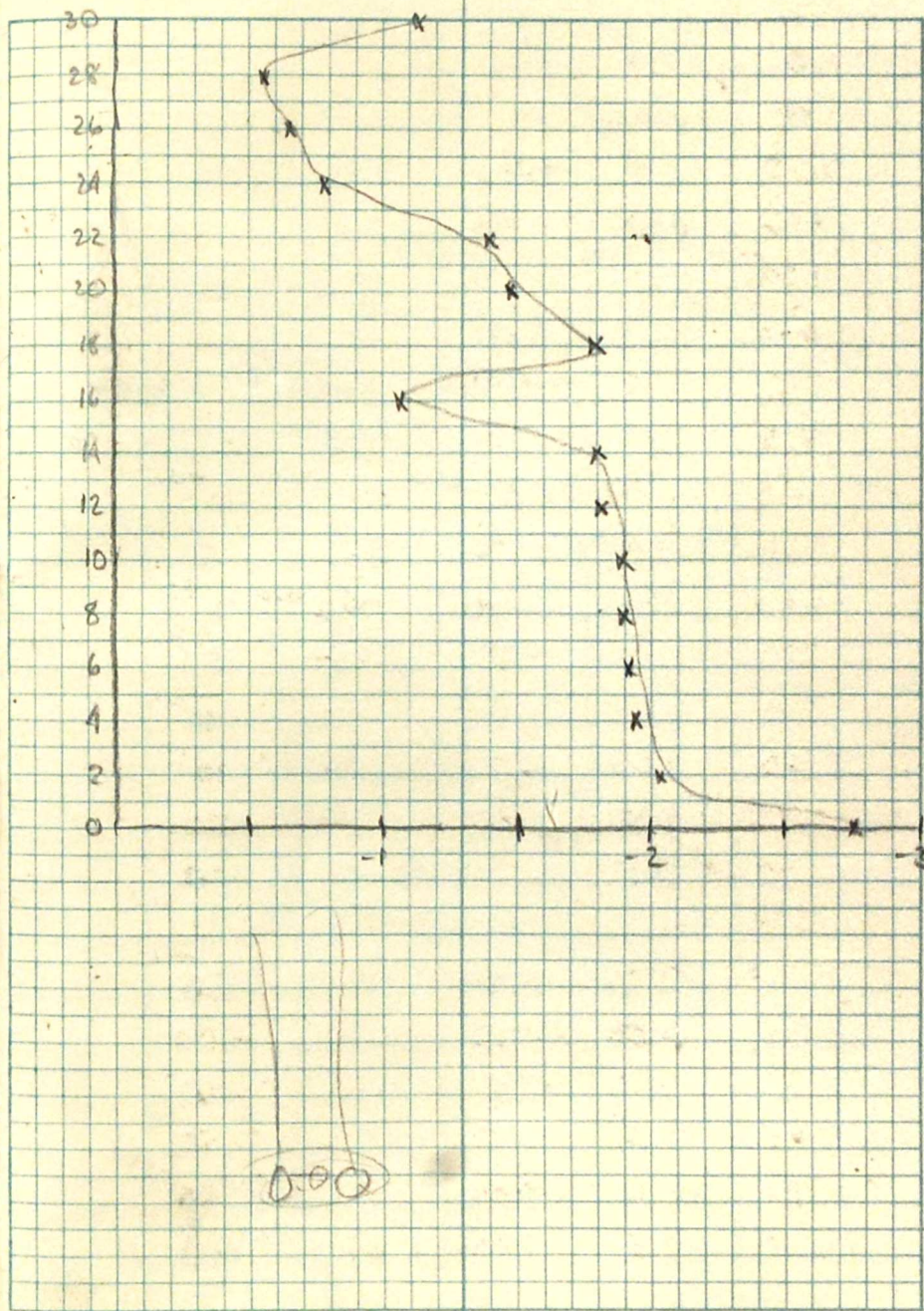

May 20/73 - Line 1200 S

1800 E	road
1525 E	pisser flowing S
2050	small creek " S
2300	pisser flowing SW
3700	small creek flowing S
4600	crest of hill sloping vry gently up to N
5200	35-3 andesite w/ small disseminated pyrite? - float
5400	pisser flowing S.
5600	35-4 f.g. basic volcanic w/ amphibole phenocrysts fractures
100' S of 5600	35-5 andesite w/ veinlets & blebs of calcite
6000	top of stream bank
	35-6 pyroxene andesite
	35-7 volcanic tuff interbedded? w/ 35-6

LINE 2000 S

5350 E	pyroxene-blebbed andesite - stream bank
4800 E	N. side gulley - basic f.g. volcanics in place?
4600	rusty zone \approx 100' N-S 50' E-W
	35-8 breccia
	35-9 volcanic
3800	small creek flowing S
2000	large pisser " "
1850	road
1200	pisser let (S)

E

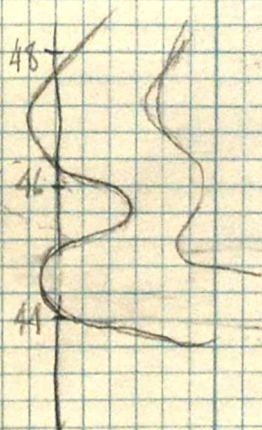
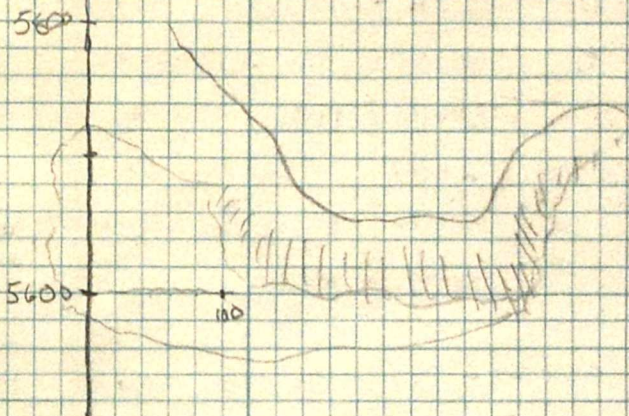

May 21/73

BL-00	10:20	500			
2N	10:23	990			
4N	10:25	1100	0		1100
6N	10:27	1570		5	1580
8N	10:30	1400	5	9.8	1410
NINE (N) - (W)	10:31	1260		13	1270
2W	10:32	1100		16	1120
3W	10:34	1100	10	19.5	1120
4W	10:35	1160		22	1180
5W	10:37	1120		24	1140
6W	10:38	1500	14	27	1530
7W	10:40	1540		30	1570
8W	10:42	1940		33	1970
9W	10:43	1840	19	37	1880
10W	10:45	1300		40	1340
11	10:46	1840		44	1880
12	10:48	1876	24	47	1920
13	10:50	1810	26	50.7	1860
14	10:53	1450	34	66	1520
15	11:00	1930		68	2000
16	11:01	2040		71	2110
17	11:02	1980		73	2050
18	11:03	1840		76	1920
19	11:04	1670	40	78	1950
20	11:05	1900		81	1980
21	11:07	2060	43	83.9	2140

160 x ~~82~~
82

8N-22W	11:08	2330		44	85.7	2420
LINE 4N-19W	11:15	2200		51	99.5	2300
18W	11:16	2240			102	2340
17	11:18	1840			105	1950
16	11:19	1650		55	107	1760
15	11:21	1760			109	1870
14	11:22	2200			142	2310
13	11:23	2000		59	115	2120
12	11:25	1880			118	2000
11	11:27	1600			122	1720
10	11:28	1650		64	124.9	1780
9	11:30	1930			129	2060
8	11:32	2000			133	2130
7	11:34	1750		70	136.6	1890
6	11:35	1330			140	1470
5	11:37	1300			143	1440
4	11:39	1100		75	146	1250
3	11:40	1050			149	1200
2	11:42	1040			152	1190
1	11:45	980		(82)	80	1140
BL 4N-0	11:47 ^{10.25}	960	1100		140 ¹⁶⁰	1110
6W	11:50 ²⁷	1450	1570		120	1680
5N	11:51 ³⁰	1200	1400		200	1360
BL-00	12:00	200	500		86	

May 22/73

Line 28 S

200' S of 1200 E

Initial Fire 29, 30

Final Fire 31, 32

July 14/67

2750 E road

100' @ 240° 3S-10, 3S-11, 3S-12

From 2800 E

feldspar porphyry w/ mineralization
along fracture surfaces (pyrite?)
outcrop ≈ 25' long 10' wide

3750 E small amphibole phenocrysts in andesite

3S-13 v. small outcrop(?)

LINE 36 S

100' S of 4000 E outcrop on bank of Kaya Creek

3S-14 fractured volcanics filled w/ calcite
just N of stream → Kaya

3950 E in stream bed

3S-15 calcareous siltstone w/ disseminated
pyrite bedrock?

3S-16, 17 porphyry w/ mineralization
along fracture sfc float?

2950 road

2350 3S-18 v. small outcrop(?) of vg volcanics

LINE 44 S

100' N of 1200 E 3S-19 volcanic tuff(?) brown

200' N of long Kaya Creek 3S-20 brecciated andesite w/ calcite

May 24/73

1.1765

Bl-00	12:09	530	0		530
2s	12:11	1200	2	-2	1200
4s	12:12	1250	3	-4	1250
6s	12:13	1300	4	-5	1300
8s	12:15	1240	6	-7	1230
10s	12:16	1150	7	-8	1140
12s	12:18	1350	9	-11	1340
6s	12:22	1300	13	-15	1290
BL-00	12:26	550	17	-20	530

BR-05-0	12:41	520	0		
1		1250	1		
2	12:43	1290	2		
3		1470	3		
4	12:45	1300	4		
5		1300	5		
6	12:47	1200	6		
7		1300	7		
8	12:49	1700	8		
9		1500	9		
10	12:51	1600	10		
11		2200	11		
12	12:52	2000	12		
13		1600	13		
14	12:54	1500	13		

15	12:00	1800	14	
16	12:56	2100	15	
17	12:57	2200	16	
LINE 45 - 15W	1:00	1660	19	1650
19W		2400	20	2390
13	1:02	1850	21	1840
12		1700	22	1690
11	1:04	1700	23	1690
10		1600	24	1590
9	1:05	1650	24	1640
8		1450	25	1440
7	1:07	1550	26	1540
6		1200	27	1190
5	1:09	1250	28	1240
4		1200	29	1190
3	1:12	1050	31	1040
2		1350	32	1340
1W	1:14	1270	33	1260
BL - 45	1:16	1290	35	1270
25	1:18	1200	37	1190
00	1:19	530	38	520
BL - 85	1:37	1250	0	
1W		1240	2	
2W	1:40	1180	3	

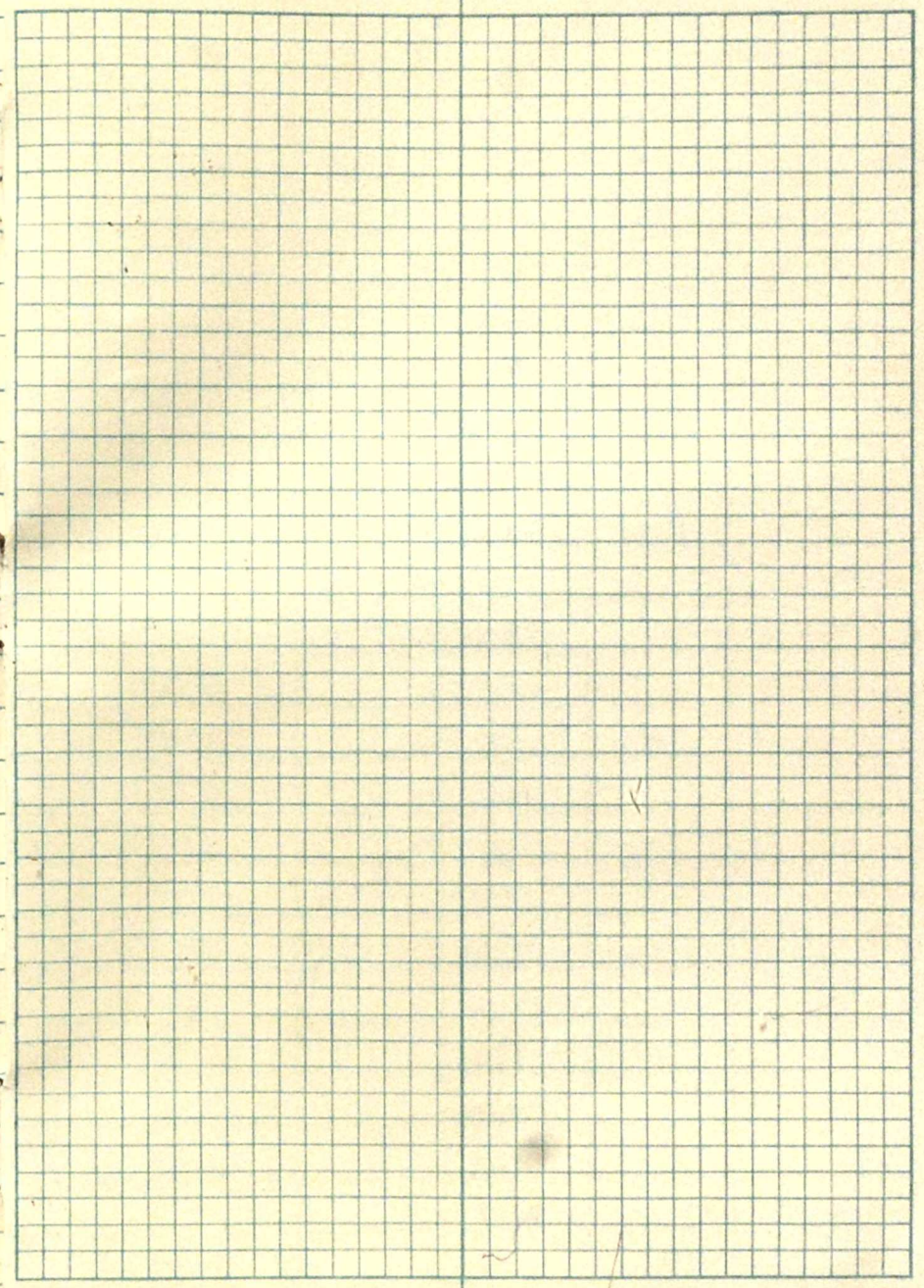

	3w		1150	4 -10	1140
	4w	1:42	1400	5 -10	1390
	5		1460	6 -10	1480
	6	1:44	1130	7 -10	1120
	7		1300	8	1290
	8	1:46	1400	9	1390
	9		1930	10 -20	1910
	10	1:48	1970	11	1950
	11		1840	12	1820
	12	1:50	2100	13	2080
				15 -20	
125	100	1:53	2300	16 -30	2270
	9		2200	17	2170
	8	1:55	1900	18	1870
	7		1850	19	1820
	6	1:57	1900	20	1870
	5		2100	21 -30	2070
	4	1:59	1650	22 -40	1610
	3		1700	23	1660
	2	2:01	1950	24	1910
	1		2000	25	1960
145		2:03	1650	26	1610
	125	2:04	1400	27 -30	1360
	105	2:06	1200	29 -50	1150
	85	2:08	1360	31 -50	1250
	65	2:14	500		

10 S	2:56	1360	0	
11		1450	1	
12 S	2:58	1500	2	
14 S	3:01	1900	5	
16 S	3:04	2450	8	
18 S	3:06	1700	10	
20 S	3:07	1950	11	
12 S	3:13	1900	17	+400
11 S	3:14	1300	18	+150
10 S	3:15	1400	19	-40

-97

LINE 16 S	3:23	2400		
10 2		2250		
2	3:25	1850		
3		1700		
4	3:27	2150		
5		1700		
6 W	3:29	1850		

LINE 20 S-5	3:32	1950		
4	3:34	1890		
3		1700		
2	3:36	-1550	3:40	-1700
1		2200	"	2100
0	3:38	1600	3:42	1550

185 3.44 1370

165 3.46 2380

May 25/73

BL-00 10:34 530

25 1300

45 10:36 1350 2 +10 1360

65 1350 1360

LINE 85 10:40 1300 6 +20 1320 ← -110

1E 1550 1570

2E 10:43 1250 9 +30 1280

3 1200 1230

4 10:45 1250 11 1280

5 1350 1380

6 10:47 1350 13 +40 1390

7 1170 1210

8 10:49 1480 15 1920

9 1380 +50 1430

10 10:51 1400 17 1950

11 1500 +60 1560

12 10:55 1500 21 +60 1560

13 1400 +70 1470

14 10:57 1500 23 +70 1570

15 1300 1370

16 10:58 1300 24 1370

	17E		1750	+80	1830	
	18	11:01	1250	27	1230	
	19		1200		1280	
	20	11:03	1050	29 +90	1140	
LINE 4S	19C	11:07	1370	33 +100	1470	
	18		1250		1350	
	17	11:09	1500	35	1600	
	16		1300	+110	1410	
	15	11:11	1300	37	1410	
	14		1250		1360	
	13	11:13	1500	39 +120	1620	
	12		1600		1720	
	11	11:15	1400	41	1520	
	10		1200		1320	
	9	11:17	1400	43 +130	1530	
	8		1800		1930	
	7	11:19	1250	45	1380	
	6		1200	+140	1340	
	5	11:21	1300	47	1440	
	4		1200		1340	
	3	11:23	1180	49 150	1330	
	2		1600		1750	
	1	11:24	1200	50	1350	
	4S-0	11:25	1200	+150	1350	1360
	2S	11:27	1100	+200 +160	1260	1280
BL-0S	11:28	400	+130	560	550	

BL-00	11:39	530	6			-70
20	11:41	1100	2			
LINE 40	11:42	1200	4			
1E		1250				
2	11:45	1300	7			
3		1450				
4	11:47	2450	9			
5		2000				
6	11:49	2450	11	+10	2460	-
7		2950			2960	-
8	11:51	3000	13		3010	-
9		2400			2410	-
10	11:54	2200	16		2210	-
11		2500			2510	-
12	11:56	1950	18		1960	-
13		1400			1410	-
14	11:58	1600	20		1610	-
15		1600			1610	-
16	12:00	1500	22		1510	-
17		1500			1510	-
18	12:03	1900	25		1910	-
19		1800			1810	-
20	12:05	1200	27		1210	-
LINE 0 - 20E	12:12	1500	31	+20	1520	-
19E		1650			1670	

18	12:14	2000		2020
17		2250		2270
16	12:16	1900		1920
15		1500		1520 ✓
14	12:19	1400		1420 ✓
13		1550		1570
12	12:21	1400		1420
11		1450		1470
10	12:22	1500		1520
9		1600		1620
8	12:24	1300		1320
7		2000		2020
6	12:24	1600		1620
5		1500		1520
4	12:28	1600		1620
3		1550		1570
2	12:30	1400		1420
1		1250		1250/1270
BL - 0	12:32	500	+30	530
25	12:34	1050	+50	1080
15	<u>12:36</u>	1200		1230
105	1:49	900		30
115		830		90
125	1:51	1150		110
				120
				40
				<u>440</u>

145		1250
165	1:54	2300
1E		2100
2	1:57	2600
3		2300
4	1:59	2700
5		1800
6	2:01	1500
7		1800
8	2:03	1700
9		1600
10	2:05	1500
11		1600
12	2:07	1700
13		1800
14	2:06	1800
15		1750
16	2:10	1700
17		1650
18	2:12	1500
19		1700
20	2:14	1550
LINE 125 - 20E	2:24	1300
19		1100
18	2:26	1150

LINE 125 17E		1100
16	2:24	1050
15		1000
14	2:30	1000
13		940
12	2:32	800
11		780
10	2:35	820
9	2:36	1100
9	2:42	??

LINE 4S (4N, 8N - 24N-W)

May 26/73

2400 E	epidotized andesitic tuff w/ pyrite interbedded (?) with abundant feldspar porphyry. Small felsic dyke (?). Outcrop scattered across Knoll just N of 2400E → 2600 E	
2800 E	35-21	altered andesite w/ calcite & pyrite sub-outcrop scattered outcrop indicates continuation of "altered" rock, porphyry & dyke alternation to 3000 E
100' W of swamp on x 2S	35-22	hornblende andesite w/ pyrite sub outcrop
500' W of swamp on x 6N ridge crest	35-23	porphyritic andesite outcrop ± 100' E-W 200' N-S fractures filled w/ calcite

35-24
N tip of ridge andesite porphyry w/ minor epidotization & calcite

next ridge similar		
500 W		
600 NW	± p	
↓ 200 W andesite		
250 W	35-25	felsic dyke in andesite
400 W	35-27	epidotized andesite
450 W	small creek & 35-26	felsic dyke knob ~ 25' R in andesite with small amphibole phenocrysts
600 W	1700 N	40 BL
sub outcrop	pyritized andesite @ 1050 N	40 BL
LINE 8N	40E	- similar to 35-23
200 N of 30E	aphanitic andesite	w/ occasional feldspar phenocrysts
100'S of 23E	andesite	w/ some epidotization & pyrite calcite in blebs & veinlets
150'S of 22E	35-28	- andesite w/ some mineralization some malachite staining
400 N	outcrop along ridge	feldspar porphyry - epidotized of 2400 E on 4N
150' E of 2200 4N	faulting	- altered andesite w/ some mineralization
100' N of 2300 4N	aphanitic andesite	w/ some mineralization
200 N of 2200 4N	tuff	interbedding of porphyry etc.
	light ground mass dark angular 1/2-2 particles	all epidotized - some calcite

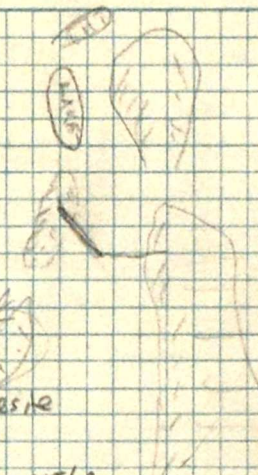

2050 E similar to 35-28
on 31N
1700 E aphanitic andesite w/ calcite in blobs some pyrite

May 27/73

small creek crossing road → creek: 35-29 altered andesitic
tuff - epidotized w/ calcite; v. minor mineralization w/
some malachite staining. Highly fractured.

May 28/73

LINE 32 N

200' S of 1400 E f.g. andesite

100' S 1400 E feldspar porphyry w/ some calcite
(LINE 24N) evidence of minor pyrite

300' N of 1000 E - 31N : f.g. andesite w/ v. occasional pyrite &
feldspar phenocrysts

on line 32N
from 1800 E - 2200
feldspar porphyry w/ epidote & pyrite

2100 on 32N similar to above, extending S of line in
patchy outcrops to within 200' of 2200 on line 24N

≈ 2600 on 24N - 200' S andesite w/ small feldspar phenocrysts
some epidote & pyrite

from 3300 on 32N → 3400 on 24N ≈ 500' from lake
feldspar porphyry w/ epidote & occasional
evidence of pyrite

between 34 & 35 on 24N: f.g. andesite w/ epidote
quartz veins & veinlets through rock

100' S of 24N - 39 E : silicified andesite w/ occasional
feldspar phenocrysts. Some epidote

Small outcrops of andesite along ridge to 160-58E

South of 160-58E small outcrop of hornblende porphyry

@ 120-38 E f.g. andesite

150' S of 120-38 E feldspar por. w/ epidote & some silica

120-28 E silicified feldspar por.

16N-26 E andesite w/ epidote & occasional ^{small} feldspar
&/or hornblende phenocrysts.

200' N of 16N-18 E feldspar por.

16N-18 E feldspar por w/ epidote & some silica

16N-18 E to 120-20 E porphyritic andesite w/ some epidote
pyrite near 120-20 E

120-16 E last outcrop = feldspar por.

52 → 58

May 29/73

conglomerate $\approx 150/30$ W

35-30 5' trachyte^(?) dyke w/ feldspar phenocrysts
 $\times 148/32^\circ$ W intrude conglomerate

35-31 felsic dyke 100' down stream from congl.
jointing $\approx 204/80^\circ$ E $\times 076/68^\circ$ N
(blocky)

interbedding of coarse sandstone & congl
bedding $\approx 150/36$ W
sandstone coarse w/ occasional fragments
averaging 1cm

congl. w/ mainly intrusive cobbles (av. 6cm)
congl. overlies sandstone - appears to grade into
sst.

overlying congl. : ^{fine} sandstone 35-32 @ $136/78^\circ$ W

50' past congl - felsic dykes - main joints $\approx 136/58^\circ$ W
intruding : congl. & coarse sst @ $155/30^\circ$ E
(interbedded)

across creek (S) coarse sst w/ pyrite 35-33 @ $150/36^\circ$ E
congl $\approx 35'$ up stream

200' @ 340° from creek ; felsic dyke

200' W of N end of Beaver Ponds (on stream) felsic o.c.

100' N of stream - graded congl

200' N of stream \rightarrow N end meadow felsic o.c. } interbedded
at end of meadow & just E of above - congl.

coarse sst 500' SE of meadow

1500' SE of meadow felsic dyke

+100' congl

felsic = rhyolite

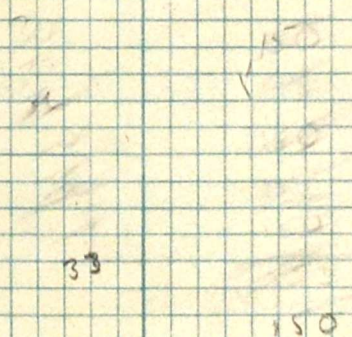

May 25/73

① greenish f.g. volcanic w/ small amphibole
crystals & fine quartz veinlets

@ N12 1060w - 1140w

② andesite w/ small phenocrysts
of amphibole & feldspar

@ N16 2000w R=50'

N16-10w andesite = 25' (US)

N16-3.5w andesite w/ feldspar phenocrysts

N16-2.5w road.

N16-00 epidotized andesite

N8-1w epidote & chlorite (altered?)
orthoclase?
road.

N4-25.4w fences

45 w road

12 w road

2462

PACIFIC
WATERPROOF

Mining Transit Book

FILLER No. 321

B. HOWARD

KAZA COPPER PROJECT
GRID NOTES

1973

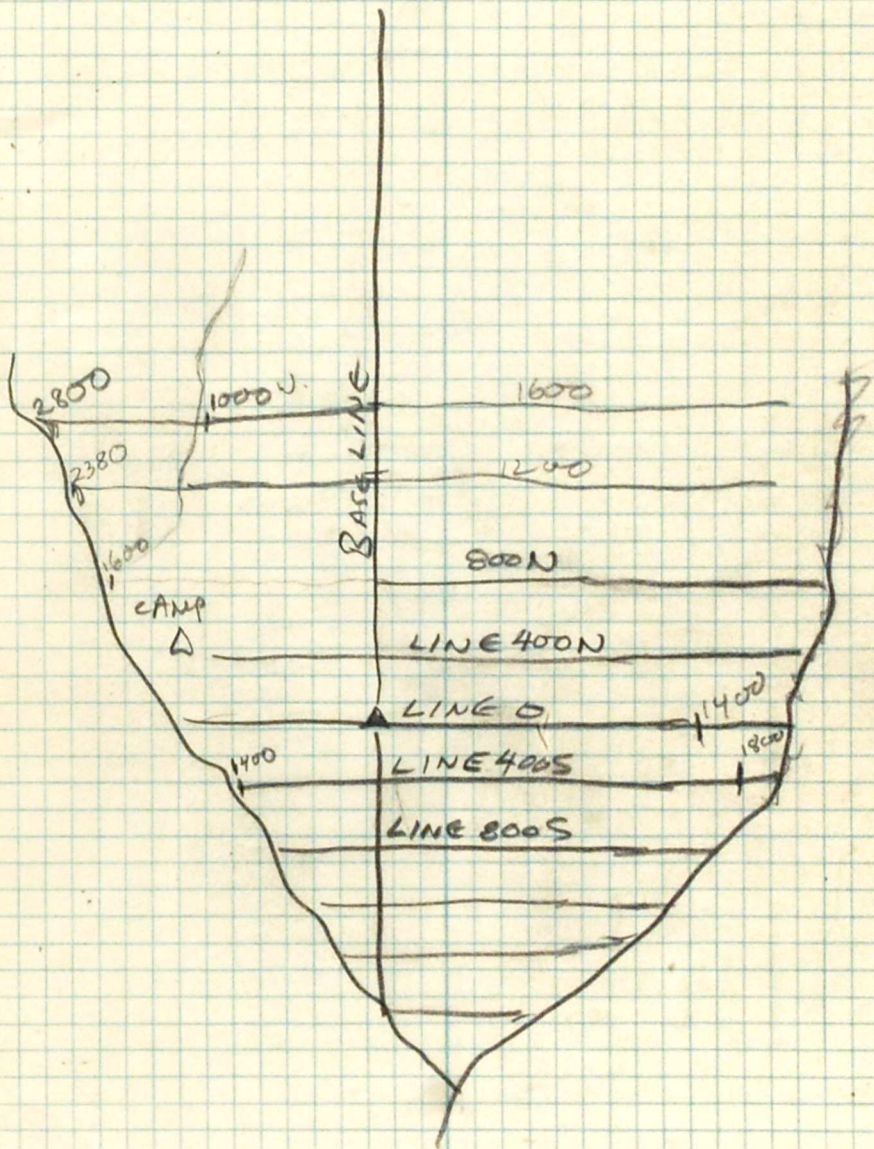

KAZA CK. BANK SAMPLE

1) 200' E 2800 N on BL.
CLAIMS POST.

BRONCO 1st INITIAL
LEFT 1500.

BRONCO 2nd RIGHT 1500
2nd POST NE.

1) 3KH1 WEST BANK.

2) 3KH2 WEST BANK

3) 3KH3 EAST BANK.

4) 3KH4 SILT

5) 200' N OF 3KH7 5' CK -

6) 3KH8 RUSTY SOIL
ROCK SLIDE (sample)
GOSSAM

7) 3KH9S STREAM sample

8) 1' CK

9) 3KH22 Bottom of Reed
3KH23 Rock Canyon.

10) 3KH24S CK near
Bottom of Canyon.

11) ~~3KH30 of 50's 6' CK~~

50's. of 3KH30 is 6' CK.

LEO STN. E

1) APPROX - 320 FT. TO PEAK OF Hill.

2) small CK crosses LINE O AT
APPROX 1085 FT E

3) 1500' E SWAMP.

4) 3800' E 5' CK.

5) 2800 E 4' CK.

6) 1600' E 4-5' CK. POND.
BL

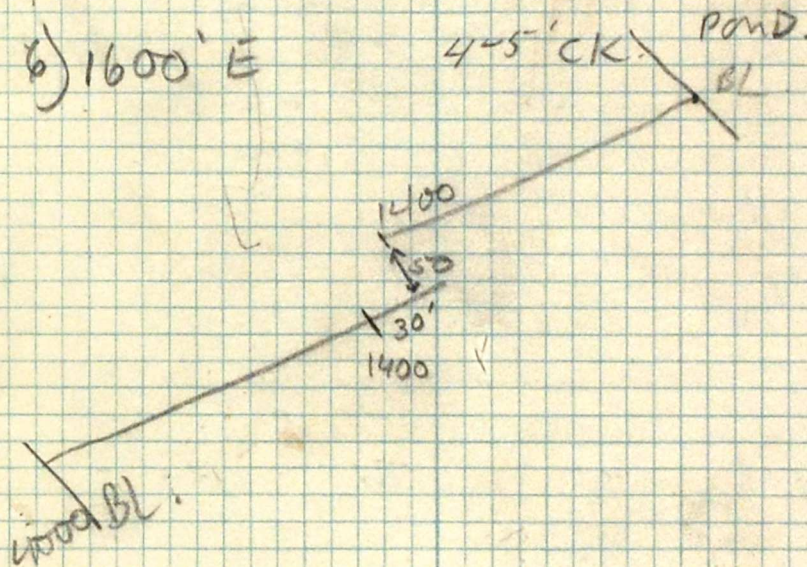

SIDE OF SCALLOP MT.

Soil Sample
Tue 29 MAY 73

3KH35 WEST OF LOG SARM.
 3KH38 1500' S.
 3KH39 2000' S - Headed 1000'
 (TAKEN BESIDE) WEST FOR NEXT sample
 5' CK

3KH39 — wet meadow — ^{DRY} 3KH40.
 → WEST.

3KH43 - heads ~~to~~ NW FROM 3KH42
 TO AVOID WET MEADOW
 TO N.

3KH44 ACROSS WET MEADOW
 APPROX 800' FROM 3KH43

3KH47 2' CK. (1/2 way between 3KH46)
 AND 47 IS 5' CK

3KH48 - BESIDE 10' CK.

3KH49 ROBERTA 5+6 (FINAL)

3KH50 BESIDE 4' CK.

3KH54 - 1000' E TO 3KH55

1/2 WAY BETWEEN 3KH61 & 3KH62
 IS 10' CK.

3KH64 FINAL FLAG.

LINE 400 S.

- 1) 1650' E (SMALL CK. 2' WIDE)
SEASONAL
- 2) 1800' E (3' CREEK)
POSSIBLY SEASONAL
- 3) 600' E Summit of Hill
- 4) 360' W CROSS ROAD sed.
- 5) 1480' W TRIBUTARY OF LION CK.

6) Note Base line crosses 400 S.
 at approx 125' EAST
 of Base line FLAG on
 400 S. Line

7) line ^{385'} south at B.L. intersection

- 8) 2600' E 3' CK.
- 9) 3200' E HEIGHT OF LAND
- 10) INTERSECTS WITH BL 4000' E
 AT ~~39~~ ~~40~~ 4050'
 AND AT 450' S

3200 N

1) 500' W + 1' CK ~~██████████~~

2) 750' W ^{Same} + 1' CK

3) 1300' W 4' CK

4) 1700' W 2' CK

5) ~~2000~~ 2000' W Final Flag

1) 750' E 3' CK

2) 1050' E ROAD

3) 1950' E Height of Land

4) 2400-2600 2' CK MUSKEG

5) 3100' E Height of Land

6) 3550' E FINAL FLAG
Bog

LINE 1600 N

1) 300' W CROSS ROAD TRENCH

2) 1100' W ^{1200' W} LARGE BRAIDED CK.

3) 2800' W MARSH - beyond which
ANOTHER 900' IS
FROM CK.

1) 3700' E Height of Land

2) 3100' E 2' CK

3) 2600' E Height of Land

4) 2225' E 2' CK

5) 1800' E Height of LAND

6) 1075' E 4' CK

7) 400' E Height of Land

8) INTERSECT WITH O Base line
at 4125' FROM 4000' E BL
AT 1595' N on O B.L.

LINE 1200 N

1) 2380 W TRIBUTARY OF LION CK.

2) 2600' W LION CK.

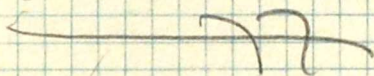

1) 400' E Height of Land

2) 1400' E 4' CK.

3) 2000' E Height of LAND

4) 2400' E 2' CK.

5) 3500' E 3' CK.

6) 3800' E Height of Land

7) INTERSECT BASELINE 4000 E

EAST AT ~~4000~~ 4100' E

AND AT 120' N OF 1200' on BL.

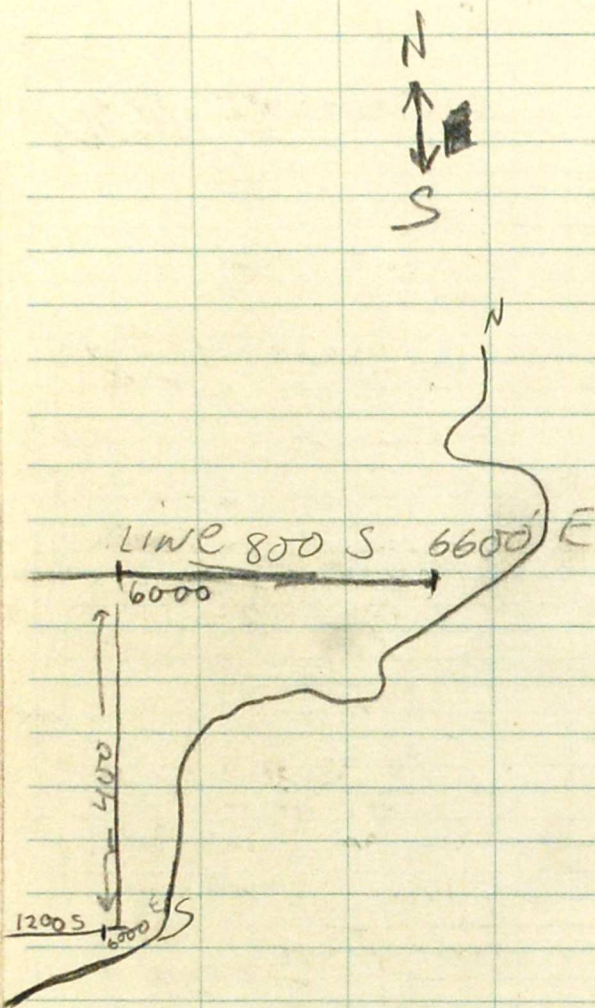

LINE 800 S

- | | |
|------------|----------------------------|
| 1) 200 E | LINE CROSSES ROAD TRENCH |
| 2) 725 E | CROSS ROAD |
| 3) 750 E | CROSS TRENCH WORKING |
| 4) 850 E | HIGH POINT OF RIDGE HILL |
| 5) 1740 E | SMALL CK 3-4' wide |
| 1850 E | " " CK. 3' wide. |
| 6) 2290 E | SMALL CK 2' wide SEASONAL. |
| 7) 3000 E | HEIGHT OF LAND-HILL |
| 8) 3725 E | 6' WIDE CK. |
| 9) 3900 E | <u>CLAIM POST FINAL</u> |
| 10) 4400 E | HEIGHT OF LAND |
| 11) 5200 E | WET MEADOW & SMALL CK |
| 12) 5800 E | HEIGHT OF LAND |
| 13) 6150 E | SMALL CK 2' wide |
| 14) 6700 E | River |
- CLAIM NAME BURN 4th + 3rd?
 LOCATOR R. TRIT
 North Star
 EXPLORATIONS
 June 13/07
- INITIAL POST
 FIRE 38 + 37
 37th = 1500' TO LEFT
 38th = 1500' TO RIGHT
 TO SECOND DIRECTION N. POST

800 N

- 1) 3725' E 2' CK
- 2) 2660' E 2' CK
- 3) 2500' E 3' CK
- 4) 2050' E Height of Land
- 5) 1400' E 4' CK
- 6) 400' E Height of Land

- 7) INTERSECT BL. AT
110' N OF 800 N on BL
120' E OF BL

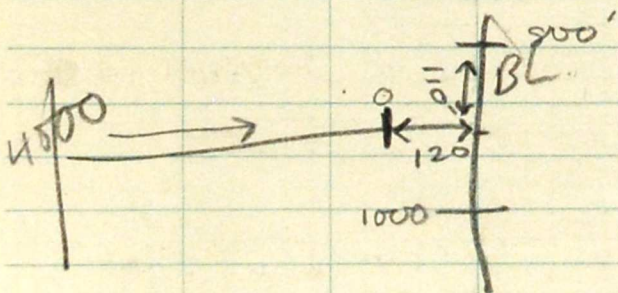

LINE DOOS

- 1) 6000' E River
- 2) 5400' E CK. 2-3' WIDE
- 3) 4600' E HEIGHT OF LAND
- 4) 3750' E CK. 6' WIDE
- 5) 3200' E HEIGHT OF LAND
- 6) 2250' E CRK. 3' WIDE
- 7) 2050' E CK. 4-5' wide
- 8) 1975' E CK. 2' wide

confluence approx
250' downstream S.

- 9) 1850' E 2' CK
- 10) 1775' E ROAD
- 11) 1330' E CROSS OUT FLAGGED, BLAZED
LINE
Running NE-SW

-
- 12) INTERSECT WITH Bull line
125' Long
50' N

LINE 1600 S

- 1) 1000' E HEIGHT OF LAND
- 2) 1770' E ROAD
- 3) 1925' E 5' WIDE CK.
- 4) 3400' E HEIGHT OF LAND
- 5) 3750' E 4-5' CK.
- 6) 4600' E HEIGHT OF LAND
- 7) 5200' E 2' CK.
- 8) 5400' E River

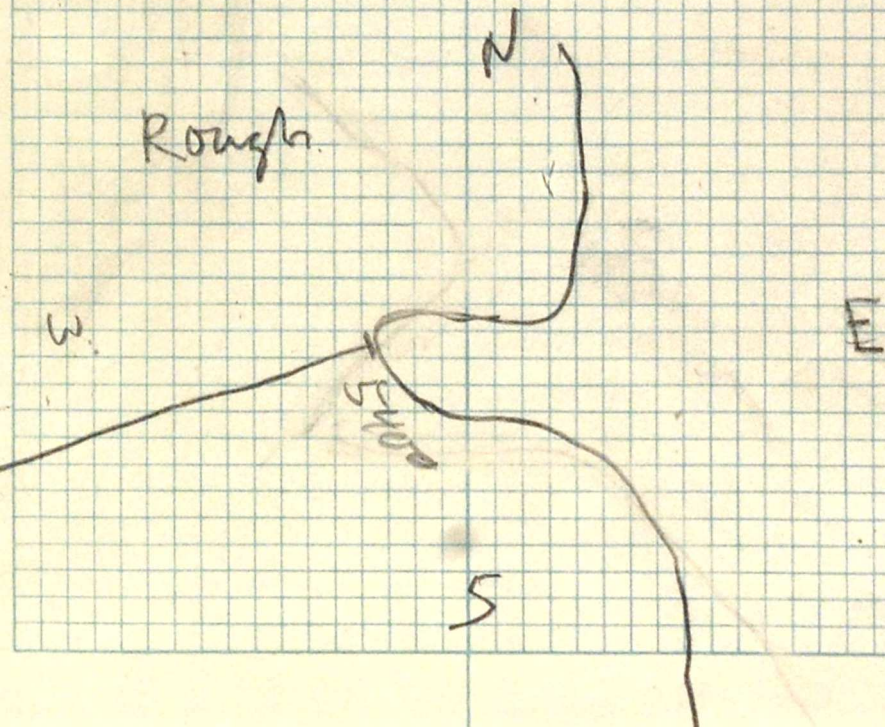

LINE 2000 S.

- 1) 4600' E SMALL POND + gully
Running E to W.
- 2) 4600' E RED SOIL + ROCKS.
- 3) 3800' E 4-5' CK.
- 4) 3400' E HEIGHT of LAND.
- 5) 2025' E 5' wide CK.
- 6) 1875' E Road.
- 7) 2000 LINE E BISECTS
BASELINE AT 1830 S.

+ EXTENDS
~~S~~ APPROX 40' W of
BASELINE

LINE 400 N

- 1) 25' W TRENCH ROAD
- 2) 100' W ROAD AND TRENCHING

- 4) 1400' W ROAD
- 5) 1550' W CK 2' WIDE
- 6) 2000' W CK^{5'} AND SWAMP

-
- 1) 300' E HEIGHT OF LAND
 - 2) 1000' E 2' CK

- 3) DUE South of 1675' E
APPROX 130'

CLAIMS POST FINAL POST FIRE 40+39

INITIAL FIRE 41[#] DIRECTION TO SECOND POST N. 1500' & LEFT (west)

- 4) 1700' E 4' CK

APPROX 5) 2400' E HEIGHT OF LAND

- 6) INTERSECT 4000' E B L. AT 350' N AND A H I Z O E

LINE 2400 S

- 1) 1700' E Height of LAND
- 8) 1800' E 45' CK.
- 9) 2200' E ROAD
- 10) APPROX 120' SE OF 2200' E
on LINE 2415

15 CLAIMS POST.

KAZA COPPER.

INITIAL CLAIMS

"MAG 13 + 14" = NW - 1500 to Right
13 = NW 1500 to LEFT.

FINAL CLAIM = "LOGAN 11"

FINAL CLAIM "MAG 11 & 12"

- 11) 3700' E Height of land
- 12) 3900' E 4-5' CK.
- 13) 4600' E Height of LAND.
- 14) 4800' E River

2400' N LINE

- 1) 200' W Height of Land
- 2) 300' W ROAD
- 3) 1200' W 4' CK
- 4) 2000' W FINAL FLAG

-
- 1) 3300' E Height of Land
 - 2) 2850' E 3' CK
 - 3) 2675' E Height of Land
 - 4) 23-2400' E Bog
 - 5) 2100' E Height of Land
 - 6) 800-1000' E Bog 2' CK
 - 7) INTERSECT B. Line
4125' FROM 4000' E BC
30' N on O BL FROM 2400' N

LINE 2800 S

- 1) 5000' E River
- 2) 4225' E 4-5' CK
- 3) 2700' E Road
- 4) 2150' E 4-5' CK
- 5) 2000' E 4-5' CK
- 6) LINE 2800 S INTERSECTS
WITH BASELINE AT 200' E
+ AT APPROX 2640' FT S.

LINE 1200 W

- 1) 175' W Road Trench
- 2) 800' W Road Trench
850' W Trench

Base line

2000' E OF MAIN BASE LINE
AT FLAG 2200' E. on 2800 S

1) 3175' KAZA RIVER
ALSO CLAIMS POST

3200'

BL. 4000' E

1) 300' N 5' CK.

2) 500' N 2' CK.

3) HEIGHT OF LAND 2000 N.

4) 2400' N LAST FLAG.

2400 N SMALL LAKE

THINGS TO NOTE WHILE SAMPLING

- ① RUSTY ROCKS, SOIL, OR RUSTY SLIME IN CREEKS - (MOST IMPORTANT)
- ② Note any prominent topographic or geographic features, such as:
 - CREEKS, SWAMPS, LAKES
 - VALLEY BOTTOMS OR RIDGE TOPS
 - PROMINENT OUTCROPS OF ROCK (such as might show up on air photo)
- ③ MENTION ANY ORGANIC SAMPLES (DON'T TAKE SAMPLE IF VERY ORGANIC)
- ④ Note any sign of previous exploration activity, such as claim posts, flagged lines, trenches, roads, or other workings.
- ⑤ When taking silt samples, take active, wet silt from as near middle of creek as possible. Don't take bank samples & call them "silt".

3KH15

side of CK.

6000 S. Line

600' W. open Trench Bed.

800' W. FINAL FLAG

900' W. River.

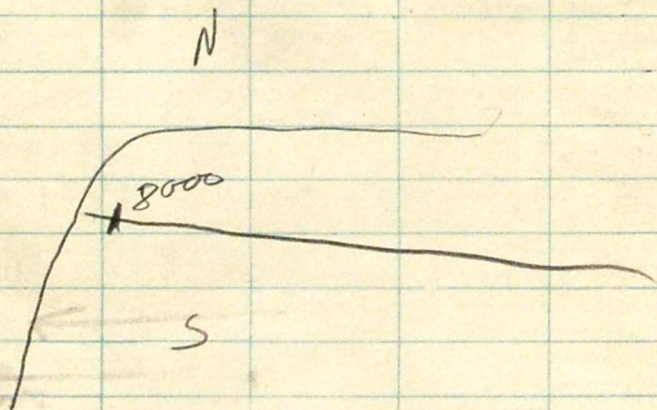

7600 S LINE OF 30' EBL

1) 1100' W

2' CK.

2) 1100' W

radical direction
change. APPROX 20°

3) 1250' W

claim line



#NE - 65W APPROX

200' SW

FINAL POST

LOGAN 1+2

INITIAL LOGAN 3# 1500 to LEFT

4# " " RIGHT

4) 2600' W

FINAL FLAG

5) 1800' W

1800' 6700' River

6800.

6800 S

CLAIM ~~LINE~~ CROSSES
AT 250' W.

INTERSECTS 50' short of BL.
AND 70' N of BL.

2) 450' W

CLAIMS POST 80'S.

FINAL MAG 9+10

INITIAL LOGAN 7 - LEFT

LOGAN 2 RIGHT

2400'S BL. a 5200'S

1) 400' W. SWAMP
MARCH

2) 1000'E 5200'S on
2000'E BL.
= ROAD.

3) 1200'E LAST
FLAG

4) 1300'E RIVER.

44 S LINE

1800'E RIVER
950'E ROAD

HIT 2000 E BL.

AT. 0'E - 20' N

OF 1600 S LINE

600' W LINE
ENDS
MARCH -

3600 S

1000 E

5' CK.

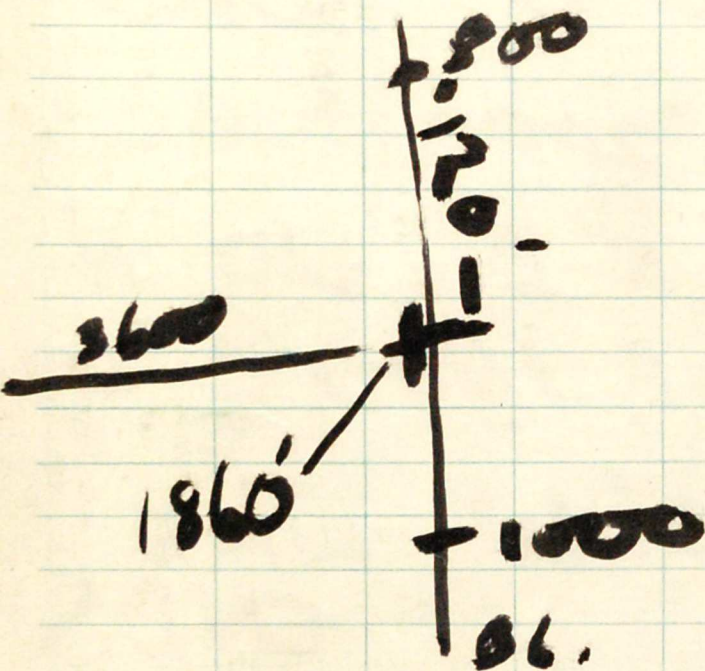

2800' E

H. OF L.

2900' E

ROAD

3900' E

GULLY, CK.

4200 E

LAST FLANK

4400

RIVER

PACIFIC
WATERPROOF

Mining Transit Book

FILLER No. 321

Pierre

KAZA COPPER
GEOCHEM NOTES

1973

THINGS TO NOTE:

- ① POSITION OF CREEKS & SWAMPS
- ② ORGANIC OR RUSTY SAMPLE OR STAIN
- ③ NOTE LOCATION OF SAMPLE IF MORE THAN 50 FT FROM STM
- ④ CLAIM POSTS
- ⑤ SILT SAMPLES - note size OF CREEK.

MAY 18 1973

- 1 00-12W - slightly organic
- 2 00-12W + 00 10W at base of slope - some swamp
3. 40S-80W - slightly organic
- based slope - some swamp.
- 4 at 45-12W - small creek ($\approx 12''$ wide +
6" deep) - flowing S. E towards Lion Creek
- ⑤ at 45-15W - all swamp
- 6 85-12W - some swamp
- 7 85-10W - some swamp.
8. BL-14S - slightly organic
- some swamp
- 9 - 12S-10W - swamp
- 10- 16S-6W - slightly organic

BL @ 1850 - small creek
(2' wide x 4" deep)
- flowing east.

BL @ 3810 - small creek
1' wide x 4" deep
- flowing east into
Lion Creek.

BL @ 3900 - creek
3' wide 5-10" deep
- flowing into Lion Creek.

- Sample at BL 44-S - organic

- south of BL 42-S + BL 44-S -
- swampy

- completed:

{ 4, 8, 12, 16, 20 W
- BL from 00 to 44S

- map of page 45/46

May 19

- at 8005 - 1750 E - creek
≈ 4' X 8" - flowing S

- at 8005 - 1850 E - creek
≈ 2' X 6" - flowing S

at 8005 - 2250 E creek
2'-3' wide - 8"-12" deep
- flowing S.

- 8005 - 2750 E
- all swampy - water
flowing down slope into
creek - No Sample.

at 8005 - 3650 E - creek
- 2'-3' wide X 1'-2' deep
- flowing S.

at 3900 - claim post
- claim name - Burn #3
Burn #3
- North Star
- June 13, 1967

- missed flop at 85 48E+46E

- at 5250E - creek
2' 1' wide x 1' deep
- flowing S.

at 1200S - 5400E
- creek 1' x 1'
- flowing S.

at 125 - 3820E creek
3' x 1' - flowing S

at 125 - 2300E - creek
4' x 1' - flowing S

at 125 - 2050E - creek
4' - 5' x 1' flowing S

- at 125 - 2000E - creek
3' - 4' x 6" - flowing S

at 125 - 1820E - creek
2' x 1' - flowing S

cut 125-1780 E - road.

- today - finished

- 8S → E to 66

BL to 8N

12 → E to 60

8N → W to 20

tomorrow

16 → 54

20 → 52

May 20

at 16S-1850 E

- creek 3' x 1' - flowing S.

at 16S 3750 E - creek 3' x 2' - flows S

- sample at 16S 38E - organic "
- all swampy.

at 165-5210 E

creek 2' x 6" - flowing
into main creek just
5400

at 205 3800 E - out

2' x 2' - flowing S.

at 205 - 30 E

- swampy

- sample organic

at 205 - 2010 E

- creek 1' x 6" flows S

at 205 - 4 E

- sample organic

- area is generally swampy

- today completed:

- 165 → E

205 → E

4N - N

- tomorrow

- 12N

16N

- BL to 16N

- 007E - 14 - swamp

- 47E - 18 -

May 21

- at 16N - 1200W

- swamp \approx 50ft wide.

at 12N - 9W

12N - 10W

} SWAMP

} NO SAMPLE

- at 12N - 1210W - creek

2' \vee 2' - flowing S

- completed

- 12N to W

16N to W

- tomorrow

- 12N

16N

- BL to 16N

- 007E - 14 - swamp

- 47E - 18 -

May 21

- at 16N - 1200W

- swamp \approx 50ft wide.

at 12N - 9W

12N - 10W

} SWAMP

} NO SAMPLE

- at 12N - 1210W - creek

2' x 2' - flowing S

- completed

- 12N to W

16N to W

to do:

S 24E to 48 - {24}
S 28E to 50 (25)

MAY 22

- at 24S 1800 E

crack - 2' x 1"

- flow S.

at 24S - 2E

- SAMPLE ORGANIC

- area generally v. wet

at 28S - 4E

- SAMPLE ORGANIC

at 28S - 6E

NOSAMPLE

- all swamp v. wet

- appears to be a drainage area

at 28S - 900E

very swampy

at 28S - 10E

- SAMPLE ORGANIC

at 285 20E
- creek 2' x 1'
- flowing S.

at 285 - 4210E
creek 3' x 1' - S →

at 245 - 3900E
creek 4' x 1' - S →

at 245 - 3800
SAMPLE ORGANIC

at 245 - 3600
- SAMPLE SLIGHTLY ORGANIC

at 245 - 3400
SAMPLE ORGANIC

at 245 - 3200E
SAMPLE ORGANIC

COMPLETED

- 245 to E

285 to E

36 S from 30E to 42E

Wetaree -

tomorrow:

365 - BL to 30

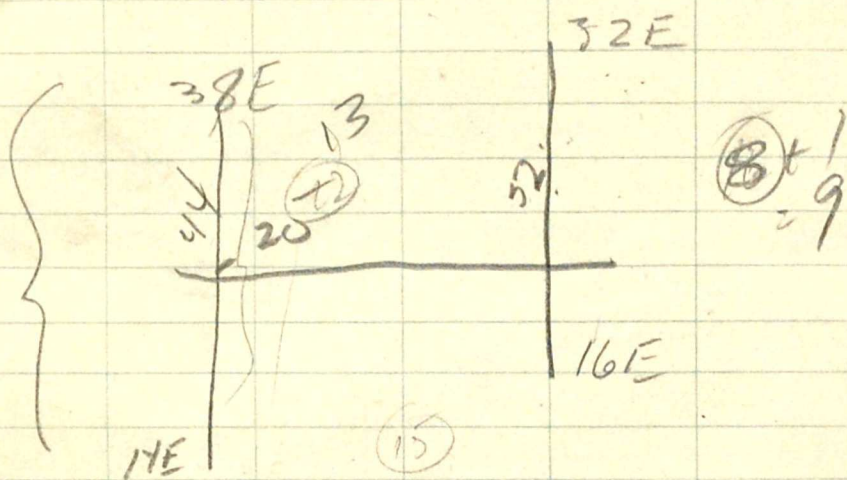

36

MAY 23

- at 365 - 10E
creek 3' x 11' - SW

at 365 - 12E
- NO SAMPLE
- SWAMP

at 365-14E

- SAMPLE ORGANIC

365-16E

NO SAMPLE

- SWAMPY

365-1650E

Creek

- 2' x 6" ~~SW~~ SW

at 445-34E

SAMPLE ORGANIC

525-18E

SAMPLE ORGANIC

525-16E

- NO SAMPLE

- SWAMP

at \approx 485-16E

- claim post

ROAD 4

- TRAIL
AR 166

ANOMIZ

TRAIT

8/6/70

at 445 - 14E

NO SAMPLE

SWAMP

at 445 - 18E

SAMPLE ORGANIC

COMPLETED:

- 36S to E

44S to E

52S to E

(tomorrow)

76S - 4E to 30E

(14)

68S - 12E to 30E

(10)

60S 22E to 30E

(5)

29

MAY 24

-at \approx 775-16E

LOCAN 1 } CLAIM
LOCAN 2 } POSTS

13/8/72

MAY

at 45-38E

SAMPLE SLIGHTLY ORGANIC

-45-40E

"

"

at 00-3850E

crk 2' x 1" S

at 00-1600E

NO SAMPLE

SWAMP

Source forest

4N-28E

-Creek- 3'-4' X 6"-12"

-Flowing S

-NO SAMPLE

-Swampy v. wet

-spruce forest

Completed

4S to E

80 to E

4N to E

8N to E

MAY 26

- 3KM6 - at claim post on lake
CAT#1
R PETERSON
KAZA COPPER
JULY 11/68

SAMPLE 3KM-14
- SLIGHTLY ORGANIC

- stopped at 3KM-38.

TO DATE 446

MAY 27

- Began at 3KM-39

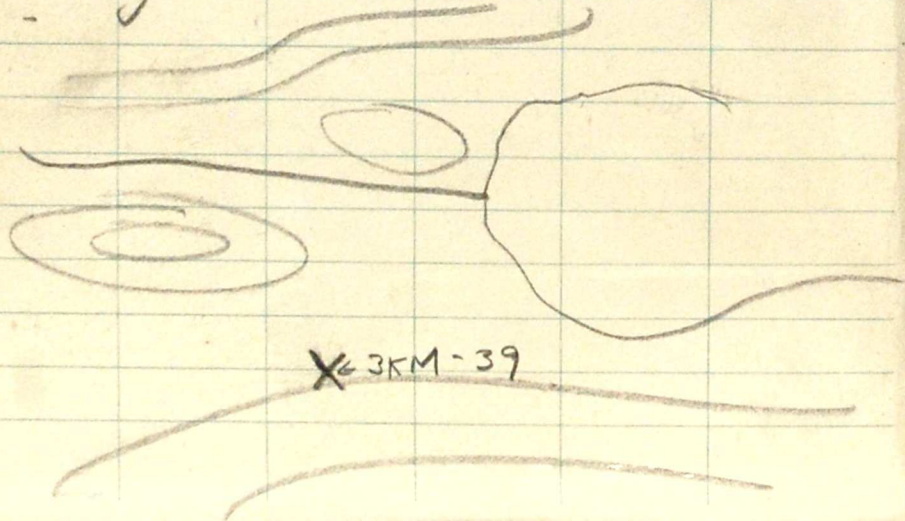

X 3KM-39

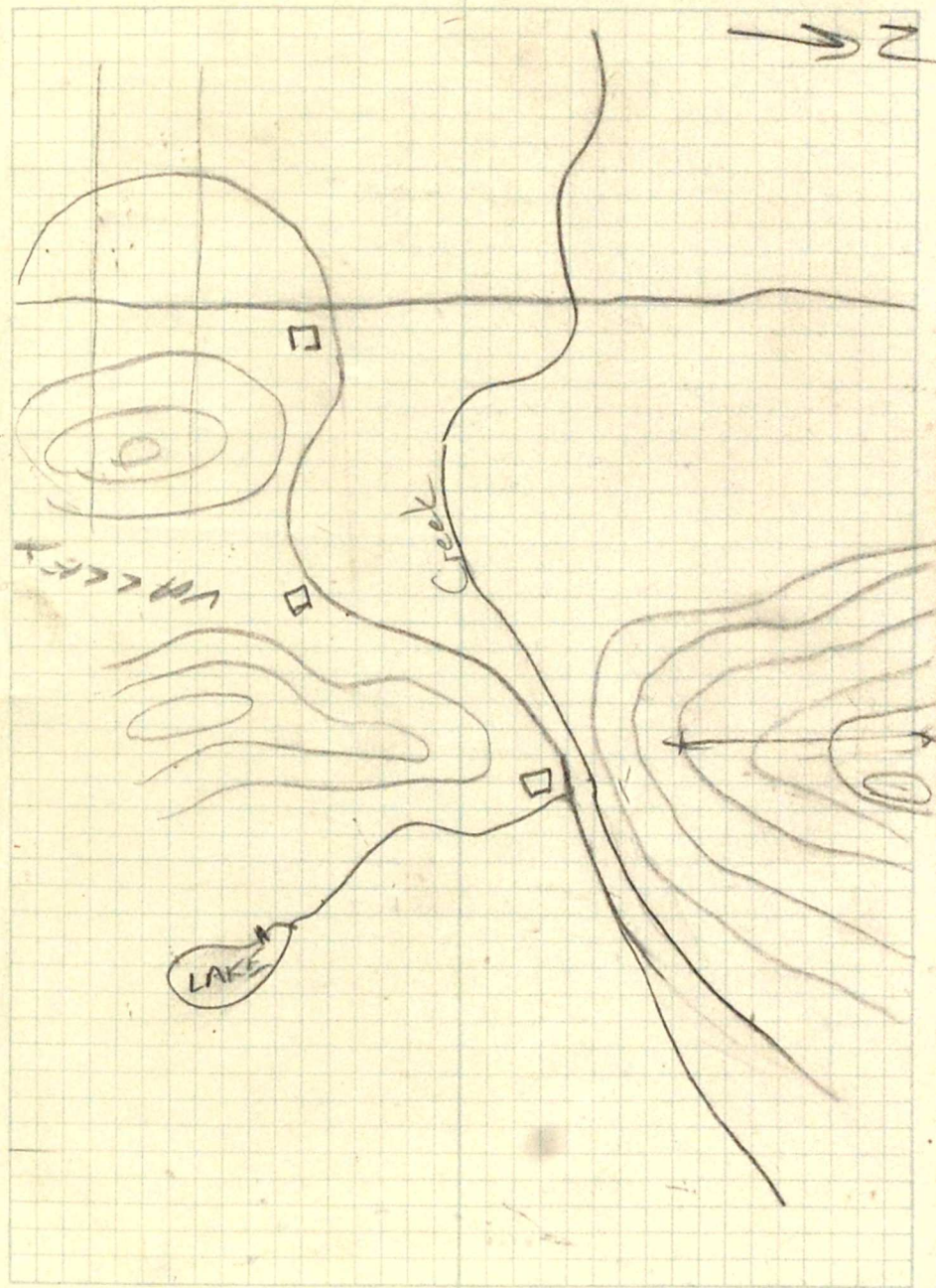

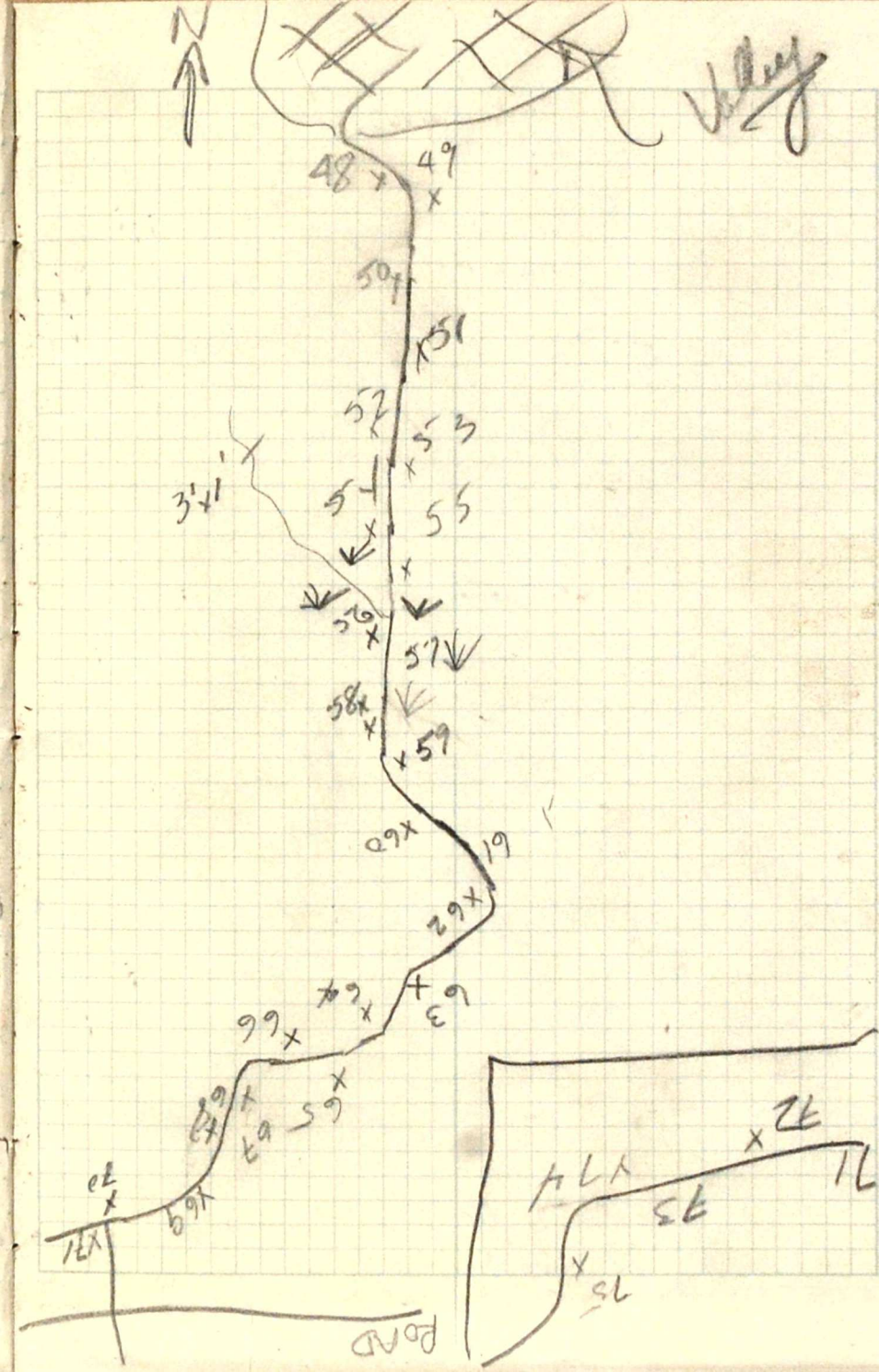
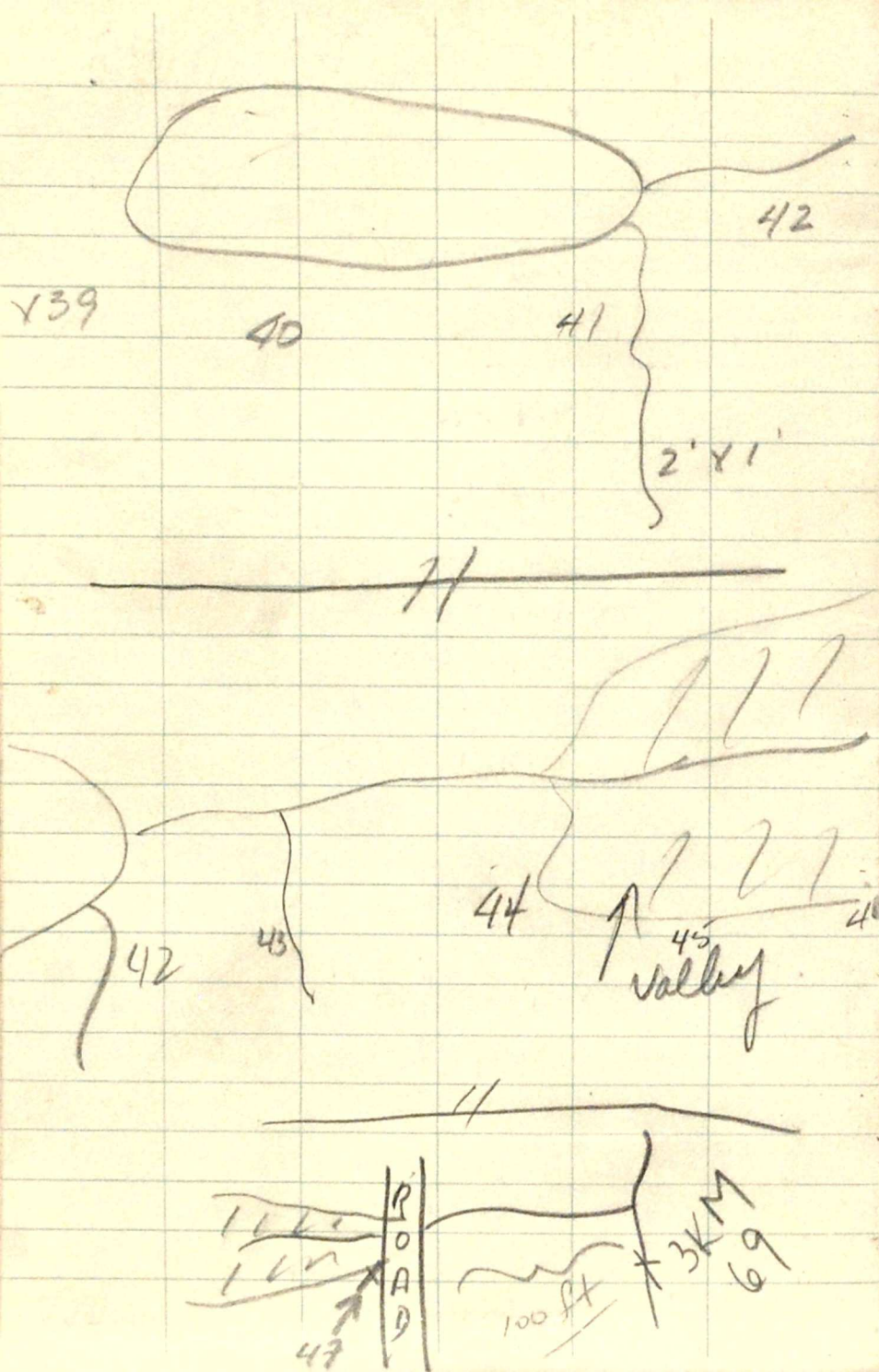

SAMPLE : 3KM 50
ORGANIC

3KM 57
ORGANIC

Completed: 3KM-39 to 3KM-75
- 37 SAMPLES

to date : 446

37
483

MAY 28

at 16N-22E

with 1' x 1'

→ S

16N 22E

SAMPLE ORGANIC

from 16N-28E to 30E

SWAMP

- 16N 30E - NO SAMPLE

- at 16N-34E

SAMPLE - SLIGHTLY

ORGANIC

at 12N-24E
creek 1' x 11'
- → S.

From 12N-14E to 15E
SWAMP

at 24N-2E
SAMPLE SLIGHTLY ORGANIC

- 24N-24E
- SWAMPY
- SAMPLE ORGANIC

COMPLETED

12N to 40E	20
16N to 40E	20
24W to 40E	20
BL - 18, 20, 22, 24	4

64

73

3KM - 76-85 (10)

73

483

556

To DATE

(73)

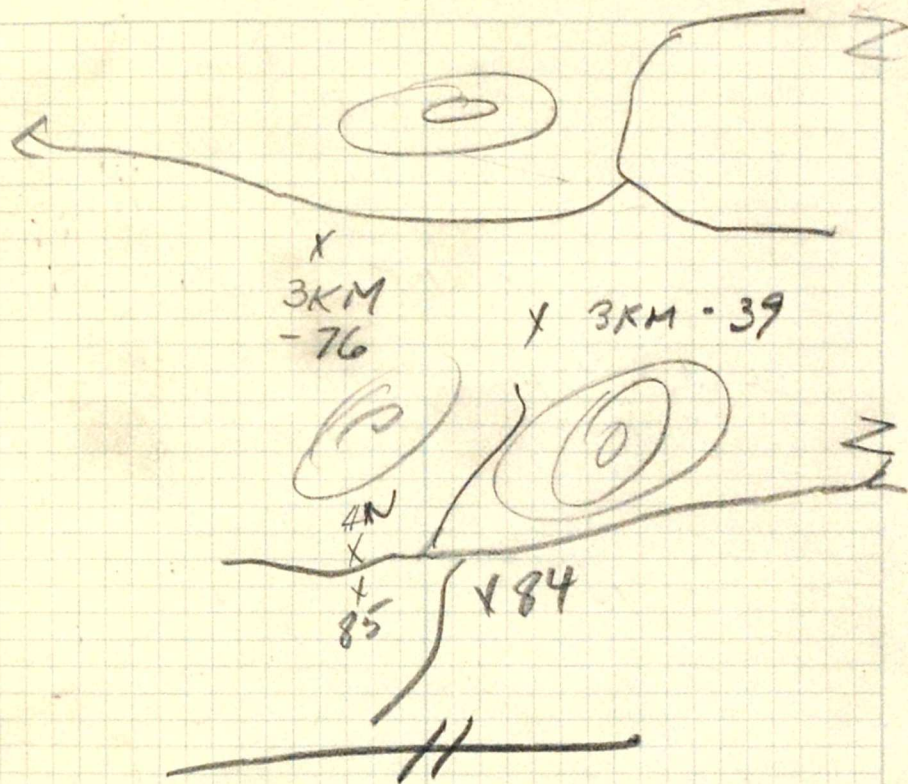

MAY 29

- 1 - 24N - 2W } No SAMPLE
2 24N - 4W } - straddled road
 where I took
 SAMPLE 3KM - 34

- 24N - 10W
 SAMPLE ORGANIC

3 24N - 12W - SWAMP
 NO SAMPLE

32N - 8E - SAMPLE
 ORGANIC

4 32N - 10E } NO SAMPLES
5 32N - 12E } - beside road
 + SAMPLE 3KM 26

6 13L - 26N } NO SAMPLES
7 13L - 28N }

- completed

24 N to W	10
32 N to W	10
32 N to E	15
BL at 32 + 30	<u>2</u>
	37
	<u>7</u>
	30

TO DATE: 556
 30
 586
 586