

019508

PACIFIC
WATERPROOF

Mining Transit Book

FILLER No. 321

~~500~~
300

28 AUG 1973.

Michael Hamilton, SE side RAKLA LK.
Gordon Davis talked to BERT REESE
Pres of BARRIOLZ ROSE

(Ed Muller - CYPRESS ROSE)

106 C / 7 $\frac{1}{2}$ C / 8

3001G = 9.05 ft
3002F = 8.0 ft. all DOLM } LF
3003S = 8.5 }
3004C = RL sub occ 9.05 } RF

{ P1 PAL 30
P1 PAL 29
P2 PAL 28
P2 PAL 27 } July 27/73
M. Evenden

300' above S\$

3005S (7.8) DOLM RUTROCK
9/20

3006S = RL mig hole 8.5 } gent dip
3007S = MAIN RLW 8.5 } DOLM

QOS CK. 106-C-7
- Barrier Reef Shoring
Shoring 1.

Main exp. 200' long. ~2' wide,
knobs up to 5-10 ft. Irregular but
flat lying - corresponding to general
bedding that is NOT discernable ATP.

Rock generally v. porous DOLM.

HZ, SL > GA, & other alt. of Pb-Zn.

QZ-XLS common and main gen
assoc. w QZ LOC calc. cony.

No fossils noted but several
algae-like "structures."

4460 - RAKLA TIME
- 8:30

DON COROTE - CJL-325
If cant call 329 & relay
to DON. to

106 C-21

BLACK CANYON CK.

300 19\$ - at mouth near
Hematite Ch.

300 20\$ = RL trib

300 21\$ = Main Ch.

300 22\$ = Main LL trib

300 23\$ = LL trib

24\$ } JEN

25\$ }

26\$ } JEN Head of ch
27\$ }

GAZSL

@

JEN

106 B 5

106 B 6 - NORANDA

106 B 12

106 C 11 - Black Canyon Ch.
- Pinguicula proximity

106 C 15 - X-section

10 DAYS ~~2~~ 5 MAP SHEETS

CHOPPER COST @ 5 HRS/DAY = 200 X 10 X 5
= \$10,000+

DURATION = 15 DAYS

ASSAY COST: 100 X 2.00 X 10 = \$2,000

SALARY = \$1,000

GRUB = 20 X 15 = \$500

MOB-DEMOb = 1500

TOTAL = \$15,000

PLACEMENT OF GAS.

AT ① PINGUICULA
- 8 DRUMS.

② BONNET PLUMS
- 12 DRUMS

31 AUG 73

VISIT W. G. DAVIS TO
GOS AREA

(1) MAJOR DOZ SHOW

(2) BRECCIA SHOW ON

HARRISON CK. BY + minor SLF
ZEN

1 SEPT 1973

VISIT G. DAVIS TO
NORANDA ECONO GRP &
showed mineralized extensions.
Advised against staking.

Chopper Hopped in morning.

3GG

MAP NO.

2 SEPT. 1973

Corn Ck. Area in Am. 106C/II

3GA 235\$ to 245L

3GA 240 \$' ATP Just below 50'
cut canyon

Well Rounded & spherical Boulder
CONG 30' thick - Dolm
above and below?

ATP g. 121

168

CONG - rusty stained - boulders
& cobbles mainly QZIT
Loc. CONG very rusty
& UNC above

3GA 241 \$ - sample of mainly
matrix of CONG where yellow
effl. CHECK FOR U (NONE)
of

Q241 & Q240 checks
for Au?

Check records for
Au in CORN CK.

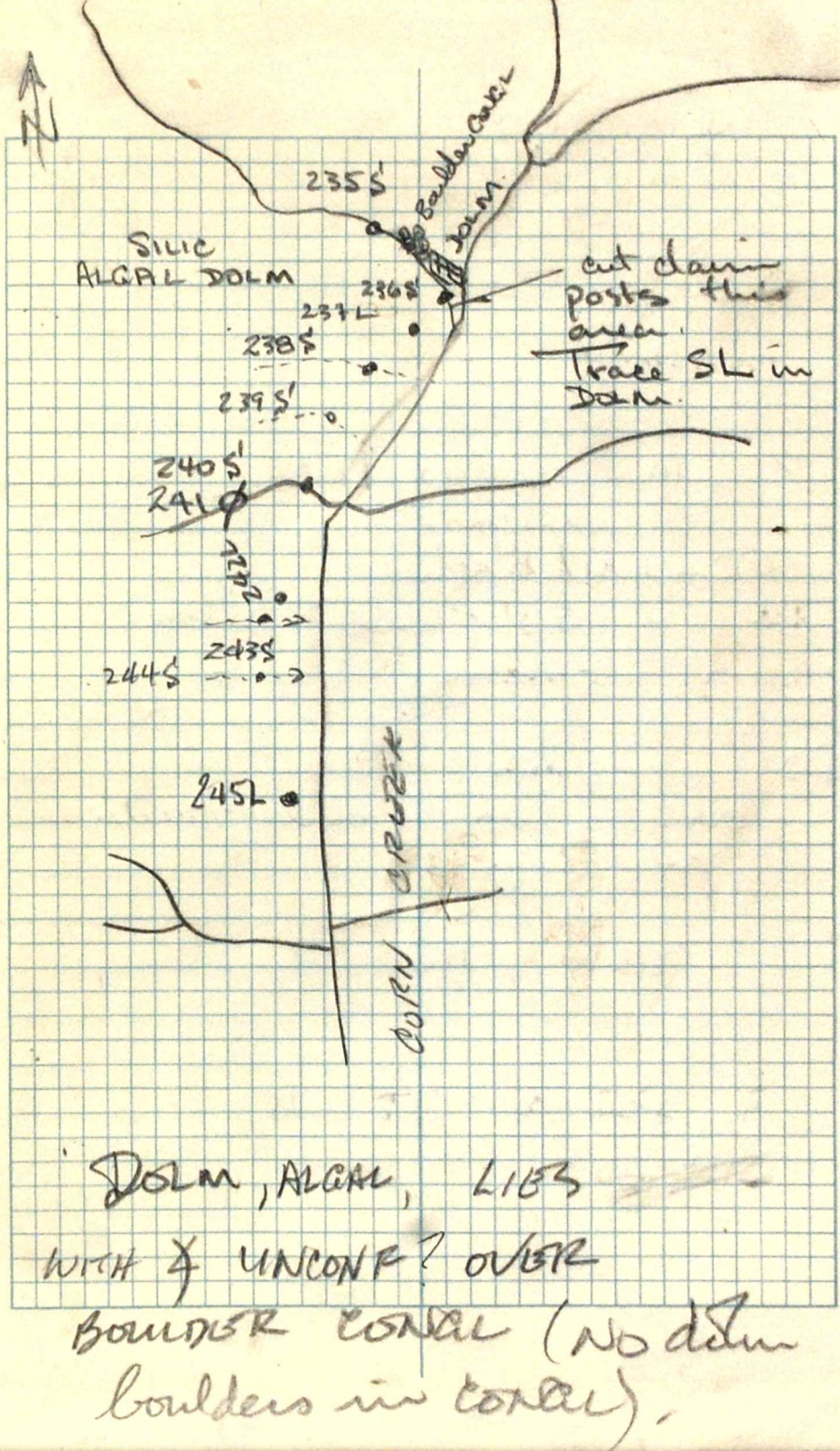

DOLM, ALGAL, LIBS
WITH & UNCONF? OVER

BOULDER CONG (No dam
boulders in CONG).

APT. 2 SEPT 73

PINAWICULA OK TRAN
106 C/14

3CC 246S to 260S

3CC 248S FLT pyritized
DAM BRXX Neg ZEN
Minor Cos FLT

Δ1 RBSH shale & siltstone (40%)
g. 59 117

Δ2 Grey DAM with bl. chert
bands and oval structures
ex. 44 81

Overlain by blocky orange
weathered DAM

Δ3 DAM + sub

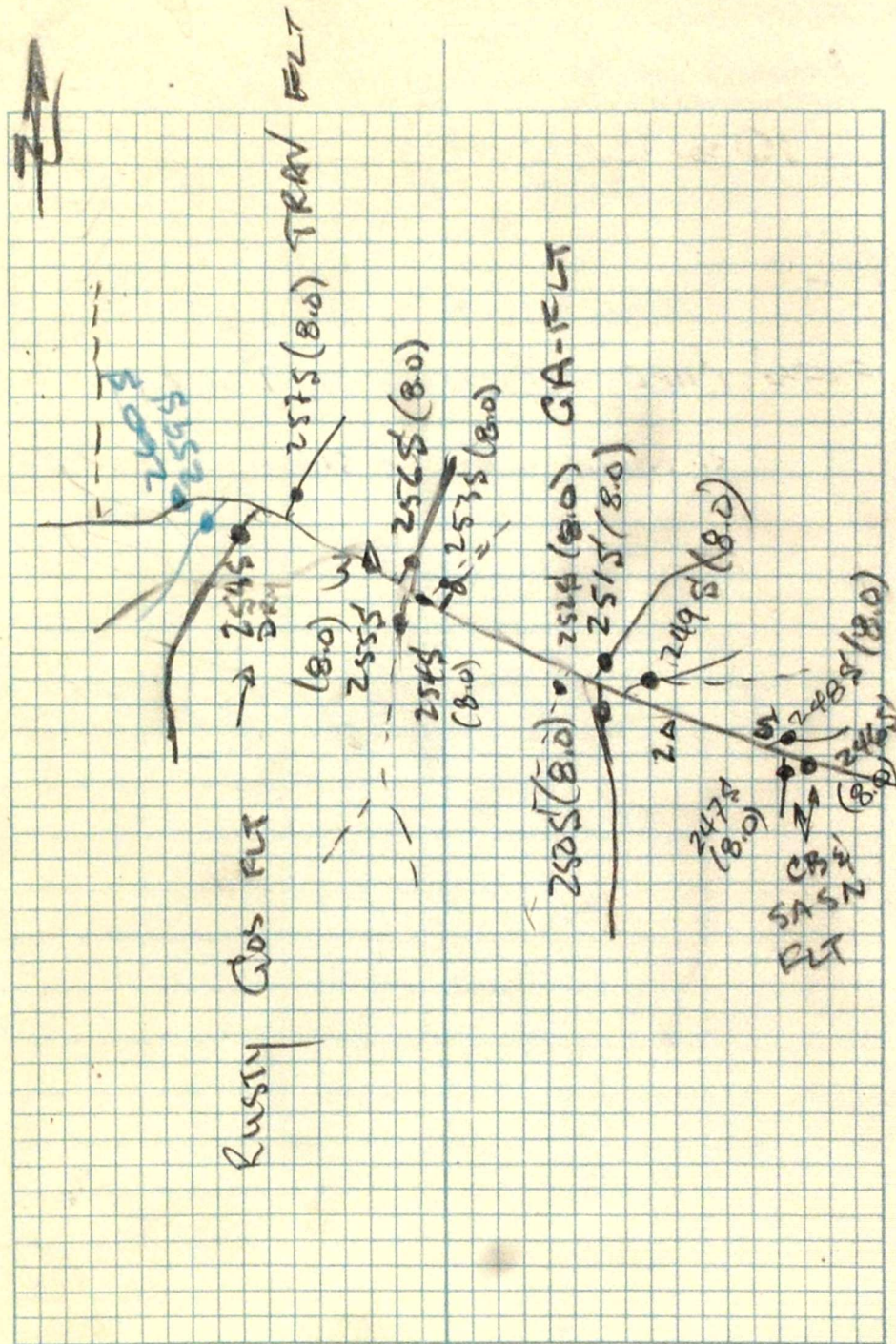

SUMMARY

SECTION

- ? ORANGE WEATH DOLM
≤ 1000' CHERTY, LIGHT GRAY, DOLM
? SILTSTONE - BLACK SHAL = BOT. OF CK
LOCAL

Note: CA - flat @ 2525.