

019511

PACIFIC
WATERPROOF

Mining Transit Book

FILLER No. 321

FYRE LAKE PROJECT

P. DEAN

JUNE 1973

5 June:

- general reconnaissance of area with Paul. Brian started grid, Peter started sampling.

- rock types in area include graphitic phyllite, qtz schists (Ptz?), volcanics.

6 June:

3D-100 - qtz phyllite ¹⁴² 44E

3FD-1R - qtz phyllite, rusty & with minor sweated out qtz veins. Slightly graphitic.

~~- map locations of these steps probably not accurate (LOCATED ON AT CAMP)~~

3FD-2S - seepage in bog minor FeOH
PH 6.5

3FD-3S - PH 7 seep

3FD-4S - PH 7 stream 3 FT X 6"
minor rust in glauc.

3FD-5SG - PH 6.5 abundant FeOH
seepage

poor, highly organic sample

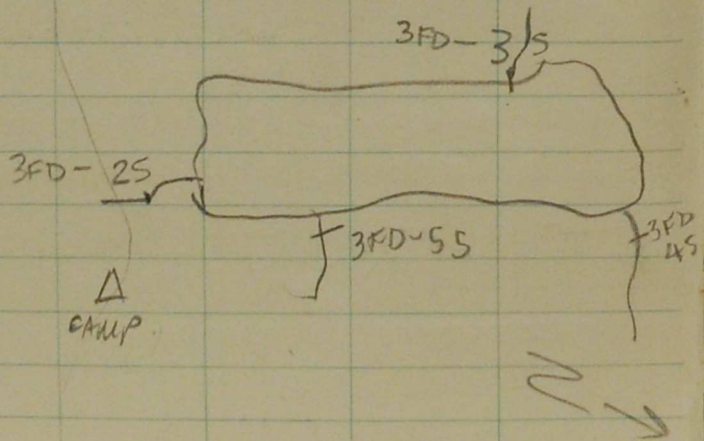

June

7 May

QTZ CHLOR SCH 90% Qtz

~~E~~ ~~120~~
-60E

D-102 - QTZ-CHLOR SCH Sabotep.

D-103 - massive light to dark green,
patchy amphibolite occ. grains
of pyrite & some small Qtz
~~grains veins~~

~~120~~
-60E

500 FT NE of last - chlor sch w
6" congl Qtz veins N42 E

- massive lg lite gn volc w recognizable
pillow structures on weathered outcrops

- chlorite schist with abundant ep forming
Syncline, possibly overturned to north.

~~and~~ plunges at 10° to 126° (SE)

D-105 - QTZITE AT L8N 36E,
massive, pure, ~~some~~ many full Qtz
veins

3FD-6 RG - rock chip sample of
luggy, very rusty Qtzite
float from ~~200~~ 200FT N of
QTZITE OTEP AT 36E ON L16N

11 May:

3FD-7 L - blue-grey clay soil
valley, 6th st S of #2 camp

3FD-8 L - brn silty soil

3FD-9 S - pH 6.25 3FT X 1FT

3FD-10 S - pH 6.25 - SOFT
dustm from BL

minor transported gossan
chunks.
where BL D crosses pk (N4N).

3FD-11 R - graphitic phyllite
with rusty cavities

Qtz bands lying along F₁ folds
make up about 10% of pk

S₂ - 140° x 36° NE

3FD-12 R - same place:
more Qtzite, may contain ga

3FD-13S - L800N, 600E

pH 5.75 beginning of
main gossan deposit.

3FD-14LG - Sample of leached
gossan - 200 FT upstn from
last. Photo

3FD-15L - pH 6.0 top of
main gossan area - 800 FT
upstream from 3FD-14LG.

3FD-16R - highly graphitic phyllite
from in place step in creek bottom.
Most of step is g with angular
chunks of phyllite & occ. rounded
cobbles of granite & qtz. Old
talus slope or river channel
material. Whitish deposit coats
underside of overhangs.
Rx in place form highly by
nose of fold with axis at
142°, dipping 10° to SE and
overturned to the E:

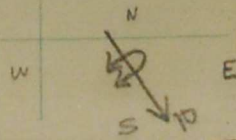

3FD-17R - S2-135/44E

qtzose & graph phyllite
yellow deposit on weathered
fracture surfaces
at L24N-10E, & 150 FT
upstream from 3FD-16R step

500 FT upstn - another step of phyllite
bx at 3FD-16R. Rough
horizontal layering
pH in creek at this
point is 6.0 No silt to
be had, all organic.

L40N-18E - pH 6.0 1 FT x 6" ck

L56N-10?E - pH 5.5 3 FT x 6"
(other drainage)

L64N-14E - 200 FT dn stn - pH 6.0

L88N-14E - pH 6.5 2 1/2 FT x 6"

3FD-18R - float of rusty, lim.
qtzose phyllite in frost heave
200 S of 800E or L96N

3FD-19R - L80N-3E-20 FT N -
step of qtzite, lim. stained

Camp Ck - at BL - pH 5.25
at drainage from small wet bog

Camp Ck - 1000 FT W - pH 5.25

Camp Ck 1500 FT W of BL, 1000 FT?
E of camp meadow
Sample 3FD-20 S pH 6

- L 24 N - 14 E - 100 N

graph phyll

S₂ - 122 / 36 E

isoclinal folding - imp. to determine
attitudes of fold axis (talus)

- 500 FT east of sm pond at east
end of L 0

F_{axis} 106 / dipping 22° to east

thoroughly contorted quartzite
in nose of fold. Abundant
chlorite and finely diss. py throughout
D-106

- D 107 - variscite? From L 0, 15 E.

3FD-20 R G - 75 FT N of
20 W on L 40 N
very rusty rk

14 June: Traverse #40 -

notes attached to photo overlays -
rock samples for geochem -
3FD-21 R to 3FD-30 R
spec D-120 to 123

15 June:

Checked Pauls mineralization
from yesterday traverse (#43).

076 R - assay for Pb Zn Au Ag.
(Elden)

3FD-31 R - Au

3FD-32 R - ~~■~~ Cu Pb Zn

Afternoon - took Paul to reccy
Camp 2, then went to Frye to
reccy ice & camps, thence to

Traverse # 46 where we took
check silt samples and looked
at rocks (trübsch & Spr
augen guess). Thence to
Traverse # 39, where we
only had time for a brief
look. Took rock sample
D-124 (serp) and D125
(qtz carb alt'n w. mag, magnetit,
& chromite?)

- geochem sample ZFD-33R
to be run for Ni Cr Pt.
(= sample D125)

PACIFIC
WATERPROOF

Mining Transit Book

FILLER No. 321

FYRE LAKE PROJECT
PAUL SIHOTA
JUNE 1973

June 6/73

3FS-1-G - gossan sample from small o.c. of protogine schist (?) w/ leached pyrite cubes. gtz.

S-2 →

200' NE of creek between ridges - green schist.
top of N ridge - graphitic phyllite w/ occasional gtz veins

June 7/73

frost heaves & side hills around gulleys indicate graphitic phyllite

S-3 → suboutcrop of altered f.g. volcanics

S-4 → suboutcrop of f.g. green volc. w/ some pyrite
100' NE of 2nd gully

BL-104 in gully bottom ~300' from NE end.

S-5 → small outcrop of graphitic phyllite w/ evidence of mineralization

S-6 → low grade green schist w/ pyrite

S-7 → ?? pyrite, gtz & chlorite (??)

S-8 → gray phyllite

scattered & chopped up outcrop on S side of valley bottom S-6 seems to be most common

S-9 → ?? small calcite crystals, occasional pyrite, chlorite

S-10 → ?? calcite & chlorite

top ridge of N-S hill - near top; due S of closest tk.

3FS-2-G - soil sample

S-11 - v top of ridge ~200' past above - malachite stain?

3FS-3-G - soil sample

S-12 → f.g. vol. w/ pyrite, & gtz - near top 2nd ridge

S-13 → chlorite schist w/ pyrite top of 2nd ridge
100' from **S-12**

S-14 → Graphitic phyllite nose of 1st ridge
500' N 3FM-121

June 10/73

Line 46N no outcrop from BL → W

LINE 40N
150' W sub outcrop: graphitic phyllite

300' E sub outcrop of meta. volcanics **S-15**

400' E " " of volcanics **S-16**

LINE 32N
6 E sub outcrop of volcanics **S-16** w/ pyrite

7-8 E frost heaves of graphitic phyllite

41 E **S-17** → schist w/ gtz

S-18 → quartzite

41.5 E **S-19** → volcanics suboutcrop - float(?)

44 E **S-20** → massive meta. volcanics.

200' N of 16N-39E **S-21** → graphite phyllite w/ gtz & weathered mineralization

200' N of 16N-39SE **S-22** → quartzite schist. overlying S-21

100' N of 16N-34E **S-23 & 26** → quartzite w/ quartz veins & leached mineralization.

24N-32E **S-24** → phyllite

300' N of 24N-18E **S-25** → "rusty" graphitic phyllite

S-26 → graphitic phyllite = noses of ridges
w/ lines 24 & 16 from 18E-14E 20W
22E 18E 4N

24N-11E conglomerate to S, phyllite to N

300' N of 24N-14E **S-11**

60-0E → 160-6E - graphitic phyllite

BL 5N - G. Ph.

LINE ON 16E - G. Ph w/ gtz. } min of G. Ph.
LINE 8N

LINE 40N
2W - G. Ph.

7W - " "

10W - " "

June 11/73

S-27 - gtz w/ sericite & "rusty" spots ≈ 700' W on 27N

S-28 - g. phyl. w/ rusty spots ≈ 400 SE of **S-27**

S-29 - gtz rich g. phyl scattered in talus 200' E of above & becoming more abundant to S no visible o.c. cleavage not as well defined as **S-28** or **S-30**

S-30 - pyrite rich g. phyl - near S end of ridge just above tree line
338/40° E 500' N 16N-3W ①

BL 11N - similar to above.
≈ 310/56° E ②

S-31 → g. phyl w/ gtz & rust - BL 8N **3FS-4-R**

200' W of 4N o.c. similar to above

S-32 - quartzite w/ pyrite BL 11N gtz veins also

LINE 10N

S-15 & **S-14** - floats

S-33 → gtz & sericite schist w/ leached pyrite
≈ 058/51N - 150' S of 40N-34E

40E - suboutcrop - greenstone w/ pyrite **S-34**

LINE 4N

24E - frost heaves → sericite schist

22E - " → g. phyl

June 12/73

LINE 56 - no o.c.

600' N of 56N-40E [S-35] → chlorite schist w/ quartz & pyrite

700' N of 56N-40E [S-36] chlorite schist 320/58E

LINE 64N - above scattered to 39E

LINE 72N - no o.c.

LINE 80N - 2E Peters sample

LINE 85N - no o.c.

LINE 96N

8E: frost heaves indicate g. phyll.

LINE 112N 14E → 20E: frost heaves indicate g. phyll.

LINE 120N

1E [S-37] g. phyll w/ leached pyrite: 008/28E

LINE 64N - west side no o.c.

June 13/73

≈ 102N-4W g. phyll @ 112/45°N [S-38]

E from 3FH-21 ≈ 100'

[S-39] → g. phyll w/ qtz & "rust"

June 14/73

fold axis 169/18 SW

Traverse # 43

conjunction of two creeks [S-40] - black phyllite w/ abundant pyrite

main creek ph = 7.5 also other creek.

just at mouth of 2nd creek: (in place) [S-41] g. phyllite w/ rust. 137/74° SW

Float on main creek

- [S-40] - blk sl. st. w/ abundant pyrite
- [S-42] - carbonate w/ pyrite & soft metallic min.
- [S-43] - limestone w/ mineralization - folded.
- [S-44] - granodiorite w/ some mineralization

pisser on right - ph = 7.5 ≈ 300' up stream from con.

[S-45] - quartzite w/ mineralization

in place: phyllite w/ qtz veins foliation: 330/28 SW

[S-46] [S-47] w/ pyrite.

pisser on right ph = 7.5

in place: phyllite w/ qtz & pyrite ≈ 339/46° SW

[S-48]

in place: similar to above 310/31° SW

500' up stream [S-49] & [S-50] similar 310/30 SW except w/ amphibole (?)

400' upstream [S-51] interbed of ls & phyllite w/ underlying phyllite

[S-52] b. w/ rust' 300/33 SW @ 3FH-29 L

[S-53] ls w/ pyrite @ 3FH-20 L

S-54 316/24° SW phyllite w/ pyrite
100' past JF11-20-L

S-55 gorge creek (right) ph=7 JF11-16L

S-60 - phyllite @ end of creek canyon

* Traverse #42 *

3FS-5-S ph=7.5 1500' from confluence

3FS-6-S ph=7.5 300' " "

9W322 at confluence of large + bottom

S-56 150' W side stream greenstone w/ pyrite

S-57 at anomalous creek @ 280/39° W
g. phyll w/ rust.

3FS-7-L

+200' W L side creek 3FS-8-L ± S-58

+200' W R side creek 3FS-9-L

+200' W L side creek 3FS-10-L

June 15

3FS-11-S

3FS-12-S ph=7.

S-58 biotite gts gneiss

3FS-13-S

S-59 118/28° E

June 16/73

S-60

232/64° N ^{merposite (?)}
quartzite w/ fuchsite, feldspar
+ rust

S-61 - phyllite w/ rust 238/40° SE

S-62 - chlorite - sericite - gts schist (?) w/ pyrite

S-63 - green schist w/ pyrite

S-64 - serpentine w/ magnetite - talus

S-65 - in place

S-66 - serpentine - talus

S-67 - serpentine in place

S-68 - diorite

S-69 - macro crystalline diorite

3FS-14-R

S-70 - biotite gneiss

3FS-15-R

S-71 ± S-72 at ridge height

3FS-16-R

3FS-17-R - on knob S side S-73

Fault (in streambeds) 058/85° S S-74

3FS-18-R

S-75 top first ridge

3FS-19-R

200' N
landing
place

June 17/70

S-76 - g. ph w/ 'rust' fold axis: 045/17° SW

S-77 - antigorite w/ pyrite - bottom gorge

S-78 - gtzite w/ mariposite? - above dirt rock

S-79 - antigorite 200' SW of landing spot

S-80 } antig. 100' W of landing spot

S-81 }

S-82 Smearred antig. ~ 300' W of ridge

S-83 - gtzite w/ mariposite & pyrite surrounds
by rocks similar to S-82

S-84 fig. biotite schist (?) w/ pyrite

3FS-20-R

3FS-21-R

100' NW 3FS-19-R

3FS-22-R

200' NW "

S-85 - over crest W. hill

S-86 - sericite schist w/ 'rust' 100' W S-85

3FS-23-L

200' W S end ridge, 500' N dike

S-87

biotite schist w/ gtz & pyrite 130/14° S

3FS-24-L

SW tip of small valley w/ S-88

S-89

- g. ph. head of valley

June 18 - move camp ** photo A-12343-33 **

June 19

[S-90] sericite gtz schist - suboutcrop - along E ridge
outcrop of above @ 040/25° E
700' along & down ridge @ 018/10° E outcrop of above

[S-91] outcrop @ 333/10° E gtz sericite schist w/ limonite

[S-92] - gtz w/ galena(?) in talus
outcrop of [S-91] at al @ 0°0/15° S : NW side
of crotch.

[S-93] - gtz sericite schist w/ manginite(?) & limonite
@ 090/15° S

[S-94] - sericite schist 130/25° S (?)
tension gashes elongate 080/20° W (?)

[S-95] - chlorite schist - suboutcrop W side of knob

[S-96] - banded biotite gtz schist - outcrop 128/14° W

June 20

[S-97] - graphitic phyllite w/ pyrite & gtz & sericite
@ 032/20° S

[S-98] 400' WNW same altitude
gtz sericite schist (interbedded?)

[S-99] gtz sericite (??) w/ pyrite &
sphalerite (?)
gtz - sericite schist w/ gtz veins 107/35° S

[S-100] gtz - sericite schist 122/05° S

[S-101] - gtz biotite (?) schist.

[S-102] - gtz mica schist w/ mineralization 172/05° SW

[S-103] - sericite schist w/ mineralization

[S-104] - gtz sericite schist w/ min. 060/10° S

[S-105] - gtz - mica schist w/ min 165/10° E
280/14° S

[S-106] gtz - graphite schist

[S-107] - gtz biotite schist overlying [S-108] chlorite
schist. 014/34° E

[S-109] banded gtsite schist (??) 076/18° S
below [S-109] biotite schist.

050/12° S similar to [S-109]

050/10° S mica schist

025/17° S chlorite schist
ph = 6.5 - small stream E side cirque

026/14° S biotite gtz schist

chlorite schist overlain by ser. gtz sch. 158/26° E

next outcrop to W. : [S-110] - mica gtz schist
overlain w/ chlorite schist [S-111]
135/28° N

ph = 6.5 passes on W side cirque

[S-112] by passer - dull black matrix w/ gtz & limonite
150/16° N

NW side of outcrop **S-113** - gtz sericite schist
136/18° N

S-114 graphitic gtzite (???) w/ limestone

200' above **SFS-25-G**

top of ridge - sericite schist

sericite schist (above valley) 152/26° N

creek out of valley pH = 6

valley wall - sericite & mica schist 160/6° N

June 21/73

S-115 chlorite schist w/ gtz & pyrite above camp
≈ 160/16° E

S-116 above **S-115** - gtzite w/ pyrite ≈ 137/38° E
ON-26 E - small pond

S-117 gtz rich g. phyllite w/ pyrite 108/50° N
100' E of BL50E - 4N

pisser @ BL50E-28W pH = 6.5
draining E

1 yr old flag. (?) - near BL-50-54N no markings

creek @ BL50-74N pH = 6.5

S-118 - g. phyllite w/ 'rust' 080/10° S
@ BL50-104N creek - pH = 6.5

S-119 - rusty gtz mica schist (?) 185/10° W
@ BL-50-104N creek pH = 6.5

S-120 - banded gtzite w/ sericite pyrite 056/29° S
@ 112N-18E

creek @ 26 S of 112N-20E pH = 6.5

pisser @ 62 S of 112N-20E pH = 6.5

June 22/73

S-121 gtz-sericite schist w/ pyrite 018/26° E

S-122 gtz mica schist 044/26° E

S-123 graphitic-sericite gtz schist (??) above **S-122**
inter bedded

S-124 3rd graphitic phyllite w/ 'rust' 150/24° E
(small) 3/4 way at bottom

S-125 gtzite w/ pyrite - overlying **S-124**
SFS-29-E

4th sericite schist (knob N of 114) 016/29° E

(5th) interbed of sericite & g mica schists 010/29° E
- top section

S-126 sericite gtz schist (above **S-125**) ≈ 360/16° E

above (5th) - top gtz mica schist 017/12° E

next top knob N 360/06° E

last good top knob N. 140/19° E

200' @ 20° from bluff small a.c. of sericite schist
360/32° E (??)

mica schist 173/29° E
@ BL0-50N 7 200' W

sericite schist @ BL0-76N

S-127 300' N ↑ talus of gtz-sericite schist
or (??) in snowfield

sericite schist @ BLO-91N 152/63° E 1

" " @ BLO 84N 08/30° W 1

S-128 gtz schist w/ mica & limonite 73/31° W 1
400' SW of BLO 88N

continues N side gorge

200' SW BL @ 92N sericite schist 119/44° N
w/ gtz // to foliation

@ bottom snowfield gtz & mica schists ≈ 40°/30° E

mica gtz schist 160/26° E
100' W of BLO-108N

4-9 W on 112 sericite schist 180/20° E

S-129 banded gtzite w/ mica 11 W on 112

S-130 - granite (suboutcrop??) w side hill

S-131 chlorite schist 200' SSE of ↑
100' above 1131 - mica schist ≈ 030/25° E
spotty outcrops of mica schists.

Sericite schist across from 890 010/18° E

S-132 suboutcrop of graphite(?) mica gtz schist 200' S ↑

S-133 biotite gtz schist (?) w/ mineralization 173/23° E
100' S o.c. sericite schist.

300' SE of 1133 chlorite schist

edge of ridge - gtz mica schist

top NW edge of ridge - ser gtz schist

rust leaves indicate chlorite schist
trending @ 45° across top of hill

suboutcrops, frost heaves etc. indicate gtz sericite
schist along middle of S side hill

S-134 → mica gtz schist w/ limonite 360/35° E
interbedded w/ sericite schist
creek ph = 5.5 ↑
boudinage structure w/ gtz

100' downstream from 1139 053/34° S

last outcrop of top 70/27° S
(sericite schists)

Camp creek: ph = 6.5

June 23/73

S-135 - gtzite schist (banded) 120/20° E
E wall main valley near outlet

100' below 1155 - main o.c.: gtz sericite schist 015/31° E
creek ph = 7.5

S side of brush linear: mica-gtz schist w/ boudinage 055/13° E

N side same rock but: 050/10° W

interbedding of sericite-gtz & g. biotite-gtz(?) schists w/ gtz lenses & 'rust'

100' from valley wall & N side	110/15° S
100' " " " & S side	085/17° S
50' " " " & S side	100/13° S

175' W of brush linear: 'rusty' gtzite w/ mariposite S-136

S-137 50' N of 1136 gtzite w/ mariposite & mineralization
pyrite & sphalerite (?)

13FS-26-9 20° E of 1137 : 16S-31W

area of above type ≈ 200' R.
N - sericite schist.

sericite schist (E side) 145/14° W
faulting (?) (W side) 150/12° W

S-138 - schisty gbsite w/ sericite & 'rust' - suboutcrop
together w/ gtz sericite schist w/ v. well developed
platy cleavage

outcrop similar to S-138 115/13° N

S-139 gtz sericite schist on E wall @ 50' from pool in
cirque - 1/2 way up - 146/28° SE

300' N of S-139 - same rock - 155/29° E

100' W of (same) 160/30° E

" " " 200/29° E

mica-gtz schist 200' E of saddle pt. 150/13° NE

near top of hill (schist) 140/29° WE

v. temp frost heaves indicate gtzite

banded gbsite (depression) 230/26° S

along lineation running @ 70° across top of hill
across at brow of hill (facing E) 130/20° S

S-140 'rusty' gbsite @ v. top of main cirque
mica-gtz schist to W.

sericite gtz schist 100' W of edge 120/18° N
of highest pt.

S-141 - 3 phyllite - suboutcrop along w top

N side (top) of cirque schist gtz schist (same as)

mica gtz schist 040/12° SE

w of ravine. rubble alternates between
v. gtz & gtz-mica schist further W.
S-142 gtz-biotite schist 080/13° SE
N side ravine

S-143 - biotite schist E side ravine 060/23° SE
above S-142 (top of ravine) gtz-biotite schist
above S end ravine gtz sericite schist

sericite schist along hill S of ravine 100/15° SW

June 24/73

above camp (S) gtz-mica schist 040/25° SE
w/ gtz lenses.

chlorite schist w/ gtz lenses 120/24° NE
gtz contains some magnetite

S-144 above ↑ - 'rusty' gbsite w/ mariposite & minor magnetite

S-145 same as 144 but w/ pyrite not magnetite. some place

chlorite schist near S end o.c. 040/22° SE
fold axis (?) plunging E @ 25° (?)

Disser on E side flowing SW ph=7.5

S-146 weathered - ? - w/ gtz

S-147 - gtzite w/ chlorite

S-148 - ?? gtz & chlorite (?) w/ minor pyr.ite
major fractures running 355°

S-149 - rhyolite (?) w/ pyrite next to S-145 on line 165
6E → 3E

S-150 - ?? w/ pyrite & phalinite (?) 840-165 165
soft, cleaved, not calcite

creek @ 840-34S ph=7.5

SFS-28-E

CV

S-151 - gtsite schist w/ biotite & pyrite
top of hill between E part of L485 & L725.

S-152 - rusty gtsite w/ mariposite & minor calcite
creek ph = 7.5

creek below S-153 ph = 7.5

S-153 similar to S-152 w/ dolomite (?)

S-154 - g. phyl w/ rust' just s of S-153

sericite schist 080/27°S

S-155 - ? - interbedded w/ S-153 070/43°N
25' N of ser. schist

June 25/73

1493R - flagging @ 190-165

3FS-27-R

S-156 - gtsite w/ pyrite 200' N of 325-6E

S-157 - gtsite (?) w/ pyrite 300' S of 325-6E
290/22SE

S-158 - gtsite Top E valley wall 400' N 445-12E

S-159 - gtsite w/ lineations trending 040/00 485-19E

@ 485-22E similar to S-159 but w/ gtz veins 53/13°SW
& minor pyrite

S-160 - f.g. black metamorphosed sediment (?) graphitic (?)
w/ gtz veinlets sub o.c. contacting above to N

@ 485-26E fold axis 55/11°SW
outcrop trending same way 34E same rock
anticlinal to NE

S-161 - graphitic gtsite conformable w/ above &
underlying (?) or interbedded (?)
@ 200' N 485-34E

S-162 - rusty gtsite @ Bl 485-50E 92/25°N
w/ 1.0 inclusions of sericite / lineations 70/03E
overlain w/ similar to S-161 - fold series
across outcrop face (?)

S-163 - 'rusty' ?? 200' of gully near 325 300/31°N

S-164 - gtsite 100' from S-163 & small gully @ 30°
3 yr. old flagging

granite - long sloping o.c. across creek from
N112 W

S-165 - sericite schist above ↑

S-166 - biotite schist w/ pyrite - just below S-155

S-167 - chlorite schist - E of S-166

Suboutcrop of conglomerate: clasts local lithologies
100' NW of camp

... finis

June 19

241
5.3 | 11.2
106
20
53

lines:

Baseline 0 → 11200

line 11200 - 1500' W

9600 - 2000' W

8000 - 3600' W

samples:

baseline: every 400 from 0 - 11200 N

line 11200 W - every 200'

June 20

lines:

0N - 50E

BL 50E 0 → 11200

112N - 50E

samples:

traverse #1 : NE side of valley

June 21

samples:

lines 0N, 16N, 32N, 48N to E

traverse #2 : SW side of valley

June 22

samples:

lines 0N 16N 32N & 48N to W

all of 80N & 64N

June 23

samples

lines 112N to E all line 96

lines: 16S, 32S & 48S all to W.

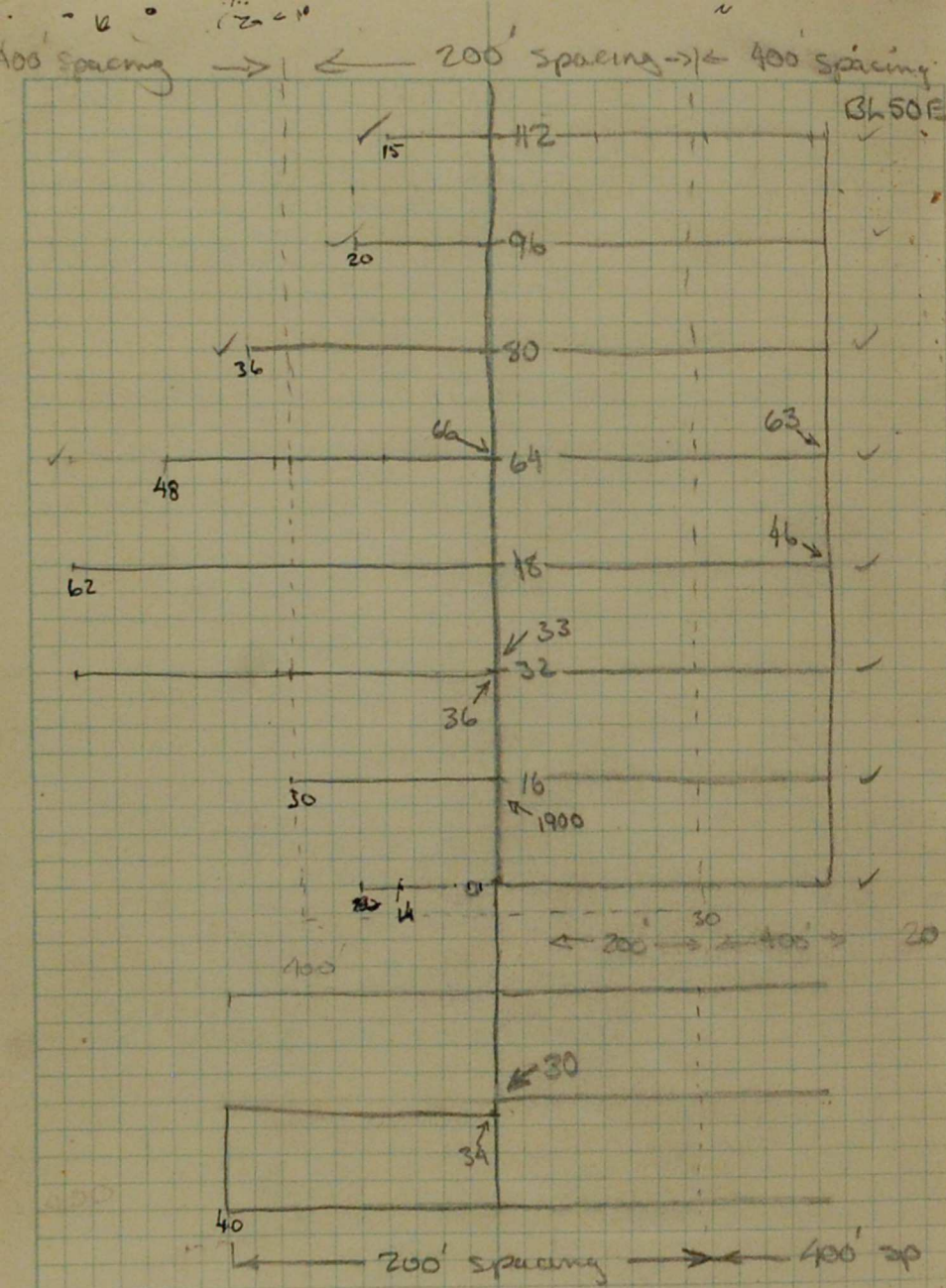

- quartz-sericite schist
- quartz-mica schist (biotite or indistinguishable)
- sericite schist
- quartzite or quartz schist
- graphitic phyllite
- chlorite schist
- granite

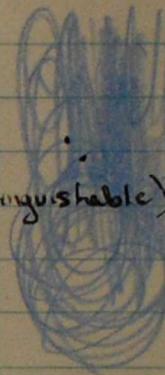

PACIFIC
WATERPROOF

Mining Transit Book

FILLER No. 321

FYRE LAKE PROJECT

GRID NOTES

JUNE 1973

BRIAN HOWARD

2.1
17500

GRID AT CAMP 1

JUNE 5/73

BASE LINE 0'

- | | | |
|-------------|-------------------------|---------------|
| 1) 400' N | 3' CK | VALLEY Bottom |
| 2) 680' N | SHALLOW DRAW | |
| 3) 1100' N | SHALLOW DRAW - cut BANK | |
| 4) 3300' N | HEIGHT OF RIDGE (N-S) | |
| 5) 5725' N | 2' CK | Gully |
| 6) 8900' N | 2' CK | GULLEY |
| 7) 10125' N | 1' CK | DRAW |
| 8) 10350' N | SHALLOW DRAW | |

JUNE 6/73

LINE 0' NORTH

1) 1000' E

NEARLY FLAT BENCH.

2) 3300' E

Height of sand on E-W line

3) 4000' E

- APPROX 450' To Bottom
of COL. ONE E

LINE 800 N JUNE 6/73

- 1) 4000' E Bottom of W.
- 2) 2400' E FLAT FORESTED BENCH 200' wide
- 3) 600' E 3' CK.
- 4) ● INTERSECT O' BASELINE 985' N 3950 W OF 4000' E POINT
- 5) 2200' W FINAL FLAG.
- 6) 2250' W LAKE.

LINE 1600 N JUNE 7/73

- 1) FINAL FLAG 2200' W
- 2) 2350' W APPROX LAKE.
- 3) INTERSECT O' BASELINE AT 1610' N AND AT 2190' E FROM 2200' W FLAG.
- 4) 200' E Height of Land
- 5) 900' E 3' CK Valley Bottom
- 6) 2100' E to 2600' E gently sloping bench.
- 7) 2650' E to 3400' APPROX TREES AND willow
- 8)

LINE 2400 N JUNE 7/73

- 1) 2250' E 1-2' CK
- 2) 1700' E Height of Land
- 3) 1050' E 3' CK.
- 4) INTERSECT O' BASELINE 2500' N 4025' W OF 4000' E FLAG.

LINE 3200 N JUNE 7/73

1) 1800' E MEADOW - Valley Bottom

2) 2000' E 2' CK

LINE 4000' N JUNE 7/73

3) 3200 E to - 2600 E
gently sloping TREED BENCH

4) 1900' E VALLEY Bottom
WET MEADOW.

5) 200' E Height of Land

6) INTERSECT O' BASE LINE
4095' N.
4010' W FROM 4000' E FLAG
TH

7) 2800' W FINAL FLAG.

8) 3100 Bottom of Meadow

LINE 4800 N JUNE 10/73

1) 2400' W FINAL FLAG ENDS
IN MEADOW BESIDE CAMP.

2) INTERSECT O' B.L. AT
4785' N
2380' E OF 2400' W FLAG.

3) 200' E Height of Land approx.

4) 1400' E SHALLOW GULLEY.

5) 1725' E HEIGHT OF LAND.

6) 2160' E 6 INCH CREEK.

7) 2715' E 1' CK.

8) 3025' E 1' CK.

LINE 5600' N JUNE 10/73

1) 2880' E 2' CK.

2) 2175' E 2' CK

3) 2060' E DRAW 2' CK.

4) 1550' E 1' CK DRAW

5) 600' E POND IN GULLEY.

6) INTERSECT O' BASE LINE
5775' N

4050' W FROM 4000' E FLAG

June 11/73

- 1) 200' W 2' CK. gully
- 2) 550' W Height of Land
- 3) 2600' W FINAL FLAG
- 4) 2650' W LAKE

LINE 64100' N June 10/73

- 1) 1125' E 1' CK.
- 2) 1430' E 1' CK.
- 3) 2050' E 1' CK.
- 4) 600' W Height of Land
- 5) 2800' W FINAL FLAG.

7200' N

June 10/73

- 1) 3300' E 2' CK.
- 2) 2750' E 1' CK.
- 3) 1500' E Valley Bottoms
3-4' CK.
- 4) INTERSECT 0' BASELINE
7280' N.
4000' W FROM 4000' E FLAG.

June 12/73

- 1) 3200' W FINAL FLAG.
- 2) 700' W HEIGHT OF LAND.
- 3) INTERSECT 0' BASELINE
7255' N
3210' E OF 3200' W FLAG.

June 11/73

8000 North

1) 1200' E

FINAL FLAG

2) 1350' E

3-4' CK.

June 12/73

3) 400' W

Height of Land

4) 3000' W

2' CK.

5) 3500' W

FINAL FLAG

LINE 8800' N

June 11/73

1) 1400' E

FINAL FLAG

2) 1460' E

3-4' CK.

3) 500' E

Height of Land

4) INTERSECT

6' BASELINE

8850' N

1450' W OF 1400' E FLAG.

LINE 8800' N

June 12/73

5) 3500' W

FINAL FLAG.

6) 2800' W

Height of Land

7) 2200' W

2' CK Valley.

8) INTERSECT 0' BASELINE

8740' N

3450' E OF 3500' W FLAG

LINE 9600' N

JUNE 11/73

1) 450' E

Height of Land.

2) 1600' E

FINAL FLAG.

3) 1700' E

3-4' CK.

LINE 9600' N.

June 13/73

- 1) 3500' W FINAL FLAG
- 2) 2800' W Height of Land
- 3) 1950' W SHALLOW DRAW FROM NORTH
- 4) 1400' W 1' CK. wide gully meadow
- 5) INTERSECT 0' BASE LINE
9730' N.
3490' E OF 3500' W FLAG

10,400' N LINE

June 11/73

- 1) 2200' E FINAL FLAG
- 2) 2350' E 3' CK.
(END OF OPEN MEADOW.
AIR PHOTO).
- 3) 600' E Height of Land.
- 4) 100' E GULLY - MEADOW.
- 5) INTERSECT 0' BASE LINE
AT 10,480' N
~~2210'~~ 2210' W OF 2200' E FLAG

LINE 10,400' N

June 13/73

- 1) 3500' W FINAL FLAG

LINE 11,200' N

JUNE 11/73

- 1) 1600' E Height of Land.
- 2) 2800' E FINAL FLAG.
- 3) 3050' E CONFLUENCE OF
2 MAJOR VALLEY CREEKS.

LINE 11200 N

June 13/73

- 1) 3000' W FINAL FLAG.
- 2) INTERSECT 0' BASELINE
11,305 N
3000' E OF 3000' W FLAG

12,000' N Line June 14/73

- 1) 3150' E 5' CK
Valley Bottom
- 2) 3000' E FINAL FLAG.
- 3) 1200' E HEIGHT OF LAND.
- 4) 275' E 1' CK.
- 5) INTERSECT 0' BASELINE
~~12,125' N~~ 12,125' N
3025' W FROM 3000' E FLAG.

12,000' N-W

June 13/73

- 1) 3000' W FINAL FLAG

LINE 3200' N (W) June 14/73

- 1) ~~3200'~~ 3200' N on BASELINE
Highest Point of RIDGE
- 2) 2800' W FINAL FLAG
- 3) 2850' W LAKE.

END OF CAMP 1 GRID NOTES

PACIFIC
WATERPROOF

Mining Transit Book

FILLER No. 321

FYRE LAKE PROJECT

BRIAN HOWARD

JUNE 1973

GEOCHEM NOTES

① NUMBERING SYSTEM :

73 -
F - YRE -
H - OWARD -
3 F H L
SAMPLE NUMBER -

L - soil

O - highly organic

S - silt

R - rock chip

G - gossan

② MAKE NOTE OF THE FOLLOWING THINGS NEATLY IN YOUR BOOK.

(a) STN NUMBER when sampling on grid lines

(b) TOPOGRAPHIC FEATURES - creeks, swamps, lakes, prominent rock outcrops, etc. - anything that might show up on an air photo.

(c) GOSSANS of any kind - such as rusty seeps or swamps, rusty rock outcrops or soil

(d) Any signs of previous exploration activity, such as flagging, cat roads, claim posts, etc.

June 14/73

- 1) 3FH14S - Sample from main CK.
- 2) 3FH16L. TRIBUTARY CK FROM E
- 3) 3FH50L CK FROM W (MAJOR)
- 4) 3FH58L FINAL SAMPLE.
- 5) ALL EVEN NUMBERS, ON WEST SIDE OF CK. ALL ODD NUMBERS ON EAST SIDE OF CK.

June 15/73

TRAVERSE.

- 1) 3FH65L STEEP High River BANK. OUT CROPS.
- 2) 3FH77L 200 FT high CUT BANK CENTER
- 3) 3FH83L. END OF CUT BANK
- 4) 3FH92S CK 2' wide
- 5) 3FH96S CK 6" wide
- 6) 3FH110L 3'-4' CK. (NO SILT SAMPLE)
- 7) 3FH116S 1' CK
- 8) 3FH124L. on E side of River CK. opposite sample.
- 9) 3FH134S 2' CK.
- 10) Between 139-140 - 1' CK.
- 11) 3FH145L. LAST SAMPLE TAKEN



TRAVERSE

June 16/73

- 1) 3FH 146 L FIRST Sample
 2) 3FH 160 L END OF 200' INTERVAL SAMPLING
 3) 3FH 166 O Lightly organic
 4) FROZEN + organic soil unable to sample 3FH 172 L - so IT IS 1000' FROM 171 - 172.

- 5) 3FH 174 S TINY CK
 6) 3FH 185 L FINAL Sample adjacent to pond in CK.

TRAVERSE Down Campbell R. June 17/73

EAST SIDE

- 1) 3FH 186 L FIRST SAMPLE TAKEN AT CLIFFS.
 2) 3FH 194 L AT BASE OF 100' high OUTCROP.
 3) 3FH 196 L Beginning of high CLIFFS CUT BANKS
 4) 3FH 200 L. END OF CUT BANK CLIFFS
 5) 3FH 207 S 3' CK.
 6) 3FH 215 S 1' CK.
 7) 3FH 218 L High CLIFFS CUT BANK
 8) 3FH 224 S 1' CK
 9) 3FH 225 S 1' CK
 10) 3FH 235 L 200' high CLIFFS SAMPLE TAKEN TOP OF CLIFFS.
 11) 3FH 236 L " "
 12) 3FH 237 L " "
 13) 3FH 257 L LAST SAMPLE.

TRAVERSEJune 21/73

- | | | |
|---------------|--------------------|--------------|
| 1) 3FH 258 R | (FIRST SAMPLE) | Rock sample. |
| 2) 3FH 266 R | " | " |
| 3) 3FH 273 R | " | " |
| 4) 3FH 275 R | " | " |
| 5) 3FH 284 R | " | " |
| 6) 3FH 285 R | " | " |
| 3FH 287 L | confluence of CKS. | |
| 7) 3FH 303 R | " | " |
| 8) 3FH 319 R | " | " |
| 9) 3FH 323 L | 3' CK | |
| 10) 3FH 332 L | CONFLUENCE OF CKS | |
| 11) 3FH 355 L | LAST SAMPLE | |

TRAVERSE ⁹⁴ Line 8000' N June 22/73

1) 3FH356L - 8000' N on Base line
2) 3FH372L FINAL SAMPLE
on 8000' N line TAKEN
3600' W.

3) 3FH412L 5000' E

4) 3FH430L AT BASELINE
INTERSECT BASELINE AT
8000' N

34

19

Line 6400' N

June 22/73

1) 3FH376L 4200' W (LAST sample)
2) 3FH373L 3600' W.
3) 3FH392L Base line
intersect Base line
6600' N
4) 3FH394L 400' E of Baseline
5) 3FH411L (BASE line 5000' E)
intersect Base line 4600' E
115' S of 6400' N point

END OF Fyre LAKE AREA
WORK

16

GODLIN AREA North side

TRAVERSE DOWN CK. July 7/73

1) 3GH431L - Sample Taken
400' Downstream from
where +800 SE Grid line crosses CK,

1) 3GH4338 4' CK

2) 3GH438S - silt 4' CK

3) 3GH442S 4' CK

4) 3GH443S small side CK

5) 3GH446S 4' CK

6) 3GH451S 4' CK

7) 3GH455S 4' CK

8) 3GH460S 4' CK

9) 3GH465S 4' CK

10) 3GH469L - LAST SAMPLE

GODLIN AREA

TRAVERSE HEAD CIRQUE July 3/73

1) 3GH470L - FIRST SAMPLE
(North side of CK)

2) 3GH483S - 1' CK N side
HEAD OF CIRQUE

3) 3GH485S - MAIN CK Head
of cirque

4) 3GH486L - South side of CK

5) 3GH490S - MAIN 4' CK

6) 3GH492S - LAST SAMPLE South
side of cirque (CK)
1' CK Tributary from S.

1-2-73
PACIFIC
WATERPROOF

1-2-73
Mining Transit Book

FILLER No. 321

BRIAN D. HOWARD
FYRE LAKE PROJECT
JUNE 1973

FYRE LK - CAMP 2

EYRE LAKE PROJECT June 19/73

BASELINE 0

1) 200' N

4-5' CK

(DOWN FROM JUNCTION)

2) 400' N

3-4' CK ABOVE (INFLUENCE)

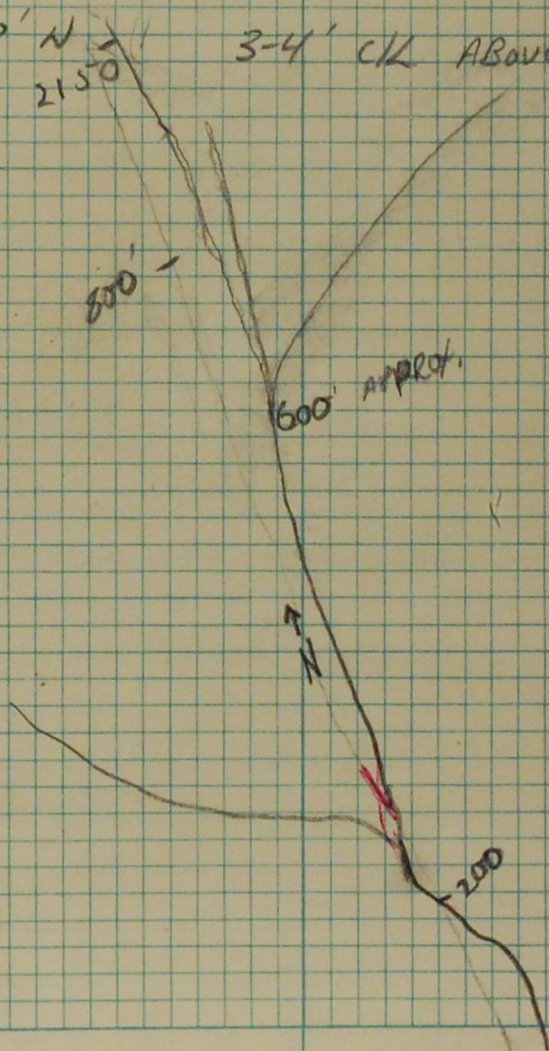

- 3) 2150' N 1' CK
- 4) 4000' N old FLAGGING NOT on CK.
- 5) 5125' N 2' CK.
- 6) 6800' N - in snow so FLAGGED AT 6900' N INSTEAD
- 7) 7900' N 1' CK.
- 8) 9200' N gully CK
- 9) 11200' N 300'S OF Bottom of COL (High pass).

BL. 2 South. June 23/73

- 1) 1425' S CONFLUENCE OF TWO MAIN CKS.
- 2) 3425' S 4' CK.
- 3) 2800' S leave CK Valley Bottoms

LINE 11200 N

- 1) 1500' W FINAL FLAG.
- 2) 5000' E FINA FLAG
- 3) 4140' E 3' CK.
- 4) 2200' E OUT OF TREES.
- 5) INTERSECT BASELINE
5150' W FROM 5000' E FLAG
11,215' N

LINE 9600' N

1) 2000' W

FINAL FLAG

LINE 8000' N

1) 3600' W

FINAL FLAG

2) 2800' W

HEIGHT of LAND

3) INTERSECT 0' BASELINE

3600' E OF 3600' W FLAG

8025' N on BASELINE

LIN E 0' N

June 20/73

- | | |
|------------|------------------------|
| 1) 15' E | 4-5' CK - Valley |
| 2) 1525' E | 1-2' CK wet meadow |
| 3) 2500' E | Small Pond (100') |
| 4) 4880' E | 3-4' CK (slight gully) |
| 5) 5000' E | LAST FLAG - EAST |

BASELINE 5000' E

June 20/73

- | | |
|---------------|------------|
| 1) 350' N | gully |
| 2) 2675' N | 1' CK |
| 3) 2825' N | 2' CK |
| 4) 3150' N | 2' CK |
| 5) 3375' N | 3' CK |
| 6) 3500' N | 2-3' CK |
| 7) 3850' N | 3' CK |
| 8) 3950' N | 4' CK |
| 9) 4700' N | 2' CK |
| 10) 7125' N | 3' CK |
| 11) 7350' N | 2-3' CK |
| 12) 7575' N | 4' CK |
| 13) 9900' N | 3' CK |
| 14) 10,025' N | 2-3' CK |
| 15) 10,500' N | 4' CK |
| 16) 11,200' N | FINAL FLAG |

LINE #200 4800'S

- 1) 2300' W Height of Land.
- 2) 2950' W Valley Bottom.
- 3) 4000' W LAST FLAG.

4) 1400' E Height of Land.
→ begin 400' flagging

5) 4700' E 3' CK.

6) 5000' FINAL FLAG.

LINE 3200'S

June 23/73

- 1) 4000' W LAST FLAG.
- 2) 2900' W 4' CK
- 3) 2750' W 4' CK. (same CK)
- 4) 2600' W leave Valley Bottom
- 5) 400' W 4' CK cross
- 6) INTERSECT BASE LINE

3400'S

3990' E FROM 4000' W FLAG

- 1) 4730' E 1-2' CK.
- 2) 1400' E HEIGHT OF LAND

LINE 1600'S.

June 23/73

1) 3600' W

Height of Land

2) 4000' W

Final Flag

June 24/73

1) 50' E

6' CK (Just Below
confluence)

2) 600' E

Begin 400' FLAG
spacing

3) 1100' E

Height of Land

4) 250' E

6' CK - Valley
Bottom

5) INTER 1

3025 S

4970 FROM 5000.

Geology Work

June 25/73

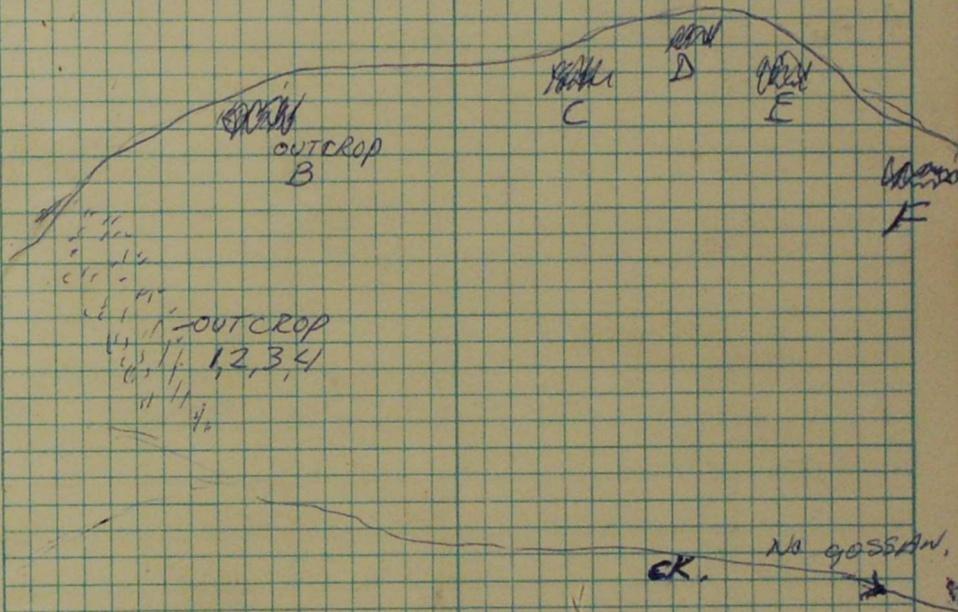

PACIFIC
WATERPROOF

Mining Transit  Book

FILER NO. 111

Pine

FYRE AREA PROJECT

BOOK III

FYRE AREA and

KEG CLAIMS GRID
GEOCHEM

F.Y.B.

June 16 #52

- began traverse with # 593

- * gossans in soil at # 634

- #633 taken 100' W of 635

- ended traverse with 656

657
593
<u>64</u>

SAMPLES to date

510
64
<u>574</u>

JUNE 17

- began TRAVERSE #52 with # 657

- small gossan on outcrop at #668

June 16

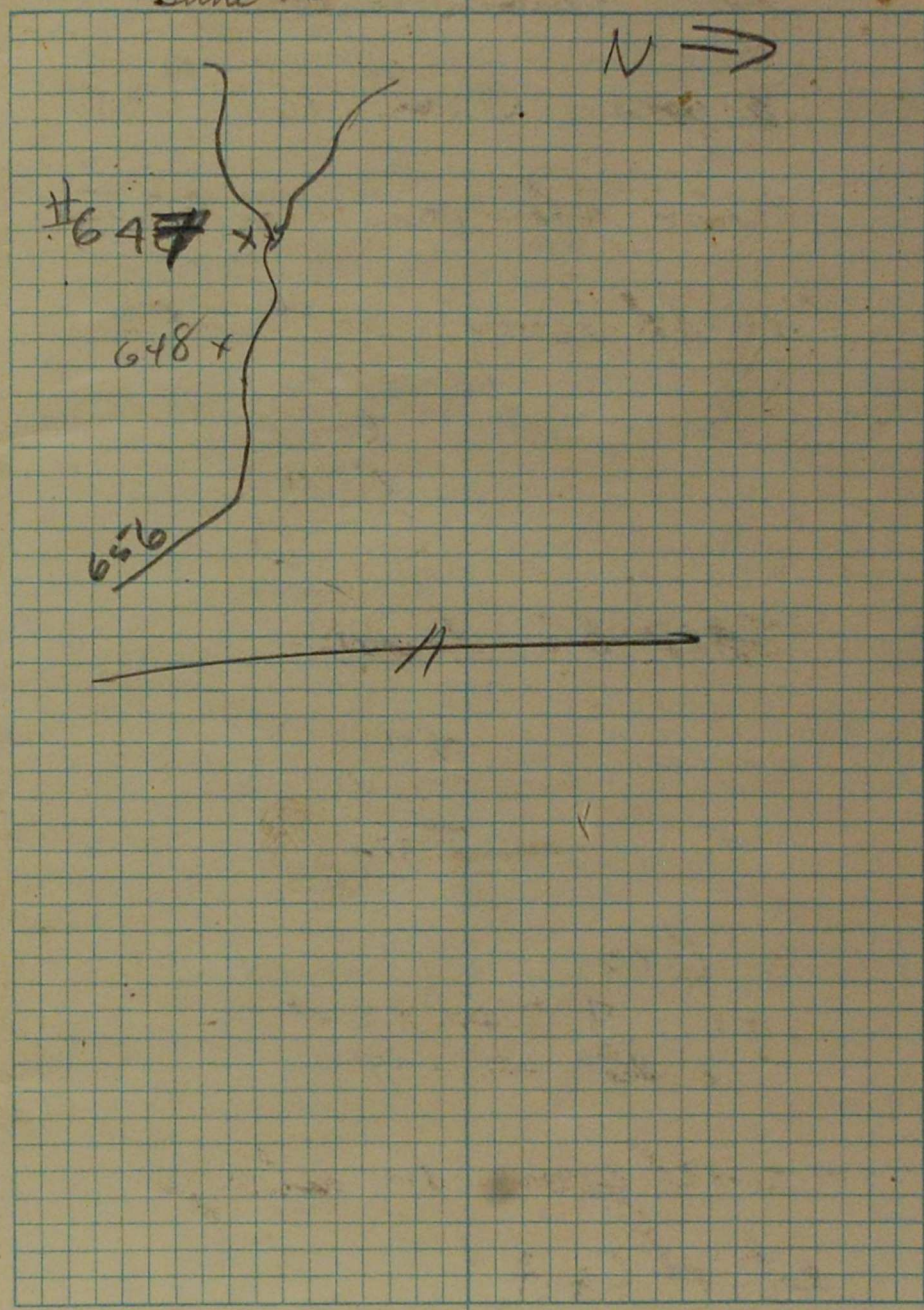

673 taken from a v.
small seepage draining
into C.C.

- across creek from #694 is
one hollow big gossan

- # at 695 found an old
flag - no marks on it -
bleached white.

- 50' N of 696 - small
gossan outcrop

- missed # 717

- finished at 745

- today - 88 Samples

- to date: 574

88
662

JUNE 19 1973

- BL - every 400'
- BL runs to - 12,800 = 32 samples
- follow ridge -

- BL 00 + 0 at campsite
- begin sampling with # 746.

750 taken at 16 N

754 taken at 32 N

756 taken 100' N of ~~70~~⁴⁰ N
due to snow

- 758 taken at 48 N

- 762 taken at 64 N

- 763 taken 100' N of 68 N

766 taken at 80 N

770 taken at 96 N

774 taken at 112 N

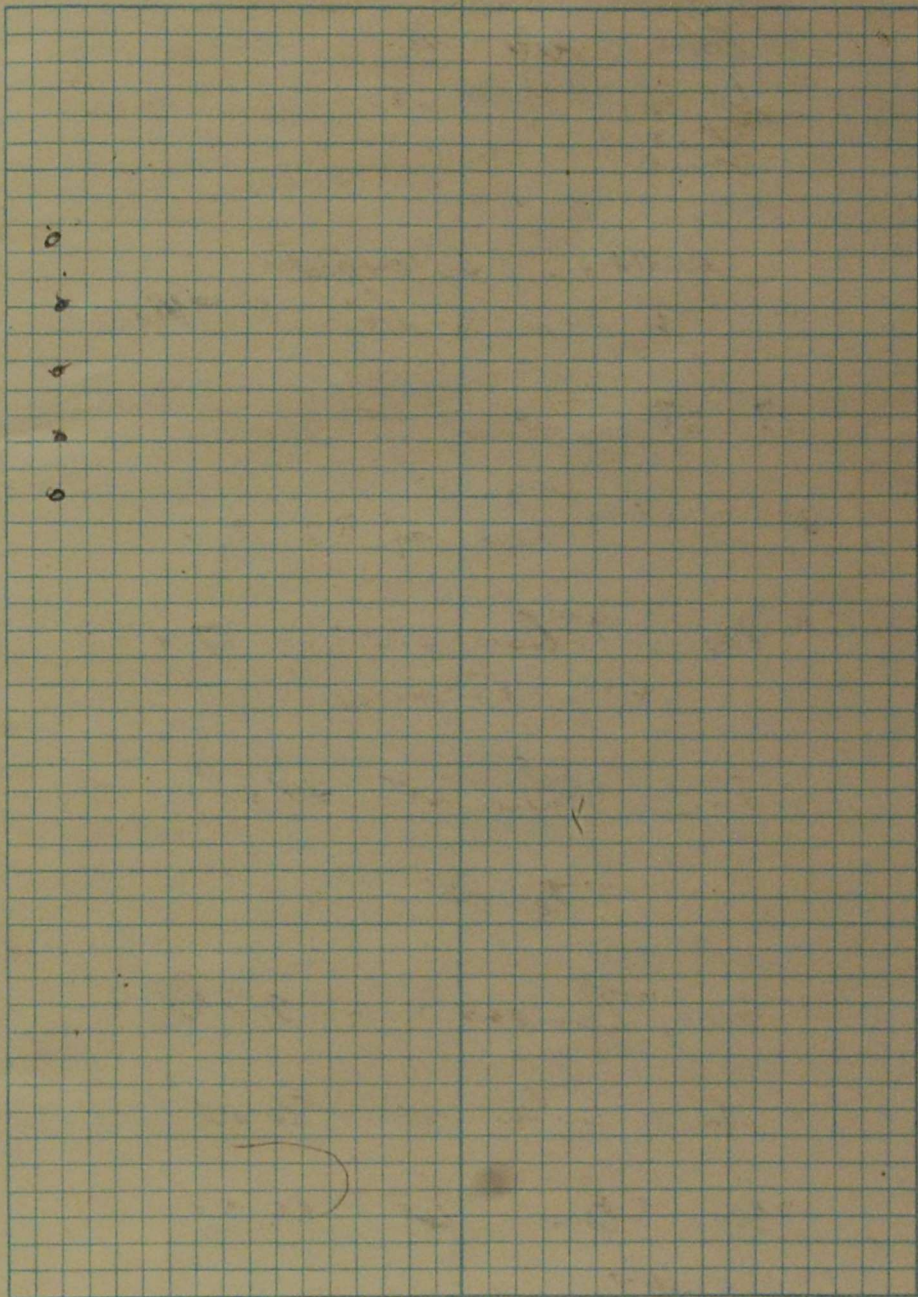

- began 112 N - 2 W with # 775
- 200' spaces

- ended 112 N at 1400 W
with 781

782
746
36 samples today

TO DATE:

- 662

36
698

- JUNE 20 '73

- began traverse along side hill
with # 782

- ended line along slope with #
826

- began lower line with 827

- ended " " " 870

Today

871
782
89

6

TO DATE: 698
89
787

June 21 '73

- began 00-2E with # ~~871~~ 871
- ended 00-50E with # ~~890~~ 890
- began 16N-50E with # 891
- at 16N-30E # ~~896~~
 - NO SAMPLE
 - wet - deep moss (897)
- 16N-26E - ~~898~~
 - NO SAMPLE (899)
- finished line 16N ~~at~~ at
19.00 N on BL with Sample
908

- began 48N-2E with #909.

- 48N-8E 915
NO SAMPLE

- 48N-18E - ~~917~~
NO SAMPLE

48N-28E - 922
NO SAMPLE

- 48N-34E 924
NO SAMPLE

- Lt Bl 5000E at
46N

- added 48N-50E with
#928

~~#~~

32N-50E
NO SAMPLE

32N-46E
N/S

32N-42E - N/S

32N-38E - NS

- 32N-34E - # 929

- 32N-30E - N.S

32N-28E - NS

" - 26 - # 930

" 24 # 931

" 22 - N.S

" 20 - # 932

18 - # 933

16 934

14 - 935

12 - 936

10 - N.S

8 E

937

6 E

938

4

939

2 F

940

- ended line with 940

- hit BL at 3300' N

-today 941

871

70

-6

64

TO DATE

787

64

851

JUNE 22

981
941
21

began 48N 2W with #941

-ended 48N with #963

-began ³²~~48~~N at ridge with #964

-ended ³²~~48~~N-2W with #987

-hit BL-0- at 3600N

-began ~~48~~16N-2W with #988

-ended 16N at ridge with #1002

began - 00N at ridge with 1003

-finished 00N-2W with 1009

TODAY

1010
941
69

TO DATE

851
69
920

≡≡≡
≡≡≡
963
941
22

JUNE 23

- began 96N - 20W with # 1010

- ended 96N - 2W with 1019

- began 112N - 2E with 1020

- ended 112N - 50E with 1039

- began 96N - 50E with 1040

- ended 96N - 20E with 1059
2E[↑]?

SAMPLES	today	1060
		<u>1010</u>
		<u>50</u>

TO DATE	920
	<u>50</u>
	<u><u>970</u></u>

June 27

- began BL - 45 - with # 1060

- 165 - 106~~3~~³

- began 165 - ~~20W~~^{40W} with 1064

- ended 165 - 2W with 1083

- began BL - 20 S with 1084 n

- BL - 325 1087

- began 325 - 2W with 1088

- ended 325 - 40 with 1107

- began 485 - 40W with 1108

- ended 485 on BL # # 1128

BL 445 1129

40 1130

36 1131

Today
1132

1060
72

TO DATE

970
72
1042

JUNE 25

- began 165 - 2E with 1132

- ended 165 - 50E with 1151

- began 325 - 50E " 1152

- ended 325 - 2E with 11~~8~~⁷1

- began 485 - 50E with 1172

- ended 485 - 2E with 1191

- today 60

to date: 1042

$$\begin{array}{r} 1042 \\ + 60 \\ \hline 1102 \end{array}$$

3

July ~~1973~~ 1973

- Godlin Lakes Area.

- began BL - 1000' NW with #1

- #4 taken at 800' NW

- #20 taken at 00+0

- #52 taken at 1600' SE

- #53 taken at 4000' S.E

- #99 taken at 1650' S.E

Today = 99

TO DATE - 99

July 4 1973

900

- began 12SE
#100

- ~~50~~ NE with

- ended 12SE - 50 NE with 107

- began 12SE - 50 ~~SE~~ SW with 108

- ended 12SE - 600 SW with #119

- began 14SE - 800 SW with #120

- ended 14SE 50 SW with #135

- began 14SE - 50 NE with #136

~~ended~~ ended 14SE - 400 NE with #143

- began 16SE - 400 NE with #144

ended 16SE - 50 NE with #151

- began 16SE - 50 SW with #152

- ended 16SE - 600 SW with #163

July 4

- began 185E - 600 SW - # 164
- ended 185E 500 SW with # 175
- began 185E - 50 NE with # 176
- ended 185E - 1000 NE with # 195
- began 20 SE - 1000 NE with # 196
- ended 20 SE - 50 NE with # 215
- began 20 SE - 50 SW with # 216
- ended 20 SE 700 SW with # 229
- began 22 SE 700 SW with 230
- 650 SW NO SAMPLE
- 600 SW - # 231
- ended 22 SE - 50 SW with # 242
- began 22 SE - 50 NE with 243
- ended 22 SE - 900 NE with 250

JULY 4

- began 24SE - 600NE with 251

- ended 24SE - 50NE with 262

Today: 263

~~100~~

~~100~~

163

TO DATE - 262

JULY 5 1973

- began 24SE - 50 SW with # 263

- # 275 taken at 650 SW

- 700, 750, 800 SW
NO SAMPLES

- began 26SE - 800 SW with # 276

- ended - 26SE - 50 SW with # 291

JULY 5

- began - 26 S ~~S~~^E - 50 NE with 292

- ended - 26 S ~~S~~^E - 600 NE with #303

- began - 28 S ~~S~~^E - 600 NE with #304

- ended - 28 SE - 50 NE with #315

- began - 28 SE - 50 SW with #316

- ended 28 SE - 730 SW with #330

- began 30 SE - 600 SW with #331

- ended 30 SE - 50 SW with 342

- began 30 SE - 50 NE with 343

- ended 30 SE - 800 NE with 358

began 32 SE 1300 NE with 359

ended 32 SE - 50 NE with 384

- began 32 SE - 50 SW with 385

- ended 32 SE - 600 SW with 396

JULY 5

- began 34SE - 400 SW with 397

- ended 34SE - 50SW with # 404

- began 34SE - 50 NE with # 405

- ended 34SE - ¹³100 NE with ⁴³²~~433~~

- began 36SE - 1300 NE with 433

- ended 36SE - 50 NE with #460

today

461

262

199

To

DATE

460

- 38 SE - 1300

- 40 SE - 2600

- 42 - 20

- 44 - 18

- 46 ≈ 14

- 48 - 10

- 50 - 8

- July 6 1978

- 100 ft sampling

- began 38SE - 1300 NE with 461

ended 38SE - 100 NE with #473

began 40SE - 100 NE with 474

- 1500 NE - NO SAMPLE - tubes

- ended 2600 NE with #498

- BL 26NE - 42SE - #499

- BL - 26NE - 44SE #500

- began 44SE 100 SW with #501

- ended 44SE - 1800 SW with #518

- began 42SE 2000 SW with #519

ended 42SE - 100 SW with #538

- began BL - 26NE 46SE with #339

- 100 SW - 540

200 SW - 541

300 SW - 542

- cont'd

- began ~~#48~~ 48SE - with #543

- ended 48SE - 12 SW with 555

- began 46SE - 14 SW with 556

- ended 46SE - 400 SW with 566

today - 106

to date: 566

1000 SE 400 NE } 12
 800 SW }

~~1000~~ 800 SE 800 SW } 10
 200 NE }

600 SE 200 NE } 8
 600 SW }

400 SE 600 SW } 8
 200 NE }

200 200 NE } 6
 450 SW }

0 400 SW } 7
 300 NE }

51

200 NW

400 NE

300 SW

400

200 SW

400 NE

600

500 NE

200 SW

800

400 NE

1000

600 NE

4

3

2
4

5
2

4

7

6

20

July 7

- began traverse down creek
- 400' spacing
- started 400' down creek from 48 SE with # 567
-
- 571 taken from small tributary 200' downstream from 570
- ended traverse with # 606

today: 606

566
40

to date: 606

~~##~~

July 8

- began 1000 SE - 4 NE with 607
- ended " - 100 NE with 610
- began " - 100 SW with 611
- ended " - 500 SW with 618

- began 8 SE - 800 SW with 619

- ended 8 SE - 200 NE with 628

- began 6 SE - 200 NE with 629

- ended 6 SE - 600 SW with 636

- began 4 SE - 600 SW with 637

- ended 4 SE - 200 NE with 644

2 NE

- began 2 SE - 200 ~~NE~~ - with 645

- ended 2 SE - 400 ~~NE~~ with 650
3W

- began 0 SE - 400 SW - with 651

- ended 0 SE - 300 NE with 657

- began 2 NW 4 NE with 658

- ended 2 NW 3 SW with 664

- began 4 NW 2 SW with 665

- ended 4 NW - 4 NE with 670

- began 6 NW - 5 NE with 671

- ended 6 NW - 2 SW with 677

- began 8 NW - 100 NE with 678

- ended 8 NW - 400 NE with 681

~~sampled 10NW 6NE~~

- began - 10NW - 6NE with 682
- used 10NW - ~~MOONE~~ #687

- END OF GRID

- samples today: 81

- to date: 687