

PACIFIC
WATERPROOF

019516

Mining Transit Book

FILLER No. 321

8 JUNE →

RYSD-1 →

719

SP = YSCA PAGE

A = 2014

June 9 410

Map Sheet 116 B-13

- RYSDY R - Shale & chert
- 2L Sandy soil, Rock fragments
3L - Partly frozen
4L Good soil
5L Frozen
6L -
7L Shale rock fragments in soil
8L Mossy slope
9L Mossy slope. Rock frag.
10L Talus
11L Talus
12L Talus
13 SP Poor silt. 10 paces from 12
14L Talus
15L Talus. Poor
16L Talus (corner)
17S 2' 2" Snow meltwater. Poor silt
18L-27L Talus (up middle ch)
28L-31L Talus (on other ch)
32L Talus (start new line)
33L Slump
34L minor slump
35L "

Map Sheet 116B-14 & 116B-11

- 36S 2 1/2" meltwater 25 paces from 35
- 37-39L Mossy Good soil
- 40 L Slump
- 41L-42L " "
- 43L Frozen. Very poor soil
- 44L Frozen but better
- 45L Mossey
- 46SP Small 80 paces from 45
- 47 L Sandy
- 48 Slump
- 49L poor soil
- 50L-51L Good soil (51L start up last ck.)
- 52L-53L Slump
- 54L " "
- 55L Partly frozen
- 56 L Slump (top of line)
- 57 L Mucky
- 58L-60L Slump
- 61L Frozen. Very poor. Part organic
- 62 L Poor (End of line)
- 63L-64L Mossey - Not too good
- 65L Slump
- 66 3'2" Poor silt (8 p.f. 65)
- 67L
- 68L - Slump

- 69L Slump
- 70-71L Mossey
- 72 SP small Silt not the best
- 73 SP " "
- 74 L Slump
- 75L Mossey Poor sample
- 76 SP Poor silt. Mostly organic
- 77L Soil Poor
- 78L " "
- 79S Good silt
- 80L Slump
- 81S Good silt
- 82L-83L Good ~~silt~~ soil
- 84S Dry ck.
- 85L-86L Good soil
- 87S small
- 88 L Gopher diggings
- 89 SP Small
- 90 L Good soil
- 91 SP small. Not too much silt
- 92S dry ck.
- 93L Poor
- 94 L Slump

- 95L Slump
 96S lake & stream appears. Could be part of main stream (underground)
 97S Fair silt
 98L Gopher diggings
 99L Poor soil
 100S Dry cln
 101L-102L Talus
 103L Mossey
 104S dry
 105L Organic. Very poor soil
 106L Very poor soil
 107L Better soil
 108S Good silt
 109L Very poor soil
 110L Better
 111L-112L Poor soil
 113L Very poor soil
 114L "
 115SP Small (115 p.f. 114)
 116L-117L Very poor
 118L Poor
 119L Better
 120L Very poor
 121SP Very poor silt (75 p.f. 120)
 122L-125L Very poor soil

- 126S 0127S small Good silt
 128L+129L Slump
 130S Good silt. (120 p.f. 122)
 131L-133L Slump
 134L-135L "
 136L-138L Slump
 139L Talus
 140L-141L Slump
 142S Good silt
 143S very small very poor silt
 144S Good silt
 145L+146L Slump
 147S Good silt
 148L+149L Poor soil
 150L Sandy
 151L Slump
 152L-153L Slump
 154L Mossey
 155L Slump (Bottom of cln)
 156L+157L Slump
 158S Good silt
 159L-162L Slump
 163L Mossey
 164L Sandy

165 L-167 L Slump
168 L Good soil
169 L Sandy poor
170 L "
171 S Almost seepage. Very poor silt (80 p.f. 170)
172 L Poor soil
173 L Sandy soil
174 L Slump
175 L-176 L Soil sandy Fairly poor

Map Sheet 116 C-16

June 13

177 L Mossey
178 L Talus
179 S very small. Poor silt
180 S very small
181 L-182 L Mossey
183 L Sandy
184 L Mossey
185 L Sandy
186 S Good silt
187 L-188 L Mossey
189 SP Small Good silt (68 p.f. 188)
190 L Mossey
191 L Slump

192 L-193 L Slump
194 L-195 L "
196 L-198 L Slump
199 L-200 L "
201 L-204 L "
205 L Mossey
206 L Sandy Poor
207 S Good silt
208 L-209 L Sandy
210 L-211 L Sandy
211 L-214 L "
215 L Mossey
216 L "
217 SP Dry
218 L Very very poor soil
219 L Good soil



Map Sheet 116 B-13

June 15

- 220S Good silt
221L-227L Good soil
228L Talus
229L-234L Talus
235SP Very small (40 p.f. 234)
236 ~~Fair~~ Slump
237S Fair silt (56 p.f. 236)
238L Organic Very poor
239L Poor Talus
240L Talus
241L-245L Slump & Talus
246S Very poor silt
247L
248L Partly organic
249S Fair silt (50 p.f. 248)
250L-252L
253L Partly organic
254L-255L
256S Fair silt

Map Sheet 116B-13 & 116C-16

June 17

- 257L - Talus
258L-260L Talus
261L Talus. Organic. Poor
262L-263L Organic. Poor
264 SP. Dry seepage
265S Small Poor silt (75 p.f. 264)
266L-267L Organic Poor.
268L - O.K.
269 SP Very small
270L Mossey
271S Good silt
272S " "
273SP Almost Dry (85 p.f. 272)
274SP Small (50 p.f. 273)
275L-277L Mossey
278S Good silt
279S Dry ch.
280L Organic. Poor
281L Good soil
282L Poor
283L-284L Partly organic
285S Good silt (76 p.f. 284)
286L Organic. Very, very poor

287L	Organic	Poor.
288L	Frozen	Poor
289SP	Small	(77 p.f. 288)
290L	Organic	Very poor
291L	Frozen, organic	Very poor
292L	"	"
293SP	Good silt	(92 p.f. 292)
294SP		(60 p.f. 293)
295L	Frozen, Organic	Very poor
296S	Good silt	
297L	Organic.	Very poor
298L	Good soil	
299L	Frozen, Organic.	Very poor
300L	Partly organic	
301S	Good silt	
302L	Partly organic	
303S	Good silt	
304L	Partly organic	
305L	Fair soil	
306L	Fair soil	

307L	Organic	Poor
308V	Good silt	
309	Partly organic	
310S	Fair silt	
311L	Good soil	
312S	Good silt	
313S	Dry	Very rusty above
314L-315L	Good soil	
316S	}	Good
317L		
318S		
319L-320L	Talus	
321S		
322L	Talus	Partly organic
323-329L	Talus	
330L	Talus	Poor soil
331L-332L	"	"
333L-335L	"	"
336L	Talus	O.K.
337L	Talus	O.K.
338L	Talus	Poor
339-341L	"	"
342L	Better	

343L - Talus Poor
 344L Mossey Very very Poor Organic
 345-348L Fair soil
 349S Fair silt
 350L Fair soil
 351SP Good silt (30p.f. 350)
 352SP " " "
 353S Good silt
 354L Poor
 355L Good soil
 356L Fair soil
 357S Good silt
 358L
 359S Good silt
 360L
 361SP Dry (77 p.f. 360)
 362L Organic Poor
 363L-364L OK
 365S Good silt (80 p.f. 364)
 366L Organic Very poor
 367L " "
 368L-369L " "
 370S Good silt
 371SP
 372L organic. very poor
 373SP O.K.
 374L Organic very poor

Map Sheet 116B-14

June 19

375SP Fair silt
 376L-379L Fair soil Talus
 380S Good silt
 381-384L Talus
 385L-386L Mossey Rock frag
 387L-388L " "
 389L Talus
 390S (directly opposite ch. on the road)
 391L Talus
 392S OK (62 p.f. 391)
 393L
 394SP OK (84 p.f. 393)
 395L-396L
 397S (50 p.f. 396)
 398L Mossey
 399SP Good silt (80 p.f. 398)
 400L-401L Mossey
 402S Poor silt (first in big valley)
 403L Talus
 404SP OK (50 p.f. 403)
 405S Poor silt
 406S Fair silt (46 p.f. 405)
 407L Slump
 408S Fair silt

409 L Talus. Poor
 410 SP Fair. (89 p.f. 409)
 411 L-414 L Slump
 415 S Good silt
 416 L-417 L Slump
 418 SP Fair silt
 419 SP Poor
 420 L Organic. Very very poor,
 421 L "
 422 S Good silt } next valley over
 423 S Fair silt }
 424 L
 425 SP Fair silt (40 p.f. 424)
 426 SP "
 427 SP Fair (60 p.f. 426)
 428 SP Fair (70 p.f. 428)
 429 L-438 L Part Organic. Some poor
 439 SP Good silt
 440 L-442 L
 443 S Fair silt. (Big ch)
 444 L Organic. Very very poor "
 445 L-446 L "
 447 L-451 L "
 451 L Ok.
 452 L Fair soil

Map Sheet 116B-11

June 20

453 L-455 L Good soil
 456 SP Fair silt (58 p.f. 455)
 457 L Good soil
 458 S-459 S Good silt
 460 L Slump 467 S
 476 S
 479 L-479 L Mossey
 480 S Fair silt
 481 L-483 L Slump
 484 S O.K.
 485 S O.K.
 486 SP Fair silt
 487 S Good silt
 488 SP "
 489 SP Fair silt (65 p.f. 488)
 490 SP " " (70 p.f. 489)
 491 L Organic. Poor. Frozen
 492 SP Good silt
 493 L-495 L Organic. Poor
 496 SP Poor silt. Organic
 497 SP "
 498 SP Partly organic
 499 L-500 L Organic. Poor
 501 L O.K.
 502 S Good silt (40 p.f. 501)

503L-506L Fair soil
 507S Good silt
 508SP " " (88 p.f. 507)
 509L O.K.
 510Z Partly organic.
 511S Good silt
 512L Poor
 513L Organic Very very poor
 514-516L Fair soil 516 Poor
 517SP Good silt
 518L Organic. Poor
 519SP Good silt (25 p.f. 518)
 520L-522L ^{part} Organic Poor
 523L O.K.
 524L Mostly organic. Poor
 525L-527L Partly organic
 528S Good silt 1. ft
 529L-533L Fair soil

534L-541L Good soil
 542S Fair silt
 543-544L Good soil
 545L-546L Organic Poor
 547L-554L Talus Fair soil
 555S Rusty patch starts here
 556L-558L Massey Fair to poor soil
 559L Organic. Very poor
 560L " "
 561L Partly organic. Poor
 562L-568L Fair soil
 569S Fair silt (Big ch) (70 p.f.)
 570S " "
 571L-573L Partly organic
 574SP Good silt
 575L-576L Organic. Poor
 577SP Fair silt
 578-584L Partly organic Fair
 585SP Good silt
 586SP Good silt (58 p.f. 585)
 587L-589L Part organic. Poor
 590S Fair silt (130 p.f. 589)
 591L-594L Organic Poor
 595SP Good silt (86 p.f. 594)

596 L Good soil
597L-5982 Fair soil
5995 Good silt
600L-601L Fair soil

Map Sheet 116B-10

June 22

602SP Fair silt
603 L Partly organic
604L Fair soil
605SP Fair silt
606L-609L Talus. Fair soil
610SP Fair silt
611L-614L Talus.
615SP Good silt
616L-618L Slump. Fair soil
619S-620S Good silt
621L Mossey
622SP Good silt
623L-626L Part organic
627L Organic. Very poor
62P
629SP Good silt (71 p.f. 628)

630L-633L Some organic. Fair
634SP Fair silt
635L
636L Good soil (new line)
637L-645L. Mossey. Some organic. Fair
646S Dry chert
647SP Good silt (top. f. 646)
648 O.K.
649L-650L Organic. Poor

Map Sheet 116C-10

June 23

651L-652L Fair soil
653L Organic. Very poor
654L " "
655L Good soil
656L Fair soil
657L There's no soil here. Organic
658L Absolute garbage. Frozen organic
659L Poor
660S Partly organic
661L O.K.
662L Very poor. Organic
663L " " Garbage

664L O.K. (85 p.p. 663)
665L O.K.
666L-668L O.K.
669L Fair soil (new line)
670L-672L Fair soil
673SP Fair silt
674L-678L Some organic Fair
679SP Fair silt
680 Fair soil
684L Fair soil (110 p.p. 683)
685L-687L Fair soil
688L Fair soil (end line)
689L-693L Fair soil

Map Sheet 1168-12

June 24

694L-703L Good soil
704L Fair soil (500 ft along line)
705SP O.K.
706L O.K.
707S O.K. (big ch.)
711SP Fair
712-715L Fair
716SP Fair (90 p.p.)
717L-719L Fair

PACIFIC
WATER

Mining Transit Book

FILER NO. 521

RYSD

720 →

2009

Map Sheet 116A-9

June 27

720-722L	Good soil	
723 SP	Good silt	
724 SP	"	" (65 pt. 723)
725 SP	"	" (75 pt. 724)
726 SP	"	" (88 pt. 725)
727 SP	"	"
728L-729L		
730 SP		(92 pt. 729)
731L		
732 SP		
733L-739L		
740 SP		
741L-744L		
745 S		
765 SP		
766 S		
767L-		
771L	Fair soil	
772		
785 S	86. 84 87. 83	(big ck.)
786L-792L	Talus	

Map Sheet 116A-9 June 28

792L-794L	Good soil
795L	Fair soil
796L-798L	Fair soil
799L	Talus
800S	Good silt
801L	Sandy
802L-809L	Fair soil
810S	Good silt
811L-817L	Fair soil
818SP	Fair silt (70 p.f. 817)
819L	
820SP	Poor silt (60 p.f. 819)
821L	
822SP	Part organic (35 p.f. 821)
823L	Good soil
824SP	Good silt
825SP	" " (60 p.f. 824)
826L-831L	Fair soil
832S	Fair silt
833L-837L	Good soil
838L-845L	Talus, Fair
846S	Fair
847L	Fair Talus
848L	Part organic Talus
849L-851L	

Map Sheet 116A-9

June 29

852L	Fair soil	
853SP	Fair silt	
854L	Fair soil	
855L	Part Organic	Poor
856L	Part Organic	Fair (126 p.f. 855)
857S	Good silt	(56 p.f. 856)
858L	Part organic	
859L	Good soil	(bottom new line)
860-861L	Fair soil	Talus
862S	Good silt	
863L	Good soil	Talus
864L	Slightly organic	Talus
865L	Fair soil	Talus
866L	Organic	Very poor
867L	"	"
868SP	Very poor, organic	
869L	Talus	Poor
870S	Organic	Very poor
871L	Talus	Poor
872L-877L	Talus	Fair to Poor
878L-883L	"	"
884S	Good silt	
885L	Talus	
886SP	Good silt	(69 p.f. 885)
887L		

888 S	} Good silt		
889 S			
890 SP	Good silt, Below vein.	Almost	
	Gossany		
891	Fair soil		
892 SP	Good silt		
893 SP	"	(55 p.f. 892)	
894 S	Good silt		
895 S	Fair silt		
896 L			
897 SP	Dry seepage		
898 SP			
899 S	Big ck.		
900 L-901 L	Grassy	Fair soil	
902 SP	Fair silt		
903 L-905 L			

Castle Ridge

Map Sheet 106D-6

June 30

906 L-907 L	Good soil (Grassy)	
908 SP	Organic. Very poor	
909 L		
910 L	Part organic	
911 L-912 L	Fair soil	
913 S	Good silt	(68 p.f. 912)
914 L	Part organic. Poor	
915 L-918 L	Fair soil	
919 S	Good silt	
920 L-921 L	Good soil	Talus
922 SP	Fair silt	
923 L	Talus. Poor	
924 L-927 L	Talus. Fair to poor	927 (2 p.f. 925)
928 S	Poor silt	
929 L-933	Part organic. Poor	
934 L	Organic. Very poor	
935 L-936 L		
937 S (3 p.f.)	Small Good silt	(Big ck)
939 S	Good silt	
939 L-945 L	Fair soil. Some organic	
946 L	Organic. Very poor	
947 L	"	" (on the corner)
948 L-955 L	Organic. Garbage. Very poor	
956 L	O.K.	

Castle Ridge

Map Sheet 106D-6

July 3

957L-964L	Good soil	
965SP	Fair silt	(12 p.f. 964)
966SP	Good silt	(70 p.f. 965)
967SP		(60 p.f. 966)
968L-970L	Good soil	
971L		
972S	Fair silt	
973L-976L	Good soil	
977SP	Good silt	
978L		
979SP	Good silt	(40 p.f. 978)
980L-981L		
982L		(new line)
983L-996L		
997L		(new line)
998L	Soil very poor, in Organic	
999L		
1004	Soil poor Organic	
1005-1010	Some organic	
1011L	Poor Organic	(New line)
1012L-1013L	Organic Poor	
1014L	Organic Very poor	
1015L-1023L	Organic (Partly) Fairly poor	

Castle Ridge

Map Sheet 106D

106D-12/106D-11

106D-5/106D-6

July 5

1024SP	Fair silt	
1025L-1030L	Fair soil	Some organic
1031S	Good silt	
1032L	Fair	
1033L	Poor Organic	
1034L	Good soil	
1035-1043L	Fair	Some organic
1044L	Poor	Organic
1045L-1047L	Fair	Little organic
1048L-1050L	Poor	Organic
1051L-1054L	O.K.	
1055L-1057L	Fair soil	
1058L	Poor organic	
1059S	Fair silt	(50 p.f. 1058)
1060	Good soil	
1062L	Organic	Very poor
1063L-1066L	Fair	Some organic
1067L	Organic	Very poor
1068L	Fair soil	
1069S	Good silt	Dry (70 p.f. 1068)
1070L-1074L	Fair soil	
1075SP	Poor silt	
1076L	Fair soil	

Castle Ridge

Map Sheet 106D-12

July 7

1077L-1080L	Good soil
1081-1087L	Good soil
1088L-1089L	Some organic.
1090L-1096L	Some organic. Fair
1097L-1107L	Fair soil
1108 SP	Good silt
1109	Good soil
1110L	Poor soil. Organic.
1111L-1113L	Fair. Some organic.
1114L-1118L	Talus. Fair to poor
1119 SP	Good silt (60 p.f. 1118)
1120-1123 L	Fair. Some organic.
1124L-1128L	Organic. Poor
1129L	Organic. Very poor
1130L-1131L	Talus. Good soil
1132L-1133L	Good soil

Castle Ridge

Map Sheet 106D-12 July 8

1134L-1138L	Fair soil
1139L	Organic. Poor
1140 L	" "
1141-1146L	" "
1147 SP	Good silt (27 p.f. 1146)
1148L-1149L	Organic. Poor
1150L	Organic. Garbage. Very poor
1151L	" "
1152L	Fair soil
1153L-1154L	Organic. Poor
1155L	Fair soil
1156L	Fair soil
1157 SP	Good silt (45 p.f. 1156)
1158L-1160L	Organic. Poor
1161L-1162L	Fair soil
1163L-1166L	Good soil
1167L	Organic. Poor
1168 SP	Good silt
1169	Poor Organic.
1170L	Grade A. Good stuff
1171L-1173L	Organic. Poor
1174-1178	Fair soil
1179L-1180L	Organic. Poor

July 9

1181 L	Good soil	
1182L-1183L	Good soil	
1184 SP	Good silt	(50 p.f. 1183)
1185 SP	" "	(56 p.f. 1184)
1186 L	Good soil	
1187 SP	Good silt	(37 p.f. 1186)
1188L-1190L	Good soil	
1191 S	Good silt	(50 p.f. 1190)
1192 L	Good soil	
1193 SP	Good silt	
1194L-1198L	Good soil	
1199L-1202L	Good soil	
1203 S	Good silt	(60 p.f. 1202)
1204L-1206L	Good soil	
1207 SP	Good silt	(40 p.f. 1206)
1208 L	Good soil	
1209 S	Good silt	(67 p.f. 1208)
1210 L-1211L	Good soil	
1212 SP	Good silt	(33 p.f. 1211)
1213 SP	" "	(80 p.f.)
1214 L	Fair soil	
1215 SP	Good silt	(80 p.f.)
1216 SP	" "	
1217 SP	" "	

1218 L	Poor. Organic	
1219 L	Fair soil	
1223 S	Good silt (70 p.f.)	
1224L-1225L	Fair to Poor soil	
1226L-1227L	Fair soil	
1228 S	Good silt (70 p.f.) (logged)	
1229L-1230L	Poor. Part organic.	
1231 SP	Good silt (77 p.f.)	
1232L-1234L	Some organic. Fair	

Castle Ridge

Map Sheet 106D-11 July 10

1235L-1236L	Fair soil	
1237L-1239L	Fair soil	
1240 SP	Good silt	(46 p.f.)
1241L-1244L	Fair soil	
1245 L	Talus. Good soil	
1246 L	Fair soil	
1247 SP	Good silt	(40 p.f.)
1248L-1249L	Fair soil	
1250 SP	Good silt	(75 p.f.)
1251 SP		(48 p.f.)
1252L-1255L	Fair soil	
1256 SP	Good silt	(65 p.f.)
1257 SP	Fair silt	(50 p.f.)
1258 L	Fair soil	
1259	" "	
1261 SP	Good silt	(88 p.f.)
1262S-1263S	Good silt	
1264L-1268L	Good soil	
1269 SP	Good silt	
1270L-1272L	Good soil	
1273 SP	Good silt	(80 p.f.)
1274 SP	" "	(80 p.f.)
1275 SP	" "	
1276 SP	" "	(85 p.f.)

1277-1283L	Good soil	
1284 SP	Fair silt	(30 p.f.)
1285 L	Good soil	
1286L-1288L	" "	
1289S	Dry ck.	(30 p.f.)
1290L	Good soil	
1291 SP	Good silt	(86 p.f.)
1292-1293L	Good soil	
1294 SP	Good silt	(75 p.f.)
1295 SP	Fair silt	(66 p.f.)
1296 SP	" "	(67 p.f.)
1297 L	Good soil	

Map Sheet 106 D-11

July 4

1298L-1302L	Poor. Part organic.	
1303L	Organic. Very poor	
1304L-1306L	Poor Some organic	
1307L	Fair soil	
1308-	" "	
1314-1316	Talus. Fair	
1317 SP	Good silt	(80 p.f.)
1318 SP	" "	(60 p.f.)
1319L-1320L	Talus. Poor	
1321 SP	Goodsilt	(75 p.f.)
1322L	Talus. Poor	
1323 SP	Goodsilt	(50 p.f.)
1324 SP	" "	
1325 SP	" "	(66 p.f.)
1326L-1327L	Fair	
1328 SP	Fair silt	(76 p.f.)
1329 SP	Good	
1330 SP	Good	(66 p.f.)
1331 SP		(85 p.f.)
1332L	Fair	
1333 SP	Fair	(50 p.f.)
1334L	Fair	
1335 SP	Good	
1336 SP	Good	

1337 SP		
1338L-1344L	Fair soil	
1345L	Organic. Very, very poor	
1346L	Fair	
1347L	Good	
1348 SP	Dry Good. (50 p.f.)	
1349L	Organic. Very very poor	
1350L-1352L	Organic. Poor.	
1353L-1357L	Fair	
1358 SP	Fair silt	(12 p.f.)
1359L	Fair	
1360 SP	Good	(55 p.f.)

Castle Ridge

Map Sheet	106D-6	July 12
1361L	Fair soil	
1362SP	Fair soil	(6sp.f.)
1363L	Fair	
1364SP	" "	(7sp.f.)
1365L-1370L	Fair	
1371L	Poor Organic	
1372L-1374L	Fair	
1373L	Poor Organic	
1376L-1379L	" "	
1380L	Talus Fair	
1381L-1383L	Poor Organic	
1384SP	Dry Good	
1385SP	Fair	(50p.f.)
1386L-1389L	Very poor Organic	
1390L	(Good soil)	
1391	Poor Organic	
1393L	Fair	
1394L	Fair	

Map Sheet	106D-5412	July 14
1395 SP	Fair	
1396L	Good	
1397SP	Fair	(50p.f.)
1398L-1401L	Good	
1402S	Good	Big ck. (50p.f.)
1403L-1406L	Fair	
1407S	Dry ck.	(38p.f.)
1408L-1419L	Fair soil	
1420SP	Fair	(20p.f.)
1421L-1423L	Fair	
1424S	Poor	
1425L-1431L	Fair	
1432SP	Good silt	
1433 SP	" "	(36p.f.)
1434 SP	" "	(50p.f.)
1435 SP	" "	(50p.f.)
1436 SP	" "	(36p.f.)
1437 SP	" "	(90p.f.)
1438 SP	" "	(90p.f.)

Map Sheet 106D-7

July 15

1439L-1443L	Good soil	
1444SP	Good silt	
1445-1448L	Good	
1449R	Rusty chloritic schist	
	Small view. Found piece of hydro-zincite here in ch.	
1450L-1463L	Fair	
1464J	Fair. Dry ch.	
1465L-1467L	Good.	
1468L	Poor. Organic.	
1469L-1472L	Fair	
1473SP	Good	(30 p.f.)
1474L-1476L	Fair	
1477L-T	Poor. Organic.	
1480-1495L	Fair soil.	
1496-1517L	Fair	
1518-	44 ch.	
1521SP	Fair	(76 p.f.)
1522SP	Good	(36 p.f.)
1523SP	Fair	(58 p.f.)
1524L	Fair	
1525SP	Fair	

Map Sheet 106A-11

July 16

1526L-1530L	Fair soil	
1531SP	Part Organic.	
1532L-1533L	Fair	
1534SP	Fair	(93 p.f.)
1535L-1541L	Fair	
1542G	Gossan	(76 p.f.)
1543L	Fair	
1544L-1548L	Organic. Very poor (end line)	
1546L-1548L	Fair	(new line)
1549L	Organic. Poor	
1550L-1553L	Fair	
1554SP	Fair	(90 p.f.)
1555L-1556L	" "	
1557SP	Fair	(4 p.f.)
1558SP	Fair	(80 p.f.)
1559SP	Fair	(75 p.f.)
1560L-1561L	Fair	
1562SP	Fair	(50 p.f.)
1563L	" "	
1564SP	" "	
1565L-1566L	Fair	

Map Sheet 106A-9

July 17

1567SP	Fair	
1568SP	Fair	(90p.f.)
1569L	Fair	Rock frag.
1570-1581L	Fair soil	
1582	Fair	
1583S	Fair	(30p.f.)
1584L	Talus, Poor	
1585L-1591L	Talus, Poor to Fair	

UNO CLAIM GROUP

July 18

1592L	4	1 Gold pan
1593L		
1594SP		(20p.f.)
1595L		
1596SP		(20p.f.)
1597L	4	2 Gold pan
1598		
1601L	4	3 Gold pan
1602-4L		
2000ft down	4	Gold pan
2000ft. down	5	Gold Pan

PBS CLAIM GROUP July 18

1605-1606L	Good	
1607-1614L	Fair	
1615 S	Good	
1616-1623L	Fair	
1624SP	Good	(62 p.f.)
1625L-1626L	Fair	
1627E-1630L	Slump	
1643-44L	Organic, Poor	
1645L-1651L		
1652 SP		(30 p.f.)
1653-1658	Fair	
1659 SP		(68 p.f.)
1660L-1662L	Fair	

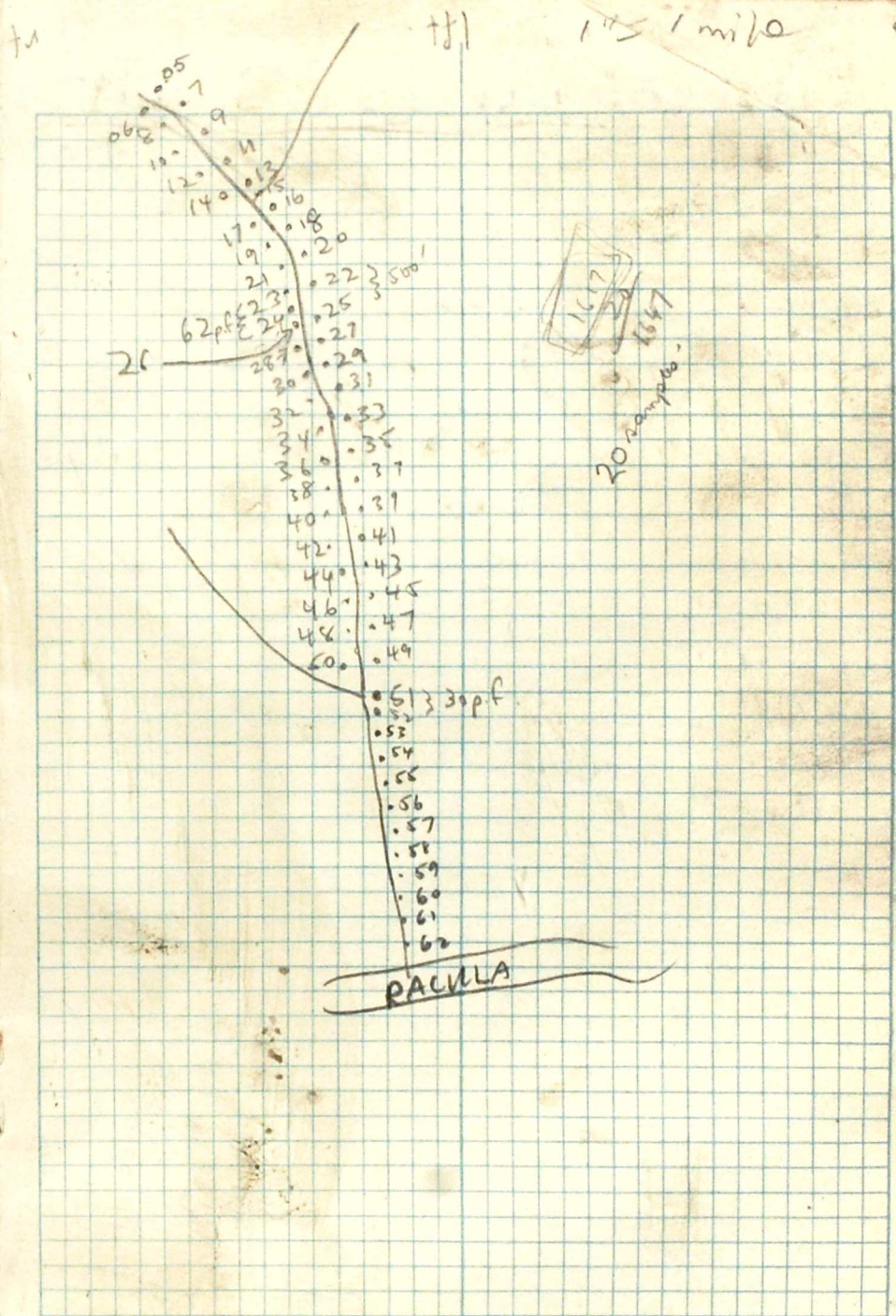

Map sheet 106C-13

July 25

1663L	} Good	
1664SP		(21 p.f.)
1665L		Talus
1666SP	Good	(71 p.f.)
1667L		Talus
1668SP	Good	(25 p.f.)
1669L		Talus
1670SP	Good	(25 p.f.)
1671L-1673L		Talus
1674SP		Dry ck.
1675L-1678L		Partial Talus
1679S		Dry ck.
1680		
1681S		Rusty ck.
1682L-1865L		Fair
1686S-1687S		Fair silt
1688		
1693SP		Dry
1694L-1702L		Fair to Good soil
1703-1709L		Talus
1710SP		Good silt
1711L-1717L		
1718 SP		Dry

1719L-1731L	Fair	(end line)
1732SP	Fair	(550 p.f.)
1733 SP	Dry	(350 p.f.?)
1734SP		(43 p.f.)
1735SP	Very small	(342 p.f.)
1736S		(433 p.f.)

943
~~442~~
~~433~~

171875=
1718
5
8590
2160

25
1750

Map Sheet 106C-13

July 26

1737L-1739L	Good	
1740 SP	Good	
1741 SP	" "	(36 p.f.)
1742 SP	" "	(54 p.f.)
1743L	Not good sample	
1744 SP		(120 p.f.)
1745L-1754L	Talus	
1755 SP		(54 p.f.)
1756		
1759S	Dry cl.	
1760L-1766L	Talus	
1767 SP		(70 p.f.)
1768L-1789L	Talus	
1790 SP		48 p.f.)
1791L-1819L	Talus	
1820 SP		(80 p.f.)
1827 SP		(71 p.f.)
1828L	Talus	
1829 SP	Junction of cks.	(60 p.f.)
1833 SP		(58 p.f.)
1834L	Talus	
1835L	Talus	(26 p.f.)
1836L		
1837 SP		(36 p.f.)

1841 SP

(41 p.f.)

1846 SP

(84 p.f.)

Map Sheet 106C-13

July 27

18475P

1861 SP

1870 SP

1874 SP

1875

1876 SP

1877

1885 SP

1896 SP

1897 SP

1908 S

1915 G

1920 SP

1921

1923 SP

1926 SP

(32 p.f.)

(42 p.f.)

(50 p.f.)

by other little
(62 p.f.)⁵ k.

Dry ck. (bottom) (57 p.f.)

Very Small Gossan (62 p.f.)

Dry ck.

Big ck

2900
Σ
145

1938 SP

1942 S

1943 S

1944 S

1945 S

1946 SP

1947 S

1948 SP

1949 SP

Dry

of 700 pages

(32 p.f.)

(585 p.f.)

(350 p.f.)

(139 p.f.)

(240 p.f.)

(82 p.f.)

(60 p.f.)

(30 p.f.)

(550 p.f.)

2452
DOUG DAVID

PACIFIC
WATERPROOF

Book 3

Mining Transit Book

FILLER No. 321

~~RECEIVED~~

RK5D

RI5D

RH5D

Aug. 3

KIWI

Column
for
Smithsonite
in
float

L4W

1S }
2S } Good
3S }
4S } Some organic

Grassy

12S	Talus	Smithsonite in float	✓
13S	Talus		✓
14S	Talus		✓
15S	Talus		✓
16S	Talus		✓
17S	Talus		✓
18S	Talus		✓
19S	Talus	cat 1950, on line 550	✓
20S	Poor	Part organic. Talus	✓
21S	Talus		✓
22S	Talus		✓
23S	Poor	Talus	✓
24S	Talus		✓
25S	Talus		✓
26S	Poor	Grassy	✓

275	} Grassy	
285		
295	} Grassy	
305		
315	Grassy poor	
325	Grassy. poor	
335	Poor	
345	Poor	
355	Fair	
365	} Poor	
375		

L 8 W

395	} Poor. Partly organic	
385		
375		
365	Fair	
355	Fair	
345	Fair	
335	Good	
325	Fair	Talus
315	Fair	Talus
305	Fair	Talus
295	Talus	

✓

285	Talus		✓
275	Talus. Poor		✓
265	Talus		✓
255	Talus		✓
245	Talus		✓
235	Talus		✓
225	Talus		✓
215	Talus. No Sample		✓ (lots)
205	End up 10w, go down to 8w	(Sample on 8w, poor)	✓
195	Talus		✓
185	Talus		✓
175	Talus		✓
165	Talus		✓
155	Talus		✓
145	Talus		✓
135	Talus		✓
125	Talus		✓
115	Talus		✓
105	Talus		✓
95	Talus		✓
85	Talus		✓
75	Talus		✓
65	Talus		✓
55	Talus		✓
45	Carried by stream		✓

		Smith- sonite
35	Talus	✓
25	Talus	✓
15	Grassy	✓
BLO 8W	Grassy	✓
<u>L12W</u>		
BLO	Talus	
15	Talus	✓?
25	Talus	✓
35	Talus	✓
45	Talus	✓
55	Talus	✓
65	Talus	✓
75	Talus	✓
85	Talus	✓
95	" "	✓
105	" "	✓
115	" " Poor, Part organic	✓
125	" "	✓
135	" "	✓
145	" "	✓ (lots)
155	" "	✓
165	" "	✓

		Smith- sonite
175	Talus	✓
185	Talus	✓
195	No sample Much smith.	✓
205	Talus Much smith.	✓
215	Talus	✓
225	Talus	✓
235	Talus. Poor Part organic	✓
245	Talus	
255	Talus Poor Part org.	
265	Talus Poor Part org.	
275	" " " "	
285	" " " "	
295	No Sample Talus	
305	Talus	
315	Talus	
325	No Sample	
335	Talus	
345	No sample	
355	Very poor. Organic,	✓
365	Very poor Organic	
375	Fair	✓
385	Poor. Part org.	✓
395	" "	
405	Fair	

K1W1

Aug. 4

Smithsonite

L16W

BLO	No sample		
15	Talus		✓
25	" "		✓
35	" "		✓
45	" "		✓
55	" "		✓
65	" "		✓
75	" "		✓ (lots)
85	No sample		✓ (lots)
95	Talus	Smith in outcrop	✓
105	No sample		✓ (lots)
115	Talus		✓ } Smith
125	Talus		✓ } Smith
135	" "		✓
145	" "	taken below smith.	✓
		outcrop or sub outcrop	
155	Talus		very little
165	Talus.	Poor organic	" "
175	Talus.	Poor org. 100' above main showing	✓
		30' south is sub-outcrop or outcrop of smith	
185	Talus		✓

195	Talus.	Smith outcrop	✓
205	(taken at real L16W		✓
215	Talus		✓
225	Silt		✓
235	Poor	Organic. Grassy.	
245	Talus		✓
255	Talus		✓
265	" "		✓
275	" "		✓
285	No sample		✓
295	Poor	} Part org.	✓
305	Poor		✓
315	Poor	part org.	✓
325	} Talus. Poor. part org.		✓
335			✓
345			✓
355		} Poor. Mostly organic	
365			
375	Fair		
385	} Poor. Part org.		
395			
405			
415			

Row

425	Fair	
415	Poor. Organic (much))
405	ll)
395	ll)
385	ll)
375	ll)
365	ll)
355	ll)
345	ll)
335	ll)
325	ll)
315	ll)
305	Poor. Partorganic.	
295	poor org	
285	Talus Poor org	
275	Talus	
265	Talus	
255	Talus	
245	No Sample	
235	Talus	
225	Talus	
215	Talus	
205	(taken at real? Row not 23w)	✓
195	Talus	✓?

185	Talus	✓
175	Talus	
165	Talus	
155	Talus	✓
145	Talus	
135	No sample	
125	Talus.	✓ little
115	Talus	✓
105	ll ll	✓
95	ll ll	✓
85	ll ll	✓
75	No sample	✓
65	Talus	✓
55	No sample	✓
45	Talus	✓
35	ll ll	✓
25	ll ll	✓
15	No sample	✓
0	No sample	✓

L24W

Smith -
sonite

Smith
-sonite

BLO	Talus		✓
15	Talus		?
25	Talus		
35	Talus		
45	Talus		
55	No Sample		
65	No Sample		
75	Talus		
85	" "		
95	" "		
105	" "		
115	" "		
125	Water Transported.	Talus	
135	Talus		
145	Talus		
155	Part. Org.	Poor Talus	
165	"	"	
175	"	"	
185	"	"	
195	Talus	Fair soil	
205	Talus		
215	" "		
225	" "		

235	Talus		
245	Talus		
255	No sample	} Talus	
265	No sample		
275	Talus		
285	Organic	Poor	
295	"	"	
305	"	"	
315	"	"	
325	"	"	
335	"	"	
345	"	"	
355	"	"	
365	Very poor	"	
375	"	"	
385	} Poor . Organic (Garbage)		
395			
405			
415			
425			

Kiw

Aug. 5

Smith-sonite

Smith-sonite

L28W

BLO

15	Talus
25	Talus
35	No sample
45	Talus
55	" "
65	" "
75	" "
85	" "
95	Talus
105	} Poor soil
115	
125	
135	Talus
145	Talus, Poor
155	Poor.
165	Talus
175	Talus
185	} Talus. Fair to Poor
195	
205	
215	
225	
235	

✓

245	} Talus Fair to Poor
255	
265	
275	No Sample
285	} Talus. Fair to Poor
295	
305	
315	
325	
335	
345	Organic Poor
355	} Organic. Poor
365	
375	
385	
395	} Very poor. Organic
405	
415	
425	
435	

L32W

Smith-
sonite

435	}	Poor, Organic	
425			
415			
405			
395			
385	}	Fair	
375			
365	}	Poor	
355			
345			
335			
325	Fair		
315	}	Poor	
305			
295			
285			
275	Fair	Talus	
265	" "	Talus	
255	" "	Talus	
245	Talus.	Good soil	
235	Talus.	Good soil	
225	Talus		
215	" "		
205	" "		

Smith-
sonite

195	Talus	
185	" "	
175	" "	
165	" "	
155	" "	
145	" "	
135	" "	
125	Poor	
115	Talus, Fair	
105	Poor	
95	Talus Fair	
85	Poor	
75	Talus	
65	No Sample	
55	Talus	
45	No Sample	
35	Talus	
25	Talus	
15	No Sample	
BLO	Talus	

✓
✓
✓

KIWI

Aug. 6

Smith
-sonite

L40W

BLO Talus (Galena) ✓

15	} Talus	
25		
35		
45		
55	Talus	
65	Poor Organic	
75	Talus	
85	Talus	
95	No Sample	
105	Fair	
115	} Part organic	
125		
135		
145		
155	No Sample	} Huge Talus
165	No Sample	
175	No Sample	
185	Talus	
195	" "	
205	" "	
215	No sample	
225	Part org.	
235	Talus	

245	Talus	
255	Talus	
265	Talus	
275	Talus	
285	} Talus	
295		
305		
315		
325	No sample	
335	} Talus	
345		
355	No Sample	
365	} Talus	
375		
385		
395		
405		
415	Organic. Poor	
425		
435	} Fair soil	
445		
455		
465		

L44W

465 Organic. Very poor

455

445 } Poor organic

435

425 Fair

415

405

395

385

375

365

355

Talus. Fair to good

345

335

325

315

305

295

285

Probably water transported

275

265

255

245

Talus

235

225

Smith
- soil e

215

205

Talus

195

185

175

No sample

165

155

Talus

145

135

125

Poor. Organic

115

Probably water transported

105

95

85

75

65

Talus. Fairly good soil

55

45

35

25

15

10

5

L48W

Smith
son

13L0 }
 15 } Talus
 25 }
 35 }
 43 }
 55 } Talus
 65 }
 75 }
 85 Part org
 95 Talus
 103 }
 115 } Poor Part org
 125 }
 135 }
 145 }
 155 } Talus. Fair soil
 165 }
 175 }
 185 }
 195 No such animal
 205 }
 215 }
 225 } Grassy Fair soil
 235 }

✓
 ✓
 ✓

245 }
 255 }
 265 } Grassy. Fair soil
 275 }
 285 }
 295 }
 305 } Talus. Fair soil
 315 }
 325 }
 335 } Organic. Poor
 345 }
 355 }
 365 }
 375 }
 385 } Fair soil
 395 }
 405 }
 415 }
 425 }
 435 }
 445 }
 455 }
 465 }

K1W)

AUG 8

L52W

405

395

385

375

365

355

345

335

325

315

305

295

285

275

265

255

245

235

225

215

205

195

185

175

} Rock fragments.
Mossey

} Rock fragments
Mossey
Fair to good soil

} Talus

} Mossey
Rock frag.

165

155

145

135

125

115

105

95

85

75

65

55

45

35

25

15

B10

} Mossey.
Rock Frag.

} Part organic

ll "

ll "

} Mossey

} Mossey.
Rock frag.

} Part org.

} Part org.

} Talus

} taken at BLO 52W

} No such thing

L56W

BLO

15

25

35

45

55

65

75

85

95

105

115

125

135

145

155

165

175

185

195

205

215

235

255

All by creek bank
Values influenced by creeks

Taken at 2nd (another baseline)

} No such things

} Creek influence

275

295

315

335

355

375

395

415

435

455

475

495

} creek influence

- influence of other mtn.

Part org.

} Good soil / Mossey hill

L D W

36 S

35 S

34 S

33 S

32 S

31 S

30 S

29 S

28 S

27 S

26 S

25 S

24 S

23 S

22 S

21 S

20 S

19 S

17 S

15 S

13 S

11 S

9 S

7 S

Poor

Fair to poor

Organic Very poor

Parting

" "

" "

" "

5 S

3 S

1 S

Part org

Note: Samples marked "Talus" were usually sandy material looking like decomposed dolomite

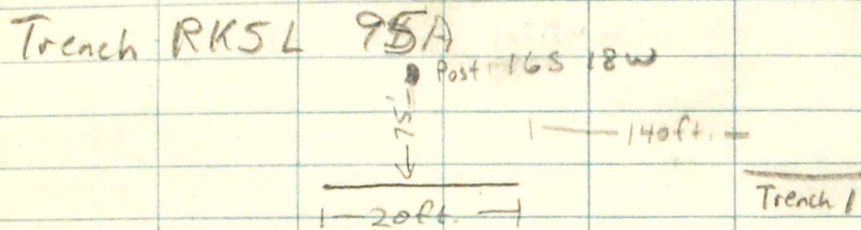

RKSL 96A along bedding } increek
 RKSL 97A across } below No 1
 trench. By
 claim posts

Massive dolomite with smith. in
 fractures

Trench "I" (located 80' east
 of 12W 16S on grid)

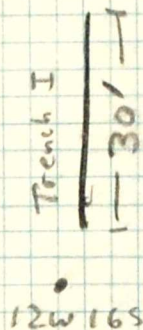

Samples RKSL 98A
 RKSL 99A

Descrip. Massive dolomite with
 smithsonite in fractures. Occasional
 massive smithsonite

ID contour linesAug. 18

R15D

2010-2011L Fair soil

2012L Good soil

2013SP Good silt

(16 p.f.)

2014L-2018L Talus

2019L Poor sample

2020L-2032L Talus

2033L Below showing

2034L-2036L Talus

2037S Dry ck.

2038L-2039L Talus

2040S Almost dry

(10 p.f.)

2041L-2052L Talus

2053L-2059L Talus

HOT contour linesAug. 19

RH5D

2060L-2067L Talus

2068SP Dry ck.

(80 p.f.)

2069L

2070L } Talus

(66 p.f.)

2071L-2072L Talus

(120 p.f.)

2073L-2074L Talus

(54 p.f.)

2075L Talus

(140 p.f.)

2076L " "

(54 p.f.)

2077L " "

(100 p.f.)

2078L-2083L " "

2084L Talus

(60 p.f.)

2085L " "

(66 p.f.)

2086L " "

(50 p.f.)

2087L " "

(60 p.f.)

2088L " "

(114 p.f.)

2089L-2095L Talus

(50 p.f.)

2096L " "

2097L-2105L Talus

2106L " "

(53 p.f.)

2107L " "

(50 p.f.)

2108L-2109L Talus

2110L " "

(93 p.f.)

Aug. 20

HOT contour lines

2111 L Talus
 2112 L " " (59 p.f.)
 2113 L Poor soil Talus
 2114 L Talus (50 p.f.)
 2115 L " " (133 p.f.)
 2116 L Talus. Smithsonite in float (45 p.f.)
 2117 L Talus
 2118 L " " (80 p.f.)
 2119 L Talus
 2120 Talus. Smithsonite in float
 2121 L Talus
 2122 " "
 2123 L " " (60 p.f.)
 2124 L " " (48 p.f.)
 2125 L - 2129 L " "
 2130 L " " (60 p.f.)
 2131 L " " (52 p.f.)
 2132 L - 2135 L " "
 2136 L - 2146 L " "
 2147 L " " (60 p.f.)
 2148 L - 2152 L " "
 2153 S Good silt (30 p.f.)
 2154 L - 2155 L Talus

2156 L - 2200 L Talus
 2201 - 2346 Talus

Mostly sandy soil. Nothing out of ordinary.

$$\begin{array}{r} 2346 \\ 2156 \\ \hline 19041 = 191 \end{array}$$

2	3	4	5	6	7	8
9	10	11	12	13	14	15
				20	21	22
				27	28	29

Sat	Sun	Mon	Tues	Wed	Thurs	Fri
				30	31	1
				Lv Frehill	Heart Break	Left Dawson
2	3	4	5	6	7	8
tent day	1st day work					tent day chopper
9	10	11	12	13	14	15
Glen	tent day	trench I finished				
16	17	18	19	20	21	22
	Move to Hot & Id	1st day work	contour on Hot			
23	24	25	26	27	28	29
					leave Dawson	leave Whitehorse
30	31	1	2	3	4	5
6	7	8				

RYSD 2009 last sample