

019594

CALCULATED SURVEY DATA

SET-UP STATION = 3041 HI = 1.360 H.EDM = 1.360 Location = 6437.753 N 2559.089 E 1291.773 E1.
 BACKSIGHT STATION = 1462 Reference Horizontal Angle = 000-00-00 Location = 5503.329 N 4814.980 E 1581.978 E1.
 Reference Backsight Azimuth = 112-30-00

Comments =
 Instrument = TOTAL STATION

Bench Type	Line Shot No.	Horiz. Angle	Zenith Angle	Horiz. Distance	Shot Azimuth	Vertical Distance	Height Target	Height Boost	Offset T	Coordinates		
										Dist.	Northing	Easting
1288 19	1	269-15-46	090-42-08	91.338	021-45-46	-1.119	1.490	0.000	0.0	6522.581	2592.954	1290.524
1288 19	2	268-34-34	090-19-08	130.545	021-04-34	-0.725	1.490	0.000	L 9.0	6562.802	2597.637	1290.917
1288 19	3	272-33-23	089-52-18	166.659	025-03-23	0.375	1.490	0.000	L 0.0	6588.728	2629.671	1292.018
1288 19	4	271-31-18	089-33-38	170.818	024-01-18	1.312	1.490	0.000	L 12.0	6598.662	2617.666	1292.955
1288 19	5	286-19-51	089-14-46	216.068	038-49-51	2.846	1.490	0.000	0.0	6606.070	2694.569	1294.489
1288 19	6	291-27-45	089-46-47	258.284	043-57-45	0.997	1.490	0.000	0.0	6623.664	2738.387	1292.640
1288 19	7	313-16-06	091-51-56	325.697	065-46-06	-10.601	1.490	0.000	0.0	6571.427	2856.090	1281.041

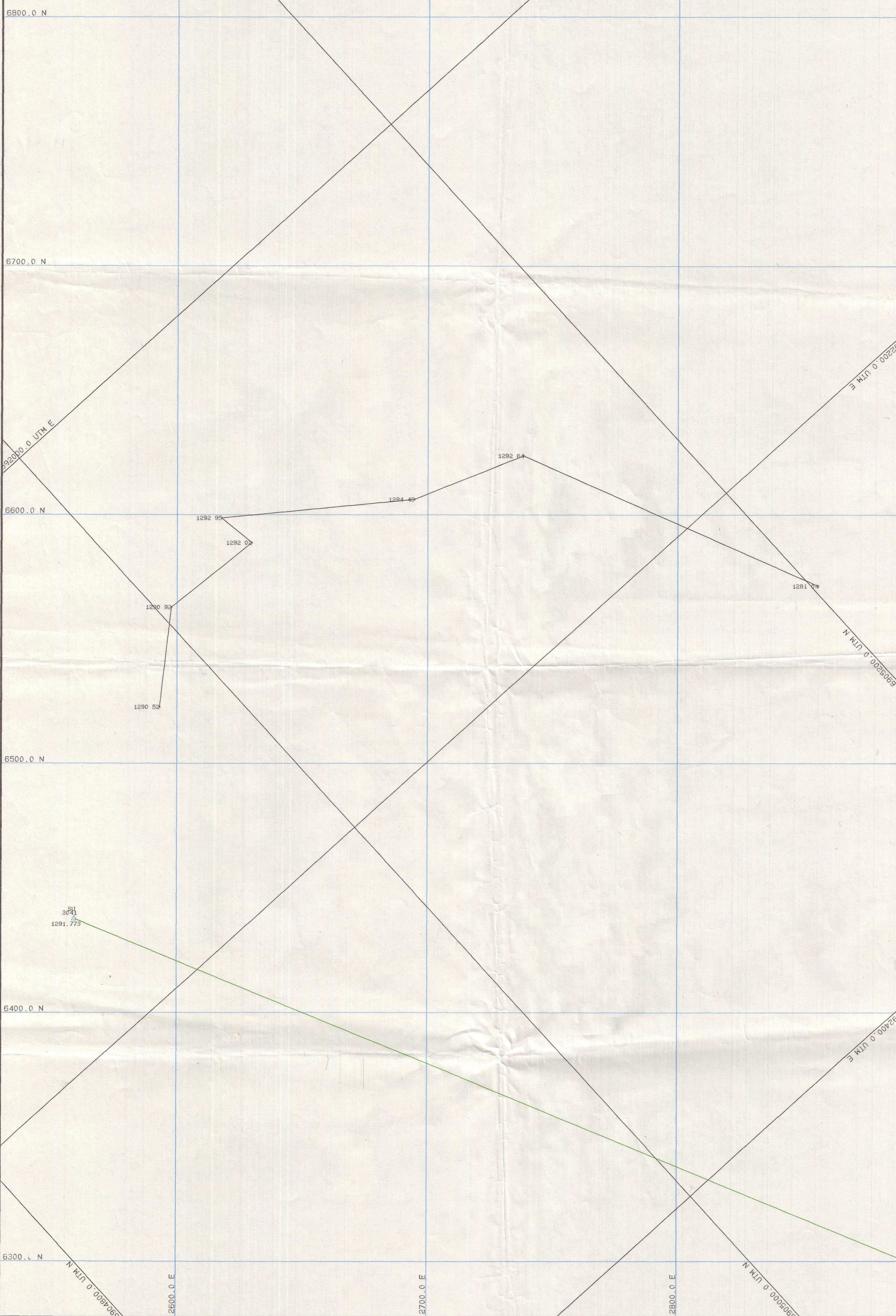

QUICK-PLOT GEMCOM Services Inc.	DATE = 30-08-90 TIME = 09:35:18	Curragh Resources Faro Mine Site
HORIZONTAL SCALE = 1 : 1000		VERTICAL SCALE = 1 : 1000

Setup Plot