

NOTICE

THIS MAP IS ISSUED AS A PRELIMINARY GUIDE FOR WHICH THE DEPARTMENT OF INDIAN AFFAIRS AND NORTHERN DEVELOPMENT WILL ACCEPT NO RESPONSIBILITY FOR ANY ERRORS, INACCURACIES OR OMISSIONS WHATSOEVER.

Canadian Coal Areas

SHEET 115-H-16

LATITUDE 61°45' To 62°00'
LONGITUDE 136°00' To 136°30'

MOUNT MORRISON

CANADA
DEPARTMENT OF NORTHERN AFFAIRS AND NATIONAL RESOURCES
NORTHERN ADMINISTRATION BRANCH
RESOURCES DIVISION

SCALE: 1/2 MILE TO 1 INCH

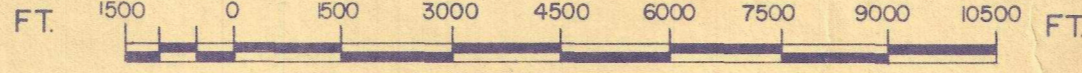

ISSUED UNDER THE AUTHORITY OF THE MINISTER OF NORTHERN AFFAIRS AND NATIONAL RESOURCES

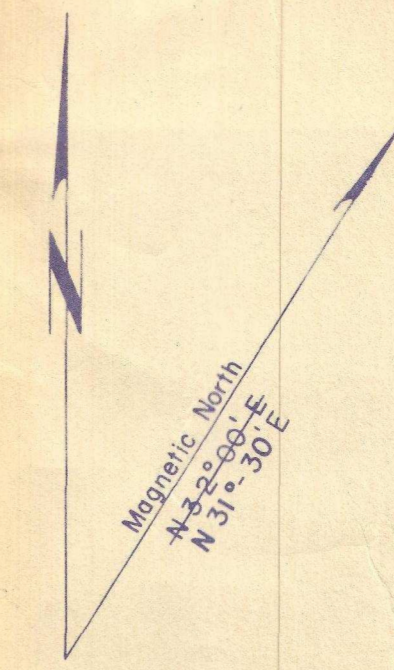

115-I-2	115-I-1	105-L-4
115-H-15	115-H-16	105-E-13
115-H-10	115-H-9	105-E-12

PRICE 25 CENTS

WHITEHORSE 2 Nov. 71, 14 Feb. 61, 15 Nov. 72, 22 Sept. 73, 23 July 74, 15 Nov. 75, 23 Aug. 76, 28 July 74

1st Edition

