

This sheet is issued as a preliminary guide to prospectors for which the Department accepts no responsibility as it is impossible to eliminate errors before adequate surveys have been made. Every effort has been made to show as accurately as possible the location of claims.

This sheet will be revised from time to time upon receipt of more accurate information.

**NOTICE**

THIS MAP IS ISSUED AS A PRELIMINARY GUIDE FOR WHICH THE DEPARTMENT OF NORTHERN AFFAIRS AND NATIONAL RESOURCES WILL ACCEPT NO RESPONSIBILITY FOR ANY ERRORS, INACCURACIES OR OMISSIONS WHATSOEVER ON THE SHEET BEFORE ADEQUATE SURVEYS HAVE BEEN MADE.

# SHEET 115-1-1

LATITUDE 62° 00' To 62° 15'  
LONGITUDE 136° 00' To 136° 30'

## CARMACKS

CANADA  
DEPARTMENT OF NORTHERN AFFAIRS AND NATIONAL RESOURCES  
NORTHERN ADMINISTRATION BRANCH  
RESOURCES DIVISION

SCALE: 1/2 MILE TO 1 INCH

FT. 0 500 1000 1500 2000 2500 3000 3500 4000 4500 5000

ISSUED UNDER THE AUTHORITY OF THE MINISTER OF NORTHERN AFFAIRS AND NATIONAL RESOURCES

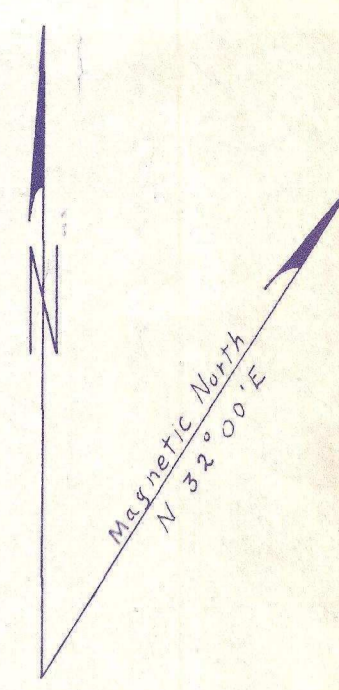

115-1-7	115-1-8	105-L-5
115-1-2	115-1-1	105-L-4
105-H-15	105-H-16	105-E-13

50 CENTS

WHITEHORSE 28 Oct 65  
15 Oct 65  
11 Jan. 63

