

GRID - DEA-DY - BLIND CREEK

GRAVITY DATA

ORIGINAL FIELD WORK				DENSITY -			DENSITY -			DENSITY -			DENSITY -		
STATION	OBSERVED GRAVITY	ELEV.	LATH CORR.	ELEV. CORR.	TERRA CORR.	BOUGUER GRAVITY	ELEV. CORR.	TERR. CORR.	BOUGUER GRAVITY	ELEV. CORR.	TERR. CORR.	BOUGUER GRAVITY	ELEV. CORR.	TERR. CORR.	BOUGUER GRAVITY
<b>L 80W</b>															
1	22+35 <sup>N</sup>	164.56	2831.10	+845		343.38									
2	20N	162.71	2864.50	+898		343.56									
3	16N	166.36	2814.80	+904		343.29									
4	12N	166.34	2798.00	+911		343.34									
5	8N	162.27	2870.90	+918		343.70									
6	4N	158.92	2928.30	+924		343.86									
7	0+00	152.65	3030.00	+931		343.76									
8	4S	146.82	3142.40	+938		343.74									
9	8S	135.80	3310.40	+944		343.86									
10	12S	127.81	3441.30	+951		343.80									
11	16S	137.50	3279.50	+958		343.85									
12	20S	140.41	3223.90	+964		343.48									
13	24S	130.82	3386.40	+971		343.71									
14	28S	117.20	3600.50	+978		343.01									
<b>L-72W</b>															
1	21+90N	151.32	3059.50	+905		343.94									
2	20N	149.68	3092.40	+907		344.29									
3	16N	149.36	3093.30	+913		344.09									
4	12N	151.72	3044.80	+920		343.61									
5	8N	149.05	3096.70	+927		344.12									
6	4N	143.92	3174.10	+933		343.70									
7	0+00	136.27	3315.40	+940		344.59									
8	4S	129.90	3413.50	+947		344.18									
9	8S	120.65	3571.50	+953		344.47									
10	12S	116.67	3642.30	+960		344.81									
11	16S	117.43	3626.30	+967		344.68									
12	20S	122.76	3537.30	+973		344.73									
13	24S	115.65	3642.70	+980		344.01									
14	28S	111.69	3702.90	+987		343.73									
<b>L 64W</b>															
1	19+84N	136.06	3329.00	+916		344.96									
2	16N	134.62	3346.20	+922		344.61									
3	12N	133.09	3367.60	+929		344.44									
4	8N	131.81	3392.20	+936		344.70									
5	4N	132.75	3383.40	+942		345.17									

DEA-DY Blind Creek Grids  
 "No terram"  
 Fall - 1977  
 W-169 + "018"

1  
2  
3  
4  
5  
6  
7  
8  
9  
10  
11  
12  
13  
14  
  
1  
2  
3  
4  
5  
6  
7  
8  
9  
10  
11  
12  
13  
14  
  
1  
2  
3  
4  
5

SE  
CL.  
CR.

ORIGINAL FIELD WORK				DENSITY -			DENSITY -			DENSITY -			DENSITY -			DENSITY -			
STATION	OBSERVED GRAVITY	ELEV.	LATH CORR.	ELEV. CORR.	TERR. CORR.	BOUGUER GRAVITY	ELEV. CORR.	TERR. CORR.	BOUGUER GRAVITY	ELEV. CORR.	TERR. CORR.	BOUGUER GRAVITY	ELEV. CORR.	TERR. CORR.	BOUGUER GRAVITY	ELEV. CORR.	TERR. CORR.	BOUGUER GRAVITY	
<b>L64W</b>																			
0+00	130.07	3432.00	+9.49			345.48													
45.	122.03	3561.50	+9.56			345.38													
85.	113.96	3698.60	+9.62			345.50													
125.	112.80	3725.00	+9.69			345.99													
165.	112.08	3734.90	+9.76			345.93													
205.	108.37	3778.70	+9.82			344.91													
245.	103.73	3850.50	+9.89			344.65													
285.	100.77	3890.80	+9.96			344.18													
305.	97.85	3933.20	+9.99			343.83													
<b>L56W</b>																			
18+73N	126.15	3505.80	+9.27			345.77													
16N	125.74	3511.10	+9.32			345.73													
12N	123.18	3550.80	+9.39			345.62													
8N	124.71	3533.70	+9.46			346.19													
4N	122.33	3568.50	+9.52			345.96													
0+00	118.65	3629.20	+9.59			345.99													
45.	114.55	3701.10	+9.66			346.28													
85.	109.67	3777.40	+9.72			346.03													
125.	107.31	3820.40	+9.79			346.32													
165.	106.07	3838.70	+9.86			346.25													
205.	102.36	3893.00	+9.92			345.86													
245.	99.40	3930.40	+9.99			345.21													
285.	93.95	4003.40	+10.06			344.75													
<b>L48W</b>																			
17+48	119.99	3612.50	+9.38			346.12													
16N	120.81	3601.95	+9.41			346.34													
12N	119.73	3619.70	+9.48			346.39													
8N	117.89	3649.00	+9.55			346.38													
4N	114.73	3697.50	+9.61			346.19													
0+00	110.41	3773.30	+9.68			346.49													
45.	107.37	3824.80	+9.75			346.61													
85.	104.91	3862.62	+9.81			346.48													
125.	104.91	3864.70	+9.88			346.67													
165.	101.65	3913.80	+9.95			346.43													
205.	101.15	3919.70	+10.01			346.34													

6  
SEE  
BY  
C.R.

1  
3  
1  
3  
6  
SEE  
BY  
C.R.

1  
3  
4  
7  
8  
9  
10  
11

ORIGINAL FIELD WORK				DENSITY -			DENSITY -			DENSITY -			DENSITY -			DENSITY -			
STATION	OBSERVED GRAVITY	ELEV.	LATH CORR.	ELEV. CORR.	TERRA CORR.	BOUGUER GRAVITY	ELEV. CORR.	TERR. CORR.	BOUGUER GRAVITY	ELEV. CORR.	TERR. CORR.	BOUGUER GRAVITY	ELEV. CORR.	TERR. CORR.	BOUGUER GRAVITY	ELEV. CORR.	TERR. CORR.	BOUGUER GRAVITY	
<b>L48W</b>																			
12	24S.	97.41	3972.00	+10.08		345.81													
13	28S.	94.26	4011.62	+10.15		345.11													
14	32S.	94.18	4009.60	+10.22		344.98													
<b>L40W</b>																			
1	13+96N	115.17	3699.43	+9.55		346.69													
2	12N	115.41	3698.90	+9.57		346.91													
3	8N	112.89	3739.20	+9.64		346.88													
4	4N	108.40	3807.20	+9.70		346.53													
5	0+00	106.25	3847.40	+9.77		346.86													
6	4S.	105.52	3859.80	+9.84		346.95													
7	8S.	105.61	3860.42	+9.90		347.14													
8	12S.	103.99	3883.70	+9.97		346.98													
9	16S.	102.79	3898.80	+10.04		346.76													
10	20S.	102.78	3896.80	+10.10		346.69													
11	24S.	106.53	3924.70	+10.17					CHECK										
12	28S.	96.94	3973.40	+10.24		345.58													
13	32S.	98.30	3947.50	+10.31		345.46													
<b>L32W</b>																			
1	12N	111.80	3767.30	+9.66		347.50													
2	8N	108.86	3810.40	+9.73		347.21													
3	4N	107.52	3829.00	+9.79		347.05													
4	0+00	106.98	3839.00	+9.86		347.18													
5	4S.	106.78	3842.20	+9.93		347.24													
6	8S.	105.61	3857.20	+9.99		347.03													
7	12S.	103.12	3893.20	+10.06		346.77													
8	16S.	103.69	3885.30	+10.13		346.94													
9	20S.	103.64	3881.10	+10.19		346.70													
10	24S.	96.50	3978.80	+10.26		345.49													
11	28S.	97.84	3955.10	+10.33		345.48			CHECK										
12	32S.	104.26	3857.30	+10.40		346.10													
13	36S.	107.10	3812.10	+10.46		346.29													
<b>L24W</b>																			
1	10+25N	110.58	3793.80	+9.78		347.99													
2	8N.	110.49	3795.80	+9.82		348.06													
3	4N	109.89	3803.90	+9.88		348.00													

ORIGINAL FIELD WORK				DENSITY -			DENSITY -			DENSITY -			DENSITY -			DENSITY -			
STATION	OBSERVED GRAVITY	ELEV.	LATH CORR.	ELEV. CORR.	TERR. CORR.	BOUGUER GRAVITY	ELEV. CORR.	TERR. CORR.	BOUGUER GRAVITY	ELEV. CORR.	TERR. CORR.	BOUGUER GRAVITY	ELEV. CORR.	TERR. CORR.	BOUGUER GRAVITY	ELEV. CORR.	TERR. CORR.	BOUGUER GRAVITY	
L24W																			
4	0+00	109.93	3803.60	+9.95		348.10													
✓	4S.	109.26	3808.20	+10.02		347.77													
✓	8S.	105.13	3864.00	+10.08		347.05													
7	12S.	104.37	3875.00	+10.15		347.02													
8	16S.	108.35	3820.00	+10.22		347.77													
9	20S.	106.84	3826.80	+10.28		347.33													
10	24S.	104.65	3862.20	+10.35		346.73													
11	28S.	108.76	3795.90	+10.42		346.93													
12	32S.	111.44	3760.00	+10.49		346.93													
13	36S.	115.38	3681.60	+10.55		346.83													
L16W																			
1	8N	111.45	3780.20	+9.92		348.18													
2	4N	111.63	3779.10	+9.98		348.36													
3	0+00	111.83	3772.20	+10.05		348.21													
4	4S.	110.31	3792.30	+10.12		347.97													
5	8S.	107.96	3822.90	+10.18		347.51													
6	12S.	112.18	3763.50	+10.25		348.24													
7	16S.	112.38	3757.90	+10.32		348.17				?									
8	20S.	110.80	3774.20	+10.38		347.63				CHECK									
9	24S.	111.58	3758.80	+10.45		347.56													
10	28S.	113.96	3720.60	+10.52		347.72													
11	32S.	117.05	3668.80	+10.59		347.77													
L8W																			
1	6+50N	114.21	3737.30	+10.03		348.48				✓									
2	4N	114.96	3724.80	+10.07		348.52													
3	0+00	114.58	3731.40	+10.14		348.60													
4	4S.	113.76	3744.00	+10.21		348.61													
5	8S.	113.96	3736.20	+10.27		348.40													
6	12S.	114.58	3721.60	+10.34		348.22													
7	16S.	113.73	3733.00	+10.41		348.12													
8	20S.	115.06	3713.40	+10.47		348.33													
9	24S.	115.95	3699.40	+10.54		348.45													
10	28S.	116.93	3679.90	+10.61		348.33													
11	32S.	116.89	3675.20	+10.68		348.08													
12	36S.	116.47	3677.20	+10.74		347.84													
13	40S.	116.92	3667.00	+10.81		347.75													

ORIGINAL FIELD WORK				DENSITY -			DENSITY -			DENSITY -			DENSITY -			DENSITY -			
STATION	OBSERVED GRAVITY	ELEV.	LATI-CORR.	ELEV. CORR.	TERRA CORR.	BOUGUER GRAVITY	ELEV. CORR.	TERR. CORR.	BOUGUER GRAVITY	ELEV. CORR.	TERR. CORR.	BOUGUER GRAVITY	ELEV. CORR.	TERR. CORR.	BOUGUER GRAVITY	ELEV. CORR.	TERR. CORR.	BOUGUER GRAVITY	
<b>L 0+00</b>																			
4N	118.99	3657.80	+10.16			348.62													
0+00	118.58	3665.20	+10.23			348.72													
4S	117.54	3682.20	+10.30			348.77													
8S	117.62	3678.20	+10.36			348.67													
12S	116.93	3682.40	+10.43			348.30													
16S	117.26	3678.20	+10.50			348.45													
20S	116.52	3689.50	+10.56			348.45													
24S	116.69	3683.20	+10.63			348.31													
28S	117.09	3675.90	+10.70			348.34													
32S	115.51	3695.90	+10.77			348.03													
36S	115.09	3700.90	+10.83			347.97													
40S	117.97	3661.30	+10.90			347.95													
<b>L 8E</b>																			
2+52N	123.20	3584.50	+10.29			348.56													
0+00	123.27	3580.30	+10.32			348.41													
4S	123.88	3570.80	+10.39			348.52													
8S	123.13	3580.70	+10.45			348.42													
12S	122.77	3582.70	+10.52			348.25													
16S	120.04	3624.70	+10.59			348.11													
20S	119.60	3633.20	+10.65			348.24													
24S	118.45	3648.10	+10.72			348.06													
28S	118.03	3652.60	+10.79			347.98													
32S	117.82	3654.10	+10.86			347.93													
36S	119.02	3630.90	+10.92			347.79													
40S	119.90	3610.50	+10.99			347.55													
<b>L 16E</b>																			
1+20N	129.75	3466.10	+10.39			348.11													
0+00	129.78	3470.20	+10.41			348.40													
4S	130.00	3459.90	+10.48			348.07													
8S	126.96	3514.60	+10.54			348.38													
12S	123.77	3563.10	+10.61			348.17													
16S	123.77	3564.90	+10.68			348.34													
20S	123.18	3569.00	+10.74			348.06													
24S	124.29	3550.90	+10.81			348.15													
28S	122.80	3572.30	+10.88			348.02													

ORIGINAL FIELD WORK				DENSITY -			DENSITY -			DENSITY -			DENSITY -			DENSITY -			
STATION	OBSERVED GRAVITY	ELEV.	LATH CORR.	ELEV. CORR.	TERR. CORR.	BOUGUER GRAVITY	ELEV. CORR.	TERR. CORR.	BOUGUER GRAVITY	ELEV. CORR.	TERR. CORR.	BOUGUER GRAVITY	ELEV. CORR.	TERR. CORR.	BOUGUER GRAVITY	ELEV. CORR.	TERR. CORR.	BOUGUER GRAVITY	
L16E																			
10	32S.	121.44	3589.80	+10.96		347.78													
11	36S.	123.60	3556.50	+11.01		348.00													
12	40S.	125.44	3523.00	+11.08		347.90													
L24E																			
1	0+00	131.51	3431.90	+10.50		347.92													
2	4S.	132.89	3409.70	+10.57		348.04													
3	8S.	131.22	3437.40	+10.63		348.09													
4	12S.	129.90	3465.20	+10.70		348.51													
5	16S.	130.08	3462.50	+10.77		348.60													
6	20S.	128.76	3484.30	+10.83		348.65													
7	24S.	128.49	3489.00	+10.90		348.73													
8	28S.	128.31	3487.60	+10.97		348.54													
9	32S.	129.94	3457.40	+11.04		348.42													
10	36S.	129.61	3457.60	+11.10		348.17													
11	40S.	132.10	3415.20	+11.17		348.18													
12	44S.	135.42	3360.80	+11.24		348.31													
L32E																			
1	28N.	142.89	3234.20	+10.12		347.06													
2	24N.	142.12	3250.90	+10.19		347.32													
3	20N.	141.10	3263.30	+10.26		347.16													
4	16N.	137.76	3317.10	+10.32		347.11													
5	12N.	132.93	3397.30	+10.39		347.16													
6	8N.	133.07	3396.60	+10.46		347.33													
7	4N.	130.43	3442.10	+10.52		347.48													
8	0+00	130.86	3435.90	+10.59 (+10.603)		347.61													
9	4S.	131.50	3426.70	+10.67		347.77													
10	8S.	134.51	3378.40	+10.73		347.94													
11	12S.	134.41	3378.80	+10.80		347.94													
12	16S.	N.R.	N.R.	+10.87		N.R.													
13	20S.	N.R.	N.R.	+10.93		N.R.													
14	24S.	135.31	3372.60	+11.00		348.67													
15	27+30S	135.23	3370.00	+11.07		348.50													
16	32S.	135.19	3369.90	+11.14		348.52													
17	36S.	134.87	3379.30	+11.20		348.83													
18	40S.	134.60	3378.30	+11.27		348.57													
19	44S.	134.15	3376.70	+11.34		348.09													

} missing from input data : inserted April 1995

ORIGINAL FIELD WORK				DENSITY -			DENSITY -			DENSITY -			DENSITY -			DENSITY -			
STATION	OBSERVED GRAVITY	ELEV.	LAT. CORR.	ELEV. CORR.	TERR. CORR.	BOUGUER GRAVITY	ELEV. CORR.	TERR. CORR.	BOUGUER GRAVITY	ELEV. CORR.	TERR. CORR.	BOUGUER GRAVITY	ELEV. CORR.	TERR. CORR.	BOUGUER GRAVITY	ELEV. CORR.	TERR. CORR.	BOUGUER GRAVITY	
<b>L40E</b>																			
1	28N	148.41	3137.20	+10.21		346.85													
2	24N	147.82	3146.00	+10.28		346.86													
3	20N	144.78	3197.90	+10.35		347.00													
4	16N	140.34	3272.60	+10.41		347.11													
5	12N	135.03	3357.50	+10.48		346.96													
6	8N	132.16	3405.90	+10.55		347.06													
7	4N	131.85	3414.10	+10.61		347.31													
8	0+00	129.89	3443.40	+10.68		347.17													
<b>L48E</b>																			
1	26N	153.28	3044.70	+10.37		346.33													
2	24N	151.28	3076.30	+10.40		346.26													
3	20N	144.75	3183.40	+10.47		346.22													
4	16N	136.67	3316.10	+10.53		346.17													
5	12N	132.98	3380.60	+10.60		346.42													
6	8N	134.17	3368.90	+10.67		346.97													
7	4N	131.74	3409.60	+10.73		347.05													
8	0+00	129.87	3442.90	+10.80		347.24													
<b>L56E</b>																			
1	24N	152.16	3055.60	+10.49		345.99													
2	20N	144.44	3192.50	+10.56		346.55													
3	16N	138.74	3283.70	+10.62		346.38													
4	12N	134.51	3362.20	+10.69		346.93													
5	8N	130.93	3421.00	+10.76		346.95													
6	4N	129.12	3454.80	+10.82		347.23													
7	0+00	128.02	3475.10	+10.89		347.42													
<b>L64E</b>																			
1	30N	157.29	2969.80	+10.48		345.96													
2	28N	155.39	2999.40	+10.51		345.86													
3	24N	149.17	3102.72	+10.58		345.91													
4	20N	142.12	3232.66	+10.65		346.73	CHECK												
5	16N	135.75	3339.36	+10.71		346.82													
6	12N	130.72	3423.80	+10.78		346.93													
7	8N	129.52	3445.80	+10.85		347.12													
8	4N	127.25	3484.60	+10.91		347.24													
9	0+00	127.37	3490.20	+10.98		347.76													

missing from input data: inserted Apr 7  
DTS

GRAVITY DATA

ORIGINAL FIELD WORK				DENSITY -			DENSITY -			DENSITY -			DENSITY -			DENSITY -			
STATION	OBSERVED GRAVITY	ELEV.	LATH CORR.	ELEV. CORR.	TERR. CORR.	BOUGUER GRAVITY	ELEV. CORR.	TERR. CORR.	BOUGUER GRAVITY	ELEV. CORR.	TERR. CORR.	BOUGUER GRAVITY	ELEV. CORR.	TERR. CORR.	BOUGUER GRAVITY	ELEV. CORR.	TERR. CORR.	BOUGUER GRAVITY	
L 72F.																			
1	24N.	147.76	3134.50	+10.67		346.50													
2	20N.	141.35	3244.70	+10.74		346.77													
3	16N.	136.20	3333.10	+10.80		346.99													
4	12N.	133.64	3379.60	+10.87		347.29													
5	8N.	128.06	3469.40	+10.94		347.16													
6	4N.	126.52	3496.60	+11.00		347.32													
7	0+00.	125.49	3520.30	+11.07		347.78													
L 80F.																			
1	28N.	155.22	3000.40	+10.70		345.94	CHECK.												
2	24N.	148.40	3122.60	+10.77		346.53													
3	20N.	142.39	3225.10	+10.84		346.74													
4	16N.	137.06	3319.50	+10.90		347.13													
5	12N.	132.16	3405.10	+10.97		347.44													
6	8N.	129.85	3443.40	+11.04		347.49													
7	4N.	126.24	3502.40	+11.10		347.48													
8	0+00.	123.63	3541.00	+11.17		347.26													
BASE LINE.																			
1	80W.	152.65	3030.00	+9.31		343.76													
2	76W.	N.R.	N.R.	+9.36															
3	72W.	136.27	3315.40	+9.40		344.59													
4	68W.	133.03	3378.10	+9.44		345.16													
5	64W.	130.07	3432.00	+9.49		345.48													
6	60W.	124.09	3532.50	+9.54		345.58													
7	56W.	118.65	3629.00	+9.59		345.99													
8	52W.	114.18	3706.80	+9.63		346.22													
9	48W.	110.41	3773.30	+9.68		346.49													
10	44W.	107.83	3821.40	+9.73		346.84													
11	40W.	106.25	3847.40	+9.77		346.86													
12	36W.	105.87	3856.10	+9.82		347.06													
13	32W.	106.98	3839.00	+9.86		347.18													
14	28W.	108.60	3819.10	+9.90		347.64													
15	24W.	109.93	3803.60	+9.95		348.10													
16	20W.	110.67	3788.66	+10.00		347.99													
17	16W.	111.83	3772.00	+10.05		348.21													

ORIGINAL FIELD WORK				DENSITY -			DENSITY -			DENSITY -			DENSITY -			DENSITY -			
STATION	OBSERVED GRAVITY	ELEV.	LATH CORR.	ELEV. CORR.	TERR. CORR.	BOUGUER GRAVITY	ELEV. CORR.	TERR. CORR.	BOUGUER GRAVITY	ELEV. CORR.	TERR. CORR.	BOUGUER GRAVITY	ELEV. CORR.	TERR. CORR.	BOUGUER GRAVITY	ELEV. CORR.	TERR. CORR.	BOUGUER GRAVITY	
BASE LINE.																			
18	12W.	113.10	3753.70	+10.09		348.41													
19	8W.	114.58	3731.40	+10.14		348.60													
20	4W.	116.46	3701.00	10.19		348.71													
21	"A" 0+00	118.58	3665.00	+10.23		348.72													
22	4E.	120.53	3631.10	10.28		348.68													
23	8E.	123.97	3580.30	+10.32		348.41													
24	12E.	127.55	3511.50	10.36		348.60													
25	16E.	129.78	3470.00	+10.41		348.40													
26	20E.	131.58	3432.50	10.45		347.98													
27	24E.	131.51	3431.90	+10.50		347.92													
28	28E.	130.75	3443.50	10.55		347.91													
29	32+76E.	130.86	3435.90	+10.60		347.61													
30	36E.	130.67	3437.50	10.64		347.56													
31	40E.	129.89	3443.40	+10.68		347.17													
32	44E.	129.41	3449.10	10.74		347.10													
33	48E.	129.87	3442.90	+10.80		347.24													
34	52E.	128.79	3461.10	10.84		347.30													
35	56E.	128.02	3475.10	+10.89		347.42													
36	60E.	128.22	3474.50	10.93		347.62													
37	64E.	127.37	3490.20	+10.98		347.76													
38	68E.	127.43	3490.10	10.93		347.77													
39	72E.	125.49	3520.30	+11.07		347.78													
40	76E.	123.41	3546.60	11.12		347.33													
41	80E.	123.63	3541.00	+11.17		347.26													

ORIGINAL FIELD WORK				DENSITY -			DENSITY -			DENSITY -			DENSITY -			DENSITY -			
STATION	OBSERVED GRAVITY	ELEV.	LATH CORR.	ELEV. CORR.	TERR. CORR.	BOUGUER GRAVITY	ELEV. CORR.	TERR. CORR.	BOUGUER GRAVITY	ELEV. CORR.	TERR. CORR.	BOUGUER GRAVITY	ELEV. CORR.	TERR. CORR.	BOUGUER GRAVITY	ELEV. CORR.	TERR. CORR.	BOUGUER GRAVITY	
L72W																			
1	0+00	136.24	3314.85	+9.40		344.53													
2		134.90	3337.85	+9.42		344.59													
3	25.	133.85	3355.38	+9.43		344.60													
4		132.90	3381.65	+9.45		344.55													
5	45.	130.42	3411.65	+9.47		344.59													
6		128.34	3443.95	+9.48		344.46													
7	65.	124.98	3495.25	+9.50		344.20													
8		122.76	3433.95	+9.52		338.32	CHECK.												
9	85.	120.83	3567.45	+9.53		344.41													
10		119.66	3589.05	+9.55		344.55													
11	105.	118.96	3603.45	+9.57		344.74													
12		117.88	3621.95	+9.58		344.78													
13	125.	116.87	3639.45	+9.60		344.84													
14		117.08	3638.15	+9.62		344.99													
15	145.	117.54	3630.25	+9.63		344.99													
16		118.05	3621.65	+9.65		345.00													
17	165.	117.62	3621.75	+9.67		344.60													
18		119.82	3588.95	+9.68		344.84													
19	185.	120.86	3569.55	+9.70		344.73													
20		122.53	3540.15	+9.72		344.66													
21	205.	122.80	3533.25	+9.73		344.53													
22		122.51	3535.63	+9.75		344.40													
23	225.	120.20	3570.65	+9.77		344.21													
24		118.53	3595.15	+9.78		344.02													
25	245.	116.06	3631.55	+9.80		343.75													
26		116.35	3629.85	+9.82		343.96													
27	265.	117.36	3612.55	+9.83		343.94													
28		115.14	3642.95	+9.85		343.57													
29	285.	111.87	3694.34	+9.87		343.40													
30	295.	109.08	3738.55	+9.89		343.28													
31	29+885	107.12	3770.95	+9.90		343.28													
L68W																			
1	0+00	132.89	3376.84	+9.45		344.95													
2		131.32	3403.45	+9.47		345.00													
3	25.	129.54	3431.25	+9.48		344.90													

ORIGINAL FIELD WORK				DENSITY -			DENSITY -			DENSITY -			DENSITY -			DENSITY -			
STATION	OBSERVED GRAVITY	ELEV.	LATH CORR.	ELEV. CORR.	TERRA CORR.	BOUGUER GRAVITY	ELEV. CORR.	TERR. CORR.	BOUGUER GRAVITY	ELEV. CORR.	TERR. CORR.	BOUGUER GRAVITY	ELEV. CORR.	TERR. CORR.	BOUGUER GRAVITY	ELEV. CORR.	TERR. CORR.	BOUGUER GRAVITY	
L68W																			
4 3S.	127.67	3461.25	+9.50			344.85													
5	125.08	3502.25	+9.52			344.74													
6 5S.	121.87	3554.55	+9.53			344.67													
7	120.22	3583.85	+9.56			344.80													
8 7S.	118.48	3613.85	+9.57			344.88													
9	117.12	3638.65	+9.58			345.02													
10 9S.	115.90	3658.95	+9.60			345.04													
11	114.82	3678.75	+9.62			345.17													
12 11S.	114.57	3685.95	+9.63			345.36													
13	114.93	3682.95	+9.65			345.56													
14 13S.	115.30	3678.25	+9.67			345.67													
15	115.39	3676.85	+9.68			345.68													
16 15S.	115.08	3678.75	+9.70			345.51													
17	114.98	3678.35	+9.72			345.40													
18 17S.	115.38	3669.95	+9.73			345.31													
19	114.64	3676.35	+9.75			344.97													
20 19S.	113.80	3686.75	+9.77			344.78													
21	112.92	3697.35	+9.78			344.54													
22 21S.	111.59	3715.85	+9.80			344.34													
23	111.33	3719.75	+9.82			344.34													
24 23S.	111.17	3722.65	+9.83			344.36													
25	109.76	3742.65	+9.85			344.17													
26 25S.	106.54	3787.95	+9.87			343.69													
27	106.84	3785.69	+9.88			343.86													
28 27S.	108.47	3761.72	+9.90			344.07													
29	106.33	3795.85	+9.92			344.00													
30 29S.	102.87	3830.05	+9.94			343.81													
L64 W																			
1 0+00.	130.13	3432.50	+9.49			345.57													
2	129.05	3449.85	+9.51			345.55													
3 2S.	127.16	3479.47	+9.52			345.45													
4	124.77	3517.50	+9.54			345.36													
5 4S.	122.57	3555.43	+9.56			345.46													
6	120.38	3592.61	+9.57			345.51													
7 6S.	118.13	3630.30	+9.59			345.54													

ORIGINAL FIELD WORK				DENSITY -			DENSITY -			DENSITY -			DENSITY -			DENSITY -			
STATION	OBSERVED GRAVITY	ELEV.	LAT. CORR.	ELEV. CORR.	TERR. CORR.	BOUGUER GRAVITY	ELEV. CORR.	TERR. CORR.	BOUGUER GRAVITY	ELEV. CORR.	TERR. CORR.	BOUGUER GRAVITY	ELEV. CORR.	TERR. CORR.	BOUGUER GRAVITY	ELEV. CORR.	TERR. CORR.	BOUGUER GRAVITY	
L 64W																			
8	7S.	116.36	3660.80	+9.61		345.62													
9		114.17	3695.78	+9.62		345.51													
10	9S.	113.33	3711.53	+9.64		345.66													
11		113.16	3717.80	+9.66		345.89													
12	11S.	113.04	3722.06	+9.67		346.03													
13		112.99	3724.02	+9.69		346.12													
14	13S.	112.54	3728.68	+9.71		345.97													
15		112.07	3735.49	+9.72		345.92													
16	15S.	111.98	3737.66	+9.74		345.98													
17		111.88	3738.10	+9.76		345.93													
18	17S.	111.84	3736.55	+9.77		345.80													
19		110.84	3748.73	+9.79		345.55													
20	19S.	109.89	3761.65	+9.81		345.40													
21		109.06	3773.70	+9.82		345.30													
22	21S.	107.62	3793.03	+9.84		345.04													
23		106.11	3814.40	+9.86		344.83													
24	23S.	105.11	3830.02	+9.87		344.78													
25		104.04	3845.31	+9.89		344.65													
26	25S.	103.08	3859.07	+9.91		344.53													
27		102.37	3869.29	+9.92		344.45													
28	27S.	101.72	3878.02	+9.94		344.34													
29		101.01	3887.03	+9.96		344.19													
30	29S.	100.10	3899.31	+9.98		344.04													
31		99.28	3911.40	+9.99		343.95													
32	31S.	98.21	3927.26	+10.01		343.86													
L 60W																			
1	0+00	124.19	3534.07	+9.45		345.68													
2		123.43	3546.36	+9.56		345.77													
3	2S.	122.35	3559.26	+9.57		345.48													
4		121.63	3571.90	+9.59		345.53													
5	4S.	119.51	3606.62	+9.61		345.52													
6		117.07	3646.56	+9.62		345.48													
7	6S.	114.82	3682.85	+9.64		345.43													
8		113.07	3711.76	+9.66		345.44													
9	8S.	111.76	3735.07	+9.67		345.53													

ORIGINAL FIELD WORK				DENSITY -			DENSITY -			DENSITY -			DENSITY -			DENSITY -			
STATION	OBSERVED GRAVITY	ELEV.	LATH CORR.	ELEV. CORR.	TERRA CORR.	BOUGUER GRAVITY	ELEV. CORR.	TERR. CORR.	BOUGUER GRAVITY	ELEV. CORR.	TERR. CORR.	BOUGUER GRAVITY	ELEV. CORR.	TERR. CORR.	BOUGUER GRAVITY	ELEV. CORR.	TERR. CORR.	BOUGUER GRAVITY	
L60W																			
10	95	111.10	3747.82	+0.69		345.66													
11		110.43	3759.33	+0.71		345.70													
12	115.	109.98	3767.25	+0.72		345.74													
13		109.32	3778.52	+0.74		345.77													
14	135.	108.99	3784.89	+0.76		345.84													
15		109.13	3783.16	+0.77		345.89													
16	155.	109.25	3780.75	+0.79		345.89													
17		108.83	3785.97	+0.81		345.80													
18	175.	107.97	3797.60	+0.82		345.65													
19		107.06	3810.74	+0.84		345.54													
20	195.	105.97	3826.84	+0.86		345.44													
21		105.10	3840.93	+0.87		345.43													
22	215.	104.17	3854.05	+0.89		345.30													
23		103.30	3866.74	+0.91		345.21													
24	235.	102.44	3878.36	+0.92		345.06													
25		101.94	3884.86	+0.94		344.97													
26	255.	101.21	3893.74	+0.96		344.79													
27		100.08	3907.33	+0.97		344.49													
28	275.	98.64	3925.47	+0.99		344.16													
29		97.26	3945.10	+10.01		343.98													
30	295.	96.13	3962.25	+10.03		343.90													
31		94.79	3981.96	+10.04		343.75													
32	315.	93.22	4007.83	+10.06		343.75													
L56W																			
1	0+00	118.65	3628.92	+0.59		345.98													
2		117.96	3641.75	+0.61		346.08													
3	25.	116.70	3662.65	+0.62		346.08													
4		115.51	3681.85	+0.64		346.06													
5	45.	114.34	3700.55	+0.66		346.03													
6		113.20	3719.65	+0.67		346.05													
7	65.	111.85	3740.45	+0.69		345.97													
8		110.77	3758.65	+0.71		346.00													
9	85.	109.65	3777.65	+0.72		346.03													
10		109.13	3786.85	+0.74		346.08													
11	105.	107.91	3806.25	+0.76		346.05													

ORIGINAL FIELD WORK				DENSITY -			DENSITY -			DENSITY -			DENSITY -			DENSITY -			
STATION	OBSERVED GRAVITY	ELEV.	LATH CORR.	ELEV. CORR.	TERR. CORR.	BOUGUER GRAVITY	ELEV. CORR.	TERR. CORR.	BOUGUER GRAVITY	ELEV. CORR.	TERR. CORR.	BOUGUER GRAVITY	ELEV. CORR.	TERR. CORR.	BOUGUER GRAVITY	ELEV. CORR.	TERR. CORR.	BOUGUER GRAVITY	
L56w																			
11s.	107.29	3816.65	+9.77			346.06													
13	107.20	3819.75	+9.79			346.18													
14	13s	107.22	3819.25	+9.81		346.19													
15		107.18	3820.35	+9.82		346.22													
16	15s.	106.87	3820.15	+9.84		345.92													
17		106.01	3837.25	+9.86		346.11													
18	17s.	104.91	3853.65	+9.87		346.00													
19		104.03	3867.15	+9.89		345.95													
20	19s.	103.12	3879.75	+9.91		345.82													
21		102.27	3892.05	+9.92		345.71													
22	21s.	101.79	3900.45	+9.94		345.76													
23		101.23	3908.05	+9.96		345.67													
24	23s.	100.52	3917.75	+9.97		345.56													
25		99.46	3930.05	+9.99		345.25													
26	25s.	98.17	3946.15	+10.01		344.95													
27		96.81	3965.55	+10.02		344.76													
28	27s.	95.37	3984.45	+10.04		344.48													
29		94.10	4000.75	+10.06		344.21													
30	29s.	92.54	4021.75	+10.08		343.93													
31		91.55	4036.25	+10.09		343.82													
32	31s.	90.66	4048.65	+10.11		343.69													
33	32s.	90.05	4057.21	+10.13		343.61													

BEAK CONSULTANTS (WEST)  
 UNBILLED DISBURSEMENTS SUBSIDIARY LEDGER  
 MONTH ENDED 28 FEBRUARY 1978

DESCRIPTION REFERENCE

A J JORDAN	JEK2020	27.93
J E G SIKES	JEK2027	21.00
TELEPHONE	JEK2027	9.00
ZIPPER	JEK2036	4.00
WORD PROCESS	JEK2050	63.25
TELEPHONE	JFK2055	5.25
TELEPHONE	JEK2055	17.10
XEROX	JEK2057	62.30
AFF. DISBURSEMENTS	K4294	1.90

CLOSING BALANCE 232.22

K4294A FMC

	OPENING BALANCE	(2,147.58)
INVOICE	BJK4254	(464.34)
TO CORR JE 2003	JEK2013	2,611.92
XEROX	JEK2014	0.53
XEROX	JEK2021	6.12
ZIPPER	JEK2036	8.00
REDACTRON	JEK2050	1.81

CLOSING BALANCE 16.46

K4294B FMC

	OPENING BALANCE	5.50
INVOICE	BJK4255	(5.50)
XEROX	JEK2014	1.58

CLOSING BALANCE 1.58

K4295 ECONOTECH

	OPENING BALANCE	3.15
WRITE OFF	JEK2047	(3.15)

CLOSING BALANCE 0.00

K4296 ALPINE

	OPENING BALANCE	68.30
INVOICE	BJK4251	(68.30)
BAYSHORE TVI	C K11271	89.30
LOOMIS	C K11286	7.40
XEROX	JEK2014	2.62
XEROX	JEK2014	0.88
J D GANSHORN	JEK2016	14.75
TELEPHONE	JEK2027	0.90
REDACTRON	JEK2050	44.00
WORD PROCESS	JEK2050	8.25
XEROX	JEK2057	10.33
AFF. DISBURSEMENTS	K4296	0.14

CLOSING BALANCE 178.57

DEA-DY

(BLIND CREEK)

#7

080  
072  
272  
268  
064  
264  
260  
056  
256  
048  
040  
032  
024  
016  
008  
000  
108  
116  
124  
132  
140  
148  
156  
164  
172  
180  
001

080 W  
072 W  
272 W (Blind Creek)  
268 W "  
064 W  
264 W (Blind Creek)  
260 W  
056 W  
256 W  
048 W  
040 W  
032 W  
024 W  
016 W  
008 W  
0000  
008 E  
016 E  
024 E  
032 E  
040 E  
048 E  
056 E  
064 E  
072 E  
080 E  
BASE

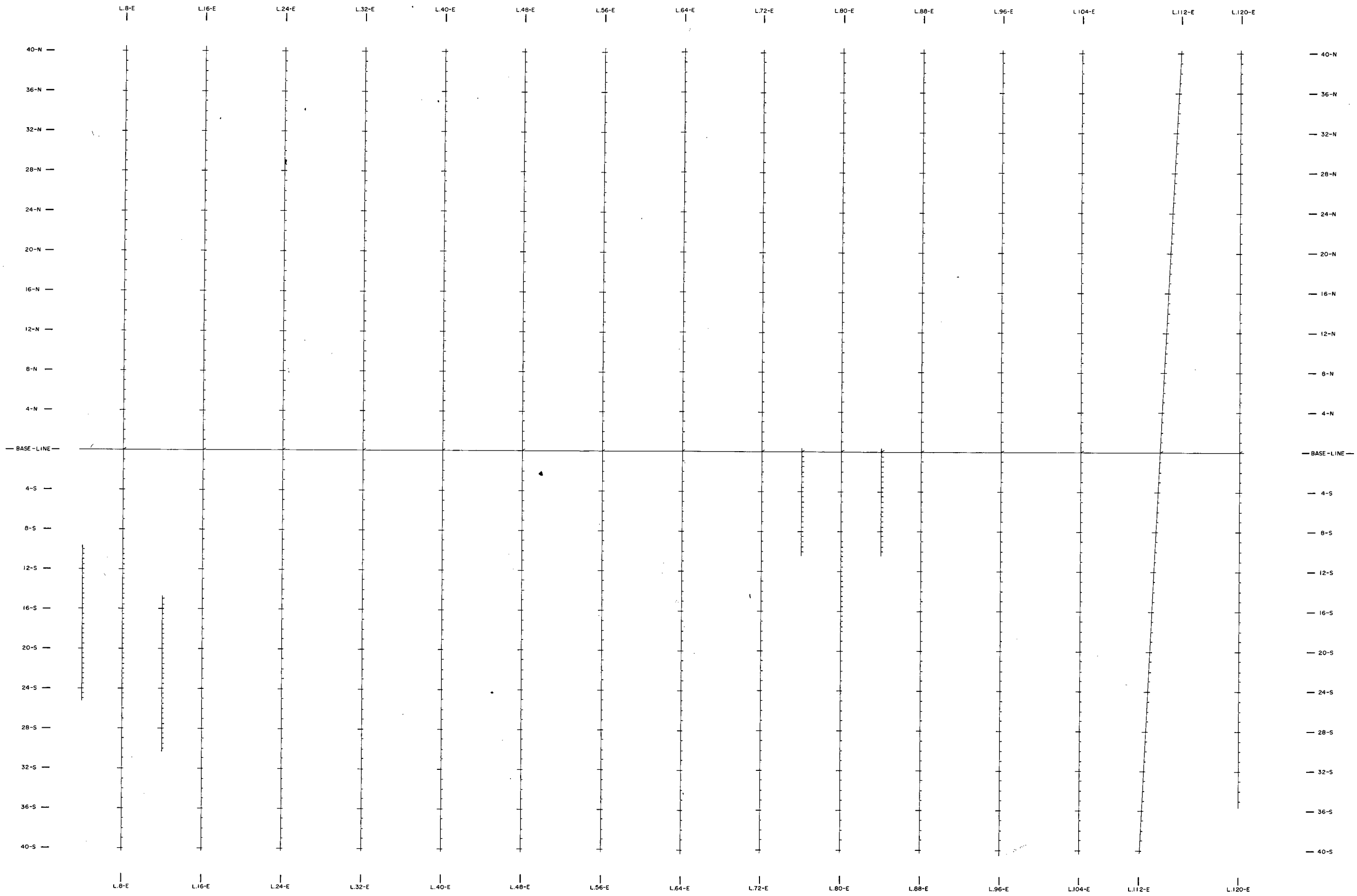

Notes DY F-6

Di.

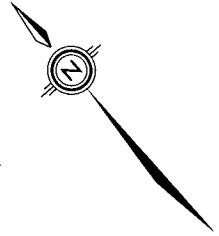

CYPRUS ANVIL MINING CORP  
 DY GRID; ANVIL AREA; WHITEHORSE M.D., YUKON

**GRAVITY SURVEY**

SCALE 1" = 400 FEET

PETER E. WALCOTT & ASSOC. LTD.

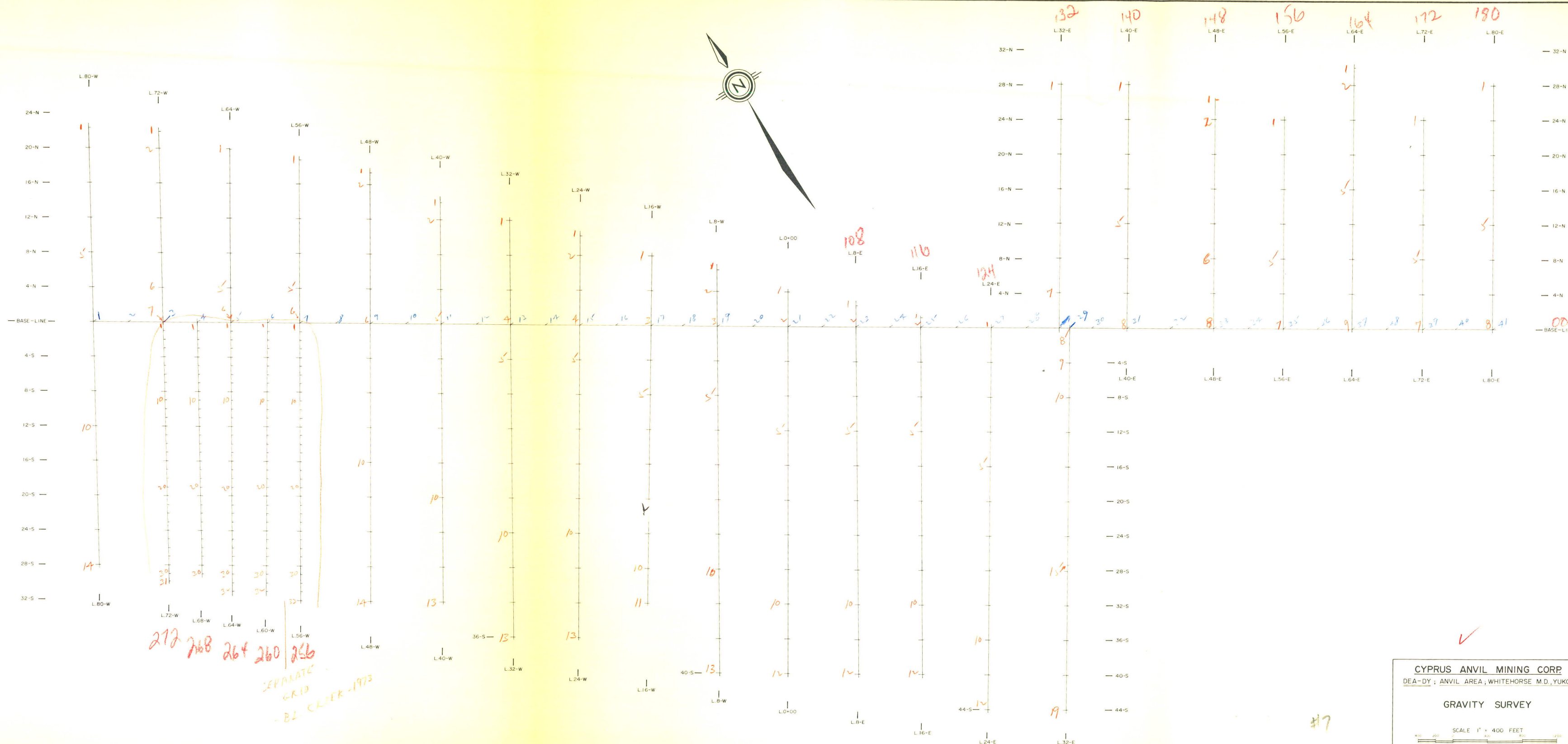
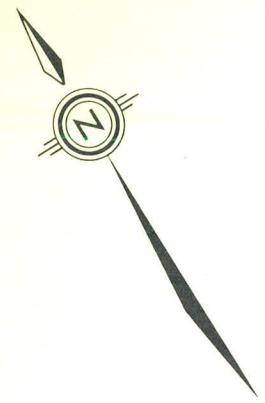

272 268 264 260 256  
 SEPARATE GRID  
 - BL. CREEK - 1973

CYPRUS ANVIL MINING CORP  
 DEA-DY; ANVIL AREA, WHITEHORSE M.D., YUKON

GRAVITY SURVEY

SCALE 1" = 400 FEET

MAP No. W-169-  
 TO ACCOMPANY A REPORT BY  
 PETER E. WALCOTT, P. ENG., DATED

PETER E. WALCOTT & ASSOC. LTD.  
 SEPTEMBER - 1973

#17

**Q  
U  
E  
R  
Y**

on pages 1 & 2

SHOWN AS:

some lines with  
LMO numbers

"see Bk. CR"

QUERIED INFORMATION K/P AS:

did not KP  
the lines

CORRECTIONS

#7 DEA Dy.

Lines 72, 64, 56 W should be keypunched  
as follows

L 72	* 1 to 7
64	1 to 6
56	1 to 6

For plotting purposes L 72, 64, 56 same as 272, 264, 256 on Blind Creek grid.

OK  
APR 7 '78  
DAS

1. CONVERSION OF DIGITIZED STATION LOCATION DATA

2. AREA: DEA-DY

3.							
4.							
5.	LINE: 080W (080)	STATIONS = 14	SEQUENCE= 4	STATION-1 X,Y = 20. , -46.	STATION 14 X,Y = 17.		
6.							
7.	LINE: 072W (072)	STATIONS = 7	SEQUENCE= 6	STATION-1 X,Y = 20. , -46.	STATION 7 X,Y = 19.		
8.							
9.	LINE: 272W (272)	STATIONS = 31	SEQUENCE= 12	STATION-1 X,Y = 19. , -48.	STATION 31 X,Y = 18.		
10.							
11.	LINE: 268W (268)	STATIONS = 30	SEQUENCE= 17	STATION-1 X,Y = 19. , -48.	STATION 30 X,Y = 18.		
12.							
13.	LINE: 064W (064)	STATIONS = 6	SEQUENCE= 18	STATION-1 X,Y = 21. , -47.	STATION 6 X,Y = 20.		
14.							
15.	LINE: 264W (264)	STATIONS = 32	SEQUENCE= 24	STATION-1 X,Y = 20. , -48.	STATION 32 X,Y = 18.		
16.							
17.	LINE: 260W (260)	STATIONS = 32	SEQUENCE= 30	STATION-1 X,Y = 20. , -49.	STATION 32 X,Y = 18.		
18.							
19.	LINE: 056W (056)	STATIONS = 6	SEQUENCE= 31	STATION-1 X,Y = 21. , -47.	STATION 6 X,Y = 20.		
20.							
21.	LINE: 256W (256)	STATIONS = 33	SEQUENCE= 37	STATION-1 X,Y = 20. , -49.	STATION 33 X,Y = 19.		
22.							
23.	LINE: 048W (048)	STATIONS = 14	SEQUENCE= 40	STATION-1 X,Y = 22. , -48.	STATION 14 X,Y = 19.		
24.							
25.	LINE: 040W (040)	STATIONS = 13	SEQUENCE= 43	STATION-1 X,Y = 23. , -49.	STATION 13 X,Y = 20.		
26.							
27.	LINE: 032W (032)	STATIONS = 13	SEQUENCE= 46	STATION-1 X,Y = 23. , -49.	STATION 13 X,Y = 20.		
28.							
29.	LINE: 024W (024)	STATIONS = 13	SEQUENCE= 49	STATION-1 X,Y = 24. , -50.	STATION 13 X,Y = 21.		
30.							
31.	LINE: 016W (016)	STATIONS = 11	SEQUENCE= 51	STATION-1 X,Y = 24. , -50.	STATION 11 X,Y = 22.		
32.							
33.	LINE: 008W (008)	STATIONS = 13	SEQUENCE= 54	STATION-1 X,Y = 25. , -51.	STATION 13 X,Y = 22.		
34.							
35.	LINE: 0000 (000)	STATIONS = 12	SEQUENCE= 56	STATION-1 X,Y = 25. , -52.	STATION 12 X,Y = 23.		
36.							
37.	LINE: 008E (108)	STATIONS = 12	SEQUENCE= 58	STATION-1 X,Y = 26. , -52.	STATION 12 X,Y = 24.		
38.							
39.	LINE: 016E (116)	STATIONS = 12	SEQUENCE= 60	STATION-1 X,Y = 26. , -53.	STATION 12 X,Y = 24.		
40.							
41.	LINE: 024E (124)	STATIONS = 12	SEQUENCE= 62	STATION-1 X,Y = 27. , -53.	STATION 12 X,Y = 25.		
42.							
43.	LINE: 032E (132)	STATIONS = 19	SEQUENCE= 66	STATION-1 X,Y = 29. , -51.	STATION 19 X,Y = 25.		
44.							
45.	LINE: 040E (140)	STATIONS = 8	SEQUENCE= 68	STATION-1 X,Y = 30. , -52.	STATION 8 X,Y = 28.		
46.							
47.	LINE: 048E (148)	STATIONS = 8	SEQUENCE= 70	STATION-1 X,Y = 31. , -53.	STATION 8 X,Y = 29.		
48.							
49.	LINE: 056E (156)	STATIONS = 7	SEQUENCE= 72	STATION-1 X,Y = 31. , -53.	STATION 7 X,Y = 30.		
50.							
51.	LINE: 064E (164)	STATIONS = 9	SEQUENCE= 74	STATION-1 X,Y = 32. , -53.	STATION 9 X,Y = 30.		
52.							

53.	LINE: 072E (172)	STATIONS = 7	SEQUENCE= 76	STATION-1 X,Y = 32. , -54.	STATION 7 X,Y = 31.
54.					
55.	LINE: 080E (180)	STATIONS = 8	SEQUENCE= 78	STATION-1 X,Y = 33. , -54.	STATION 8 X,Y = 32.
56.					
57.	LINE: BASE (001)	STATIONS = 41	SEQUENCE= 84	STATION-1 X,Y = 18. , -47.	STATION 41 X,Y = 32.
58.	FINISHED -- CARDS = 84	STATIONS = 423			
59.	STOP				

1. OUTPUT FROM MERGE OF GRAVITY AND STATION LOCATION DATA

2.

3. GRID DEA-DY

4.

5.

6.

7.

8.

9.

10. GRAVITY AND STATION FILES HAVE BEEN MERGED  
11. OUTPUT RESIDES ON FILE MEROUT.NN (NN = GRID NO.)

12. GRAVITY DATA RECORDS = 423

13. STATION LOCATION RECORDS = 423

14. NUMBER OF ERRORS = 0

15. STOP