

GEOCHEMICAL REPORT

TAM CLAIM GROUP

(Tam 2-5, 22)

Watson Lake Mining District
Yukon Territory

Latitude : 60°34'N

Longitude : 129°45'W

N.T.S. 105-I-12

Field Work:
September 18, 19, 1974

By:

T. J. Adamson

DYNASTY EXPLORATIONS LIMITED

December, 1974



LIST OF CLAIMS

<u>Claim</u>	<u>Claim Number</u>	<u>Grant Numbers</u>	<u>Recording Date</u>
TAM	1-48	Y71437-Y71484	Dec. 18, 1972

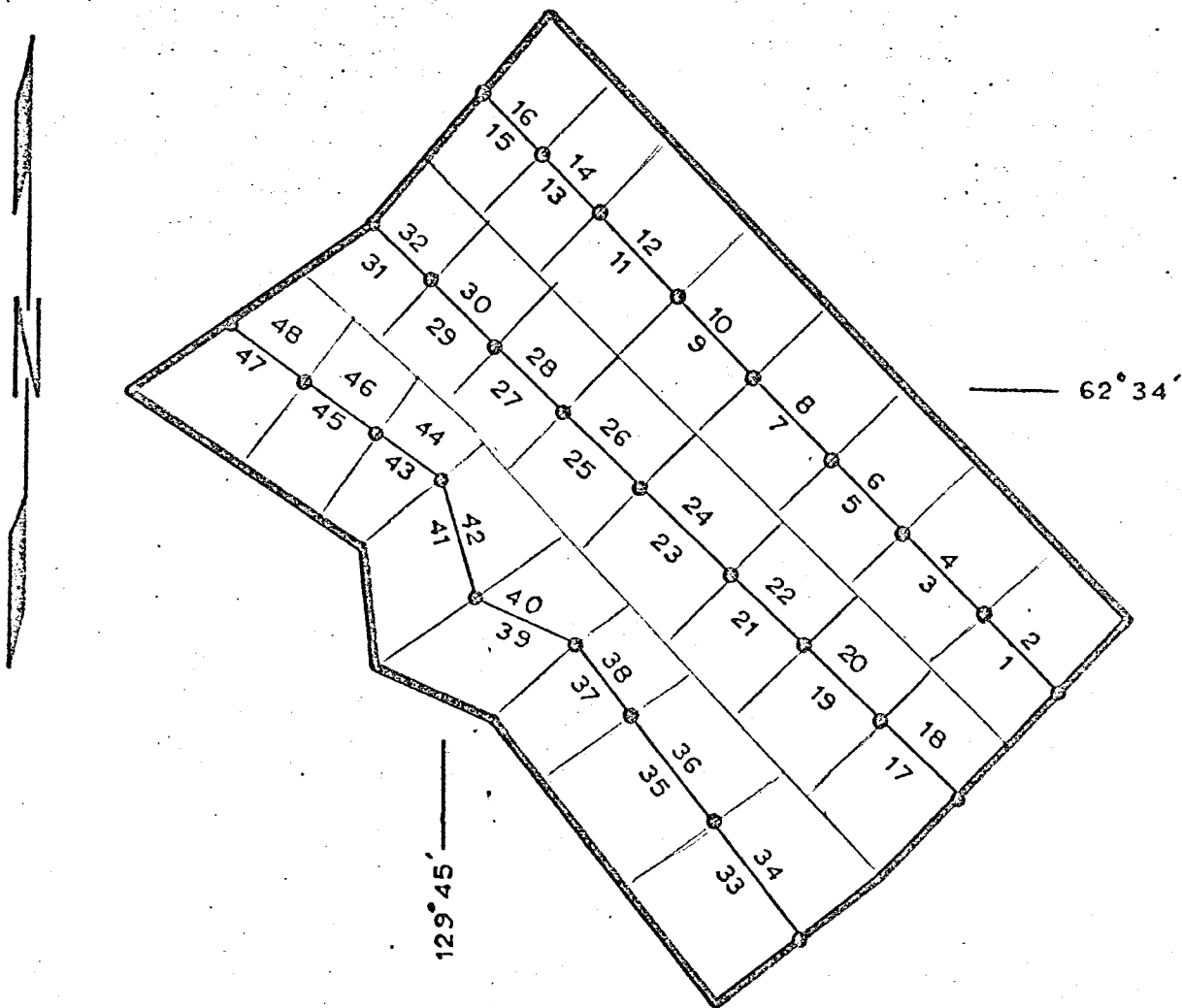
DYNASTY EXPLORATIONS LTD.

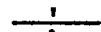

LEGEND

-  claim outline
-  claim post
-  claim line, name

TAM GROUP

claim sketch

N.T.S.: 105 I-12

scale: 1 in. = 1/2 mi.

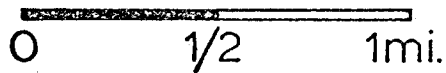

FIGURE: I

DYNASTY EXPLORATIONS LIMITED

330 MARINE BUILDING
355 BURRARD STREET
VANCOUVER 1, B.C.

GEOCHEMICAL REPORT TAM CLAIM GROUP (Tam 2-5, 22)

INTRODUCTION

The Tam 1-48 claim group was staked by Welcome North Mines Ltd. during December, 1972, and was optioned to Dynasty Explorations Limited in the spring of 1973. Dynasty Explorations carried out an exploration program on the claim group during the 1973 field season consisting of geological mapping and geochemical sampling. (See "Geological and Geochemical Report - Tam Claim Group, Y.T." by Colin I. Godwin, November, 1973).

The 1973 mapping indicated that the northeast corner of the claim group may be underlain by the shale-mudstone unit which hosts lead-zinc mineralization in the Howard's Pass area.

The 1973 geochemical sampling of the claim group shows anomalous results to be erratic and often only "spot" highs. Lead is essentially absent; copper has a high background; zinc anomalies are generally explained by hydromorphic dispersion.

A number of marginally anomalous copper and zinc results in reconnaissance soil and silt samples on claims Tam 4, 5 and 22 were not adequately evaluated in 1973. This area may be underlain by the favourable shale-mudstone host unit. A small amount of soil sampling was carried out in this area in September, 1974.

LOCATION AND ACCESS

The 48 claim Tam Group is located approximately 96 miles east-northeast of the town of Ross River, in Yukon Territory, on N.T.S. Map Sheet 105-I-12, at 62°34'N latitude and 129°45'W longitude. The property spans the tree line and is at an average elevation of approximately 4500 feet.

Access to the property during 1974 was by helicopter from the Pas claim group, in the Howard's Pass area, about 17 miles to the east-southeast.

GEOCHEMISTRY (See Figure 2)

Soil samples collected on the Tam Group during September, 1974, were analyzed for copper, lead and zinc at the Acme Analytical Laboratories Ltd. lab at Ross River, Y.T. (Head Office at 6455 Laurel Street, Burnaby 2, B.C.).

Samples were dried and then screened. The minus 80 mesh fraction was retained for analysis. Sample digestion was in hot aqua regia and analysis was by an atomic absorption procedure.

Anomalous geochemical soil sample results, from the 1974 sampling, for copper, lead and zinc are scattered, are of low magnitude, and in most cases are not coincident.

Lead results, as elsewhere on the Tam claims, are generally very low. The highest 1974 result (98 ppm) is from an isolated sample with no coincident high copper or zinc results. The next highest lead value is only 46 ppm.

Copper results greater than 120 ppm and zinc results greater than 1000 ppm are scattered within the sampled area. Anomalous

copper results tend to form clusters, while anomalous zinc results tend to be more scattered. Generally, high copper and zinc results are not coincident.

There is good bedrock and rubble exposure in the area of most of the higher soil sample results. No indication of significant sulphide mineralization was encountered.

CONCLUSIONS AND RECOMMENDATIONS

The 1973 exploration program and the small amount of fill-in soil sampling done on the Tam claims in 1974 did not define any areas on which further work is warranted.

Respectfully submitted,

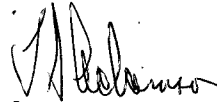

Thomas J. Adamson,

December, 1974

QUALIFICATIONS

I, THOMAS J. ADAMSON, of 3842 West 23rd Avenue, Vancouver, B.C., hereby certify that:

1. I am a graduate of the University of British Columbia, (B.Sc., Geology, 1967).
2. I have been engaged in mining exploration in Canada, as a geologist, since 1967.
3. I am an Associate Fellow of the Geological Association of Canada.
4. I have been employed by Dynasty Explorations Limited for a total of six years, the latest period since January, 1973.
5. I personally worked on this property during the 1974 field season.



Thomas J. Adamson

Dec. 18, 1974
Date

LIST OF PERSONNEL

T. J. Adamson	Geologist-Party Chief	330-355 Burrard St., Vancouver, B.C.
Robert Downs	Geochem Sampler	1231 Woodlands, Nanaimo, B.C.

SUMMARY OF COSTS
(January 1 - October 31, 1974)

Schedule "A"

	<u>Schedule No.</u>	<u>Total</u>
Salaries and Wages	"B"	\$ 63.87
Assays	"C"	119.81
Field Equipment	"D"	2.09
Camp Maintenance	"E"	14.32
Fuel	"F"	29.37
Rotary Wing	"G"	203.72
Fixed Wing	"H"	12.58
Miscellaneous Transportation	"I"	<u>2.08</u>
		\$447.84
District Expense 5%		<u>22.39</u>
		\$470.23
Administration 10%		<u>47.02</u>
		<u>\$517.25</u>

Note: Copies of invoices in excess of \$100.00 have been included. Copies of other invoices will be provided upon request.

DYNASTY EXPLORATIONS LIMITED

330 MARINE BUILDING
355 BURRARD STREET
VANCOUVER 1, B.C.

AFFIDAVIT SUPPORTING SUMMARY OF COSTS

I, THOMAS J. ADAMSON, Geologist, Dynasty Explorations Limited, of Vancouver, British Columbia, do hereby state that, to the best of my knowledge and belief, the statement of costs presented in this report (Geochemical Report - Tam Claim Group) is both correct and true.

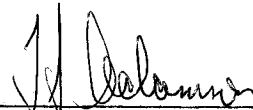

Thomas J. Adamson,

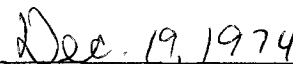

Date

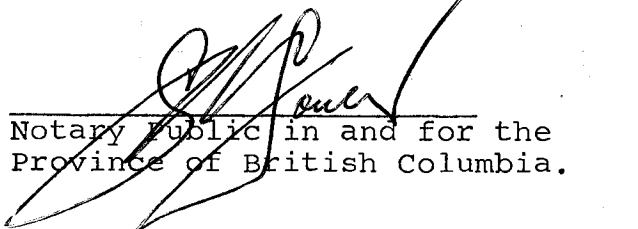

Notary Public in and for the
Province of British Columbia.



LEGEND

- claim outline
- claim post
- claim line name

• SOIL SAMPLE SITE (Cu, Pb, Zn ppm)

- : Cu > 120 ppm
- : Pb > 50 ppm
- : Zn > 1000 ppm

DYNASTY EXPLORATIONS LTD

TAM GROUP

1974 Geochem results

NTS 105-1-12

Scale: 1 in. = 1/4 mi.

0 1/4 1/2 1 mi.

MAP 2

A12245-381