

B.L. O.R.

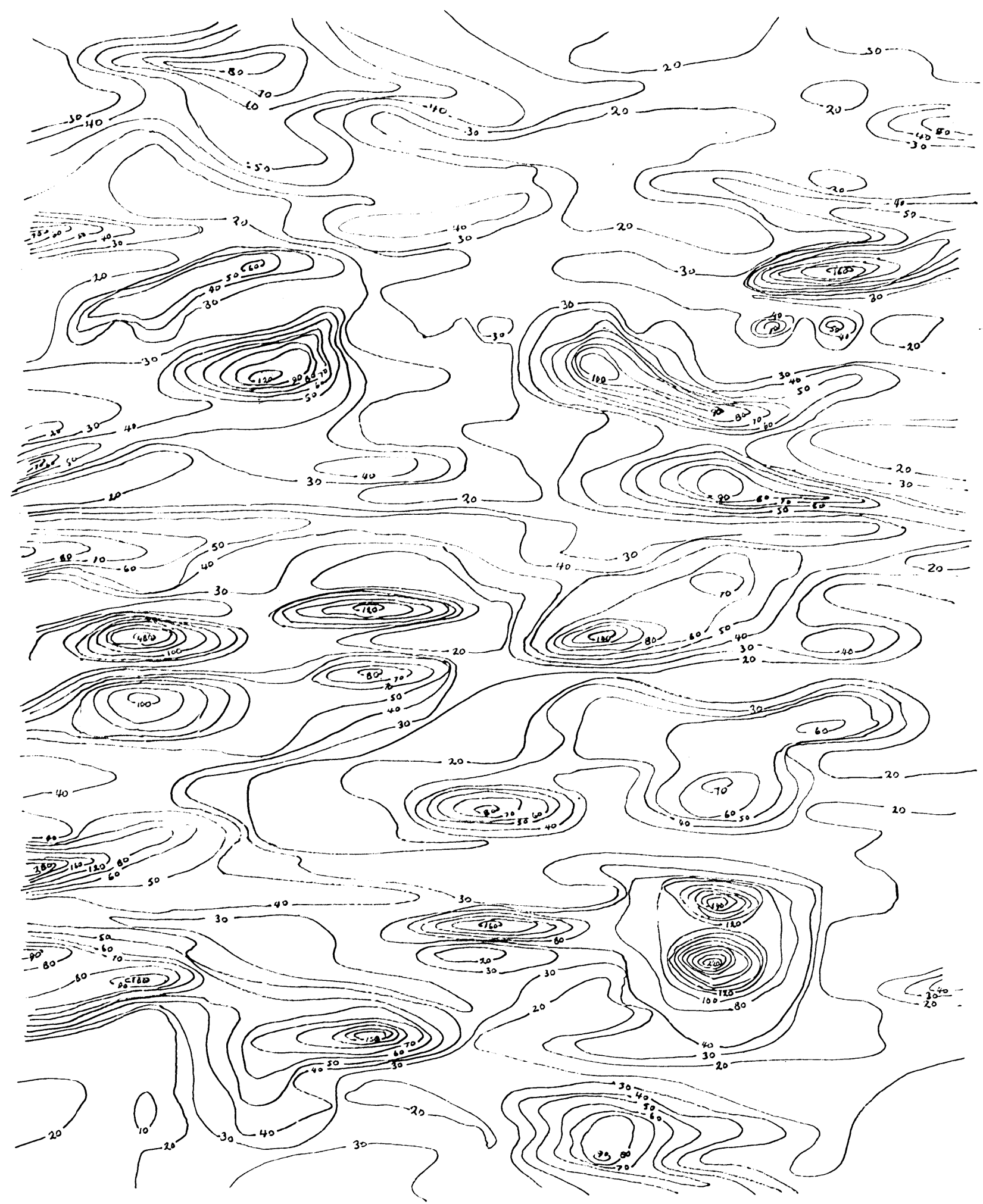

60 E. B.L.

ATLAS EXPLORATIONS LTD
ROSS RIVER, YUKON.
PIKE EXTENSION Cu

DRAWING No: T11052/18	SCALE: 1" = 400'
DRAWN BY: J.N.B	DATE: 23rd. AUG, 1966

B.L. O.R.

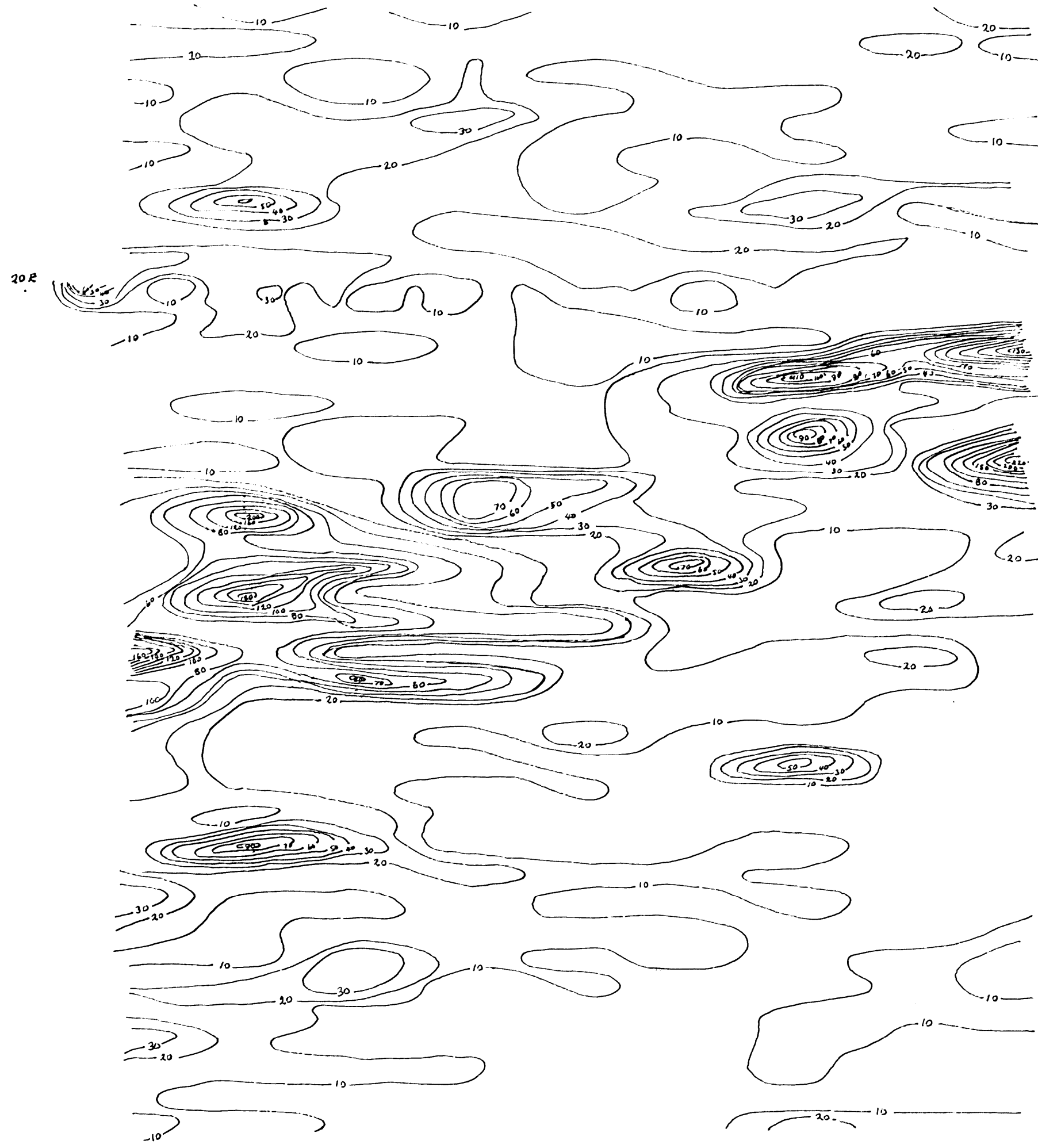

605 B.L.

ATLAS EXPLORATIONS LTD.
ROSS RIVER, YUKON.
PIKE EXTENSION Pb.

DRAWING No: T/1055/19 SCALE: 1" = 400'
DRAWN BY: J.N.B. DATE: 26th. AUG, 1966

B.L. 0.E.

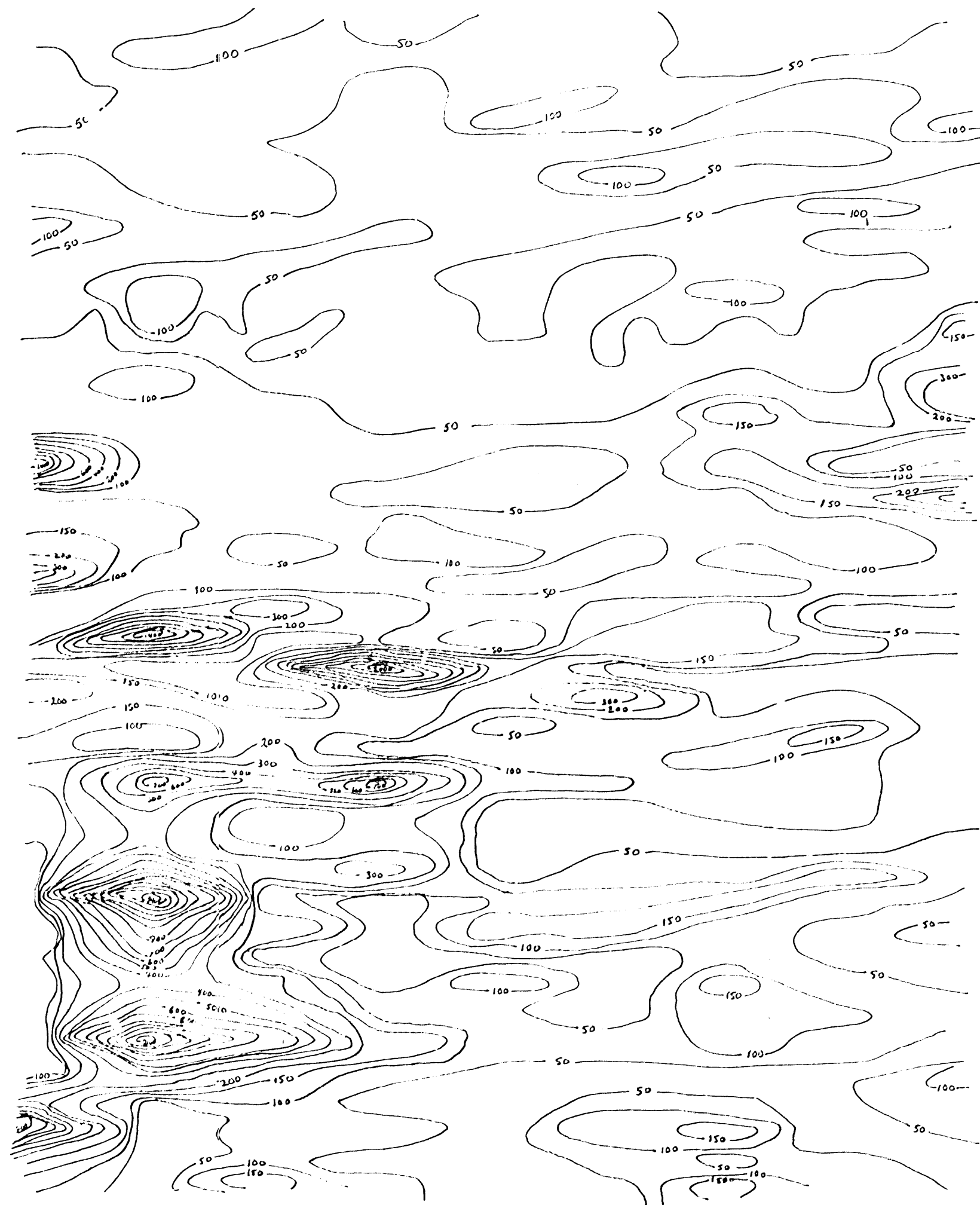

60 E. B.L.

ATLAS EXPLORATIONS LTD
ROSS RIVER, YUKON.
PIKE EXTENSION Zn.

DRAWING No: T/1053/17 SCALE: 1 = 400
DRAWN BY: J. N. B. DATE: 22nd AUG, 1966

PIKE GEOCHEM ANOMALIES

--- G (>150 ppm)
--- Pb (>20 ppm)

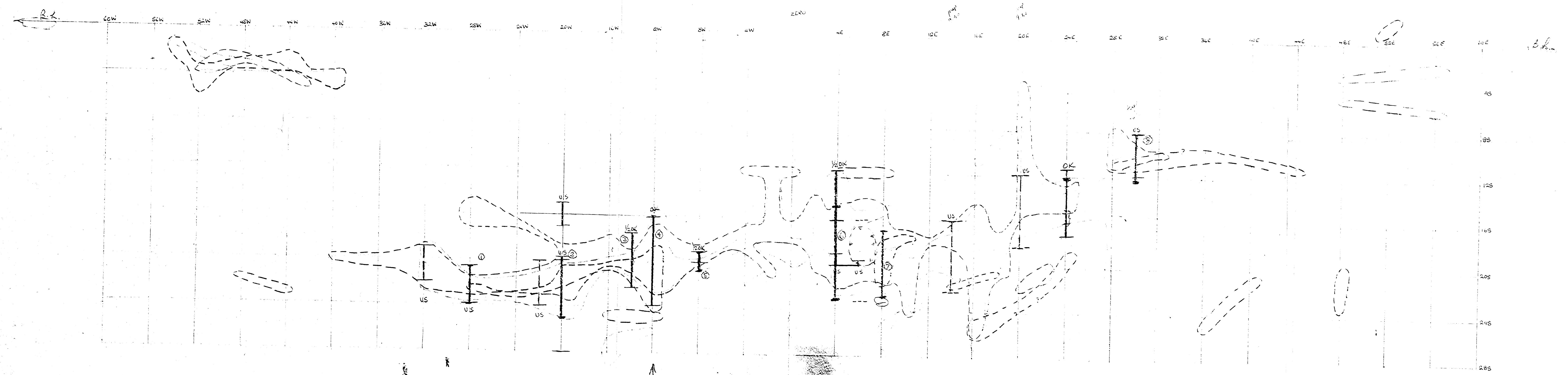

REVISED: SEPT 28/66

PIKE - WYOMING - U.S. GEOLOGICAL SURVEY - 1966

- - - - - COPPER 20 ppm (90 ppm)
 - - - - - LEAD 10 ppm (40 ppm)

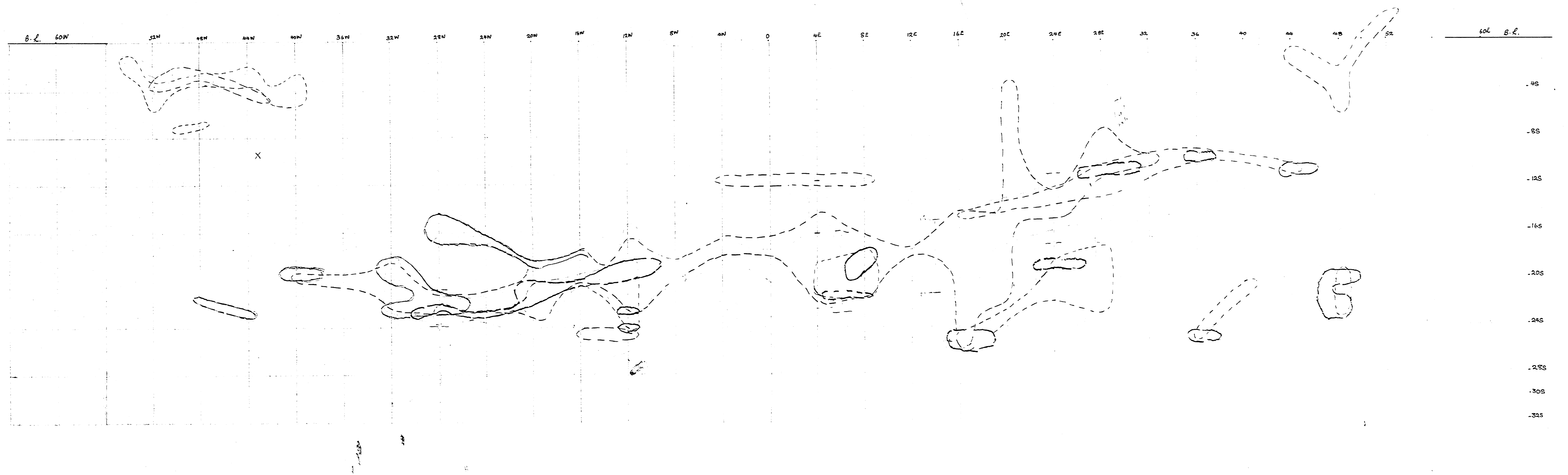

COMPOSITE GEOCHEM ANOMALOUS AREAS
 PIKE GROUP
 SCALE 1" = 400'

PIKE-VANADINE GROUP GEOCHEM

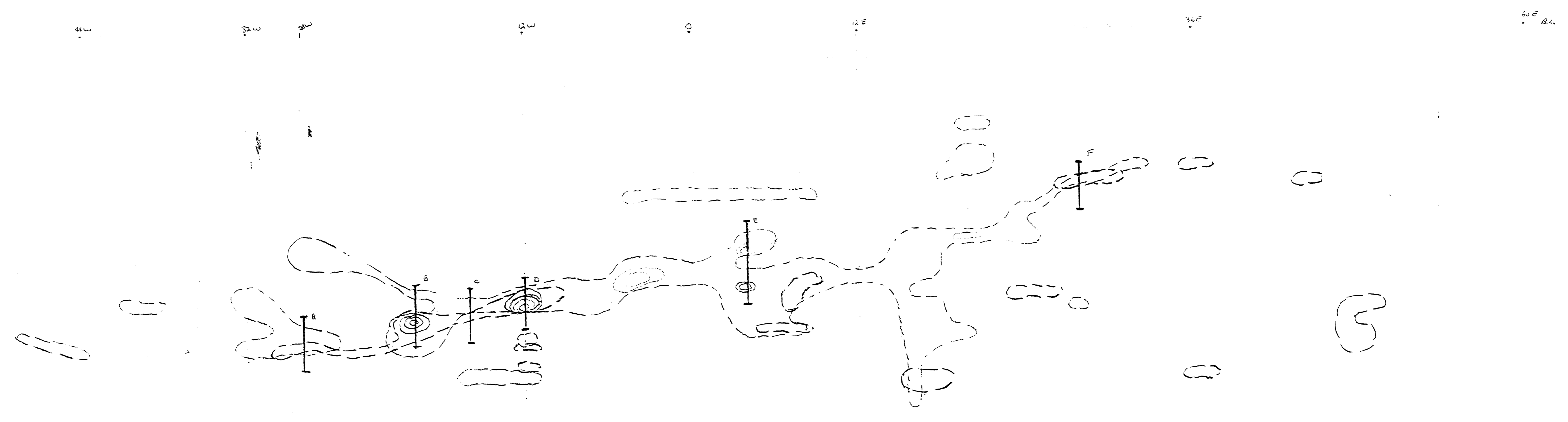

LEGEND

- - - Anomalous Copper > 120 ppm
- - - Anomalous Lead > 90 ppm
- - - Anomalous Zinc > 250 ppm

WJR

Outline of romified geochemical anomalous zones
with proposed trenches A → F [on theoretical grid].

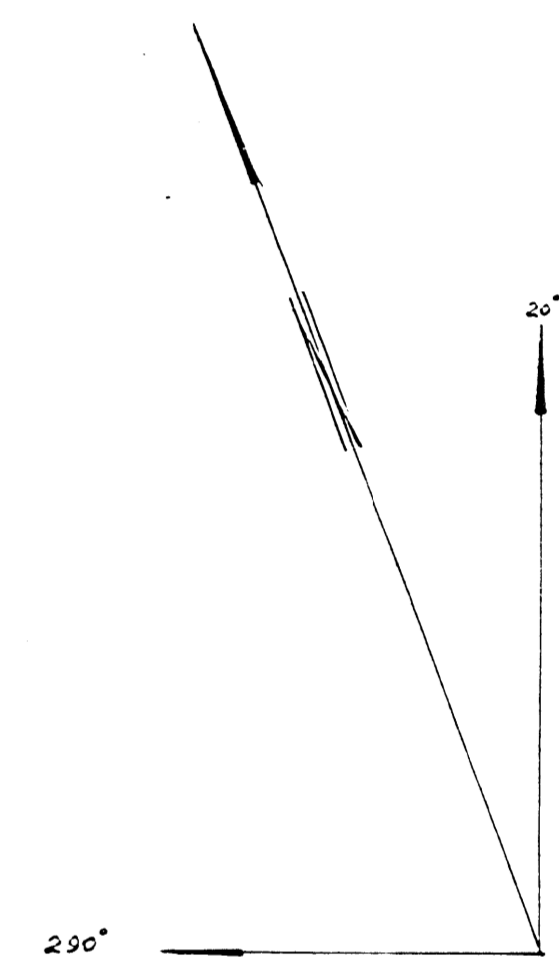
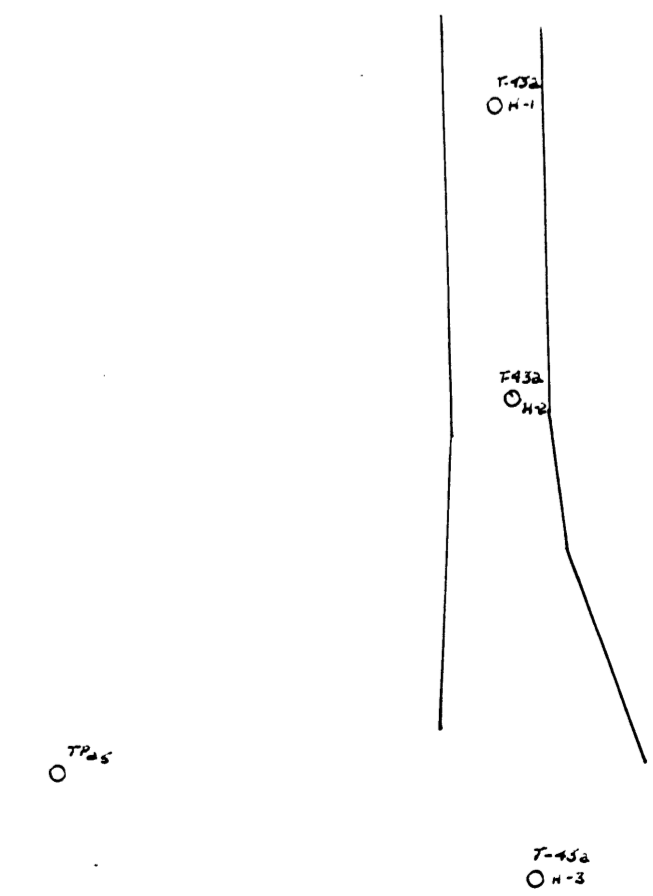
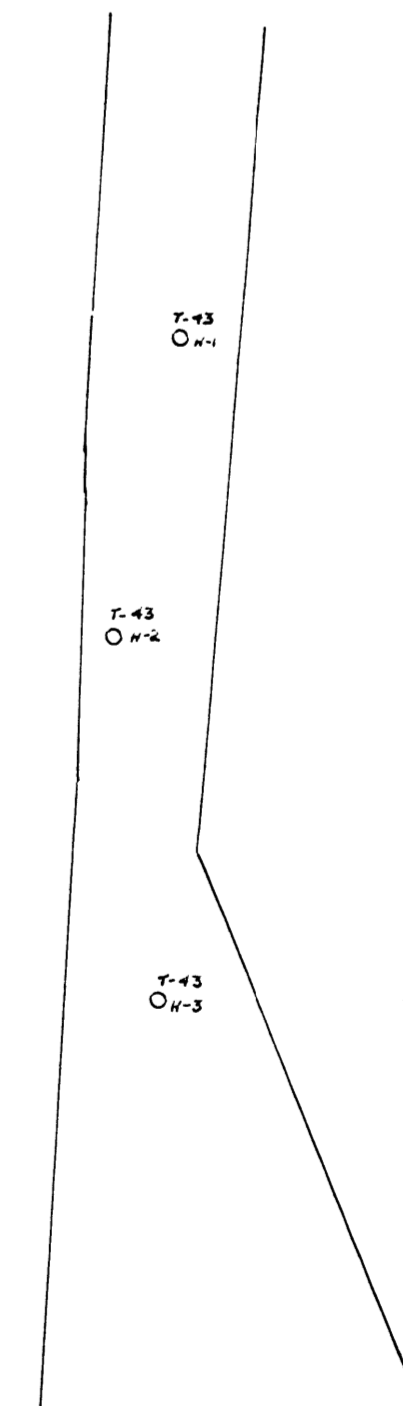
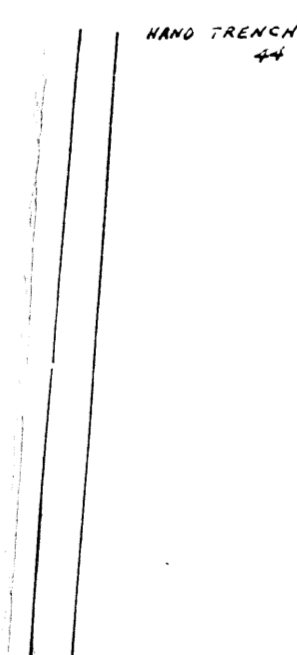
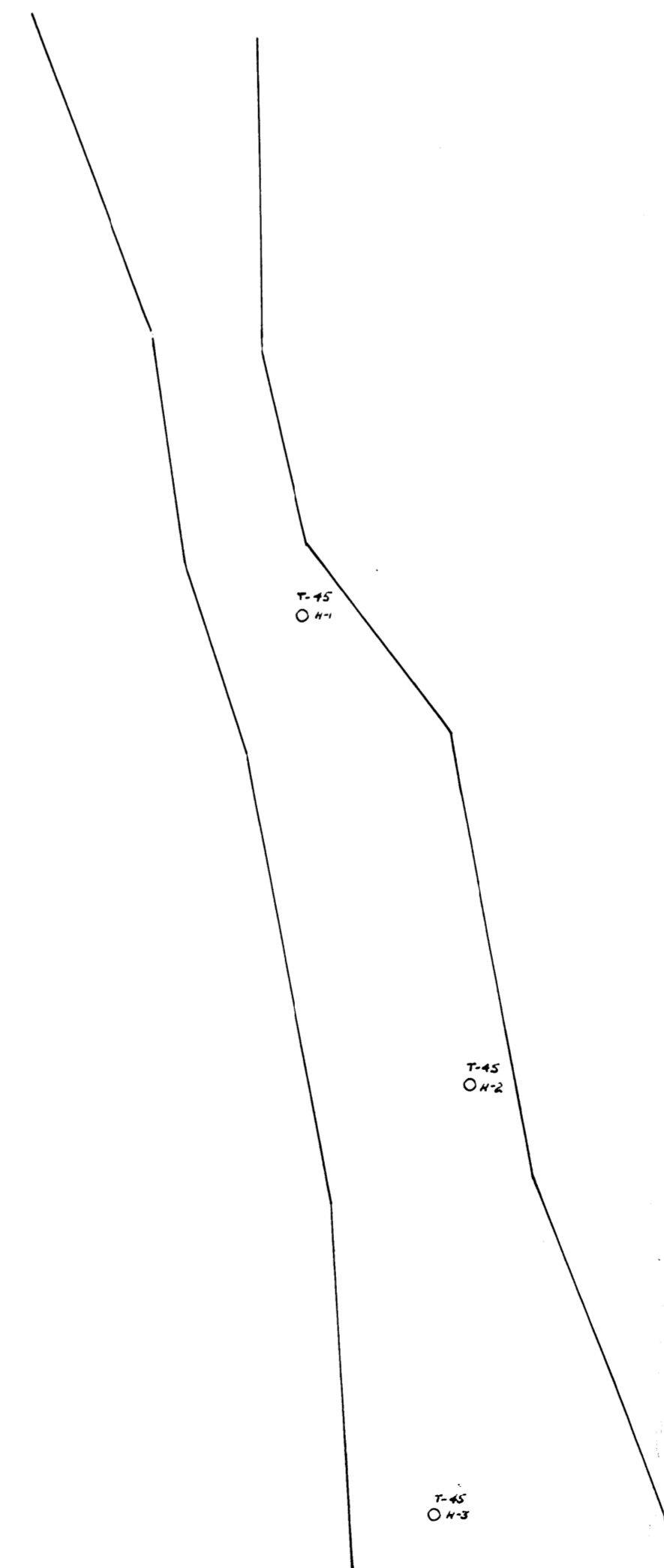
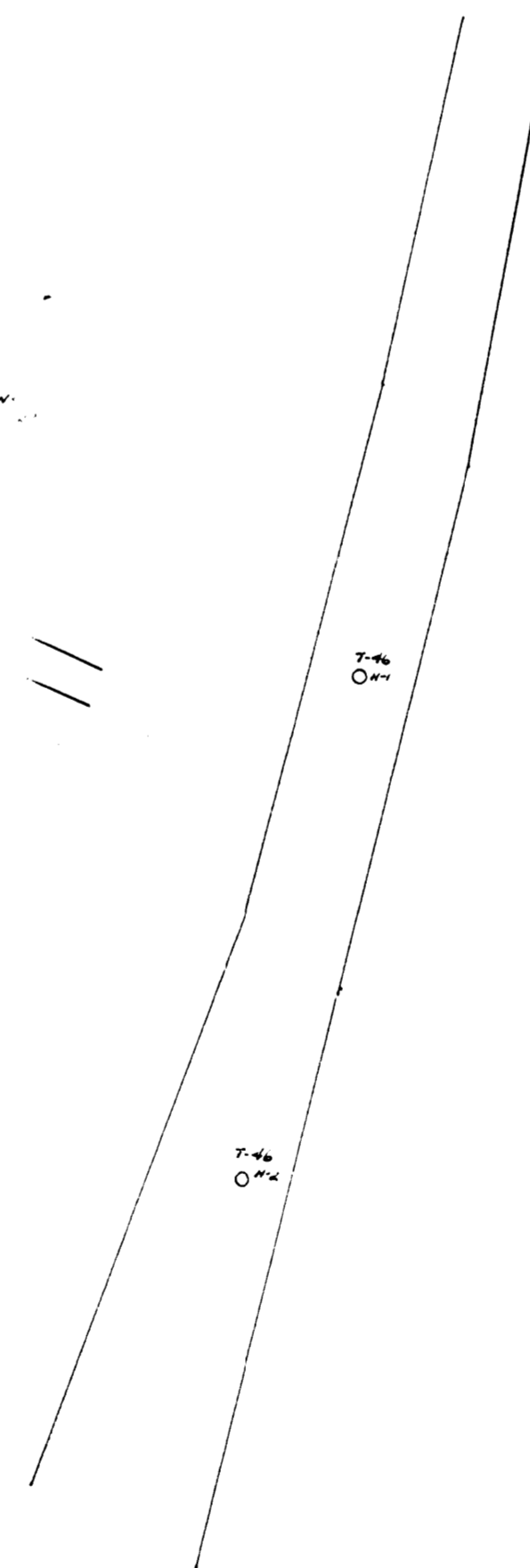
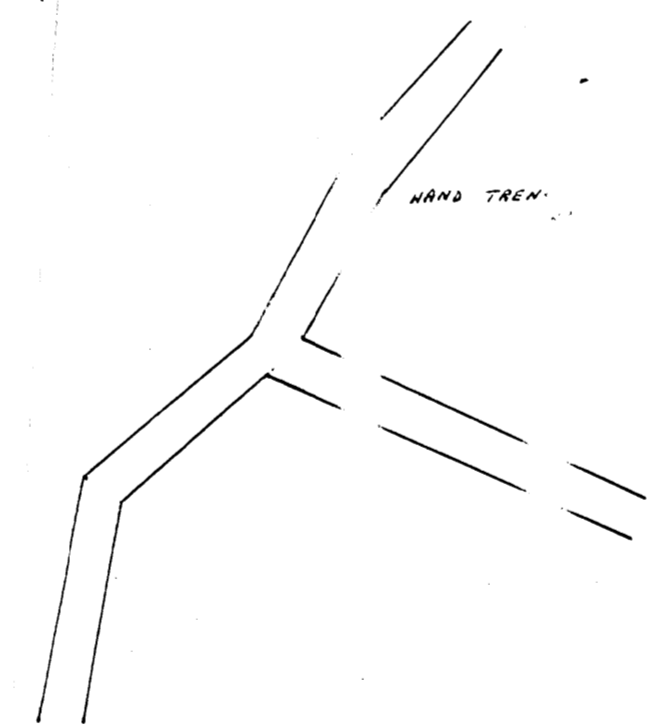
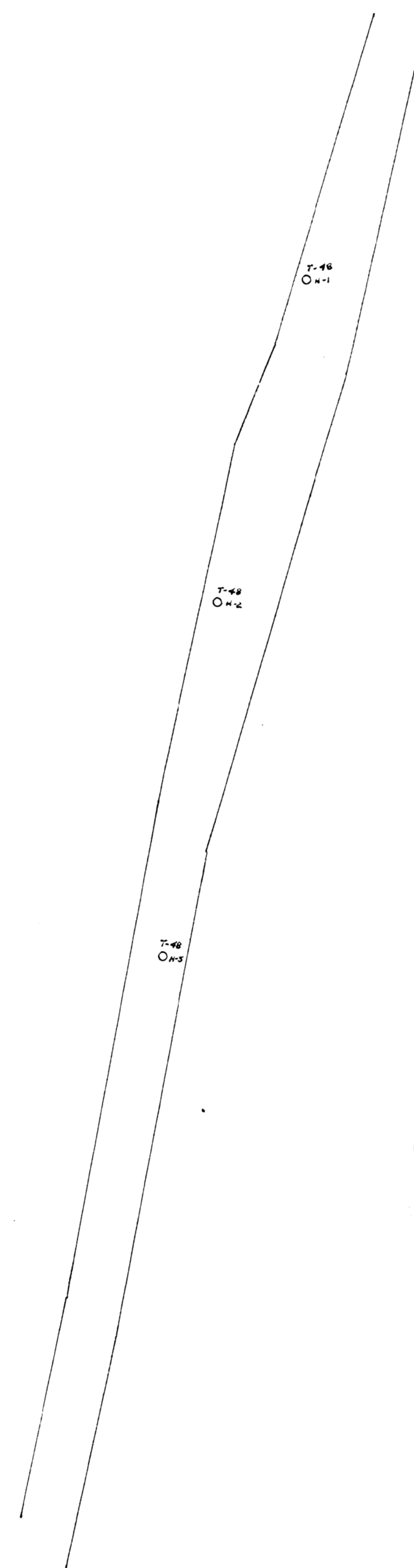
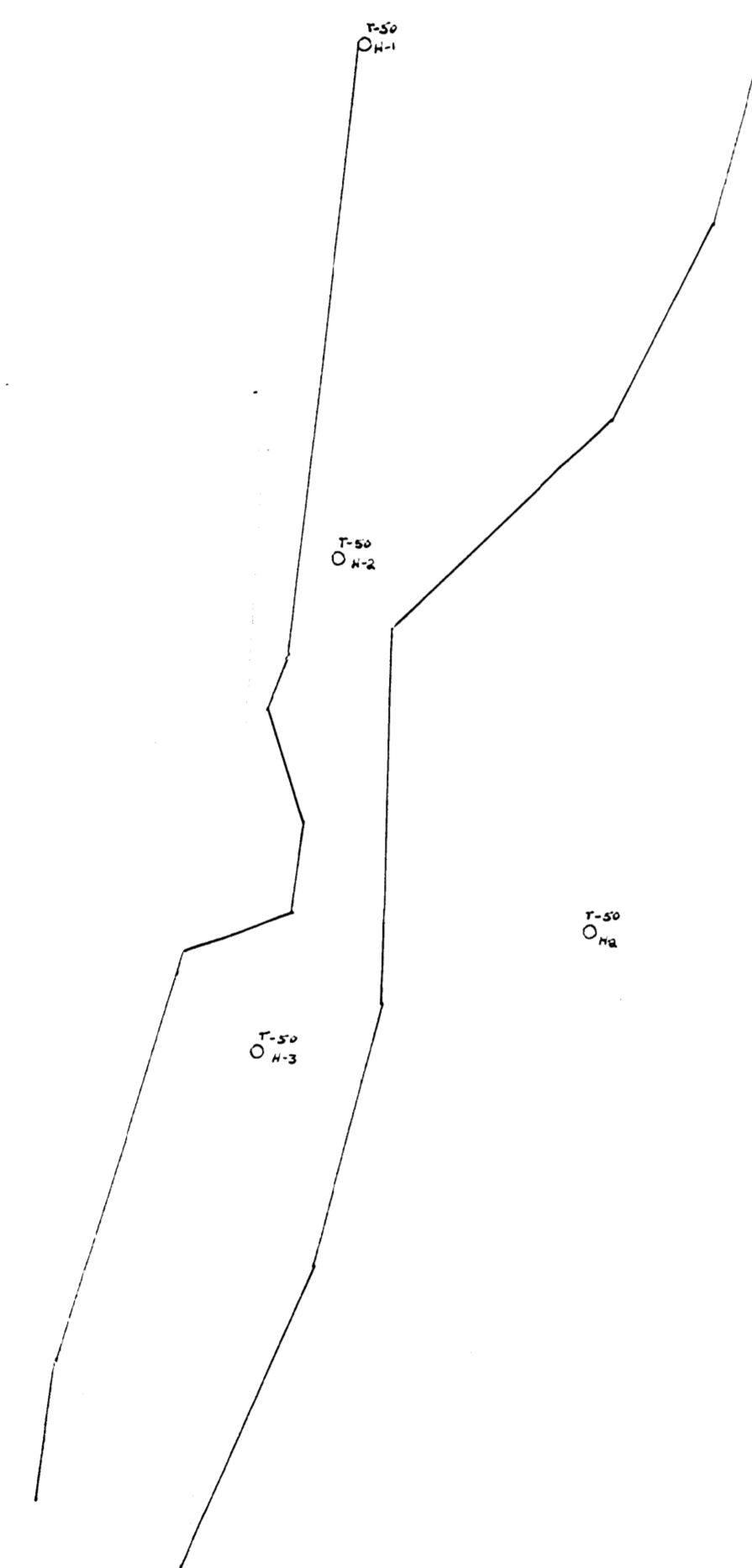
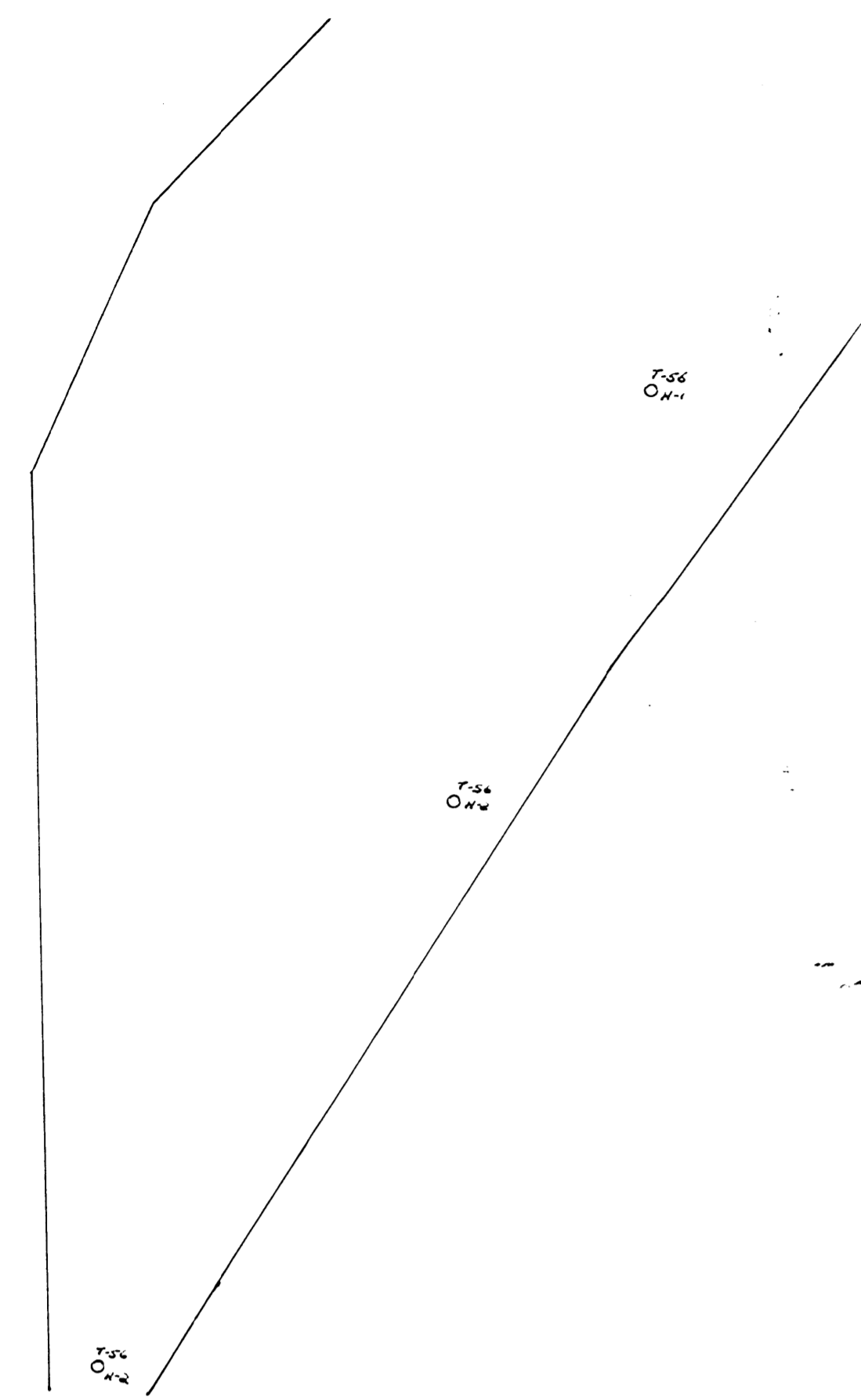

ATLAS EXPLORATIONS LTD
 VANCOUVER, B.C.
 PIKE MINERAL CLAIMS
 GEOCHEM. ANOMALOUS ZONES

INSTRUMENT USED FOR ANALYSIS: A.A.S. UNIT
 COPPER VALUES OVER: 120 p.p.m.
 LEAD: 30 p.p.m.
 ZINC: 250 p.p.m.
 SCALE: 1" = 400'
 DATE: NOV. 17, 1966
 DRAWN BY: J.V.S. CLAIM POST: PIKE 4-12
 3-11

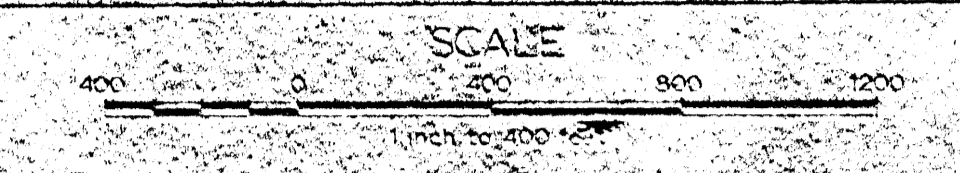

TRENCH LOCATION MAP



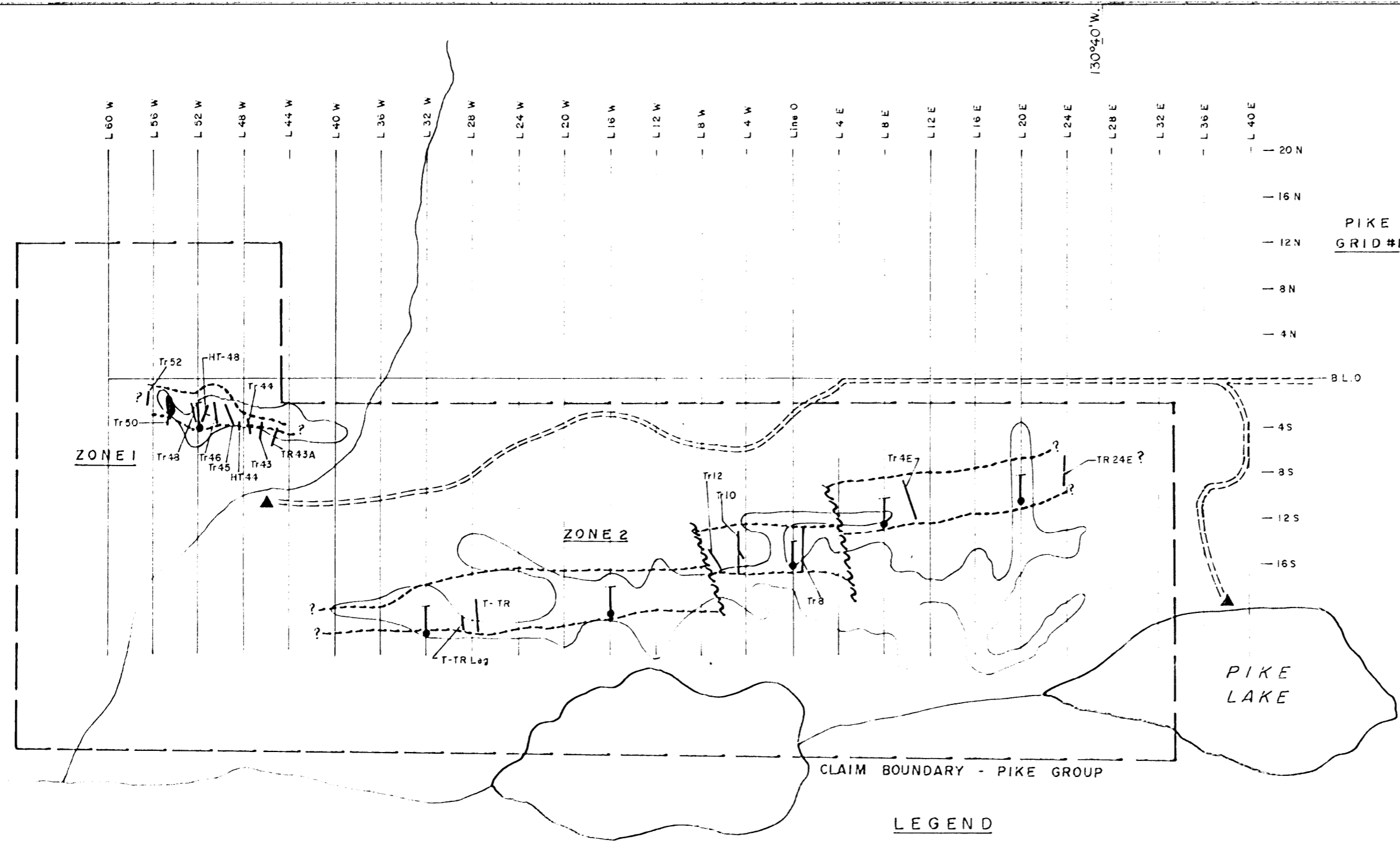

TRENCH SAMPLING RESULTS

TRENCH No.	INTEVAL	LENGTH	AVERAGE % Cu	AVERAGE Ag(O3/T)
24E	170' - 205'	35'	Tr	4.33
43	45' - 90'	45'	0.57	1.44
43A	20' - 58'	38'	0.69	1.50
HT 44	5' - 55'	50'	0.40	0.93
46	25' - 45'	20'	0.45	1.20
48	0' - 135' or 10' - 80'	135' 70'	0.36 0.44	2.58 3.86
50	0' - 120' or 25' - 60'	120' 35'	0.29 0.61	1.59 2.48
T-TR Leg	0' - 25'	25'	1.48	2.91
T-TR	25' - 88'	63'	1.21	2.20

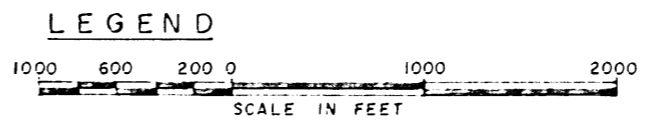

ATLAS EXPLORATIONS LIMITED
SHELDON PROJECT
PIKE GROUP
COMPILATION MAP

DATE NOV. / 74 NTS-105-J-2

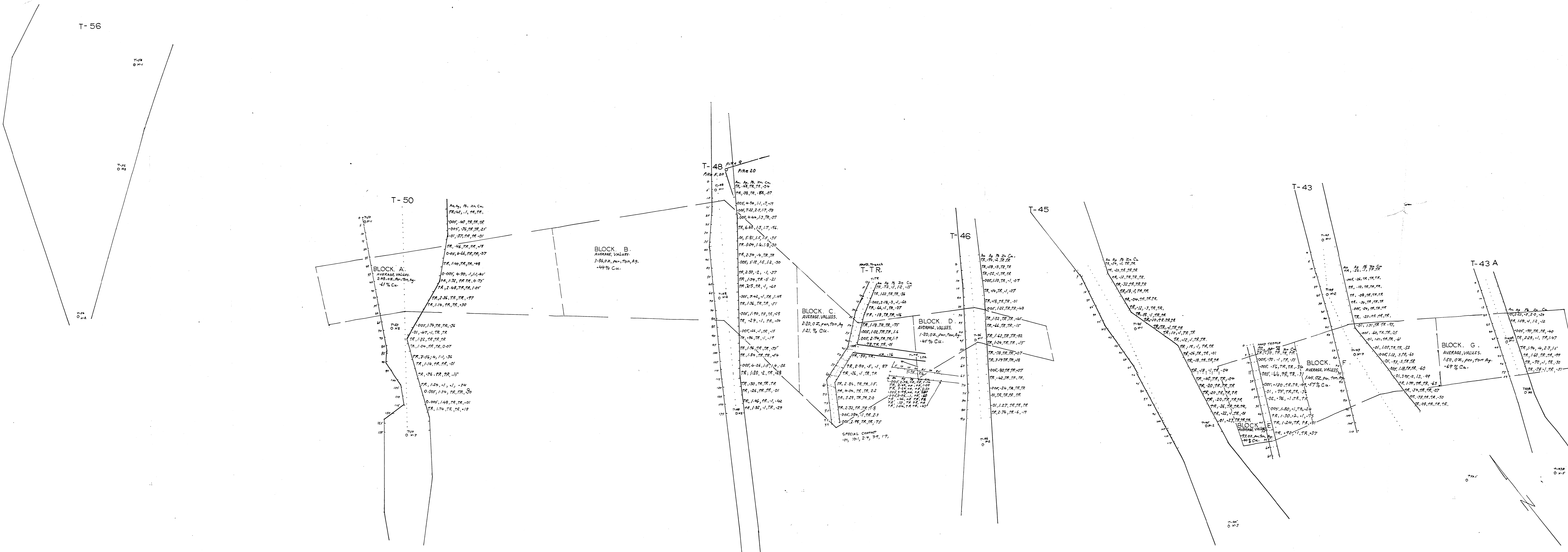

ATLAS EXPLORATIONS LTD.
 ROSS RIVER YUKON.
 PIKE LAKE AREA.
 PIKE MINERAL CLAIMS
 ASSAY RESULTS FOR Au, Ag, Pb, Zn, & Cu,
 ZONE 1.

Scale, 1" = 20'
 Sampler, T. Skonseng.
 Assayer, Whitehorse, Assay Office.
 G. Spalding.
 Party Chief, C. L. Smith. Pike claim F.20
 Date, Oct. 1966.
 Drawn by, *[Signature]*

