

110 3211  
18031  
18031

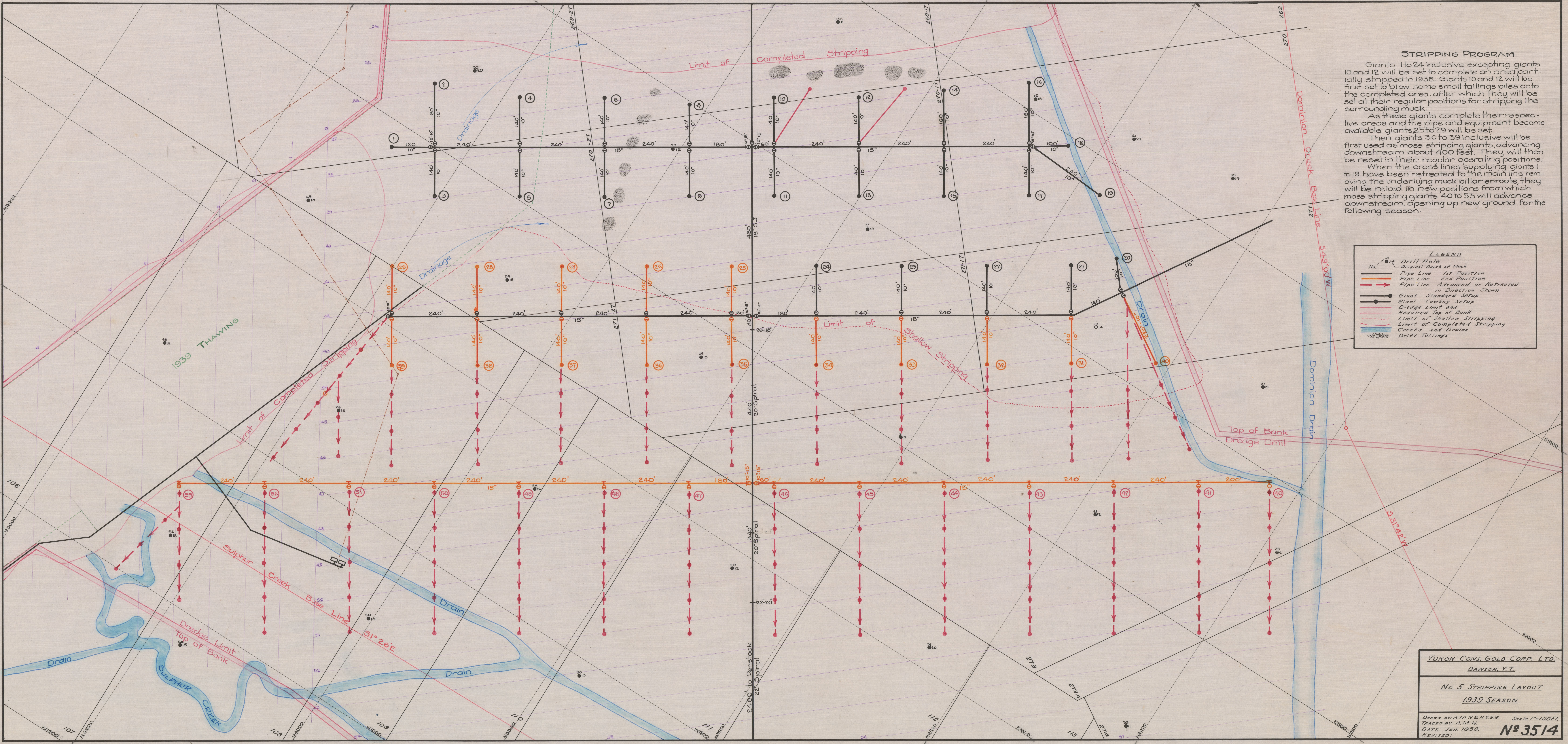

**STRIPPING PROGRAM**

Giants 1 to 24 inclusive excepting giants 10 and 12 will be set to complete an area partially stripped in 1938. Giants 10 and 12 will be first set to allow some small tailings piles onto the completed area, after which they will be set at their regular positions for stripping the surrounding muck.

As these giants complete their respective areas and the pipe and equipment become available giants 25 to 29 will be set.

Then giants 30 to 39 inclusive will be first used as mass stripping giants, advancing downstream about 400 feet. They will then be reset in their regular operating positions.

When the cross lines supplying giants 1 to 19 have been retreated to the main line removing the underlying muck pillar enroute, they will be reset in new positions from which mass stripping giants 40 to 53 will advance downstream, opening up new ground for the following season.

**LEGEND**

- Drill Hole
- No. Original Depth of Muck
- Pipe Line 1st Position
- Pipe Line 2nd Position
- Pipe Line Advanced or Retreated in Direction Shown
- Giant Standard Setup
- Giant Cowboy Setup
- Dredge Limit and Required Top of Bank
- Limit of Shallow Stripping
- Limit of Completed Stripping
- Creeks and Drains
- Drift Tailings

YUKON CONS. GOLD CORP. LTD.  
Dawson, Y.T.

No. 5 STRIPPING LAYOUT  
1939 SEASON

Drawn by: A.N.N. & H.G.W. Scale 1"=100'  
Traced by: A.M.W.  
DATE: Jan. 1939  
REVISED: **No 3514**