

Plan showing Area Dredged to Dec. 31st 1923.

Granville Flat Y.T.

Dredge North West No. 2.

Scale - 200' = 1 inch.

Barn
Todd's Note

1/2 Drill Hole
Total Depth Value per
Cubic Yards

Depth Note Thickness Ground to B.P.
Value Ground to B.P.
2/1 yd

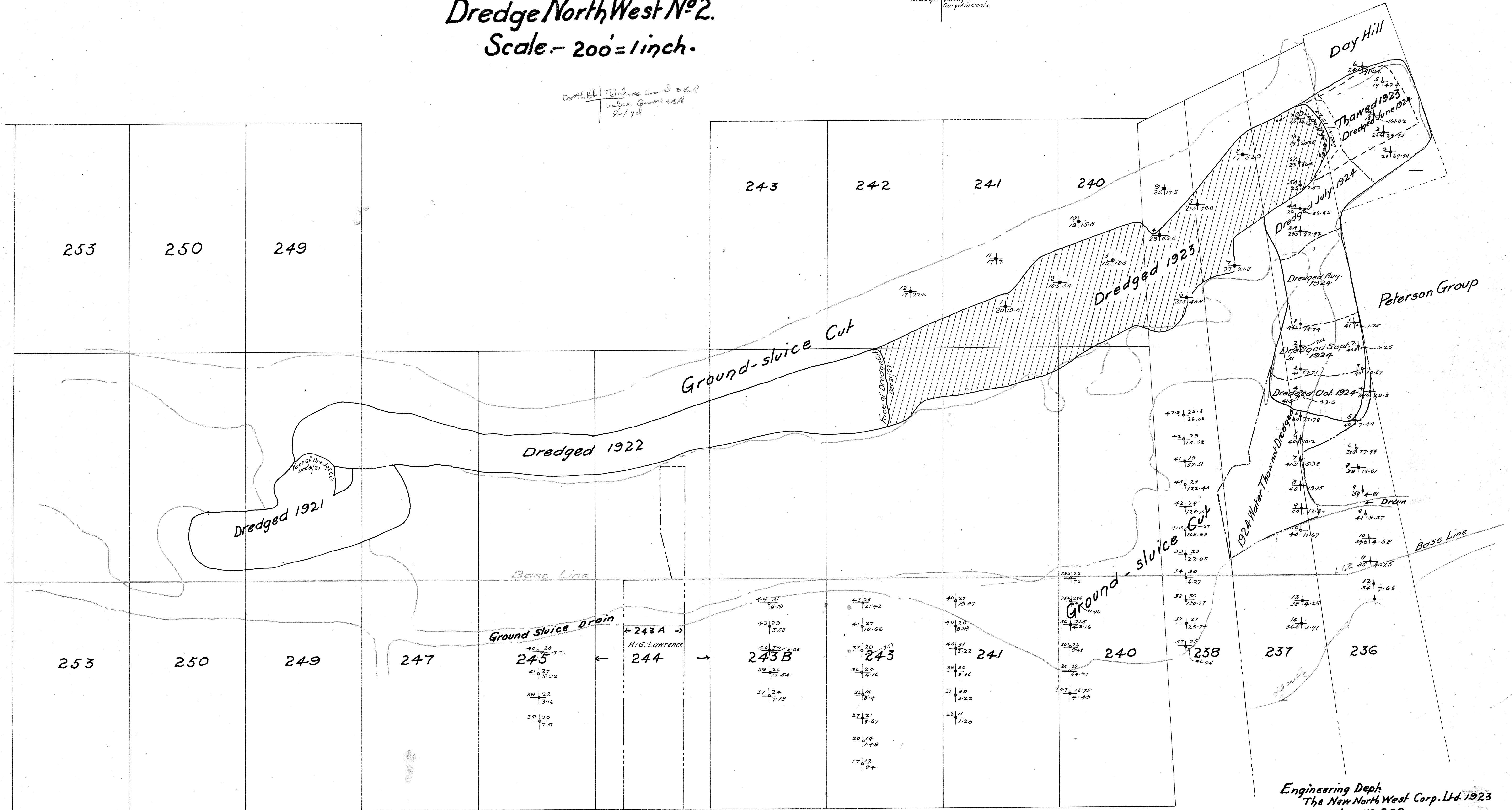

Engineering Dept.
The New North West Corp. Ltd. 1923
Plan No 288