

STRIPPING PROGRAM

Giants 1 to 25 will cover an area having a few scattered tailings piles. These setups will be permanent until the muck surrounding the tailings piles has been stripped to grade. Then secondary setups, not shown, will be made to blow the tailings into the stripped area and remove the underlying muck.

Giants 26 to 70 will be operated similarly to giants 1 to 25.

The pillars of muck underlying the pipelines will be removed as the pipelines are retreated. As each cross pipe line is dismantled, it will be moved to and set up at the next downstream available main line outlet.

LEGEND

- Required Top of Bank
- - - Present Dredge Limit
- Present Top of Bank
- Stripping Completed
- Tailings on Muck
- Shallow Limit of Stripping
- Creek or Drain
- Pipe Lines - 1st Step
- " " 2nd "
- " " 3rd "
- Giant
- Prospect
- Valve
- drill hole with no. above & feet of muck at right.

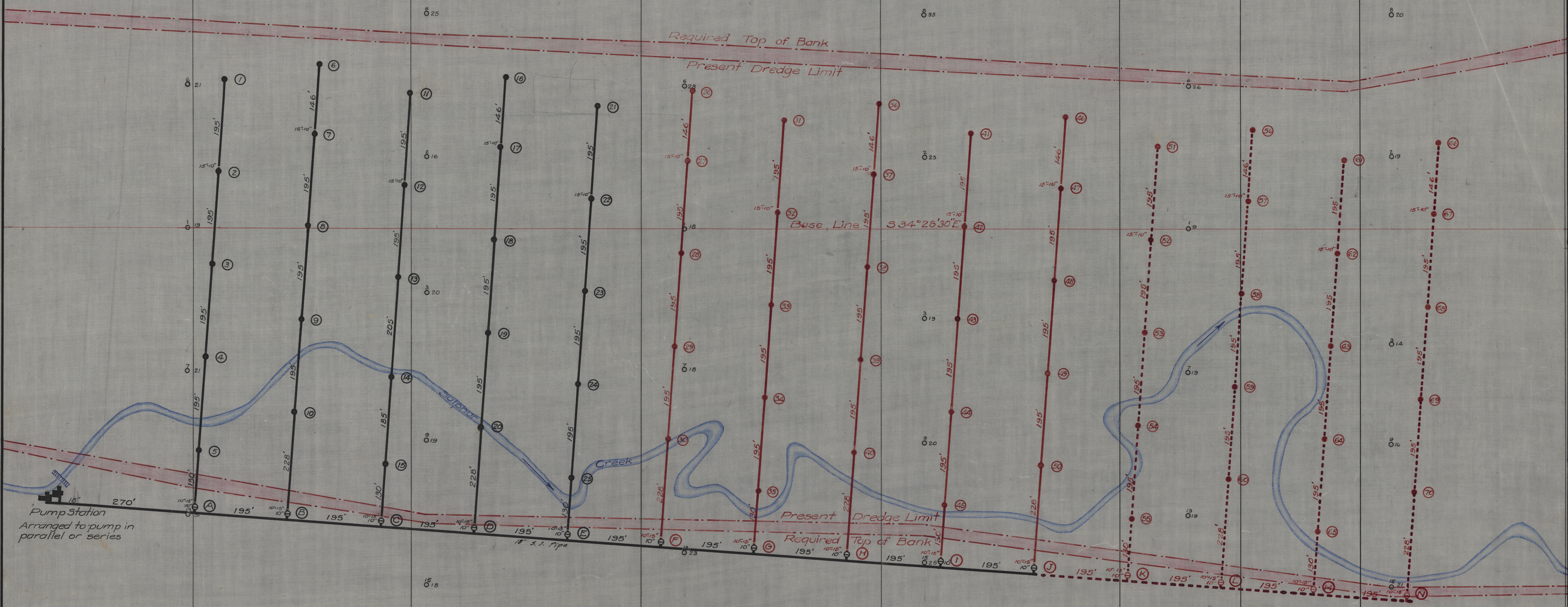
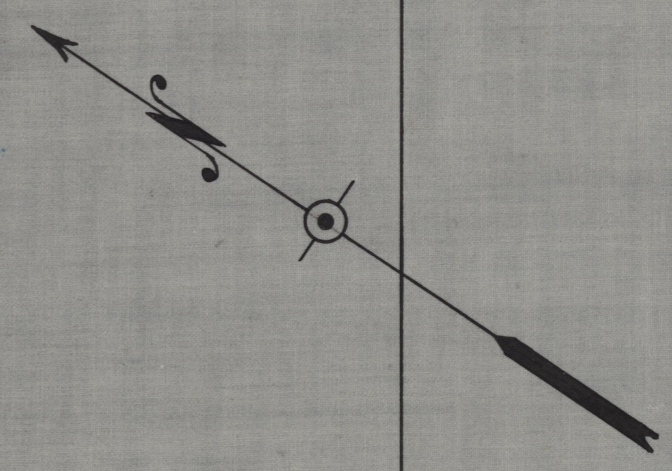

Pump Station
Arranged to pump in parallel or series

YUKON CONSOLIDATED GOLD CORP.
DAWSON Y. T.

STRIPPING LAYOUT
SULPHUR
SEASON 1936

DRAWN BY A.M. Nordale
DATE Jan. 8, 1936
REVISED

SCALE 1" = 100'
No. 3503

48

49

50

51

52

53

53A

54