

Ms 4025  
15938  
1835

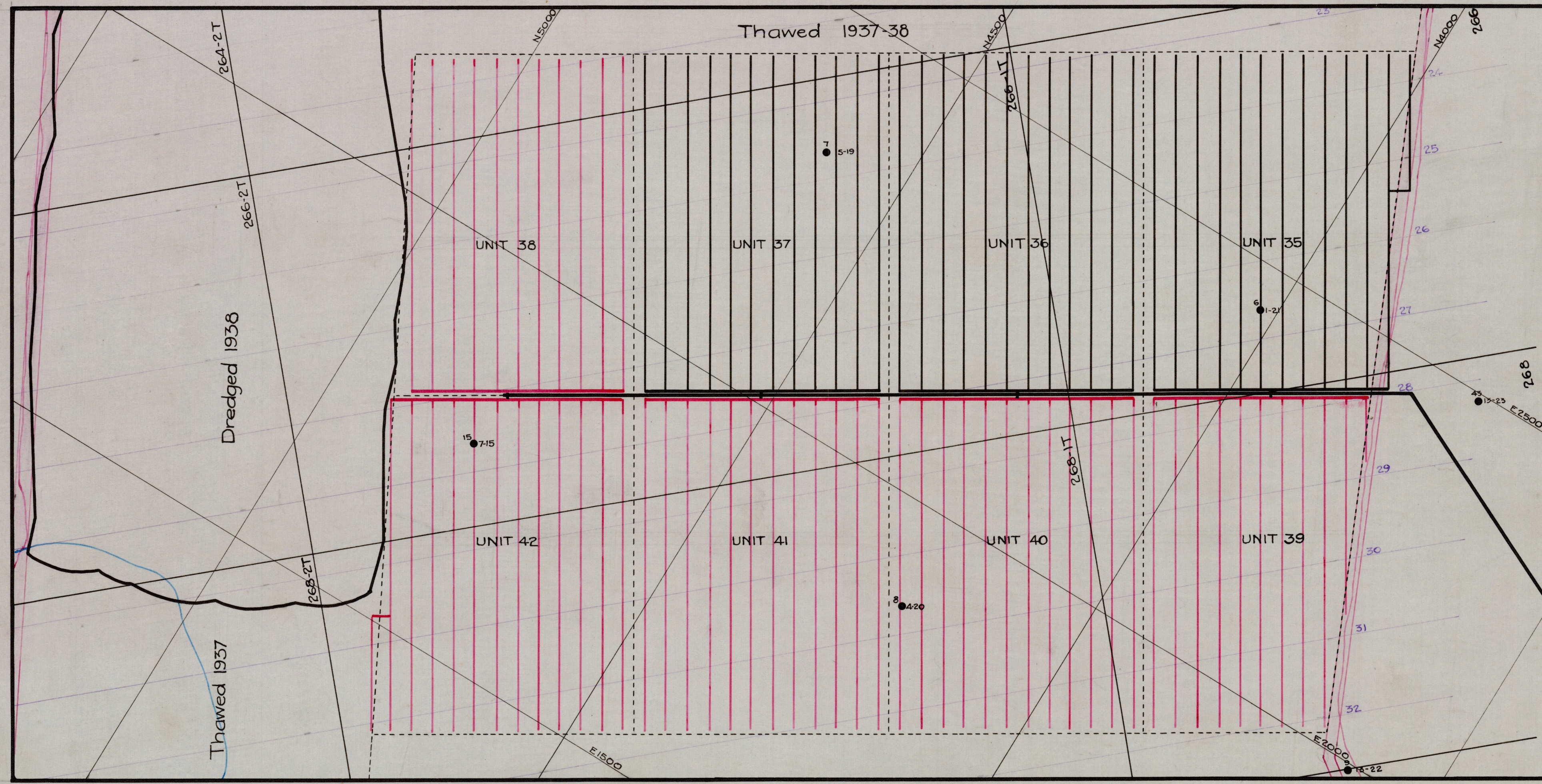

DRIVING DATA

UNIT	AREA Sq.Yds.	No. of POINTS	AVERAGE DEPTHS			TOTAL FOOTAGE	VOLUME CU.Yds.
			MUCK	GR.	Bk		
35	15791	642	2	22	2	15408	136855
36	16182	660	3	20	1	15180	134650
37	16182	660	6	20	1	17160	151032
38	14471	598	6	19	1	14950	130311
39	13054	530	2	21	1	12190	108783
40	16182	660	4	20	1	15840	140244
41	16182	660	5	19	1	15840	140244
42	15889	650	6	18	1	15700	137705
TOTAL	123933	5060				122268	1080024

Probable driving rate per 9hr. shift 100 ft.  
 Probable driving season May 10 to Aug. 20 102 days  
 Order in which units will be driven 35-36-37-38-39-40-41-42  
 Driving crew required Feet ÷ (Days × Rate) 12 men

**LEGEND**

- 4-20 Drill Hole
- Thawed
- Frozen Part Thawed
- Depth of Gravel
- Depth of Remaining Muck
- Pipe Line 1st Position
- Pipe Line 2nd Position
- - - Unit Boundary
- Dredge Limit and Top of Stripping Bank (Theor.)
- Top of Stripping Bank (Actual)
- Creeks and Drains
- Power Lines
- Outline of Dredge Cut

Point Spacing 16 ft Centres  
 YUKON CONS. GOLD CORP. LTD.  
 DAWSON, Y.T.  
 No. 5 THAWING LAYOUT  
 1939 SEASON  
 DRAWN BY: A.M.N. & H.V.G.W. Scale 1"=100 FT.  
 TRACED BY: A.M.N.  
 DATE: Jan. 1939  
 REVISED:  
 No 4025