

LEGEND

Scale - 1" = 1/2 Mile - Contour Interval 100 Feet

Claims owned by Consolidated Lone Star Ltd. shown in Red.

Dredged Areas shown [stippled symbol]

Creeks shown [wavy line symbol]

Roads shown [double line symbol]

Claims adversely owned shown in green

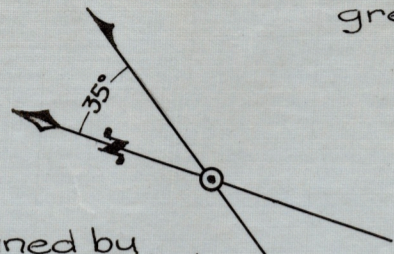

Claims owned by Yukon Consolidated Gold Corp. shown in orange

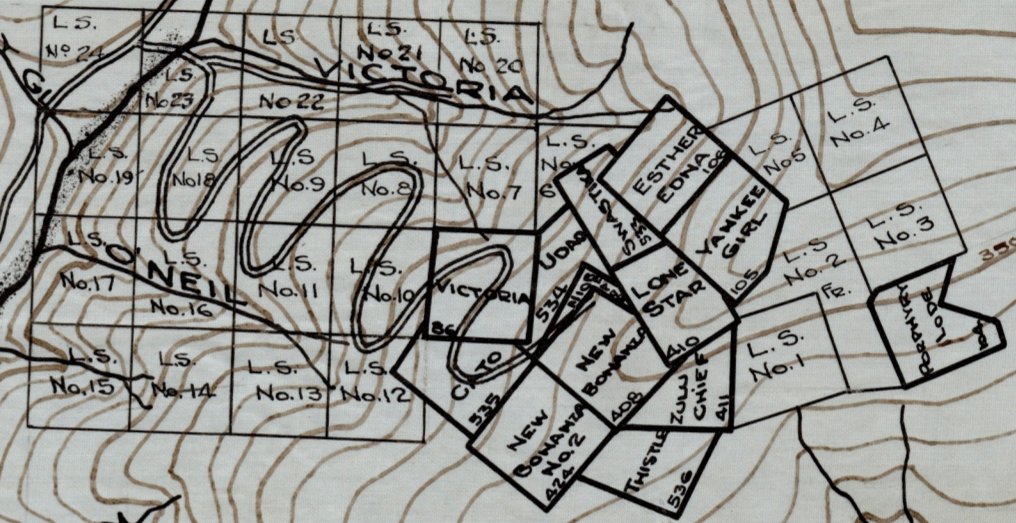

GENERAL MAP OF BONANZA CREEK SHOWING

LOCATION OF CONSOLIDATED LONE STAR LTD. PROPERTY

AND ADJACENT CLAIMS
A.M.N. Nov. 21st 1943 No. 1157